

TRANSPORTATION PROJECT PLAT NO: 1650-06-20 - 4.05

PART LOT 25 IN THE SUBDIVISION OF SECTION 35 LOCATED IN THE SOUTHEAST 1/4 OF THE NORTHWEST 1/4, SECTION 35, T3N, R3W, VILLAGE OF POTOSI, GRANT COUNTY, WISCONSIN

RELOCATION ORDER USH 61 DICKEYVILLE - LANCASTER (HICKORY LANE - ALONA LANE) GRANT COUNTY

TO PROPERLY ESTABLISH, LAY OUT, WIDEN, ENLARGE, EXTEND, CONSTRUCT, RECONSTRUCT, IMPROVE, OR MAINTAIN A PORTION OF THE HIGHWAY DESIGNATED ABOVE, THE STATE OF WISCONSIN DEPARTMENT OF TRANSPORTATION DEEMS IT NECESSARY TO RELOCATE OR CHANGE SAID HIGHWAY AND ACQUIRE CERTAIN LANDS AND INTERESTS OR RIGHTS IN LANDS FOR THE ABOVE PROJECT.

TO EFFECT THIS CHANGE, PURSUANT TO AUTHORITY GRANTED UNDER SECTION 84.02 (3), 84.09 AND 84.30, WISCONSIN STATUTES, THE DEPARTMENT OF TRANSPORTATION HEREBY ORDERS THAT:  
1. THAT PORTION OF SAID HIGHWAY AS SHOWN ON THIS PLAT IS LAID OUT AND ESTABLISHED TO THE LINES AND WIDTHS AS SO SHOWN FOR THE ABOVE PROJECT.  
2. THE LANDS OR INTERESTS OR RIGHTS IN LANDS AS SHOWN ON THIS PLAT ARE REQUIRED BY THE DEPARTMENT FOR THE ABOVE PROJECT AND SHALL BE ACQUIRED IN THE NAME OF THE STATE OF WISCONSIN, PURSUANT TO THE PROVISIONS OF SECTION 84.09 (1) OR (2), WISCONSIN STATUTES.

1" REBAR  
WITH CAP  
Y = 468,534.282  
X = 821,435.919

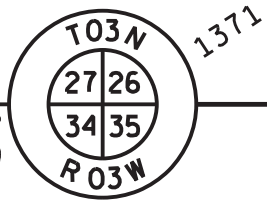

PISTA 836+50.48  
PIY =468054.390  
PIX =823017.230  
DELTA =70°19'20" (RT)  
R =1845.00  
D =3°06'20"  
T =1299.63  
L =2264.47  
PT STA 846+15.32

10' WATERMAIN  
EASEMENT  
DOC. # 443759

TLE - SLOPES  
0.09 AC.

LOT 25 OF THE  
SUBDIVISION OF SECTION 35

SE - NW  
SEC 35-T3N-R3W

STATION OFFSET TABLE		
POINT	STATION	OFFSET
205	822+45.00	58.04' LT
206	823+02.24	81.52' LT
207	823+50.85	85.00' LT
208	824+50.00	75.00' LT
209	824+50.00	58.07' LT

UTILITY SCHEDULE & INTEREST REQUIRED

UTILITY NUMBER	UTILITY OWNER (S)	INTEREST REQUIRED
109	VILLAGE OF TENNYSON (WATER)	RELEASE OF RIGHTS

UTILITY INTEREST TABLE			
UTILITY NUMBER	PARCEL	INTEREST DESCRIPTION	RECORDING INFORMATION
109	13	EASEMENT	DOC. # 443759

SCHEDULE OF LANDS & INTERESTS REQUIRED

OWNER'S NAMES ARE SHOWN FOR REFERENCE PURPOSES ONLY AND ARE SUBJECT TO CHANGE PRIOR TO THE TRANSFER OF LAND INTERESTS TO THE DEPARTMENT.

PARCEL NUMBER	OWNER (S)	INTEREST REQUIRED	R/W ACRES REQUIRED			TLE ACRES
			NEW	EXISTING	TOTAL	
13	JOINT SCHOOL DISTRICT 1 AND 10 OF THE VILLAGES OF POTOSI AND TENNYSON AND THE TOWNS OF POTOSI, HARRISON AND AND PARIS, GRANT COUNTY	TLE	---	---	---	0.09

ALL AREAS SHOWN IN ACRES UNLESS OTHERWISE NOTED.

EXISTING HIGHWAY RIGHT-OF-WAY SHOWN HEREIN IS BASED ON THE FOLLOWING POINTS OF REFERENCE:  
EXISTING HIGHWAY RIGHT-OF-WAY FOR USH 61 ESTABLISHED FROM PREVIOUS PROJECT DIVISION JOB 9453 AND  
EXISTING HIGHWAY RIGHT-OF-WAY FOR SIDE ROADS ESTABLISHED FROM CENTERLINE OF EXISTING PAVEMENTS.

recorded at the Grant County  
register of Deeds in  
Volume C  
Page 75A  
as Document # 788454  
August 15, 2017

RESERVED FOR REGISTER OF DEEDS  
PROJECT NUMBER 1650-06-20-4.05

3/4" REBAR  
WITH CAP  
Y = 468,533.611  
X = 824,094.877

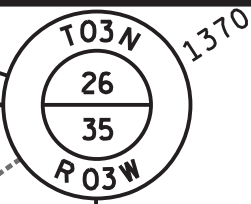

S89°59'08"E 2658.96'

VILLAGE

OF

TENNYSON

OF

POTOSI

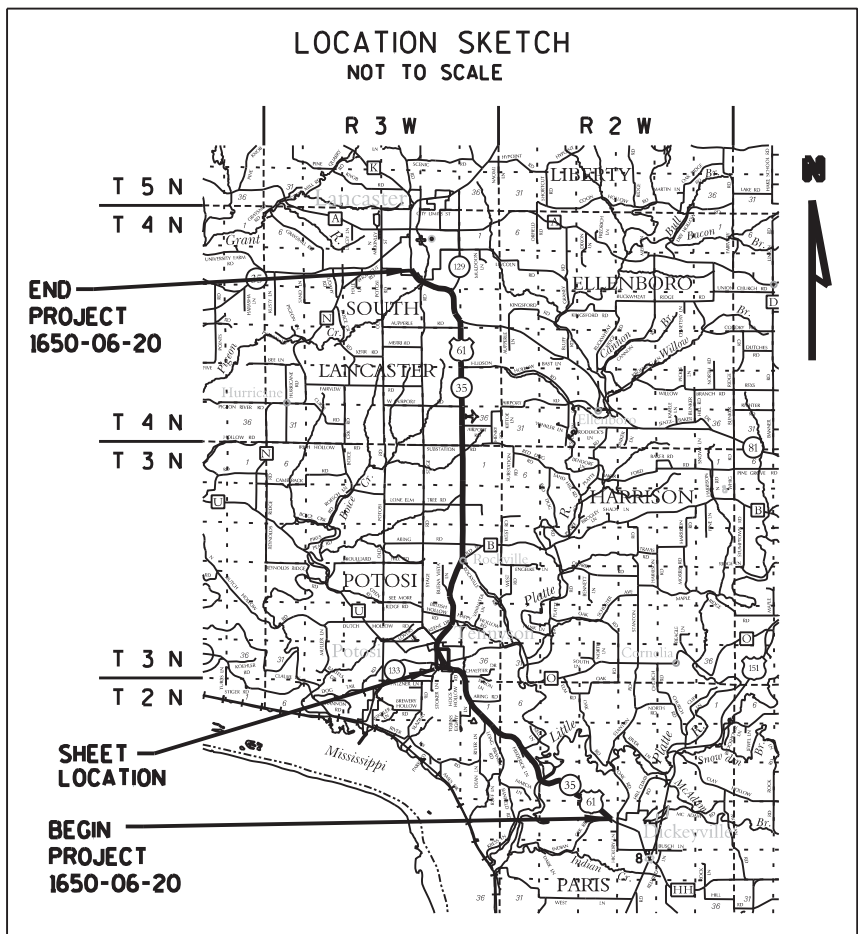

FOR ADDITIONAL INFORMATION REFER TO THE TITLE SHEET, RECORDED IN THE OFFICE OF THE REGISTER OF DEEDS, IN GRANT COUNTY, AS SHEET 2 OF 2 OF DOCUMENT #788245.



10 N. BRIDGE STREET  
CHIPPEWA FALLS, WI 54729



I, JASON L. CANCE, PROFESSIONAL LAND SURVEYOR, HEREBY CERTIFY THAT IN FULL COMPLIANCE WITH THE PROVISIONS OF SECTION 84.095 OF THE WISCONSIN STATUTES AND UNDER THE DIRECTION OF THE DEPARTMENT OF TRANSPORTATION SOUTHWEST REGION, I HAVE SURVEYED AND MAPPED THIS TRANSPORTATION PROJECT PLAT AND SUCH PLAT CORRECTLY REPRESENTS ALL EXTERIOR BOUNDARIES OF THE SURVEYED LAND.

SIGNATURE: *Jason L. Cance* DATE: 8-7-2017  
PRINTED NAME: JASON L. CANCE  
REGISTRATION NUMBER: S-2688

THIS PLAT AND RELOCATION ORDER ARE APPROVED FOR THE DEPARTMENT OF TRANSPORTATION SOUTHWEST REGION.

SIGNATURE: *Cory Schlager* DATE: 8/7/17  
PRINTED NAME: CORY SCHLAGEL