

NOTES:
FOR ADDITIONAL INFORMATION REFER TO THE TITLE SHEET, RECORDED IN THE OFFICE OF THE REGISTER OF DEEDS IN COLUMBIA COUNTY AS SHEET 2 OF 3 OF DOCUMENT #910751 AND FILED IN VOLUME 1, PAGE 309A.
POSITIONS SHOWN ON THIS PLAT ARE WISCONSIN COORDINATE REFERENCE SYSTEM COORDINATES (WISCRS), COLUMBIA COUNTY, NAD83(2011), IN U.S. SURVEY FEET. VALUES SHOWN ARE GRID COORDINATES, GRID BEARINGS, AND GRID DISTANCES. GRID DISTANCES MAY BE USED AS GROUND DISTANCES.
FOR THE LATEST ACCESS/DRIVEWAY INFORMATION, CONTACT THE PLANNING UNIT OF THE CITY OF PORTAGE.
FOUND PROPERTY PIPES ARE 3/4" REBAR, UNLESS OTHERWISE NOTED.

SCHEDULE OF LANDS & INTERESTS REQUIRED		OWNERS NAMES ARE SHOWN FOR REFERENCE PURPOSES ONLY, AND ARE SUBJECT TO CHANGE PRIOR TO TRANSFER OF LAND INTEREST TO THE CITY OF PORTAGE ALL AREAS SHOWN IN SQUARE FEET BUILDINGS WILL NOT BE AFFECTED BY TLES			
PARCEL NUMBER	OWNER(S)	INTEREST REQUIRED	R/W SQUARE FOOTAGE REQ'D NEW EXISTING TOTAL	TLE S.F.	
1	GREGORY J. IVERSON AND JULIE A. IVERSON	FEE/TLE	7038 ---- 7038	1259	
4	CITY OF PORTAGE	TLE	---- ---- ----	2295	
6	COLUMBIA COUNTY	FEE/TLE	264 ---- 264	1849	
9	WISCONSIN DEPARTMENT OF NATURAL RESOURCES	TLE	---- ---- ----	13560	
11	CHRISTOPHER D. SHADEL	FEE/TLE	178 ---- 178	762	
12	ASSOCIATED BANK PORTAGE NA	FEE/TLE	1206 ---- 1206	2026	
13	CARDINAL CONTRACTORS, INC., A WISCONSIN BUSINESS CORPORATION	FEE/TLE	149 ---- 149	581	
14	FIRSTAR BANK MADISON, N.A.	FEE/TLE	3074 ---- 3074	3278	
15	CITY BANK AND TRUST COMPANY, A WISCONSIN BANKING CORPORATION	FEE	500 ---- 500	----	
16	DARLENE M. CRAIG	TLE	---- ---- ----	332	

TRANSPORTATION PROJECT PLAT NO: 6918-01-22 - 4.02

THAT PART OF LOT 1, CERTIFIED SURVEY MAP NUMBER 1569 RECORDED IN VOLUME 7 OF CERTIFIED SURVEYS ON PAGE 119 AS DOCUMENT NUMBER 487272 COLUMBIA COUNTY REGISTER OF DEEDS, LOT 1, CERTIFIED SURVEY MAP NUMBER 1113 RECORDED IN VOLUME 5 OF CERTIFIED SURVEYS ON PAGE 105 AS DOCUMENT NUMBER 459865 COLUMBIA COUNTY REGISTER OF DEEDS, LOT 1, CERTIFIED SURVEY MAP NUMBER 256 RECORDED IN VOLUME 2 OF CERTIFIED SURVEYS ON PAGE 31 AS DOCUMENT NUMBER 378930 COLUMBIA COUNTY REGISTER OF DEEDS, LOT 1, CERTIFIED SURVEY MAP NUMBER 568 RECORDED IN VOLUME 3 OF CERTIFIED SURVEYS ON PAGE 43 AS DOCUMENT NUMBER 410533 COLUMBIA COUNTY REGISTER OF DEEDS, LOT 1, CERTIFIED SURVEY MAP NUMBER 2371 RECORDED IN VOLUME 15 OF CERTIFIED SURVEYS ON PAGE 67 AS DOCUMENT NUMBER 543845 COLUMBIA COUNTY REGISTER OF DEEDS, LOTS 13, 14, 15 AND 16, BLOCK 245, LOTS 1 AND 2, BLOCK 246, LOT 1, BLOCK 250, LOT 3 AND 4, BLOCK 54, LOT 5, BLOCK 254, LOT 1 AND VACATED ALLEY, BLOCK 255 OF JJ GUPPEY'S PLAT OF THE TOWN OF PORTAGE CITY, LOT 12, BLOCK 244 OF MC FARLANE, DUNN AND ARMSTRONG'S ADDITION, ALSO THAT PART OF VACATED EAST MULLETT STREET, VACATED MAIN STREET, VACATED DODGE STREET AND THE PORTAGE CANAL, ALL LOCATED IN GOVERNMENT LOT 6 OF SECTION 8, T 12 N, R 9 E; ALSO THAT PART OF LOT 1, CERTIFIED SURVEY MAP NUMBER 2371 RECORDED IN VOLUME 15 OF CERTIFIED SURVEYS ON PAGE 67 AS DOCUMENT NUMBER 543845 COLUMBIA COUNTY REGISTER OF DEEDS, LOT 12, BLOCK 247 AND LOT 12, BLOCK 244 OF MC FARLANE, DUNN AND ARMSTRONG'S ADDITION, ALL LOCATED IN GOVERNMENT LOT 5 OF SECTION 8, T 12 N, R 9 E; ALSO THAT PART OF LOT 1, CERTIFIED SURVEY MAP NUMBER 256 RECORDED IN VOLUME 2 OF CERTIFIED SURVEYS ON PAGE 31 AS DOCUMENT NUMBER 378930 COLUMBIA COUNTY REGISTER OF DEEDS, ALSO THAT PART OF VACATED DODGE STREET ALL LOCATED IN GRIGNON FRENCH CLAIM NO. 21, CITY OF PORTAGE, COLUMBIA COUNTY, WISCONSIN.

RELOCATION ORDER USH 51 CITY OF PORTAGE, WISCONSIN & DEWITT STREETS (ONTARIO STREET - EAST PLEASANT STREET)

TO PROPERLY ESTABLISH, LAY OUT, WIDEN, ENLARGE, EXTEND, CONSTRUCT, RECONSTRUCT, IMPROVE, OR MAINTAIN A PORTION OF THE HIGHWAY DESIGNATED ABOVE, THE CITY OF PORTAGE DEEMS IT NECESSARY TO RELOCATE OR CHANGE SAID HIGHWAY AND ACQUIRE CERTAIN LANDS AND INTERESTS OR RIGHTS IN LANDS FOR THE ABOVE PROJECT.

TO EFFECT THIS CHANGE, PURSUANT TO AUTHORITY GRANTED UNDER SECTION 62.22, WISCONSIN STATUTES, CITY OF PORTAGE HEREBY ORDERS THAT:
1. THAT PORTION OF SAID HIGHWAY AS SHOWN ON THIS PLAT IS LAID OUT AND ESTABLISHED TO THE LINES AND WIDTHS AS SO SHOWN FOR THE ABOVE PROJECT.
2. THE LANDS OR INTERESTS OR RIGHTS IN LANDS AS SHOWN ON THIS PLAT ARE REQUIRED BY THE CITY FOR THE ABOVE PROJECT AND SHALL BE ACQUIRED IN THE NAME OF THE CITY OF PORTAGE, PURSUANT TO THE PROVISIONS OF SECTION 62.22, WISCONSIN STATUTES.

911424
STATE OF WISCONSIN
COLUMBIA COUNTY
REGISTER OF DEEDS
RECEIVED FOR RECORD
DATE: 2-12-2019 TIME: 2:51 PM
Vol 1 Page 310

RESERVED FOR REGISTER OF DEEDS
PROJECT NUMBER 6918-01-22-4.02
SHEET 1 OF 2
AMENDMENT NO: _____

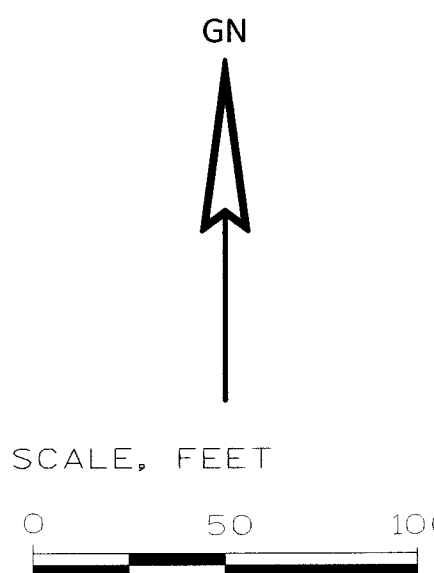

- (200) GENERAL TELEPHONE COMPANY (DBA FRONTIER COMMUNICATIONS)
V. 77, P. 11, DOC. 342993 (BLANKET EASEMENT) - PARCEL 14
- (201) ALLIANT ENERGY
NO RECORDED EASEMENT - PARCEL 4, PARCEL 6, PARCEL 9, PARCEL 12 AND PARCEL 13

UTILITY INTERESTS REQUIRED		
UTILITY NUMBER	UTILITY OWNER(S)	INTEREST REQUIRED
200	FRONTIER COMMUNICATIONS	RELEASE OF RIGHTS
201	ALLIANT ENERGY	RELEASE OF RIGHTS

GRIGNON FRENCH CLAIM NO. 21

BP 97+14.00'WS'
Y = 394034.636
X = 537341.977

BP 538+00.00'DW'
Y = 393801.664
X = 537876.367

PI 101+03.47'WS'
Y = 393877.156
X = 537698.188
Delta = 01° 40' 28" LT

PI 102+06.14'WS'
Y = 393838.403
X = 537793.264
Delta = 01° 40' 28" RT

PI 104+77.44'WS'
Y = 393728.702
X = 538041.401
Delta = 01° 14' 30" RT

PI 106+62.02'WS'
Y = 393650.428
X = 538208.561
Delta = 0° 19' 12" LT

BP 539+47.73'DW'
Y = 393949.128
X = 537915.448
Delta = 46° 49' 50" RT
D = 28° 56' 14"
T = 85.75'
L = 161.84'
R = 198.00'
PT STA. 540+28.65'DW'
AH. BRG. = N31° 59' 14"W

LOCATION SKETCH

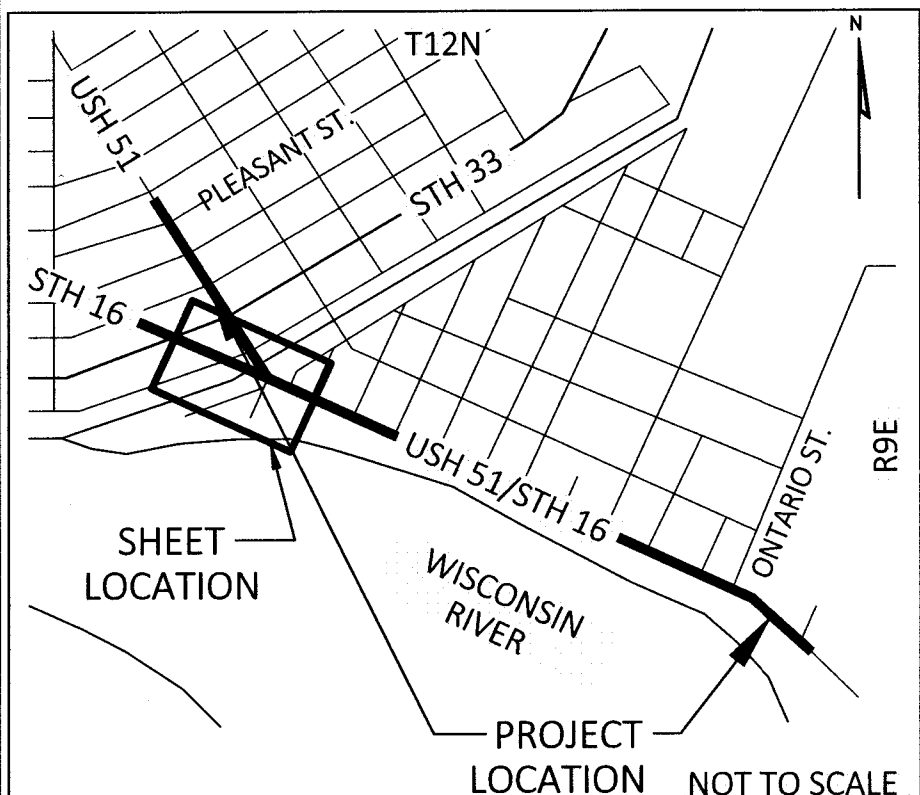

HIGHWAY	BASIS
USH 51 / STH 16 WISCONSIN ST.	R/W PLAT 6996-05-06, MC FARLANE, DUNN AND ARMSTRONG'S ADDITION TO THE CITY OF PORTAGE, CSM 1113, CSM 4645, PLATS OF SURVEYS 13164, 13857, 10369, 5471, 7612, 5470.
USH 51 / DEWITT ST.	R/W PLAT 6996-05-06, JJ GUPPEY'S SUBDIVISION OF THE CITY OF PORTAGE, CSM 1569, PLATS OF SURVEY 7022.
EDGEWATER ST.	JJ GUPPEY'S SUBDIVISION OF THE CITY OF PORTAGE, MC FARLANE, DUNN AND ARMSTRONG'S ADDITION TO THE CITY OF PORTAGE, CSM 1569, PLATS OF SURVEYS 13164, 5466, 13857, 7022.
DODGE ST.	JJ GUPPEY'S SUBDIVISION OF THE CITY OF PORTAGE, WEBB AND BRONSON'S PLAT OF THE CITY OF PORTAGE, PLATS OF SURVEYS 5373, 5470, 5371.
EAST MULLETT ST.	JJ GUPPEY'S SUBDIVISION OF THE CITY OF PORTAGE, CSM 1113, PLATS OF SURVEYS 7612, 5470, 5471.
WEST MULLETT ST.	JJ GUPPEY'S SUBDIVISION OF THE CITY OF PORTAGE, PLATS OF SURVEYS 2021, 13425.
WARREN ST.	JJ GUPPEY'S SUBDIVISION OF THE CITY OF PORTAGE, DOCUMENT NO. 471209, CSM 568.
COOK ST. / STH 33	JJ GUPPEY'S SUBDIVISION OF THE CITY OF PORTAGE, CSM 4095, CSM 2460, PLATS OF SURVEYS 13164, 12754, 12268.

FILE NAME : G:\WDOTSW\15026-000\CIVIL 3D\SHEETS\PLAN\RW\040101-RP.DWG
APPRAISAL PLAT DATE : JANUARY 29, 2019

PLOT DATE : 1/29/2019 10:45 AM

PLOT BY : KL ENGINEERING

PLOT NAME :

PLOT SCALE : 1 IN=100 FT

6918-01-22 4.02