

STATE OF WISCONSIN  
DEPARTMENT OF TRANSPORTATION  
TRANSPORTATION PROJECT PLAT TITLE SHEET  
6918-01-22  
CITY OF PORTAGE, WISCONSIN & DEWITT STREETS  
(ONTARIO STREET - EAST PLEASANT STREET)

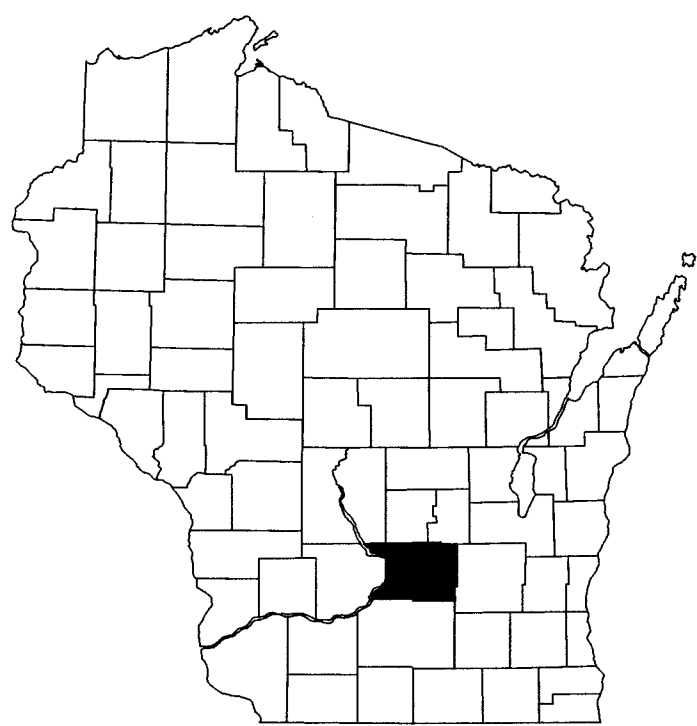

CONVENTIONAL SYMBOLS

SECTION LINE	---	SECTION CORNER SYMBOL		R/W MONUMENT (TO BE SET)	●
QUARTER LINE	---	SECTION CORNER MONUMENT		NON-MONUMENTED R/W POINT	○
SIXTEENTH LINE	---	GEODETIC SURVEY MONUMENT		FOUND IRON PIN (3/4-INCH UNLESS NOTED)	IP
NEW REFERENCE LINE	---	SIXTEENTH CORNER MONUMENT		FOUND CHISLED X	CX
NEW R/W LINE	---	SIGN	IP SIGN	OFF-PREMISE SIGN	
EXISTING R/W OR HE LINE	---				
PROPERTY LINE	---				
LOT, TIE & OTHER MINOR LINES	---				
SLOPE INTERCEPT	---				
CORPORATE LIMITS	---				
UNDERGROUND FACILITY (COMMUNICATIONS, ELECTRIC, ETC)	---				
NEW R/W (FEE OR HE) (HATCHING VARIES BY OWNER)	---				
TEMPORARY LIMITED EASEMENT AREA	---				
EASEMENT AREA (PERMANENT LIMITED OR RESTRICTED DEVELOPMENT)	---				
TRANSMISSION STRUCTURES	---				
BUILDING	---				
BRIDGE	---				

CONVENTIONAL ABBREVIATIONS

ACCESS RIGHTS	AR	POINT OF INTERSECTION	PI
ACRES	AC	PROPERTY LINE	PL
AHEAD	AH	RECORDED AS	(100')
ALUMINUM	ALUM	REEL / IMAGE	R/I
AND OTHERS	ET AL	REFERENCE LINE	R/L
BACK	BK	REMAINING	REM
BLOCK	BLK	RESTICTIVE DEVELOPMENT	RDE
CENTERLINE	C/L	EASEMENT	
CERTIFIED SURVEY MAP	CSM	RIGHT	RT
CONCRETE	CONC	RIGHT OF WAY	R/W
COUNTY	CO	SECTION	SEC
COUNTY TRUNK HIGHWAY	CTH	SEPTIC VENT	SEPV
DISTANCE	DIST	SQUARE FEET	SF
CORNER	COR	STATE TRUNK HIGHWAY	STH
DOCUMENT NUMBER	DOC	STATION	STA
EASEMENT	EASE	TELEPHONE PEDESTAL	TP
EXISTING	EX	TEMPORARY LIMITED	TLE
GAS VALVE	GV	EASEMENT	
GRID NORTH	GN	TRANSPORTATION PROJECT	TPP
HIGHWAY EASEMENT	HE	PLAT	
IDENTIFICATION	ID	UNITED STATES HIGHWAY	USH
LAND CONTRACT	LC	VOLUME	V
LEFT	LT		
MONUMENT	MON		
NATIONAL GEODETIC SURVEY	NGS		
NUMBER	NO		
OUTLOT	OL		
PAGE	P		
POINT OF TANGENCY	PT		
PERMANENT LIMITED EASEMENT	PLE		
POINT OF BEGINNING	POB		
POINT OF CURVATURE	PC		
POINT OF COMPOUND CURVE	PCC		

CURVE DATA

LONG CHORD	LCH
LONG CHORD BEARING	LCB
RADIUS	R
DEGREE OF CURVE	D
CENTRAL ANGLE	Δ/DELTA
LENGTH OF CURVE	L
TANGENT	T
DIRECTION AHEAD	DA
DIRECTION BACK	DB

CONVENTIONAL UTILITY SYMBOLS

W	WATER
G	GAS
T	TELEPHONE
OH	OVERHEAD
TL	TRANSMISSION LINES
E	ELECTRIC
TV	CABLE TELEVISION
FO	FIBER OPTIC
SAN	SANITARY SEWER
SS	STORM SEWER

R-9-E

GN

USH 51  
COLUMBIA COUNTY

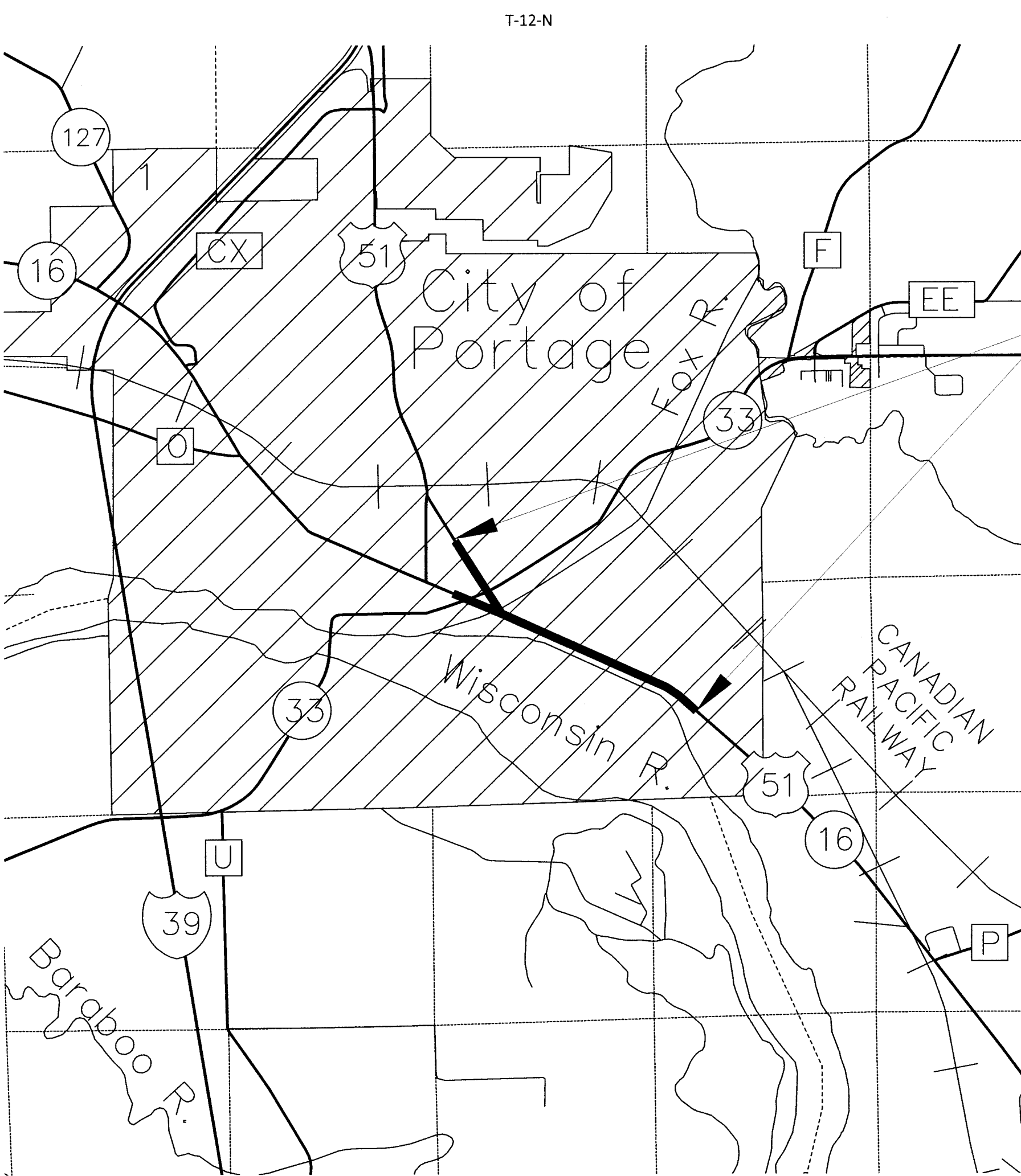

LAYOUT  
SCALE 0 0.5 MI.

THE NOTES, CONVENTIONAL SIGNS, AND ABBREVIATIONS ARE ASSOCIATED WITH EACH TRANSPORTATION PROJECT PLAT FOR PROJECT 6918-01-22

NOTES:

POSITIONS SHOWN ON THIS PLAT ARE WISCONSIN COORDINATE REFERENCE SYSTEM COORDINATES (WISCRS), COLUMBIA COUNTY, NAD83(2011), IN U.S. SURVEY FEET. VALUES SHOWN ARE GRID COORDINATES, GRID BEARINGS, AND GRID DISTANCES. GRID DISTANCES MAY BE USED AS GROUND DISTANCES.

RIGHT-OF-WAY MONUMENTS WILL BE TYPE 2 (TYPICALLY 3/4" X 24" IRON REBAR), UNLESS OTHERWISE NOTED, AND WILL BE PLACED PRIOR TO THE COMPLETION OF THE PROJECT.

ALL RIGHT-OF-WAY BOUNDARIES DEPICTED IN THE NON-ACQUISITION AREAS ARE INTENDED TO RE-ESTABLISH EXISTING RIGHT-OF-WAY LINES AS DETERMINED FROM PREVIOUS PROJECTS, OTHER RECORDED DOCUMENTS, OR FROM CENTERLINE OF EXISTING PAVEMENTS.

RIGHT-OF-WAY BOUNDARIES ARE DEFINED WITH COURSES OF THE PERIMETER OF THE HIGHWAY LANDS REFERENCED TO THE U.S. PUBLIC LAND SURVEY SYSTEM OR OTHER "SURVEYS" OF PUBLIC RECORD.

DIMENSIONING FOR THE NEW RIGHT-OF-WAY IS MEASURED ALONG AND PERPENDICULAR TO THE NEW REFERENCE LINES.

A TEMPORARY LIMITED EASEMENT (TLE) IS A RIGHT FOR CONSTRUCTION PURPOSES, AS DEFINED HEREIN, INCLUDING THE RIGHT TO OPERATE NECESSARY EQUIPMENT THEREON, THE RIGHT OF INGRESS AND EGRESS, AS LONG AS REQUIRED FOR SUCH PUBLIC PURPOSE, INCLUDING THE RIGHT TO PRESERVE, PROTECT, REMOVE, OR PLANT THEREON ANY VEGETATION THAT THE HIGHWAY AUTHORITIES MAY DEEM DESIRABLE. ALL (TLEs) ON THIS PLAT EXPIRE AT THE COMPLETION OF THE CONSTRUCTION PROJECT FOR WHICH THIS INSTRUMENT IS GIVEN.

PROPERTY LINES SHOWN ON THIS PLAT ARE DRAWN FROM DATA DERIVED FROM MAPS AND DOCUMENTS OF PUBLIC RECORD AND/OR EXISTING OCCUPATIONAL LINES. THIS PLAT MAY NOT BE A TRUE REPRESENTATION OF EXISTING PROPERTY LINES, EXCLUDING RIGHT-OF-WAY, AND SHOULD NOT BE USED AS A SUBSTITUTE FOR AN ACCURATE FIELD SURVEY.

FOR THE LATEST ACCESS/DRIVEWAY INFORMATION, CONTACT THE PLANNING UNIT OF THE CITY OF PORTAGE.

PARCEL IDENTIFICATION NUMBERS MAY NOT POINT TO ALL AREAS OF ACQUISITION, AS NOTED ON THE SCHEDULE OF LANDS & INTERESTS REQUIRED.

EXISTING ACCESS CONTROL ALONG USH 51 HAS BEEN ESTABLISHED FROM PREVIOUS PROJECT CA 05-2(1).

PROJECT LOCATION

EXISTING HIGHWAY RIGHT-OF-WAY SHOWN HEREIN IS BASED ON THE FOLLOWING POINTS OF REFERENCE:

EXISTING HIGHWAY RIGHT-OF-WAY FOR USH 51 / DEWITT STREET ESTABLISHED FROM PREVIOUS PROJECTS AND SURVEYS: R/W PLAT 6996-05-06, JJ GUPPEY'S SUBDIVISION OF THE CITY OF PORTAGE, CSM 1569, CSM 2460, CSM 4645, PLATS OF SURVEYS 9980, 13164, 12268, 5466, 7022.

EXISTING HIGHWAY RIGHT-OF-WAY FOR USH 51 / STH 16 / WISCONSIN STREET ESTABLISHED FROM PREVIOUS PROJECTS AND SURVEYS: R/W PLAT 6996-05-06, JJ GUPPEY'S SUBDIVISION OF THE CITY OF PORTAGE, WEBB AND BRONSON'S PLAT OF THE CITY OF PORTAGE, MC FARLANE, DUNN AND ARMSTRONG'S ADDITION TO THE CITY OF PORTAGE, CSM 1113, CSM 5166, CSM 1329, CSM 1042, CSM 4645, CSM 5165, CSM 5209, CSM 1034, PLATS OF SURVEYS 13164, 13857, 10369, 5471, 7612, 5470, 1571, 13120, 9135, 8955, 4349, 10213, 5362, 14524, 5230, 5361, 9859, 9088, 5347, 6959.

EXISTING HIGHWAY RIGHT-OF-WAY FOR PLEASANT STREET ESTABLISHED FROM PREVIOUS SURVEYS: JJ GUPPEY'S SUBDIVISION OF THE CITY OF PORTAGE, PLATS OF SURVEYS 5459, 9980, 14531.

EXISTING HIGHWAY RIGHT-OF-WAY FOR CONANT STREET ESTABLISHED FROM PREVIOUS SURVEYS: JJ GUPPEY'S SUBDIVISION OF THE CITY OF PORTAGE, CSM 2640, CSM 4645, PLATS OF SURVEYS 9980, 13164, 11537, 5579.

EXISTING HIGHWAY RIGHT-OF-WAY FOR COOK STREET / STH 33 ESTABLISHED FROM PREVIOUS SURVEYS: JJ GUPPEY'S SUBDIVISION OF THE CITY OF PORTAGE, CSM 2460, CSM 4095, PLATS OF SURVEYS 13164, 12754, 12268.

EXISTING HIGHWAY RIGHT-OF-WAY FOR EDGEWATER STREET ESTABLISHED FROM PREVIOUS SURVEYS: MC FARLANE, DUNN AND ARMSTRONG'S ADDITION TO THE CITY OF PORTAGE, CSM 1569, PLATS OF SURVEYS 13164, 5466, 13857, 7022.

EXISTING HIGHWAY RIGHT-OF-WAY FOR DODGE STREET ESTABLISHED FROM PREVIOUS SURVEYS: JJ GUPPEY'S SUBDIVISION OF THE CITY OF PORTAGE, WEBB AND BRONSON'S PLAT OF THE CITY OF PORTAGE, PLATS OF SURVEYS 5373, 5470, 5371.

EXISTING HIGHWAY RIGHT-OF-WAY FOR EAST MULLETT STREET ESTABLISHED FROM PREVIOUS SURVEYS: CSM 1113, PLATS OF SURVEYS 7612, 5470, 5471.

EXISTING HIGHWAY RIGHT-OF-WAY FOR WEST MULLETT STREET ESTABLISHED FROM PREVIOUS SURVEYS: JJ GUPPEY'S SUBDIVISION OF THE CITY OF PORTAGE, PLATS OF SURVEYS 2012, 13425.

EXISTING HIGHWAY RIGHT-OF-WAY FOR WARREN STREET ESTABLISHED PREVIOUS SURVEYS: JJ GUPPEY'S SUBDIVISION OF THE CITY OF PORTAGE, DOCUMENT NO. 471209, CSM 568.

EXISTING HIGHWAY RIGHT-OF-WAY FOR PAUQUETTE STREET ESTABLISHED FROM PREVIOUS SURVEYS: WEBB AND BRONSON'S PLAT OF THE CITY OF PORTAGE, PLAT OF SURVEY 1571.

EXISTING HIGHWAY RIGHT-OF-WAY FOR BRADY STREET ESTABLISHED FROM PREVIOUS SURVEYS: WEBB AND BRONSON'S PLAT OF THE CITY OF PORTAGE, PLATS OF SURVEYS 13120, 5367, 9135, 8955.

EXISTING HIGHWAY RIGHT-OF-WAY FOR BROOKE STREET ESTABLISHED FROM PREVIOUS SURVEYS: WEBB AND BRONSON'S PLAT OF THE CITY OF PORTAGE, PLATS OF SURVEYS 9135, 8955.

EXISTING HIGHWAY RIGHT-OF-WAY FOR WASHINGTON STREET ESTABLISHED FROM PREVIOUS SURVEYS: WEBB AND BRONSON'S PLAT OF THE CITY OF PORTAGE, PLAT OF SURVEY 4349.

EXISTING HIGHWAY RIGHT-OF-WAY FOR SUPERIOR STREET ESTABLISHED FROM PREVIOUS SURVEYS: WEBB AND BRONSON'S PLAT OF THE CITY OF PORTAGE, PLATS OF SURVEYS 5798, 10213, 5362, 7043, 14524.

EXISTING HIGHWAY RIGHT-OF-WAY FOR MICHIGAN STREET ESTABLISHED FROM PREVIOUS SURVEYS: WEBB AND BRONSON'S PLAT OF THE CITY OF PORTAGE, PLATS OF SURVEYS 3804, 9859, 5362.

EXISTING HIGHWAY RIGHT-OF-WAY FOR WAUONA TRAIL ESTABLISHED FROM PREVIOUS SURVEYS: WEBB AND BRONSON'S PLAT OF THE CITY OF PORTAGE, PLATS OF SURVEYS 5230, 5361, 5345, 9088, 5347.

EXISTING HIGHWAY RIGHT-OF-WAY FOR HURON STREET ESTABLISHED FROM PREVIOUS SURVEYS: WEBB AND BRONSON'S PLAT OF THE CITY OF PORTAGE, PLATS OF SURVEYS 5345, 9088, 5347.

EXISTING HIGHWAY RIGHT-OF-WAY FOR ERIE STREET ESTABLISHED FROM PREVIOUS SURVEYS: WEBB AND BRONSON'S PLAT OF THE CITY OF PORTAGE, CSM 5166, PLATS OF SURVEYS 5345, 6959.

EXISTING HIGHWAY RIGHT-OF-WAY FOR ONTARIO STREET ESTABLISHED FROM PREVIOUS SURVEYS: WEBB AND BRONSON'S PLAT OF THE CITY OF PORTAGE, CSM 5166, CSM 1329, CSM 1042, CSM 5165.

EXISTING HIGHWAY RIGHT-OF-WAY FOR SOUTHTOWN ROAD ESTABLISHED FROM PREVIOUS SURVEYS: CSM 5209, CSM 1034, DOCUMENT 365152.

PROJECT NUMBER 6918-01-22 - 4.01  
SHEET 2 OF 3