

# 1003-10-81: Emergency Access (Hart Road to Avalon Road)

June 12, 2018

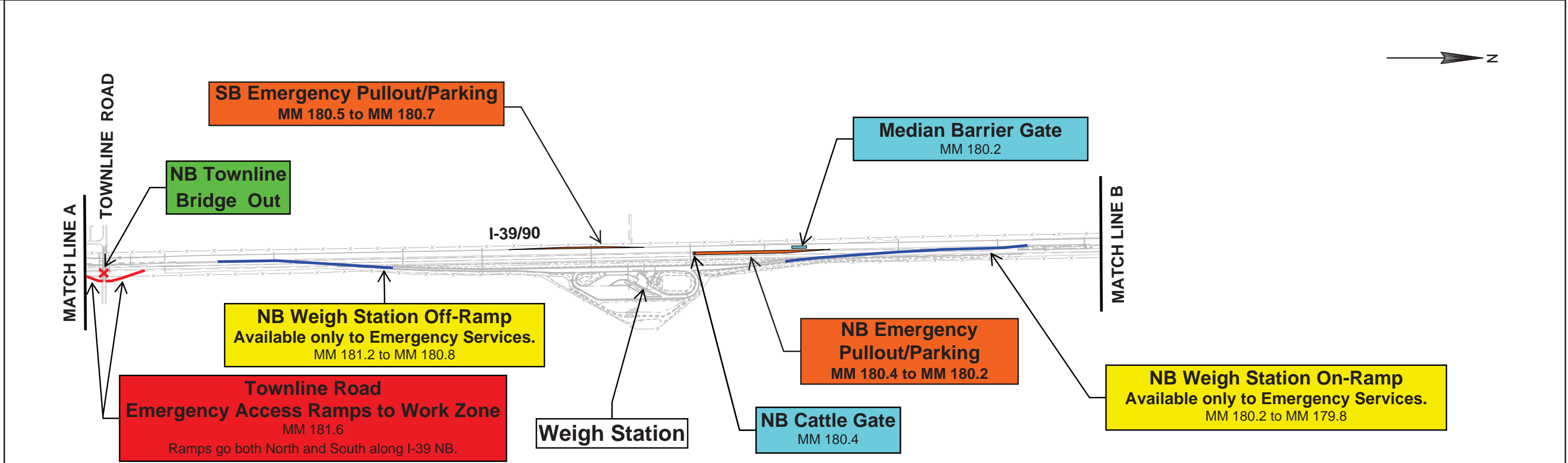
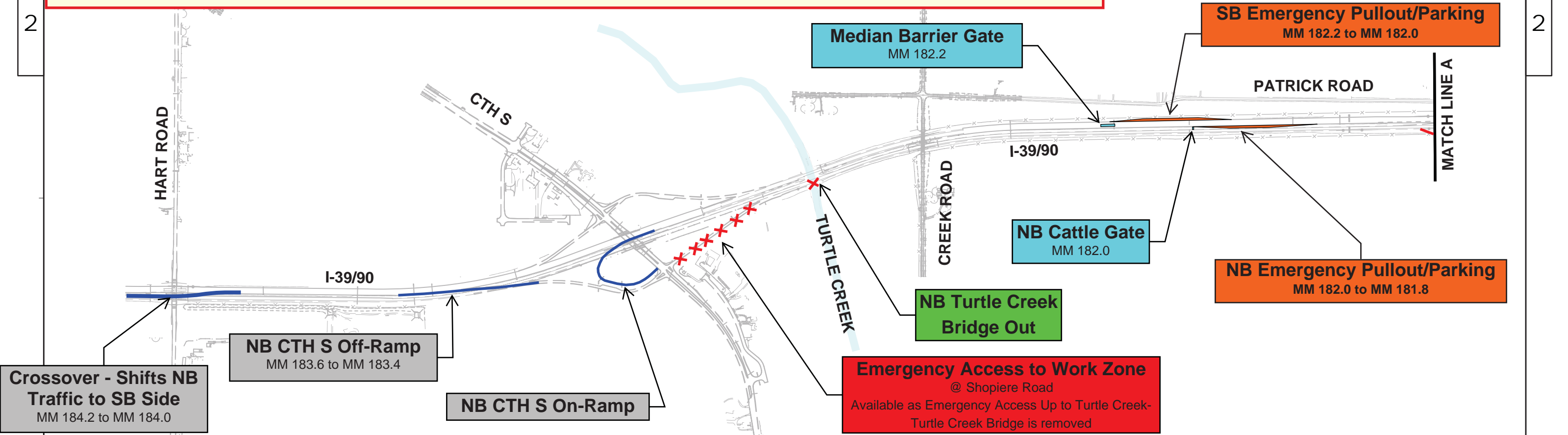

2

2

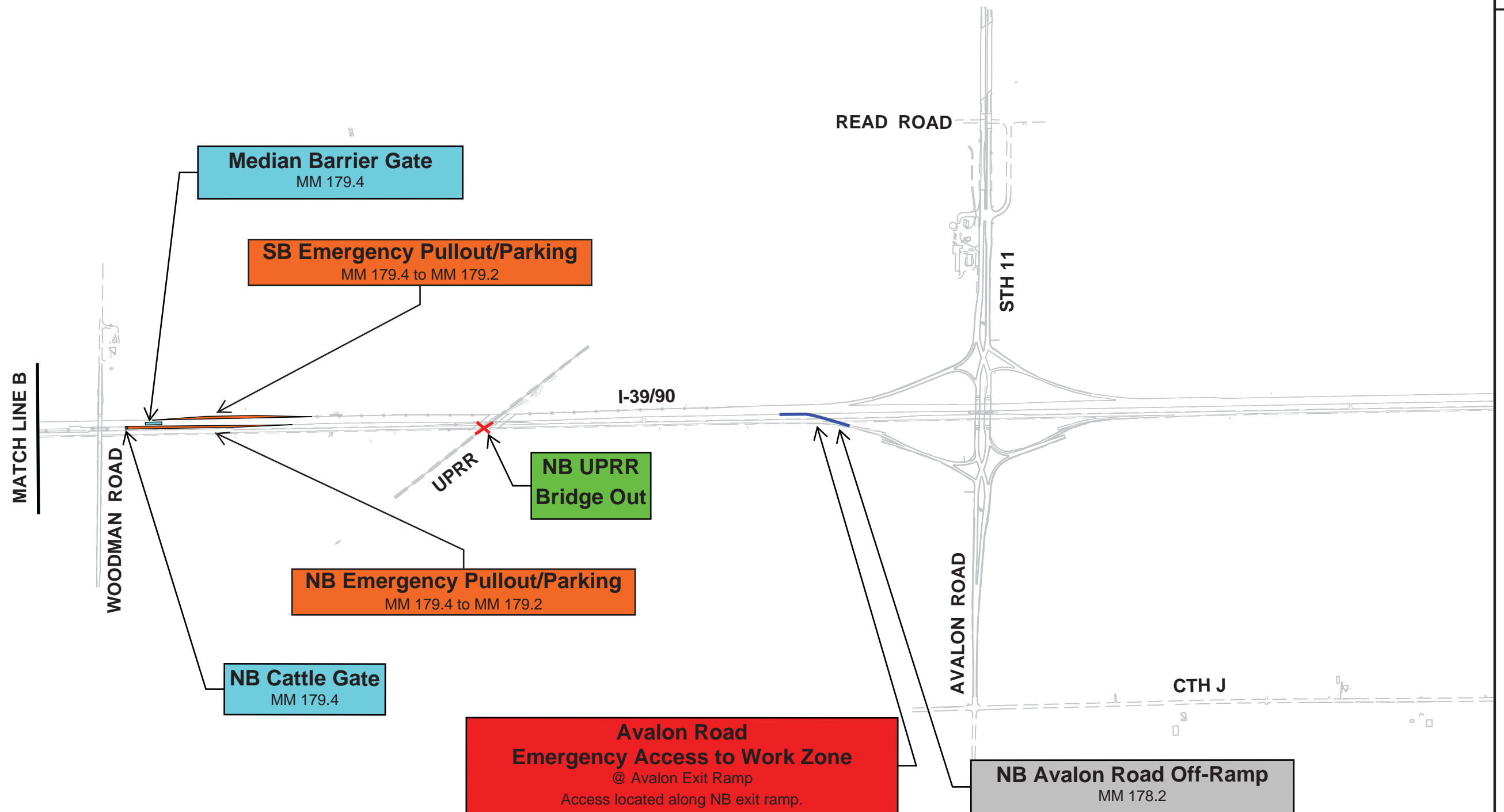

1003-10-84 Emergency Access (Avalon Road to STH 11)  
As of 6/1/18 Traffic is bi-directional in the SB lanes.

June 12, 2018

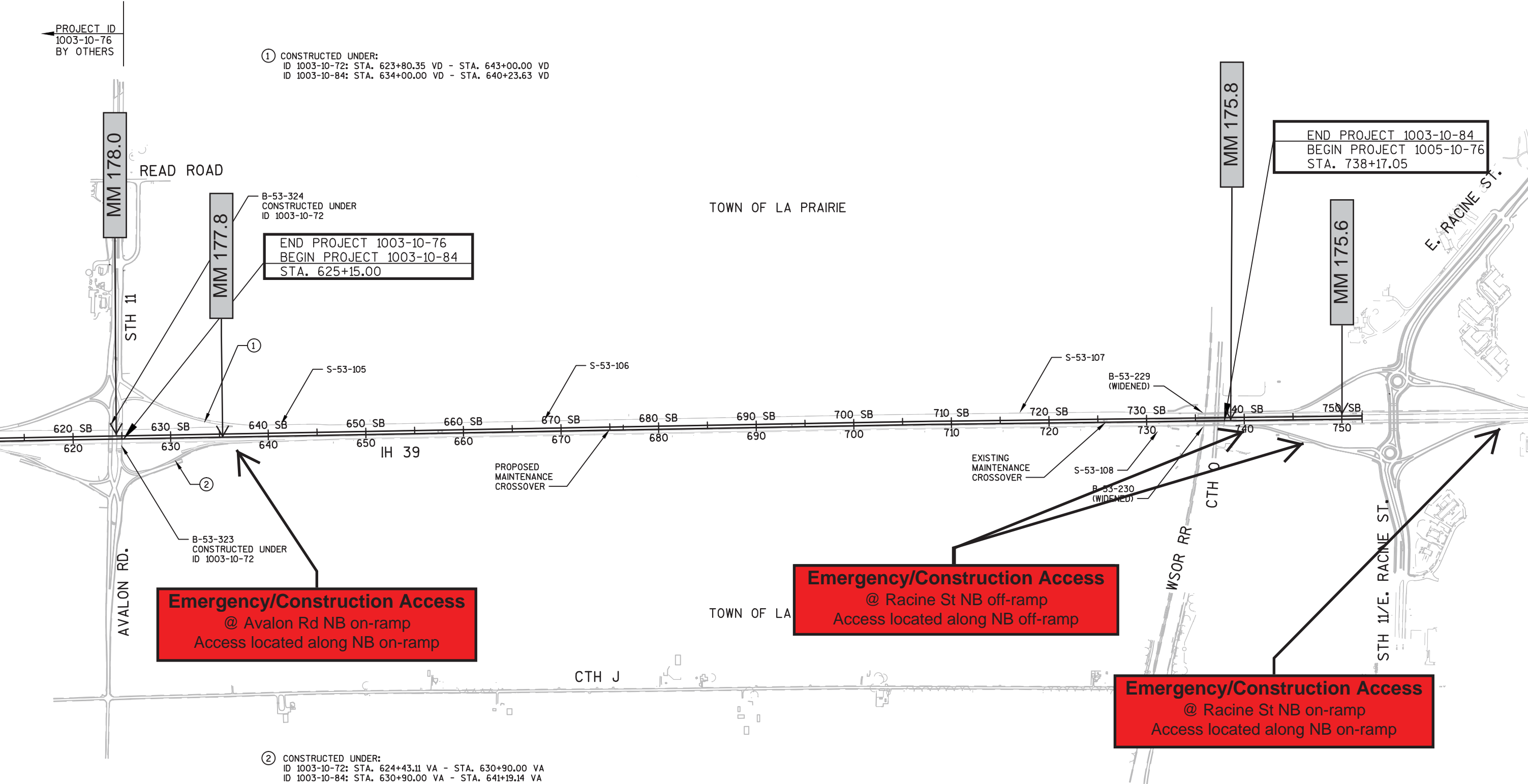

1005-10-76 Emergency Access (STH 11 to USH 14)

As of 6/1/18 Traffic is bi-directional in the SB lanes.

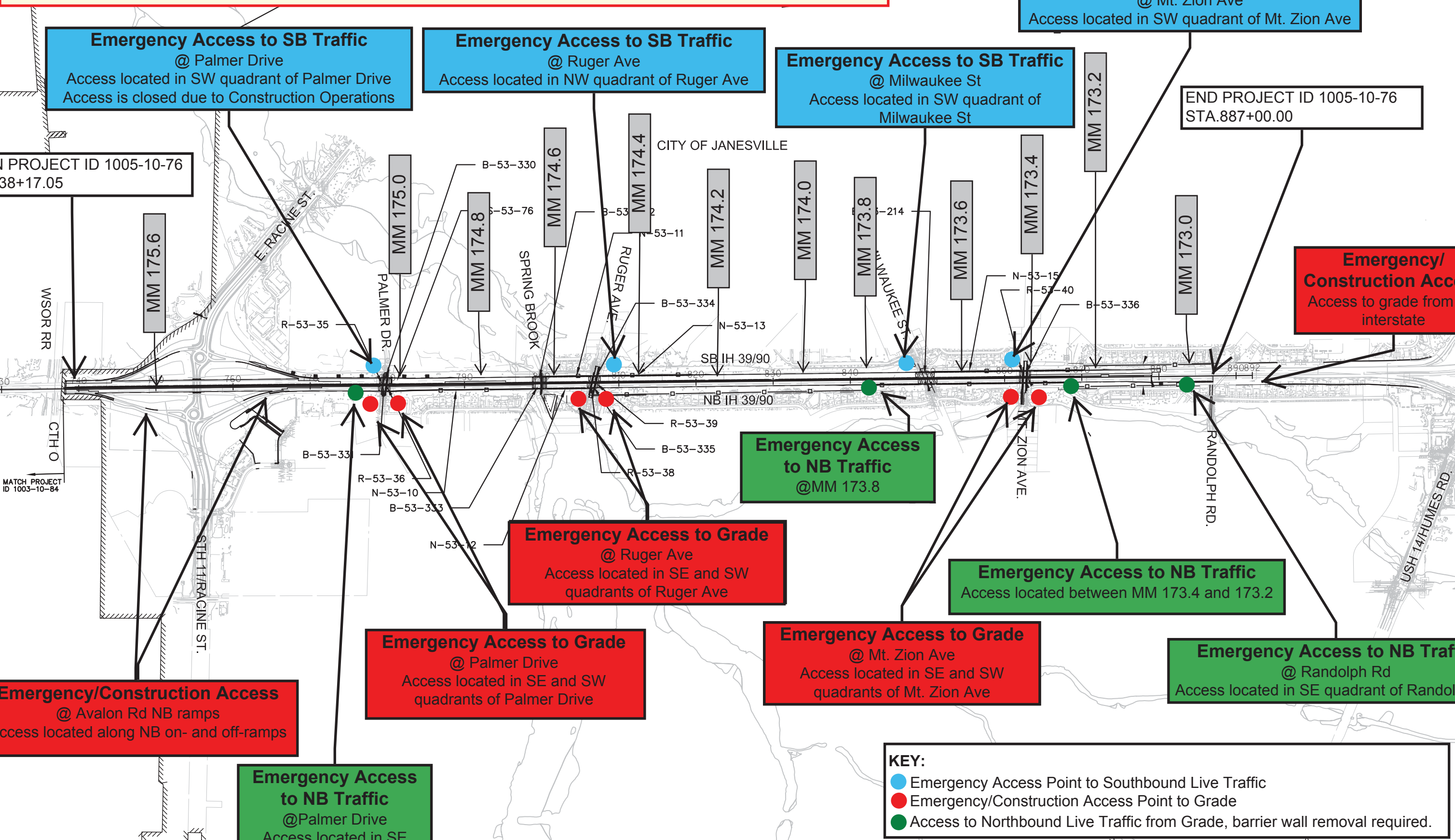



1007-11-74 Emergency Access (S. Dane County Line to East Church Rd)

June 12, 2018

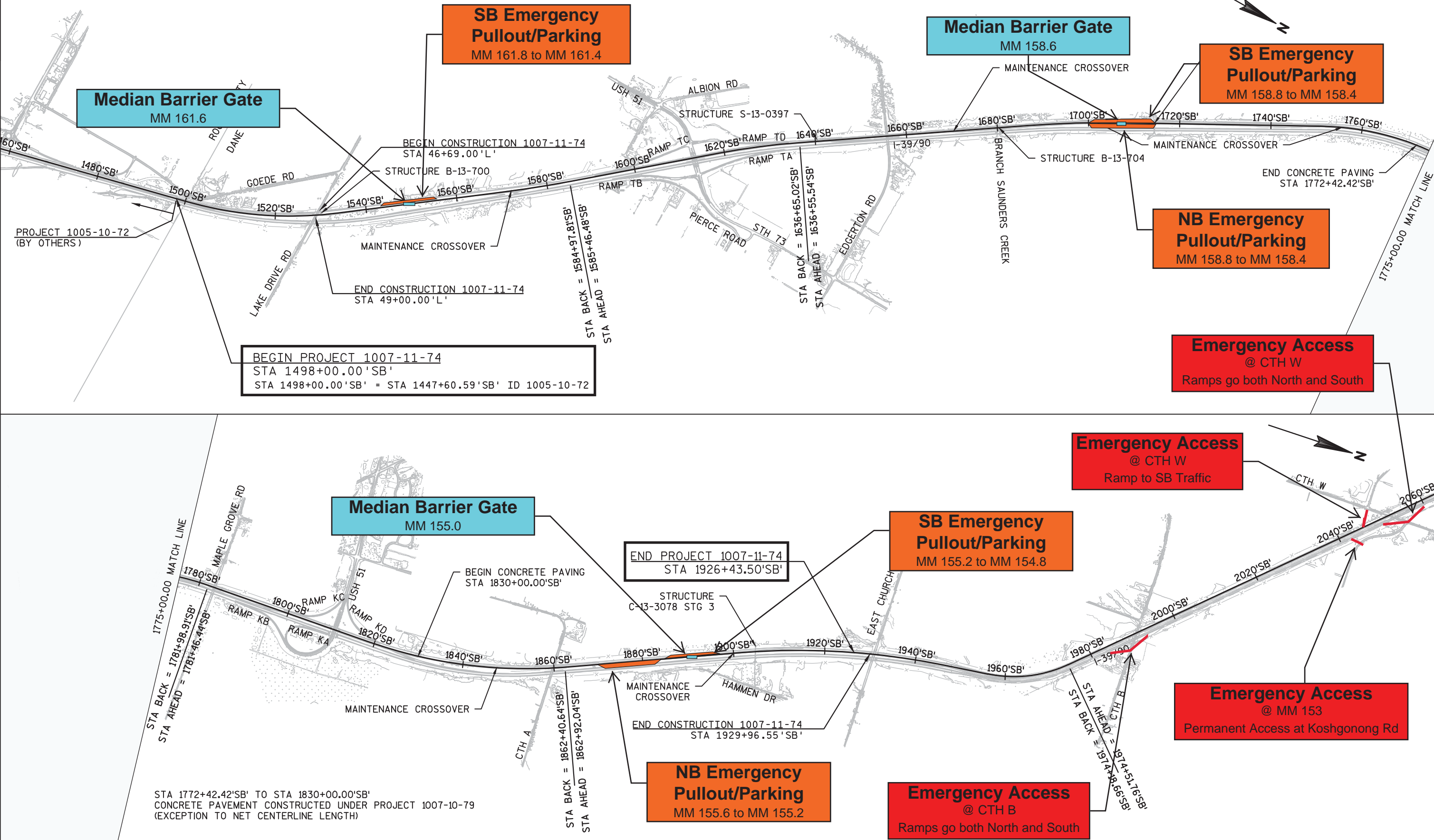

# 1007-11-71 Emergency Access (East Church Rd to Church St)

June 12, 2018

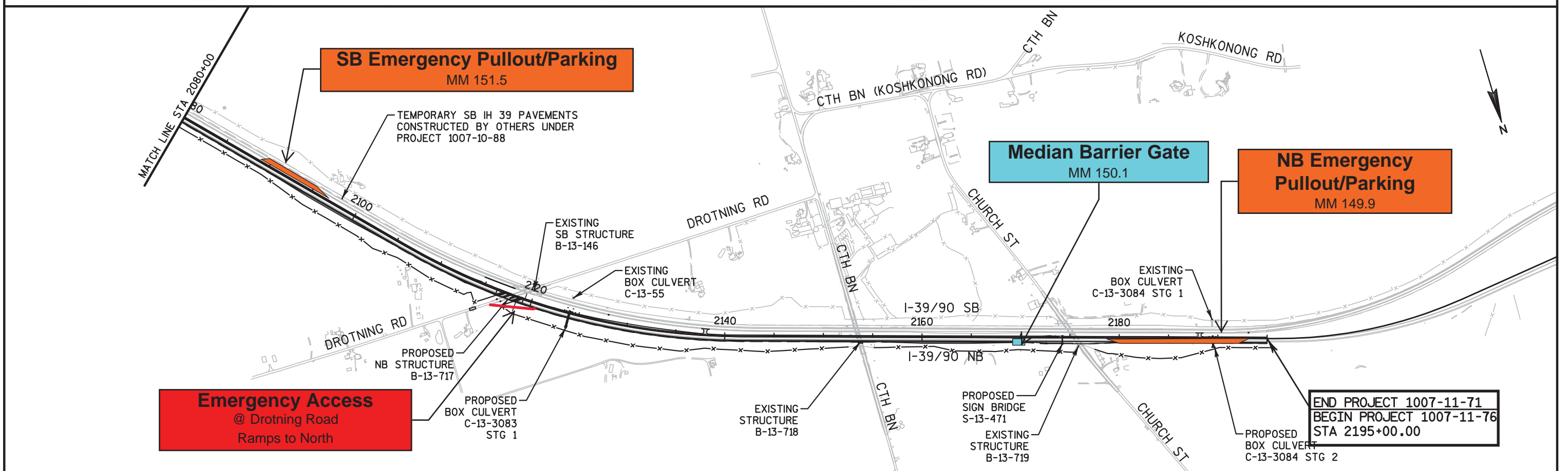
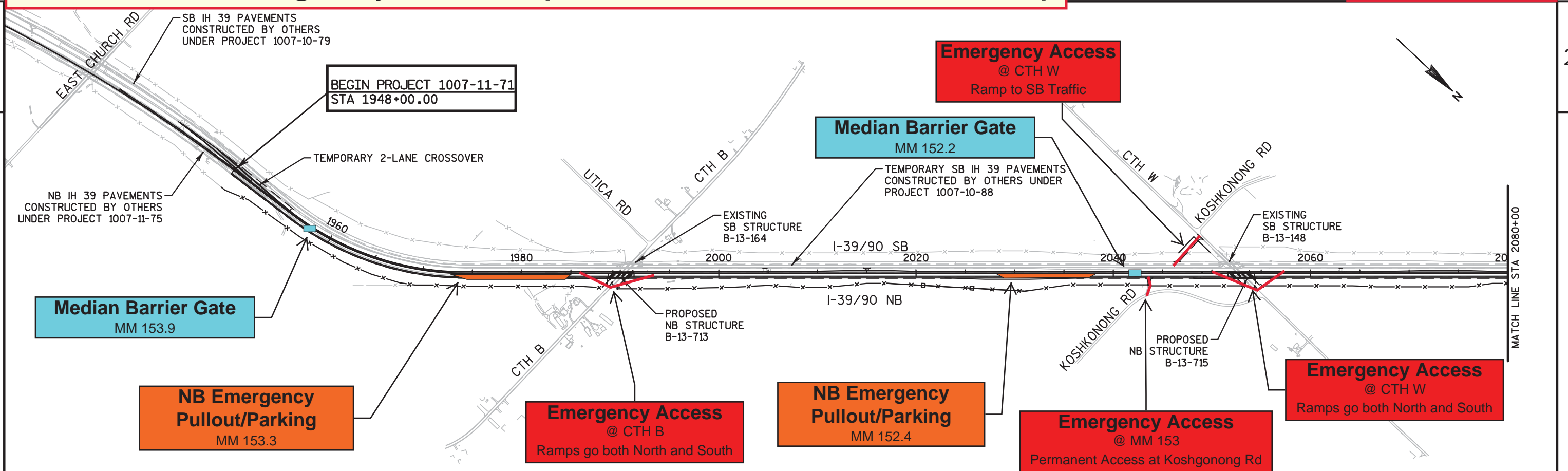



1007-11-76 Emergency Access (Church St to CTH AB)

June 12, 2018

