

TRAIL SIGN LAYOUT

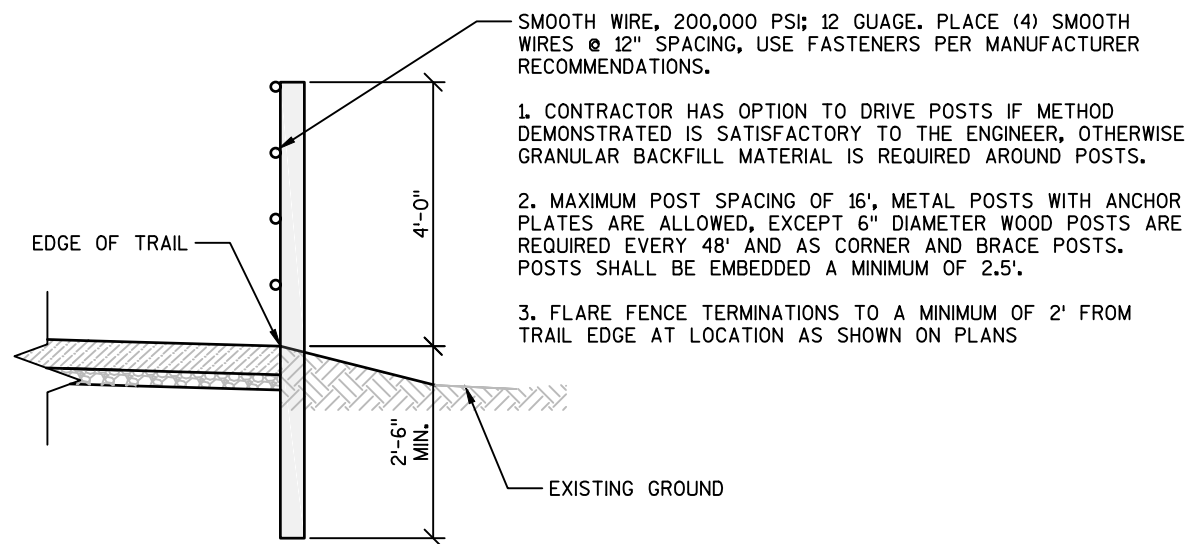

FENCE INSTALLATION DETAIL

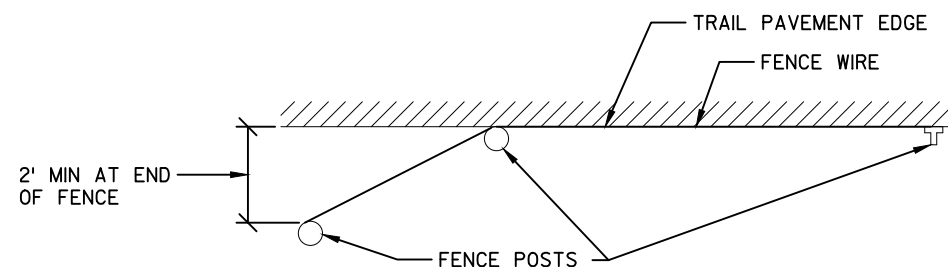

FENCE INSTALLATION DETAIL - END FLARE
TYPICAL SECTION

**Great Sauk State Trail
Prairie Du Sac/Sauk City Unit
Sauk County, Wisconsin**

Date

5/30/2017

Date	Revision

Drawing Name

**Construction
Details
Crosswalk &
Curb Information**

Sheet Number

C4.1

Project Number

16217

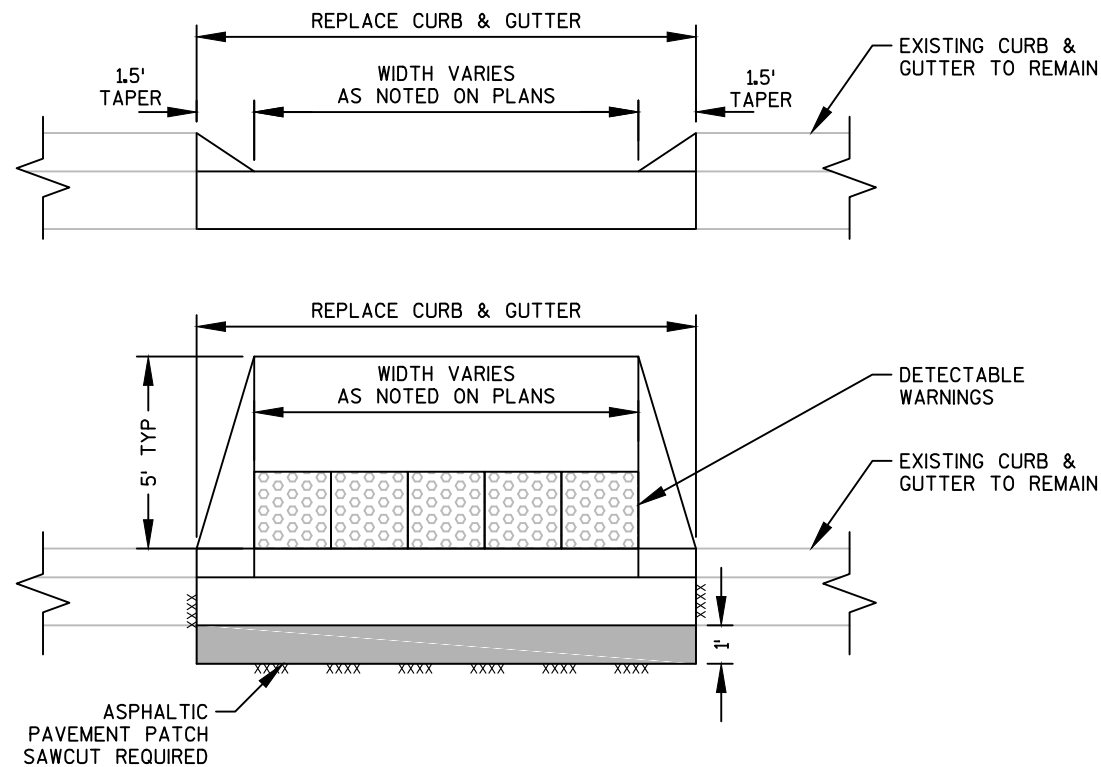

TYPICAL CURB REPLACEMENT DETAIL

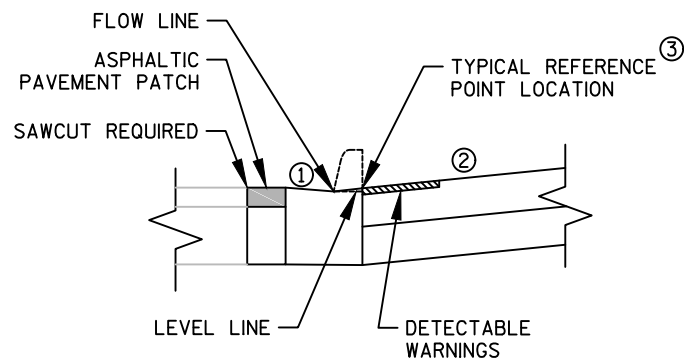

- ① 4% MAXIMUM GUTTER FLAG SLOPE. VARY SLOPE AS REQUIRED TO MATCH EXISTING ROADWAY. GRADE CHANGE BETWEEN SLOPE ① AND SLOPE ② NOT TO EXCEED 11%
- ② 8.33% MAXIMUM SLOPE. GRADE CHANGE BETWEEN SLOPE ① AND SLOPE ② NOT TO EXCEED 11%
- ③ REFERENCE POINT LOCATION AS SHOWN ON CONSTRUCTION DETAIL SHEETS C4.4 - C4.20 IS 0.035' ABOVE GUTTER FLOW LINE

TYPICAL SIDEWALK DROP CURB DETAIL

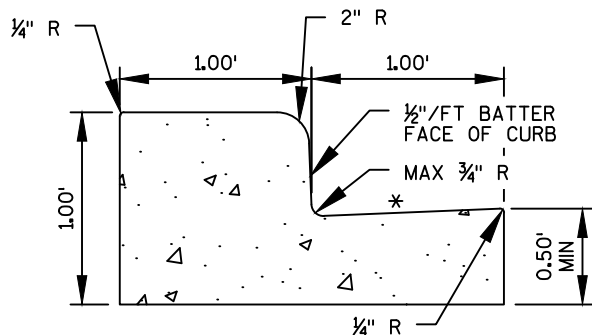

SEE S.D.D. "CONCRETE CURB, CONCRETE CURB & GUTTER AND TIES" FOR ADDITIONAL INFORMATION

*SLOPE VARIES TO MATCH ADJACENT PAVEMENT OR CURB AS APPROPRIATE. SEE ADDITIONAL SIDEWALK DROP CURB DETAIL FOR RESTRICTIONS AT SIDEWALK CROSSING LOCATIONS.

CONCRETE CURB AND GUTTER 24-INCH
TYPE D SPECIAL - PHILLIPS BLVD/US-12

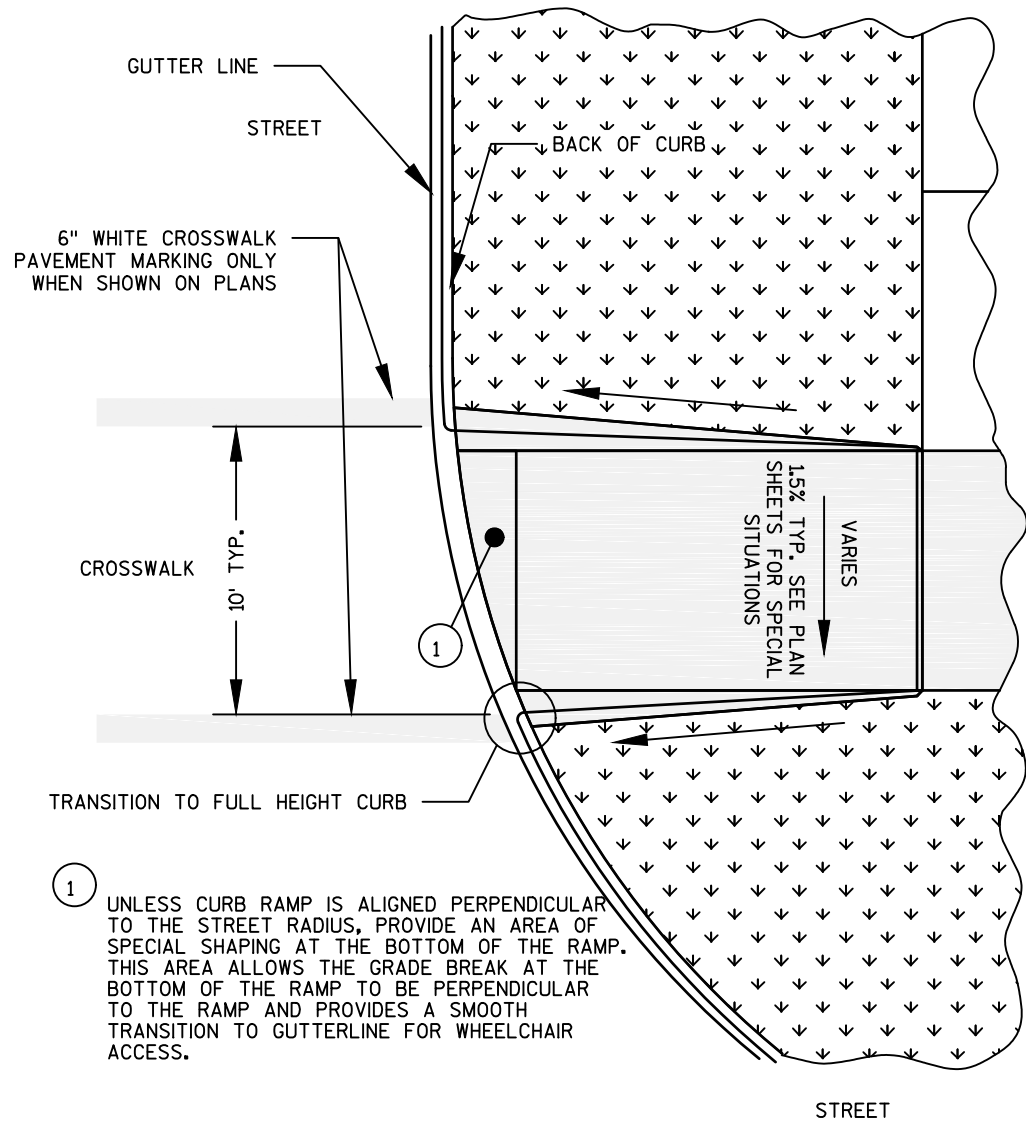

- ① UNLESS CURB RAMP IS ALIGNED PERPENDICULAR TO THE STREET RADIUS, PROVIDE AN AREA OF SPECIAL SHAPING AT THE BOTTOM OF THE RAMP. THIS AREA ALLOWS THE GRADE BREAK AT THE BOTTOM OF THE RAMP TO BE PERPENDICULAR TO THE RAMP AND PROVIDES A SMOOTH TRANSITION TO GUTTERLINE FOR WHEELCHAIR ACCESS.

TYPICAL CROSSWALK MARKING DETAIL

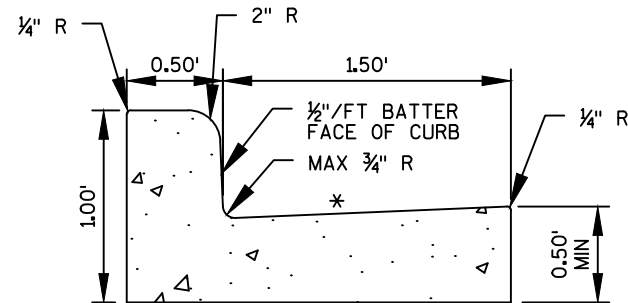

SEE S.D.D. "CONCRETE CURB, CONCRETE CURB & GUTTER AND TIES" FOR ADDITIONAL INFORMATION

*SLOPE VARIES TO MATCH ADJACENT PAVEMENT OR CURB AS APPROPRIATE. SEE ADDITIONAL SIDEWALK DROP CURB DETAIL FOR RESTRICTIONS AT SIDEWALK CROSSING LOCATIONS.

CONCRETE CURB AND GUTTER 24-INCH
TYPE D

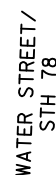

WATER ST	
----------	--

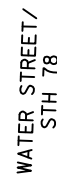

—EXISTING BACK
OF CURB

WATER ST

JEWELL
associates engineers, inc.
Engineers - Surveyors - Architects

THIS DOCUMENT, THE IDEAS AND DESIGNS INCORPORATED HEREIN AS AN INSTRUMENT OF SERVICE, IS THE PROPERTY OF JEWELL ASSOCIATES ENGINEERS, INC. AND IS NOT TO BE USED IN WHOLE OR IN PART WITHOUT PRIOR WRITTEN AUTHORIZATION OF JEWELL ASSOCIATES ENGINEERS, INC.



ARCHITECTURE
CIVIL ENGINEERING
CONSTRUCTION SERVICES
ENVIRONMENTAL ENGINEERING
LAND SURVEYING
MUNICIPAL ENGINEERING
STRUCTURAL ENGINEERING
TRANSPORTATION ENGINEERING
INTEGRITY.EXPERTISE.SOLUTIONS

[illegible]

Sheet Number

C4.1

Project Number
1621

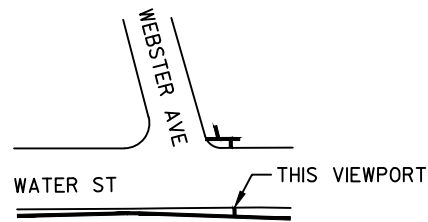

LEGEND	
XXXXXXX	SAWCUT REQUIRED
----	BREAK IN GRADE
---	EXISTING BALLAST

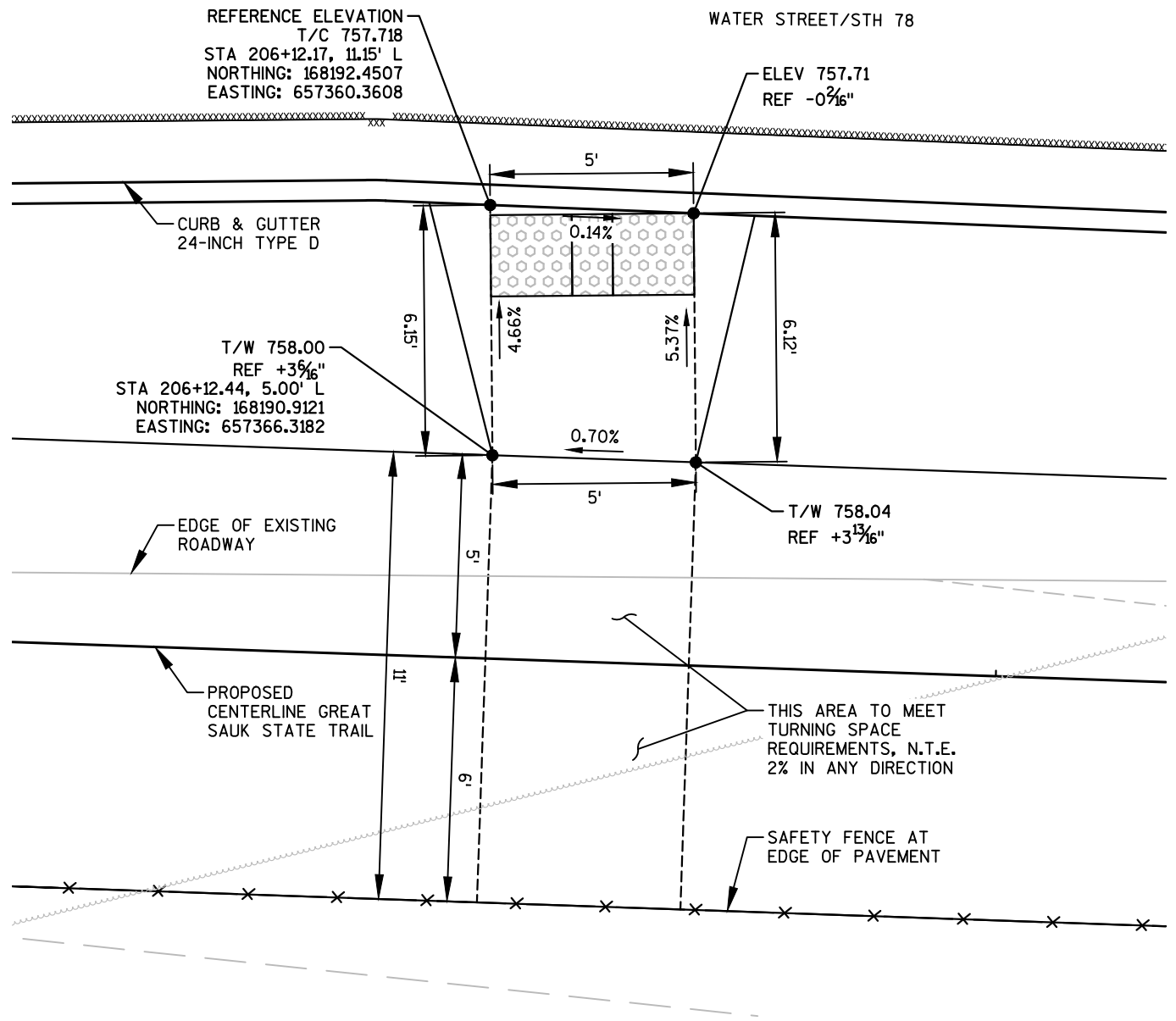

JEWELL
associates engineers, inc.
Engineers - Surveyors - Architects

560 Sunrise Drive
Spring Green, WI 53588
phone: 608-588-7484
fax: 608-588-9322

THIS DOCUMENT, THE IDEAS AND DESIGNS INCORPORATED HEREIN AS AN INSTRUMENT OF SERVICE, IS THE PROPERTY OF JEWELL ASSOCIATES ENGINEERS, INC. AND IS NOT TO BE USED IN WHOLE OR IN PART WITHOUT PRIOR WRITTEN AUTHORIZATION OF JEWELL ASSOCIATES ENGINEERS, INC.

IIW, P.C.

iiw

ARCHITECTURE
CIVIL ENGINEERING
CONSTRUCTION SERVICES
ENVIRONMENTAL ENGINEERING
LAND SURVEYING
MUNICIPAL ENGINEERING
STRUCTURAL ENGINEERING
TRANSPORTATION ENGINEERING
INTEGRITY.EXPERTISE.SOLUTIONS

Great Sauk State Trail Prairie Du Sac/Sauk City Unit Sauk County, Wisconsin

Date
5/30/2017

-	.
-	.
-	.
-	.
-	.
-	.

Date Revision

Drawing Name
**Construction
Details - Water St
& Webster Ave
Curb Ramps**

Sheet Number

C4.17

Project Number

16217

LEGEND

WORK AREA

STAGE 1

TEMPORARY PEDESTRIAN

ACCESS ROUTE

TRAFFIC CONTROL DRUM

DIRECTION OF TRAFFIC

SIDEWALK CLOSURE

STAGE 1 TRAFFIC CONTROL IS FOR CONSTRUCTION ON THE WEST SIDE OF WATER STREET. STAGE 2 TRAFFIC CONTROL IS FOR CONSTRUCTION ON EAST SIDE OF WATER STREET. EITHER STAGE 1 OR STAGE 2 MAY OCCUR FIRST, BUT STAGE 1 & STAGE 2 CONSTRUCTION MAY NOT OCCUR AT THE SAME TIME. MAINTAIN A MINIMUM OF 11' TRAVEL LANES IN EACH DIRECTION AT ALL TIMES ON WATER STREET. STAGE 3 TRAFFIC CONTROL IS FOR THE CONSTRUCTION AT THE INTERSECTION OF WATER ST & WEBSTER AVENUE. STAGE 3 MAY NOT OCCUR UNTIL STAGE 1 & STAGE 2 ARE COMPLETE.

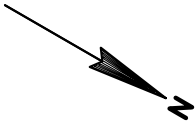
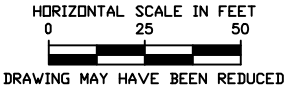

INSTALL SDD 15 D 28-3 TRAFFIC CONTROL, WORK ON SHOULDER OR PARKING LANE, UNDIVIDED, FOR ALL WORK AREAS ON THIS SHEET

INSTALL SDD 15 D 30-3a, TRAFFIC CONTROL, PEDESTRIAN ACCOMMODATION, DETAIL SIDEWALK DIVERSION DURING CONSTRUCTION OF CURB RAMPS, CURB & GUTTER, ETC.

PROPOSED GREAT SAUK STATE TRAIL

EXISTING C/L
WATER STREET/STH
78

← WATER STREET →

WEBSTER AVENUE

JEWELL
associates engineers, inc.
Engineers - Surveyors - Architects

560 Sunrise Drive
Spring Green, WI 53588
phone: 608-588-7484
fax: 608-588-9322

THIS DOCUMENT, THE IDEAS AND DESIGNS INCORPORATED HEREIN AS AN INSTRUMENT OF SERVICE, IS THE PROPERTY OF JEWELL ASSOCIATES ENGINEERS, INC. AND IS NOT TO BE USED IN WHOLE OR IN PART WITHOUT PRIOR WRITTEN AUTHORIZATION OF JEWELL ASSOCIATES ENGINEERS, INC.

IIW, P.C.

iiw

ARCHITECTURE
CIVIL ENGINEERING
CONSTRUCTION SERVICES
ENVIRONMENTAL ENGINEERING
LAND SURVEYING
MUNICIPAL ENGINEERING
STRUCTURAL ENGINEERING
TRANSPORTATION ENGINEERING
INTEGRITY.EXPERTISE.SOLUTIONS

Great Sauk State Trail
Prairie Du Sac/Sauk City Unit
Sauk County, Wisconsin

Date
5/30/2017

-	-
-	-
-	-
-	-
-	-
-	-
Date	Revision

Drawing Name
Traffic Control
Water St/STH 78
Stage 1

Sheet Number
C4.33

Project Number
16217

LEGEND

WORK AREA
STAGE 2

TRAFFIC CONTROL DRUM

DIRECTION OF TRAFFIC

ROAD WORK AHEAD
W20-1-A

W24-1-L

W24-1-R

END ROAD WORK
G20-2A

INSTALL 48" X 48" ROAD WORK AHEAD,
BLACK ON ORANGE, 600' BEFORE
SHIFTING TAPER IN BOTH DIRECTIONS

INSTALL 48" X 48" DOUBLE
REVERSE CURVE, BLACK ON ORANGE,
200' BEFORE SHIFTING TAPER IN
BOTH DIRECTIONS

INSTALL 48" X 24" END ROAD WORK
BLACK ON ORANGE, 250' AFTER
CONSTRUCTION AREA IN BOTH
DIRECTIONS

- NOTES:
1. SPACING BETWEEN TRAFFIC CONTROL SIGNS
SHOULD BE ADJUSTED TO NOT CONFLICT WITH
EXISTING SIGNS, AND SHOULD PROVIDE A
DESIRABLE MINIMUM OF 200 FEET CLEARANCE TO
EXISTING SIGNS.

2. THE EXACT NUMBER, LOCATION, AND SPACING OF
ALL SIGNS AND DEVICES SHALL BE ADJUSTED TO
FIT FIELD CONDITIONS AS APPROVED BY THE
ENGINEER.

3. TRAFFIC CONTROL DRUMS WITH TYPE "C" STEADY
BURN LIGHT REQUIRED ON SHIFTING TAPER

4. MAINTAIN A MINIMUM OF 11' TRAVEL LANES IN EACH
DIRECTION ON WATER STREET AT ALL TIMES.

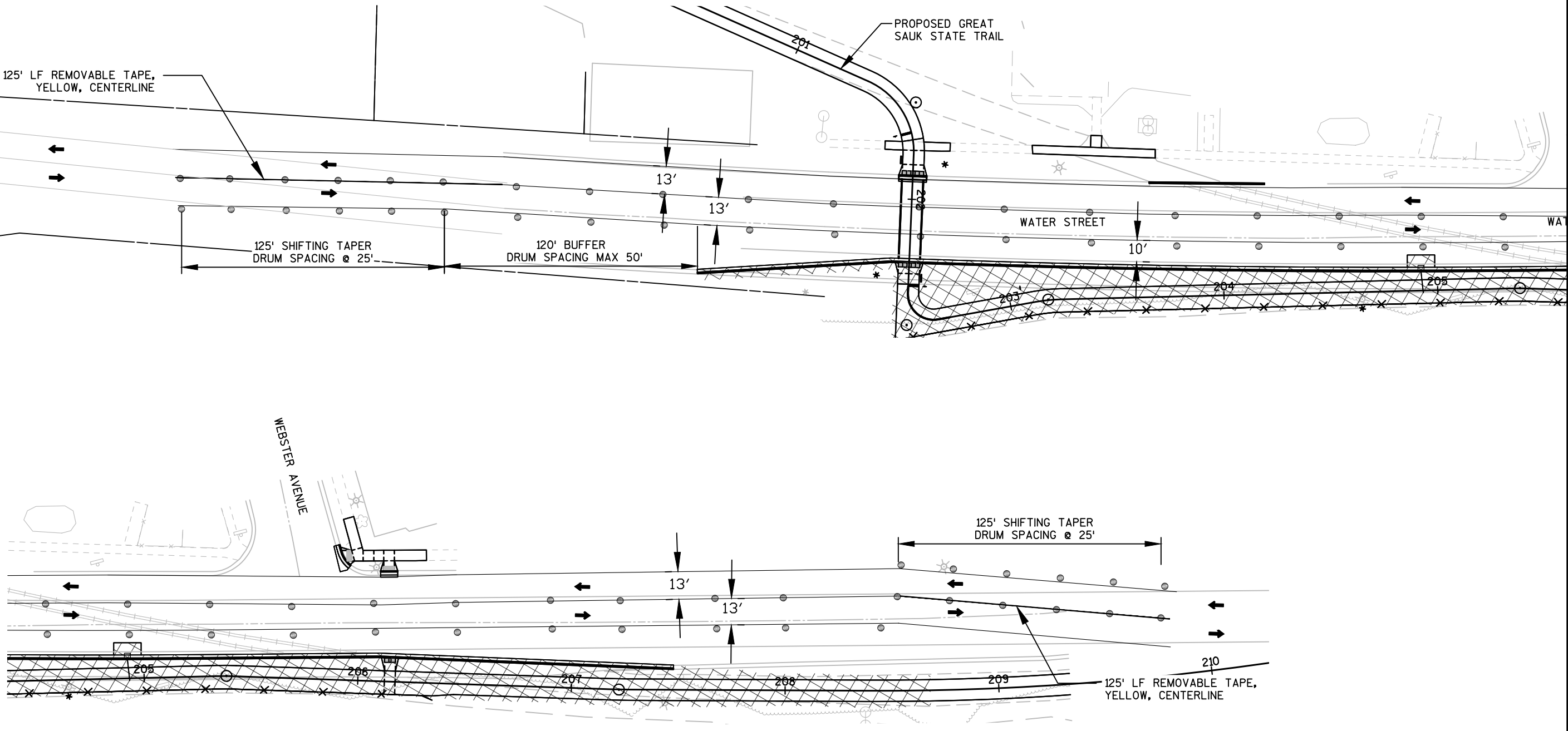
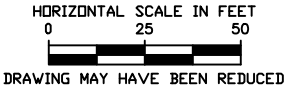

JEWELL

associates engineers, Inc.

Engineers - Surveyors - Architects

560 Sunrise Drive
Spring Green, WI 53588
phone: 608-588-7484
fax: 608-588-9322

THIS DOCUMENT, THE IDEAS AND DESIGNS INCORPORATED
HEREIN AS AN INSTRUMENT OF SERVICE, IS THE PROPERTY
OF JEWELL ASSOCIATES ENGINEERS, INC. AND IS NOT TO BE
USED IN WHOLE OR IN PART WITHOUT PRIOR WRITTEN
AUTHORIZATION OF JEWELL ASSOCIATES ENGINEERS, INC.

iiw, P.C.

iiw

ARCHITECTURE
CIVIL ENGINEERING
CONSTRUCTION SERVICES
ENVIRONMENTAL ENGINEERING
LAND SURVEYING
MUNICIPAL ENGINEERING
STRUCTURAL ENGINEERING
TRANSPORTATION ENGINEERING
INTEGRITY.EXPERTISE.SOLUTIONS

Great Sauk State Trail
Prairie Du Sac/Sauk City Unit
Sauk County, Wisconsin

Date
5/30/2017

Drawing Name
Traffic Control
Water St/STH 78
Stage 2

Sheet Number
C4.34

Project Number
16217

FILE NAME : P:\16\217\DRAWINGS\16217\SHEETPLAN\040302_TC.DWG
LAYOUT : C4.34 - TRAFFIC CONTROL

PLOT DATE : 5/30/2017
PLOT TIME : 8:34:41 PM

PLOT BY : ERIC URE

PLOT SCALE : 1" = 1'

LEGEND

WORK AREA

STAGE 1

TEMPORARY PEDESTRIAN ACCESS ROUTE

TRAFFIC CONTROL DRUM

DIRECTION OF TRAFFIC

SIDEWALK CLOSURE

STAGE 3 TRAFFIC CONTROL IS FOR THE CONSTRUCTION OF SIDEWALK AND CURB RAMPS AT THE INTERSECTION OF WATER ST AND WEBSTER AVE. STAGE 3 MAY NOT OCCUR UNTIL STAGE 1 & 2 ARE COMPLETE. CURB RAMP CONSTRUCTION ON THE SOUTH SIDE OF OAK STREET AT WATER STREET MUST ALSO BE COMPLETE. DURING STAGE 3 CONSTRUCTION, PEDESTRIAN TRAFFIC WILL BE DIVERTED TO THE EAST SIDE OF WATER STREET USING THE PROPOSED GREAT SAUK STATE TRAIL.

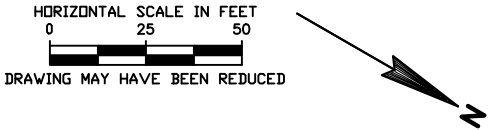
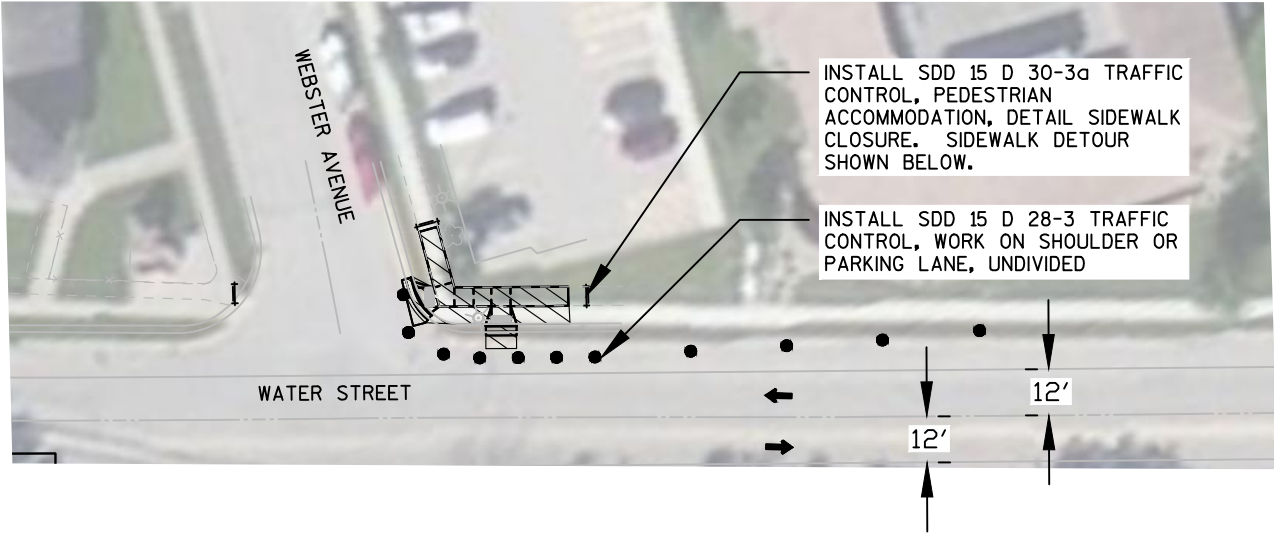

WASHINGTON STREET

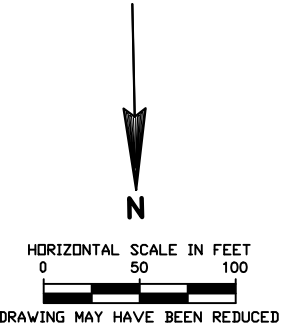
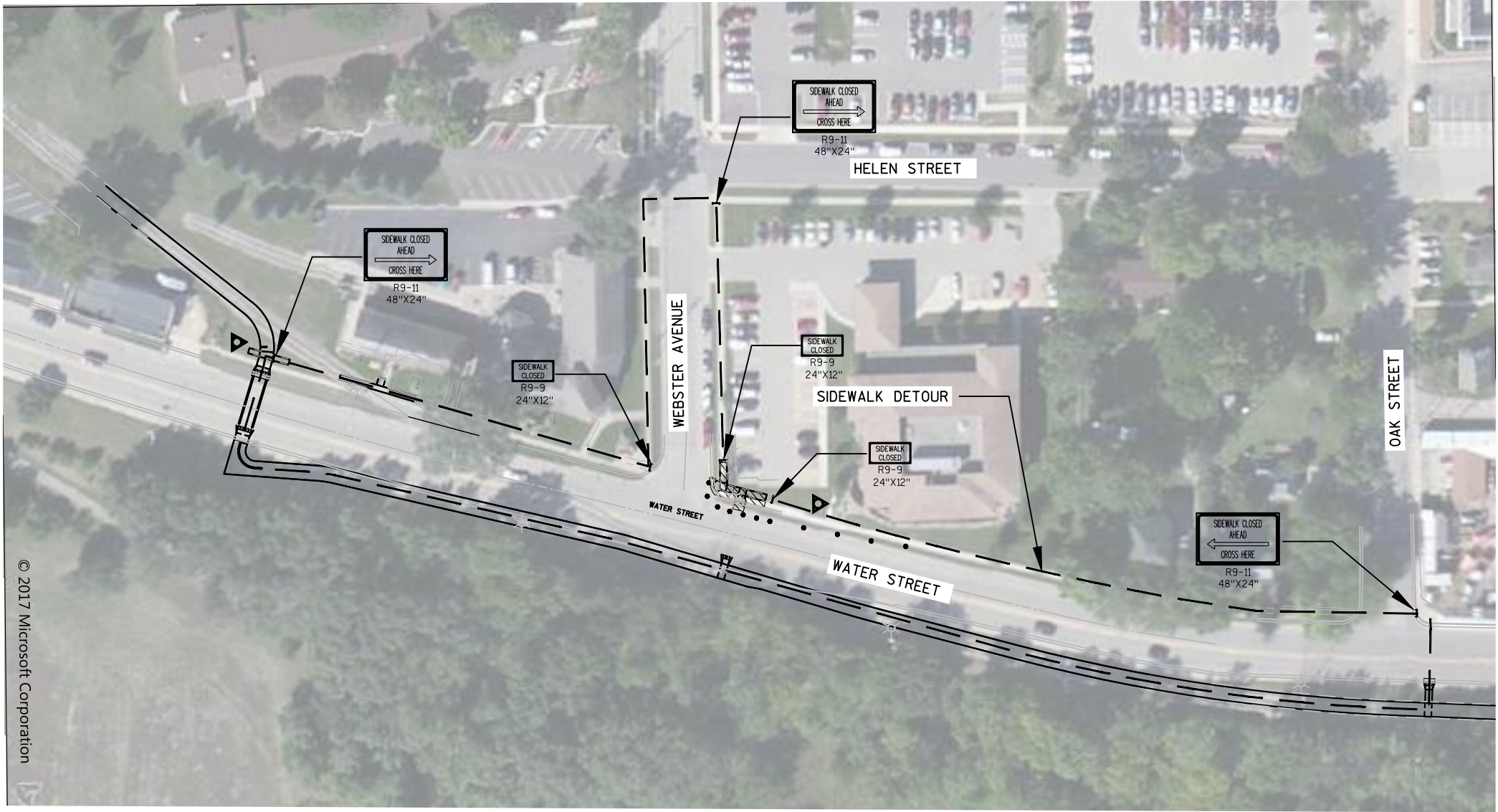

JEWELL
associates engineers, inc.
Engineers - Surveyors - Architects

560 Sunrise Drive
Spring Green, WI 53588
phone: 608-588-7484
fax: 608-588-9322

THIS DOCUMENT, THE IDEAS AND DESIGNS INCORPORATED HEREIN AS AN INSTRUMENT OF SERVICE, IS THE PROPERTY OF JEWELL ASSOCIATES ENGINEERS, INC. AND IS NOT TO BE USED IN WHOLE OR IN PART WITHOUT PRIOR WRITTEN AUTHORIZATION OF JEWELL ASSOCIATES ENGINEERS, INC.

iiw, P.C.
iiw
ARCHITECTURE
CIVIL ENGINEERING
CONSTRUCTION SERVICES
ENVIRONMENTAL ENGINEERING
LAND SURVEYING
MUNICIPAL ENGINEERING
STRUCTURAL ENGINEERING
TRANSPORTATION ENGINEERING
INTEGRITY.EXPERTISE.SOLUTIONS

Great Sauk State Trail
Prairie Du Sac/Sauk City Unit
Sauk County, Wisconsin

Date	5/30/2017
Revision	
Drawing Name	Traffic Control
Sheet Number	C4.35
Project Number	16217

LEGEND
XXXXXXX SAWCUT REQUIRED
--- EXISTING BALLAST

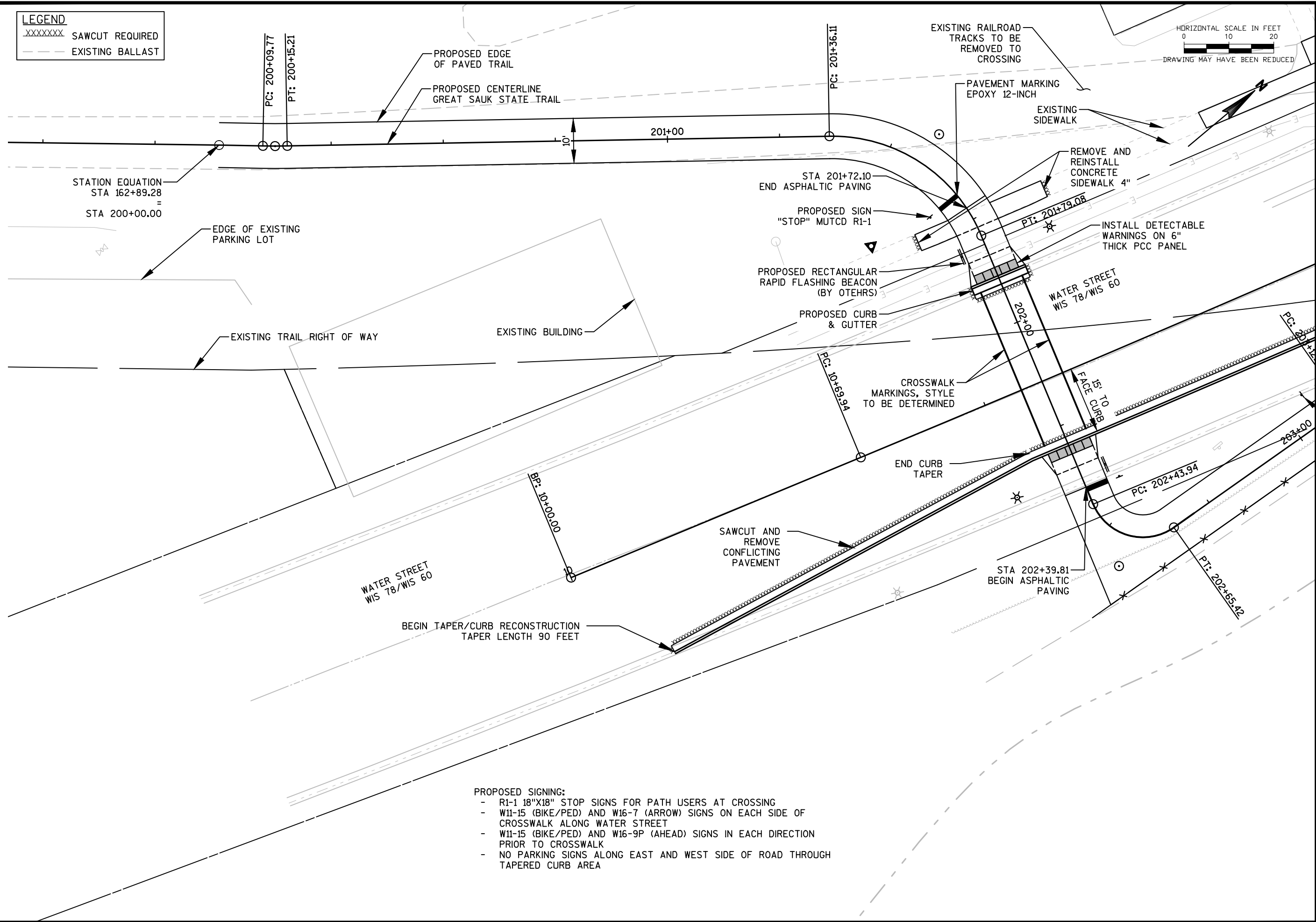

- PROPOSED SIGNING:**
- R1-1 18"X18" STOP SIGNS FOR PATH USERS AT CROSSING
 - W11-15 (BIKE/PED) AND W16-7 (ARROW) SIGNS ON EACH SIDE OF CROSSWALK ALONG WATER STREET
 - W11-15 (BIKE/PED) AND W16-9P (AHEAD) SIGNS IN EACH DIRECTION PRIOR TO CROSSWALK
 - NO PARKING SIGNS ALONG EAST AND WEST SIDE OF ROAD THROUGH TAPERED CURB AREA

JEWELL
associates engineers, inc.
Engineers - Surveyors - Architects

560 Sunrise Drive
Spring Green, WI 53588
phone: 608-588-7484
fax: 608-588-9322

THIS DOCUMENT, THE IDEAS AND DESIGNS INCORPORATED HEREIN AS AN INSTRUMENT OF SERVICE, IS THE PROPERTY OF JEWELL ASSOCIATES ENGINEERS, INC. AND IS NOT TO BE USED IN WHOLE OR IN PART WITHOUT PRIOR WRITTEN AUTHORIZATION OF JEWELL ASSOCIATES ENGINEERS, INC.

IIW, P.C.

iiw

ARCHITECTURE
CIVIL ENGINEERING
CONSTRUCTION SERVICES
ENVIRONMENTAL ENGINEERING
LAND SURVEYING
MUNICIPAL ENGINEERING
STRUCTURAL ENGINEERING
TRANSPORTATION ENGINEERING
INTEGRITY.EXPERTISE.SOLUTIONS

Great Sauk State Trail Prairie Du Sac/Sauk City Unit Sauk County, Wisconsin

Date
5/30/2017

Date	Revision

Drawing Name

**Plan Views
Mainline Trail**

Sheet Number

C6.12

Project Number

16217

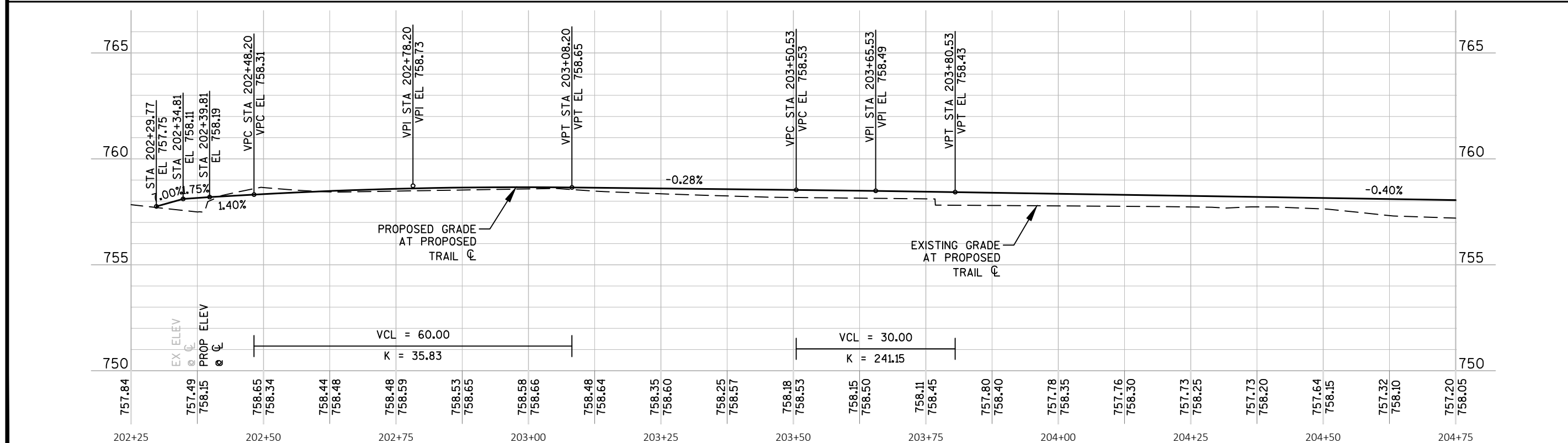
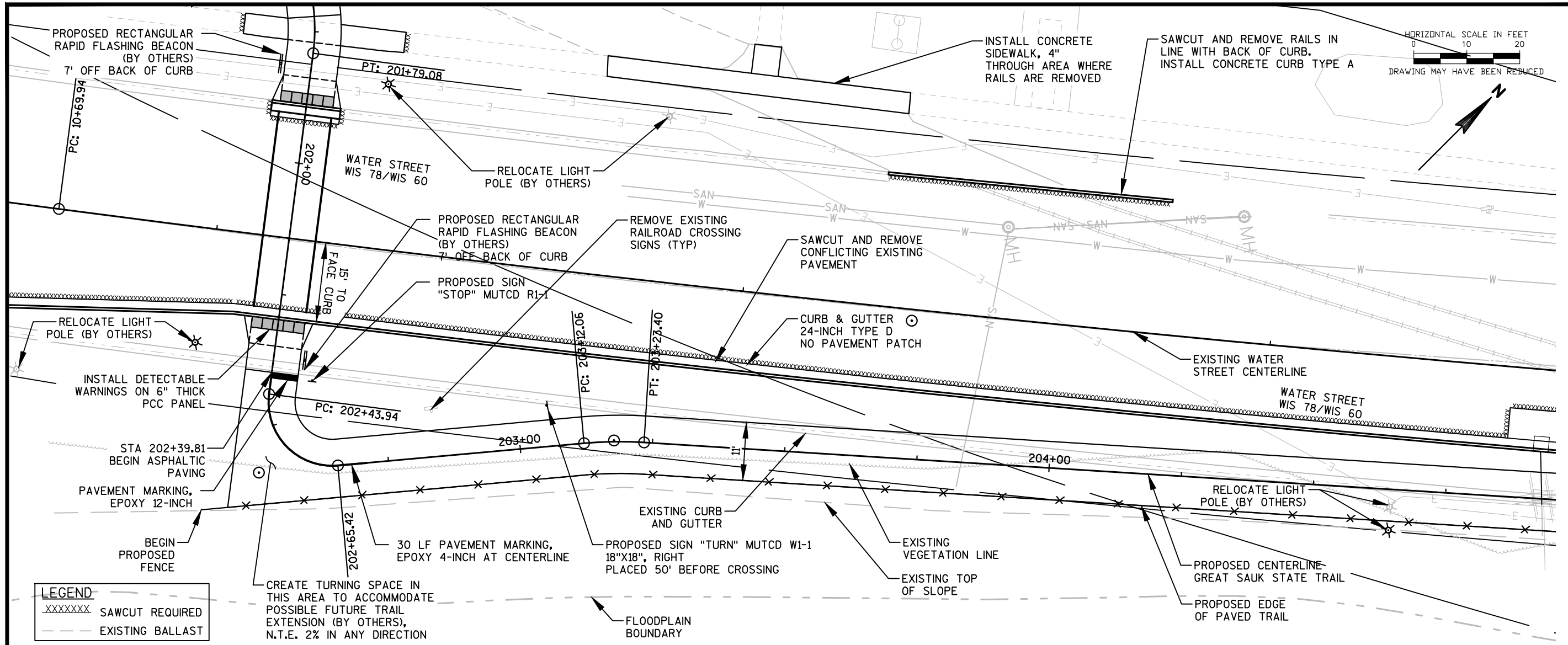

JEWELL
associates engineers, inc.
Engineers - Surveyors - Architects

560 Sunrise Drive
Spring Green, WI 53588
phone: 608-588-7484
fax: 608-588-9322

THIS DOCUMENT, THE IDEAS AND DESIGNS INCORPORATED HEREIN AS AN INSTRUMENT OF SERVICE, IS THE PROPERTY OF JEWELL ASSOCIATES ENGINEERS, INC. AND IS NOT TO BE USED IN WHOLE OR IN PART WITHOUT PRIOR WRITTEN AUTHORIZATION OF JEWELL ASSOCIATES ENGINEERS, INC.

iiw
ARCHITECTURE
CIVIL ENGINEERING
CONSTRUCTION SERVICES
ENVIRONMENTAL ENGINEERING
LAND SURVEYING
MUNICIPAL ENGINEERING
STRUCTURAL ENGINEERING
TRANSPORTATION ENGINEERING
INTEGRITY.EXPERTISE.SOLUTIONS

**Great Sauk State Trail
Prairie Du Sac/Sauk City Unit
Sauk County, Wisconsin**

Date
5/30/2017

Date	Revision

Drawing Name
**Plan & Profile
Mainline Trail**

Sheet Number
C6.13

Project Number
16217

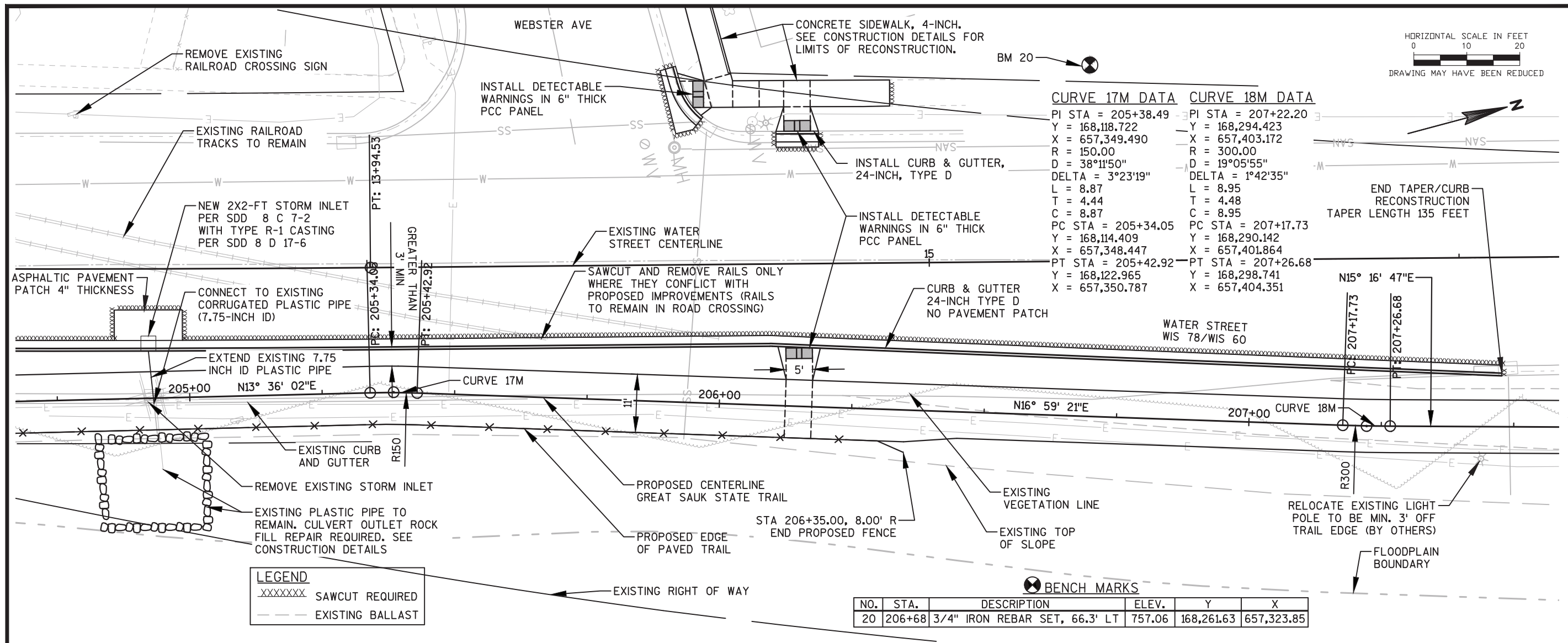

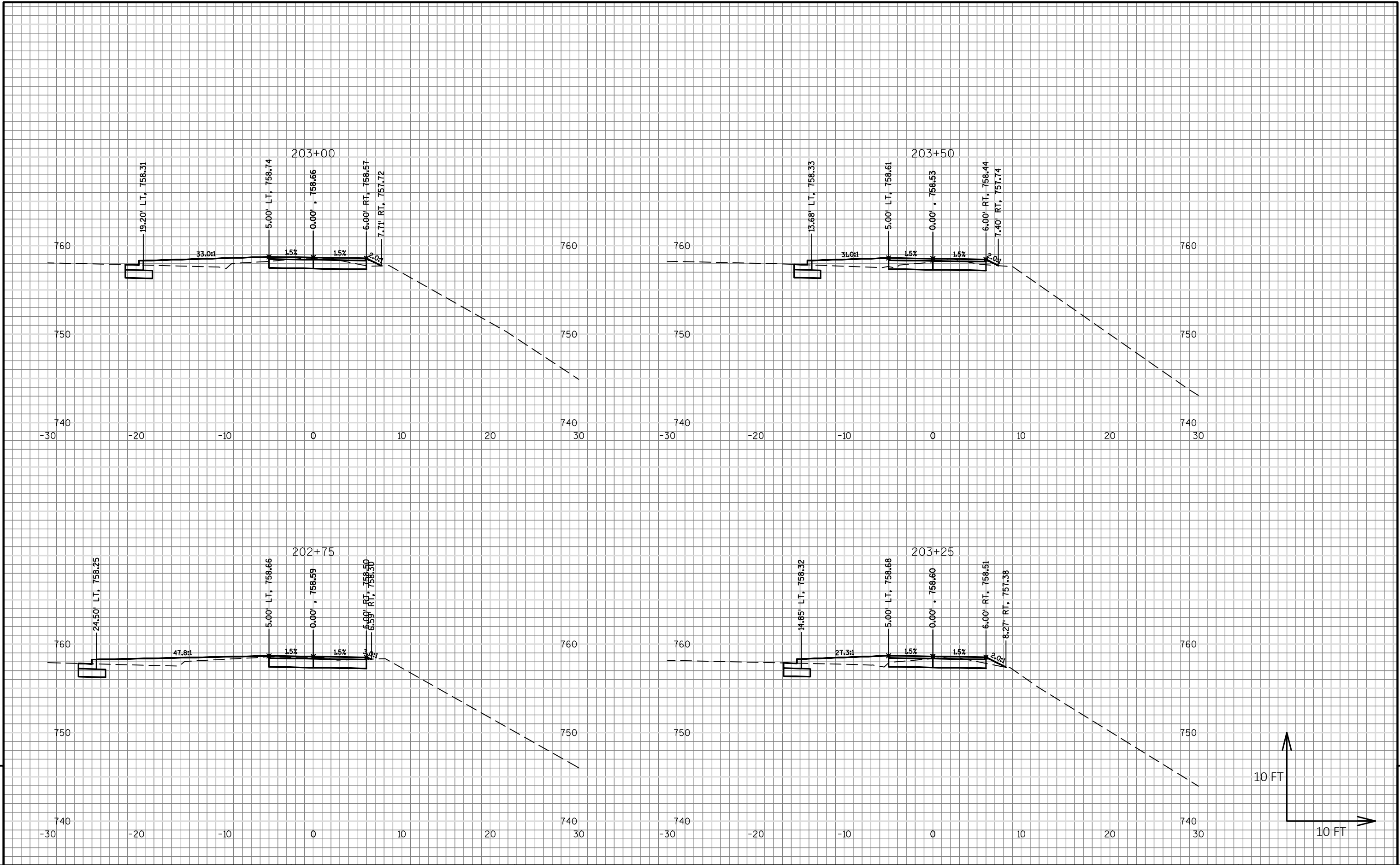

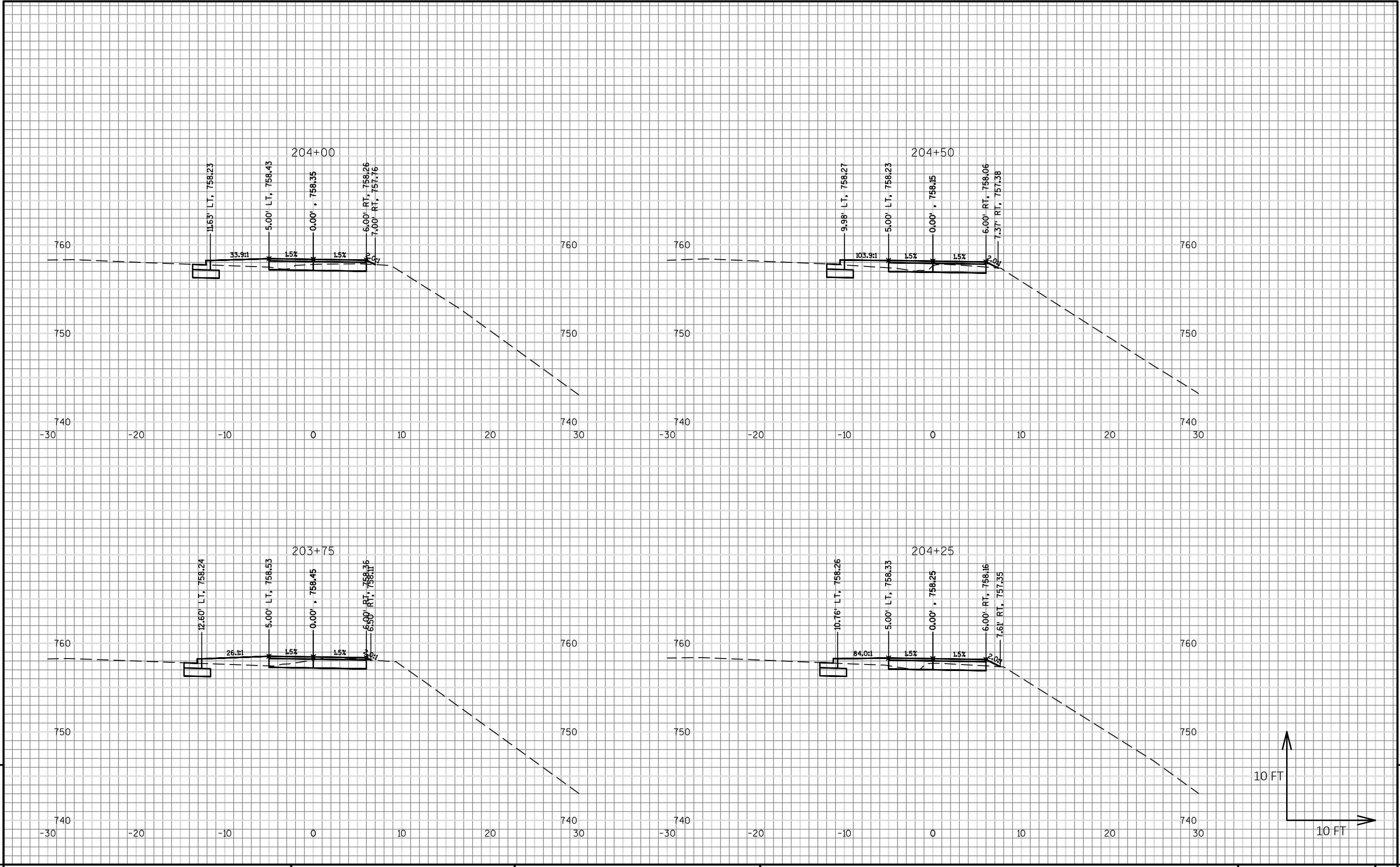

7

7

PROJECT NO: 16217	PROJECT: Great Sauk State Trail	COUNTY: Sauk County	CROSS SECTIONS: Cross Sections (Mainline, Water St, Top Of Bank)	SHEET C7.1	E
-------------------	---------------------------------	---------------------	--	------------	---

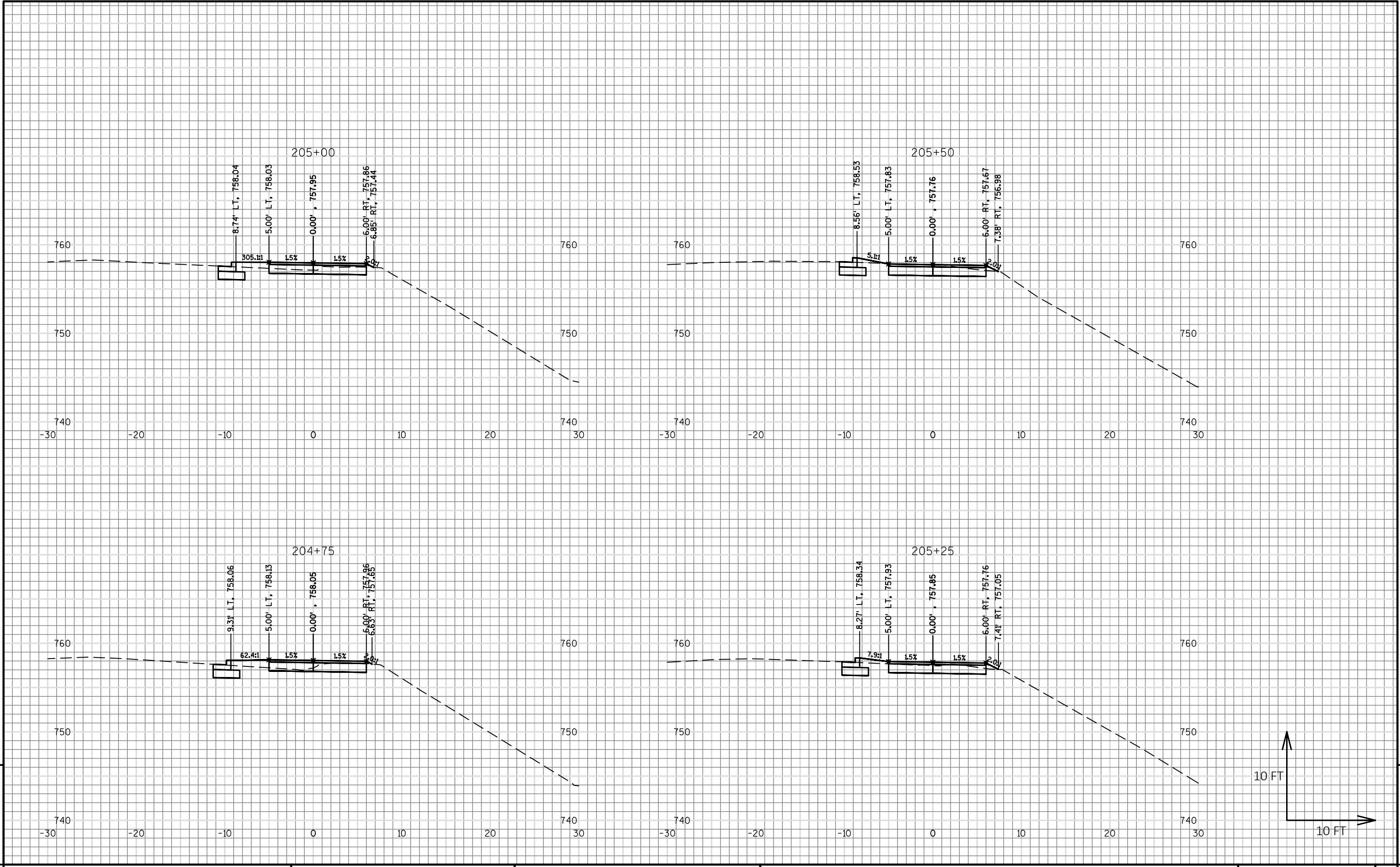

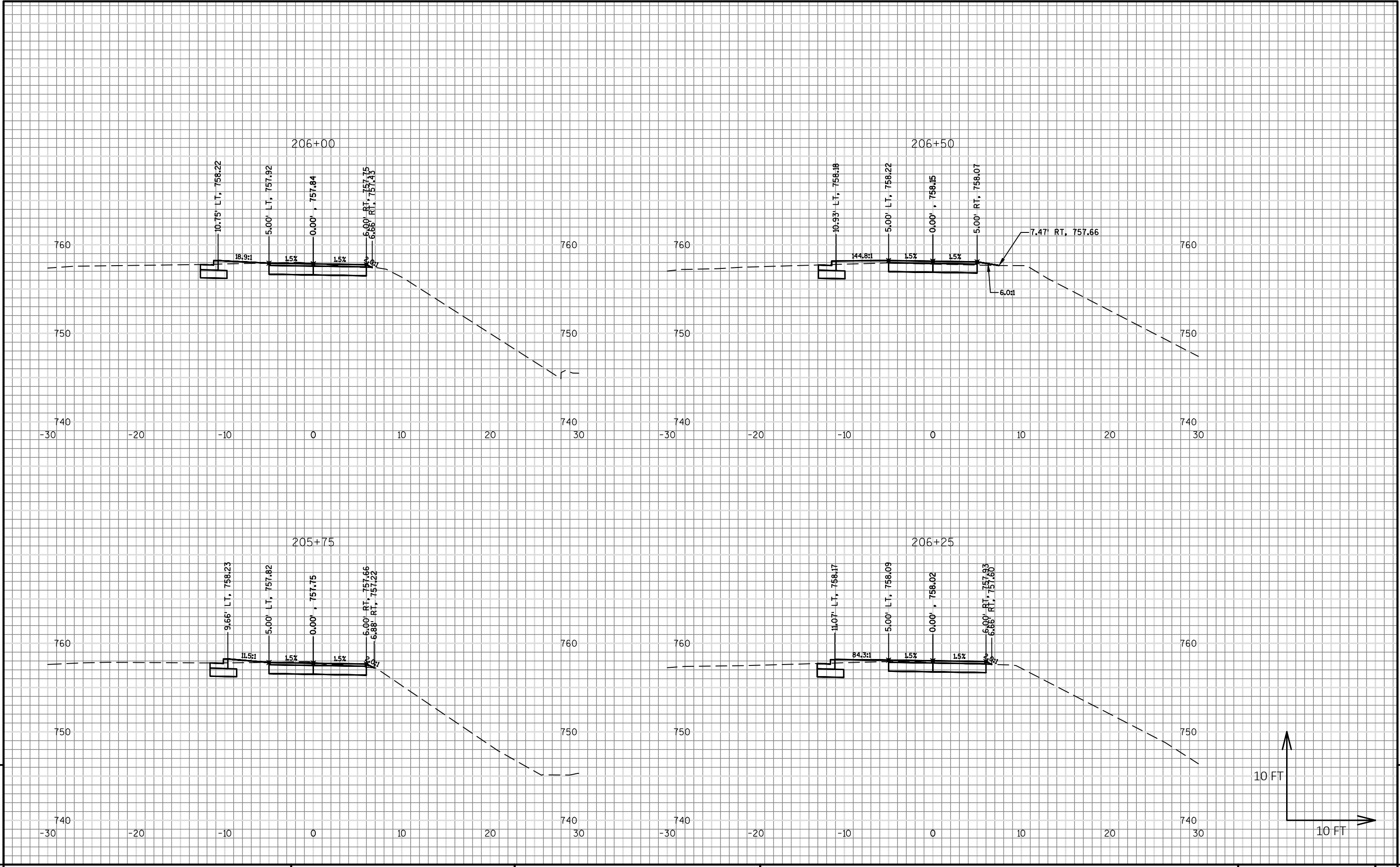

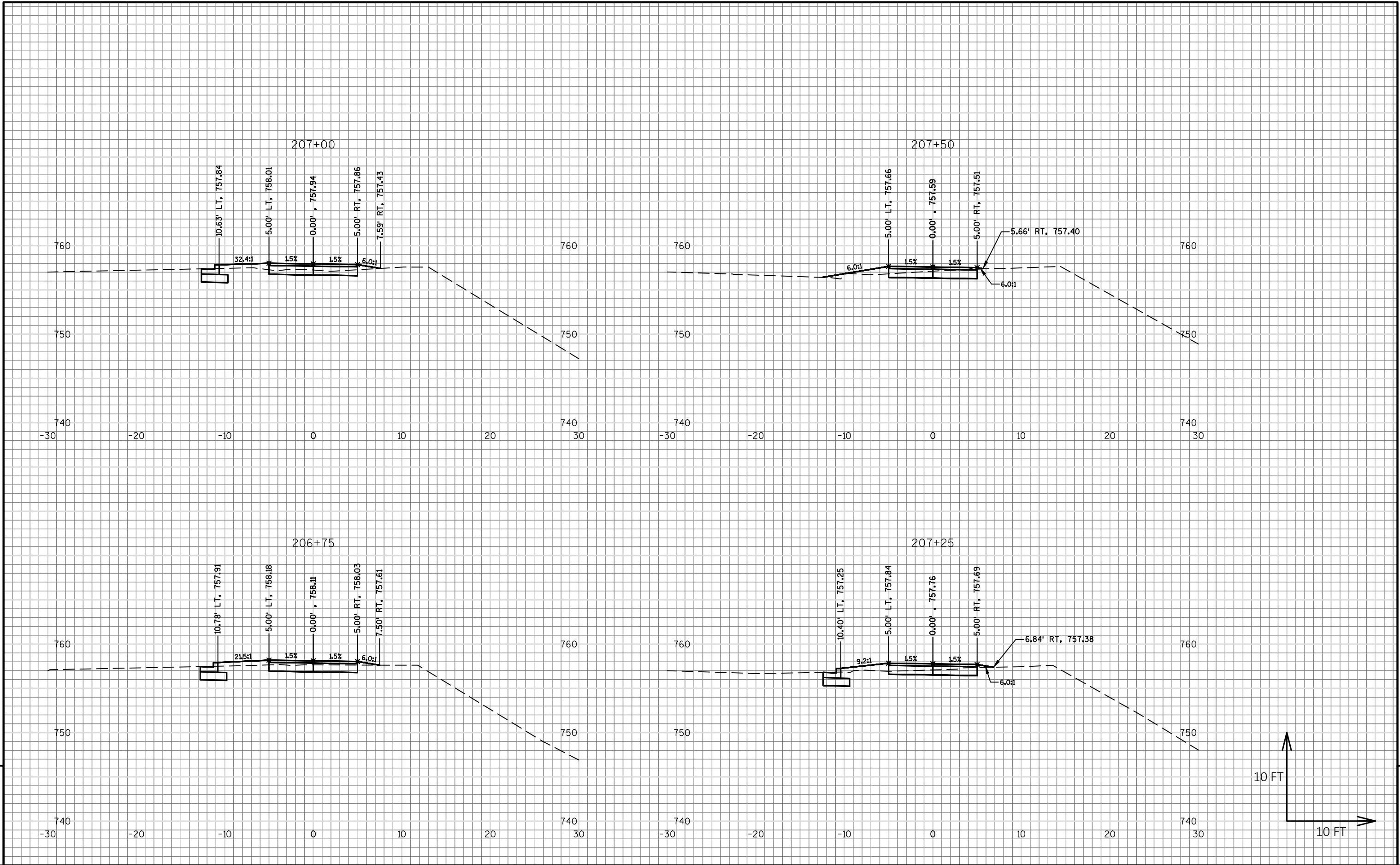

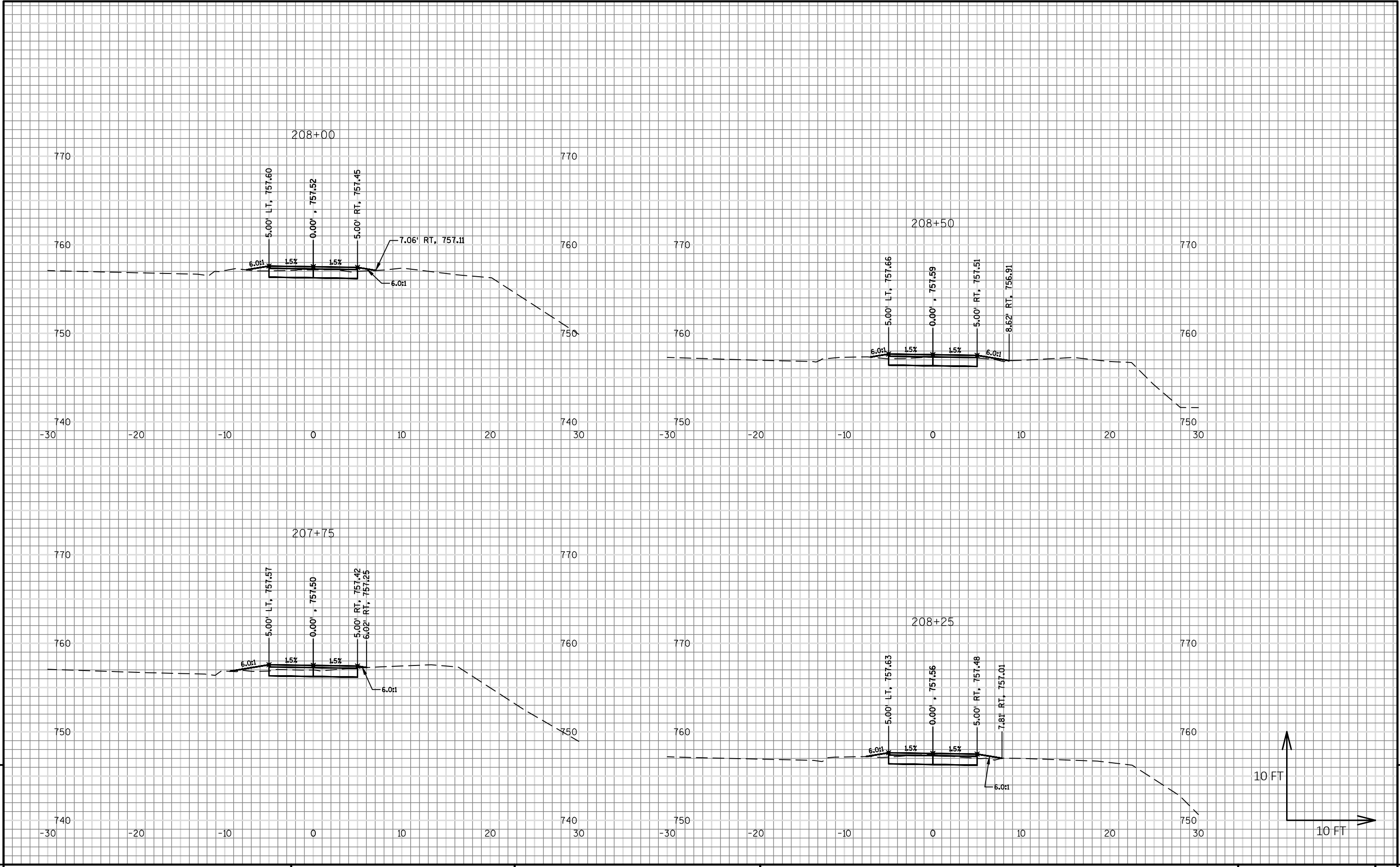

PROJECT NO: 16217	PROJECT: Great Sauk State Trail	COUNTY: Sauk County	CROSS SECTIONS: Cross Sections (Mainline, Water St, Top Of Bank)	SHEET C7.5	E
-------------------	---------------------------------	---------------------	--	------------	---