

**TYPICAL FINISHED SECTION**  
 RECONSTRUCTION AT STREET CROSSINGS:  
 JOHN QUINCY ADAMS STREET  
 JACKSON STREET/FRANKLIN STREET  
 WASHINGTON AVENUE  
 WASHINGTON STREET  
 HEMLOCK STREET

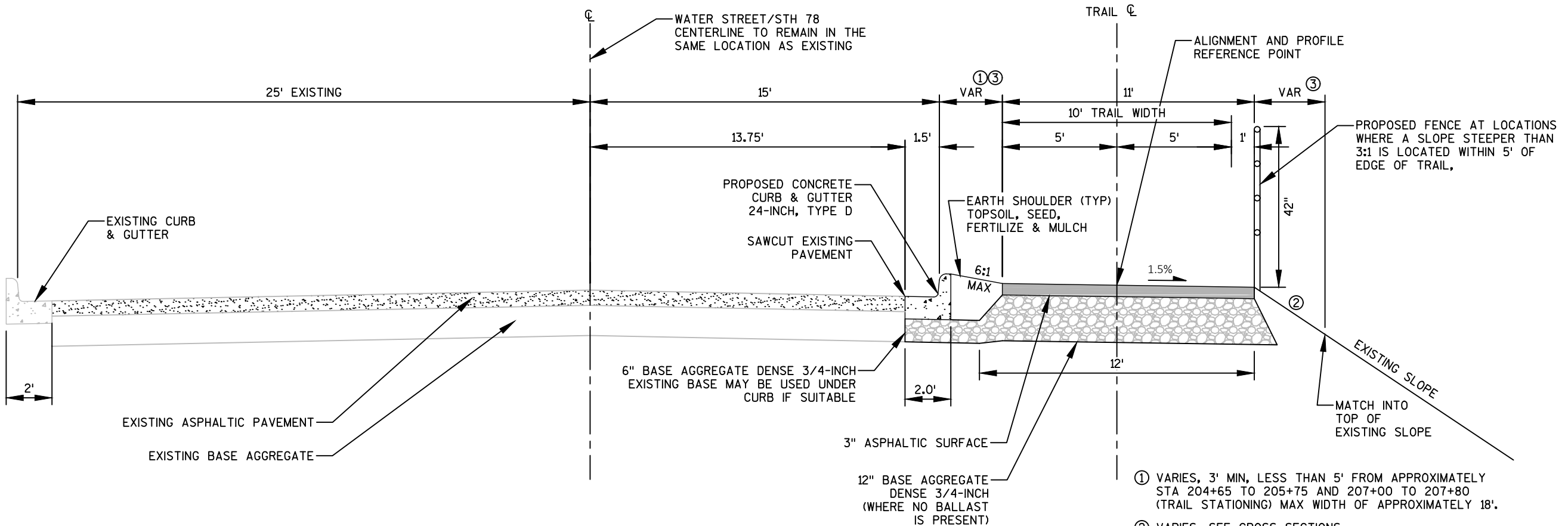

**TYPICAL FINISHED SECTION**  
 WATER STREET/STH 78 &  
 PARALLEL GREAT SAUK TRAIL  
 STA 202+30 TO STA 207+50

**Great Sauk State Trail  
 Prairie Du Sac/Sauk City Unit  
 Sauk County, Wisconsin**

Date  
**5/30/2017**

|  |  |
|--|--|
|  |  |
|  |  |
|  |  |
|  |  |
|  |  |
|  |  |
|  |  |
|  |  |
|  |  |
|  |  |

Drawing Name  
**Typical Sections**

Sheet Number  
**C3.1**  
 Project Number  
**16217**

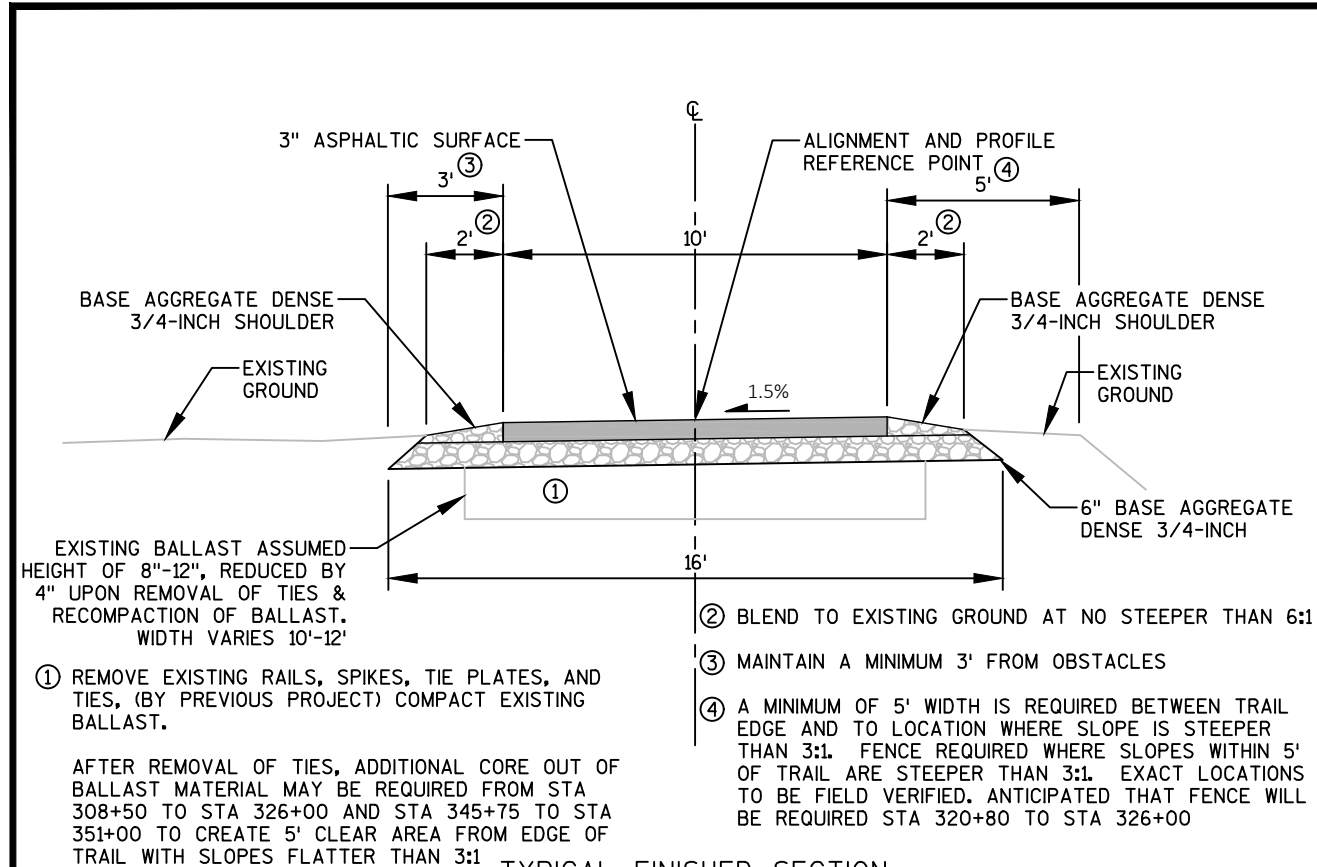

#### TYPICAL FINISHED SECTION

TRAIL WITH GRANULAR SHOULDERS  
STA 308+00 TO STA 326+00  
STA 343+00 TO STA 357+75

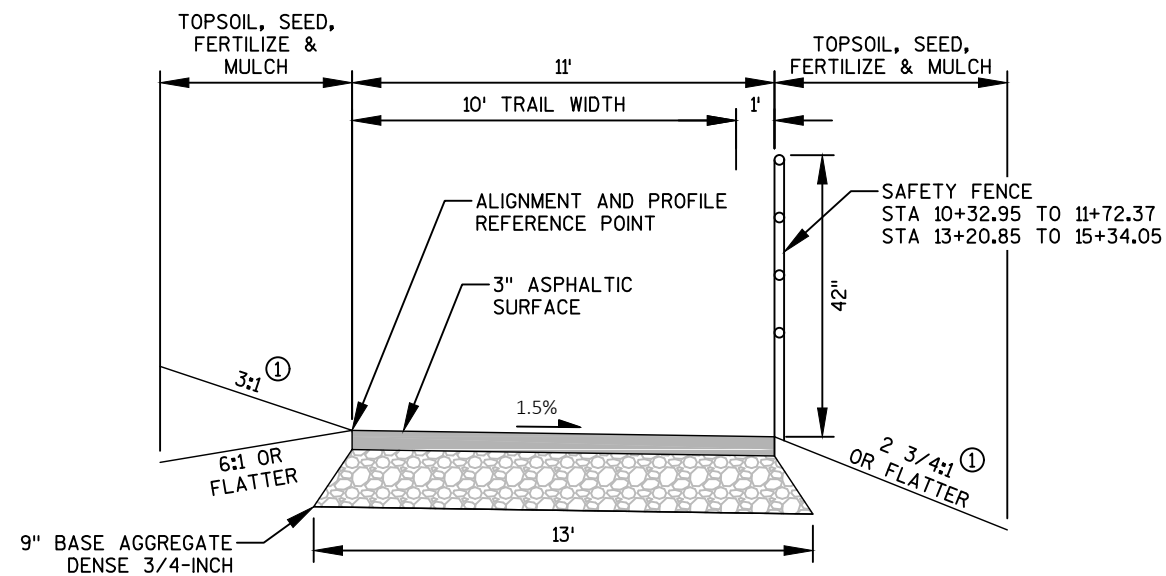

#### TYPICAL FINISHED SECTION

WATER STREET SIDEWALK ACCESS  
TO GREAT SAUK STATE TRAIL  
AT NORTH EAGLE GATE LOCATION  
STA 10+24.53 TO STA 16+02.82

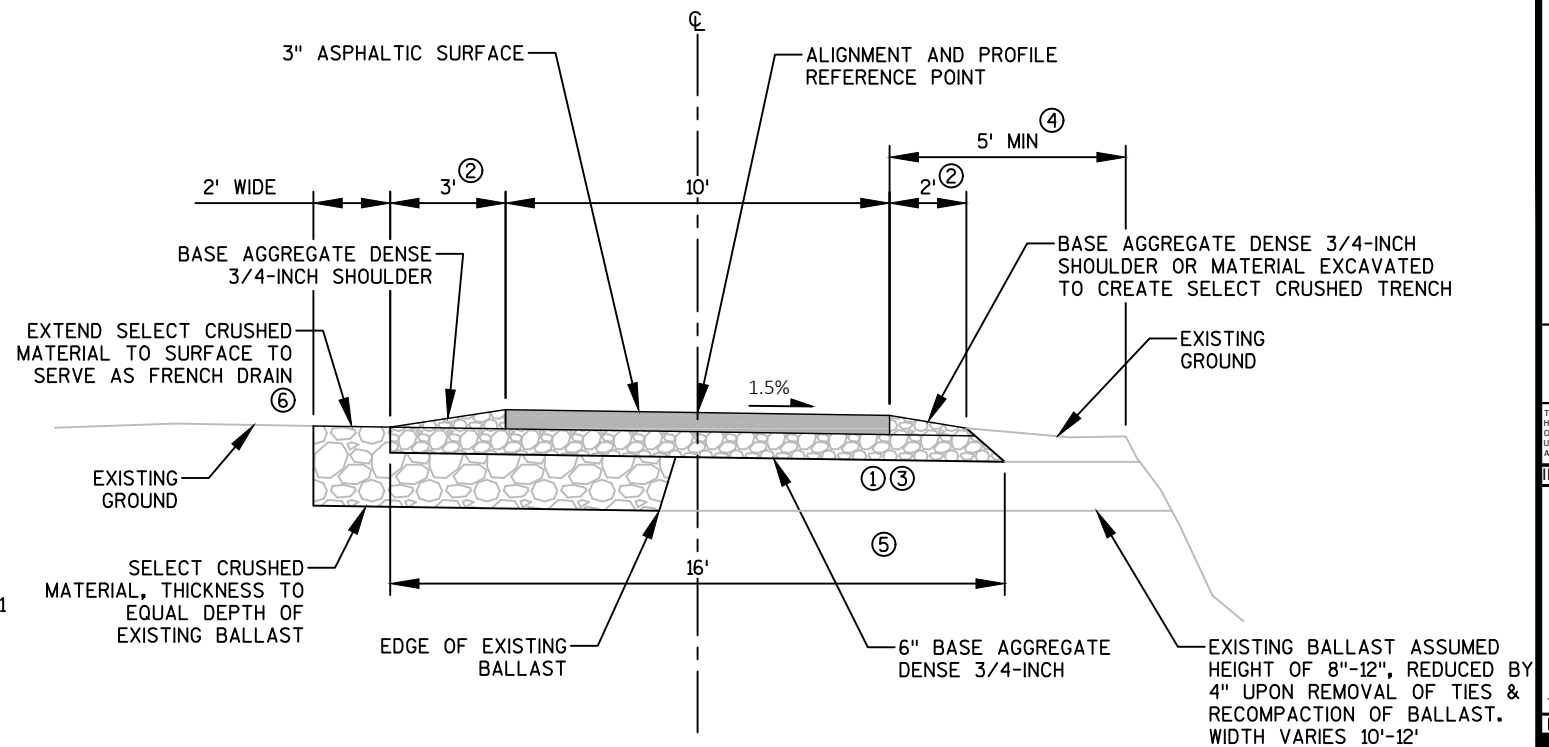

#### TYPICAL FINISHED SECTION

HORIZONTAL ALIGNMENT SHIFTED FROM EXISTING RAILROAD  
TRACK CENTERLINE, TRAIL WITH GRANULAR SHOULDERS  
STA 326+00 TO STA 343+00

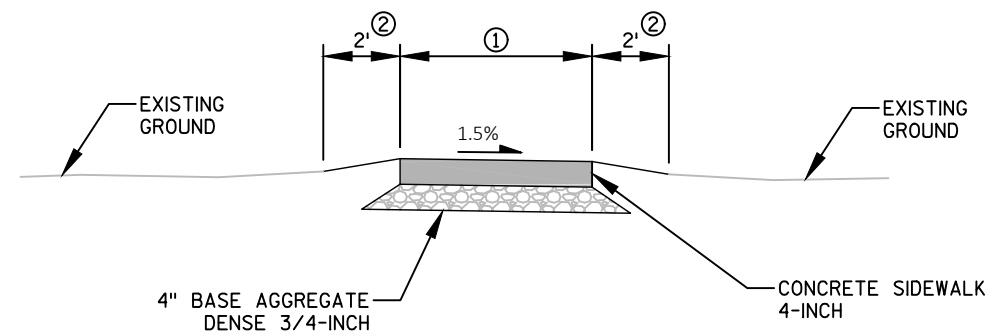

#### TYPICAL FINISHED SECTION

SIDEWALK REPLACEMENT AT TRAIL CROSSING AREAS

|                             |               |
|-----------------------------|---------------|
| STA 9+76 (NORTH EAGLE GATE) | STA 144+60    |
| STA 119+60                  | STA 150+60    |
| STA 134+10                  | STA 157+75    |
| STA 139+10 RT               | STA 206+15 LT |
| STA 139+75 LT               | STA 211+39 LT |
| STA 140+20 RT               | STA 304+46 LT |

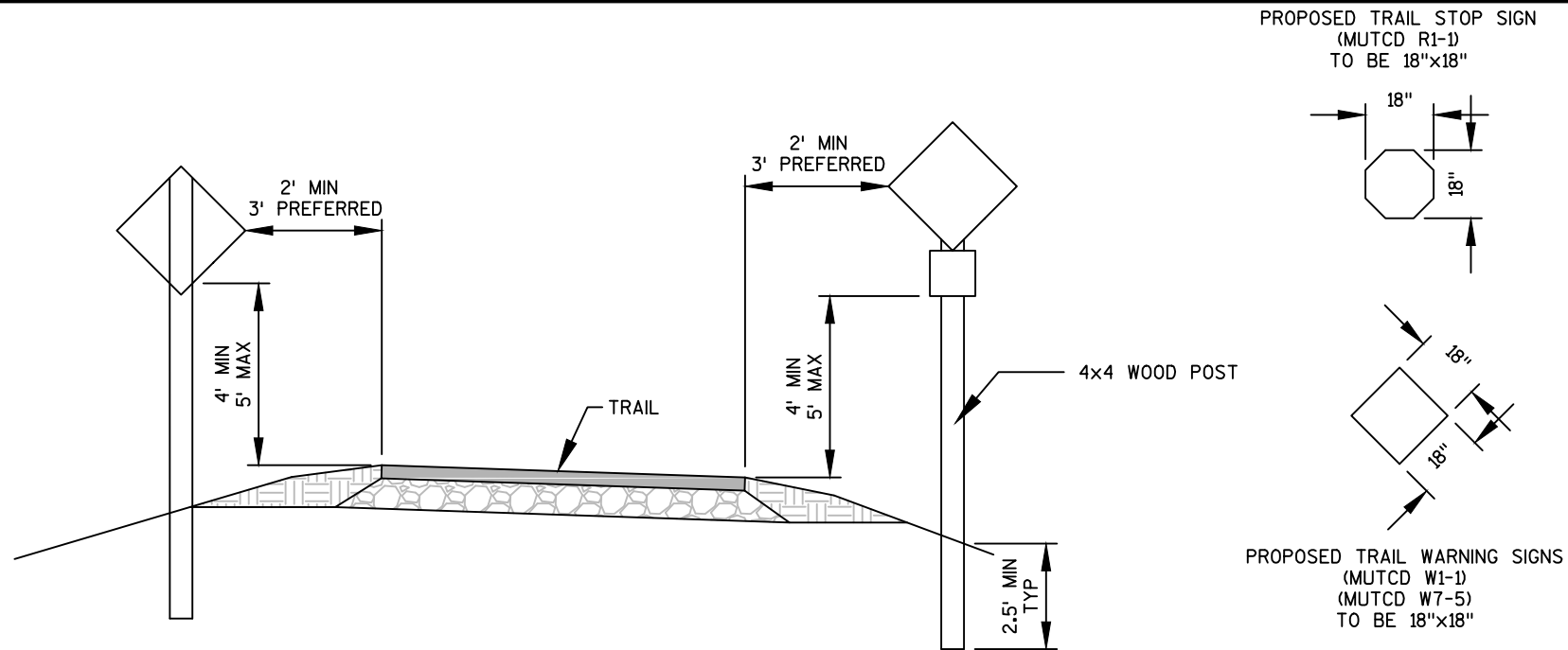

TRAIL SIGN LAYOUT

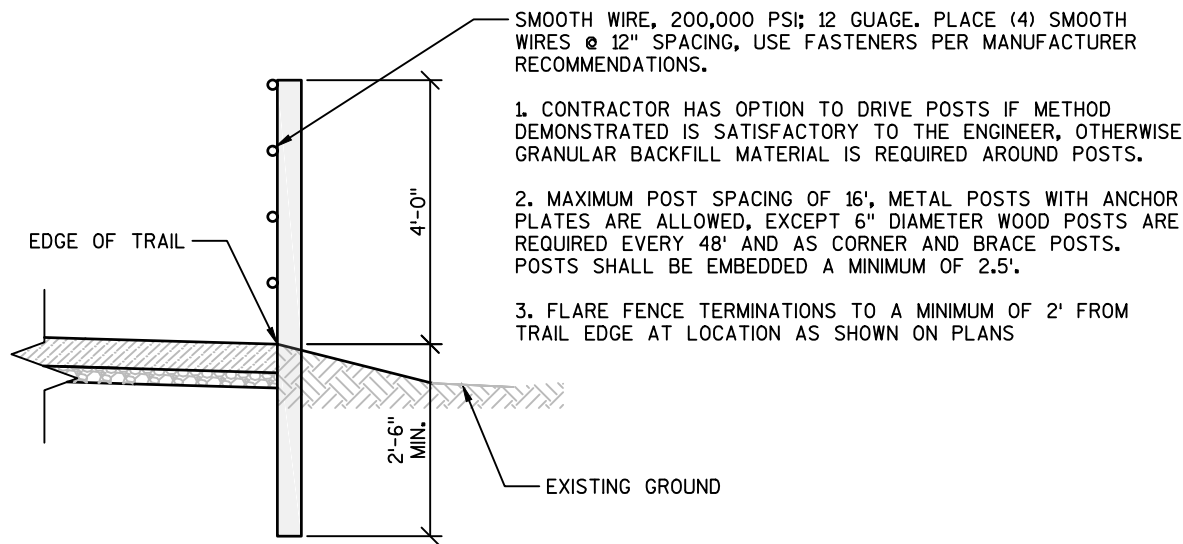

FENCE INSTALLATION DETAIL

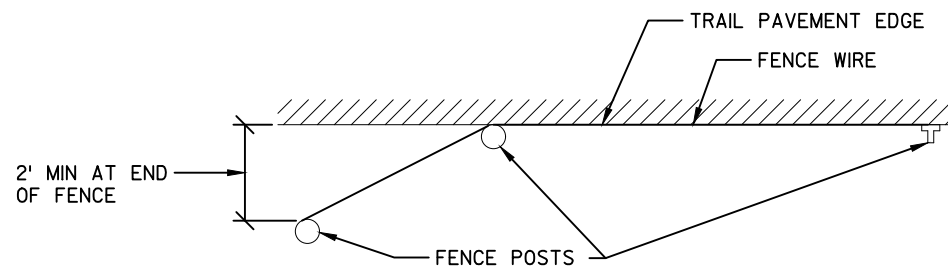

FENCE INSTALLATION DETAIL - END FLARE  
TYPICAL SECTION

**JEWELL**  
associates engineers, inc.  
Engineers - Surveyors - Architects

560 Sunrise Drive  
Spring Green, WI 53588  
phone: 608-588-7484  
fax: 608-588-9322

THIS DOCUMENT, THE IDEAS AND DESIGNS INCORPORATED HEREIN AS AN INSTRUMENT OF SERVICE, IS THE PROPERTY OF JEWELL ASSOCIATES ENGINEERS, INC. AND IS NOT TO BE USED IN WHOLE OR IN PART WITHOUT PRIOR WRITTEN AUTHORIZATION OF JEWELL ASSOCIATES ENGINEERS, INC.

IIW, P.C.

**iiw**

ARCHITECTURE  
CIVIL ENGINEERING  
CONSTRUCTION SERVICES  
ENVIRONMENTAL ENGINEERING  
LAND SURVEYING  
MUNICIPAL ENGINEERING  
STRUCTURAL ENGINEERING  
TRANSPORTATION ENGINEERING  
INTEGRITY.EXPERTISE.SOLUTIONS

**Great Sauk State Trail  
Prairie Du Sac/Sauk City Unit  
Sauk County, Wisconsin**

Date  
**5/30/2017**

|   |   |
|---|---|
| - | - |
| - | - |
| - | - |
| - | - |
| - | - |
| - | - |
| - | - |
| - | - |
| - | - |
| - | - |

Date Revision  
Drawing Name  
**Construction  
Details  
Sign & Fence  
Information**

Sheet Number  
**C4.0**  
Project Number  
**16217**

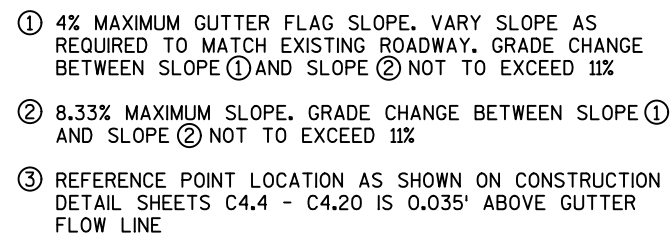

TYPICAL SIDEWALK DROP CURB DETAIL

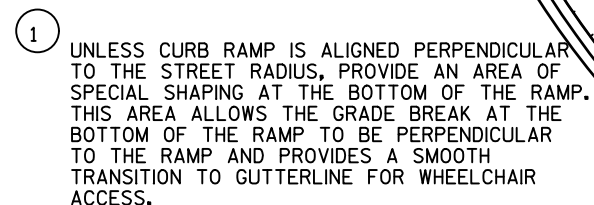

### TYPICAL CROSSWALK MARKING DETAIL

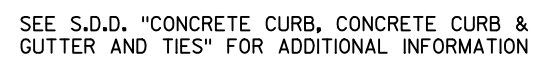

\*SLOPE VARIES TO MATCH ADJACENT PAVEMENT OR CURB AS APPROPRIATE. SEE ADDITIONAL SIDEWALK DROP CURB DETAIL FOR RESTRICTIONS AT SIDEWALK CROSSING LOCATIONS.

CONCRETE CURB AND GUTTER 24-INCH  
TYPE D SPECIAL - PHILLIPS BLVD/US-12

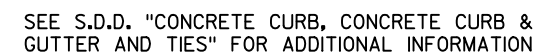

\*SLOPE VARIES TO MATCH ADJACENT PAVEMENT OR CURB AS APPROPRIATE. SEE ADDITIONAL SIDEWALK DROP CURB DETAIL FOR RESTRICTIONS AT SIDEWALK CROSSING LOCATIONS.

CONCRETE CURB AND GUTTER 24-INCH  
TYPE D

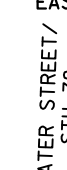

**Associates Engineers, Inc.**

THIS DOCUMENT, THE IDEAS AND DESIGNS INCORPORATED HEREIN AS AN INSTRUMENT OF SERVICE, IS THE PROPERTY OF JEWELL ASSOCIATES ENGINEERS, INC. AND IS NOT TO BE USED IN WHOLE OR IN PART WITHOUT PRIOR WRITTEN AUTHORIZATION OF JEWELL ASSOCIATES ENGINEERS, INC.

iiw

INTEGRITY.EXPERTISE.SOLUTIONS

**Great Sauk State Trail  
Prairie Du Sac/Sauk City Unit  
Sauk County, Wisconsin**

|      |          |
|------|----------|
|      |          |
| *    | *        |
| *    | *        |
| *    | *        |
| *    | *        |
| *    | *        |
|      |          |
| Date | Revision |

Sheet Number  
**C4.15**  
Project Number  
**16217**

PLOT SCALE : #####

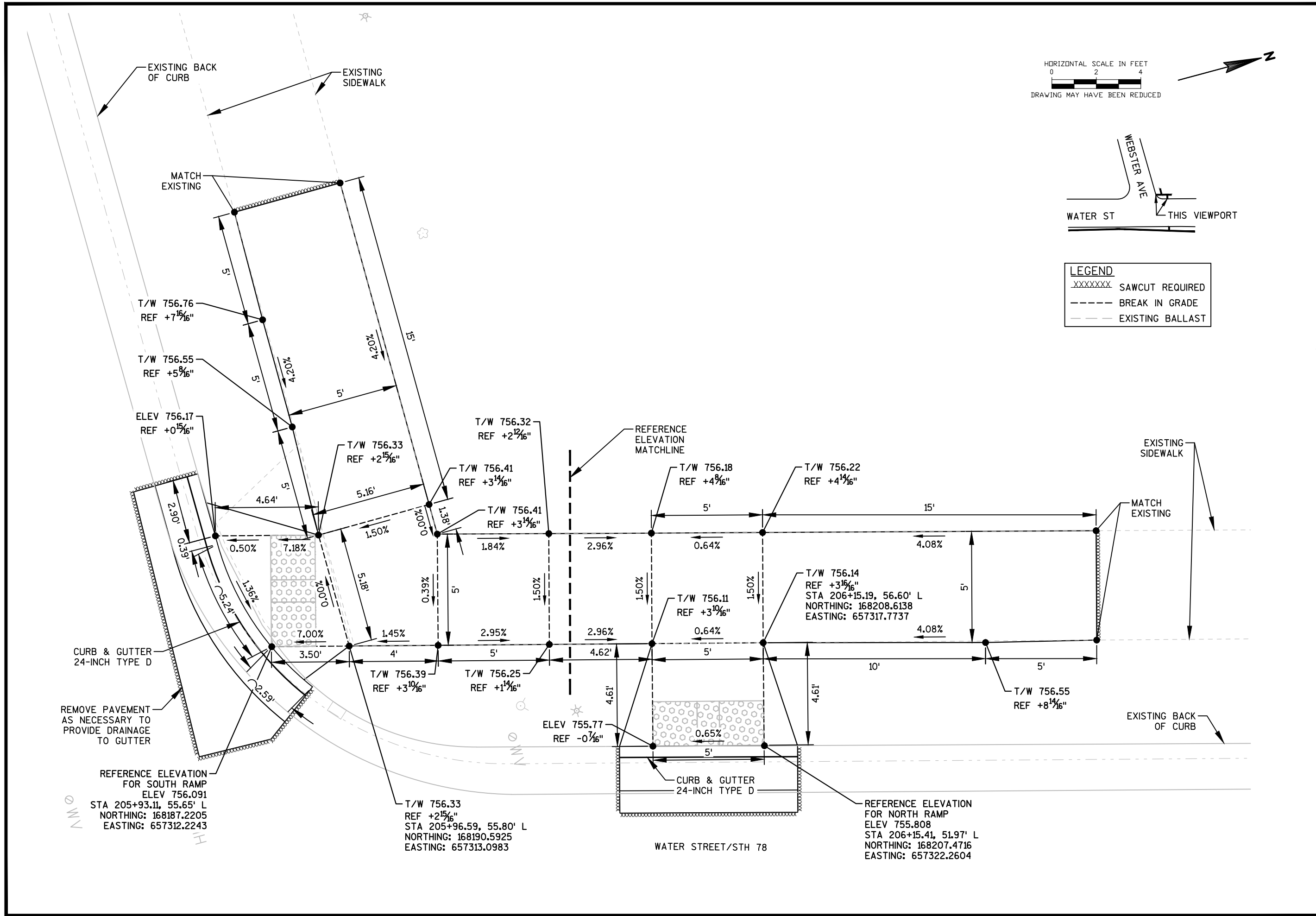

**JEWELL**  
associates engineers, inc.  
Engineers - Surveyors - Architects

560 Sunrise Drive  
Spring Green, WI 53588  
phone: 608-588-7484  
fax: 608-588-9322

THIS DOCUMENT, THE IDEAS AND DESIGNS INCORPORATED HEREIN AS AN INSTRUMENT OF SERVICE, IS THE PROPERTY OF JEWELL ASSOCIATES ENGINEERS, INC. AND IS NOT TO BE USED IN WHOLE OR IN PART WITHOUT PRIOR WRITTEN AUTHORIZATION OF JEWELL ASSOCIATES ENGINEERS, INC.

iiw, P.C.  
**iiw**  
ARCHITECTURE  
CIVIL ENGINEERING  
CONSTRUCTION SERVICES  
ENVIRONMENTAL ENGINEERING  
LAND SURVEYING  
MUNICIPAL ENGINEERING  
STRUCTURAL ENGINEERING  
TRANSPORTATION ENGINEERING  
INTEGRITY.EXPERTISE.SOLUTIONS

Great Sauk State Trail  
Prairie Du Sac/Sauk City Unit  
Sauk County, Wisconsin

Date  
5/30/2017

Date Revision

Drawing Name  
Construction  
Details - Water St  
& Webster Ave  
Curb Ramps

Sheet Number  
C4.16

Project Number  
16217

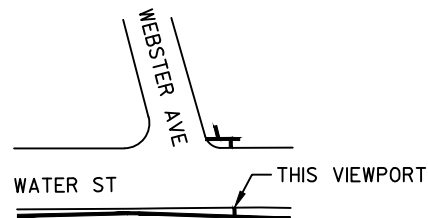

| LEGEND  |                  |
|---------|------------------|
| XXXXXXX | SAWCUT REQUIRED  |
| ----    | BREAK IN GRADE   |
| ---     | EXISTING BALLAST |

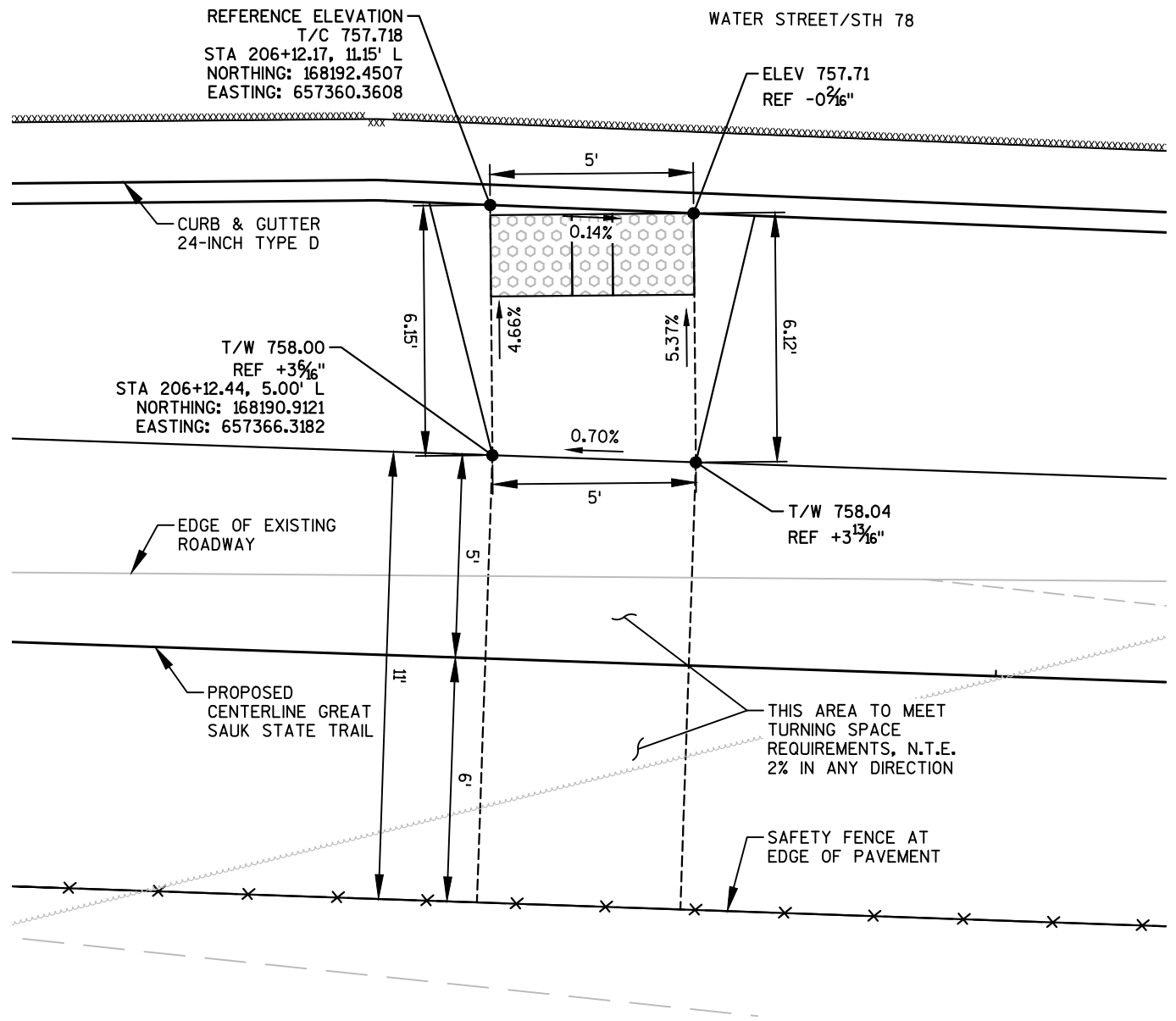

**JEWELL**  
associates engineers, inc.  
Engineers - Surveyors - Architects

560 Sunrise Drive  
Spring Green, WI 53588  
phone: 608-588-7484  
fax: 608-588-9322

THIS DOCUMENT, THE IDEAS AND DESIGNS INCORPORATED HEREIN AS AN INSTRUMENT OF SERVICE, IS THE PROPERTY OF JEWELL ASSOCIATES ENGINEERS, INC. AND IS NOT TO BE USED IN WHOLE OR IN PART WITHOUT PRIOR WRITTEN AUTHORIZATION OF JEWELL ASSOCIATES ENGINEERS, INC.

IIW, P.C.

**iiw**

ARCHITECTURE  
CIVIL ENGINEERING  
CONSTRUCTION SERVICES  
ENVIRONMENTAL ENGINEERING  
LAND SURVEYING  
MUNICIPAL ENGINEERING  
STRUCTURAL ENGINEERING  
TRANSPORTATION ENGINEERING  
INTEGRITY.EXPERTISE.SOLUTIONS

# Great Sauk State Trail Prairie Du Sac/Sauk City Unit Sauk County, Wisconsin

Date  
5/30/2017

|   |   |
|---|---|
| - | - |
| - | - |
| - | - |
| - | - |
| - | - |
| - | - |

Date Revision

Drawing Name  
**Construction  
Details - Water St  
& Webster Ave  
Curb Ramps**

Sheet Number

**C4.17**

Project Number

**16217**

LEGEND

WORK AREA

STAGE 1

TEMPORARY PEDESTRIAN ACCESS ROUTE

TRAFFIC CONTROL DRUM

DIRECTION OF TRAFFIC

SIDEWALK CLOSURE

STAGE 1 TRAFFIC CONTROL IS FOR CONSTRUCTION ON THE WEST SIDE OF WATER STREET. STAGE 2 TRAFFIC CONTROL IS FOR CONSTRUCTION ON EAST SIDE OF WATER STREET. EITHER STAGE 1 OR STAGE 2 MAY OCCUR FIRST, BUT STAGE 1 & STAGE 2 CONSTRUCTION MAY NOT OCCUR AT THE SAME TIME. MAINTAIN A MINIMUM OF 11' TRAVEL LANES IN EACH DIRECTION AT ALL TIMES ON WATER STREET. STAGE 3 TRAFFIC CONTROL IS FOR THE CONSTRUCTION AT THE INTERSECTION OF WATER ST & WEBSTER AVENUE. STAGE 3 MAY NOT OCCUR UNTIL STAGE 1 & STAGE 2 ARE COMPLETE.

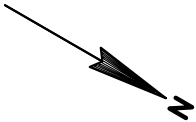
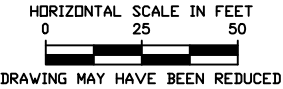

INSTALL SDD 15 D 28-3 TRAFFIC CONTROL, WORK ON SHOULDER OR PARKING LANE, UNDIVIDED, FOR ALL WORK AREAS ON THIS SHEET

INSTALL SDD 15 D 30-3a, TRAFFIC CONTROL, PEDESTRIAN ACCOMMODATION, DETAIL SIDEWALK DIVERSION DURING CONSTRUCTION OF CURB RAMPS, CURB & GUTTER, ETC.

PROPOSED GREAT SAUK STATE TRAIL

EXISTING C/L WATER STREET/STH 78

← WATER STREET →

WEBSTER AVENUE

**JEWELL**  
associates engineers, inc.  
Engineers - Surveyors - Architects

560 Sunrise Drive  
Spring Green, WI 53588  
phone: 608-588-7484  
fax: 608-588-9322

THIS DOCUMENT, THE IDEAS AND DESIGNS INCORPORATED HEREIN AS AN INSTRUMENT OF SERVICE, IS THE PROPERTY OF JEWELL ASSOCIATES ENGINEERS, INC. AND IS NOT TO BE USED IN WHOLE OR IN PART WITHOUT PRIOR WRITTEN AUTHORIZATION OF JEWELL ASSOCIATES ENGINEERS, INC.

IIW, P.C.

**iiw**

ARCHITECTURE  
CIVIL ENGINEERING  
CONSTRUCTION SERVICES  
ENVIRONMENTAL ENGINEERING  
LAND SURVEYING  
MUNICIPAL ENGINEERING  
STRUCTURAL ENGINEERING  
TRANSPORTATION ENGINEERING  
INTEGRITY.EXPERTISE.SOLUTIONS

Great Sauk State Trail  
Prairie Du Sac/Sauk City Unit  
Sauk County, Wisconsin

Date  
5/30/2017

|   |   |
|---|---|
| - | - |
| - | - |
| - | - |
| - | - |
| - | - |
| - | - |

| Date | Revision |
|------|----------|
|------|----------|

Drawing Name

Traffic Control  
Water St/STH 78  
Stage 1

Sheet Number

C4.33

Project Number

16217

LEGEND

WORK AREA  
STAGE 2

●

TRAFFIC CONTROL DRUM

➔

DIRECTION OF TRAFFIC

ROAD  
WORK  
AHEAD

W20-1-A

➔

W24-1-L

➔

W24-1-R

END  
ROAD WORK

G20-2A

INSTALL 48" X 48" ROAD WORK AHEAD,  
BLACK ON ORANGE, 600' BEFORE  
SHIFTING TAPER IN BOTH DIRECTIONS

INSTALL 48" X 48" DOUBLE  
REVERSE CURVE, BLACK ON ORANGE,  
200' BEFORE SHIFTING TAPER IN  
BOTH DIRECTIONS

INSTALL 48" X 24" END ROAD WORK  
BLACK ON ORANGE, 250' AFTER  
CONSTRUCTION AREA IN BOTH  
DIRECTIONS

NOTES:

1. SPACING BETWEEN TRAFFIC CONTROL SIGNS SHOULD BE ADJUSTED TO NOT CONFLICT WITH EXISTING SIGNS, AND SHOULD PROVIDE A DESIRABLE MINIMUM OF 200 FEET CLEARANCE TO EXISTING SIGNS.
2. THE EXACT NUMBER, LOCATION, AND SPACING OF ALL SIGNS AND DEVICES SHALL BE ADJUSTED TO FIT FIELD CONDITIONS AS APPROVED BY THE ENGINEER.
3. TRAFFIC CONTROL DRUMS WITH TYPE "C" STEADY BURN LIGHT REQUIRED ON SHIFTING TAPER
4. MAINTAIN A MINIMUM OF 11' TRAVEL LANES IN EACH DIRECTION ON WATER STREET AT ALL TIMES.

HORIZONTAL SCALE IN FEET

0

25

50

DRAWING MAY HAVE BEEN REDUCED

➔

N

**JEWELL**  
associates engineers, Inc.  
Engineers - Surveyors - Architects

560 Sunrise Drive  
Spring Green, WI 53588  
phone: 608-588-7484  
fax: 608-588-9322

THIS DOCUMENT, THE IDEAS AND DESIGNS INCORPORATED  
HEREIN AS AN INSTRUMENT OF SERVICE, IS THE PROPERTY  
OF JEWELL ASSOCIATES ENGINEERS, INC. AND IS NOT TO BE  
USED IN WHOLE OR IN PART WITHOUT PRIOR WRITTEN  
AUTHORIZATION OF JEWELL ASSOCIATES ENGINEERS, INC.

iiw, P.C.

**iiw**

ARCHITECTURE  
CIVIL ENGINEERING  
CONSTRUCTION SERVICES  
ENVIRONMENTAL ENGINEERING  
LAND SURVEYING  
MUNICIPAL ENGINEERING  
STRUCTURAL ENGINEERING  
TRANSPORTATION ENGINEERING  
INTEGRITY.EXPERTISE.SOLUTIONS

**Great Sauk State Trail  
Prairie Du Sac/Sauk City Unit  
Sauk County, Wisconsin**

|                |   |
|----------------|---|
| Date           | 5/30/2017                                     |
| Revision       |   |
| Drawing Name   | Traffic Control<br>Water St/STH 78<br>Stage 2 |
| Sheet Number   | C4.34   |
| Project Number | 16217   |

FILE NAME : P:\16\217\DRAWINGS\16217\SHEETPLAN\040302\_TC.DWG  
LAYOUT : C4.34 - TRAFFIC CONTROL

PLOT DATE : 5/30/2017  
PLOT TIME : 8:34:41 PM

PLOT BY : ERIC URE

PLOT SCALE : 1" = 1'

LEGEND

WORK AREA

STAGE 1

TEMPORARY PEDESTRIAN ACCESS ROUTE

TRAFFIC CONTROL DRUM

DIRECTION OF TRAFFIC

SIDEWALK CLOSURE

STAGE 3 TRAFFIC CONTROL IS FOR THE CONSTRUCTION OF SIDEWALK AND CURB RAMPS AT THE INTERSECTION OF WATER ST AND WEBSTER AVE. STAGE 3 MAY NOT OCCUR UNTIL STAGE 1 & 2 ARE COMPLETE. CURB RAMP CONSTRUCTION ON THE SOUTH SIDE OF OAK STREET AT WATER STREET MUST ALSO BE COMPLETE. DURING STAGE 3 CONSTRUCTION, PEDESTRIAN TRAFFIC WILL BE DIVERTED TO THE EAST SIDE OF WATER STREET USING THE PROPOSED GREAT SAUK STATE TRAIL.

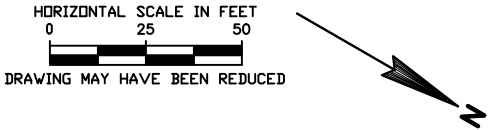
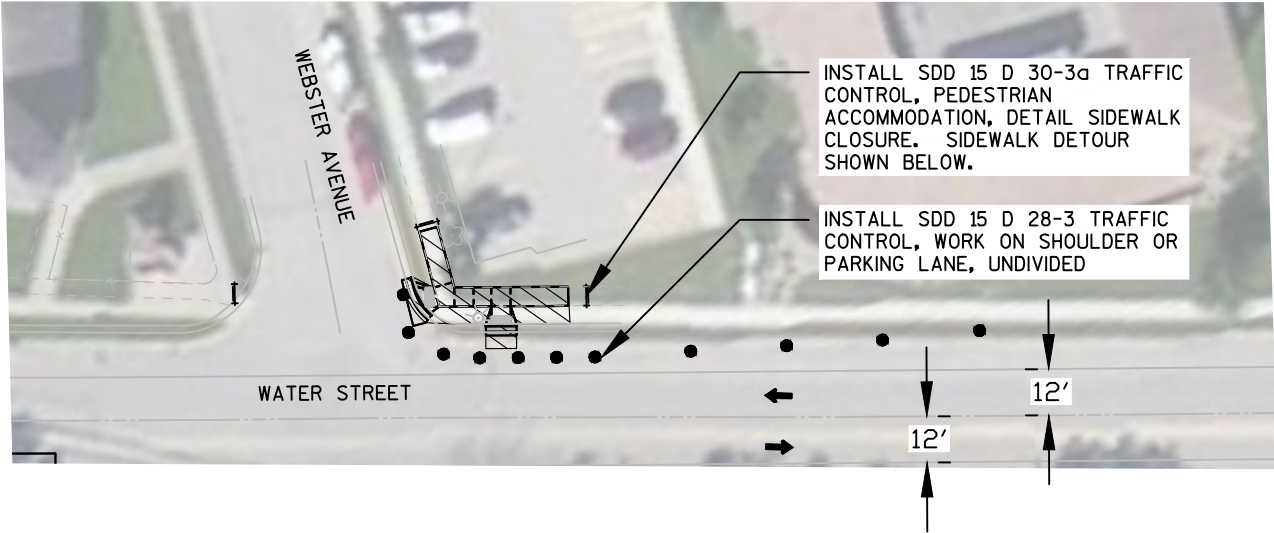

WASHINGTON STREET

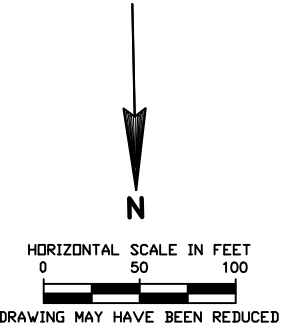
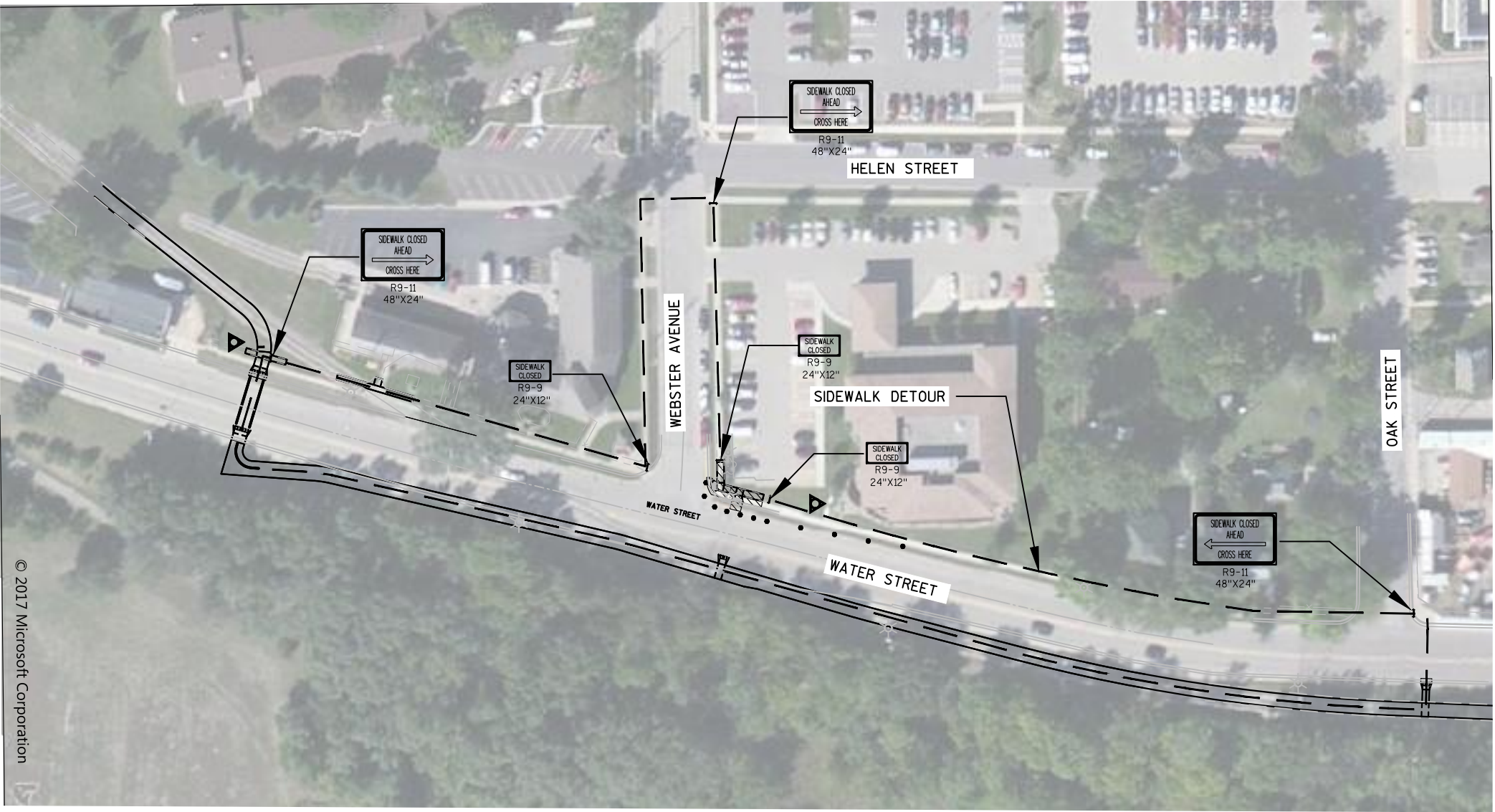

**JEWELL**  
associates engineers, inc.  
Engineers - Surveyors - Architects

560 Sunrise Drive  
Spring Green, WI 53588  
phone: 608-588-7484  
fax: 608-588-9322

THIS DOCUMENT, THE IDEAS AND DESIGNS INCORPORATED HEREIN AS AN INSTRUMENT OF SERVICE, IS THE PROPERTY OF JEWELL ASSOCIATES ENGINEERS, INC. AND IS NOT TO BE USED IN WHOLE OR IN PART WITHOUT PRIOR WRITTEN AUTHORIZATION OF JEWELL ASSOCIATES ENGINEERS, INC.

iiw, P.C.  
**iiw**  
ARCHITECTURE  
CIVIL ENGINEERING  
CONSTRUCTION SERVICES  
ENVIRONMENTAL ENGINEERING  
LAND SURVEYING  
MUNICIPAL ENGINEERING  
STRUCTURAL ENGINEERING  
TRANSPORTATION ENGINEERING  
INTEGRITY.EXPERTISE.SOLUTIONS

**Great Sauk State Trail**  
**Prairie Du Sac/Sauk City Unit**  
**Sauk County, Wisconsin**

|                |                 |
|----------------|-----------------|
| Date           | 5/30/2017       |
| Revision       |                 |
| Drawing Name   | Traffic Control |
| Sheet Number   | C4.35           |
| Project Number | 16217           |

LEGEND  
XXXXXXX SAWCUT REQUIRED  
--- EXISTING BALLAST

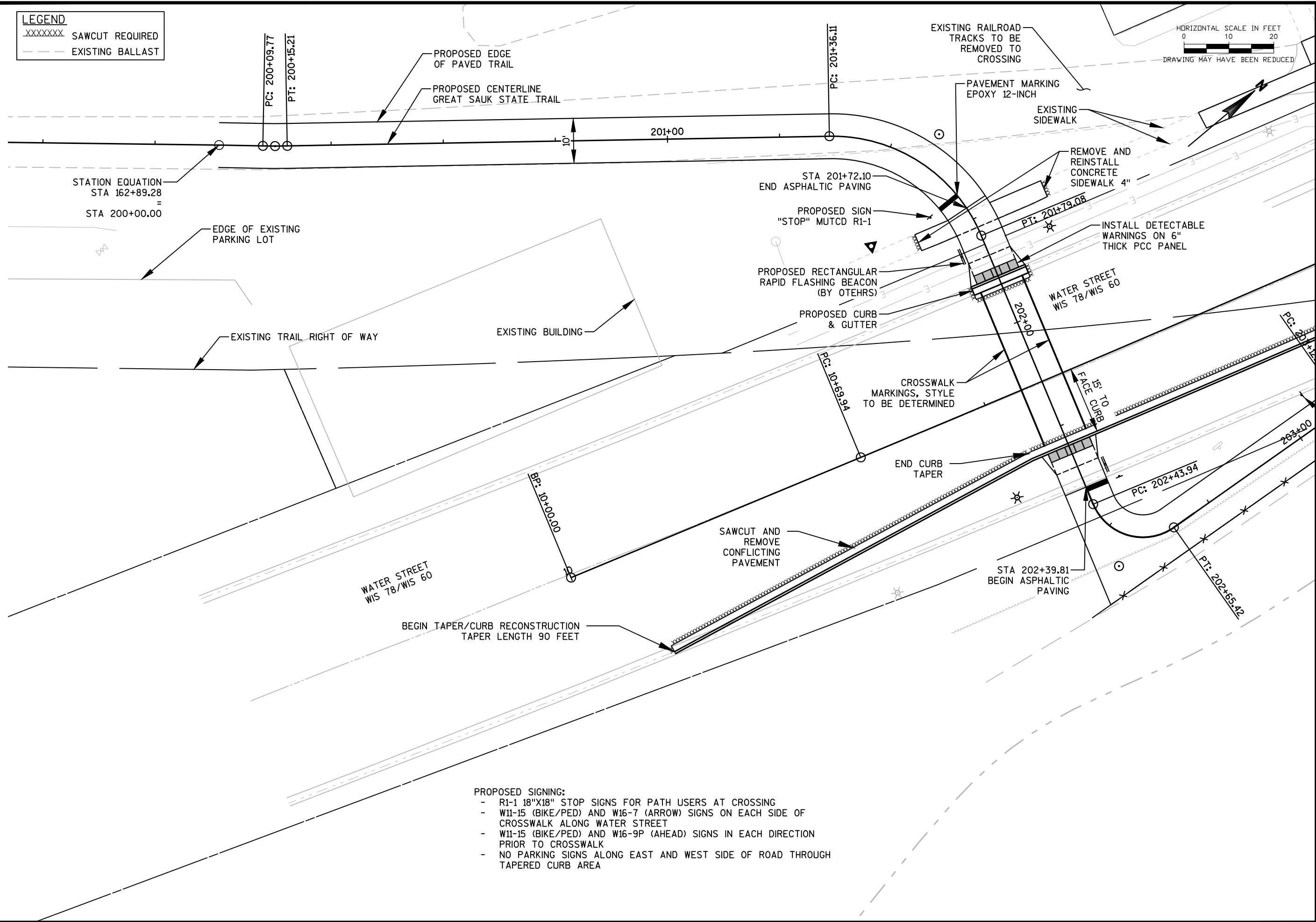

- PROPOSED SIGNING:
- R1-1 18"X18" STOP SIGNS FOR PATH USERS AT CROSSING
  - W11-15 (BIKE/PED) AND W16-7 (ARROW) SIGNS ON EACH SIDE OF CROSSWALK ALONG WATER STREET
  - W11-15 (BIKE/PED) AND W16-9P (AHEAD) SIGNS IN EACH DIRECTION PRIOR TO CROSSWALK
  - NO PARKING SIGNS ALONG EAST AND WEST SIDE OF ROAD THROUGH TAPERED CURB AREA

**JEWELL**  
associates engineers, inc.  
Engineers - Surveyors - Architects

560 Sunrise Drive  
Spring Green, WI 53588  
phone: 608-588-7484  
fax: 608-588-9322

THIS DOCUMENT, THE IDEAS AND DESIGNS INCORPORATED HEREIN AS AN INSTRUMENT OF SERVICE, IS THE PROPERTY OF JEWELL ASSOCIATES ENGINEERS, INC. AND IS NOT TO BE USED IN WHOLE OR IN PART WITHOUT PRIOR WRITTEN AUTHORIZATION OF JEWELL ASSOCIATES ENGINEERS, INC.

IIW, P.C.

**iiw**

ARCHITECTURE  
CIVIL ENGINEERING  
CONSTRUCTION SERVICES  
ENVIRONMENTAL ENGINEERING  
LAND SURVEYING  
MUNICIPAL ENGINEERING  
STRUCTURAL ENGINEERING  
TRANSPORTATION ENGINEERING  
INTEGRITY.EXPERTISE.SOLUTIONS

# Great Sauk State Trail Prairie Du Sac/Sauk City Unit Sauk County, Wisconsin

Date  
5/30/2017

|      |          |
|------|----------|
|      |          |
|      |          |
|      |          |
|      |          |
|      |          |
|      |          |
|      |          |
|      |          |
| Date | Revision |

Drawing Name  
**Plan Views  
Mainline Trail**

Sheet Number  
**C6.12**  
Project Number  
**16217**

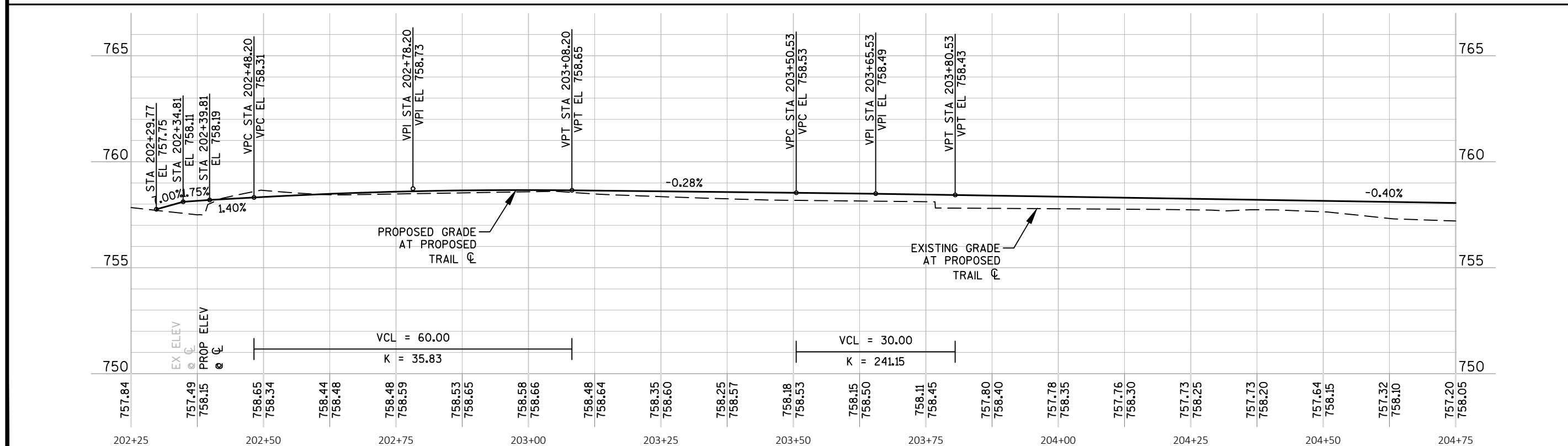
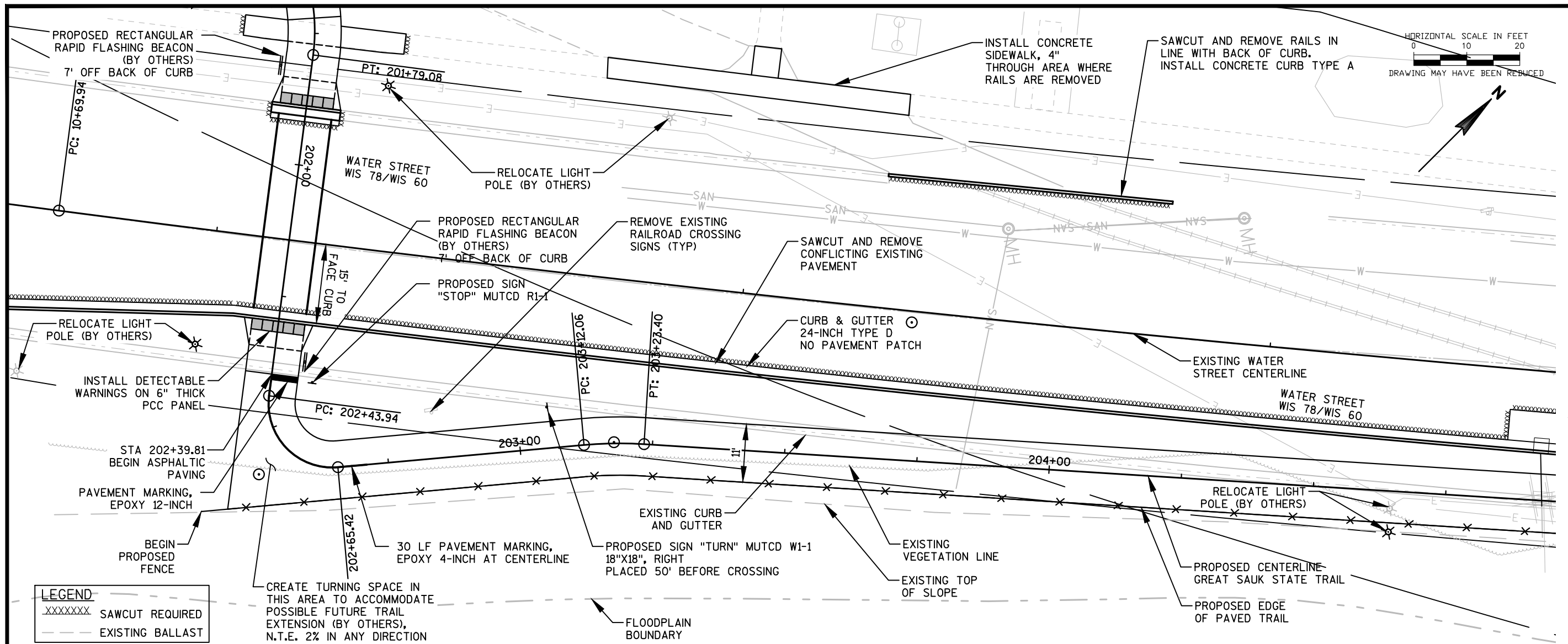

**JEWELL**  
 associates engineers, inc.  
 Engineers - Surveyors - Architects

560 Sunrise Drive  
 Spring Green, WI 53588  
 phone: 608-588-7484  
 fax: 608-588-9322

THIS DOCUMENT, THE IDEAS AND DESIGNS INCORPORATED HEREIN AS AN INSTRUMENT OF SERVICE, IS THE PROPERTY OF JEWELL ASSOCIATES ENGINEERS, INC. AND IS NOT TO BE USED IN WHOLE OR IN PART WITHOUT PRIOR WRITTEN AUTHORIZATION OF JEWELL ASSOCIATES ENGINEERS, INC.

iiw

ARCHITECTURE  
 CIVIL ENGINEERING  
 CONSTRUCTION SERVICES  
 ENVIRONMENTAL ENGINEERING  
 LAND SURVEYING  
 MUNICIPAL ENGINEERING  
 STRUCTURAL ENGINEERING  
 TRANSPORTATION ENGINEERING

INTEGRITY.EXPERTISE.SOLUTIONS

**Great Sauk State Trail**  
**Prairie Du Sac/Sauk City Unit**  
**Sauk County, Wisconsin**

Date  
**5/30/2017**

Date  
 Revision

Drawing Name  
**Plan & Profile**  
**Mainline Trail**

Sheet Number  
**C6.13**

Project Number  
**16217**

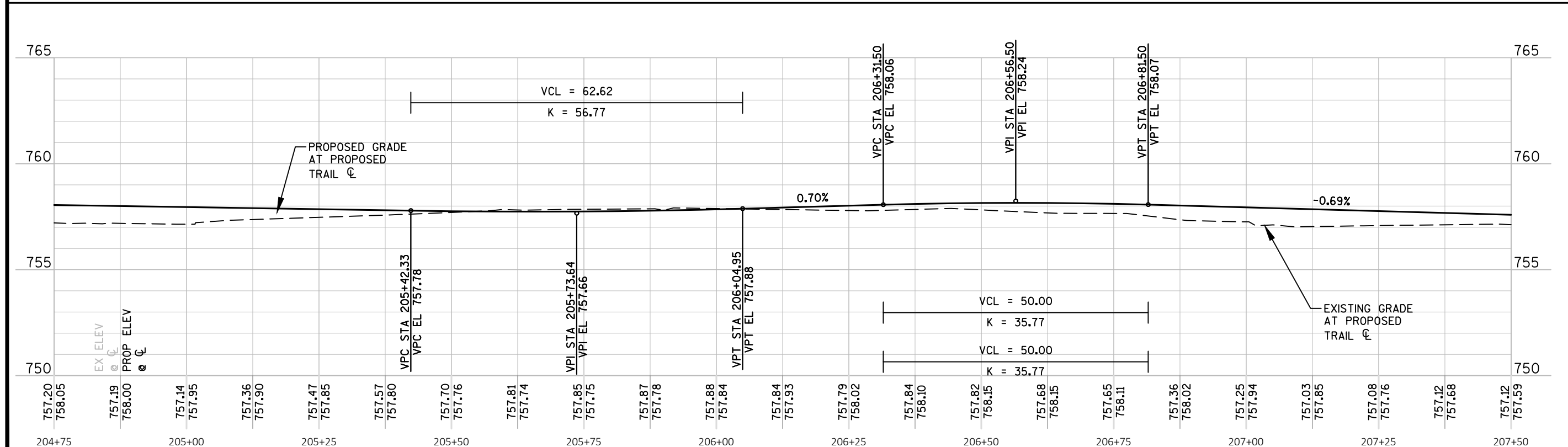
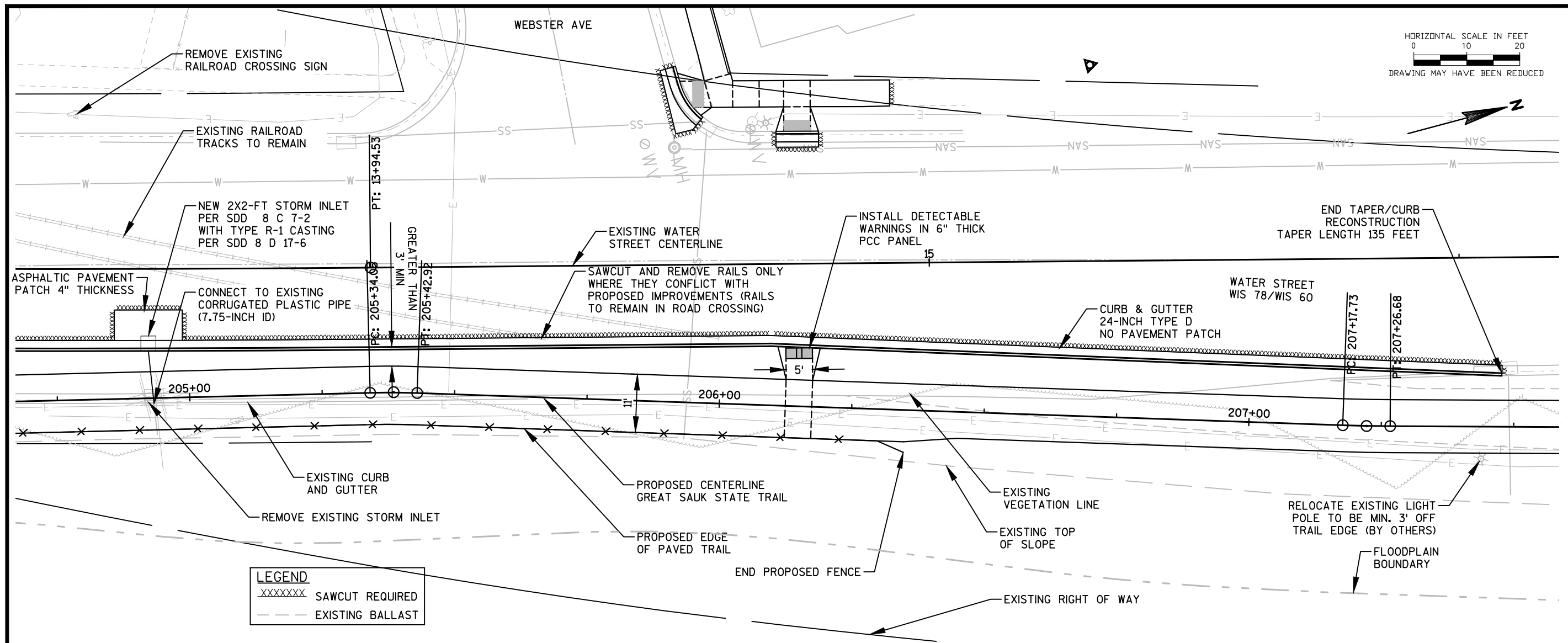

**JEWELL**  
 associates engineers, inc.  
 Engineers - Surveyors - Architects

560 Sunrise Drive  
 Spring Green, WI 53588  
 phone: 608-588-7484  
 fax: 608-588-9322

THIS DOCUMENT, THE IDEAS AND DESIGNS INCORPORATED HEREIN AS AN INSTRUMENT OF SERVICE, IS THE PROPERTY OF JEWELL ASSOCIATES ENGINEERS, INC. AND IS NOT TO BE USED IN WHOLE OR IN PART WITHOUT PRIOR WRITTEN AUTHORIZATION OF JEWELL ASSOCIATES ENGINEERS, INC.

iiw, P.C.

ARCHITECTURE  
 CIVIL ENGINEERING  
 CONSTRUCTION SERVICES  
 ENVIRONMENTAL ENGINEERING  
 LAND SURVEYING  
 MUNICIPAL ENGINEERING  
 STRUCTURAL ENGINEERING  
 TRANSPORTATION ENGINEERING  
 INTEGRITY.EXPERTISE.SOLUTIONS

**Great Sauk State Trail  
 Prairie Du Sac/Sauk City Unit  
 Sauk County, Wisconsin**

Date  
**5/30/2017**

| Date | Revision |
|------|----------|
|      |          |
|      |          |
|      |          |
|      |          |
|      |          |
|      |          |
|      |          |
|      |          |
|      |          |
|      |          |

Drawing Name  
**Plan & Profile  
 Mainline Trail**

Sheet Number  
**C6.14**

Project Number  
**16217**

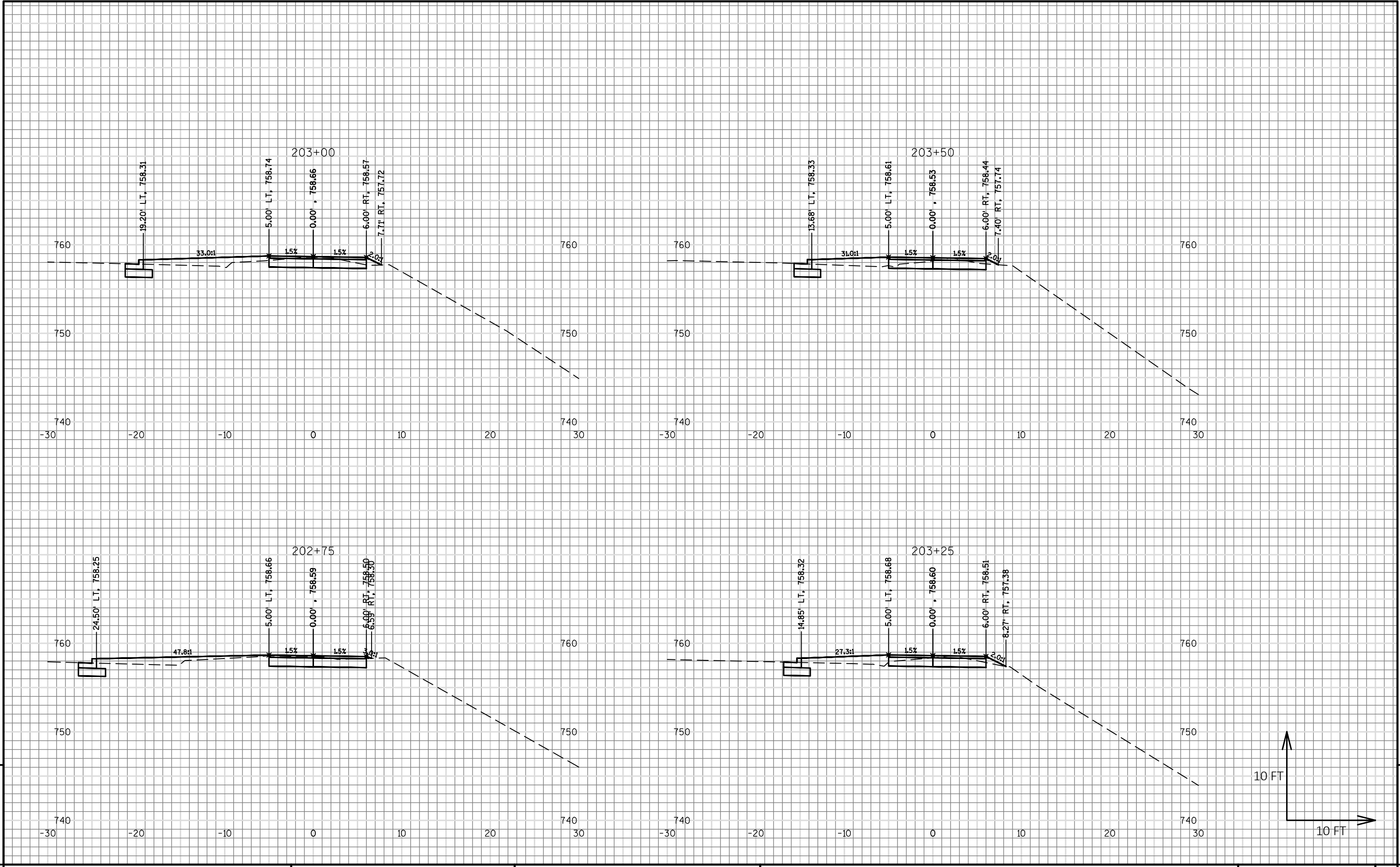

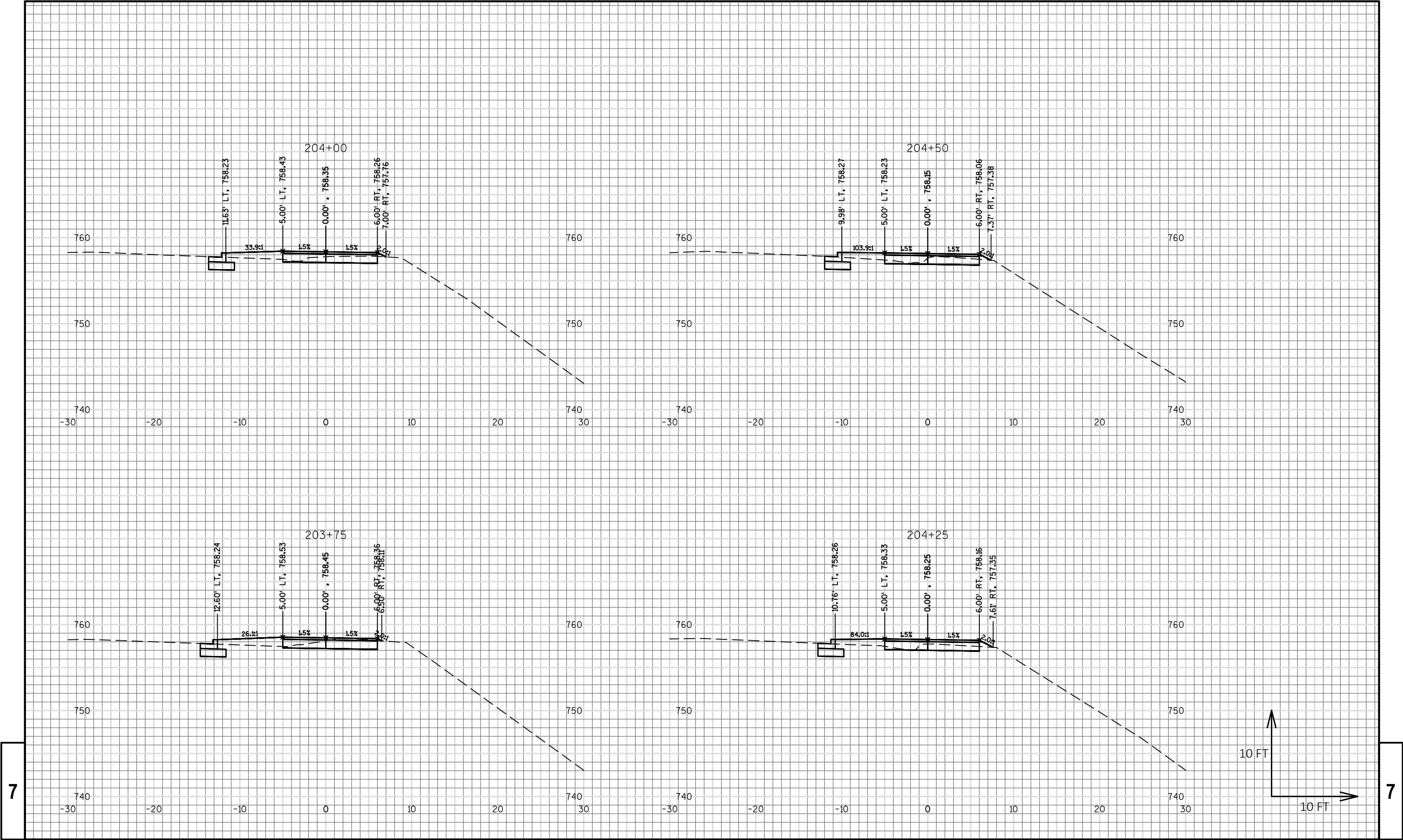

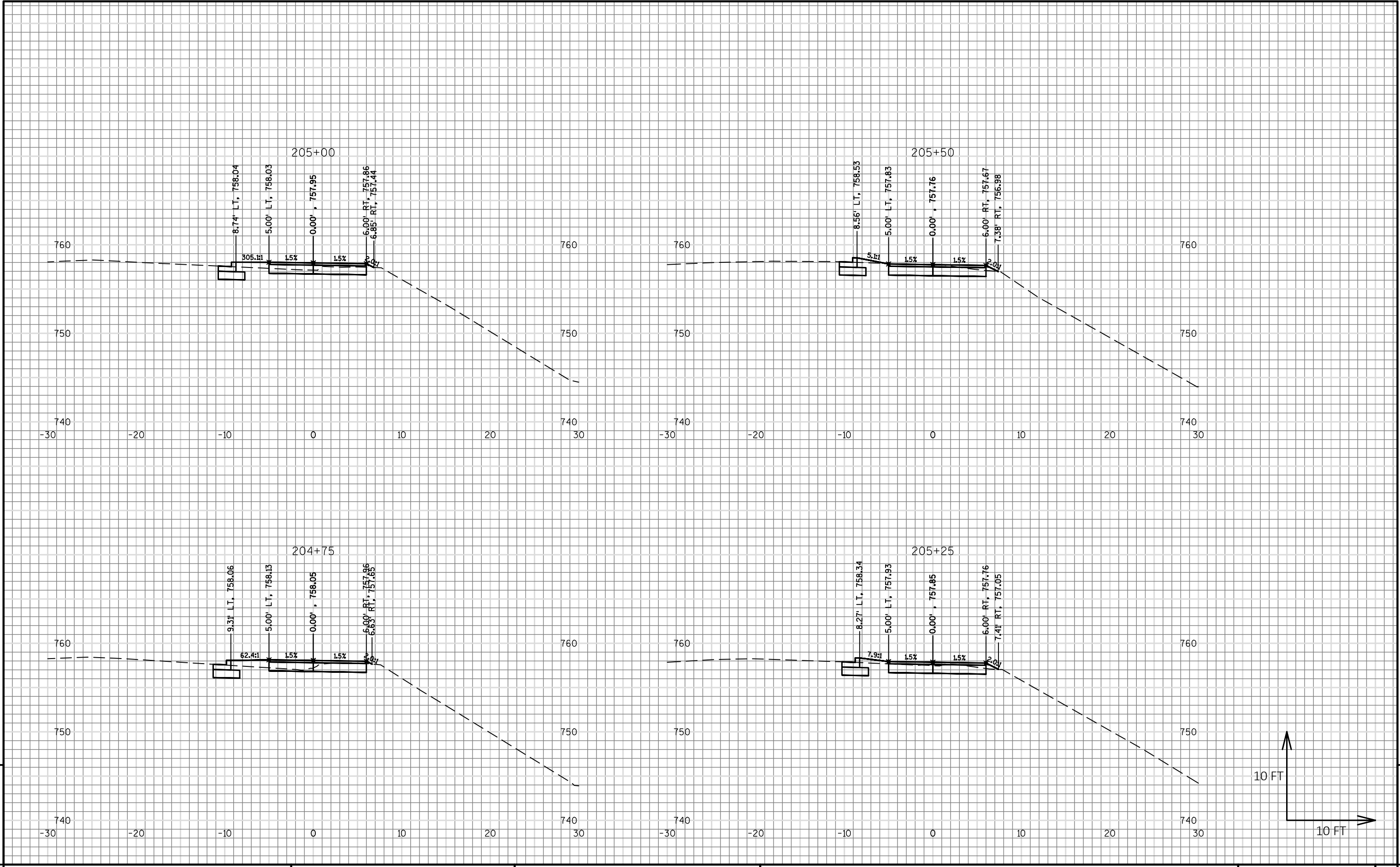

7

7

|                   |                                 |                     |  |            |   |
|-------------------|---------------------------------|---------------------|--|------------|---|
| PROJECT NO: 16217 | PROJECT: Great Sauk State Trail | COUNTY: Sauk County | CROSS SECTIONS: Cross Sections (Mainline, Water St, Top Of Bank) | SHEET C7.2 | E |
|-------------------|---------------------------------|---------------------|--|------------|---|

