

**Great Sauk State Trail
Prairie Du Sac/Sauk City Unit
Sauk County, Wisconsin**

Date
6/22/2017

Revision	
1	
2	
3	
4	
5	
6	
7	
8	
9	
10	

Date Revision

Drawing Name

Typical Sections

Sheet Number
C3.0

Project Number
16217

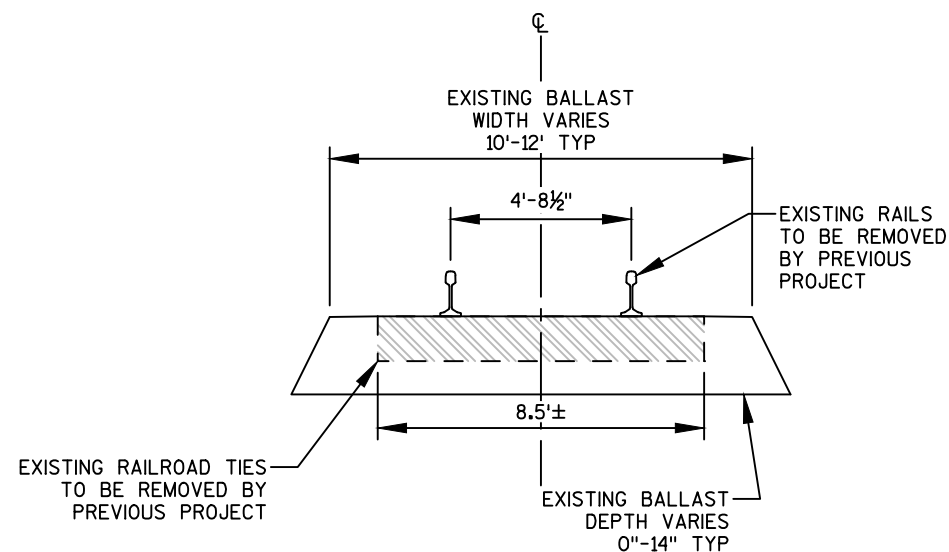

TYPICAL EXISTING SECTION

EXISTING RAIL CORRIDOR
STA 100+36 TO STA 162+89
STA 200+00 TO STA 211+46
STA 300+00 TO STA 357+75
STA 406+27.69 TO STA 840+00

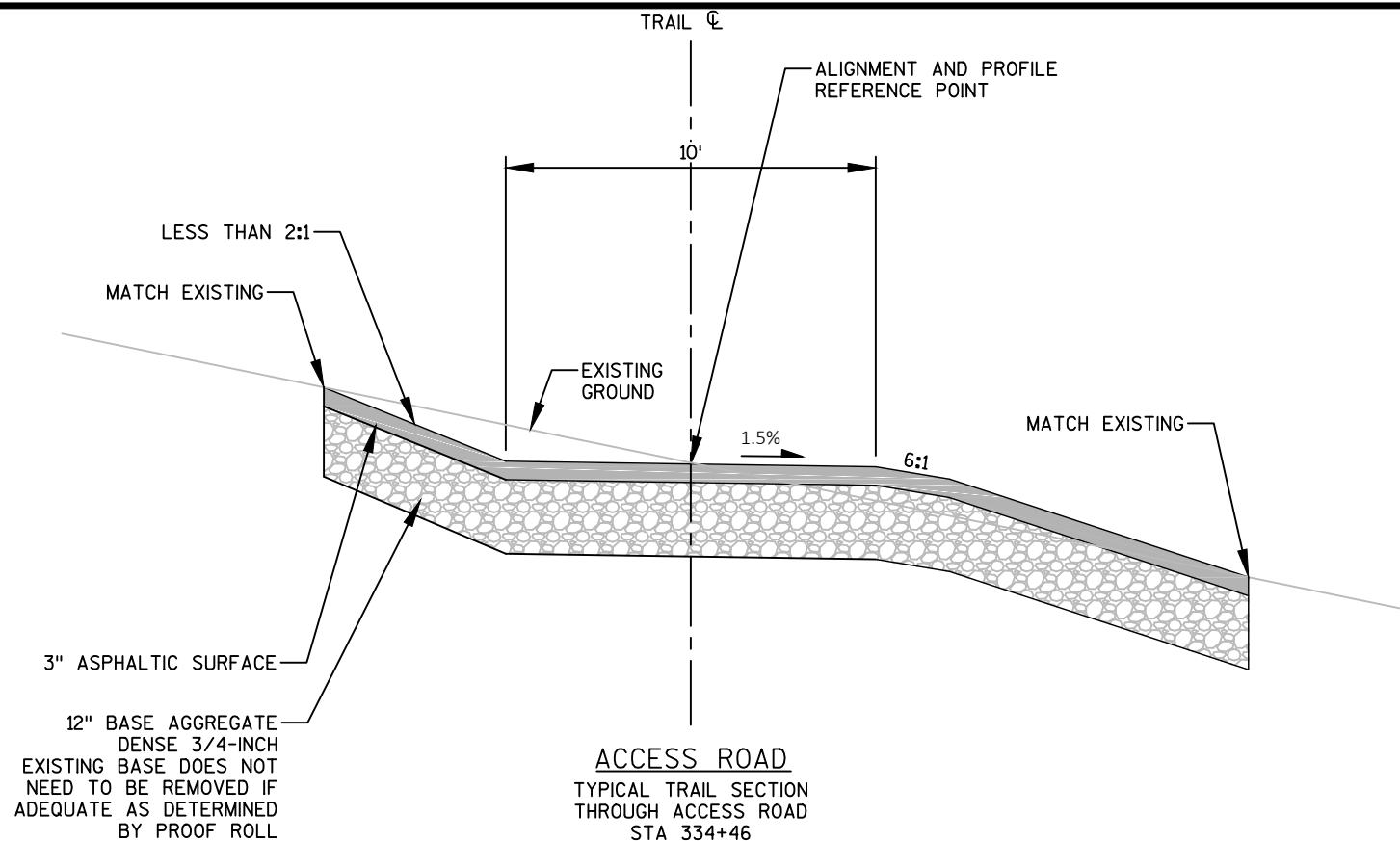

**ACCESS ROAD
TYPICAL TRAIL SECTION
THROUGH ACCESS ROAD
STA 334+46**

12" BASE AGGREGATE
DENSE 3/4-INCH
EXISTING BASE DOES NOT
NEED TO BE REMOVED IF
ADEQUATE AS DETERMINED
BY PROOF ROLL

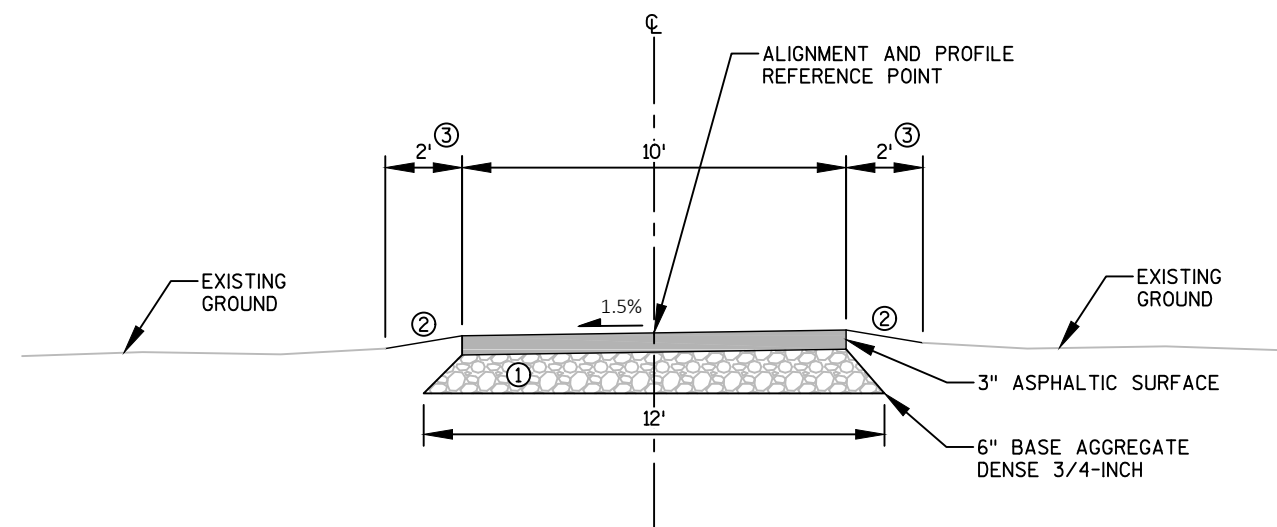

- 1 REMOVE EXISTING RAILS, SPIKES, TIE PLATES, AND TIES (BY PREVIOUS PROJECT). PROOF ROLL REMAINING SUBGRADE TO CONFIRM STABILITY, IF UNSTABLE CORE OUT EXISTING SUBGRADE FOR INSTALLATION OF 6" BASE AGGREGATE DENSE 3/4-INCH AND 3" HMA WITH FINAL SURFACE AT TOP OF RAILROAD TIE ELEVATION
- 2 BLEND TO EXISTING GROUND AT NO STEEPER THAN 6:1
- 3 TOPSOIL, SEED, FERTILIZE & MULCH DISTURBED AREA, MINIMUM 6" TOPSOIL

TYPICAL FINISHED SECTION

TRAIL WHERE BALLAST IS NO LONGER PRESENT
STA 100+42 TO STA 107+15
STA 201+35 TO STA 201+72
STA 478+33.33 TO STA 546+70

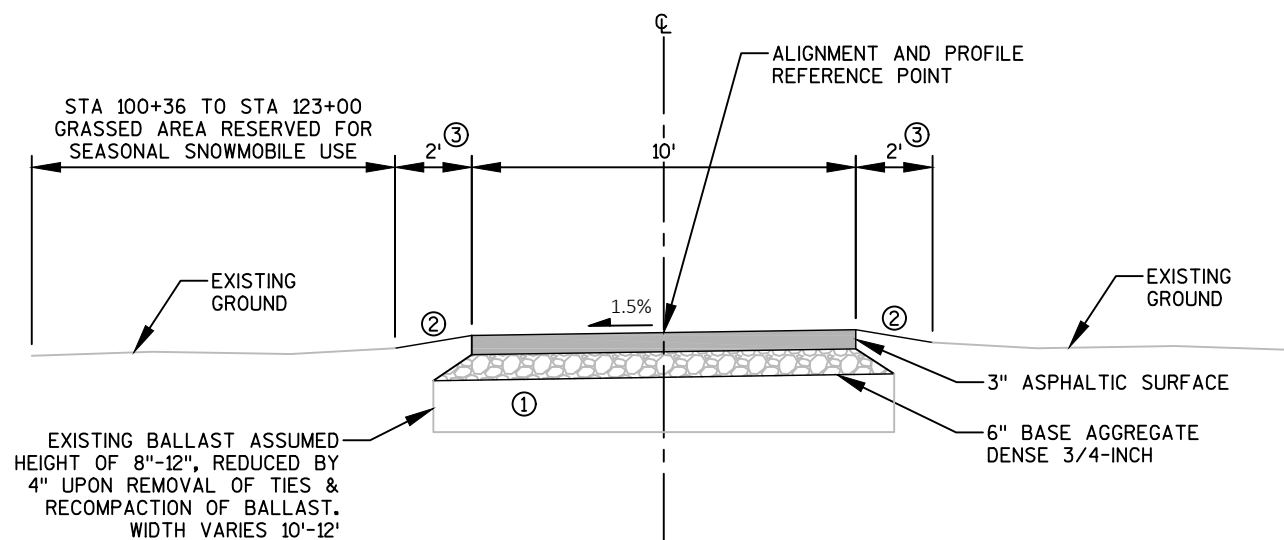

- 1 REMOVE EXISTING RAILS, SPIKES, TIE PLATES, AND TIES, (BY PREVIOUS PROJECT) COMPACT EXISTING BALLAST
- 2 BLEND TO EXISTING GROUND AT NO STEEPER THAN 6:1
- 3 TOPSOIL, SEED, FERTILIZE & MULCH DISTURBED AREA, MINIMUM 6" TOPSOIL

TYPICAL FINISHED SECTION

TRAIL WITH GRASS SHOULDERS
STA 107+15 TO STA 162+89
STA 200+00 TO STA 201+35
STA 207+50 TO STA 211+46
STA 300+00 TO STA 308+00

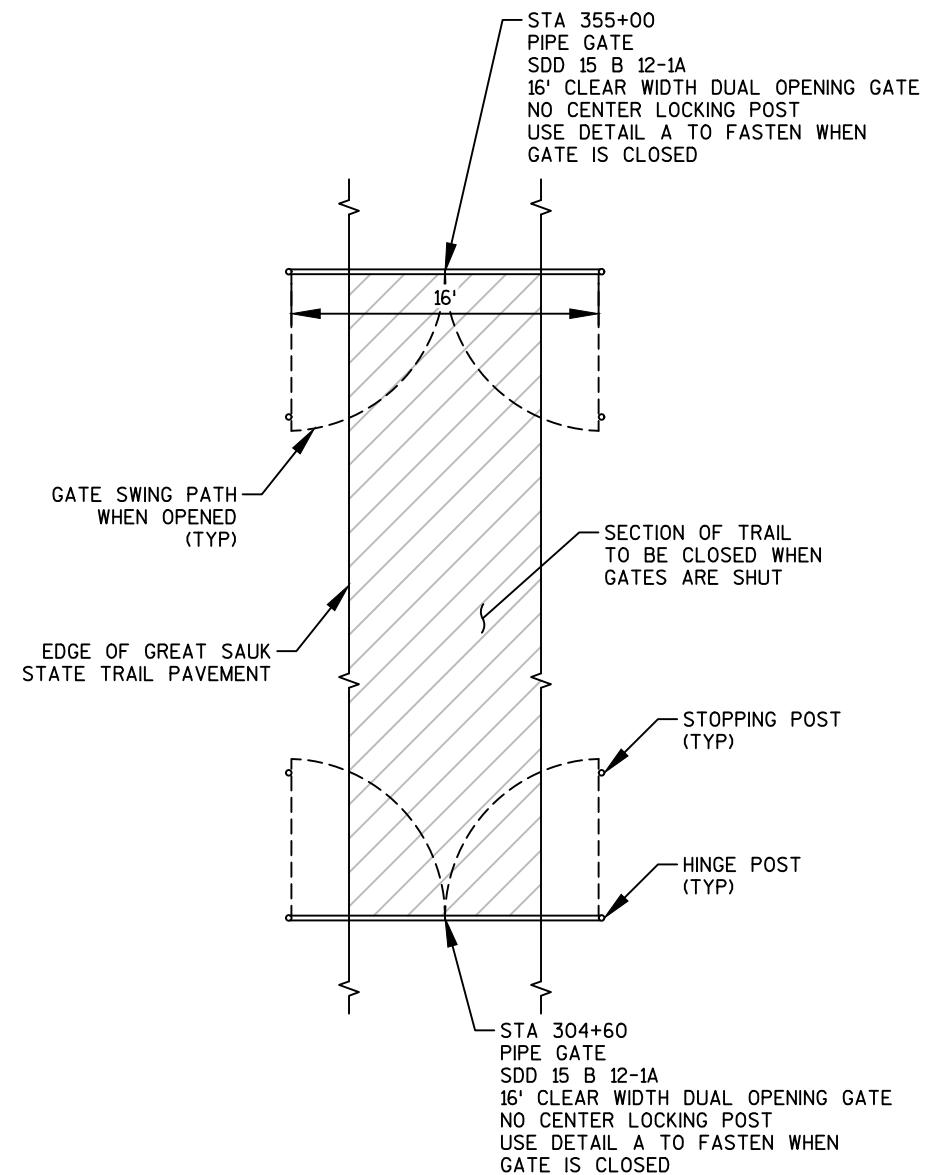
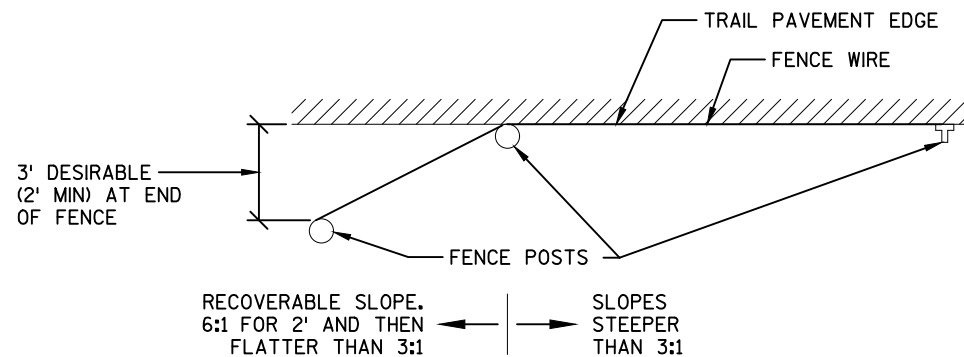
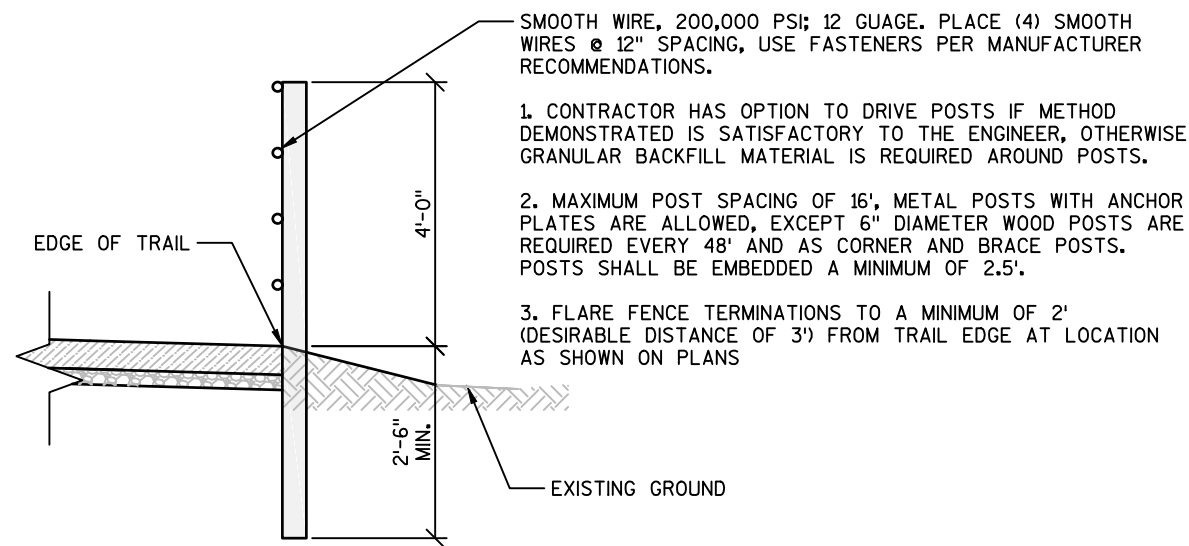
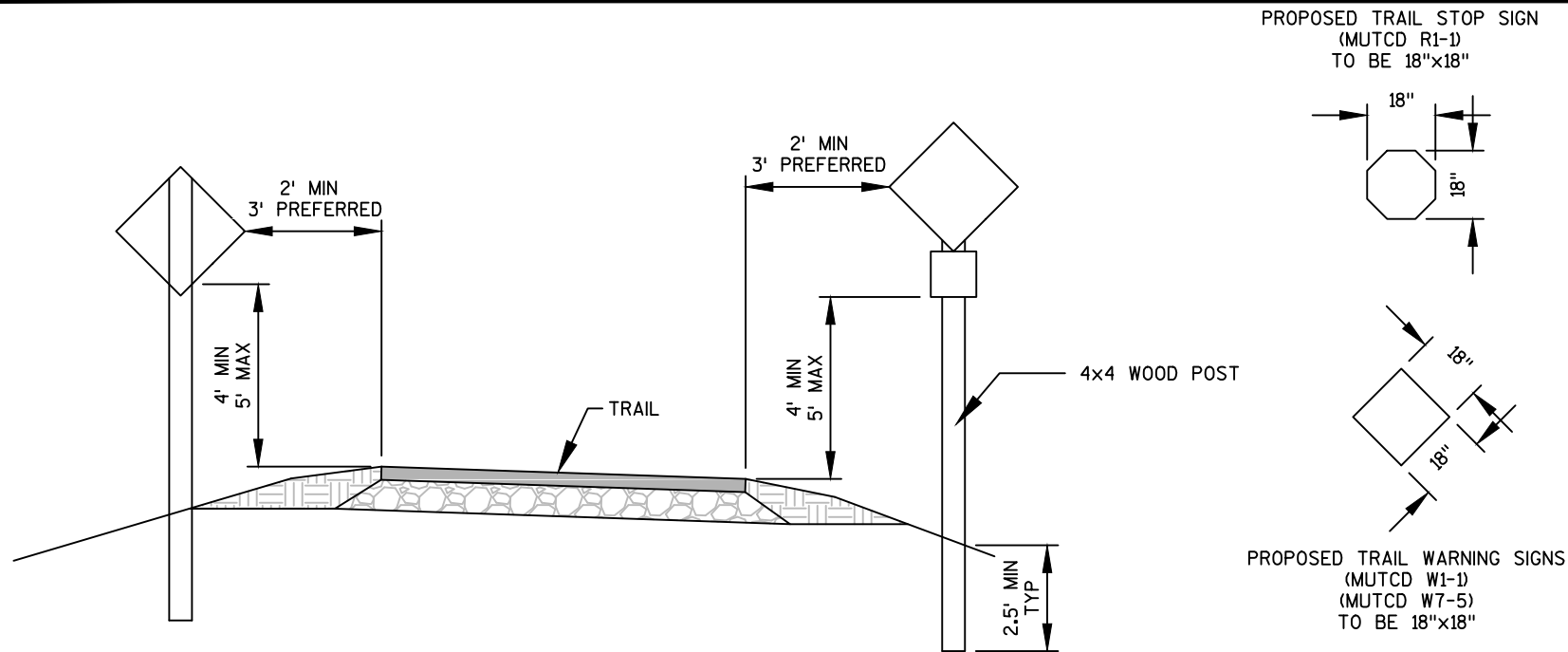

JEWELL
associates engineers, Inc.
Engineers - Surveyors - Architects

560 Sunrise Drive
Spring Green, WI 53588
phone: 608-588-7484
fax: 608-588-9322

THIS DOCUMENT, THE IDEAS AND DESIGNS INCORPORATED HEREIN AS AN INSTRUMENT OF SERVICE, IS THE PROPERTY OF JEWELL ASSOCIATES ENGINEERS, INC. AND IS NOT TO BE USED IN WHOLE OR IN PART WITHOUT PRIOR WRITTEN AUTHORIZATION OF JEWELL ASSOCIATES ENGINEERS, INC.

IIW, P.C.

iiw
ARCHITECTURE
CIVIL ENGINEERING
CONSTRUCTION SERVICES
ENVIRONMENTAL ENGINEERING
LAND SURVEYING
MUNICIPAL ENGINEERING
STRUCTURAL ENGINEERING
TRANSPORTATION ENGINEERING
INTEGRITY.EXPERTISE.SOLUTIONS

**Great Sauk State Trail
Prairie Du Sac/Sauk City Unit
Sauk County, Wisconsin**

Date
6/14/2017

Revision	Date

Drawing Name
**Construction
Details
Sign & Fence
Information**

Sheet Number
C4.0
Project Number
16217

**Great Sauk State Trail
Prairie Du Sac/Sauk City Unit
Sauk County, Wisconsin**

Date

6/14/2017

Date	Revision

Drawing Name

**Construction
Details
Crosswalk &
Curb Information**

Sheet Number

C4.1

Project Number

16217

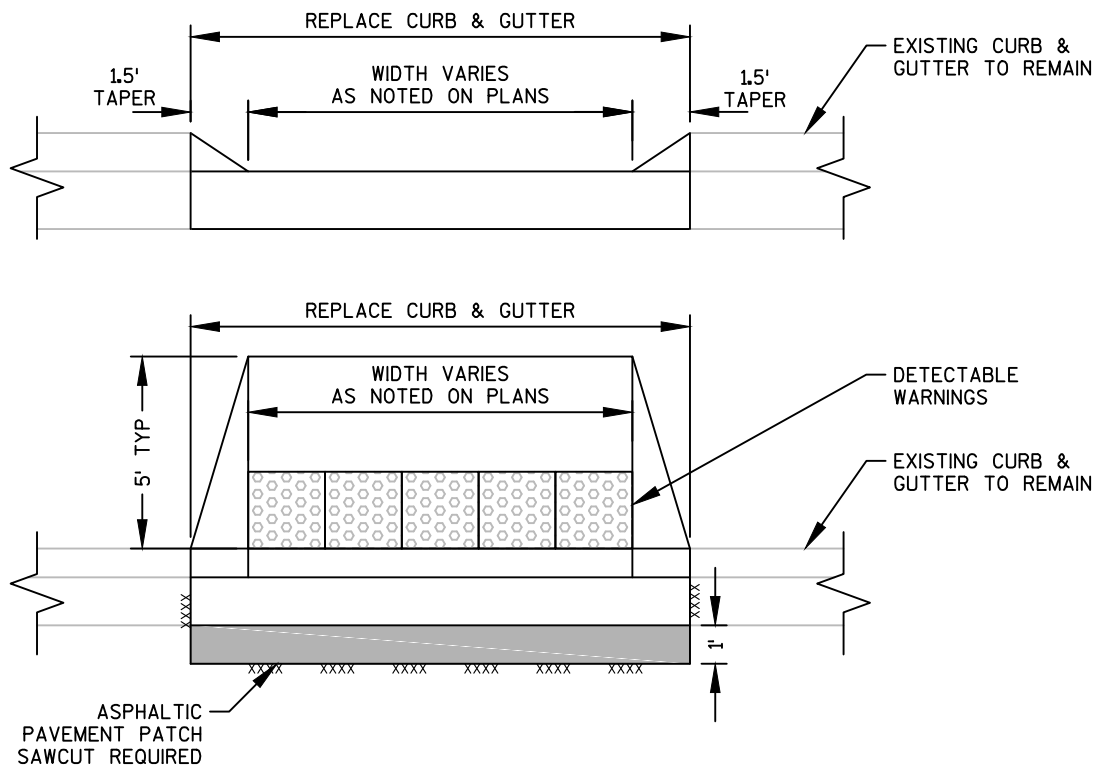

TYPICAL CURB REPLACEMENT DETAIL

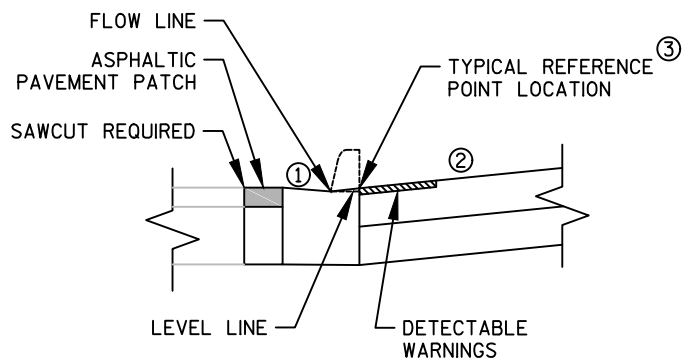

- ① 4% MAXIMUM GUTTER FLAG SLOPE. VARY SLOPE AS REQUIRED TO MATCH EXISTING ROADWAY. GRADE CHANGE BETWEEN SLOPE ① AND SLOPE ② NOT TO EXCEED 11%
- ② 8.33% MAXIMUM SLOPE. GRADE CHANGE BETWEEN SLOPE ① AND SLOPE ② NOT TO EXCEED 11%
- ③ REFERENCE POINT LOCATION AS SHOWN ON CONSTRUCTION DETAIL SHEETS C4.4 - C4.20 IS 0.035' ABOVE GUTTER FLOW LINE

TYPICAL SIDEWALK DROP CURB DETAIL

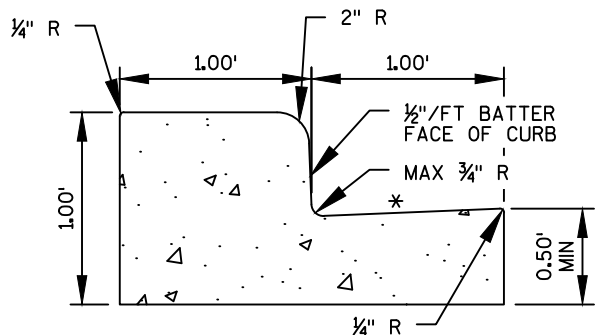

SEE S.D.D. "CONCRETE CURB, CONCRETE CURB & GUTTER AND TIES" FOR ADDITIONAL INFORMATION

*SLOPE VARIES TO MATCH ADJACENT PAVEMENT OR CURB AS APPROPRIATE. FIELD VERIFY NECESSARY SLOPE. SEE ADDITIONAL SIDEWALK DROP CURB DETAIL FOR RESTRICTIONS AT SIDEWALK CROSSING LOCATIONS.

CONCRETE CURB AND GUTTER 24-INCH
TYPE D SPECIAL - PHILLIPS BLVD/US-12

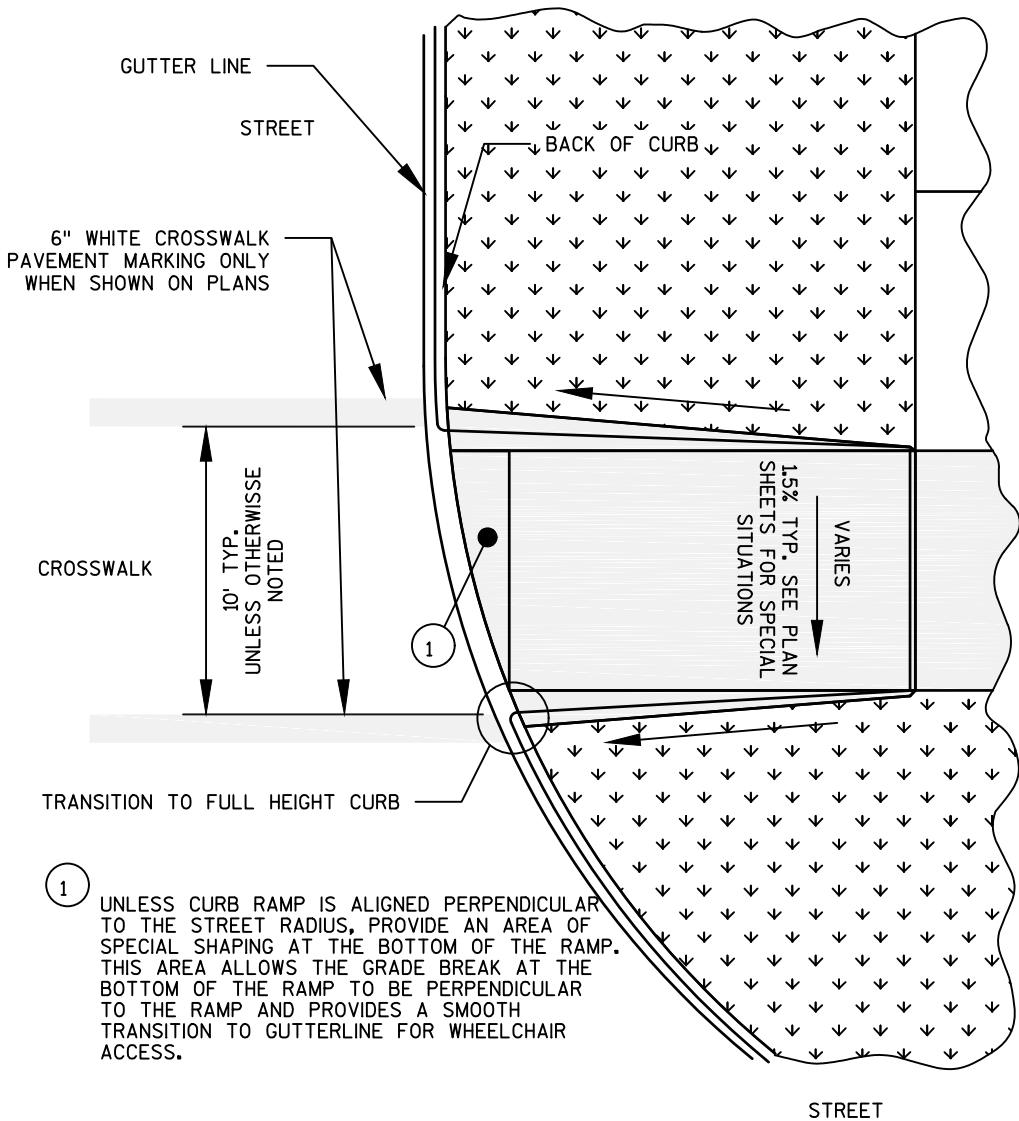

- ① UNLESS CURB RAMP IS ALIGNED PERPENDICULAR TO THE STREET RADIUS, PROVIDE AN AREA OF SPECIAL SHAPING AT THE BOTTOM OF THE RAMP. THIS AREA ALLOWS THE GRADE BREAK AT THE BOTTOM OF THE RAMP TO BE PERPENDICULAR TO THE RAMP AND PROVIDES A SMOOTH TRANSITION TO GUTTERLINE FOR WHEELCHAIR ACCESS.

TYPICAL CROSSWALK MARKING DETAIL

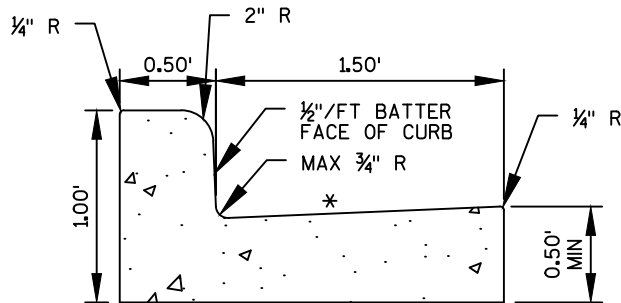

SEE S.D.D. "CONCRETE CURB, CONCRETE CURB & GUTTER AND TIES" FOR ADDITIONAL INFORMATION

*SLOPE VARIES TO MATCH ADJACENT PAVEMENT OR CURB AS APPROPRIATE. FIELD VERIFY NECESSARY SLOPE. SEE ADDITIONAL SIDEWALK DROP CURB DETAIL FOR RESTRICTIONS AT SIDEWALK CROSSING LOCATIONS.

CONCRETE CURB AND GUTTER 24-INCH
TYPE D

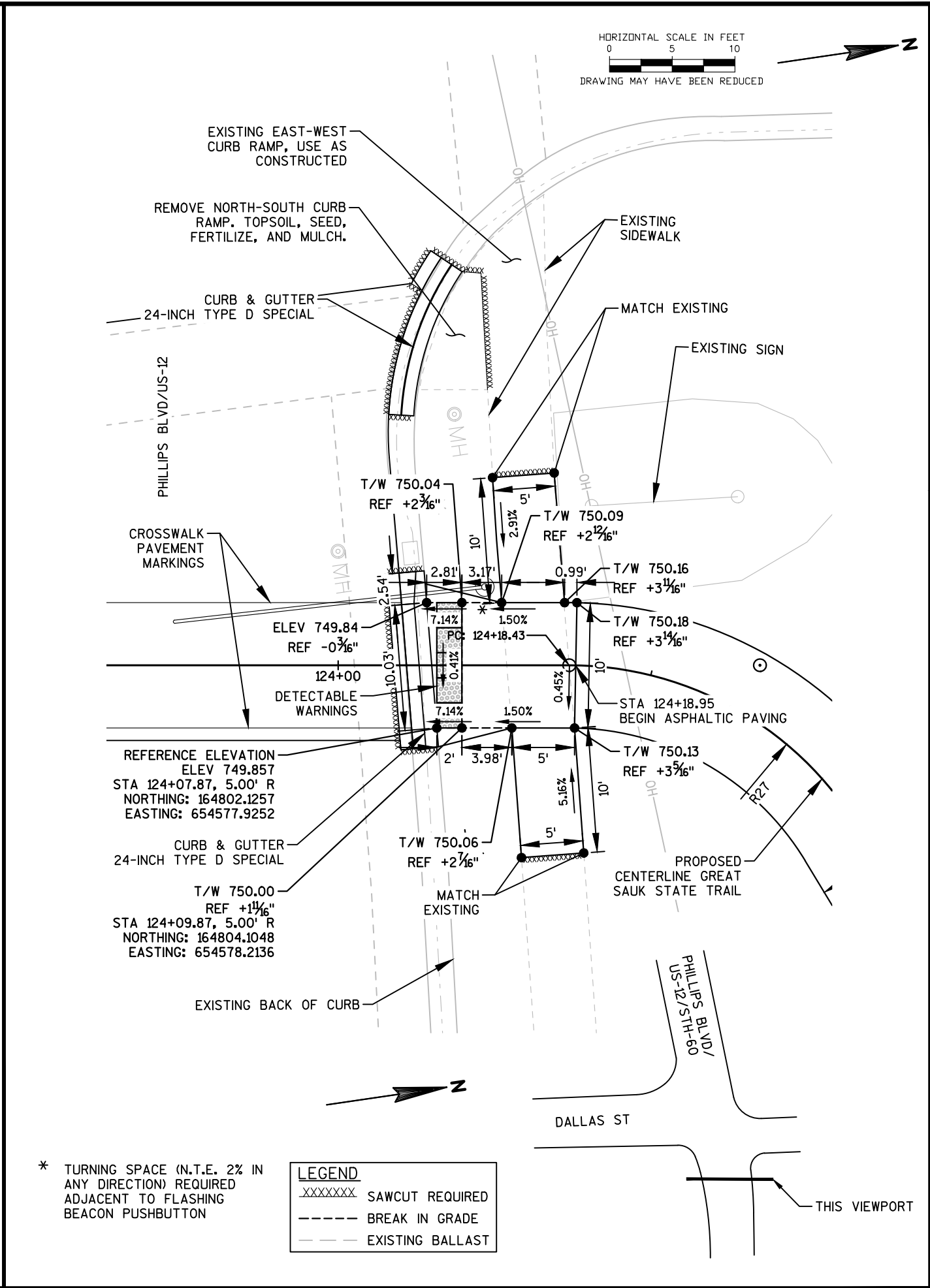
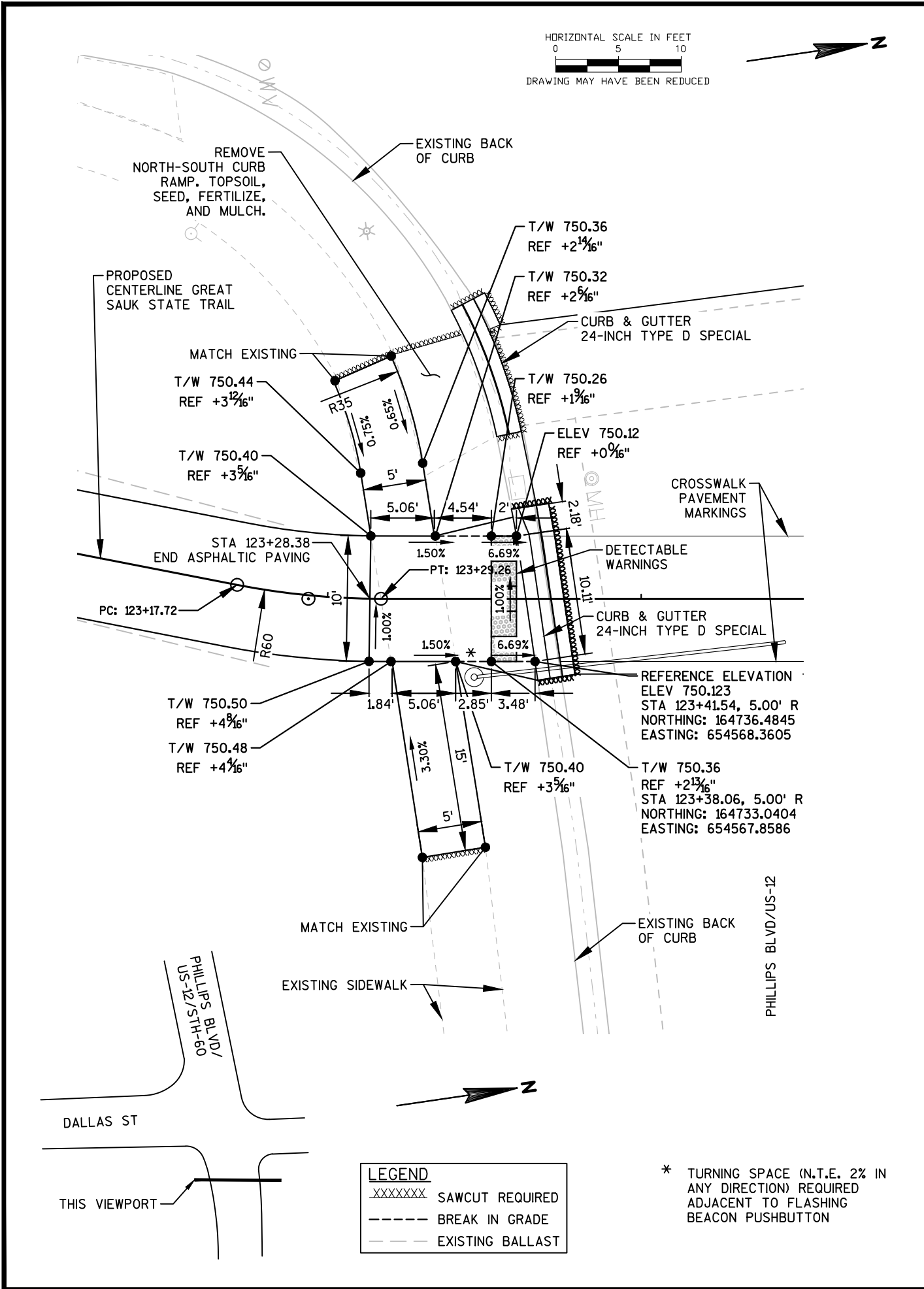

JEWELL
associates engineers, inc.

Engineers - Surveyors - Architects

560 Sunrise Drive
Spring Green, WI 53588
phone: 608-588-7484
fax: 608-588-9322

THIS DOCUMENT, THE IDEAS AND DESIGNS INCORPORATED HEREIN AS AN INSTRUMENT OF SERVICE, IS THE PROPERTY OF JEWELL ASSOCIATES ENGINEERS, INC. AND IS NOT TO BE USED IN WHOLE OR IN PART WITHOUT PRIOR WRITTEN AUTHORIZATION OF JEWELL ASSOCIATES ENGINEERS, INC.

IIW, P.C.

iiw

ARCHITECTURE
CIVIL ENGINEERING
CONSTRUCTION SERVICES
ENVIRONMENTAL ENGINEERING
LAND SURVEYING
MUNICIPAL ENGINEERING
STRUCTURAL ENGINEERING
TRANSPORTATION ENGINEERING
INTEGRITY.EXPERTISE.SOLUTIONS

Great Sauk State Trail Prairie Du Sac/Sauk City Unit Sauk County, Wisconsin

Date
6/22/2017

Date	Revision

Drawing Name
**Construction
Details
Phillips Blvd/US-12
Curb Ramps**

Sheet Number
C4.6
Project Number
16217

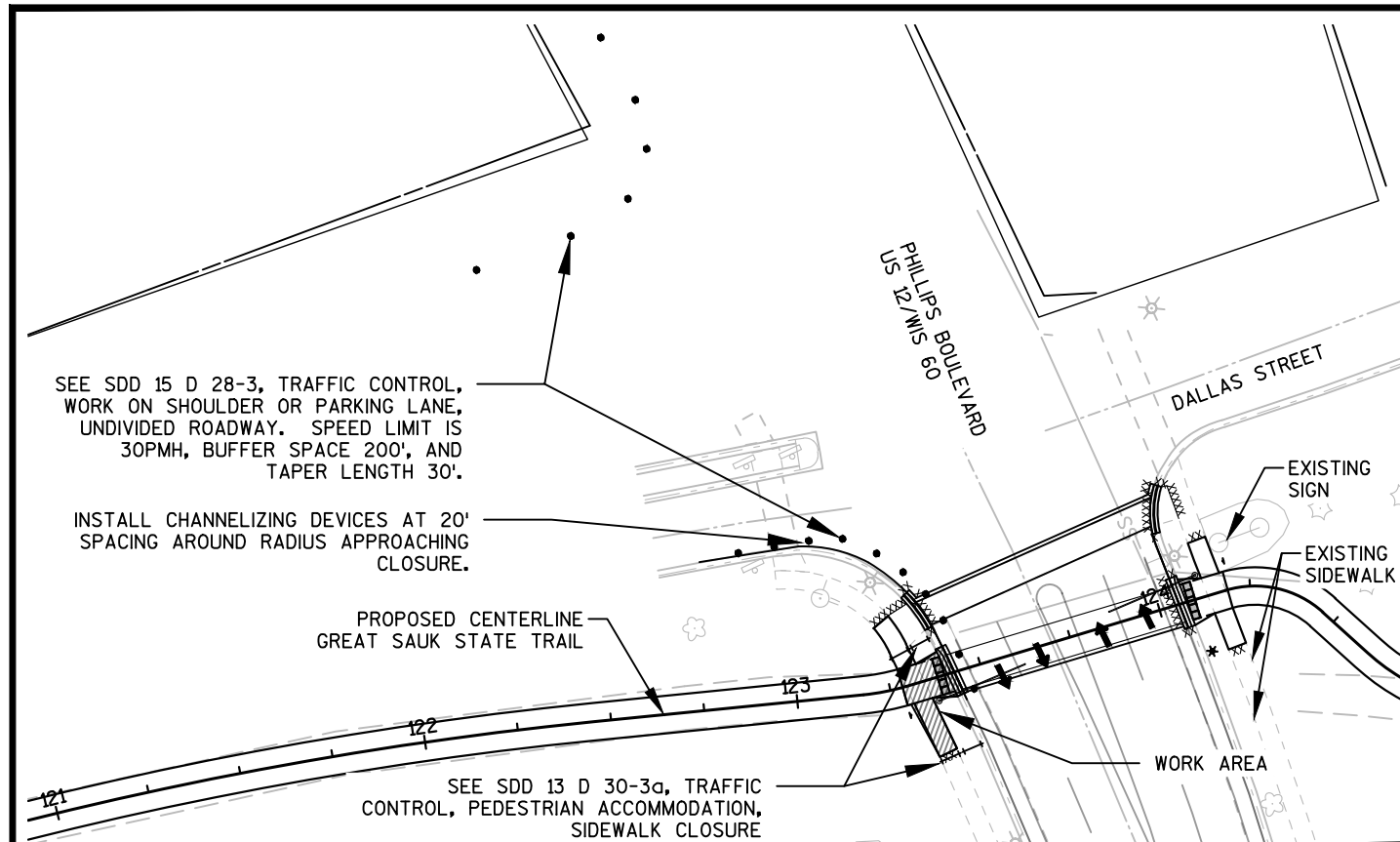

STAGE 1

DO NOT REMOVE EXISTING CROSSWALK OR EXISTING CURB RAMPS UNTIL NEW CROSSWALK IS OPERATIONAL. INSTALL SDD 13 D 30-3a, TRAFFIC CONTROL, PEDESTRIAN ACCOMMODATION, DETAIL SIDEWALK CLOSURE ON SOUTH SIDE OF INTERSECTION. DIRECT PEDESTRIANS TO USE EXISTING CROSSWALK AND NORTH SIDE OF US 12 BY INSTALLING R9-11 'SIDEWALK CLOSED AHEAD, CROSS HERE' AT FRANKLIN ST ON SOUTH SIDE OF US 12, AND AT DALLAS STREET ON SOUTH SIDE OF US 12.

INSTALL SDD 15 D 28-3, TRAFFIC CONTROL, WORK ON SHOULDER OR PARKING LANE, UNDIVIDED ROADWAY DURING CONSTRUCTION OF CURB RAMPS. PLACE W21-5 OR W05-1 SHOWN IN SDD AT DALLAS STREET ON WESTSIDE OF INTERSECTION AND W20-1A APPROXIMATELY 200' PRIOR TO INTERSECTION.

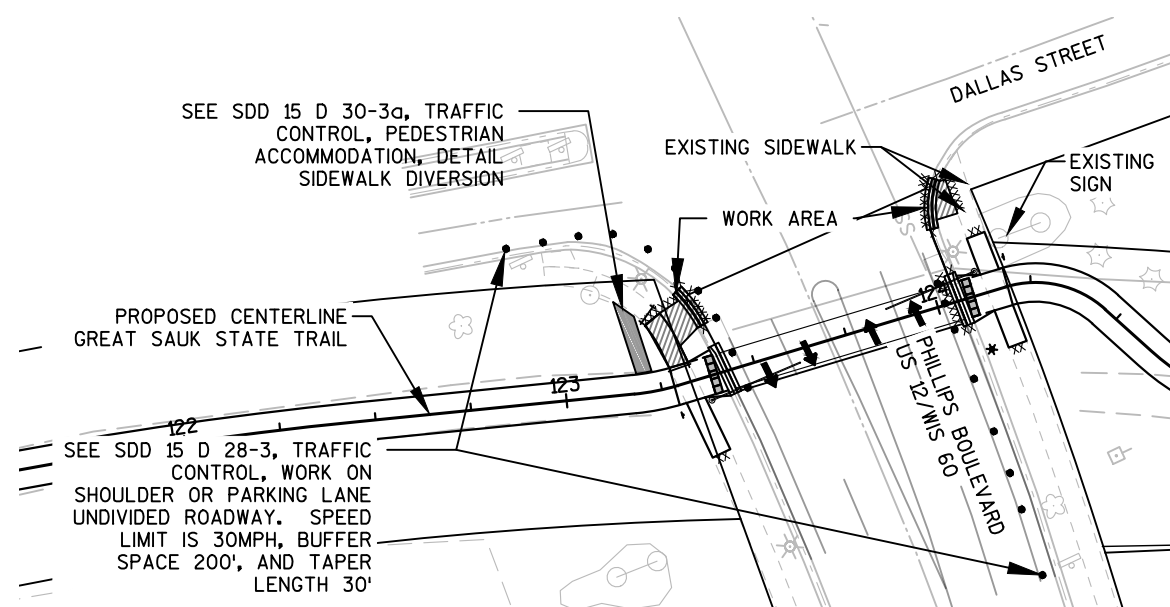

STAGE 3

REMOVE EXISTING CROSSWALK AND EXISTING CURB RAMPS.

INSTALL SDD 15 C 12-5 TRAFFIC CONTROL FOR LANE CLOSURE WITH FLAGGING OPERATION
FOR MILLING AND ASPHALTIC PAVEMENT PATCH, TO ACCOMPLISH REMOVAL OF EXISTING
CROSSWALK MARKINGS.

INSTALL SDD 15 D 28-3, TRAFFIC CONTROL, WORK ON SHOULDER OR PARKING LANE, UNDIVIDED ROADWAY DURING REMOVAL OF EXISTING CURB RAMPS. PLACE W21-5 OR W05-1 AND W20-1A SHOWN IN SDD AS INDICATED IN STAGES 1 & 2.

INSTALL SDD 15 D 30-3a, TRAFFIC CONTROL, PEDESTRIAN ACCOMMODATION, DETAIL
SIDEWALK DIVERSION ON SOUTH SIDE OF INTERSECTION.

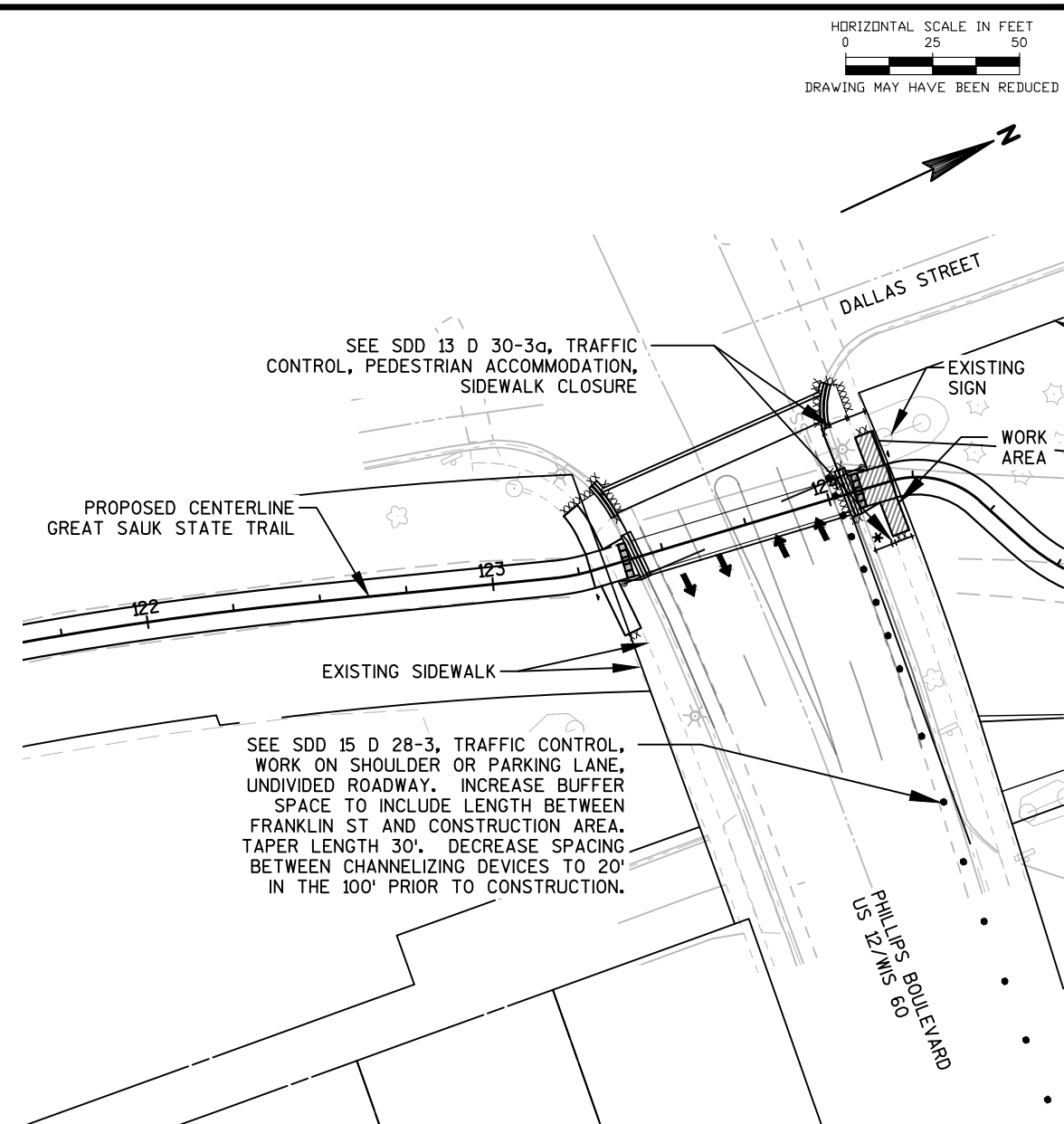

STAGE 2

DO NOT REMOVE EXISTING CROSSWALK OR EXISTING CURB RAMPS UNTIL NEW CROSSWALK IS OPERATIONAL. INSTALL SDD 13 D 30-3g, TRAFFIC CONTROL, PEDESTRIAN ACCOMMODATION, DETAIL SIDEWALK CLOSURE ON NORTH SIDE OF INTERSECTION. DIRECT PEDESTRIANS TO USE EXISTING CROSSWALK AND SOUTH SIDE OF US 12 BY INSTALLING R9-11 'SIDEWALK CLOSED AHEAD, CROSS HERE' AT FRANKLIN ST ON NORTH SIDE OF INTERSECTION AND AT DALLAS ST ON NORTH SIDE OF INTERSECTION.

INSTALL SDD 15 D 28-3, TRAFFIC CONTROL, WORK ON SHOULDER OR PARKING LANE, UNDIVIDED ROADWAY DURING CONSTRUCTION OF CURB RAMPS. PLACE W21-5 OR W05-1 SHOWN IN SDD AT FRANKLIN ST ON EASTSIDE OF INTERSECTION AND W20-1A APPROXIMATELY 200' PRIOR TO INTERSECTION.

LEGEND
XXXXXXX SAWCUT REQUIRED
--- EXISTING BALLAST

HORIZONTAL SCALE IN FEET
0 10 20
DRAWING MAY HAVE BEEN REDUCED

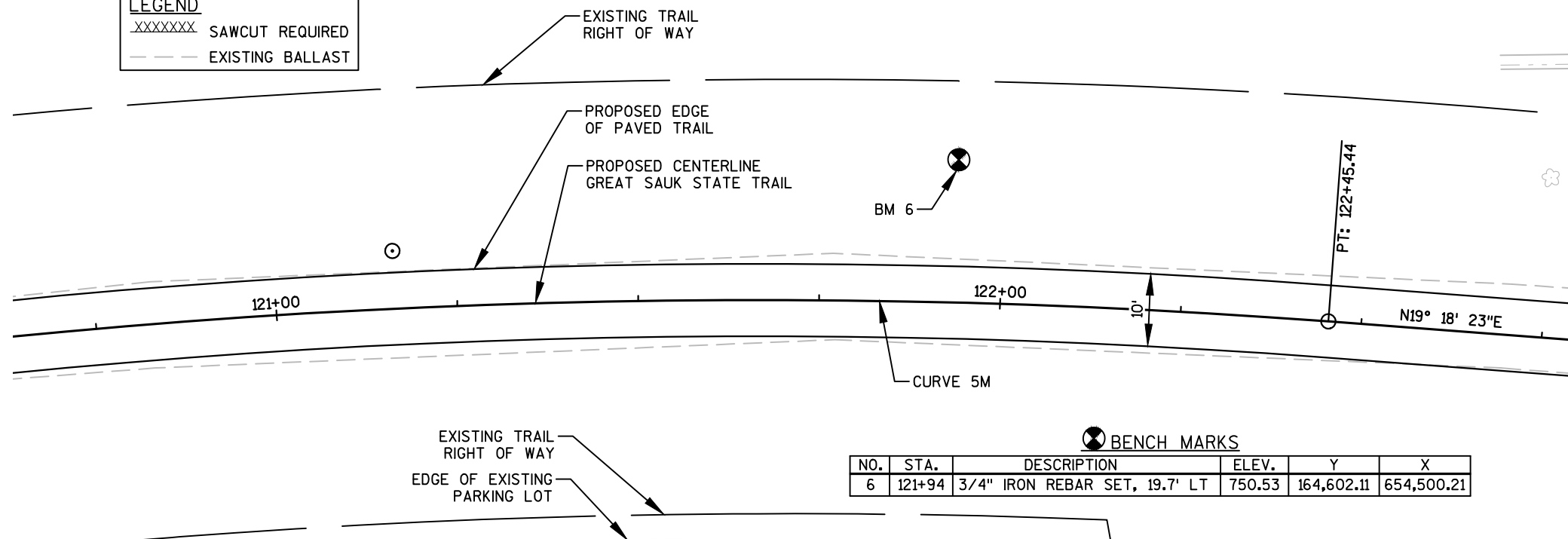

BENCH MARKS

NO.	STA.	DESCRIPTION	ELEV.	Y	X
6	121+94	3/4" IRON REBAR SET, 19.7' LT	750.53	164,602.11	654,500.21

LEGEND
XXXXXXX SAWCUT REQUIRED
--- EXISTING BALLAST

HORIZONTAL SCALE IN FEET
0 10 20
DRAWING MAY HAVE BEEN REDUCED

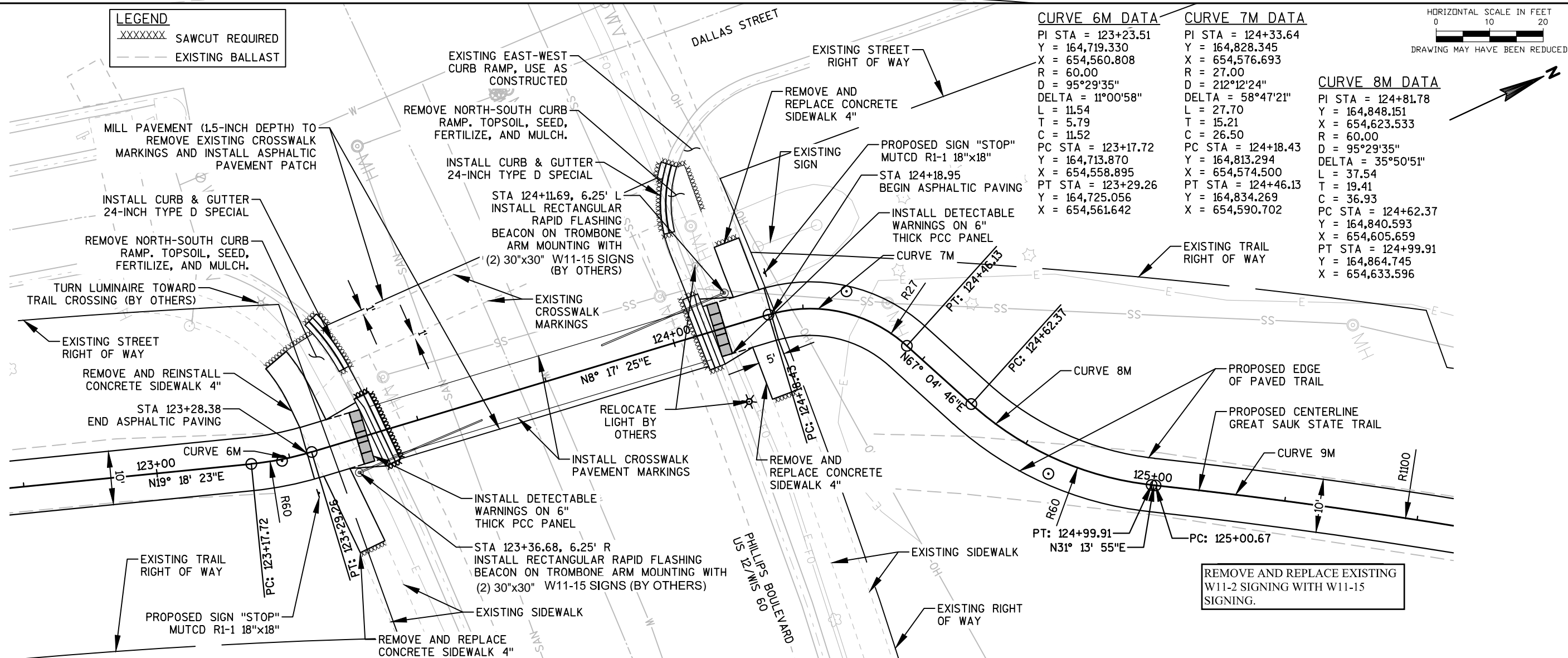

CURVE 6M DATA

PI STA = 123+23.51
Y = 164,719.330
X = 654,560.808
R = 60.00
D = 95°29'35"
DELTA = 11°00'58"
L = 11.54
T = 5.79
C = 11.52
PC STA = 123+17.72
Y = 164,713.870
X = 654,558.895
PT STA = 123+29.26
Y = 164,725.056
X = 654,561.642

CURVE 7M DATA

PI STA = 124+33.64
Y = 164,828.345
X = 654,576.693
R = 27.00
D = 212°12'24"
DELTA = 58°47'21"
L = 27.70
T = 15.21
C = 26.50
PC STA = 124+18.43
Y = 164,813.294
X = 654,574.500
PT STA = 124+46.13
Y = 164,834.269
X = 654,590.702

CURVE 8M DATA

PI STA = 124+81.78
Y = 164,848.151
X = 654,623.533
R = 60.00
D = 95°29'35"
DELTA = 35°50'51"
L = 37.54
T = 19.41
C = 36.93
PC STA = 124+62.37
Y = 164,840.593
X = 654,605.659
PT STA = 124+99.91
Y = 164,864.745
X = 654,633.596

JEWELL
associates engineers, inc.
Engineers - Surveyors - Architects

560 Sunrise Drive
Spring Green, WI 53588
phone: 608-588-7484
fax: 608-588-9322

THIS DOCUMENT, THE IDEAS AND DESIGNS INCORPORATED
HEREIN AS AN INSTRUMENT OF SERVICE, IS THE PROPERTY
OF JEWELL ASSOCIATES ENGINEERS, INC. AND IS NOT TO BE
USED IN WHOLE OR IN PART WITHOUT PRIOR WRITTEN
AUTHORIZATION OF JEWELL ASSOCIATES ENGINEERS, INC.

IIW, P.C.

iiw

ARCHITECTURE
CIVIL ENGINEERING
CONSTRUCTION SERVICES
ENVIRONMENTAL ENGINEERING
LAND SURVEYING
MUNICIPAL ENGINEERING
STRUCTURAL ENGINEERING
TRANSPORTATION ENGINEERING
INTEGRITY. EXPERTISE. SOLUTIONS.

**Great Sauk State Trail
Prairie Du Sac/Sauk City Unit
Sauk County, Wisconsin**

Date
6/21/2017

Date Revision

Drawing Name

**Plan Views
Mainline Trail**

Sheet Number

C6.4

Project Number

16217

