

GENERAL NOTES

DRAWINGS SHALL NOT BE SCALED.
BAR STEEL REINFORCEMENT SHALL BE EMBEDDED 2" CLEAR UNLESS SHOWN OR NOTED OTHERWISE.
DIMENSIONS SHOWN ARE BASED ON THE ORIGINAL PLANS.
THE FIRST DIGIT OF A THREE DIGIT BAR NO. OR THE FIRST TWO DIGITS OF A FOUR DIGIT BAR NO. SIGNIFIES THE BAR SIZE.
ALL CONCRETE REMOVAL SHALL BE DEFINED BY A 1" DEEP SAW CUT UNLESS SHOWN OR NOTED OTHERWISE.
PROTECTIVE SURFACE TREATMENT SHALL BE APPLIED TO THE ENTIRE TOP SURFACE OF THE NEW DECK.
AT ABUTMENTS ALL SPACES EXCAVATED AND NOT OCCUPIED BY THE NEW STRUCTURE SHALL BE BACKFILLED WITH BACKFILL STRUCTURE TYPE A.
UTILIZE EXISTING BAR STEEL REINFORCEMENT WHERE SHOWN AND EXTEND 24 BAR DIAMETERS INTO NEW WORK.
JOINT FILLER SHALL CONFORM TO THE REQUIREMENTS OF A.A.S.H.T.O. DESIGNATION M 153, TYPE I, II OR III OR A.A.S.H.T.O. DESIGNATION M 213.
PIGMENTED SURFACE SEALER IS TO BE APPLIED TO THE INSIDE FACES AND TOP SURFACES OF THE PARAPETS PER MANUFACTURERS RECOMMENDATIONS. THE COLOR OF THE PIGMENTED SURFACE SEALER SHALL BE WHITE.
THE CONCRETE APPROACH SLABS AT THE ABUTMENTS WILL HAVE A THICKNESS OF 1'-0".
THE CONTRACTOR SHALL SUPPLY A NEW NAME PLATE IN ACCORDANCE WITH SECTION 502.3.11 OF THE STANDARD SPECIFICATIONS AND THE STANDARD DETAIL DRAWINGS. NAME PLATE TO SHOW ORIGINAL CONSTRUCTION YEAR OF 1976.
VARIATIONS TO THE NEW GRADE LINE OVER 1/4" MUST BE SUBMITTED BY THE FIELD ENGINEER TO THE STRUCTURES DESIGN SECTION FOR REVIEW.

*ANCHOR ASSEMBLY FOR THRIE BEAM TYPE GUARDRAIL.
○ DENOTES WING NUMBER.

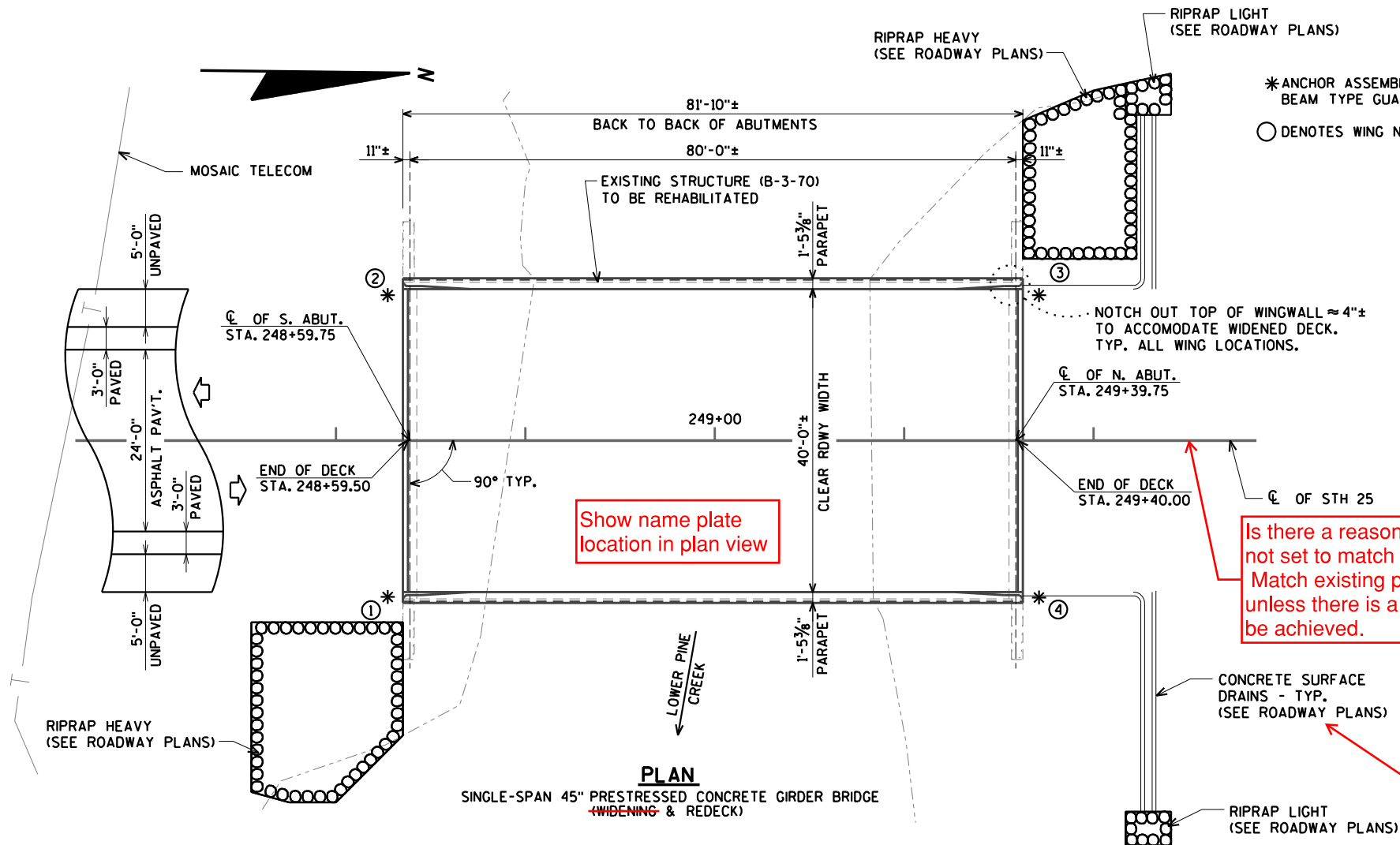

Show name plate location in plan view

Is there a reason the stationing was not set to match the existing plans? Match existing plan stationing unless there is a reason this can't be achieved.

SSR states that surface drains are at NW & SW corners. Plans show NW & NE corners. Please verify.

FOR TYPICAL SECTIONS AND DESIGN DATA SEE SHEET 2

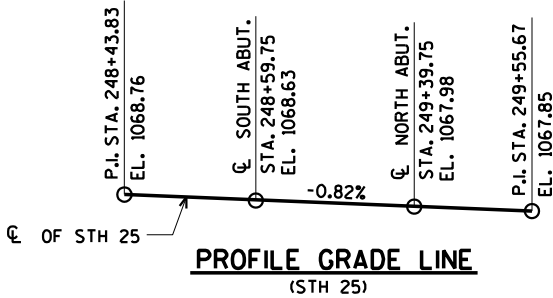
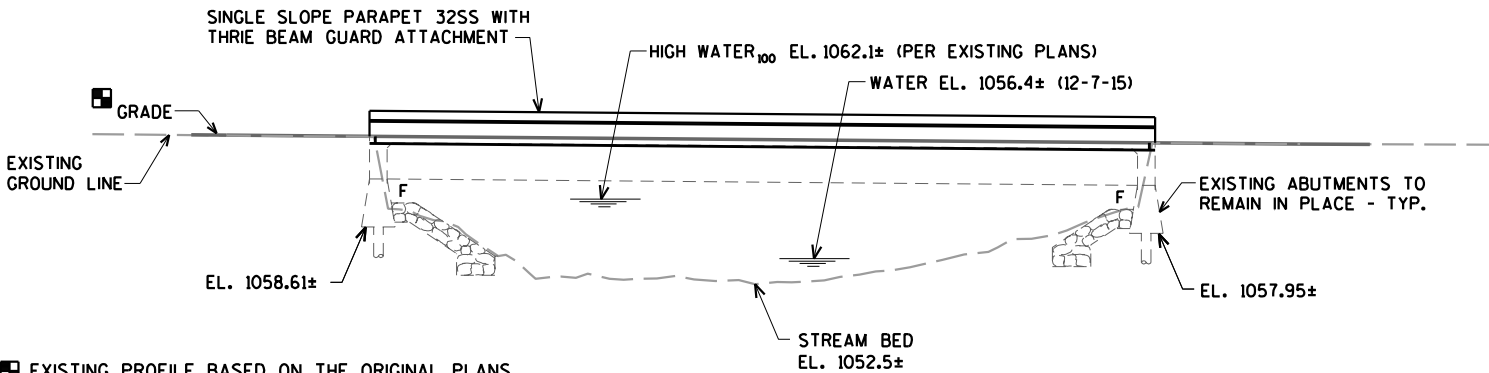

BENCH MARK:
WISDOT BRONZE DISK "6C05 2005" IN NW WING
STA. 249+40, 22' LT.
EL. 1067.49

LIST OF DRAWINGS

1. PRELIMINARY PLAN
2. TYPICAL SECTIONS AND QUANTITIES

Reviewed By
LMK 09/26/2016

BRIDGE OFFICE CONTACT:
WILLIAM DREHER
(608)-266-8489
CONSULTANT CONTACT:
CHRIS MCMAHON
(715)-834-3161

NO.	DATE	REVISION	BY
ORIGINAL PLANS PREPARED BY AYRES ASSOCIATES 3433 Oakwood Hills Parkway Eau Claire, WI 54701 www.AyresAssociates.com			
STATE OF WISCONSIN DEPARTMENT OF TRANSPORTATION			
ACCEPTED		CHIEF STRUCTURES DESIGN ENGINEER	DATE
STRUCTURE B-3-70			
STH 25 OVER LOWER PINE CREEK			
COUNTY	BARRON	TOWN/CITY/VILLAGE	DALLAS
DESIGN SPEC.	REHABILITATION	N/A	
DESIGNED BY	CBM	DESIGN CK'D.	DRAWN BY CLS PLANS CK'D.
PRELIMINARY PLAN			SHEET 1 OF 2

ecpdf.plt
42-1015 gp PREL.dgn

DATE: DATE:
CHECKED BY: BACK CHECKED BY:
CORRECTED BY:

TOTAL ESTIMATED QUANTITIES

BID ITEM NUMBER	BID ITEMS	UNIT	TOTAL
203.0210.S	ABATEMENT OF ASBESTOS CONTAINING MATERIAL B-3-70	LS	1
203.0600.S	REMOVING OLD STRUCTURE OVER WATERWAY WITH MINIMAL DEBRIS STATION 248+95.75	LS	1
206.1000	EXCAVATION FOR STRUCTURES BRIDGES B-3-70	LS	1
210.1500	BACKFILL STRUCTURE TYPE A	TON	
502.0100	CONCRETE MASONRY BRIDGES	CY	
502.3200	PROTECTIVE SURFACE TREATMENT	SY	
502.3210	PIGMENTED SURFACE SEALER	SY	
502.4205	ADHESIVE ANCHORS NO. 5 BAR	EACH	
505.0600	BAR STEEL REINFORCEMENT HS COATED STRUCTURES	LB	
506.4000	STEEL DIAPHRAGMS B-3-70	EACH	
509.1500	CONCRETE SURFACE REPAIR	SF	
516.0500	RUBBERIZED MEMBRANE WATERPROOFING	SY	
614.0150	ANCHOR ASSEMBLIES FOR STEEL PLATE BEAM GUARD	EACH	
	NON-BID ITEMS		
	FILLER	SIZE	1/2"

UNDISTRIBUTED FOR ABUTMENTS AND DIAPHRAGMS AS DIRECTED BY THE ENGINEER IN THE FIELD.

DESIGN DATA

LIVE LOAD:

DESIGN LOADING: HS-20
INVENTORY RATING: HS-
OPERATING RATING: HS-
WISCONSIN STANDARD PERMIT VEHICLE (WIS-SPV) = KIPS

MATERIAL PROPERTIES:

CONCRETE MASONRY BRIDGES $f'_c = 4,000$ p.s.i.
HIGH STRENGTH BAR STEEL REINFORCEMENT (GRADE 60) $f_y = 60,000$ p.s.i.

TRAFFIC DATA:

A.D.T. = 2,400 (2018)
A.D.T. = 2,800 (2038)
R.D.S. = 55 M.P.H.

Structure is designed for a future wearing surface of 20 pounds per square foot.

LONG. CONST. JOINT (AT CROWN POINT)
SEAL WITH CRACK SEALER
PER SECTION 502.3.13 OF STD. SPEC.

3/4" V - GROOVE, EXTEND
V-GROOVE TO 6" FROM FRONT
FACE OF ABUTMENTS - TYP.

ORIGINAL PLANS PREPARED BY
AYRES ASSOCIATES
3433 Oakwood Hills Parkway
Eau Claire, WI 54701
www.AyresAssociates.com

NO.	DATE	REVISION	BY
STATE OF WISCONSIN DEPARTMENT OF TRANSPORTATION			
STRUCTURE B-3-70			
DRAWN BY		CLS	PLANS CK'D.
TYPICAL SECTIONS AND QUANTITIES			SHEET 2 OF 2

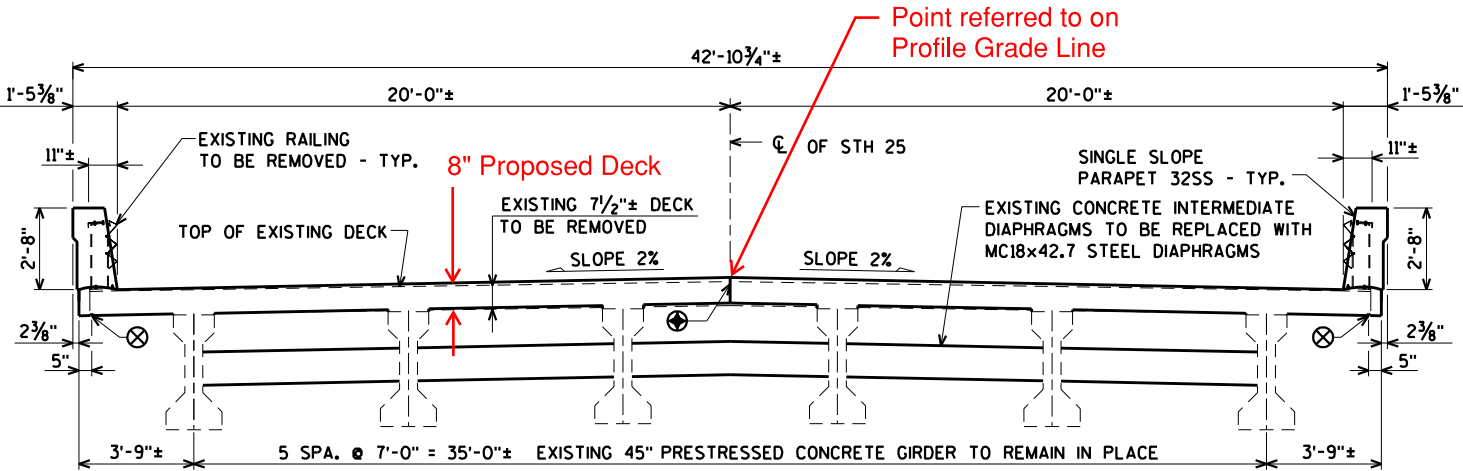

CROSS SECTION THRU ROADWAY
(LOOKING NORTH)

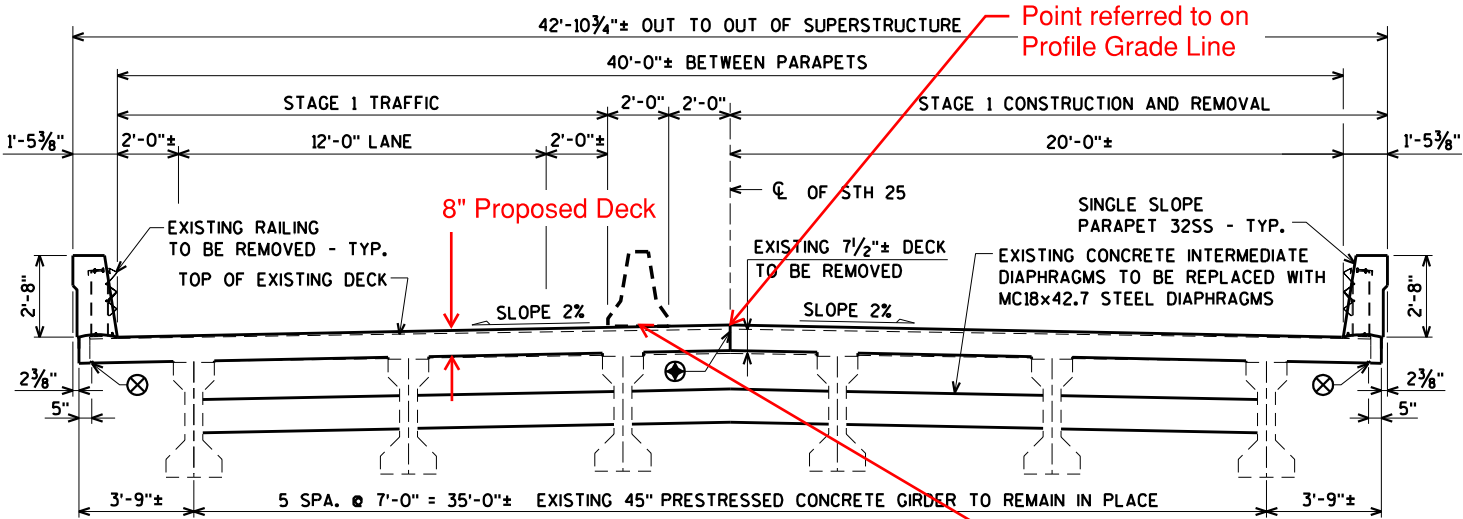

CROSS SECTION THRU ROADWAY
STAGE 1 TRAFFIC
(LOOKING NORTH)

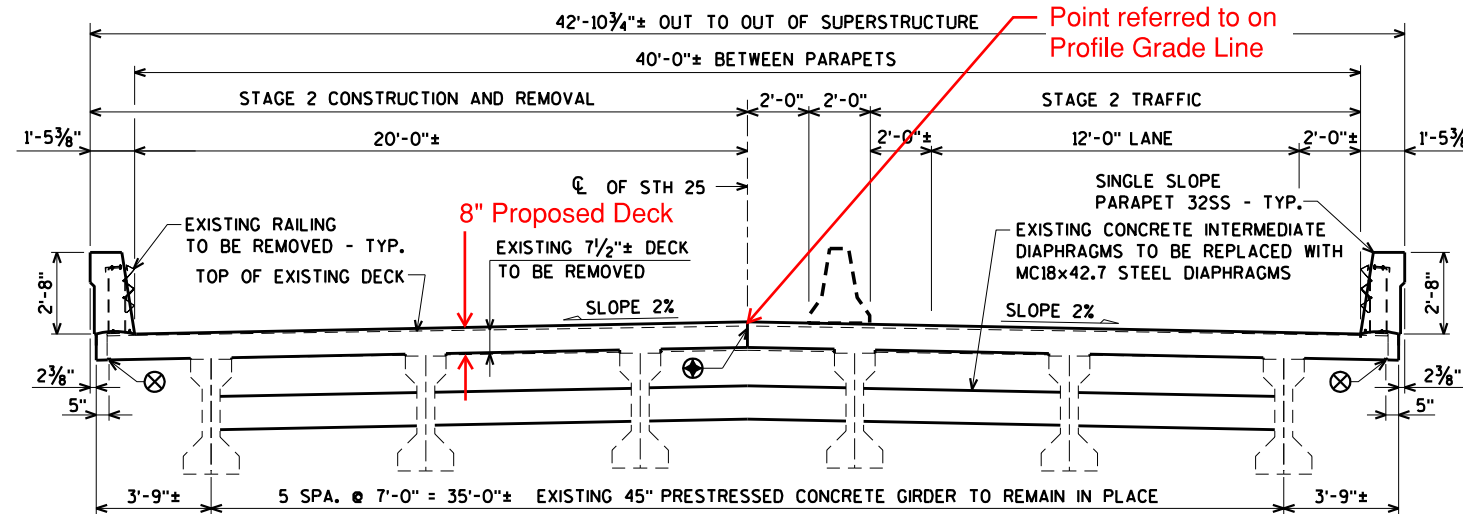

CROSS SECTION THRU ROADWAY
STAGE 2 TRAFFIC
(LOOKING NORTH)

ecpdf.plt
42-1015 gp PREL.dgn