

PROJECT LOCATION MAP

PROJECT I.D. 1050-01-11(81)
 CHIPPEWA FALLS - ABBOTSFORD
 STILLSON CREEK TO CARDINAL AVENUE
 STH 29
 CHIPPEWA & CLARK COUNTY



PROJECT LOCATION



STRUCTURE B-09-031 (WB)

STRUCTURE B-09-171 (EB)

STRUCTURE B-09-035 (WB)

STRUCTURE B-09-174 (EB)

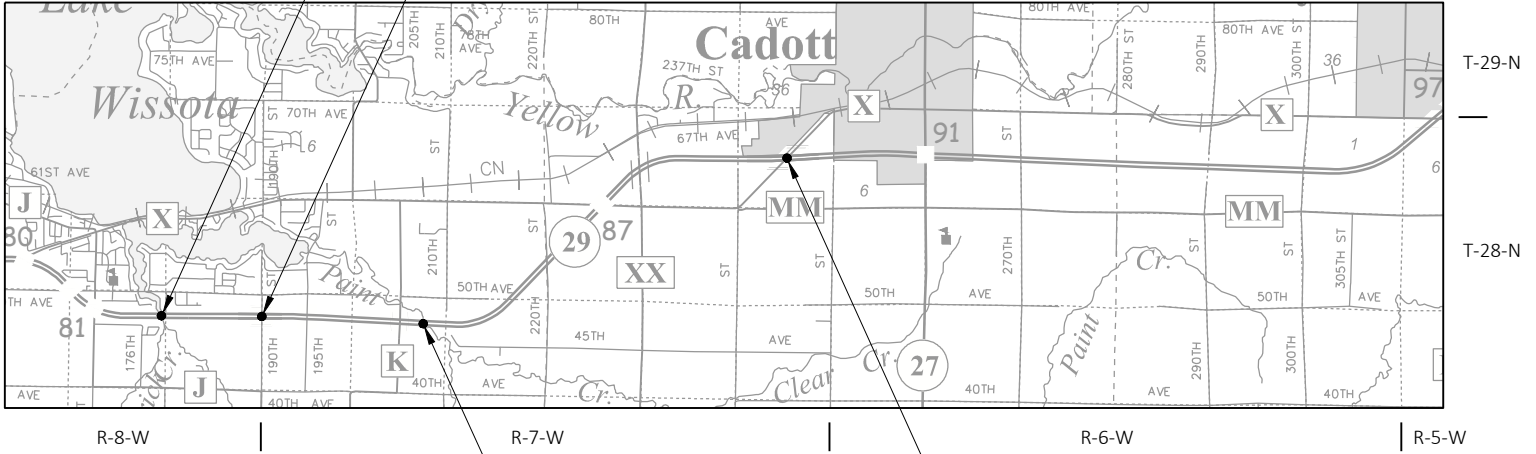

R-8-W

R-7-W

R-6-W

R-5-W

T-29-N

T-28-N

STRUCTURE B-09-038 (WB)

STRUCTURE B-09-175 (EB)

STRUCTURE B-09-177 (WB)

STRUCTURE B-09-020 (EB)

STRUCTURE B-10-178



R-4-W

R-3-W

R-2-W

R-1-W

T-29-N

T-28-N