

1. GENERAL PLAN & ELEVATION
2. TYPICAL SECTION, GENERAL NOTES & QUANTITIES

LIVE LOAD
DESIGN RATING: HS20
INVENTORY RATING: HS34
OPERATING RATING: HS77
WISCONSIN STANDARD PERMIT VEHICLE (WIS-SPV) = 250 KIPS

IH 43	BELOIT RD
AADT = 73,200 (2015)	AADT = 10,100 (2015)
AADT = 76,900 (2022)	AADT = 11,000 (2022)
AADT = 82,100 (2032)	AADT = 12,400 (2032)
AADT = 87,400 (2042)	AADT = 13,800 (2042)
RDS = 70 MPH	RDS = 40 MPH

TRAFFIC DIRECTION

LOCATION PER EXISTING PLANS AND MIN. CLEARANCE
TAKEN FROM HSI SYSTEM (4/25/2018)

EXISTING RATING DATA TAKEN FROM HSION
8/29/2019

BRIDGE OFFICE:
WILLIAM DREHER (608) 266-8489
CONSULTANT:
PAT CASHIN (414) 359-2300

NO.	DATE	REVISION	BY
<p>ORIGINAL PLANS PREPARED BY</p> <p>HNTB 11414 W. PARK PLACE MILWAUKEE, WI 53224 (414) 359-2300</p>			
<p>STATE OF WISCONSIN DEPARTMENT OF TRANSPORTATION</p>			
<p>ACCEPTED _____ CHIEF STRUCTURES DESIGN ENGINEER DATE _____</p>			
<p>STRUCTURE B-67-296</p>			
<p>IH 43 NB OVER BELOIT ROAD</p>			
<p>COUNTY WAUKESHA</p>		<p>TOWN/CITY/VILLAGE NEW BERLIN</p>	
<p>DESIGN SPEC. REHABILITATION N/A</p>			
<p>DESIGNED BY HDA</p>	<p>DESIGN CK'D. MPM</p>	<p>DRAWN BY HDA</p>	<p>PLANS CK'D. MPM</p>
<p>GENERAL PLAN & ELEVATION</p>			<p>SHEET 1 OF 2</p>

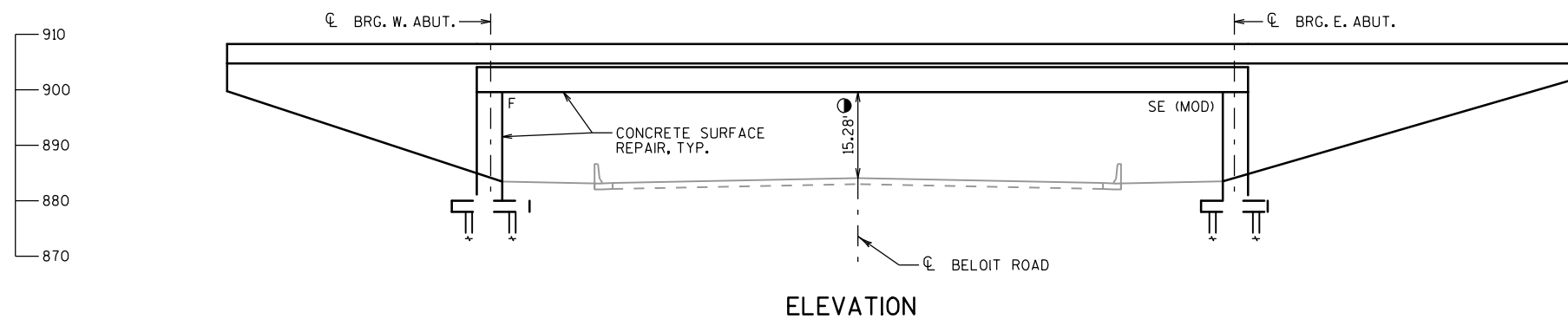
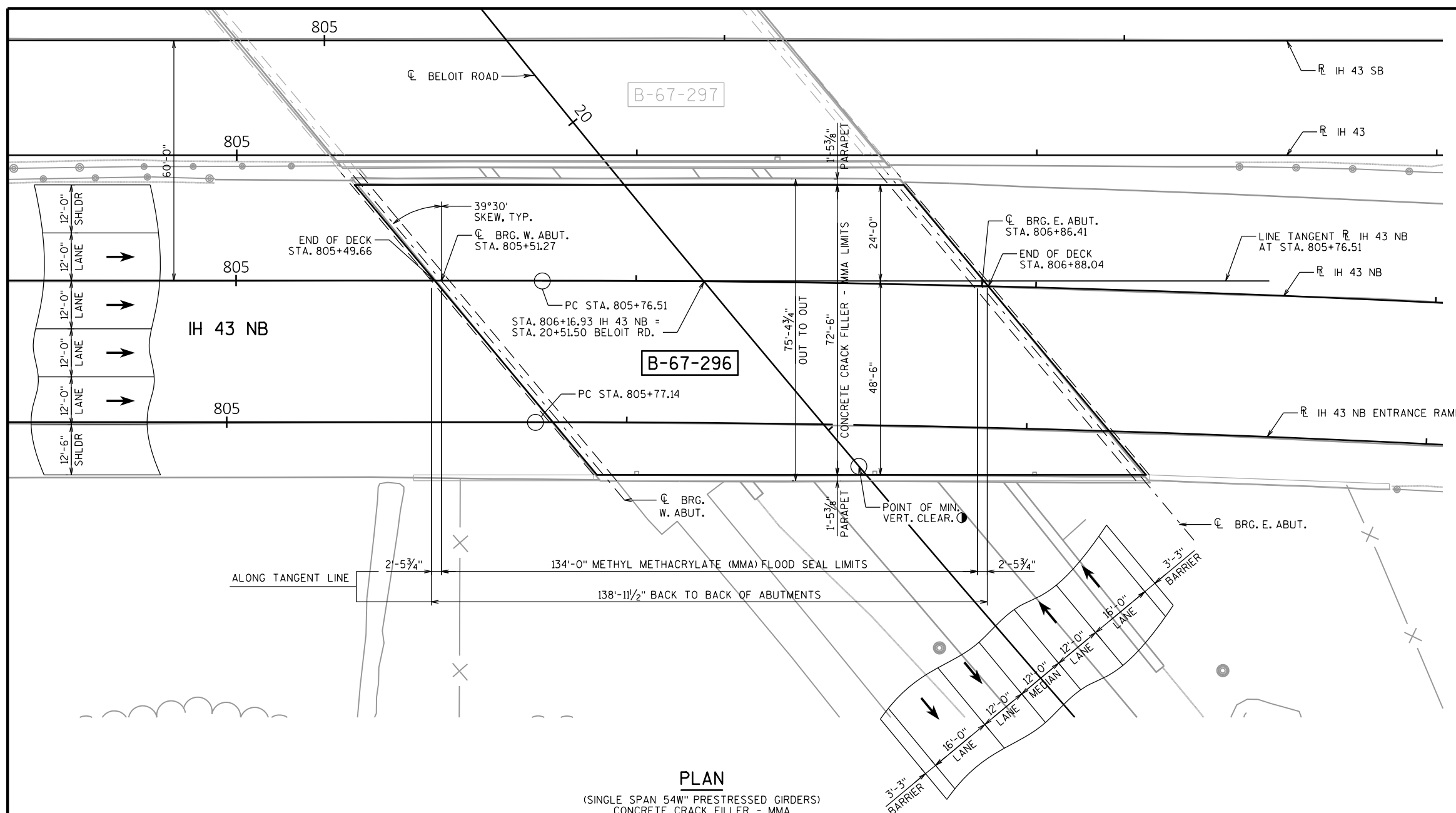

PRELIMINARY PLANS

GENERAL NOTES

DRAWINGS SHALL NOT BE SCALED.

DIMENSIONS SHOWN ARE BASED ON THE EXISTING STRUCTURE PLANS.

ALL DIMENSIONS ARE IN FEET AND INCHES UNLESS OTHERWISE NOTED. ALL STATIONS AND ELEVATIONS ARE IN FEET.

THE UTILITY INFORMATION SHOWN ON THESE DRAWINGS CONCERNING TYPE AND LOCATION IS NOT GUARANTEED TO BE ACCURATE OR ALL-INCLUSIVE. THE CONTRACTOR IS RESPONSIBLE FOR MAKING HIS OWN DETERMINATION AS TO TYPE AND LOCATION OF UTILITIES AS MAY BE NECESSARY TO AVOID DAMAGE.

DECK SURFACE PREPARATION IS INCLUDED IN THE BID ITEM "METHYL METHACRYLATE (MMA) FLOOD SEAL".

"CONCRETE SURFACE REPAIR" AREAS SHOWN IN THE QUANTITIES TABLE ARE BASED ON THE BRIDGE INSPECTION REPORT AND ARE APPROXIMATE. EXACT AREAS OF REPAIR WILL BE DETERMINED IN THE FIELD BY THE PROJECT ENGINEER.

BEVEL EDGES OF EXPOSED CONCRETE 3/4" MIN. OR MATCH EXISTING BEVELS UNLESS NOTED OTHERWISE.

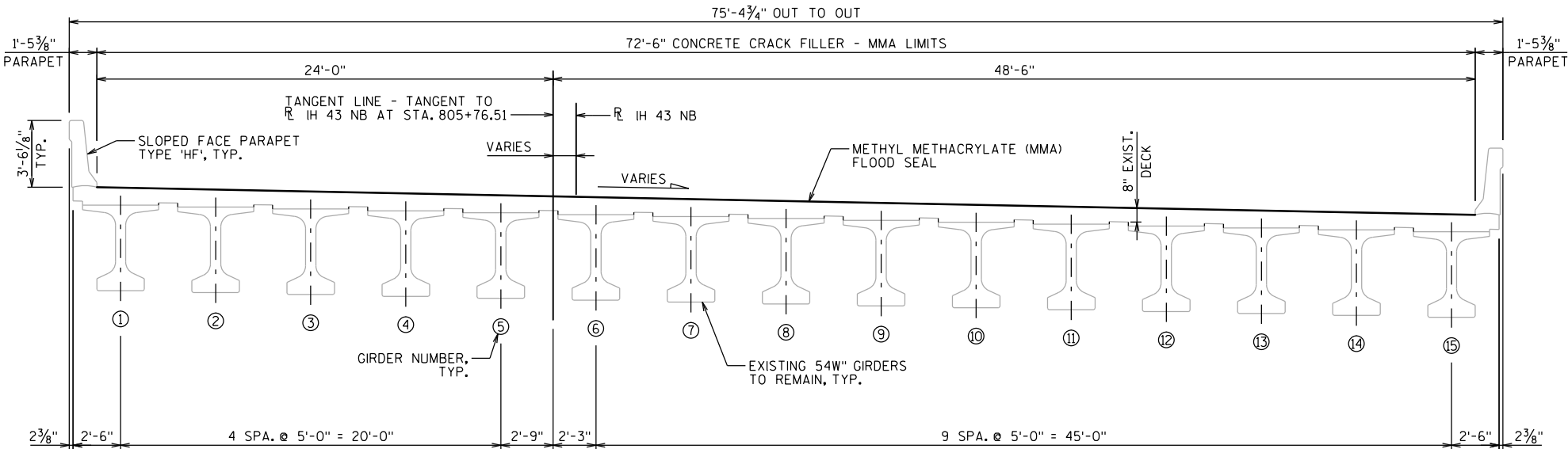

TYPICAL SECTION
(LOOKING EAST)

TOTAL ESTIMATED QUANTITIES

ITEM NO.	BID ITEM	UNIT	STAGE 1	STAGE 1	TOTAL
509.1500	CONCRETE SURFACE REPAIR	SF			X
SPV.0060.XXX	EMBEDDED GALVANIC ANODES ①	EACH			X ①
SPV.0180.XXX	METHYL METHACRYLATE (MMA) FLOOD SEAL	SY	X	X	X

ALL ITEMS ARE CATEGORY XXXX

① USE OF GALVANIC ANODES IN THE SUBSTRUCTURE TO BE DETERMINED DURING FINAL DESIGN

STATE PROJECT NUMBER
1090-35-70

PRELIMINARY PLANS

NO.	DATE	REVISION	BY
STATE OF WISCONSIN DEPARTMENT OF TRANSPORTATION			
STRUCTURE B-67-296			
DRAWN BY		HDA	PLANS CK'D. MPM
TYPICAL SECTION, GENERAL NOTES & QUANTITIES			SHEET 2 OF 2