

LIST OF DRAWINGS

1. GENERAL PLAN & ELEVATION
2. TYPICAL SECTION, GENERAL NOTES & QUANTITIES

LEGEND

- ➔ TRAFFIC DIRECTION
- Ⓧ WING NUMBER

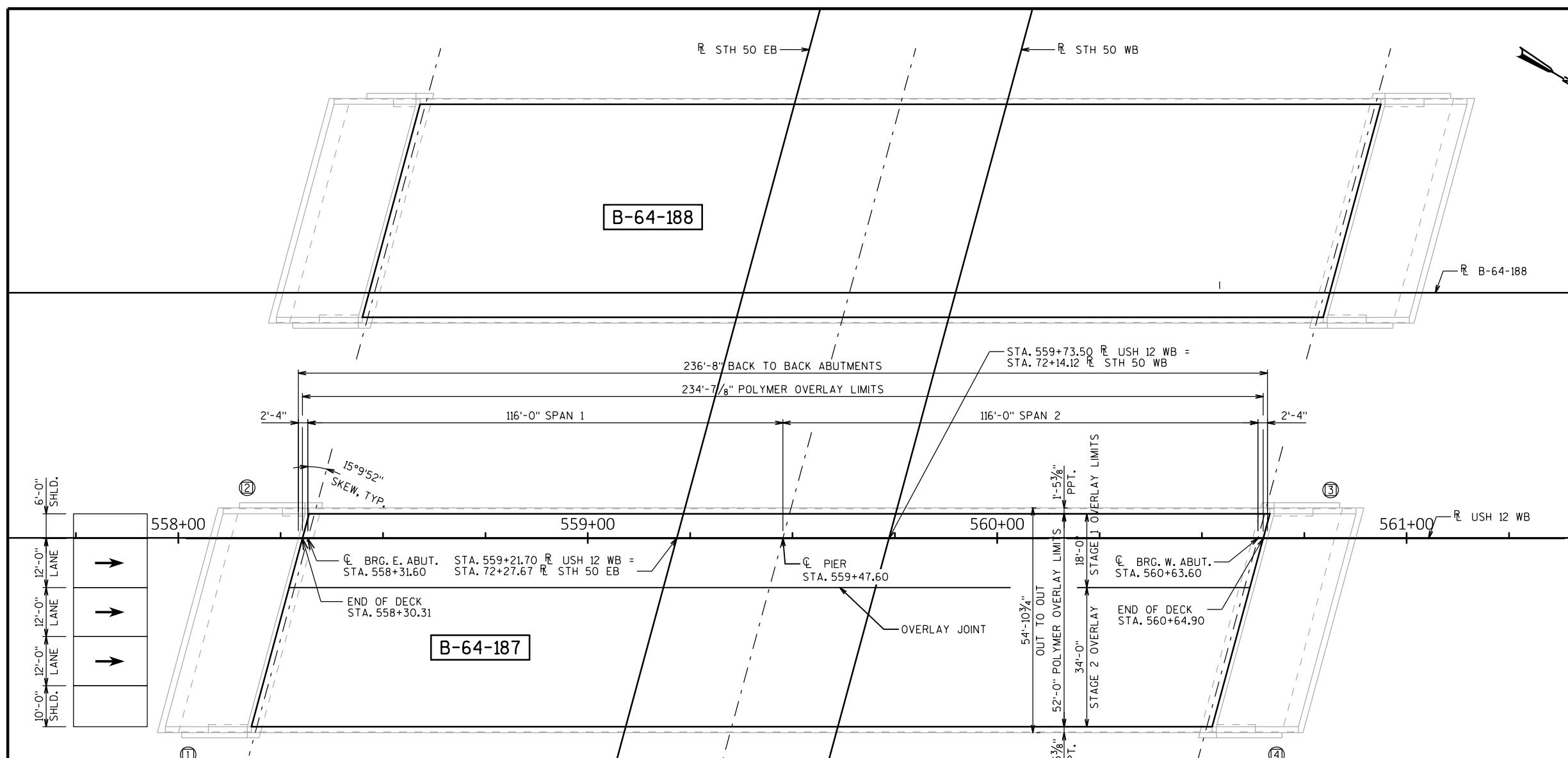

B-64-187

B-64-188

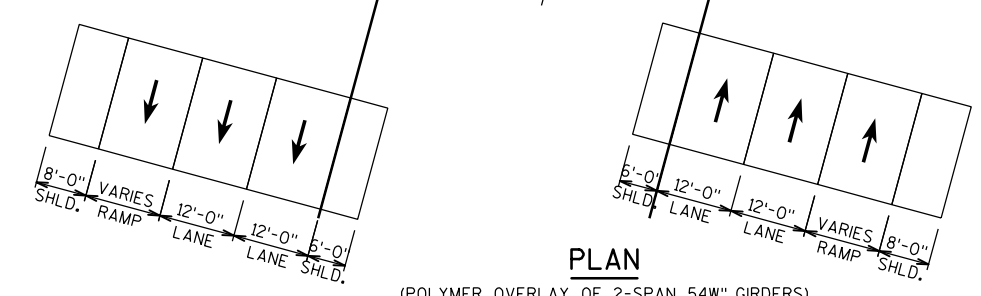

PLAN
(POLYMER OVERLAY OF 2-SPAN 54W" GIRDERS)

STRUCTURES DESIGN CONTACTS

BRIDGE OFFICE:
WILLIAM DREHER (608) 266-8489
CONSULTANT:
PAT CASHIN (414) 359-2300

NO.	DATE	REVISION	BY
ORIGINAL PLANS PREPARED BY			
HNTB		11414 W. PARK PLACE MILWAUKEE, WI 53224 (414) 359-2300	
STATE OF WISCONSIN DEPARTMENT OF TRANSPORTATION			
ACCEPTED _____		DATE _____	
CHIEF STRUCTURES DESIGN ENGINEER			
STRUCTURE B-64-187			
USH 12 WB OVER STH 50			
COUNTY	WALWORTH	VILLAGE	LAKE GENEVA
DESIGN SPEC. REHABILITATION N/A			
DESIGNED BY	HDA	DESIGN CK'D.	PJC
DRAWN BY	HDA	PLANS CK'D.	PJC
GENERAL PLAN & ELEVATION			SHEET 1 OF 2

TRAFFIC DATA

USH 12
EXISTING A.D.T. = 14,500 (2016)
FUTURE A.D.T. = 18,100 (2041)
R.D.S. = 70 M.P.H.

STH 50
EXISTING A.D.T. = 13,800 (2015)
FUTURE A.D.T. = 23,300 (2034)
R.D.S. = 50 M.P.H.

DESIGN DATA

LIVE LOAD
INVENTORY RATING: RF = X.XX
OPERATING RATING: RF = X.XX
MAXIMUM STANDARD PERMIT VEHICLE LOAD = XXX KIPS

PRELIMINARY PLANS

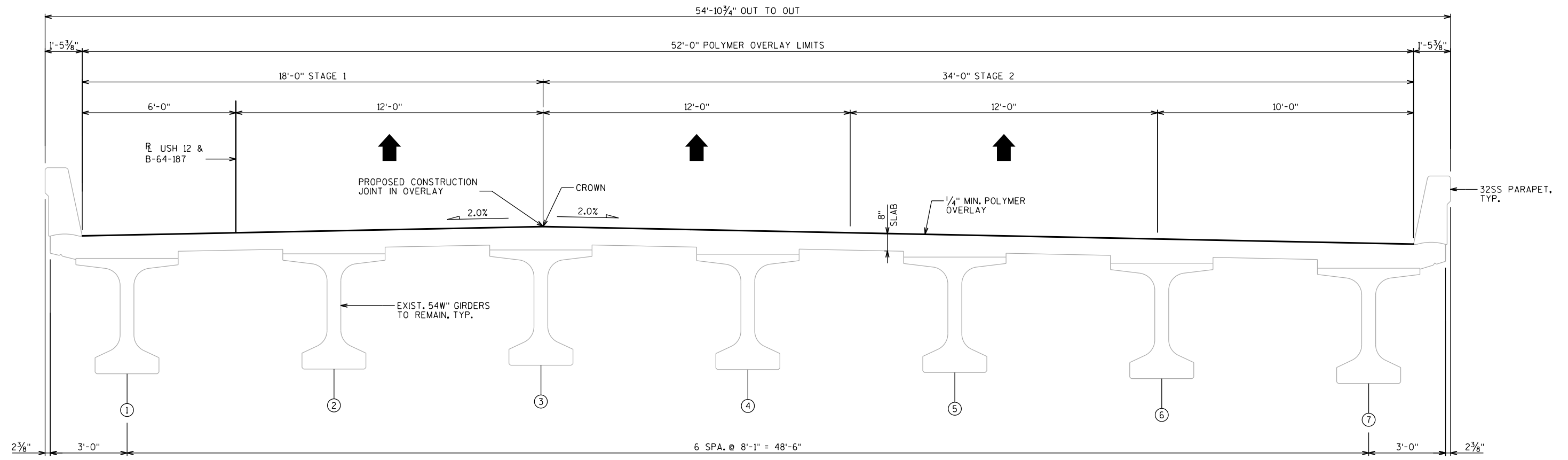

TYPICAL SECTION
(LOOKING NORTH)

GENERAL NOTES

DRAWINGS SHALL NOT BE SCALED.
 DIMENSIONS SHOWN ARE BASED ON THE EXISTING STRUCTURE PLANS.
 ALL DIMENSIONS ARE IN FEET AND INCHES UNLESS OTHERWISE NOTED. ALL STATIONS AND ELEVATIONS ARE IN FEET.
 DECK SURFACE PREPARATION IS INCLUDED IN THE BID ITEM "POLYMER OVERLAY".
 THE UTILITY INFORMATION SHOWN ON THESE DRAWINGS CONCERNING TYPE AND LOCATION IS NOT GUARANTEED TO BE ACCURATE OR ALL-INCLUSIVE. THE CONTRACTOR IS RESPONSIBLE FOR MAKING HIS OWN DETERMINATION AS TO TYPE AND LOCATION OF UTILITIES AS MAY BE NECESSARY TO AVOID DAMAGE.
 STRUCTURE STAGES DO NOT CORRESPOND TO ROADWAY STAGES. SEE ROADWAY PLANS FOR COMPLETE STAGING INFORMATION.

TOTAL ESTIMATED QUANTITIES

ITEM NO.	BID ITEM	UNIT	TOTAL
509.5100.S	POLYMER OVERLAY	SY	X
	NON-BID ITEMS		

ALL ITEMS ARE CATEGORY XXXX

NO.	DATE	REVISION	BY
STATE OF WISCONSIN DEPARTMENT OF TRANSPORTATION			
STRUCTURE B-64-187			
		DRAWN BY HDA	PLANS CK'D. PJC
TYPICAL SECTION, GENERAL NOTES & QUANTITIES			SHEET 2 OF 2

PRELIMINARY PLANS