

Public Involvement Meeting Handout

**WIS 50 (75th Street)
256th Avenue to 236th Avenue
Kenosha County**

Project ID: 1310-04-00



**September 26, 2019
5:00-7:00 p.m.
Westosha High School
Multi-Purpose Room**

PowerPoint Presentation 5:30 to 6:00 p.m.

Purpose of the meeting

Thank you for attending this public involvement meeting for the reconstruction for WIS 50 in Paddock Lake, Kenosha County. The existing pavement and drainage are in need of repair. This presentation is to inform the public about the WIS 50 project and to receive input about this project from the public.

A meeting with local officials was held on 9/5/2019.

This meeting is a presentation style meeting with time for questions at the end of the presentation. **The PowerPoint presentation will be from 5:30 pm to 6:00 pm.** There will be exhibits around the room for you to view and ask questions before and after the presentation. WisDOT representatives are available to answer questions and record comments about the project.

Project information

WisDOT is proposing to improve 1.4 miles of WIS 50 from 256th Avenue to 236th Avenue. Proposed improvements include:

- Replace pavement and curb and gutter.
- Storm sewer improvements.
- Sidewalk extension on east and west end of the project.
- Sidewalk handicap ramps will be improved to meet ADA standards.
- Traffic signals will be replaced with monotubes at WIS 83 and 246th Avenue along with turn lane improvements.
- The two existing retaining walls on the north side of WIS 50 between 246th Avenue and 248th Avenue will be replaced.
- Add on road bicycle accommodations.
- Potential median closures at the WIS 50/WIS 83 intersection.

Pavement and subgrade improvements are needed to address the drainage problem with the WIS 50 pavement. A five-foot gutter pan will provide for on road bicycle accommodations. The monotube equipment will help with visibility at the WIS 83 and 246th Avenue intersections by locating the signal head over the travel lane.

No historical properties or archaeological sites were found within the project.

WIS 50 Project Location Map

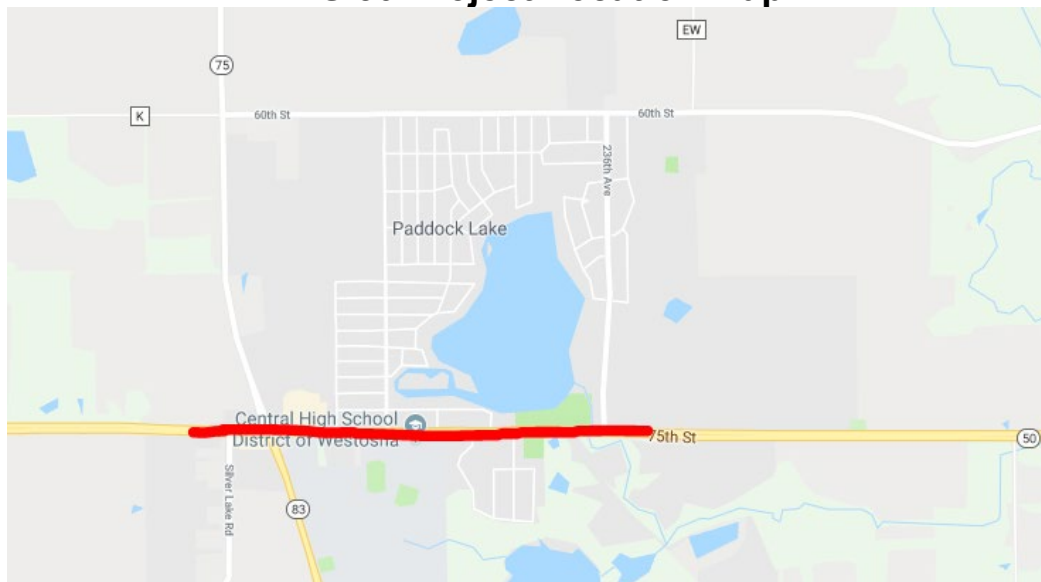

Proposed traffic impacts

Construction is tentatively scheduled for 2022 and is anticipated to last from April to November.

WIS 50 construction staging alternatives will be presented at this Public Involvement Meeting. Access to businesses and residences will remain open during construction.

Real estate

Right of way fee acquisition, highway easements, permanent limited easements and temporary limited easements will be necessary throughout the project.

The next phase is that property owners will be contacted in spring/summer of 2020 to begin the real estate acquisition process.

Persons with a concern for or knowledge about historical or archaeological resources, drainage problems, or environmental issues such as hazardous wastes and underground storage tanks are encouraged to provide information to the project design team.

Project update/next steps

- Real estate acquisition starting spring/summer 2020.
- Final design continues until November 2021.
- Construction is scheduled for 2022.

Public input/comments

We encourage you to talk to the project representatives and ask them questions. Attached to this handout is a sheet for your written comments and input regarding the proposed project. Please mail any written comments about the project before October 10, 2019 or leave them in the comment box tonight. You can also e-mail your comments to the contacts listed below.

Your comments assist us in developing a project that will serve the needs of the traveling public as well as the needs of the local community. Your input is welcome and appreciated throughout the design process.

For more information, please contact:

Brian Pluemer, P.E.
Wisconsin Department of Transportation
PO Box 798
Waukesha, WI 53187
262-548-6721
Brian.pluemer@dot.wi.gov

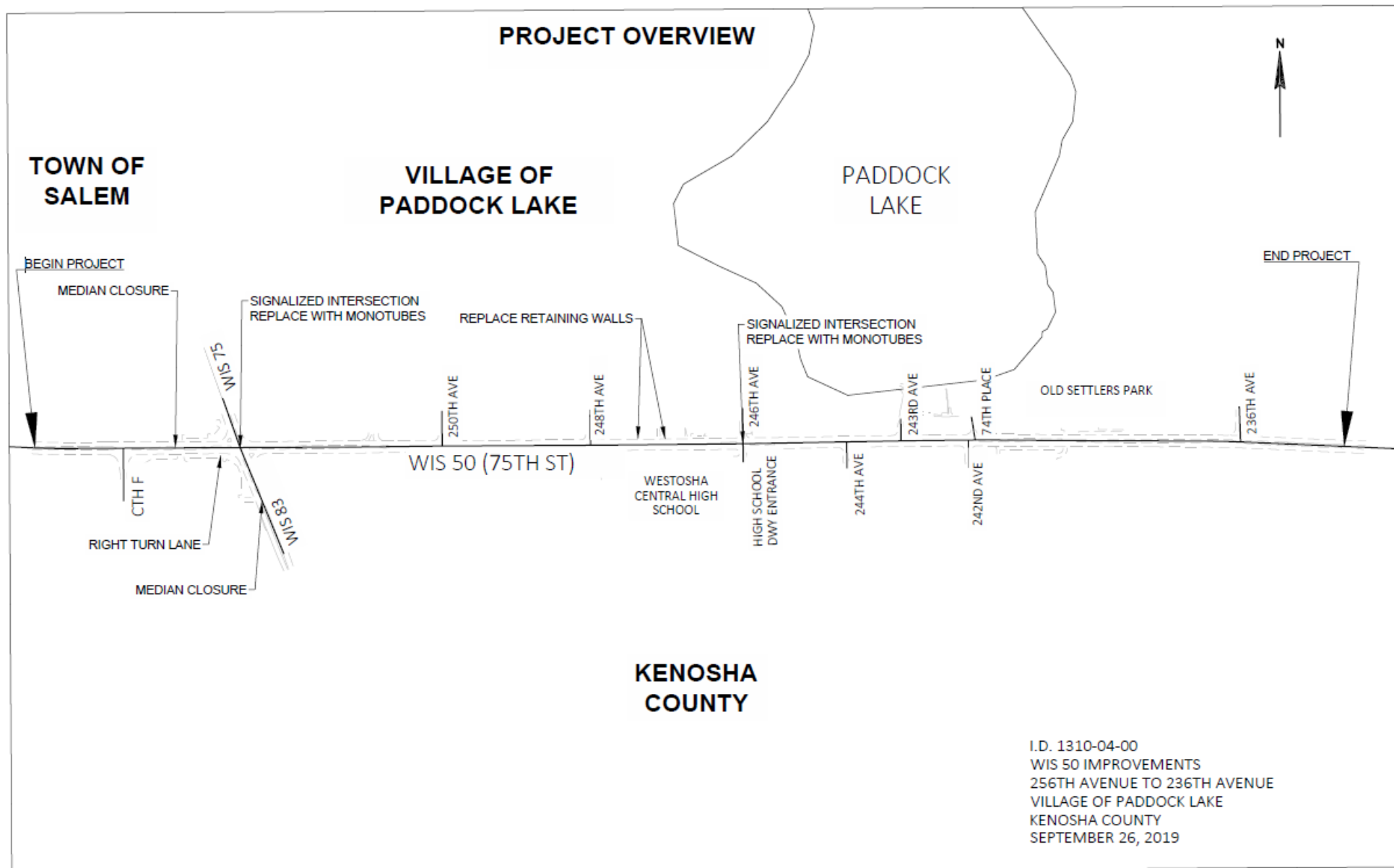

WIS 50 IMPROVEMENTS
256TH AVENUE TO 236TH AVENUE
VILLAGE OF PADDOCK LAKE
KENOSHA COUNTY
ID 1310-04-00

RECONSTRUCTION TYPICAL SECTION

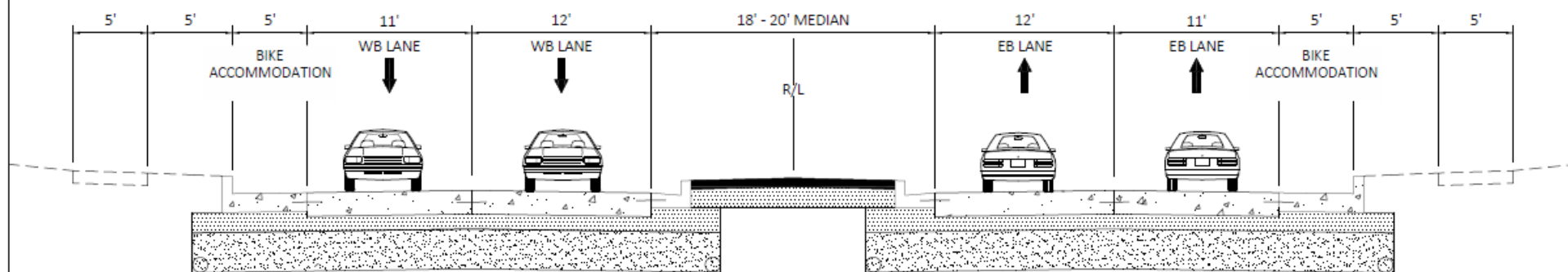

RECONSTRUCTION - RAISED MEDIAN

WIS 50

WIS 50 IMPROVEMENTS
256TH AVENUE TO 236TH AVENUE
VILLAGE OF PADDOCK LAKE
KENOSHA COUNTY
ID 1310-04-00

RECONSTRUCTION TYPICAL SECTION

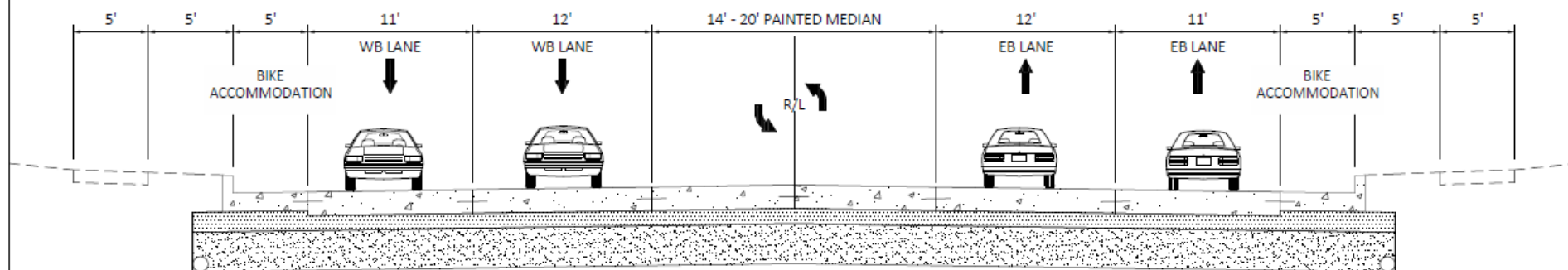

RECONSTRUCTION - FLUSH MEDIAN

WIS 50

Public Involvement Meeting Comment Form

Project ID 1310-04-00/70
WIS 50 (256th Avenue to 236th Avenue)
Kenosha County

September 26, 2019

Please place this form in the comment box or mail by October 10, 2019 to the address on the back of this sheet. Comments can also be e-mailed to brian.pluemer@dot.wi.gov. Your comments assist us in developing a project that will serve the needs of the traveling public as well as the needs of the local community. Your input is welcome and appreciated throughout the design process.

Name: _____

Address:

Daytime Phone Number (optional): _____

Email Address (optional): _____

Please Print Comments (attach additional sheets if necessary)

This image shows a blank sheet of white paper with horizontal ruling lines. The lines are evenly spaced and run across the width of the page. There are no margins, text, or other markings on the paper.

The information in this document including names, addresses, phone numbers, e-mail addresses, and signatures is not confidential, and may be subject to disclosure upon request, pursuant to the requirements of the Wisconsin open records law, sections 19.31 - 19.39 of the Wisconsin Statutes.

Fold here

Postage

Required

Wisconsin Department of Transportation

PO Box 798

Waukesha, WI 53187-0798

Attn: Brian Pluemer

Fold here to mail