

CONTROL SURVEY STATION RECORD

Wisconsin Department of Transportation
DT2262 10/2006

Project ID 8160-01-01	GPS Project ID	Station Name CP10	Station Number
Project Location BOYD CREEK BRIDGE	Highway STH 13	County BAYFIELD	PID
Region NW	Section 25	Town 48N	Range 5W

Station Location

TO REACH CP10 FROM THE JCT OF USH 2 AND STH 13 LOCATED APPROX. 3 MI WEST OF ASHLAND, WI. GO NORTH ON STH 13 FOR 1.5 MILES TO MISSION SPRINGS ROAD ON THE RIGHT. CONTINUE ON STH 13 FOR 0.9 MILES TO THE STATION ON THE LEFT. STATION IS ON THE NORTH SIDE OF A PRIVATE DRIVEWAY.

Station Description

3/4" REBAR WITH A PLASTIC ORANGE FAA-ENGINEERS CAP.

Reference Ties

28' TO A POWER POLE NORTH WEST CONTROL POINT
17.6' TO THE EDGE OF ASPHALT

Reference Sketch (Not to scale)

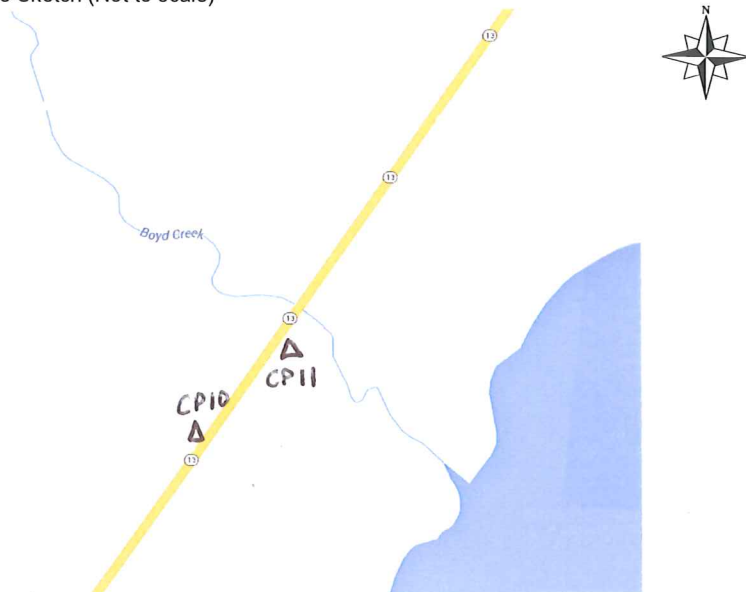

Obstruction/Visibility Diagram

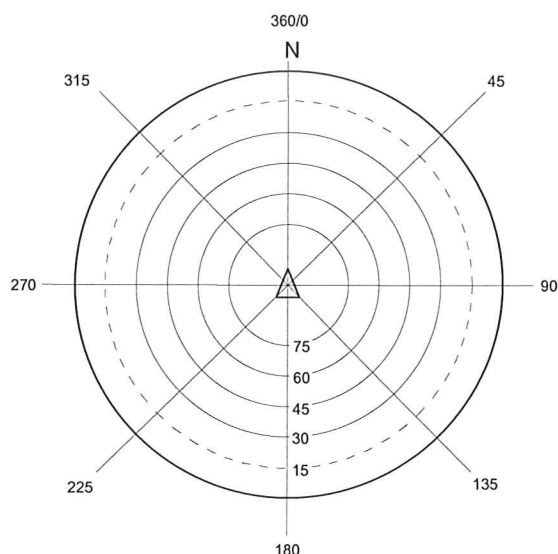

Other Stations Visible from this Station YES	Site Accessible by Vehicle <input checked="" type="checkbox"/> Yes <input type="checkbox"/> No	Recorder TGL	Description Date 11/9/15
---	---	-----------------	-----------------------------

Optional to complete section below if data exists elsewhere. If data exists, specify source of data. _____

Horizontal Accuracy GPS Observations	Vertical Accuracy GPS Observations	Surveyor (Name and Organization) TGL, FAA Engineers	Survey Date 10/26/15
Horizontal Datum <input type="checkbox"/> NAD 83 (2007) <input type="checkbox"/> NAD 83 (1997) <input type="checkbox"/> NAD 83 (1991) <input type="checkbox"/> NAD 27 <input checked="" type="checkbox"/> Other – Specify NAD 83 (2011)	Vertical Datum <input checked="" type="checkbox"/> NAVD 88 <input type="checkbox"/> NGVD 29 <input type="checkbox"/> Other – Specify _____	Coordinate System <input checked="" type="checkbox"/> WCCS, 9604 Zone – except Jackson County <input type="checkbox"/> JCOCS – for Jackson County <input type="checkbox"/> WISCRS, _____ County <input type="checkbox"/> SPCS, _____ Zone, Combination Factor _____ <input type="checkbox"/> Other – Specify _____	Unit <input checked="" type="checkbox"/> U.S. Survey Foot <input type="checkbox"/> Meter
Latitude		Longitude	Ellipsoid Height
Y-Coordinate 466467.314		X-Coordinate 802965.363	Orthometric Height 631.837

CONTROL SURVEY STATION RECORD

Wisconsin Department of Transportation
DT2262 10/2006

Project ID 8160-01-01	GPS Project ID	Station Name CP11	Station Number
Project Location BOYD CREEK BRIDGE	Highway STH 13	County BAYFIELD	PID
Region NW	Section 25	Town 48N	Range 5W

Station Location

TO REACH CP11 FROM THE JCT OF USH 2 AND STH 13 LOCATED APPROX. 3 MI WEST OF ASHLAND, WI. GO NORTH ON STH 13 FOR 1.5 MILES TO MISSION SPRINGS ROAD ON THE RIGHT. CONTINUE ON STH 13 FOR 0.91 MILES TO THE STATION ON THE RIGHT. STATION IS ON THE SOUTH SIDE OF BOYD CREEK BRIDGE.

Station Description

MAG NAIL IN ASPHALT

Reference Ties

9' TO END OF BEAM GUARD

Reference Sketch (Not to scale)



Obstruction/Visibility Diagram

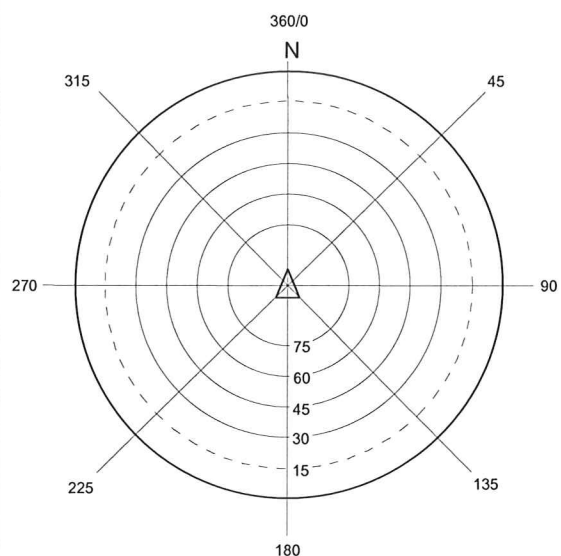

Other Stations Visible from this Station YES	Site Accessible by Vehicle <input checked="" type="checkbox"/> Yes <input type="checkbox"/> No	Recorder TGL	Description Date 11/9/15
---	---	-----------------	-----------------------------

Optional to complete section below if data exists elsewhere. If data exists, specify source of data. _____

Horizontal Accuracy GPS Observations	Vertical Accuracy GPS Observations	Surveyor (Name and Organization) TGL, FAA Engineers	Survey Date 10/26/15
Horizontal Datum <input type="checkbox"/> NAD 83 (2007) <input type="checkbox"/> NAD 83 (1997) <input type="checkbox"/> NAD 83 (1991) <input type="checkbox"/> NAD 27 <input checked="" type="checkbox"/> Other - Specify NAD 83 (2011)	Vertical Datum <input checked="" type="checkbox"/> NAVD 88 <input type="checkbox"/> NGVD 29 <input type="checkbox"/> Other - Specify _____	Coordinate System <input checked="" type="checkbox"/> WCCS, 9604 Zone - except Jackson County <input type="checkbox"/> JCOCS - for Jackson County <input type="checkbox"/> WISCRS, _____ County <input type="checkbox"/> SPCS, _____ Zone, Combination Factor _____ <input type="checkbox"/> Other - Specify _____	Unit <input checked="" type="checkbox"/> U.S. Survey Foot <input type="checkbox"/> Meter
Latitude		Longitude	Ellipsoid Height
Y-Coordinate 467081.564		X-Coordinate 803461.462	Orthometric Height 621.445

CONTROL SURVEY STATION RECORD

Wisconsin Department of Transportation
DT2262 10/2006

Project ID 8160-01-01	GPS Project ID	Station Name CP12	Station Number
Project Location BOYD CREEK BRIDGE	Highway STH 13	County BAYFIELD	PID
Region NW	Section 25	Town 48N	Range 5W

Station Location

TO REACH CP12 FROM THE JCT OF USH 2 AND STH 13 LOCATED APPROX. 3 MI WEST OF ASHLAND, WI. GO NORTH ON STH 13 FOR 1.5 MILES TO MISSION SPRINGS ROAD ON THE RIGHT. CONTINUE ON STH 13 FOR 0.91 MILES TO THE STATION ON THE LEFT. STATION IS ON THE NORTH SIDE OF BOYD CREEK BRIDGE.

Station Description

3/4" REBAR WITH A PLASTIC ORANGE FAA-ENGINEERS CAP.

Reference Ties

12.5' TO END OF THE BEAM GUARD
9' TO THE EDGE OF ASPHALT

Reference Sketch (Not to scale)

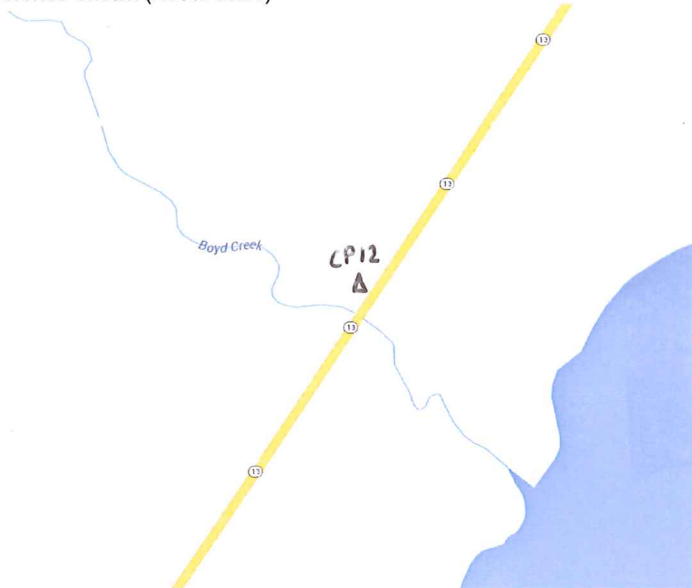

Obstruction/Visibility Diagram

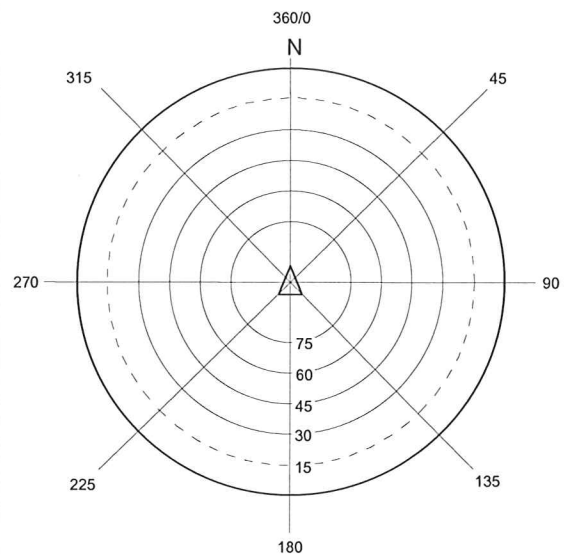

Other Stations Visible from this Station YES	Site Accessible by Vehicle <input checked="" type="checkbox"/> Yes <input type="checkbox"/> No	Recorder TGL	Description Date 11/9/15
---	---	-----------------	-----------------------------

Optional to complete section below if data exists elsewhere. If data exists, specify source of data. _____

Horizontal Accuracy GPS Observations	Vertical Accuracy GPS Observations	Surveyor (Name and Organization) TGL, FAA Engineers	Survey Date 10/26/15
Horizontal Datum <input type="checkbox"/> NAD 83 (2007) <input type="checkbox"/> NAD 83 (1997) <input type="checkbox"/> NAD 83 (1991) <input type="checkbox"/> NAD 27 <input checked="" type="checkbox"/> Other – Specify NAD 83 (2011)	Vertical Datum <input checked="" type="checkbox"/> NAVD 88 <input type="checkbox"/> NGVD 29 <input type="checkbox"/> Other – Specify _____	Coordinate System <input checked="" type="checkbox"/> WCCS, 9604 Zone – except Jackson County <input type="checkbox"/> JCOCS – for Jackson County <input type="checkbox"/> WISCRS, _____ County <input type="checkbox"/> SPCS, _____ Zone, Combination Factor _____ <input type="checkbox"/> Other – Specify _____	Unit <input checked="" type="checkbox"/> U.S. Survey Foot <input type="checkbox"/> Meter
Latitude		Longitude	Ellipsoid Height
Y-Coordinate 467319.045		X-Coordinate 803569.763	Orthometric Height 619.561

CONTROL SURVEY STATION RECORD

Wisconsin Department of Transportation
DT2262 10/2006

Project ID 8160-01-01	GPS Project ID	Station Name CP13	Station Number
Project Location BOYD CREEK BRIDGE	Highway STH 13	County BAYFIELD	PID
Region NW	Section 25	Town 48N	Range 5W

Station Location

TO REACH CP13 FROM THE JCT OF USH 2 AND STH 13 LOCATED APPROX. 3 MI WEST OF ASHLAND, WI. GO NORTH ON STH 13 FOR 1.5 MILES TO MISSION SPRINGS ROAD ON THE RIGHT. CONTINUE ON STH 13 FOR 0.93 MILES TO THE STATION ON THE LEFT. STATION IS ON THE NORTH SIDE OF BOYD CREEK BRIDGE.

Station Description

3/4" REBAR WITH A PLASTIC ORANGE FAA-ENGINEERS CAP.

Reference Ties

~875' FROM THE NORTH END OF THE BOYD CREEK BRIDGE DECK
8" TO THE EDGE OF ASPHALT

Reference Sketch (Not to scale)

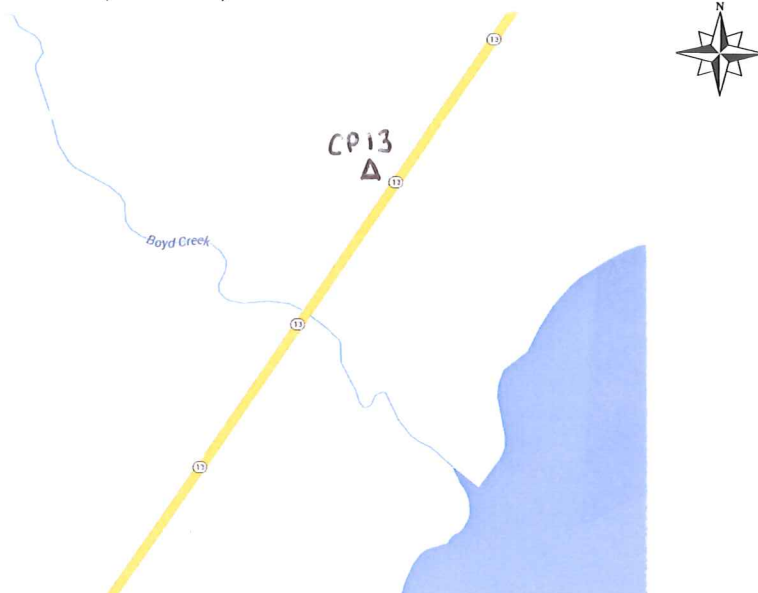

Obstruction/Visibility Diagram

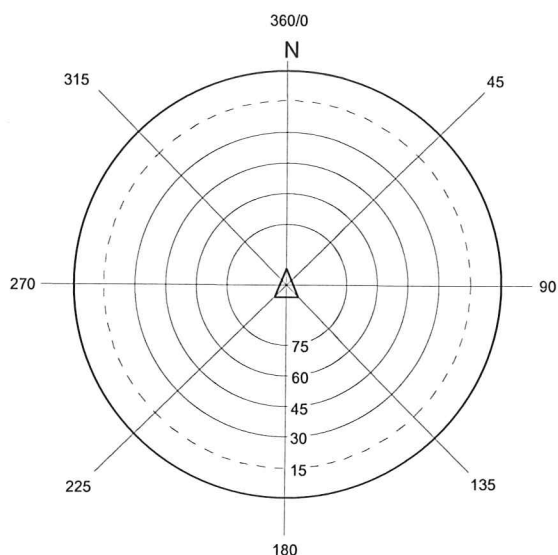

Other Stations Visible from this Station YES	Site Accessible by Vehicle <input checked="" type="checkbox"/> Yes <input type="checkbox"/> No	Recorder TGL	Description Date 11/9/15
---	---	-----------------	-----------------------------

Optional to complete section below if data exists elsewhere. If data exists, specify source of data. _____

Horizontal Accuracy GPS Observations	Vertical Accuracy GPS Observations	Surveyor (Name and Organization) TGL, FAA Engineers	Survey Date 10/26/15
Horizontal Datum <input type="checkbox"/> NAD 83 (2007) <input type="checkbox"/> NAD 83 (1997) <input type="checkbox"/> NAD 83 (1991) <input type="checkbox"/> NAD 27 <input checked="" type="checkbox"/> Other – Specify NAD 83 (2011)	Vertical Datum <input checked="" type="checkbox"/> NAVD 88 <input type="checkbox"/> NGVD 29 <input type="checkbox"/> Other – Specify _____	Coordinate System <input checked="" type="checkbox"/> WCCS, 9604 Zone – except Jackson County <input type="checkbox"/> JCOCs – for Jackson County <input type="checkbox"/> WISCRS, _____ County <input type="checkbox"/> SPCS, _____ Zone, Combination Factor _____ <input type="checkbox"/> Other – Specify _____	Unit <input checked="" type="checkbox"/> U.S. Survey Foot <input type="checkbox"/> Meter
Latitude		Longitude	Ellipsoid Height
Y-Coordinate 467941.611		X-Coordinate 804007.948	Orthometric Height 637.396