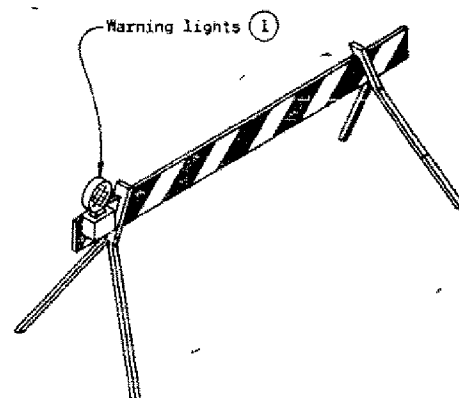

TABLE OF BARRICADE CHARACTERISTICS

BARRICADE TYPE	I	II	III
Height	3' Minimum		5' Minimum
*Rail Width	8" Minimum to 12" Maximum		
Rail Length	2' Minimum		4' Minimum
**Stripe Width	6" at 45° Angle		
Stripe Colors	Reflectorized Orange & White		

* Nominal dimensions when barricade is constructed of lumber.
 ** Shall be 4" for rail lengths less than 3'.



TYPICAL TYPE I BARRICADE

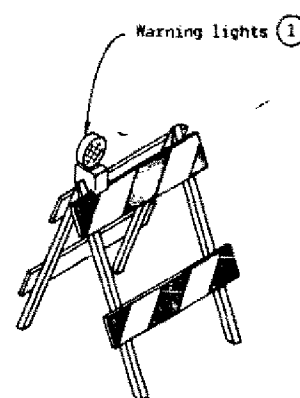

TYPICAL TYPE II BARRICADE

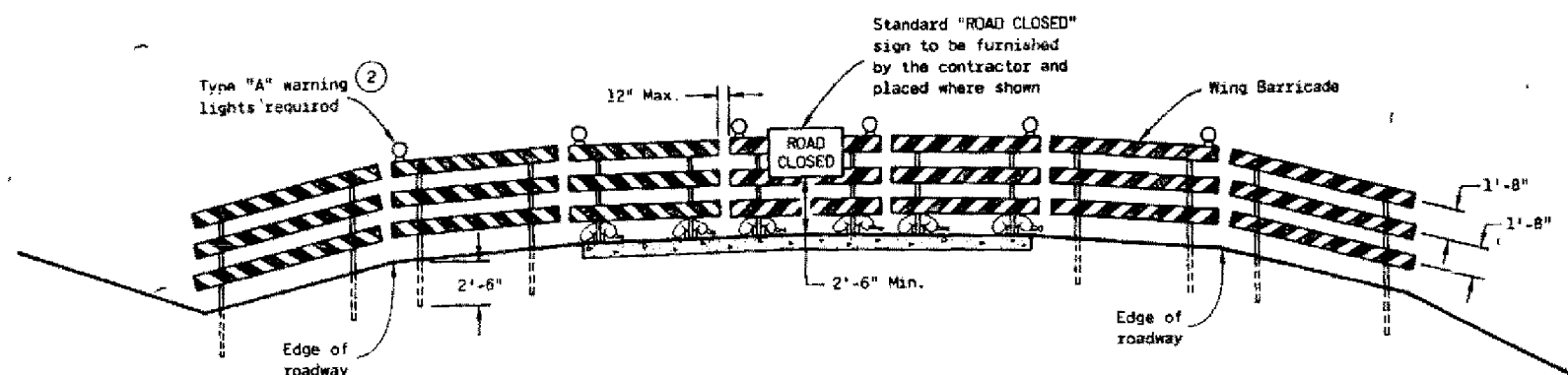

TYPICAL INSTALLATION SHOWING TYPE III BARRICADE

CONSTRUCTION BARRICADES



R11-2

48" x 30"

Black Lettering on Reflective
 White Background
 Letter Series "D"
 Letter height 8"



W20-3

48" x 48"

Black Lettering on Reflective
 Orange Background
 Letter Series "D"
 Letter height 7"

STANDARD SIGNS - TYPE II

GENERAL NOTES

The contractor shall furnish, erect and maintain barricades and signs. Details regarding location, spacing, dimensions, fabrication, material, sign lettering, lighting devices and color of barricades and signs shall conform to this drawing, the Manual On Uniform Traffic Control Devices, the Standard Specifications, Special Provisions and/or plans.

Type III Barricades and Signs shall be erected at the termini of projects and at other road or street locations where it is necessary to control or eliminate public access to the construction area.

Type I and II Barricades shall be used on projects when traffic is to be maintained through the construction area.

The actual field location of barricade installations and advance signs shall be as directed by the Engineer.

Each barricade shall have the name and telephone number of a person responsible for 24 hour emergency service printed in letters at least 1/4 inch in height on the barricade rails. Prior to May 1, 1983, such information may be shown on either front or back-faces of the barricade rails. After May 1, 1983, all printed information or identification markings shall be shown only on the back side of barricade rails.

Type I Barricades may include other unstriped horizontal panels necessary to provide stability.

On high speed expressways or in other situations where barricades may be susceptible to overturning in the wind, sandbags should be used for ballasting. Sandbags may be placed on lower parts of the frame or stays to provide the required ballast but shall not be placed on top of any striped rail.

① Unless otherwise provided elsewhere in the contract, warning lights are required on all barricades which will be located near traffic operations during periods of inclement weather or hours of darkness. Barricades used to shield isolated hazards shall be equipped with Type "A" (low intensity - flashing) lights unless Type "B" (high intensity) - flashing lights are specified elsewhere in the contract documents. Barricades used for channelization or delineation of the travel path shall be equipped with Type "C" (steady burn) lights except for the initial barricade(s) in sequence, which shall be equipped with Type "A" or "B" lights as previously noted.

② Two warning lights shall be provided on the center barricade and at least one warning light shall be provided on each of the other barricades within the roadway limits. Spacing of the warning lights shall be uniform to the edge of roadway as shown.

CONSTRUCTION BARRICADES & STANDARD SIGNS

State of Wisconsin
 Department of Transportation

APPROVED
 9-14-81
 DATE

D. Strand
 CHIEF DESIGN ENGINEER

FWHA