

TRAFFIC FORECAST REPORT

PROJECT ID(S): 1190-02-11

ROUTE(S): USH 53

REGION/COUNTY(IES): NW/Eau Claire
LOCATION: USH 53, Old Town Rd to Golf Rd
COMPLETED: 8/29/12

Developed by: Karl Buck
Phone: (608) 266-1379
FAX #: (608)-267-0294

Traffic Forecasting Section; Bureau of Planning and Economic Development; Division of Transportation Investment Management

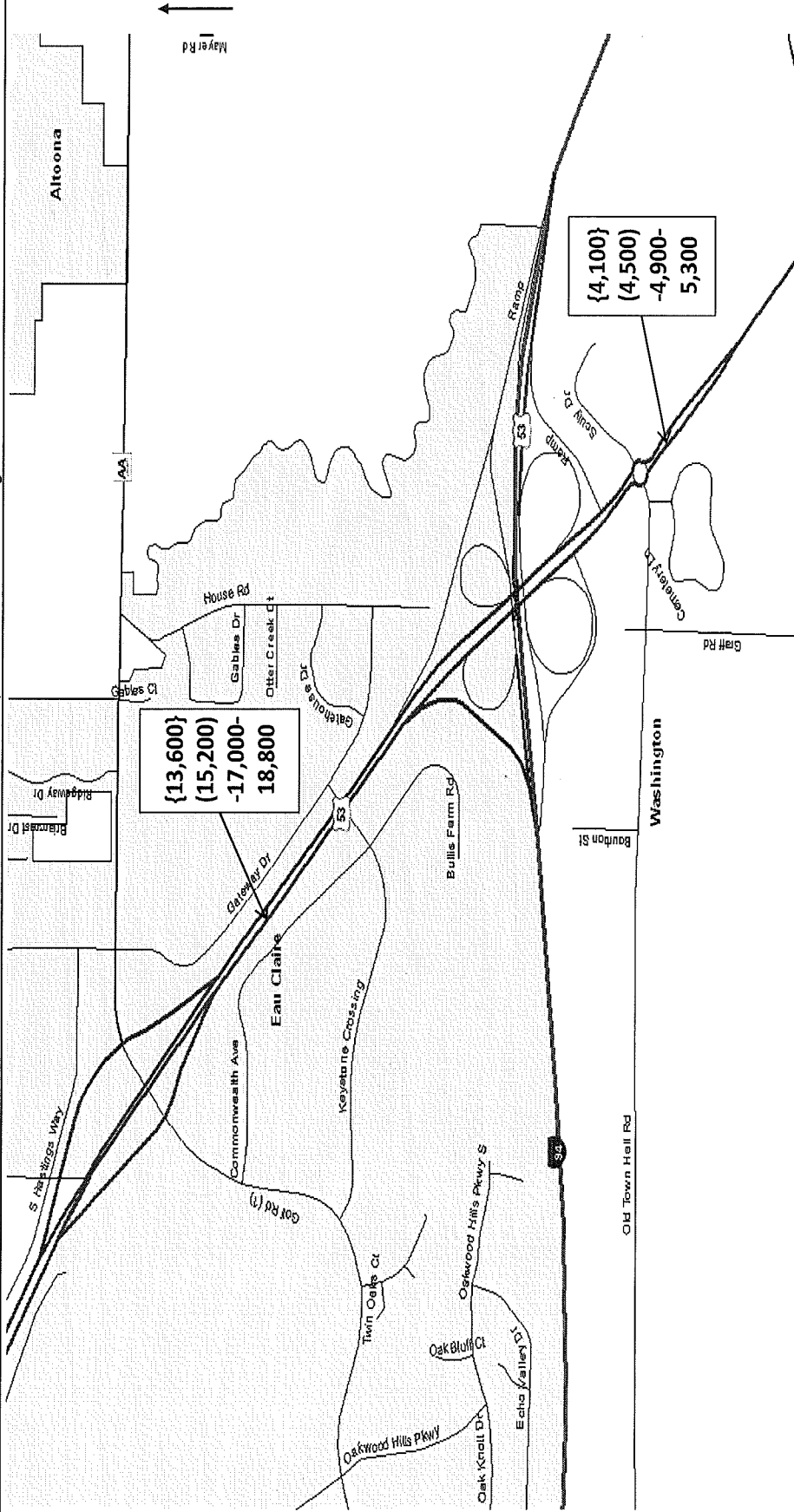

Design Values (%)		Last Count/Forecast Years:			
Routes →	USH 53	{000}	2008 AADT	2017 AADT	2027 AADT
Design Volume(s):	18800	{000}	2008 AADT	2017 AADT	2027 AADT
K250	9.7	---	---	---	---
K100	10.7	---	---	---	---
K30	11.5	---	---	---	---
T(DHV)	6.4	---	---	---	---
D(Dsgn. Hr.)	59/41	---	---	---	---
K8(ADT)	---	---	---	---	---
T(A8HV)	---	---	---	---	---
		Truck Class %'s			
		Class	Seg. 1	Seg. 2	Seg. 3
		2D	2.0	---	---
		3AX	0.6	---	---
		2S1+2S2	1.3	---	---
		3-S2	3.4	---	---
		DBL-BTM	0.1	---	---
		TOTAL	7.4%	---	---

NOTES ON THE FORECAST:

- This projection assumes that no major new traffic generators will be developed in the area served by the roadway or intersections over the course of the planning period.
- The historical traffic count trends will continue increasing at a decreasing rate. Box-Cox regression is used to project past count data.
- Truck classification percentages were taken from the 2009 Wisconsin Vehicle Classification Data (Site # 180002, USH 53-0.6 miles north of STH 312/CTH Q, Seymour, Eau Claire County).

MORE NOTES ON THE FORECAST:

- USH 53 is a factor group IV (rural-other) highway south of I-94 indicating low to moderate fluctuation in traffic from a seasonal perspective. It is functionally classified as a rural major collector (7) for count purposes there. North of I-94, USH 53 is a factor group II (urban-other) highway also indicating low to moderate fluctuation in traffic from a seasonal perspective. It is functionally classified as an urban principal arterial (14) for count purposes north of I-94.
- The Eau Claire Travel Demand Model was consulted and used as a comparison tool to check against the Traffic Analysis Forecasting Information System output. Adjustments were made as needed.

Metamanager Summary for Scoping

PROJECT ID'S **1190-02-11, 1190-02-81**

TITLE **OSSEO - EAU CLAIRE**

LIMITS **OLD TOWN RD TO GOLF RD (NB & SB)**

COUNTY **EAU CLAIRE**

HIGHWAY **USH 053**

Mainline Length **1.26**

Location Type **URBAN**

Funct. Class **PRINCIPAL ARTERIAL**

Ref. Pts From: **053N 119H + 0.56**

To: **053N 122G + 0**

RESURF

April 2017

SFY 2017

From: **053S 122G + 0**

To: **053S 121 + 0.28**

Legend:

Beginning RP - Reference Point at start of segment
Segment Beginning - intersection at segment origin (if any)
Miles - metamanager segment length
Div/Undiv - divided or undivided roadway
PCI - Pavement Condition Index (100-0, higher is better)
Surf Age - age of pavement surface (yrs since last project)
Type - type of pavement: HMA (asphalt) or PCC (concrete)
ADT - 5-year historical Average Daily Traffic
% Trucks - % of trucks during design hour
Posted Speed - posted speed limit (MPH)
Lanes - traveling lanes (separate when hwy is divided)
Width - traveled way width
Left/Right Shldr - shoulder width
AK Flag - A (severe injury) & K (fatality) greater than avg.
LOP - Level of Problem (see table of MM codes)
Spot Flag - .1 mile long "spots" with safety problems

* Please note change from **PDJ** to **PCI** as of May 2011. Scale is from 100-0, with 100 being perfect pavement and 0 is total failure.

SEGMENT				PAVEMENT			MOBILITY					SAFETY						
Beginning RP	Segment Beginning	Miles	Div/ Undiv	PCI*	Surf Age	Type	ADT	% Trucks	Posted Speed	Lanes	Width	Left Shldr	Right Shldr	AK Flag	LOP	Spot Flag	Impv Flag	Avg. Crashes
053N119H036	0	0.47	D	95.249	4	HMA over PCC	4,094	4.6	55	2	24	4	0	0	6	1	YES	1.6
053N121 000	0	0.46	D	95.249	4	HMA over PCC	14,608	8.3	65	2	24	6	10	0	0	0	0	0.4
053N122 000	0	0.53	D	97.249	4	HMA over PCC	14,608	8.3	65	2	24	6	10	0	8	0	YES	1.6
053N122G000																		
053S122G000	0	0.53	D	94.249	4	HMA over PCC	14,608	8.3	65	2	24	6	10	0	4	1	YES	2.8
053S122 000	0	0.43	D	97.249	4	HMA over PCC	14,608	8.3	65	2	24	6	10	0	0	0	0	0.6
053S121 000	0	0.51	D	97.249	4	HMA over PCC	4,094	4.6	55	2	24	4	0	0	6	1	YES	2.8
AVERAGES:				96.07	4.0		11,091	7.1	62	2	24.0	5.3	10.0	0		3	4	1.6
TOTALS:				2.93														9.8

Bridges Within Project Limits										Feature Under	
Beginning RP	Bridge ID	SR	Bridge Type	Bridge Age	Deck Age	Deck Area	Rdwy Width	Feature On	Feature Under		
053N122 000	B180038	98	ARCH	52	46	4,689	44.1	USH 53 NB	TOWN RD		
053N122G000	B180099	97.4	GENL	32	26	19,722	66	AA	USH 53		
053N122G000	B180183	94.7	GENL	13	7	8,803	86.2	JSH 53 NB HASTINGS WA	CYPRESS RD		
053N122G000	B180182	96.2	GENL	12	6	9,096	55.4	USH 53 NB	HASTINGS WAY		

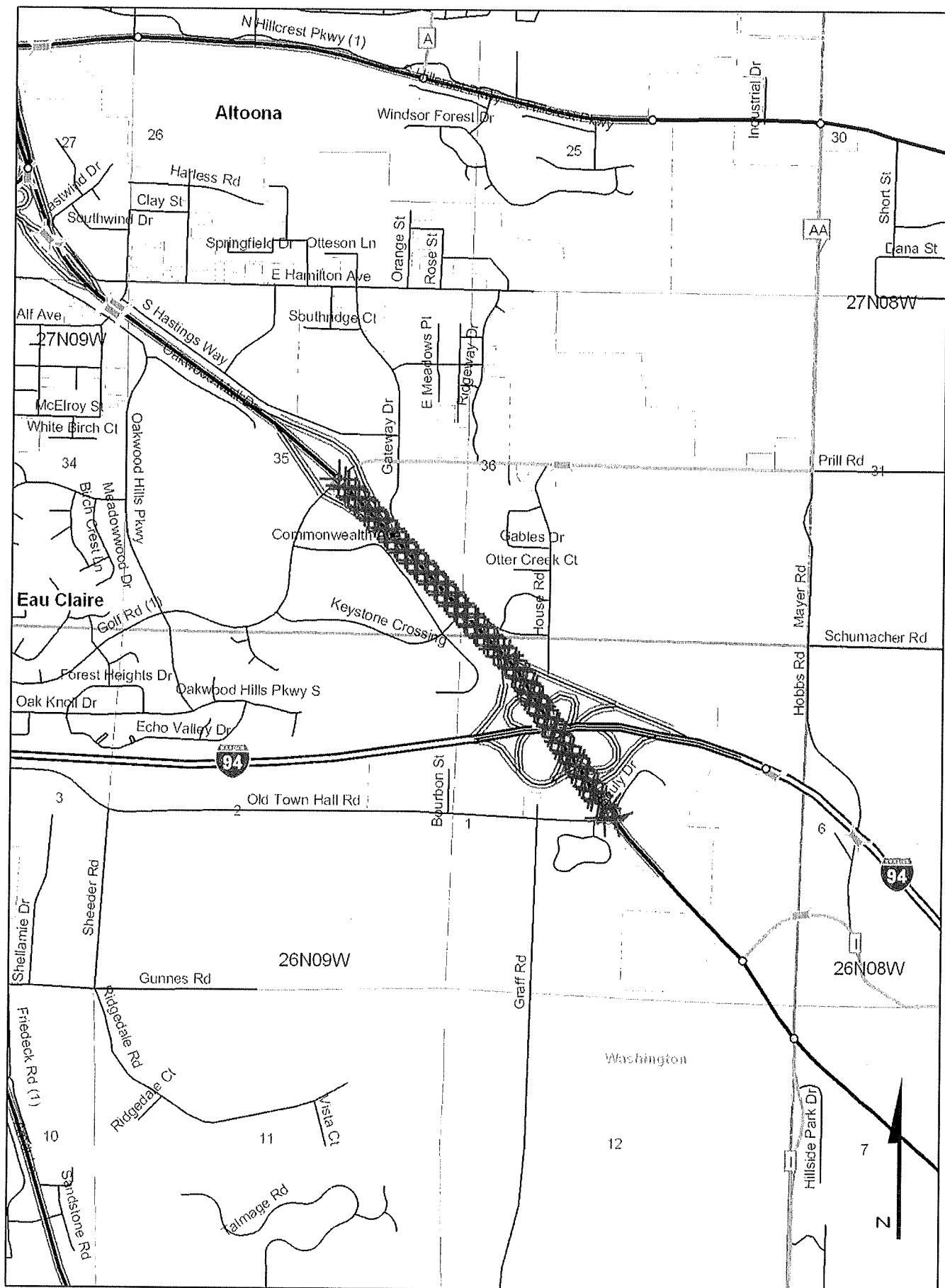

Shermo, Richard - DOT

From: Abboud, Jeffry - DOT
Sent: Thursday, October 31, 2013 10:48 AM
To: Shermo, Richard - DOT
Cc: Rusch, Stacey - DOT; Felix, Jessica L - DOT
Subject: RE: Scope Documents for USH 53, I.D. 1190-02-11/81

Concur. Believe the ramps are there now, just not to current requirements, but no sidewalks on either side of the ramps, so no update needed.

Jeff

From: Shermo, Richard - DOT
Sent: Tuesday, October 29, 2013 17:34
To: Abboud, Jeffry - DOT
Cc: Rusch, Stacey - DOT; Felix, Jessica L - DOT
Subject: RE: Scope Documents for USH 53, I.D. 1190-02-11/81

Aug scope minutes indicate we will replace deficient concrete pavement on the NW Ramp and between ramp terminals of the Golf Road Interchange. There is sidewalk over the bridge and to the ramp terminals only; nothing on the local road approaches. FDM 11-46-10.1 states we do not need to provide a curb ramp on the local approach since no sidewalk exists. Concur? However, we will retain the curb openings on the local approaches to facilitate future ramp installation.

From: Shermo, Richard - DOT
Sent: Tuesday, October 29, 2013 12:33 PM
To: Felix, Jessica L - DOT; Haig, Gregory - DOT
Cc: Rusch, Stacey - DOT
Subject: Scope Documents for USH 53, I.D. 1190-02-11/81

Reviewing estimate and scope documents for finalizing and I noted that we went from no structures work from the August meeting to eight structures for epoxy overlay. Three of those structures are outside the project limits. Confused; did I miss something?

Shermo, Richard - DOT

From: Shermo, Richard - DOT
Sent: Tuesday, October 29, 2013 12:33 PM
To: Felix, Jessica L - DOT; Haig, Gregory - DOT
Cc: Rusch, Stacey - DOT
Subject: Scope Documents for USH 53, I.D. 1190-02-11/81

Reviewing estimate and scope documents for finalizing and I noted that we went from no structures work from the August meeting to eight structures for epoxy overlay. Three of those structures are outside the project limits. Confused; did I miss something?

Programming
Going to
Schedule Separate
Project for bridge
overlays
per 2/3/14
discussion Stacey & Jessica

Shermo, Richard - DOT

From: Haig, Gregory - DOT
Sent: Friday, September 13, 2013 9:12 AM
To: Felix, Jessica L - DOT
Subject: RE: Backbone Introductions (Polymer Overlays)

Jessica,

I wasn't entirely sure if these would be appropriate to bring in with the patching job. I assumed that they would have to be done on a standalone project. If they can be bundled and put in with Project 1190-02-81 that would be great. I will go ahead and update the bridge work in PMP to reflect the change.

One question I have is should we include the last 4 bridges in with the contract?

Thanks for bringing this to my attention!

Gregory Haig, P.E.
Bridge Maintenance Engineer
Northwest Region, Eau Claire
gregory.haig@dot.wi.gov
cell. (715) 577-0646

From: Felix, Jessica L - DOT
Sent: Thursday, September 12, 2013 4:11 PM
To: Haig, Gregory - DOT
Subject: RE: Backbone Introductions (Polymer Overlays)

Greg,

We need to discuss if the following bridges can be incorporated into project 1190-02-81:

B180035	USH 53 SB	IH 94
B180036	USH 53 NB	IH 94
B180037	USH 53 SB	TOWN RD
B180038	USH 53 NB	TOWN RD
B180182	USH 53 NB	HASTINGS WAY
	USH 53 NB HASTINGS	
B180183	WAY	CYPRESS RD
	USH 53 SB HASTINGS	
B180184	WAY	CYPRESS RD
B180178	USH 53 SB	HASTINGS WAY

They are within the project limits of the SFY 2017 RESURF project. Also I had asked back in March, if you had structure work in this area and you said no. Did you want to update PMP and change that?

As for the other bridges:

B180161	USH53 NB	Otter Creek
B180162	53 SB LANE	OTTER CR
B180163	USH 53 NB	UP RR
B180164	USH 53 SB	UP RR

I will look into creating a new project ID that would include the scope of work for all 4 bridges. This way we can capitalize on quantities and one set of traffic control plans.

What is the preferred time frame (fiscal year) for all of the bridge polymer overlays?

Jessica L. Felix, P.E.

Regional Program Engineer

Office: 715-836-5170 Cell: 715-577-4365 Email: jessica.felix@dot.wi.gov

From: Haig, Gregory - DOT
Sent: Monday, August 19, 2013 8:58 AM
To: Felix, Jessica L - DOT
Subject: Backbone Introductions (Polymer Overlays)

Jessica,

If possible, I would like to introduce the attached bridges for Polymer overlays. I've put together a list with rough cost estimates. If you have any questions or comments please let me know.

Thanks,

Gregory Haig, P.E.
Bridge Maintenance Engineer
Northwest Region, Eau Claire
gregory.haig@dot.wi.gov
cell. (715) 577-0646

<< File: backbone overlays.xlsx >>

PMP Report Summary

Date: 2/1/13

HWY: USH 53

COUNTY: EAU CLAIRE

I.D. 1190-02-11

~~10/26/13~~

11/26/13

DESIGN SEGMENTS

7/26/12 ✓

ENVIRONMENTAL

NO ENTRY ✓

MAINTENANCE

~~8/20/12~~ 8/1/13

11/7/13

RIGHT-OF-WAY FENCE SEGMENTS NEEDS REPAIR
GOLF ROAD RAMP INLETS & 1 CONCRETE FLUMB NEEDS CLEANING
CULVERTS GOOD
Re-Pave X-overs

Pavement Jutting throughout segment
Ramp Gales @ Golf Rd?
Golf Road Ramps need long joints repaired

PLANNING

NO ENTRY

REAL ESTATE

NO ENTRY

SOILS & PAVEMENTS

10/1/12 ✓

11/14/13

see attached

REPEAT RESURFACE IN 2008
CROWN CORRECTIONS OF 4" MIN TO 5.5" HMA -
GOLF ROAD Ramps & ROAD SHOULD BE DONE

STRUCTURES

7/26/12

~~10/16/13~~ 11

~~NO STRUCTURES WORK~~

EPOXY overlay on numerous structures

TRAFFIC

12/18/12

8/2/13

OS/DW ROUTE

TYPE II SIGN REPLACEMENT W/ 2017 PROJECT

Recommend Night Work

PMP NOTES

1/25/13

7/26/12 overlay of the interchange

PROJECT CHANGE REQUEST WORKSHEET

PROJECT ID: 1190-02-11, 81 HIGHWAY: USH 053 COUNTY: EAU CLAIRE PROJECT DESCRIPTION (TITLE): LN 1: OSSEO - EAU CLAIRE LN 2: OLD TOWN RD TO GOLF RD (NB & SB) LN 3: DESIGN/RESURFACING	DATE: 8/17/2012 SUBMITTED BY: JLF SUPERVISOR APPR:
--	--

REQUESTED CHANGES

<input checked="" type="checkbox"/> PROJECT LIMITS CURRENT LIMITS LN 1: OSSEO - EAU CLAIRE LN 2: OLD TOWN RD TO GOLF RD (NB & SB) LN 3: DESIGN/RESURFACING PROPOSED LIMITS LN 1: OSSEO - EAU CLAIRE LN 2: IH 94 TO GOLF RD (NB & SB) LN 3: DESIGN/RESURFACING	<input type="checkbox"/> LET DATE <input type="checkbox"/> NON-LET DATE CURRENT SCHEDULE DATE: 4/11/2017 PROPOSED SCHEDULE DATE: <input type="checkbox"/> PS&E DATE (NOTE: VERIFY PS&E DATE) CURRENT SCHEDULE DATE: 11/1/2016 PROPOSED SCHEDULE DATE:
<input type="checkbox"/> PROJECT ESTIMATES SCOPE (CDR) ESTIMATE (W/O DELIVERY): CURRENT ESTIMATE (W/O DELIVERY): PROPOSED ESTIMATE (W/O DELIVERY): PROPOSED ESTIMATE DELIVERY COST: PROPOSED ESTIMATE DELIVERY %:	<input type="checkbox"/> IMPROVEMENT CONCEPT <input type="checkbox"/> PROJECT ROLE(S) <input type="checkbox"/> DELIVERY <input type="checkbox"/> TIE BID <input type="checkbox"/> ADDITIONAL CATEGORY(IES) <input type="checkbox"/> OTHER

TOTAL ESTIMATE CHANGE (+/-)	% (PROPOSED ESTIMATE divided by SCOPE (CDR) ESTIMATE)
-----------------------------	---

JUSTIFICATION:

CHANGE THE LIMITS TO NORTH OF THE IH 94/USH 53 INTERCHANGE AS THE AREA TO THE SOUTH HAS RECENTLY HAD PROJECTS (BRIDGES OVER IH 94 RE-DECKED AND ROUNDABOUT CONSTRUCTED AT OLD TOWN ROAD).

COMMENTS BY SP&O:
NEW RPS: 053N 121+0.13 (CUM MILES 65.42) TO 053N 122G+0.00 (CUM MILES 66.28)
053S 122G+0.00 (CUM MILES 151.96) TO 053S 122+0.33 (CUM MILES 152.82)

SP&O Concurrence ☒ **YES** (Explanation in Comments by SPO)
☐ **NO** (Explanation in Comments by SPO)

Date Entered in FIIPS:
Date Not Approved:



Project ID : 1190-02-11

Route : USH 053

Title : OSSEO - EAU CLAIRE

Sub Title : OLD TOWN RD TO GOLF RD (NB & SB)

Region : NORTHWEST

County : EAU CLAIRE

Design Segment - Proposed

Segment	Segment Limits	Improvement Concept	Main Line Length (Miles)	Side Road Length (Miles)	Primary
1	RP: 053N 119H+0.56 to RP: 053N 122G+0.00	Resurfacing	1.26	0	✓
2	RP: 053S 122G+0.00 to RP: 053S 121+0.28	Resurfacing	1.26	0	

Design Segment Design Criteria

Segment	Segment Limits	Route Type	Location Type	Functional Class	Design Speed	Design Class	Roadways	Lanes	Lane Width (Feet)	Shoulder L (Feet)	Shoulder R (Feet)	Roadway Width (Feet)	Struct. Min Design Loading	Clear Roadway Width of Bridges (Feet)
1	RP: 053N 119H+0.56 to RP: 053N 122G+0.00	US Highway	Urban	Arterial	N/A	N/A	2	2	12	5.3	10	24	N/A	0
2	RP: 053S 122G+0.00 to RP: 053S 121+0.28	US Highway	Urban	Arterial	N/A	N/A	2	2	12	5.3	10	24	N/A	0

modified 8/17/12
See PCR



Project ID : 1190-02-11
Title : OSSEO - EAU
 CLAIRE
Region : NORTHWEST

Route : USH 053
Sub Title : OLD TOWN RD TO GOLF RD (NB
 & SB)
County : EAU CLAIRE

Segment #1

Attributes Auxiliary Lane Comments General

Primary ** ✓

Segment - General Go to top of page

Segment limits	RP: 053N 119H+0.56 to RP: 053N 122G+0.00
Improvement concept **	Resurfacing
Main line length **	1.26 Miles
Side road length	0 Miles
Route type	US Highway
Location type	Urban
Terrain	
Functional class	Arterial Principal
Average Daily Traffic (ADT), current year	11,091
Current year (ADT)	0
Average Daily Traffic (ADT), design year	0
Design year (ADT)	0
Latest percent truck traffic	7.1%
Existing posted speed	65 MPH
Expected posted speed	0 MPH
Development type	
Design speed	N/A
Design class	N/A
Number of roadways	2
Width of roadways	24 Feet
Number of lanes	2
Width of lanes	12 Feet
Shoulder width: Left	5.3 Feet
Shoulder width: Right	10 Feet
Clear zone	0 Feet
Structure minimum design loading	N/A
Clear roadway width of bridges	0 Feet
Median width: 0 Feet	
Cross section comments	

Auxiliary lanes Go to top of page

Number	Description	Comment
--------	-------------	---------

No Auxiliary lanes for this segment.**Attributes** Go to top of page

	New alignment	
	Connecting highway	
	Acquire vision triangle	
	Bike accommodation	
	Curb	
	Curb and gutter	
	Exceptions to standards	
	Freeway operations coordination	
	Improve intersection	
	Improve horizontal alignment	
	Improve vertical alignment	
	Parking	
	Sidewalk	
	Storm sewer	
	Sanitary sewer replacement	
	Water main replacement	

Comments Go to top of page

Last updated by FELIX, JESSICA LOUIS on 07/26/2012



Project ID : 1190-02-11
Title : OSSEO - EAU
 CLAIRE
Region : NORTHWEST

Route : USH 053
Sub Title : OLD TOWN RD TO GOLF RD (NB
 & SB)
County : EAU CLAIRE

Segment #2

Attributes Auxiliary Lane Comments General

Segment - General Go to top of page

Segment limits	RP: 053S 122G+0.00 to RP: 053S 121+0.28
Improvement concept **	Resurfacing
Main line length **	1.26 Miles
Side road length	0 Miles
Route type	US Highway
Location type	Urban
Terrain	
Functional class	Arterial Principal
Average Daily Traffic (ADT), current year	11,091
Current year (ADT)	0
Average Daily Traffic (ADT), design year	0
Design year (ADT)	0
Latest percent truck traffic	7.1%
Existing posted speed	65 MPH
Expected posted speed	0 MPH
Development type	
Design speed	N/A
Design class	N/A
Number of roadways	2
Width of roadways	24 Feet
Number of lanes	2
Width of lanes	12 Feet
Shoulder width: Left	5.3 Feet
Shoulder width: Right	10 Feet
Clear zone	0 Feet
Structure minimum design loading	N/A
Clear roadway width of bridges	0 Feet
Median width: 0 Feet	
Cross section comments	

*Modified
see PCR*

Auxiliary lanes Go to top of page

Number	Description	Comment
No Auxiliary lanes for this segment.		

Attributes Go to top of page

	New alignment	
	Connecting highway	
	Acquire vision triangle	
	Bike accommodation	
	Curb	
	Curb and gutter	
	Exceptions to standards	
	Freeway operations coordination	
	Improve intersection	
	Improve horizontal alignment	
	Improve vertical alignment	
	Parking	
	Sidewalk	
	Storm sewer	
	Sanitary sewer replacement	
	Water main replacement	

Comments Go to top of page

Last updated by FELIX, JESSICA LOUIS on 07/26/2012

**Project ID :** 1190-02-11**Route :** USH 053**Title :** OSSEO - EAU CLAIRE**Sub Title :** IH 94 TO GOLF RD (NB & SB)**Region :** NORTHWEST**County :** EAU CLAIRE**Maintenance****Roadside Protection - Beam Guard and Barrier****New beam guard****Replace beam guard****Reuse beam guard on state work****Beam guard end treatment**✓ **Salvage beam guard for local government** Eau Claire County will take salvaged items.**New barrier****Replace barrier****Barrier end treatment****Special beam guard or barrier****Drainage - Storm Sewer****New pipe****Re-attach pipe ends****Realign pipe****Joints separated****Endwalls****Outfalls****Scour protection**✓ **Clean inlets, catch basins or underdrains** Golf Rd interchange inlets need cleaning.**Repair inlets, catch basins or underdrains****Upgrade inlets, catch basins or underdrains to standard****Special inlets, catch basins or underdrains****Combined storm/sanitary sewer system****Drainage - Culvert Pipes and Small Box Culverts****Culvert corrosion survey by:****Replace****Extend****Replace small box culverts with pipes****Culvert liners****Depressed****Undersized**

Heaved

Adequate size

Clean partially filled culverts

Wings moved

Weep holes

Drainage-Ditches

Ditch capacity problem

Ditch flow

Ditch siltation

Flume on NE ramp of IH 94/USH 53 interchange.

Ditch erosion

Drainage onto private property

Drainage from private property

Replace driveway/cross road culvert

Realign channel

Pave ditch

Sewers/tiling drain to ditch

Sediment, detention or retention ponds

Driveways (state if there are safety problems)

Permitted

Not permitted

Non-conforming

Illegal

Winter Driving

Areas of drifting snow

Areas of ice buildup

Pavement shaded, snowmelt sheeting

Trees shading road

Steep slopes shading road

Other

Vegetation-Management Plan

Living snow fence

No mow zone

Special seed mix

Reseeding in medians

Current vegetation management plan available

Vegetation-Erosion

Good ground cover

Eroding slopes**Vegetation-Trees****Clearing****Plantings****Glare screen****General Maintenance**✓ **Frost heave**

Joints and cracks tent in the winter.

Subgrade concerns**Drainage district****Cattle crossings or passes**✓ **Local government will take millings**

Eau Claire County will take what can be spared.

Outdoor advertising**Waysides****Scenic overlooks****Existing recreational trail(s)****Chain link fencing**✓ **Woven wire fencing**

Sections need to be repaired.

Fencing access gates**Right of way marker placement**✓ **Existing crossovers**

Re-pave cross-overs as needed.

New crossovers**Other hazards****Maintenance Comments**

[1] Pavement tenting throughout segment. [2] Right-of-way fence has sections that need to be repaired. [3] Golf Rd ramp inlets need to be cleaned. [4] IH 94 westbound to USH 53 northbound ramp has a concrete flume that needs to be cleaned. [5] Culverts are in good condition. [6] Ramp Gates are needed on the Golf Road interchange ramps. [7] Golf Road bridge over USH 53 has poor approaches and pavement between the ramps. [8] Golf Road ramps will need the longitudinal joints repaired or filled since the last warranty project patched these joints and will not last for long.

County Patrolperson Comments

The designer should contact the Eau Claire County Patrol Superintendent (Rich Walthers 715-829-1003) and the WisDOT Area Maintenance Coordinator (Richard Ricksecker 715-225-9318) to schedule a field review to get the maintenance history and problem areas on this segment of roadway.

Last updated by GINGRAS, PAUL A on 11/07/2013

**Project ID** : 1190-02-11**Route** : USH 053**Title** : OSSEO - EAU CLAIRE**Sub Title** : IH 94 TO GOLF RD (NB & SB)**Region** : NORTHWEST**County** : EAU CLAIRE**Soils and Pavements****Soils - General****Soils Report ****

Contingent upon request(s) from PDS, Pavt Designer, etc.

Select subgrade required**Type and quality of available material****Predominant soil type**

Sand

Design Group Index

6

Soil Support Value

5

Soils - Roadway Conditions**Potential frost susceptible soils****Marsh excavation****Bedrock or outcrops to be encountered****Slope stability issues****--->Cut sections****--->Fill sections****High water table****Springs/seeps****Underdrain problems****Excavation below subgrade****Floating road core/corduroy****Desirable grade line location****Two stage soil investigation required****Preliminary grade line review required****Final grade line review required****Soils - Borings****Soil borings required****--->At cut to fill transition****--->In cut sections****Structure borings required****Soil Comments**

Last updated by PERKINS, MICHAEL J on 11/07/2012

Pavements - General

<input checked="" type="checkbox"/>	Pavement Design Report **	Limited document
	Life cycle cost analysis required	na
<input type="checkbox"/>	Pavement Serviceability Index (PSI)	
<input type="checkbox"/>	International Roughness Index (IRI)	
Pavement Distress - PC Concrete		
	Raveled transverse joints and cracks	
	Raveled longitudinal joints and cracks	
	Cracked slabs with movement	
	Joint tenting	
	Surface spall	
Pavement Distress - Asphaltic		
<input checked="" type="checkbox"/>	Transverse cracking	
	Block cracking	
	Alligator cracking	
<input checked="" type="checkbox"/>	Raveled surface	
	Raveled edge	
Pavements - Evaluation/History		
<input checked="" type="checkbox"/>	Existing pavement structure	HMA over PCC
	Existing pavement condition	fair
	Year of original construction	1966
	Year(s) resurfaced/rehabilitated	Last resurfaced 2008
	Year(s) rut filled	
	Asphaltic Concrete Pavement (ACP)	approximate number of cores at foot intervals
	ACP thickness/verification & condition (not recycling cores)	approximate number of cores (at specific locations)
	Portland Cement Concrete (PCC) pavement	approximate number of cores at foot intervals
	PCC pavement depth verification & joint study (not pay cores)	approximate number of cores (at specific locations)
Pavement - Alternatives		
	Alternative Rehab Strategies (include life expectancy and approximate cost per mile)	
No Pavement - Alternatives		
Preliminary proposed alternative		
<p>UPDATED 11/14/13 AS PER DISCUSSION ON WEDNESDAY 11/13/13, THE FOLLOWING PAVEMENT TREATMENTS WERE FINALIZED FOR SCOPING PURPOSES: USH 53 MAINLINE and PASSING LANE SHOULDER--Surface mill 3.5" and replace with 3.5" HMA (probably E-10 in two layers with AC PG 64-34P). DRIVING LANE SHOULDER--Surface mill depth and overlay to match upper layer HMA thickness of 1.75". The NE,SE,SW RAMPS would receive a 2" Surface Mill and 2" HMA overlay. The NW Ramp would have a portion of the middle PCC lane replaced-no overlay</p>		

required. GOLF ROAD---Coarse grind existing PCC to a depth of 1.5"-1.75", clean and asphalt patch joints and cracks as necessary, and overlay area with 2.5"-3" HMA in two layers depending upon final design parameters and further roadway deterioration. Not discussed but should be included in estimate is approximately \$75,000 for non-doweled PCC repairs which was missed in previous entry----- (revised see above) The current proposal is to repeat the resurface that was done in 2008. This would involve surface mill to top of PCC (4 to 5.5 inches) and 4 inch minimum to 5.5 inch HMA overlay if crown correction is needed. A lesser cost treatment would be a 2 inch surface mill and 2 inch overlay. The treatment should depend on the timing of the future pavement replacement. Expected failure date, which is not known at this time, of existing pavement should also help determine treatment. Golf road ramps and any pavement WisDOT is responsible for on Golf Road should also be done with this project.

Pavement Comments**Last updated by LUEDTKE, RANDY W on 11/14/2013**

pmp

Project ID : 1190-02-11

Route : USH 053

Title : OSSEO - EAU CLAIRE

Sub Title : IH 94 TO GOLF RD (NB & SB)

Region : NORTHWEST

County : EAU CLAIRE

Ready Area

Structure Number	Existing Structure Type	Existing Structure ID	Existing Structure On	Existing Over/Under	Proposed Structure Work	Proposed Structure ID	Consultant Design Structure	Related Construction ID
1	FLAT SLAB CONT CONCRETE	B-18-0038	✓ USH 53 NB	TOWN RD	Epoxy Overlay	4510 S.F.		
3	DECK GIRDER PREST CONCRETE	B-18-0099	✓ AA	USH 53	No Structure Work	14,980 S.F.		
4	DECK GIRDER PREST CONCRETE	B-18-0183	USH 53 NB HASTINGS WAY	CYPRESS RD	Epoxy Overlay.	8520 S.F.		
5	DECK GIRDER PREST CONCRETE	B-18-0182	USH 53 NB	HASTINGS WAY	Epoxy Overlay	8600 S.F.		
6	DECK GIRDER CONT STEEL	B-18-0035	USH 53 SB	IH 94	Epoxy Overlay	11,615 S.F.		
7	DECK GIRDER CONT STEEL	B-18-0036	USH 53 NB	IH 94	Epoxy Overlay	11,915 S.F.		
8	FLAT SLAB CONT CONCRETE	B-18-0037	✓ USH 53 SB	TOWN RD	Epoxy Overlay	6275 S.F.		
9	DECK GIRDER PREST CONCRETE	B-18-0184	USH 53 SB HASTINGS WAY	CYPRESS RD	Epoxy Overlay	6410 S.F.		
10	DECK GIRDER PREST CONCRETE	B-18-0178	USH 53 SB	HASTINGS WAY	Epoxy Overlay	5940 S.F.		

Epoxy

$63,785 \text{ SF.}$

$\div 91 = 7097 \text{ S.F.}$

$\times 42$

$297,114 \text{ m}$



Project ID : 1190-02-11

Route : USH 053

Title : OSSEO - EAU CLAIRE

Sub Title : IH 94 TO GOLF RD (NB & SB)

Region : NORTHWEST

County : EAU CLAIRE

Structure # 1

Existing Structure	
Existing structure ID	B-18-0038
Existing structure type	FLAT SLAB CONT CONCRETE
Year constructed	1966
Latest year of rehab	2008
Current condition	
Bridge sufficiency number	98
Rate score	89.4
Vertical clearance	15
Clear roadway width	45.9
Last inspection date	07/11/2013
Posted load rating	
Inventory rating	HS21
Feature on	USH 53 NB
Feature over/under	TOWN RD
Location	0.6M N JCT IH 94 TO E
Existing Utilities	
Adjacent	
Under ground	
Affixed to structure	
Overhead	
Existing Lighting	
Overhead	
Lights mounted on structure	
Under deck	
Proposed Structure	
Proposed structure work **	Epoxy Overlay
Related Construction Project ID(s)	
Proposed structure ID	
Proposed aesthetic value **	No aesthetics
Structure Survey Report required	
Additional work required	

Consultant design structure	
High cost bridge	
Estimated structure cost	\$ 25,000
Proposed Utilities	
Adjacent	
Under ground	
Affixed to structure	
Overhead	
Proposed Lighting	
Overhead	
Lights mounted on structure	
Under deck	
Additional Information	
Dam	
Approach work	
Approach slabs	
Existing foundations	
Gauging station (USGS)	
Pedestrian/bike lanes	
Snowmobiles	
Canoe/boat landing	
Fisherman's platform	
Signs mounted on bridge	
Comments	

Last updated by HAIG, GREGORY H on 10/16/2013



Project ID : 1190-02-11

Route : USH 053

Title : OSSEO - EAU CLAIRE

Sub Title : IH 94 TO GOLF RD (NB & SB)

Region : NORTHWEST

County : EAU CLAIRE

Structure # 3

Existing Structure	
Existing structure ID	B-18-0099
Existing structure type	DECK GIRDER PREST CONCRETE
Year constructed	1986
Latest year of rehab	1986
Current condition	
Bridge sufficiency number	97.4
Rate score	94
Vertical clearance	18.17
Clear roadway width	66
Last inspection date	07/10/2013
Posted load rating	
Inventory rating	HS25
Feature on	AA
Feature over/under	USH 53
Location	AT JCT USH 53-CTH AA
Existing Utilities	
Adjacent	
Under ground	
Affixed to structure	
Overhead	
Existing Lighting	
Overhead	
Lights mounted on structure	
Under deck	
Proposed Structure	
Proposed structure work **	No Structure Work
Related Construction Project ID(s)	
Proposed structure ID	
Proposed aesthetic value **	No aesthetics
Structure Survey Report required	
Additional work required	

Consultant design structure	
High cost bridge	
Estimated structure cost	\$ 0
Proposed Utilities	
Adjacent	
Under ground	
Affixed to structure	
Overhead	
Proposed Lighting	
Overhead	
Lights mounted on structure	
Under deck	
Additional Information	
Dam	
Approach work	
Approach slabs	
Existing foundations	
Gauging station (USGS)	
Pedestrian/bike lanes	
Snowmobiles	
Canoe/boat landing	
Fisherman's platform	
Signs mounted on bridge	
Comments	

Last updated by FELIX, JESSICA L on 07/26/2012



Project ID : 1190-02-11

Route : USH 053

Title : OSSEO - EAU CLAIRE

Sub Title : IH 94 TO GOLF RD (NB & SB)

Region : NORTHWEST

County : EAU CLAIRE

Structure # 4

Existing Structure

Existing structure ID	B-18-0183
Existing structure type	DECK GIRDER PREST CONCRETE
Year constructed	2005
Latest year of rehab	2005
Current condition	
Bridge sufficiency number	94.7
Rate score	100
Vertical clearance	15
Clear roadway width	86.2
Last inspection date	07/11/2013
Posted load rating	
Inventory rating	HS24
Feature on	USH 53 NB HASTINGS WAY
Feature over/under	CYPRESS RD
Location	AT CYPRESS RD

Existing Utilities

Adjacent	
Under ground	
Affixed to structure	
Overhead	

Existing Lighting

Overhead	
Lights mounted on structure	
Under deck	

Proposed Structure

Proposed structure work **	Epoxy Overlay
Related Construction Project ID(s)	
Proposed structure ID	
Proposed aesthetic value **	No aesthetics
Structure Survey Report required	
Additional work required	

Consultant design structure	
High cost bridge	
Estimated structure cost	\$ 44,000
Proposed Utilities	
Adjacent	
Under ground	
Affixed to structure	
Overhead	
Proposed Lighting	
Overhead	
Lights mounted on structure	
Under deck	
Additional Information	
Dam	
Approach work	
Approach slabs	
Existing foundations	
Gauging station (USGS)	
Pedestrian/bike lanes	
Snowmobiles	
Canoe/boat landing	
Fisherman's platform	
Signs mounted on bridge	
Comments	

Last updated by HAIG, GREGORY H on 10/16/2013



Project ID : 1190-02-11

Route : USH 053

Title : OSSEO - EAU CLAIRE

Sub Title : IH 94 TO GOLF RD (NB & SB)

Region : NORTHWEST

County : EAU CLAIRE

Structure # 5

Existing Structure	
Existing structure ID	B-18-0182
Existing structure type	DECK GIRDER PREST CONCRETE
Year constructed	2006
Latest year of rehab	2006
Current condition	
Bridge sufficiency number	96.2
Rate score	97.5
Vertical clearance	16.5
Clear roadway width	55.4
Last inspection date	07/16/2013
Posted load rating	
Inventory rating	HS23
Feature on	USH 53 NB
Feature over/under	HASTINGS WAY
Location	0.9M E JCT CTH KK
Existing Utilities	
Adjacent	
Under ground	
Affixed to structure	
Overhead	
Existing Lighting	
Overhead	
Lights mounted on structure	
Under deck	
Proposed Structure	
Proposed structure work **	Epoxy Overlay
Related Construction Project ID(s)	
Proposed structure ID	
Proposed aesthetic value **	No aesthetics
Structure Survey Report required	
Additional work required	

Consultant design structure	
High cost bridge	
Estimated structure cost	\$ 45,000
Proposed Utilities	
Adjacent	
Under ground	
Affixed to structure	
Overhead	
Proposed Lighting	
Overhead	
Lights mounted on structure	
Under deck	
Additional Information	
Dam	
Approach work	
Approach slabs	
Existing foundations	
Gauging station (USGS)	
Pedestrian/bike lanes	
Snowmobiles	
Canoe/boat landing	
Fisherman's platform	
Signs mounted on bridge	
Comments	

Last updated by HAIG, GREGORY H on 10/16/2013



Project ID : 1190-02-11

Route : USH 053

Title : OSSEO - EAU CLAIRE

Sub Title : IH 94 TO GOLF RD (NB & SB)

Region : NORTHWEST

County : EAU CLAIRE

Structure # 6

Existing Structure	
Existing structure ID	B-18-0035
Existing structure type	DECK GIRDER CONT STEEL
Year constructed	1966
Latest year of rehab	2011
Current condition	
Bridge sufficiency number	75.6
Rate score	89
Vertical clearance	17.42
Clear roadway width	43
Last inspection date	07/02/2013
Posted load rating	
Inventory rating	HS16
Feature on	USH 53 SB
Feature over/under	IH 94
Location	2.5M S JCT STH 93 TO S
Existing Utilities	
Adjacent	
Under ground	
Affixed to structure	
Overhead	
Existing Lighting	
Overhead	
Lights mounted on structure	
Under deck	
Proposed Structure	
Proposed structure work **	Epoxy Overlay
Related Construction Project ID(s)	
Proposed structure ID	
Proposed aesthetic value **	No aesthetics
Structure Survey Report required	
Additional work required	

Consultant design structure	
High cost bridge	
Estimated structure cost	\$ 60,000
Proposed Utilities	
Adjacent	
Under ground	
Affixed to structure	
Overhead	
Proposed Lighting	
Overhead	
Lights mounted on structure	
Under deck	
Additional Information	
Dam	
Approach work	
Approach slabs	
Existing foundations	
Gauging station (USGS)	
Pedestrian/bike lanes	
Snowmobiles	
Canoe/boat landing	
Fisherman's platform	
Signs mounted on bridge	
Comments	

Last updated by HAIG, GREGORY H on 10/16/2013



Project ID : 1190-02-11

Route : USH 053

Title : OSSEO - EAU CLAIRE

Sub Title : IH 94 TO GOLF RD (NB & SB)

Region : NORTHWEST

County : EAU CLAIRE

Structure # 7

Existing Structure	
Existing structure ID	B-18-0036
Existing structure type	DECK GIRDER CONT STEEL
Year constructed	1966
Latest year of rehab	2011
Current condition	
Bridge sufficiency number	74.5
Rate score	89
Vertical clearance	16.92
Clear roadway width	43.1
Last inspection date	07/02/2013
Posted load rating	
Inventory rating	HS15
Feature on	USH 53 NB
Feature over/under	IH 94
Location	0.2M N JCT CTH II
Existing Utilities	
Adjacent	
Under ground	
Affixed to structure	
Overhead	
Existing Lighting	
Overhead	
Lights mounted on structure	
Under deck	
Proposed Structure	
Proposed structure work **	Epoxy Overlay
Related Construction Project ID(s)	
Proposed structure ID	
Proposed aesthetic value **	No aesthetics
Structure Survey Report required	
Additional work required	

Consultant design structure	
High cost bridge	
Estimated structure cost	\$ 65,000
Proposed Utilities	
Adjacent	
Under ground	
Affixed to structure	
Overhead	
Proposed Lighting	
Overhead	
Lights mounted on structure	
Under deck	
Additional Information	
Dam	
Approach work	
Approach slabs	
Existing foundations	
Gauging station (USGS)	
Pedestrian/bike lanes	
Snowmobiles	
Canoe/boat landing	
Fisherman's platform	
Signs mounted on bridge	
Comments	

Last updated by HAIG, GREGORY H on 10/16/2013



Project ID : 1190-02-11

Route : USH 053

Title : OSSEO - EAU CLAIRE

Sub Title : IH 94 TO GOLF RD (NB & SB)

Region : NORTHWEST

County : EAU CLAIRE

Structure # 8

Existing Structure	
Existing structure ID	B-18-0037
Existing structure type	FLAT SLAB CONT CONCRETE
Year constructed	1966
Latest year of rehab	2008
Current condition	
Bridge sufficiency number	98
Rate score	89.4
Vertical clearance	14.5
Clear roadway width	64
Last inspection date	07/11/2013
Posted load rating	
Inventory rating	HS21
Feature on	USH 53 SB
Feature over/under	TOWN RD
Location	2.1M S JCT STH 93 TO S
Existing Utilities	
Adjacent	
Under ground	
Affixed to structure	
Overhead	
Existing Lighting	
Overhead	
Lights mounted on structure	
Under deck	
Proposed Structure	
Proposed structure work **	Epoxy Overlay
Related Construction Project ID(s)	
Proposed structure ID	
Proposed aesthetic value **	No aesthetics
Structure Survey Report required	
Additional work required	

Consultant design structure	
High cost bridge	
Estimated structure cost	\$ 40,000
Proposed Utilities	
Adjacent	
Under ground	
Affixed to structure	
Overhead	
Proposed Lighting	
Overhead	
Lights mounted on structure	
Under deck	
Additional Information	
Dam	
Approach work	
Approach slabs	
Existing foundations	
Gauging station (USGS)	
Pedestrian/bike lanes	
Snowmobiles	
Canoe/boat landing	
Fisherman's platform	
Signs mounted on bridge	
Comments	

Last updated by HAIG, GREGORY H on 10/16/2013



Project ID : 1190-02-11

Route : USH 053

Title : OSSEO - EAU CLAIRE

Sub Title : IH 94 TO GOLF RD (NB & SB)

Region : NORTHWEST

County : EAU CLAIRE

Structure # 9

Existing Structure

Existing structure ID	B-18-0184
Existing structure type	DECK GIRDER PREST CONCRETE
Year constructed	2005
Latest year of rehab	2005
Current condition	
Bridge sufficiency number	94.7
Rate score	100
Vertical clearance	15
Clear roadway width	64.9
Last inspection date	07/11/2013
Posted load rating	
Inventory rating	HS24
Feature on	USH 53 SB HASTINGS WAY
Feature over/under	CYPRESS RD
Location	AT CYPRESS RD

Existing Utilities

Adjacent	
Under ground	
Affixed to structure	
Overhead	

Existing Lighting

Overhead	
Lights mounted on structure	
Under deck	

Proposed Structure

Proposed structure work **	Epoxy Overlay
Related Construction Project ID(s)	
Proposed structure ID	
Proposed aesthetic value **	No aesthetics
Structure Survey Report required	
Additional work required	

Consultant design structure	
High cost bridge	
Estimated structure cost	\$ 35,000
Proposed Utilities	
Adjacent	
Under ground	
Affixed to structure	
Overhead	
Proposed Lighting	
Overhead	
Lights mounted on structure	
Under deck	
Additional Information	
Dam	
Approach work	
Approach slabs	
Existing foundations	
Gauging station (USGS)	
Pedestrian/bike lanes	
Snowmobiles	
Canoe/boat landing	
Fisherman's platform	
Signs mounted on bridge	
Comments	

Last updated by HAIG, GREGORY H on 10/16/2013



Project ID : 1190-02-11

Route : USH 053

Title : OSSEO - EAU CLAIRE

Sub Title : IH 94 TO GOLF RD (NB & SB)

Region : NORTHWEST

County : EAU CLAIRE

Structure # 10

Existing Structure

Existing structure ID	B-18-0178
Existing structure type	DECK GIRDER PREST CONCRETE
Year constructed	2006
Latest year of rehab	2006
Current condition	
Bridge sufficiency number	100
Rate score	100
Vertical clearance	17.1
Clear roadway width	40
Last inspection date	07/16/2013
Posted load rating	
Inventory rating	HS24
Feature on	USH 53 SB
Feature over/under	HASTINGS WAY
Location	0.7M S JCT CTH HH

Existing Utilities

Adjacent	
Under ground	
Affixed to structure	
Overhead	

Existing Lighting

Overhead	
Lights mounted on structure	
Under deck	

Proposed Structure

Proposed structure work **	Epoxy Overlay
Related Construction Project ID(s)	
Proposed structure ID	
Proposed aesthetic value **	No aesthetics
Structure Survey Report required	
Additional work required	

Consultant design structure	
High cost bridge	
Estimated structure cost	\$ 35,000
Proposed Utilities	
Adjacent	
Under ground	
Affixed to structure	
Overhead	
Proposed Lighting	
Overhead	
Lights mounted on structure	
Under deck	
Additional Information	
Dam	
Approach work	
Approach slabs	
Existing foundations	
Gauging station (USGS)	
Pedestrian/bike lanes	
Snowmobiles	
Canoe/boat landing	
Fisherman's platform	
Signs mounted on bridge	
Comments	

Last updated by HAIG, GREGORY H on 10/16/2013



Project ID : 1190-02-11

Route : USH 053

Title : OSSEO - EAU CLAIRE

Sub Title : IH 94 TO GOLF RD (NB & SB)

Region : NORTHWEST

County : EAU CLAIRE

Traffic**Crash Data**

Crash data year	From 2006 To: 2012
Crash rate per 100 mil VMT	80
Statewide crash rate per 100 mil VMT	78
Fatality rate per 100 mil VMT	0
Percent fatality per 100 mil VMT	0
Percent injury per 100 mil VMT	26.9
Number of fatality crashes per 100 mil VMT	0
Number of injury crashes per 100 mil VMT	22
Number of property damage crashes per 100 mil VMT	59
Intersection crash rate per 100 mil VMT	0
Safety concerns	
Roadside barriers	

Passing Information

Current passing percentage	0
Increase passing percentage to	0

Traffic Capacity

Level of service, existing	A - Not congested 1.01 to 2.00
Level of service, after improvement	A - Not congested 1.01 to 2.00
Traffic capacity analysis	

Lighting

Existing type and condition

Proposed (standard or decorative)

Continuous, located in (median or roadside)

Lighting at isolated intersections

Install conduit, pull boxes and bases only

Traffic Signals and Roundabout(s)

Proposed signal study by

Proposed signal(s) to be designed by

Proposed signal(s) to be operated by

Proposed signal(s) to be maintained by

New signal(s) proposed **

Proposed signal agreement required

Proposed signal(s) require pedestrian, bicycle provisions

Proposed signal(s) require railroad preemption

Proposed signal(s) will be interconnected

Existing or proposed signals at isolated Intersections

Existing signal(s)

Roundabout(s)

Temporary Signals

Temporary signal study by

Temporary signal(s) to be designed by

Temporary signal(s) to be operated by

Temporary signal(s) to be maintained by

Temporary signal(s) timing by

Temporary signal agreement required

Temporary signal(s) require pedestrian/bicycle provisions

Temporary signal(s) require railroad preemption

Temporary signal(s) will be interconnected

Signal Installation and Improvements

Traffic signal or automatic traffic recorder loop impacts

Install conduit, loops, pull boxes and bases only

Replace controller in cabinet

Replace signal heads and lamps

Replace poles

Modify signal timing

Modify traffic signal communication

Existing Flashers

Existing flashers operated by

Existing flashers maintained by

Existing flasher agreement required

Flasher(s) revised under project

Pavement Marking

Existing type and condition

✓ **Proposed: epoxy**

Proposed: paint

Proposed: tape

Follow TGM pavement marking policies

Proposed: other**Existing Signing****Type and condition**✓ **Type 1**

Check with Eau Claire Sign Shop

✓ **Type 2**

Check with Eau Claire Sign Shop

Type 3**Proposed Signing**✓ **Type 1**

Check with Eau Claire Sign Shop

✓ **Type 2**

Check with Eau Claire Sign Shop

Type 3**Traffic Miscellaneous****New regulatory speed zones****Existing sign bridge(s)****Destination signing****Existing incident management signing****Proposed incident management signing****TMP project type 1**✓ **TMP project type 2****TMP project type 3****TMP project type 4****Intelligent Transportation System (ITS)******Proposed or existing Intelligent Transportation System****Closed circuit TV****Crash investigation sites****Dynamic trailblazers****Electronic blank out signs****Enhanced reference markers****Ramp meters****System detector stations****Traffic gates****Variable message signs****Construction Issues****Traffic Control Type**

Staged under traffic

State patrol mitigation contract estimated amount

\$ 0

Work zone State Patrol mitigation contract**Detour route: location/concerns****Construction will impact emergency or bus services****Work zone advisory speeds**

- ✓ **Work zone enforceable regulatory speeds** 55 mph during work operations
- Narrow roadway widths**
- Reduced vertical clearance**
- ✓ **Oversize/overweight vehicle impacts** See comments
- Temporary roads**
- Highway advisory radio**
- Changeable message signs**
- ✓ **Advance signing**

Comments

Preliminary safety screening. Meta crash data for 2006-2010, crash data 2006-2010, available 2011 and 2012. USH 53 NB RP 122 + 0.00 to RP 122G + 0.00: LOP 8. Rate and Intersection flags. 3 crashes; 1 weather; 1 rear-end; 1 ROR and 1 sideswipe same; Waive improvement flag. USH 53 SB RP 122G +0.00 to RP 122 + 0.00: LOP 4. Rate, intersection, and spot flags. 13 crashes; 5 weather; 4 rear-end; 2 sideswipe same; 7 ROR; Waive improvement flag. This project lies on an OS/OW route, OS/OW loads will need to be addressed during construction. Type II signs should be replaced with the 2017 project, Type I signs should be replaced with the 2023 project. TMP Concept: After cursory review of traffic data, Traffic recommends Night Time Work only.

Last updated by BACHMAN, STEVEN M on 08/02/2013

**Project ID** : 1190-02-11**Route** : USH 053**Title** : OSSEO - EAU CLAIRE**Sub Title** : IH 94 TO GOLF RD (NB & SB)**Region** : NORTHWEST**County** : EAU CLAIRE

Subject Area	Subject Code	Author	Date
20 Scope Approval	Program Scoping - Current	VORK, REBECCA S	08/19/2013
20 Scope Definition	Program Scoping	VORK, REBECCA S	08/19/2013
23 Scope Definition	Program Scoping	HAYEK, MOHAMAD M	03/14/2013
structures scope of work	Structures	FELIX, JESSICA L	03/01/2013
1 Introduction	Program Scoping	SYDOW, STEPHEN E	08/27/2012
limit change	Design Segment	FELIX, JESSICA L	08/17/2012
Golf Road Interchange	Program Scoping	FELIX, JESSICA L	07/26/2012

C overlay

**Project ID** : 1190-02-11**Route** : USH 053**Title** : OSSEO - EAU CLAIRE**Sub Title** : IH 94 TO GOLF RD (NB & SB)**Region** : NORTHWEST**County** : EAU CLAIRE

Project Notes

Subject Area	Golf Road Interchange
Author	FELIX, JESSICA L
Subject Code	Program Scoping
Notes	Scoping team to review <u>overlay</u> of the interchange as well and mainline

**Project ID** : 1190-02-11**Route** : USH 053**Title** : OSSEO - EAU CLAIRE**Sub Title** : IH 94 TO GOLF RD (NB & SB)**Region** : NORTHWEST**County** : EAU CLAIRE

Project Notes

Subject Area	limit change
Author	FELIX, JESSICA L
Subject Code	Design Segment
Notes	8/17/2012: Project limits will be changed to north of IH 94/USH 53 Interchange to Golf Rd. Design segment has had recent projects from the interchange to Old Town Rd and does not require a resurf. New RPs: 053N 121+0.13 to 053N 122G+0.00 053S 122G+0.00 to 053S 122+0.33

**Project ID** : 1190-02-11**Route** : USH 053**Title** : OSSEO - EAU CLAIRE**Sub Title** : IH 94 TO GOLF RD (NB & SB)**Region** : NORTHWEST**County** : EAU CLAIRE

Project Notes

Subject Area	1 Introduction
Author	SYDOW, STEPHEN E
Subject Code	Program Scoping
Notes	8/1/2012 Scoping Meeting: -Scope the 2017 RESURF and then will take to BB Committee for approval into the 6-year program (this project is currently not in the program) -Last overlay in 2008. -PVRPLA currently scheduled in 2023. -all to review, report, & fill out section in PMP. -Move to Scope Definition Phase (II) next meeting.

**Project ID** : 1190-02-11**Route** : USH 053**Title** : OSSEO - EAU CLAIRE**Sub Title** : IH 94 TO GOLF RD (NB & SB)**Region** : NORTHWEST**County** : EAU CLAIRE

Project Notes

Subject Area	23 Scope Definition
Author	HAYEK, MOHAMAD M
Subject Code	Program Scoping
Notes	12/5/2012 Scoping Meeting: -will tie to above if we can. -will include Golf Road ramps with this project. -Greg Haig to look at bridge, since we'll have traffic control with this project. -Programming getting clarification on WisDOT, county and city responsibilities/ownership at Golf Road Interchange (limits past ramps and bridge) -traffic to look at signs. -stays at Scope Definition Phase (II) next meeting. 10/3/2012 Scoping Meeting: -comments are in PMP -warranted pavement last time done, no AC in mix. -discussed tying to #21 (1190-06-31,61), but it depends on how the pavement holds -determined to leave separate for now; monitor during design process and tie projects together later if appropriate -stays at Scope Definition Phase (II) next meeting. 8/1/2012 Scoping Meeting: -Scope the 2017 RESURF and then will take to BB Committee for approval into the 6-year program (this project is currently not in the program) -Last overlay in 2008. -PVRPLA currently scheduled in 2023. -all to review, report, & fill out section in PMP. -Move to Scope Definition Phase (II) next meeting.

**Project ID** : 1190-02-11**Route** : USH 053**Title** : OSSEO - EAU CLAIRE**Sub Title** : IH 94 TO GOLF RD (NB & SB)**Region** : NORTHWEST**County** : EAU CLAIRE

Project Notes

Subject Area	structures scope of work
Author	FELIX, JESSICA L
Subject Code	Structures
Notes	03/01/2013: Per Greg Haig, no structure work included as part of this project's scope of work.

8/19/13

**Project ID** : 1190-02-11**Route** : USH 053**Title** : OSSEO - EAU CLAIRE**Sub Title** : IH 94 TO GOLF RD (NB & SB)**Region** : NORTHWEST**County** : EAU CLAIRE**Project Notes**

Subject Area	20 Scope Definition
Author	VORK, REBECCA S
Subject Code	Program Scoping
Notes	<p>08/07/2013 Scoping Meeting: -Will include Golf Road, have to check estimate and include southbound off ramp. -Move to Scope Approval Phase (III)</p> <p>04/10/2013 Scoping Meeting: -need a TMP concept -no bridge work right now; just ramp work -need to review EC County and City of EC work -FYI: Planning is working with the City of Altoona for Gateway Drive extension to USH 12(2016/2017 budget. Will only have 2 years to complete the project if approved): -Hillcrest Golf Course is being redeveloped -DOT is working with CF/EC MPO on this and will keep the scoping team informed -create a new local bridge and approaches (DOT would contribute 1/3 of this cost) -curb cuts are included in the ramps at Golf Road -add SB off ramp to the scope -keep at Scope Definition Phase (II)</p> <p>02/06/2013 Scoping Meeting: -does the City of EC or the Cty of EC have any work planned that we need to coordinate with? -structures to review the bridges within this segment [UPDATE</p> <p>03/01/2013: Per Greg Haig, no structure work included as part of this project's scope of work] -scope should include any needed work on Golf Road between the ramp terminals (ours to maintain) -Requested traffic section/Matt Reddy provide list of signs to be replaced and added [UPDATE: spreadsheet of signs provided to Programming & PDS] -traffic section to review/comment on traffic control restrictions/requirements, especially at Golf Rd -letter from the City of EC sent to Greg Helgeson about sidewalk on Golf Road -Greg Helgeson recommends that this project include ramp cutouts at the bridge sidewalks to make the ADA compliant ramps at all 4 ramp terminals (curb ramps, curb cuts through pork chops) -Stays at Scope Definition Phase (II)</p>

8/19/13

**Project ID** : 1190-02-11**Route** : USH 053**Title** : OSSEO - EAU CLAIRE**Sub Title** : IH 94 TO GOLF RD (NB & SB)**Region** : NORTHWEST**County** : EAU CLAIRE

Project Notes

Subject Area	20 Scope Approval
Author	VORK, REBECCA S
Subject Code	Program Scoping - Current
Notes	10/02/2013 Scoping Meeting: 08/07/2013 Scoping Meeting: -Will include Golf Road, have to check estimate and include southbound off ramp. -Move to Scope Approval Phase (III)

**Project ID** : 1190-02-11**Route** : USH 053**Title** : OSSEO - EAU CLAIRE**Sub Title** : IH 94 TO GOLF RD (NB & SB)**Region** : NORTHWEST**County** : EAU CLAIRE

Project Notes**Subject Area** 16 Scope Approval**Author** VORK, REBECCA S**Subject Code** Program Scoping - Current

Notes

11/07/2013 Scoping Meeting: -IH 94 to Golf, including Golf Rd interchange - The estimate for interchange work will be grind and overlay of the interchange concrete unless Pavements indicates that this will not work. -City and County Road approaches are asphalt -Resurface project; therefore, ITS allowed. Scope to include ramp gates at Golf Rd. -Recently (November 2013) repaired some warranty areas; however, some areas that were not repaired. -Rick Shermo would like to talk to Randy, extent of ramp repairs and pavement treatment on top. -Golf Road Bridge: Will we need to widen for capacity purposes? Does the city want to pursue that? Would revisit some other options. Haven't had traffic spilling out to freeway thru lanes. Up to City if they want to pursue any expansion at Golf Road Interchange. Could have that discussion now with the City to update and see if they are interested in expansion and when. -Rick will discuss what we are planning with the City and County to start discussions. -Keep at scope Approval Phase III

08/07/2013 Scoping Meeting: -Will include Golf Road, have to check estimate and include southbound off ramp. -Move to Scope Approval Phase (III)