

S:\5165312\Plat\TPP100-WillowCrk.dwg, Title Sheet, 2/5/2014 2:52:49 PM, gak

4

CONVENTIONAL ABBREVIATIONS			
ACCESS POINT/ DRIVEWAY CONNECTION	AP	REFERENCE LINE	R/L
ACCESS RIGHTS	AR	RELEASE OF RIGHTS	ROR
ACRES	AC.	REMAINING	REM.
AND OTHERS	ET.AL.	RIGHT-OF-WAY	R/W
CENTERLINE	C/L	SECTION	SEC.
CERTIFIED SURVEY MAP	CSM	STATION	STA.
CORNER	COR.	TEMPORARY LIMITED EASEMENT	TLE
DOCUMENT	DOC.	VOLUME	V.
EASEMENT	EASE.	CURVE DATA	
HIGHWAY EASEMENT	H.E.	LONG CHORD	LCH
LAND CONTRACT	LC	LONG CHORD BEARING	LCB
MONUMENT	MON.	RADIUS	R
PAGE	P.	DEGREE OF CURVE	D
PERMANENT LIMITED EASEMENT	PLE	CENTRAL ANGLE OR DELTA	DELTA
PROPERTY LINE	PL	LENGTH OF CURVE	L
RECORDED AS	(100')	TANGENT	TAN
CONVENTIONAL SYMBOLS			
FOUND IRON PIPE/PIN	IF (1" UNLESS NOTED)	PROPOSED R/W LINE	_____
R/W MONUMENT	• (SET)	EXISTING H.E. LINE	_____
R/W STANDARD	▲ (SET)	PROPERTY LINE	_____
SIGN	ISIGN	LOT & TIE LINES	_____
SECTION CORNER MONUMENT		SLOPE INTERCEPTS	_____
SECTION CORNER SYMBOL		CORPORATE LIMITS	_____
FEE (HATCH VARIES)	_____	NO ACCESS (BY PREVIOUS ACQUISITION/CONTROL)	_____
TEMPORARY LIMITED EASEMENT	_____	ACCESS RESTRICTED (BY ACQUISITION)	_____
PERMANENT LIMITED EASEMENT	_____	ACCESS RESTRICTED (BY STATUTORY AUTHORITY)	_____
R/W BOUNDARY POINT	RWB20	SECTION LINE	_____
PARCEL NUMBER	102	QUARTER LINE	_____
UTILITY PARCEL NUMBER	92	SIXTEENTH LINE	_____
SIGN NUMBER (OFF PREMISE)	21	EXISTING CENTERLINE	_____
BUILDING		PROPOSED REFERENCE LINE	_____
		PARALLEL OFFSET	_____
CONVENTIONAL UTILITY SYMBOLS			
WATER	W		
GAS	G		
TELEPHONE	T		
OVERHEAD TRANSMISSION LINES	OH		
ELECTRIC	E		
CABLE TELEVISION	TV		
FIBER OPTIC	FO		
SANITARY SEWER	SAN		
STORM SEWER	SS		
NON COMPENSABLE		COMPENSABLE	
POWER POLE	⊕	TELEPHONE POLE	⊕
TELEPHONE POLE	⊕	TELEPHONE PEDESTAL	⊕
TELEPHONE PEDESTAL	⊕	ELECTRIC TOWER	⊕

NOTES:

POSITIONS SHOWN ON THIS PLAT ARE WISCONSIN COUNTY COORDINATES, FOND DU LAC COUNTY, NAD83 (2007) IN US SURVEY FEET. VALUES SHOWN ARE GRID COORDINATES, GRID BEARINGS, AND GRID DISTANCES. GRID DISTANCES MAY BE USED AS GROUND DISTANCES.

RIGHT-OF-WAY MONUMENTS ARE TYPE 2 AND WILL BE PLACED PRIOR TO THE COMPLETION OF THE PROJECT BY _____.

FOR THE LATEST ACCESS/DRIVEWAY INFORMATION CONTACT THE PLANNING DEPARTMENT OF THE WISCONSIN DEPARTMENT OF TRANSPORTATION OFFICE IN _____.

RIGHT-OF-WAY BOUNDARIES ARE DEFINED WITH COURSES OF THE PERIMETER OF THE HIGHWAY LANDS REFERENCED TO THE U.S. PUBLIC LAND SURVEY SYSTEM OR OTHER "SURVEYS OF PUBLIC RECORD".

PROPERTY LINES SHOWN ON THIS PLAT ARE DRAWN FROM DATA DERIVED FROM MAPS AND DOCUMENTS OF PUBLIC RECORD AND/OR EXISTING OCCUPATIONAL LINES. THIS PLAT MAY NOT BE A TRUE REPRESENTATION OF EXISTING PROPERTY LINES, EXCLUDING RIGHT-OF-WAY LINES, AND SHOULD NOT BE USED AS A SUBSTITUTE FOR AN ACCURATE FIELD SURVEY.

EXISTING HIGHWAY RIGHT-OF-WAY SHOWN HEREIN IS BASED ON THE FOLLOWING POINTS OF REFERENCE:

A **TEMPORARY LIMITED EASEMENT** (TLE) IS A RIGHT FOR CONSTRUCTION PURPOSES, AS DEFINED HEREIN, INCLUDING THE RIGHT TO OPERATE NECESSARY EQUIPMENT THEREON AND THE RIGHT OF INGRESS AND EGRESS, AS LONG AS REQUIRED FOR SUCH PUBLIC PURPOSE, INCLUDING THE RIGHT TO PRESERVE, PROTECT, REMOVE, OR PLANT THEREON ANY VEGETATION THAT THE HIGHWAY AUTHORITIES MAY DEEM NECESSARY OR DESIRABLE. ALL TLE'S ARE TO EXPIRE AT THE COMPLETION OF THE CONSTRUCTION PROJECT FOR WHICH THIS INSTRUMENT IS GIVEN

A **PERMANENT LIMITED EASEMENT** (PLE) IS A RIGHT FOR CONSTRUCTION AND MAINTENANCE PURPOSES, AS DEFINED HEREIN, INCLUDING THE RIGHT TO OPERATE NECESSARY EQUIPMENT THEREON AND THE RIGHT OF INGRESS AND EGRESS, AS LONG AS REQUIRED FOR SUCH PUBLIC PURPOSE, INCLUDING THE RIGHT TO PRESERVE, PROTECT, REMOVE, OR PLANT THEREON ANY VEGETATION THAT THE HIGHWAY AUTHORITIES MAY DEEM NECESSARY OR DESIRABLE. BUT WITHOUT PREJUDICE TO THE OWNER'S RIGHT TO MAKE OR CONSTRUCT IMPROVEMENT ON SAID LANDS OR TO FLATTEN THE SLOPES, PROVIDING SAID ACTIVITIES WILL NOT IMPAIR OR OTHERWISE ADVERSELY AFFECT THE HIGHWAY FACILITIES.

DIMENSIONING FOR THE NEW RIGHT-OF-WAY IS MEASURED ALONG AND PERPENDICULAR TO NEW REFERENCE LINES.

STATE OF WISCONSIN
DEPARTMENT OF TRANSPORTATION

TRANSPORTATION PROJECT PLAT TITLE SHEET

PROJECT NO. 1110-10-21

CITY OF WAUPUN

NEITMAN RD TO 1/2 MI NORTH OF WILLOW CREEK RD

STH 26

FOND DU LAC COUNTY

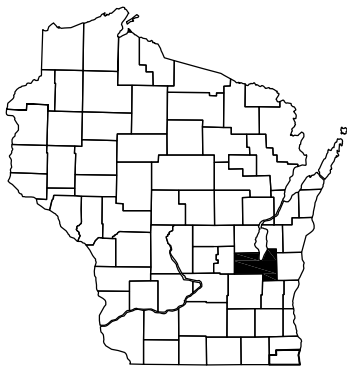

4

END PROJECT

STA 390+79.76

X = _____
Y = _____

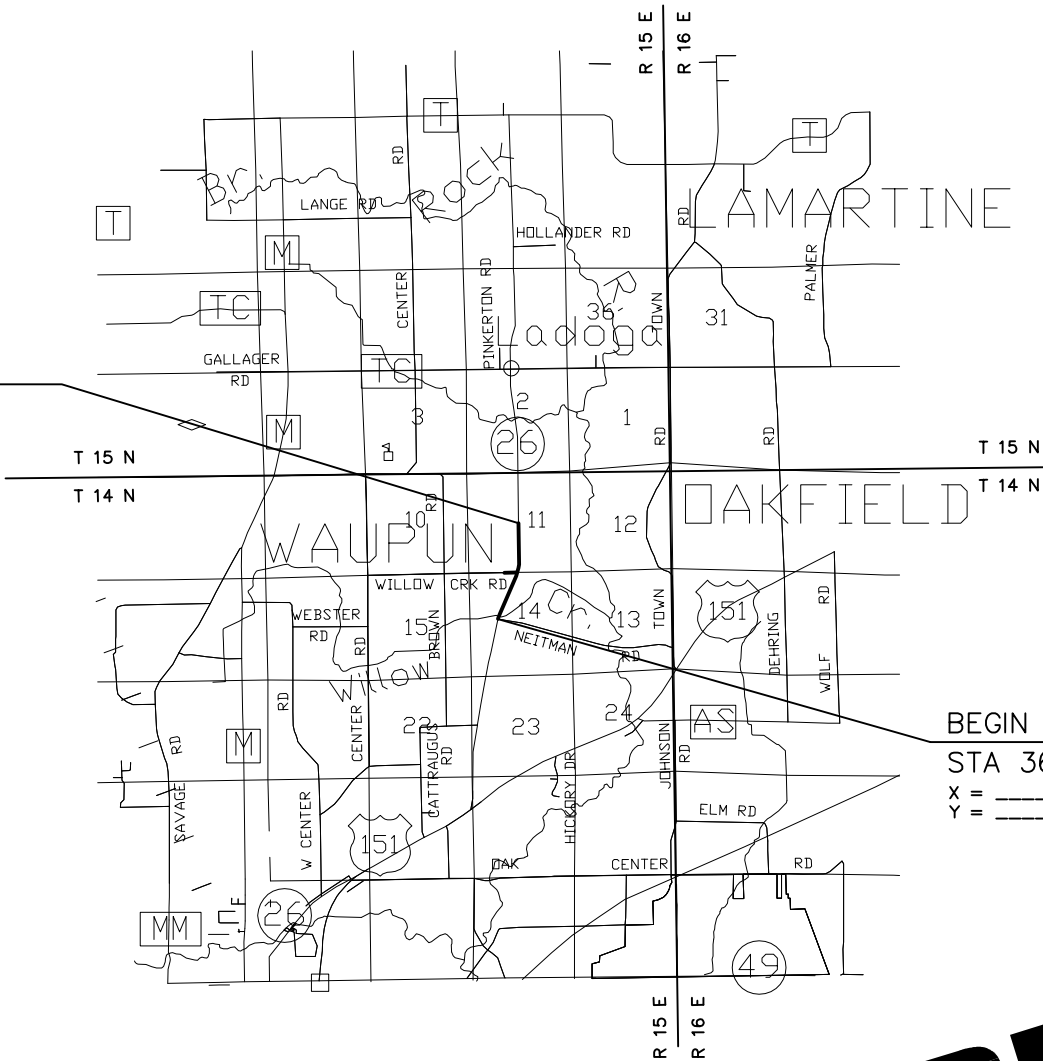

BEGIN PROJECT

STA 362+91.02

X = _____
Y = _____



PRELIMINARY
1-31-2014

LAYOUT

NO SCALE



TOTAL NET LENGTH OF CENTERLINE = ____ MI.

ORIGINAL PLAT PREPARED BY
R.A. Smith National
Beyond Surveying and Engineering
16146 W. 28th Avenue, Suite 200, Oak Brook, IL 60151
262-591-0100 Fax 262-591-0466
www.ra-smith.com

TPP PROJECT NUMBER 1110-10-21 - 4.01
SHEET 2 OF 2

4

S:\5165312\Plat\TPP100-WillowCrk.dwg, TPP Sheet 4.01, 2/5/2014 2:56:49 PM, gsk

S:\5165312\Plat\TPP100-WillowCrk.dwg,

- 5



5

5

5

5

5

5

5

5



5

5

5

5

5

5

5

5

5

5