

GENERAL NOTES (FDM 15-1-15 PG.3)

NO TREES OR SHRUBS ARE TO BE REMOVED WITHOUT APPROVAL OF THE ENGINEER.

TACK COAT HAS BEEN ESTIMATED AT AN APPLICATION RATE OF 0.025 GALLONS PER SQUARE YARD AND SHALL BE PLACED BETWEEN LAYERS OF ASPHALTIC CONCRETE PAVEMENT AND EXISTING ASPHALTIC PAVEMENT.

THE LOCATIONS OF EXISTING AND PROPOSED UTILITY INSTALLATIONS AS SHOWN ON THE PLANS ARE APPROXIMATE. THERE MAY BE OTHER UTILITY INSTALLATIONS WITHIN THE PROJECT AREA THAT ARE NOT SHOWN.

DISTURBED AREAS WITHIN THE RIGHT-OF-WAY, EXCEPT THE AREAS WITHIN THE FINISHED SHOULDER POINTS SHALL BE FERTILIZED, SEEDED AND MULCHED.

THE 5 1/2-INCH ASPHALTIC PAVEMENT FOR STH 33 SHALL CONSIST OF AN 1 1/2-INCH SURFACE COURSE OF ASPHALTIC CONCRETE PAVEMENT, TYPE HV AND TWO 2-INCH LAYERS BINDER COURSE OF ASPHALTIC CONCRETE PAVEMENT, TYPE HV.

THE 4 1/2 INCH ASPHALTIC PAVEMENT FOR THE BYPASS SHALL CONSIST OF AN 1 1/2-INCH SURFACE COURSE OF ASPHALTIC CONCRETE PAVEMENT, TYPE MV AND TWO 1 1/2-INCH BINDER COURSE OF ASPHALTIC CONCRETE PAVEMENT, TYPE MV.

WHEN THE QUANTITY OF THE ITEMS OF CRUSHED AGGREGATE BASE COURSE AND ASPHALTIC CONCRETE PAVEMENT IS MEASURED BY THE TON, THE DEPTH OR THICKNESS OF THE COURSE SHOWN ON THE PLANS IS APPROXIMATE, AND THE ACTUAL THICKNESS WILL DEPEND ON THE DISTRIBUTION OF THE MATERIAL AS DIRECTED BY THE ENGINEER.

THE CONTRACT SHALL INCLUDE THE BACKFILL FOR THE AREA BEHIND THE CURB AND GUTTER.

CURB AND GUTTER JOINT SPACING SHALL BE 20 FEET UNLESS OTHERWISE AUTHORIZED BY THE ENGINEER.

CURB AND GUTTER GRADES GIVEN ARE ON THE FLANGE LINE.

ALL RADII DIMENSIONS FOR 36-INCH CURB AND GUTTER ARE TO FACE.

PRIOR TO PLACEMENT OF STEEL PLATE BEAM GUARD, THE SHOULDERS SHALL BE IN PLACE, SHAPED AND COMPACTED.

THE LOW SIDE SHOULDER SLOPE ON SUPERELEVATED SECTIONS EQUALS SUPERELEVATION WHEN SUPERELEVATION IS GREATER THAN 0.04%. IF SUPERELEVATION IS LESS THAN OR EQUAL TO 0.04%, THEN THE LOW SIDE SHOULDER SLOPE IS 0.04%, HIGH SIDE SHOULDER SLOPE ON SUPERELEVATED SECTIONS EQUALS SUPERELEVATION.

THE EARTHWORK YARDAGE IS BALANCED BY EXPANDING THE FILL EXPANSION OF FILL WHICH IS ESTIMATED AT 25%.

TEMPORARY STORAGE OF UNCLASSIFIED EXCAVATION IN WETLANDS WILL NOT BE PERMITTED.

STANDARD ABBREVIATIONS

HYD.	HYDRANT
N.C.	NORMAL CROWN
SE	SUPERELEVATION
T.L.E.	TEMPORARY LIMITED EASEMENT
P.S.D.	PASSING SIGHT DISTANCE

STANDARD DETAIL DRAWINGS

8D	1-11	CONCRETE CURB, CONCRETE CURB & GUTTER AND PAVEMENT TIES
8D	4-3	CONCRETE SURFACE DRAIN & ASPHALTIC FLUME
8D	5-8	CURB RAMPS
8E	8-1	TYPICAL INSTALLATIONS OF EROSION BALES
8E	9-3	SILT FENCE
8F	1-10a	APRON ENDWALLS FOR CULVERT PIPE
12A	3-4	NAME PLATE (STRUCTURES)
14B	7-8a	TEMPORARY PRECAST CONCRETE BARRIER
14B	7-8b	PRECAST CONCRETE BARRIER END SECTION AND PORTABLE CRASH CUSHION
14B	15-1a	CLASS "A" STEEL PLATE BEAM GUARD, INSTALLATION & ELEMENTS
14B	16-1a	CLASS "A" STEEL PLATE BEAM GUARD END TREATMENT WITH ANCHORAGE, TYPE 1 & 2
14B	16-1b	CLASS "A" STEEL PLATE BEAM GUARD END TREATMENT WITH ANCHORAGE, TYPE 1 & 2
14B	20-2a	STEEL THRIE BEAM STRUCTURE APPROACH
14B	20-2b	STEEL THRIE BEAM STRUCTURE APPROACH, CONNECTION TO BRIDGE RAILINGS TYPES "F" & "W"
15C	8-5a	PAVEMENT MARKING (MAINLINE & INTERSECTIONS)
15C	12-1	TRAFFIC CONTROL FOR LANE CLOSURE (SUITABLE FOR MOVING OPERATIONS)
14B	18-1a	CLASS "A" STEEL PLATE BEAM GUARD (AT BRIDGES, OBSTACLES AND SIDEROADS/DRIVEWAYS)

UTILITIES

SCHODRON, KEN
WISCONSIN ELECTRIC POWER CO.
920 INDIANA AVE. P.O. BOX 119
WEST BEND, WI 53095-0119
(414) 338-7623

ALBERS, LAMONT
ALLENTON SANITARY DISTRICT
835 NORTH HWY. W
P.O. BOX 293
ALLENTON, WI 53002-0293
414-629-5761

ALBERS, DIANA
GTE-WISCONSIN
107 PLEASANTVIEW DR.
PLYMOUTH, WI 53073-0901
414-893-7462

WASTE WATER TREATMENT FACILITY
ALLENTON, WI 53002
414-629-5581

KIM, IN SOOK
WISCONSIN GAS CO.
626 E. WISCONSIN AVE.
MILWAUKEE, WI 53202
414-291-6730

BOTHE, LINDA
STAR CABLEVISION
1021 S. MAIN, P.O. BOX 241
WEST BEND, WI 53095
414-338-5680



TO OBTAIN LOCATION OF PARTICIPANTS' UNDERGROUND FACILITIES BEFORE YOU DIG IN WISCONSIN

CALL DIGGERS HOTLINE

TOLL FREE 1-800-242-8511
MILWAUKEE AREA (414) 259-1181
TELEFAX (414) 259-0947
TDD (For hearing impaired) 1-800-542-2289

WIS. STATUTE 182.0175 (1974)
REQUIRES MIN. OF 3 WORK DAYS
NOTICE BEFORE YOU EXCAVATE.



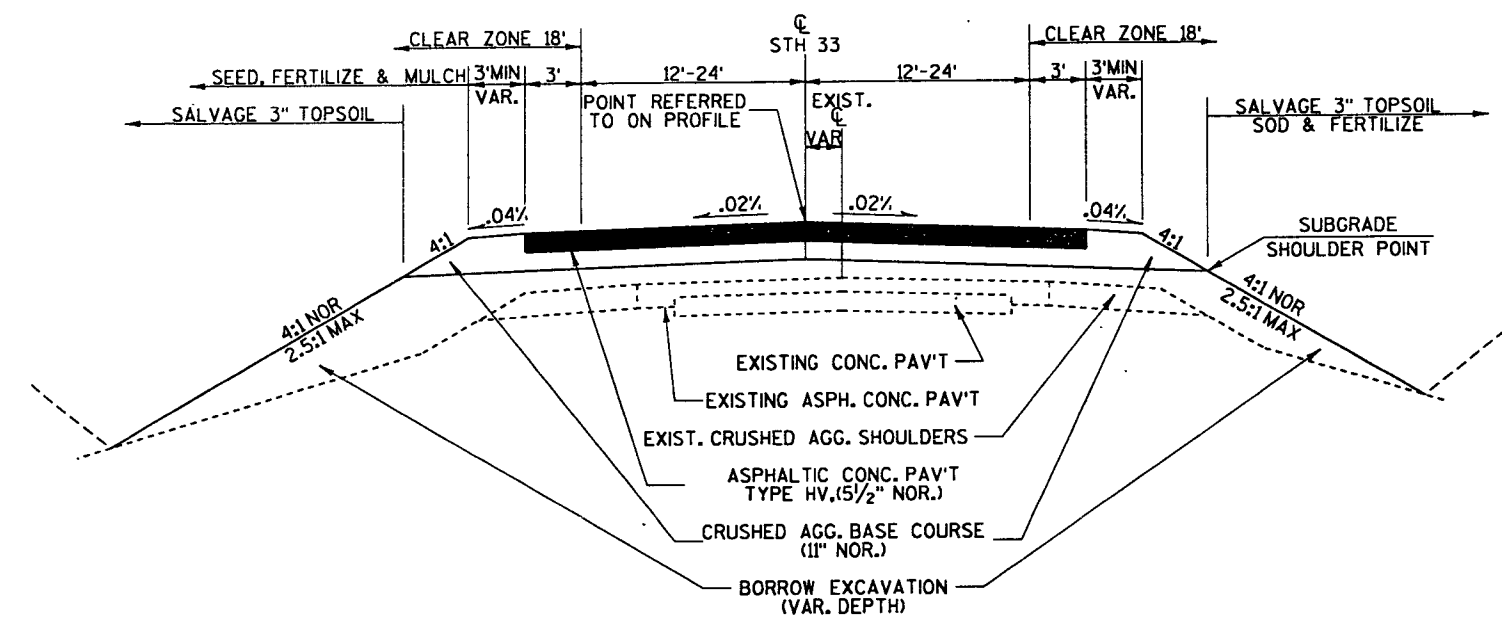

PROPOSED TYPICAL SECTION
 STA. 2+25 TO STA. 2+91.43
 STA. 9+60.03 TO STA. 11+65

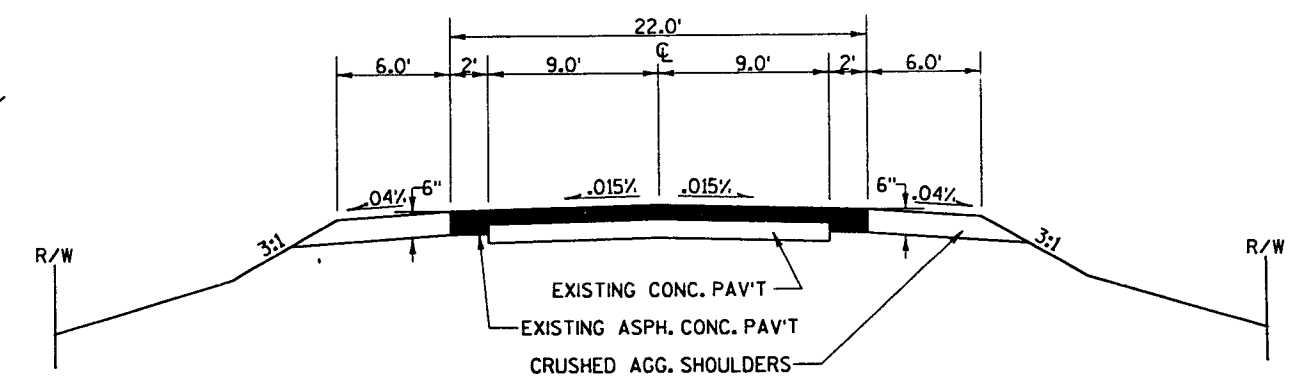

EXISTING TYPICAL SECTION

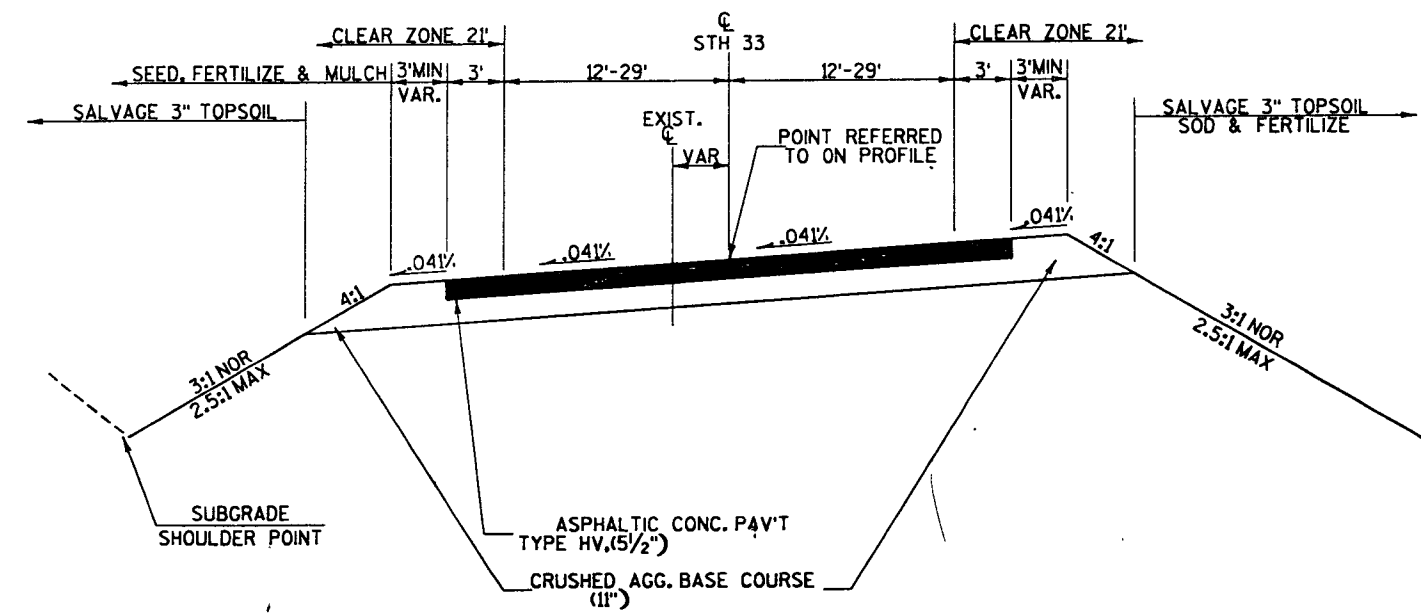

TYPICAL SUPERELEVATED SECTION
 STA. 2+91.43 TO STA. 6+08
 STA. 6+63 TO STA. 9+60.03

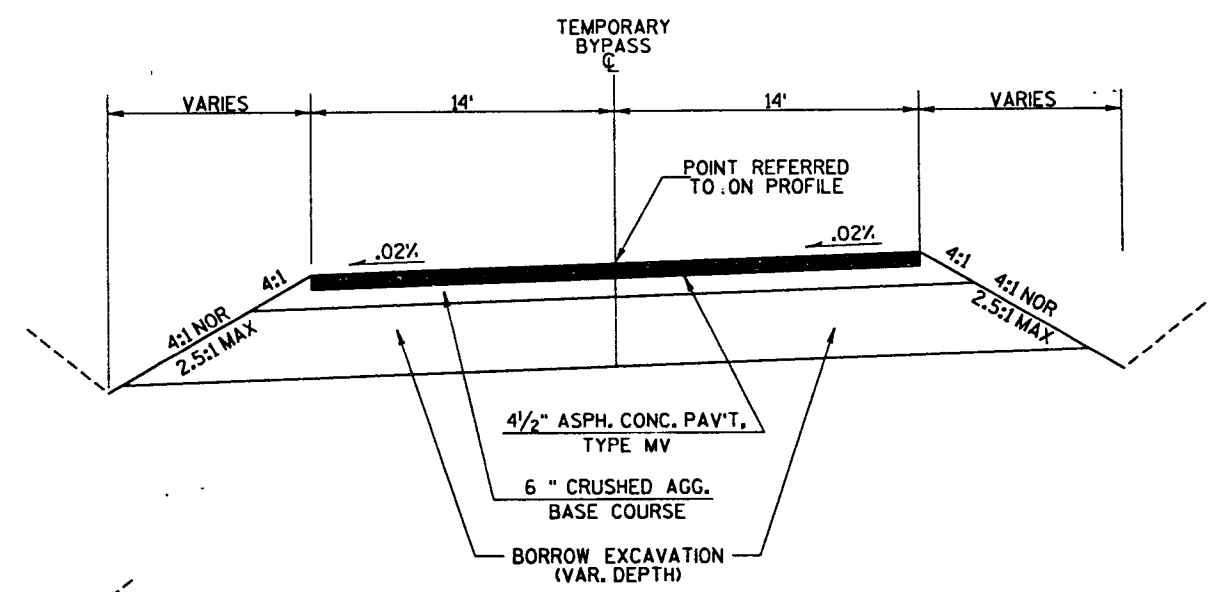

**TYPICAL SUPERELEVATED SECTION
 TEMPORARY BYPASS**
 (HORIZ. CURVE LEFT)
 STA. 5+31.51 TO STA. 8+45.13

LEVELS ON - 1, 2, 3, 4, 5, 6, 7, 8, 9, 10, 11, 12, 13, 14, 15, 16, 17, 18, 19, 20, 21, 22, 23, 24, 25, 26, 27, 28, 29, 30, 31, 32, 33, 34, 35, 36, 37, 38, 39, 40, 41, 42, 43, 44, 45, 46, 47, 48, 49, 50, 51, 52, 53, 54, 55, 56, 57, 58, 59, 60, 61, 62, 63

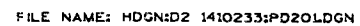
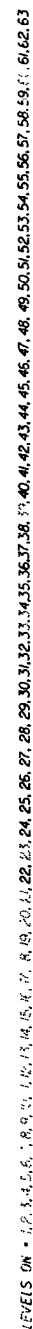

LEVELS ON - 1, 2, 3, 4, 5, 6, 7, 8, 9, 10, 11, 12, 13, 14, 15, 16, 17, 18, 19, 20, 21, 22, 23, 24, 25, 26, 27, 28, 29, 30, 31, 32, 33, 34, 35, 36, 37, 38, 39, 40, 41, 42, 43, 44, 45, 46, 47, 48, 49, 50, 51, 52, 53, 54, 55, 56, 57, 58, 59, 60, 61, 62, 63

ABUTMENT DRAINAGE DETAIL

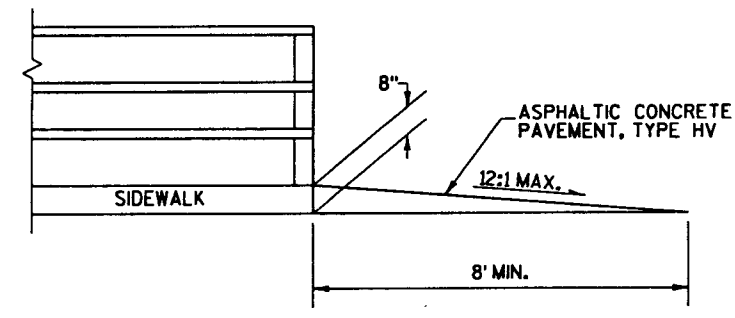
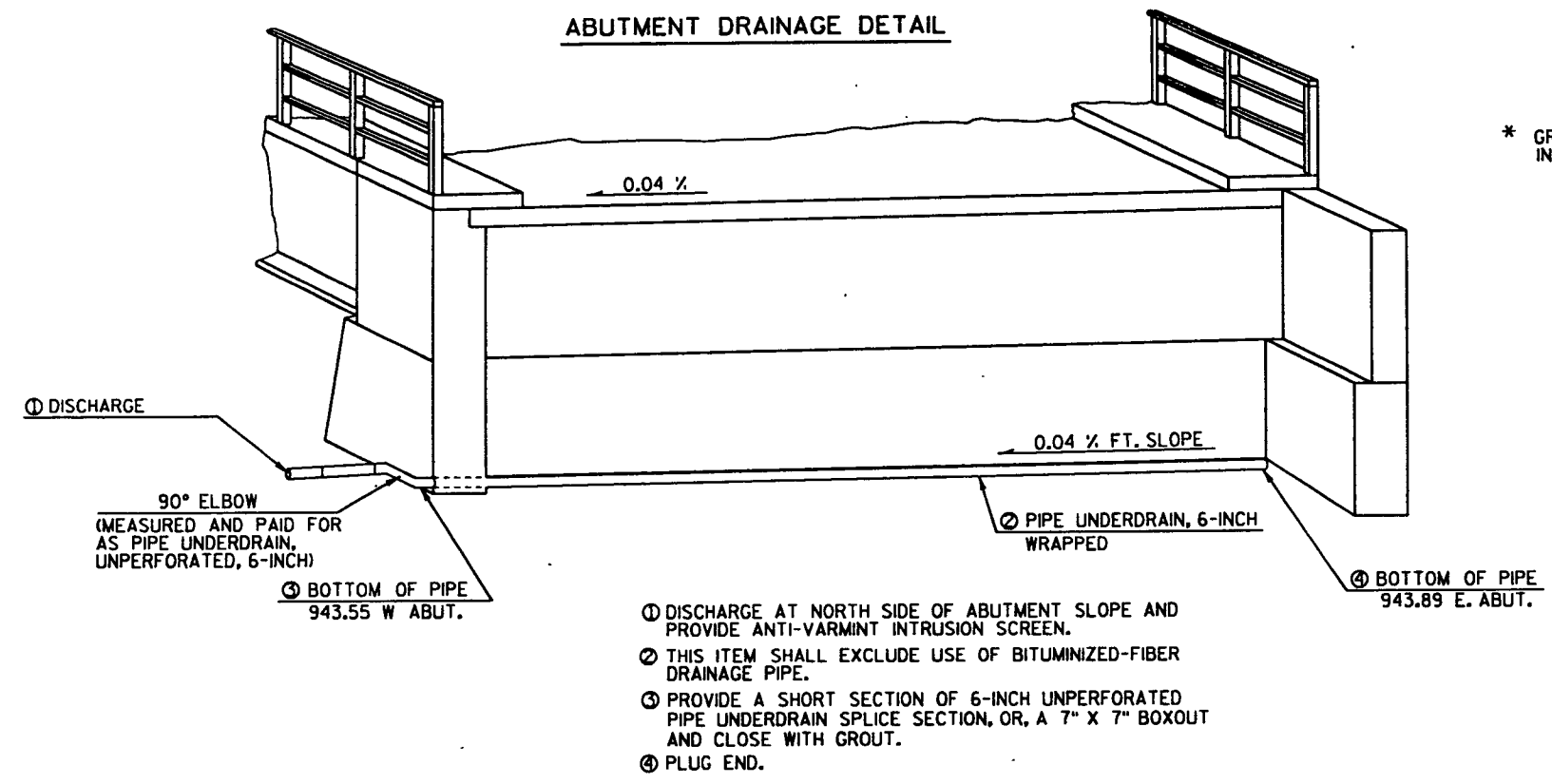

DETAIL FOR ASPHALTIC RAMPS
AT SIDEWALK ON BRIDGES

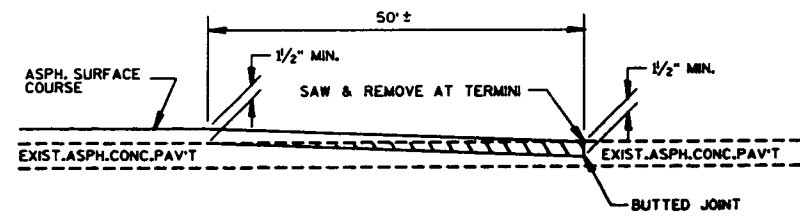

BUTT JOINT DETAIL
NEW PLAT ST.
SEWER PLANT DRWY.

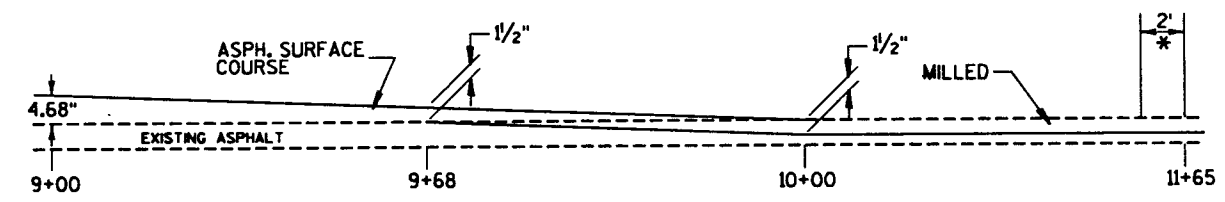

BUTT JOINT DETAIL
STA. 11+65 STH 33

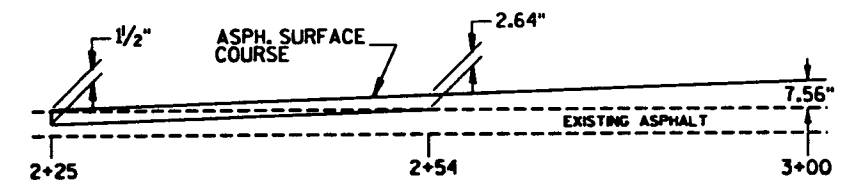

BUTT JOINT DETAIL
STA. 2+25 STH 33

STATE PROJECT NUMBER 1410-02-70	SHEET NO. 2.3
CONSTRUCTION DETAILS	
STH 33	WASHINGTON COUNTY

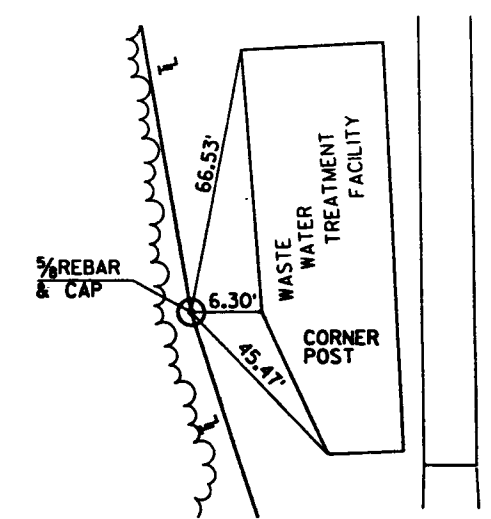
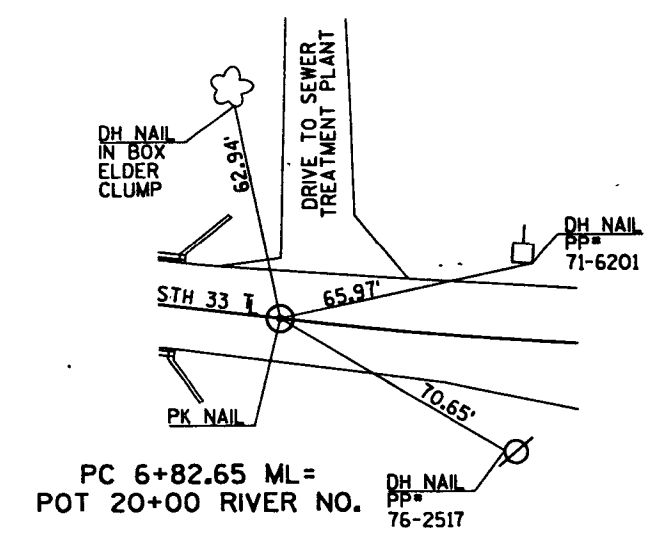
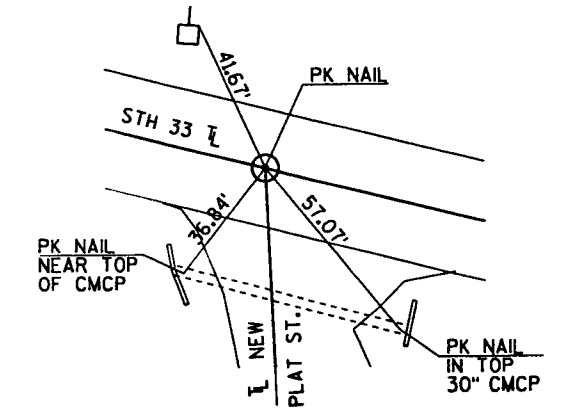

STATE PROJECT NUMBER	SHEET NO.
1410-02-70	2.4
CONSTRUCTION DETAIL	
S.T.H. 33	WASHINGTON CO.

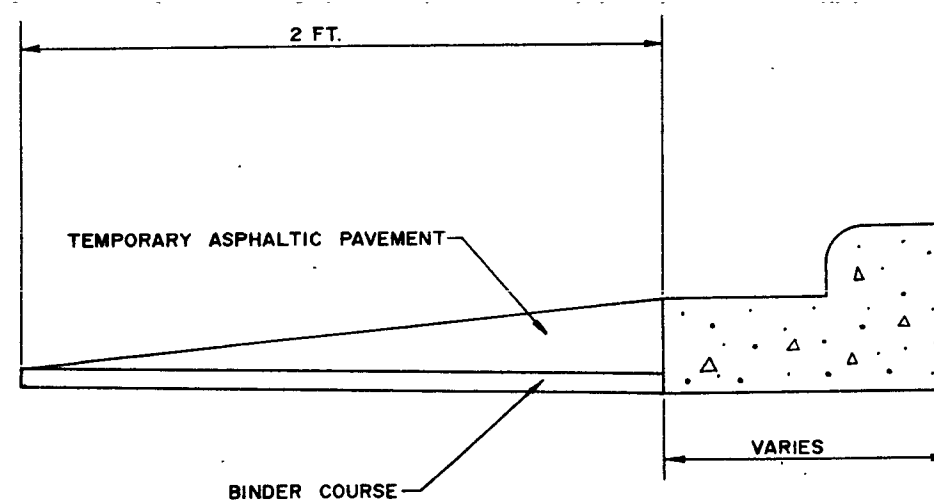

TEMPORARY CURB & GUTTER WEDGE DETAIL

URBAN AREA

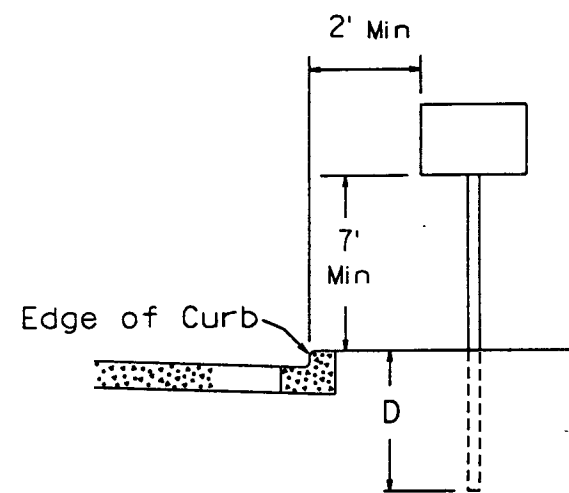

RURAL AREA

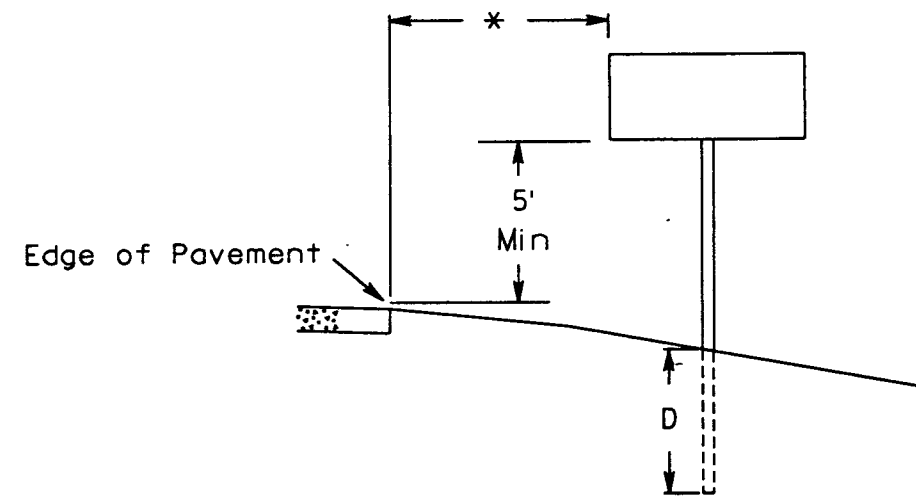

GENERAL NOTES

- Sign assemblies wider than 4 feet or larger than 20 sq. ft. shall be mounted on multiple posts. See plate A4-4 for typical installations.

POST EMBEDMENT DEPTH

Area of Sign Installation (Sq. Ft.)	D (Min)
20 or Less	4'
Greater than 20	5'

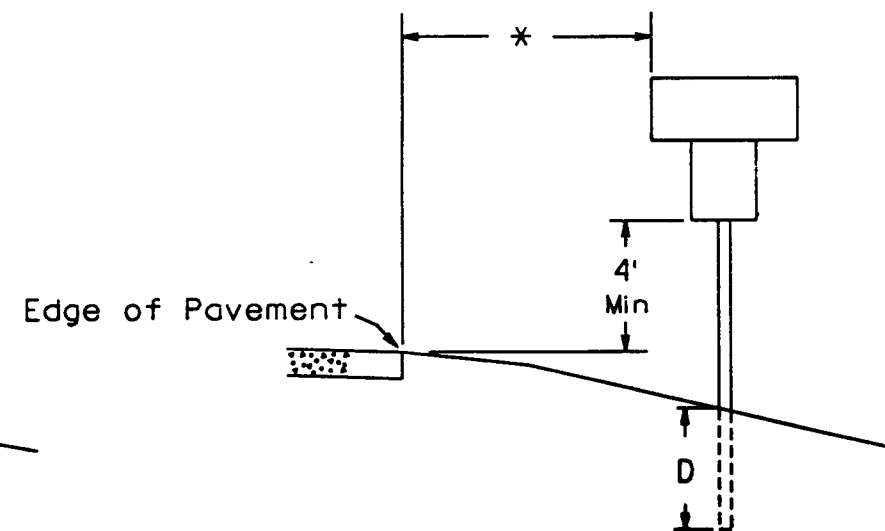
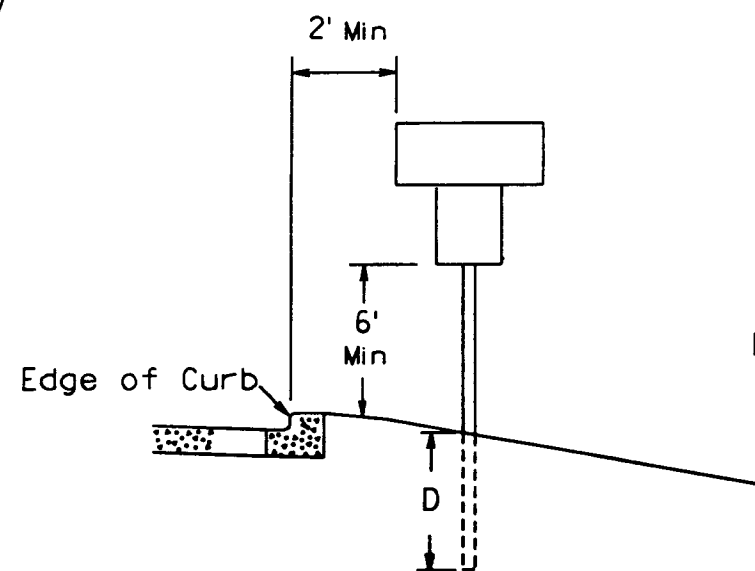

- * 12 feet minimum from edge of pavement.
Where there is a paved shoulder, 6' minimum from edge of paved shoulder, but at least 12 feet from edge of pavement.

DATE DRAWN 9-12-91	DATE REDRAWN _____
DATE REVISED 1-14-92	_____
TYPICAL INSTALLATION OF TYPE II SIGNS ON SINGLE POSTS	
WISCONSIN DEPT OF TRANSPORTATION	
APPROVED	<i>Robert J. Quach</i> State Traffic Engineer
DATE 1/21/92	PLATE NO. A4-3.8

URBAN AREA

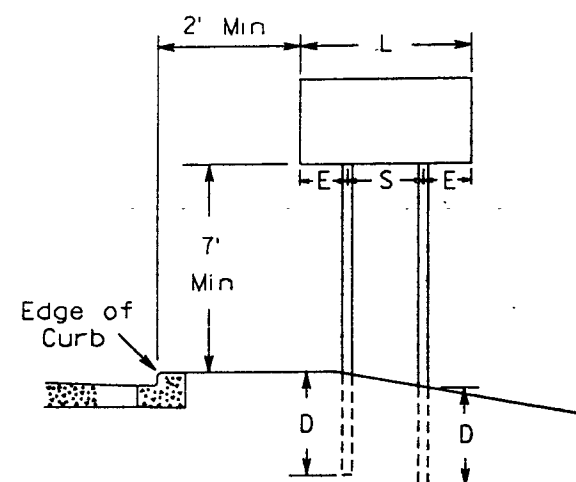

RURAL AREA

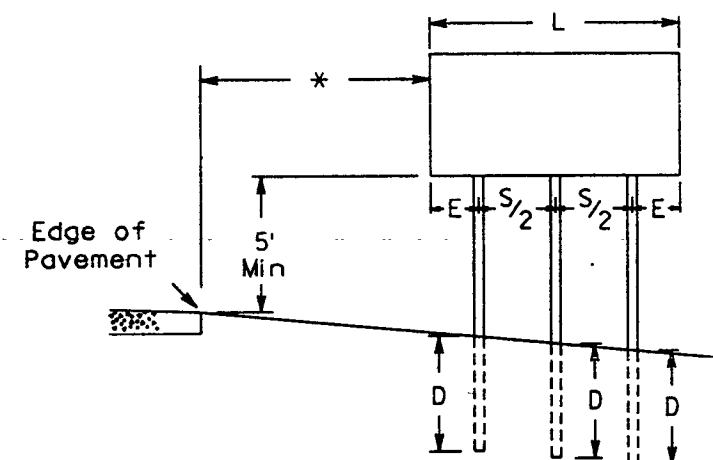
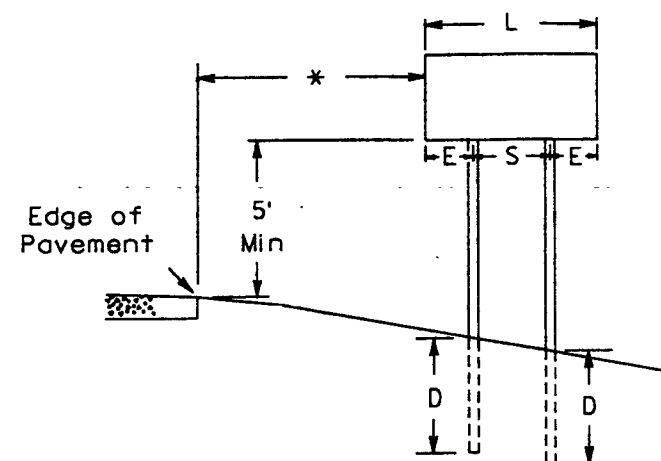

GENERAL NOTES

- For 3 post installations, post spacing is $S/2$ and S must be greater than 7'-0"
- For 4 post installations, post spacing is $S/3$ and S must be greater than 10'-6"

* 12 feet minimum from edge of pavement.
Where there is a paved shoulder, 6' minimum from edge of paved shoulder, but at least 12 feet from edge of pavement.

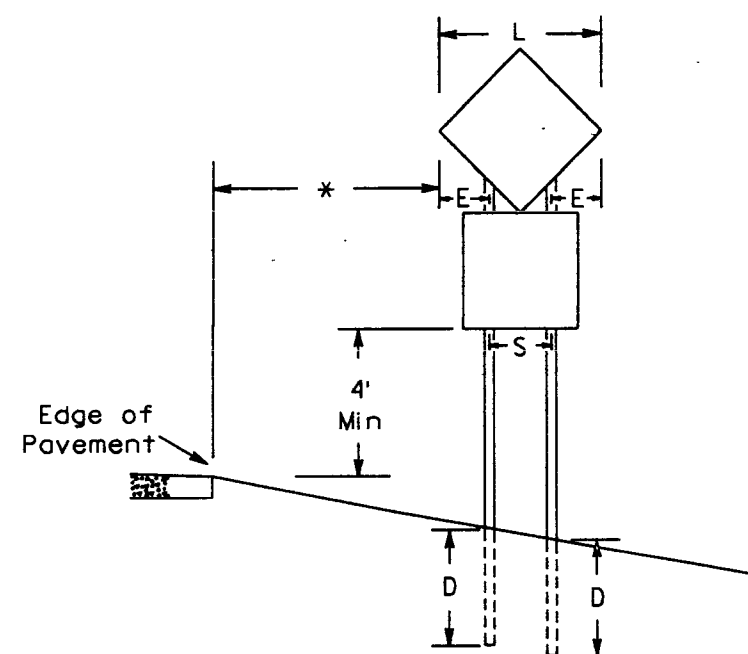
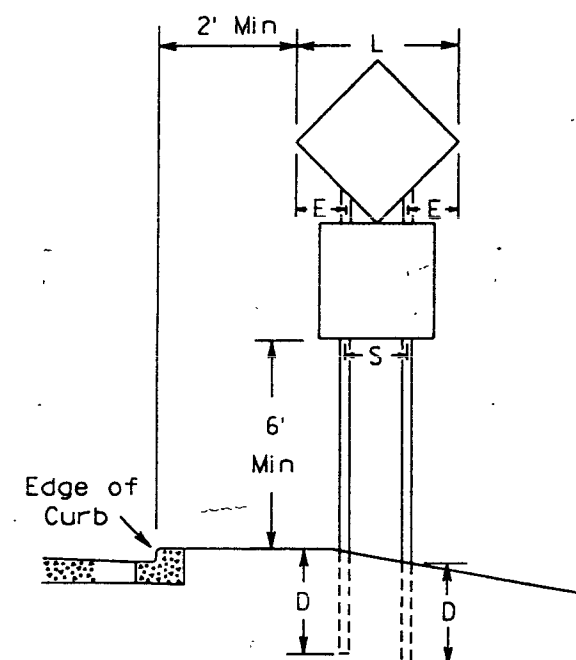

DIAMOND SHAPED SIGNS

L	S	E
Less than 60"	20"	$L/2 - 10$
60"--72"	32"	$L/2 - 16$
Greater than 72"	$3 L/5$	$L/5$

SIGN SHAPE OTHER THAN DIAMOND
(Two Post Installations)

L	S	E
Less than 60"	L-24"	12"
60" or more	$3 L/5$	$L/5$

POST EMBEDMENT DEPTH

Area of Sign Installation (Sq. Ft.)	D (Min)
20 or Less	4'
Greater than 20	5'

DATE DRAWN 6-3-87	DATE REDRAWN 10-1-91
DATE REVISED 11-6-92	
TYPICAL INSTALLATION OF TYPE II SIGNS ON MULTIPLE POSTS	
WISCONSIN DEPT OF TRANSPORTATION	
APPROVED	<i>State Traffic Engineer</i>
DATE 11/20/92	PLATE NO. A4-4.3

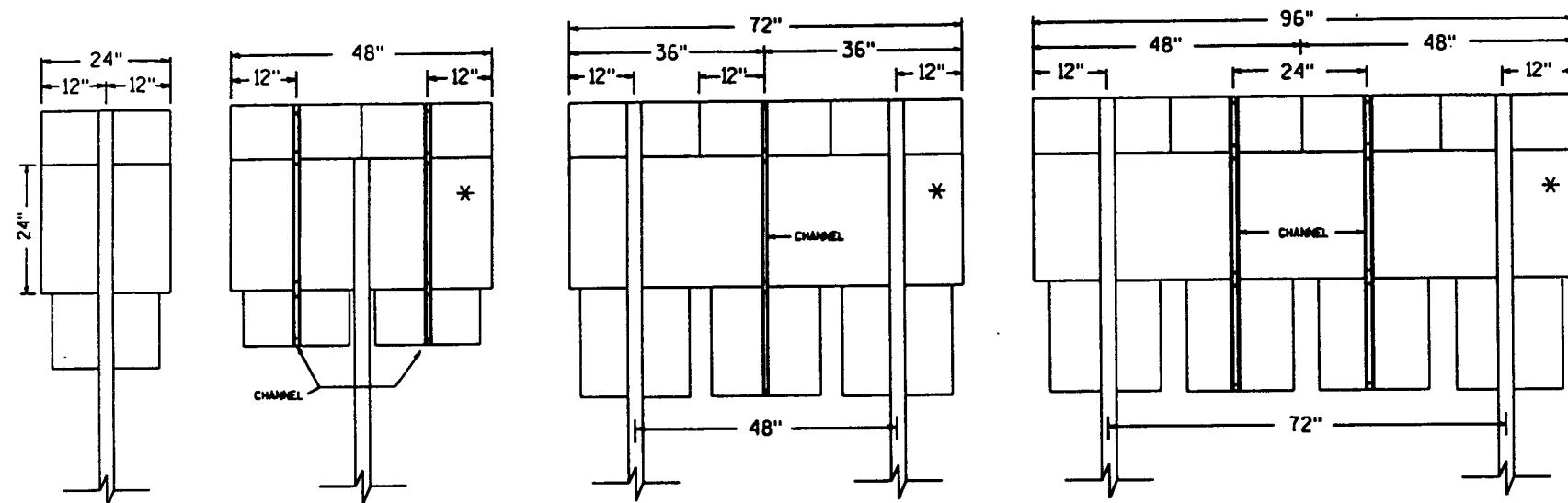
NOTES:

1. Post spacing shall be according to this detail but post embedment depth shall be in accordance with A4-4.
2. Channel material shall be as specified in Section 633 of Std. Specs. and weight shall be approx. 1.4 lbs/ft.
3. Base material for a multiple marker head panel (*) shall be one piece high density overlay plywood. All other materials within the assembly can be either plywood or aluminum.

CHANNEL HARDWARE:

Aluminum Sign components: $1/4"$ x $3/4"$ bolt and $1/4"$ flat washers

Plywood Sign Components: $1/4"$ x $1 1/4"$ bolt and $1/4"$ flat washers

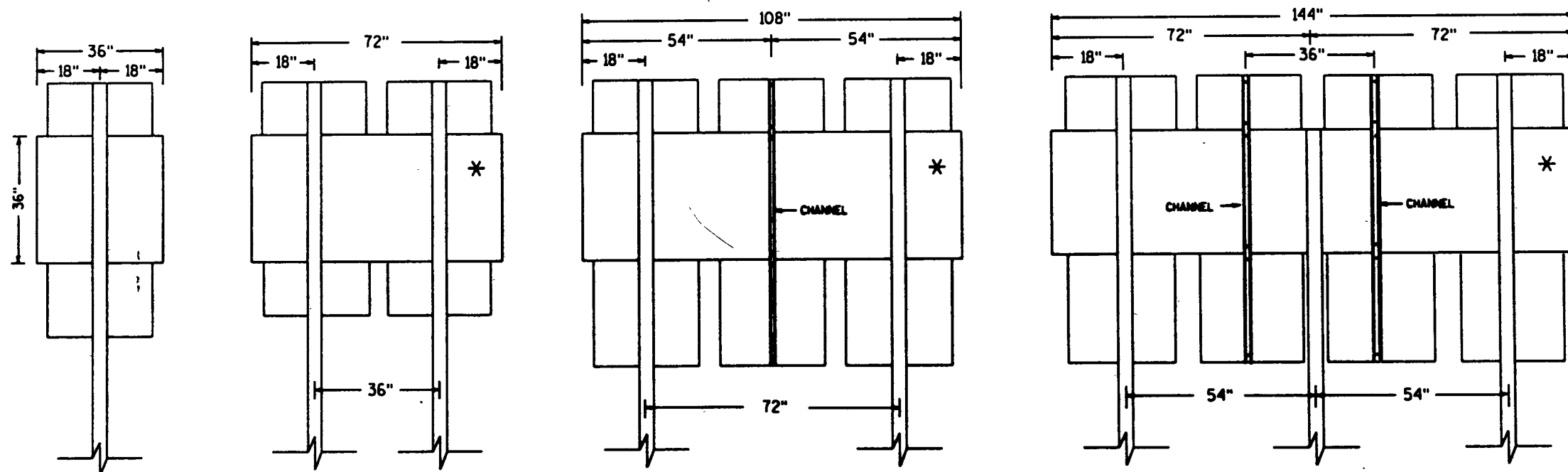
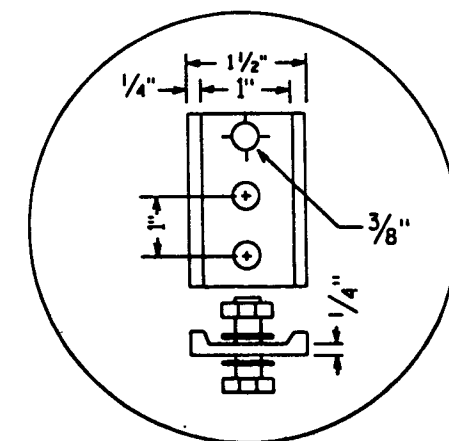
CHANNEL DETAIL

DATE DRAWN 6-3-87 DATE REDRAWN 10-3-91

DATE REVISED

TYPICAL PANEL INSTALLATION
FOR J TYPE ASSEMBLIES

WISCONSIN DEPT OF TRANSPORTATION

APPROVED

State Traffic Engineer

DATE 11/3/91

PLATE NO. A4-5.3

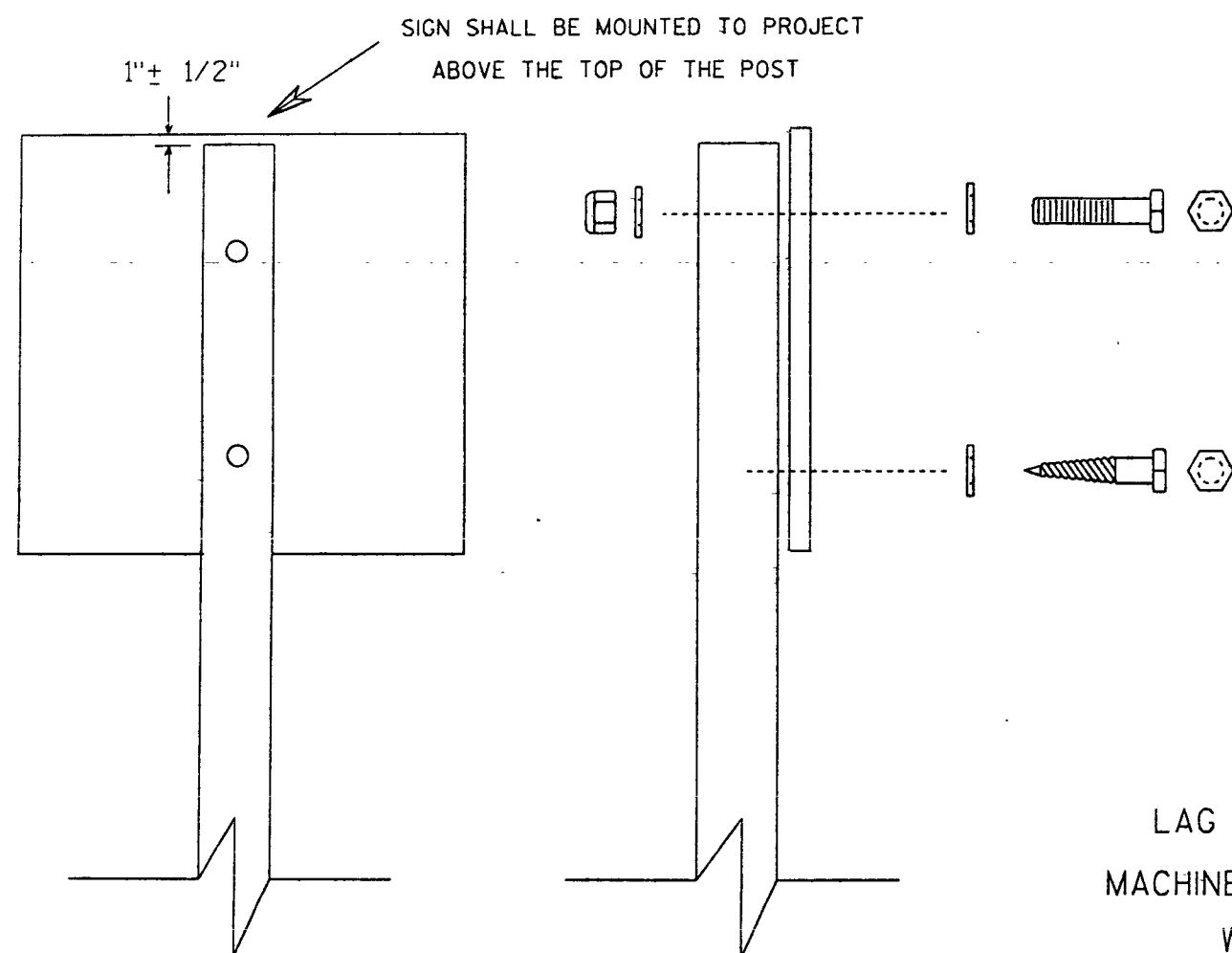

Nuts, bolts and lags used for mounting signs shall have hexagonal heads and shall be either :

- Hot dip or mechanically galvanized in accordance with ASTM Designation: A 153, Class D, or
- Cadmium plated in accordance with ASTM Designation : B 766 TYPE 3, Class 12, or
- Electro-galvanized in accordance with ASTM Designation : B 633, TYPE III, SC 3.

Threads on bolts and nuts shall be manufactured with sufficient allowance for the cadmium plate or galvanized coating to permit the nuts to run freely on the bolts.

LAG SCREWS - $\frac{3}{8}$ " X 3"

MACHINE BOLTS - $\frac{5}{16}$ " X 6-1/2" or 7" Length w/ nuts

WASHERS - 1" O.D. X $\frac{3}{8}$ " I.D. X $\frac{1}{16}$ " STEEL for signs 24x24 and smaller.
 1-1/4" O.D. X $\frac{3}{8}$ " I.D. X $\frac{1}{16}$ " STEEL for signs 24x30 to 36x48.
 1-1/2" O.D. X $\frac{7}{16}$ " I.D. X $\frac{1}{16}$ " STEEL for signs 48x48 and larger.
 1-1/4" O.D. X $\frac{3}{8}$ " I.D. X .080 TEFLON for all Type H signs.

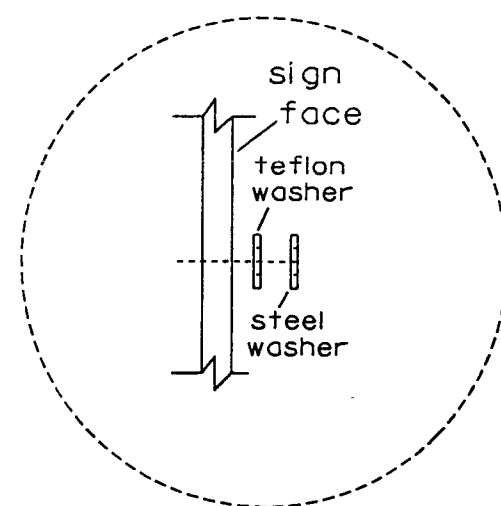

Washer Placement when
Sign Has Type H Face

DATE DRAWN 1-29-92	DATE REDRAWN
DATE REVISED	
ATTACHMENT OF SIGNS TO WOOD POSTS	
WISCONSIN DEPT OF TRANSPORTATION	
APPROVED	<i>State Traffic Engineer</i>
DATE 2-1-92	PLATE NO. A4-8.2

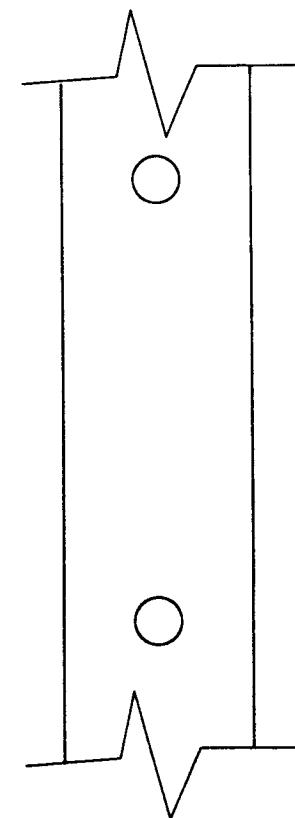
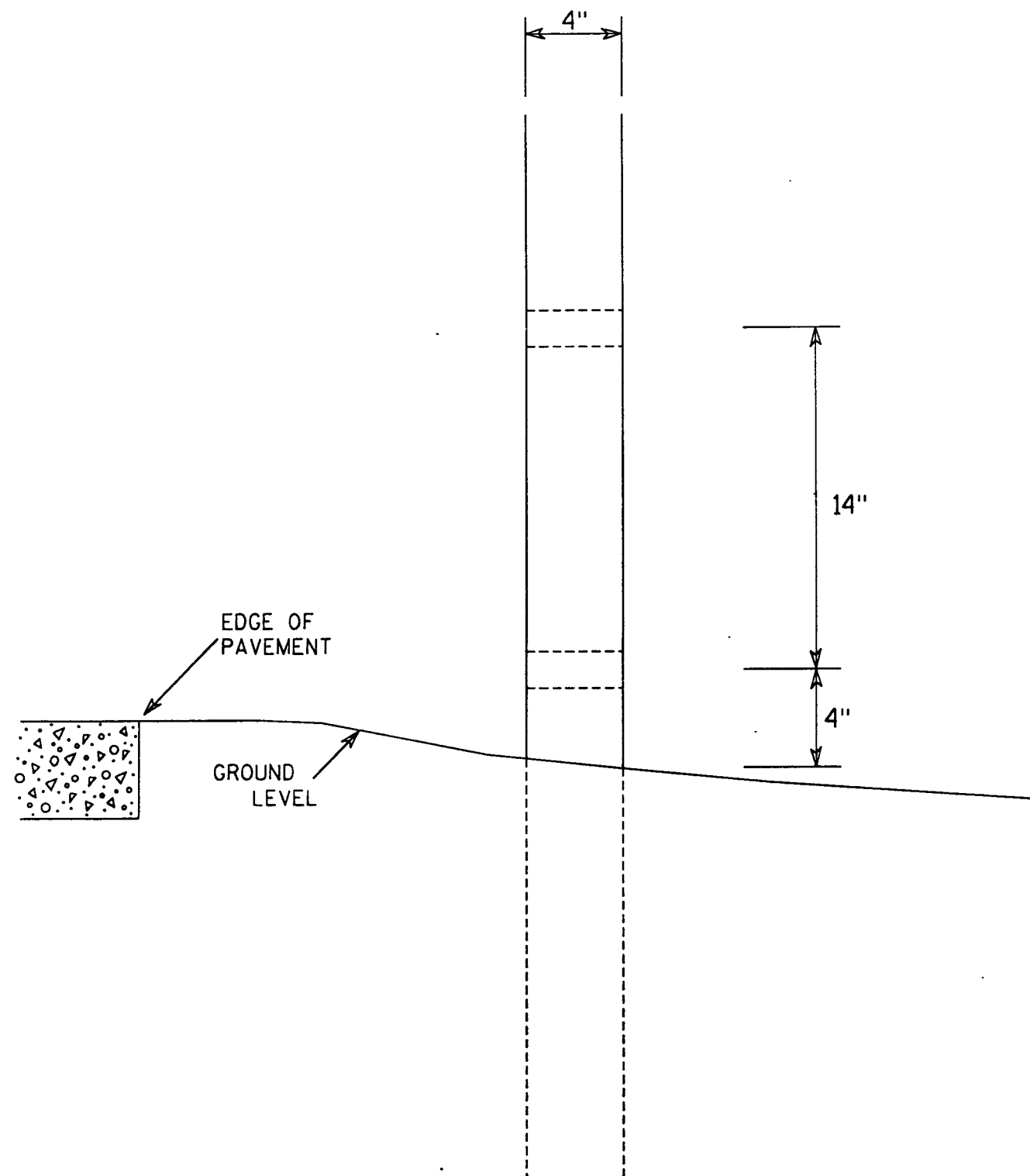

SIDE VIEW

GENERAL NOTES

1. All 4x6 Wood Posts shall be modified by having two 1½" diameter holes drilled perpendicular to the roadway centerline.

DATE DRAWN 11-1-91	DATE REDRAWN _____
DATE REVISED _____	
4 X 6 WOOD POST MODIFICATIONS	
WISCONSIN DEPT OF TRANSPORTATION	
APPROVED _____ State Traffic Engineer	
DATE 11/5/91	PLATE NO. A4-11.1

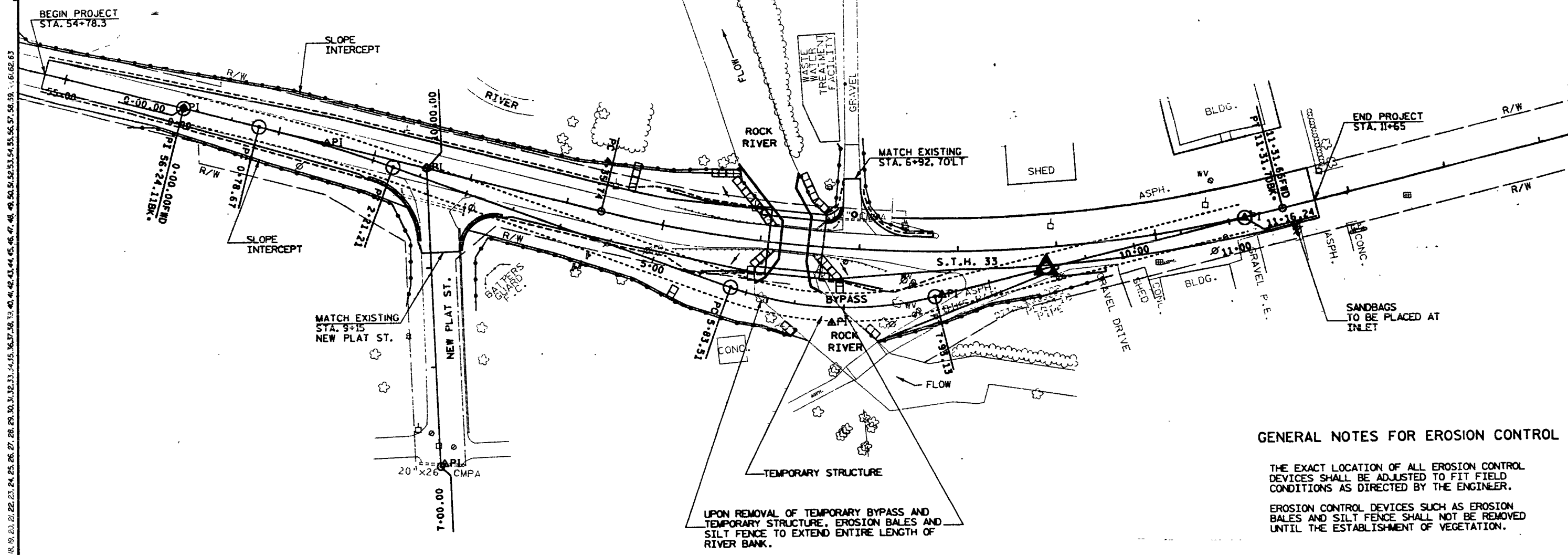

GENERAL NOTES FOR EROSION CONTROL

THE EXACT LOCATION OF ALL EROSION CONTROL DEVICES SHALL BE ADJUSTED TO FIT FIELD CONDITIONS AS DIRECTED BY THE ENGINEER.

EROSION CONTROL DEVICES SUCH AS EROSION BALES AND SILT FENCE SHALL NOT BE REMOVED UNTIL THE ESTABLISHMENT OF VEGETATION.

LEGEND

- TURBIDITY BARRIER
- EROSION BALES
- SILT FENCE

LEVELS ON * 1, 2, 3, 4, 5, 6, 7, 8, 9, 10, 11, 12, 13, 14, 15, 16, 17, 18, 19, 20, 21, 22, 23, 24, 25, 26, 27, 28, 29, 30, 31, 32, 33, 34, 35, 36, 37, 38, 39, 40, 41, 42, 43, 44, 45, 46, 47, 48, 49, 50, 51, 52, 53, 54, 55, 56, 57, 58, 59, 60, 61, 62, 63

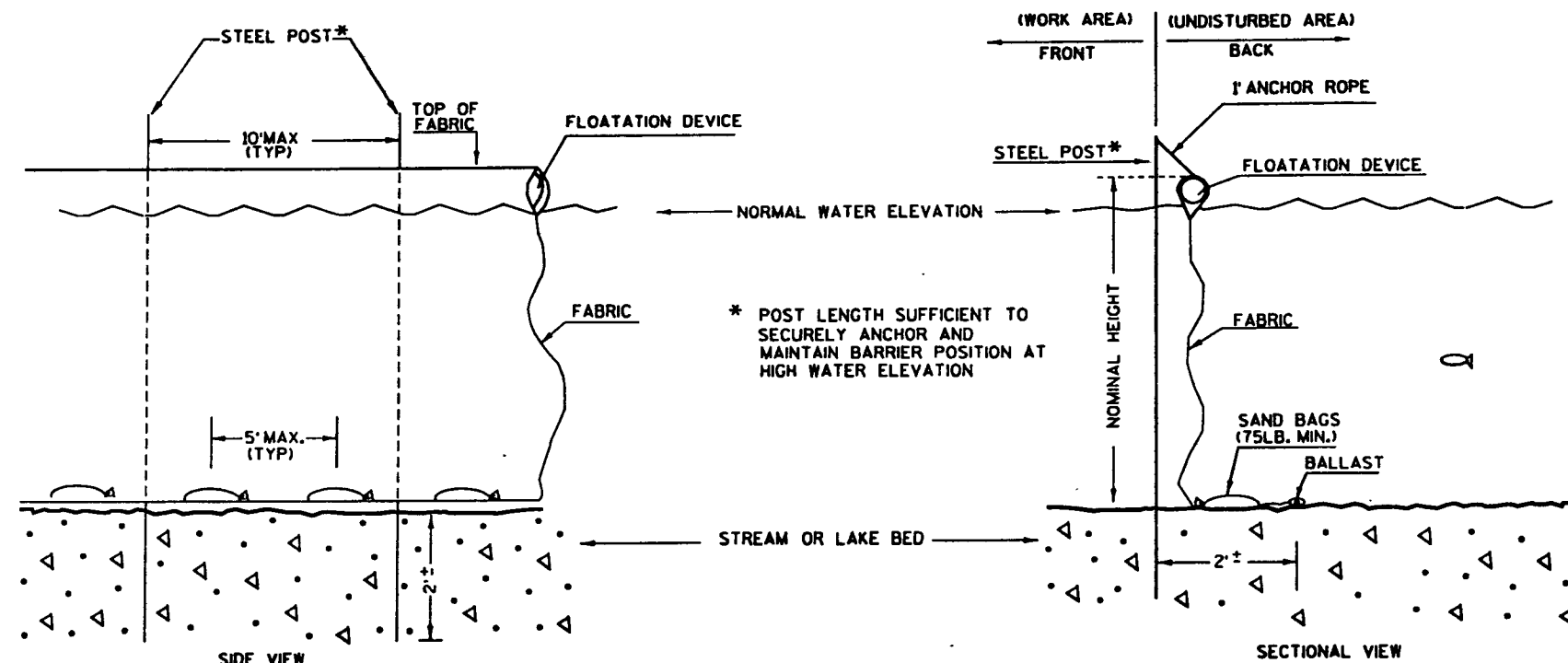

TURBIDITY BARRIER

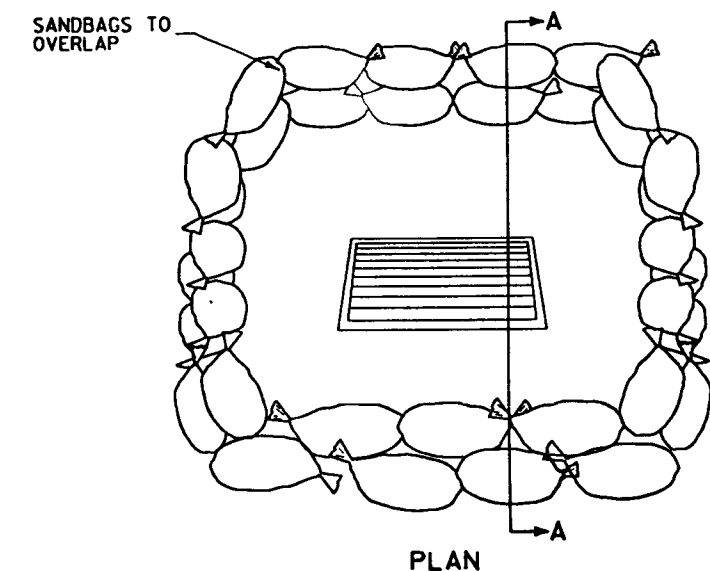

SANDBAGS SHALL BE MADE OF WOVEN FABRIC

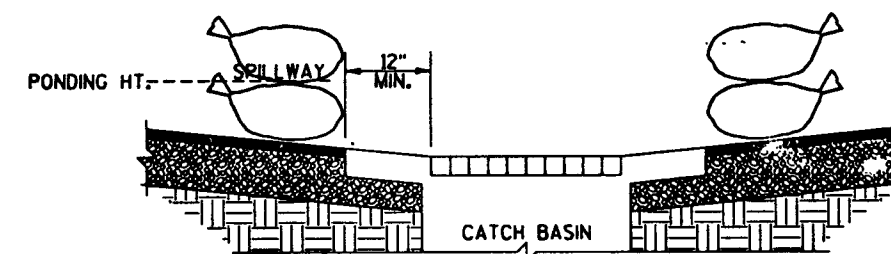

SECTION A-A

NOTES:

1. SANDBAGS SHALL BE WOVEN FABRIC.
2. CONSTRUCT ON GENTLY SLOPING STREETS WHERE WATER CAN POND AND ALLOW SEDIMENT TO SEPERATE OUT OF SUSPENSION.
3. LEAVE A GAP OF ONE BAG IN THE MIDDLE OF THE TOP ROW OF BAGS TO SERVE AS THE SPILLWAY. SPILLWAY HEIGHT SHALL BE LOWER THAN CURB HEIGHT AND SUFFICIENT IN SIZE TO PASS FLOWS FROM SEVERE STORM EVENT.
4. PLACE 2 LAYERS OF SANDBAGS, OVER LAPPING BAGS AND PACK THEM TIGHTLY TOGETHER TO MINIMIZE THE SPACE BETWEEN BAGS. FILL BAG WITH 3/4" DRAIN ROCK OR 1/4" PEA GRAVEL.
5. INSPECT AND REPAIR FILTERS AFTER EACH STORM EVENT. REMOVE SEDIMENT WHEN ONE HALF OF THE FILTER DEPTH HAS BEEN FILLED. REMOVED SEDIMENT SHALL BE DEPOSITED IN AN AREA TRIBUTARY TO A SEDIMENT BASIN OR OTHER FILTERING MEASURE.
6. SEDIMENT AND GRAVEL SHALL BE IMMEDIATELY REMOVED FROM TRAVELED WAY OF ROAD.

**INLET
SEDIMENT BARRIER
(SANDBAG TYPE)**

LEVELS ON - 1, 2, 3, 4, 5, 6, 7, 8, 9, 10, 11, 12, 13, 14, 15, 16, 17, 18, 19, 20, 21, 22, 23, 24, 25, 26, 27, 28, 29, 30, 31, 32, 33, 34, 35, 36, 37, 38, 39, 40, 41, 42, 43, 44, 45, 46, 47, 48, 49, 50, 51, 52, 53, 54, 55, 56, 57, 58, 59, 60, 61, 62, 63

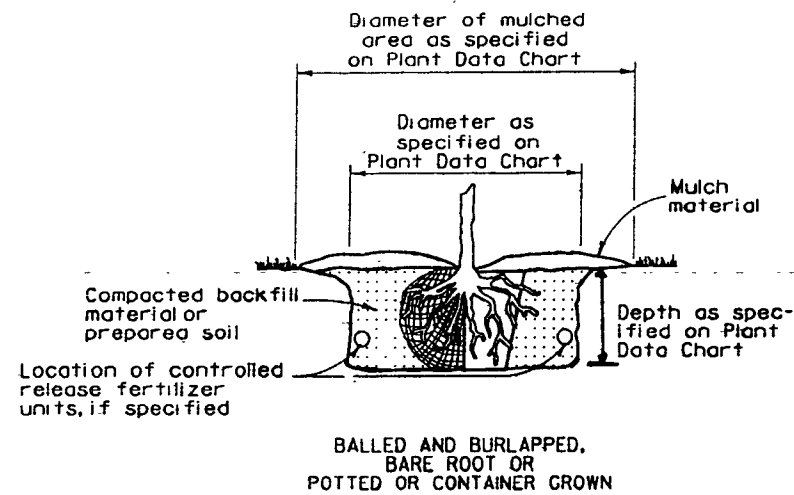

PLANTING

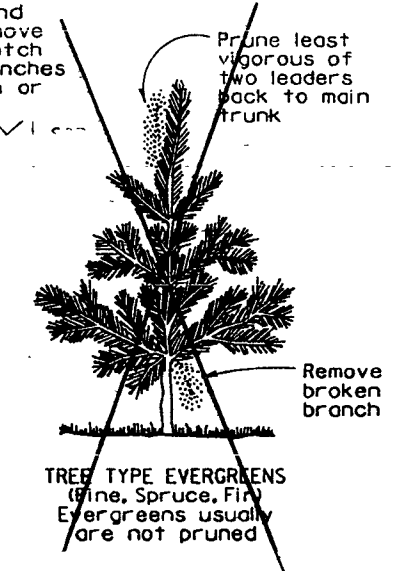
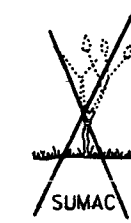
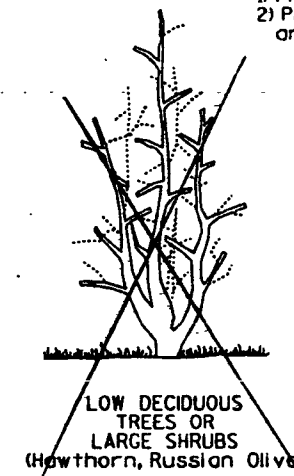
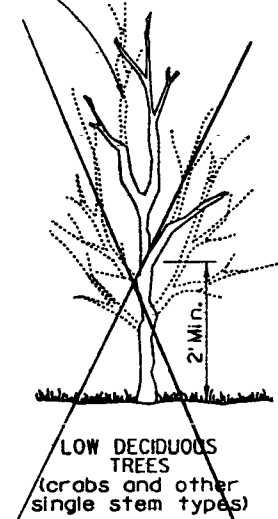
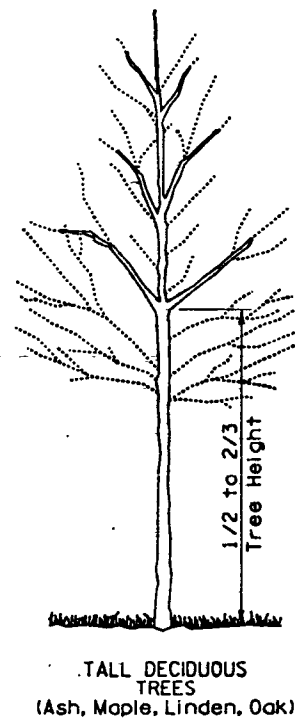

NOTE: When pruning, preserve character and shape of tree. Avoid leaving stubs - remove branch or twig back to the nearest crotch
1) Prune to remove dead and broken branches
2) Prune to remove branches that touch or are too close to other branches

PRUNING

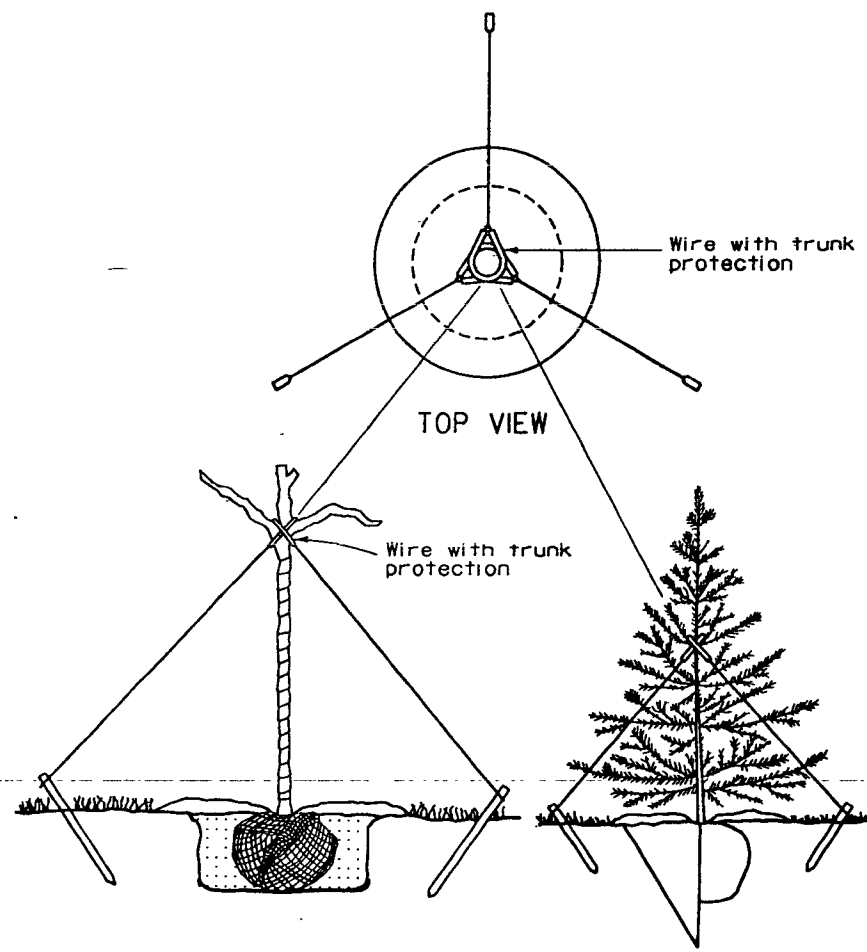

GUYING

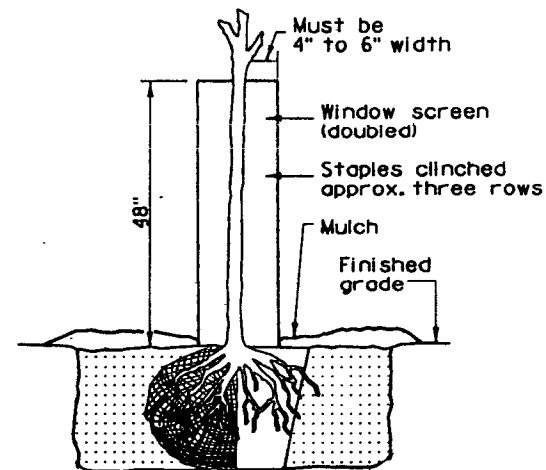

RODENT PROTECTION

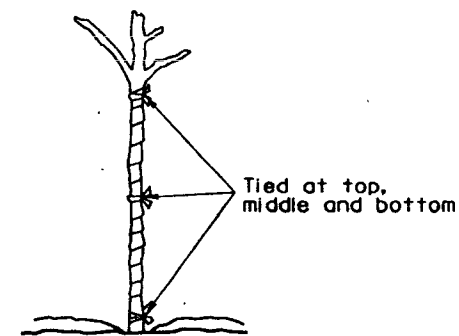

WRAPPING

NOTE: Measurements are specified on Plant Data Chart

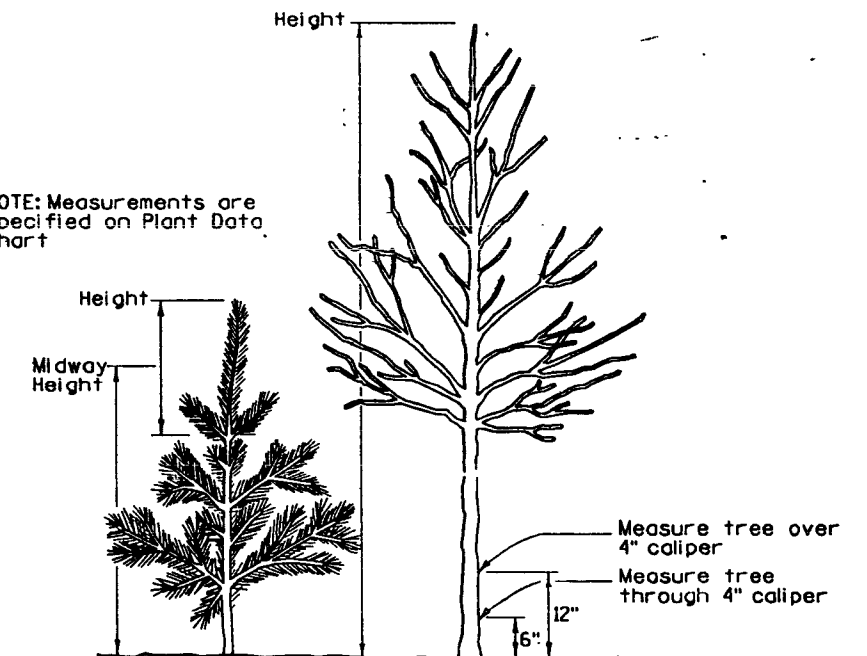

NOTES

Details of construction not shown on this drawing shall conform to the pertinent requirements of the Standard Specifications and the applicable Special Provisions.

All bracing stakes shall be made of steel.



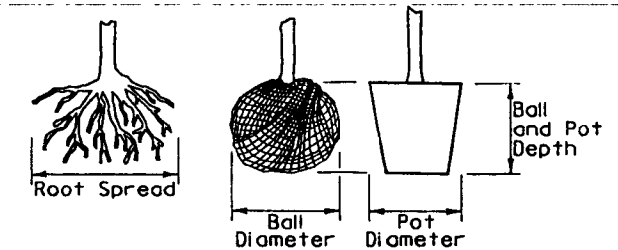

Bracing, wrapping, and guying shall be used only when specified on the Plant Data Chart.



MEASURING

LEVELS ON - 1, 2, 3, 4, 5, 6, 7, 8, 9, 10, 11, 12, 13, 14, 15, 16, 17, 18, 19, 20, 21, 22, 23, 24, 25, 26, 27, 28, 29, 30, 31, 32, 33, 34, 35, 36, 37, 38, 39, 40, 41, 42, 43, 44, 45, 46, 47, 48, 49, 50, 51, 52, 53, 54, 55, 56, 57, 58, 59, 60, 61, 62, 63

LEGEND

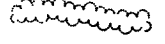
-  FERTILIZE, SEED & MULCH
-  SOD & FERTILIZE
-  DECIDUOUS TREE
-  EXISTING TREE
-  REMOVE TREE
-  DECIDUOUS GROUPING

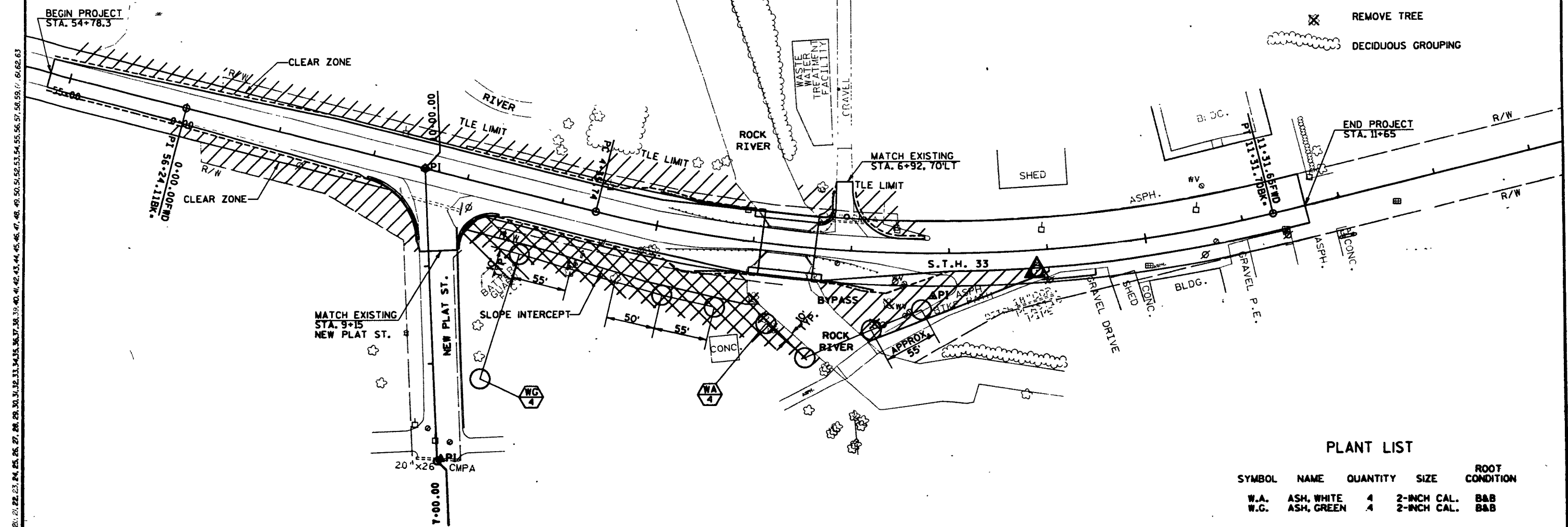

PLANT LIST

SYMBOL	NAME	QUANTITY	SIZE	ROOT CONDITION
W.A.	ASH, WHITE	4	2-INCH CAL.	B&B
W.G.	ASH, GREEN	4	2-INCH CAL.	B&B

LEVELS ON = 1, 2, 3, 4, 5, 6, 7, 8, 9, 10, 11, 12, 13, 14, 15, 16, 17, 18, 19, 20, 21, 22, 23, 24, 25, 26, 27, 28, 29, 30, 31, 32, 33, 34, 35, 36, 37, 38, 39, 40, 41, 42, 43, 44, 45, 46, 47, 48, 49, 50, 51, 52, 53, 54, 55, 56, 57, 58, 59, 60, 61, 62, 63

STATE PROJECT NUMBER	SHEET NO.
1410-02-70	2,14
MOVING ALLENTON SIGN DETAIL	
S.T.H. 33	WASHINGTON CO.

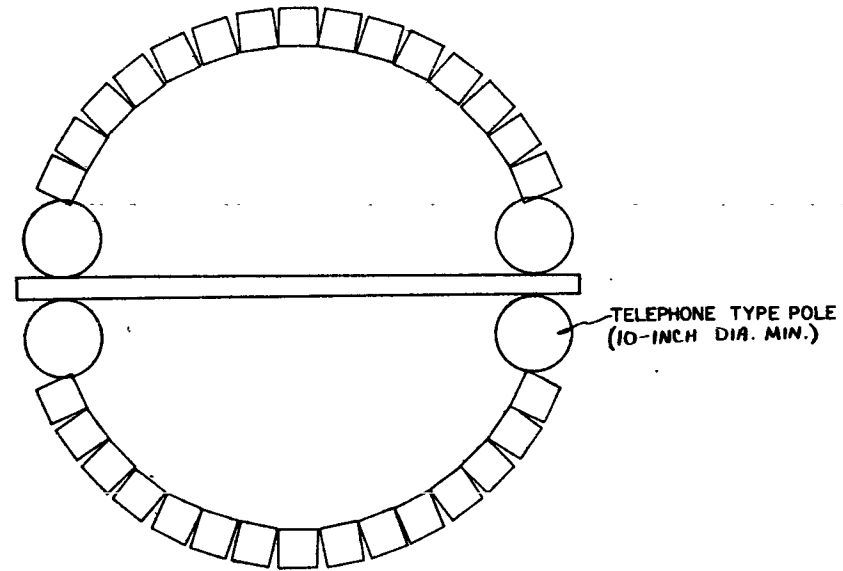

NOTE : ALL DIMENSIONS ARE APPROXIMATE

TOP VIEW

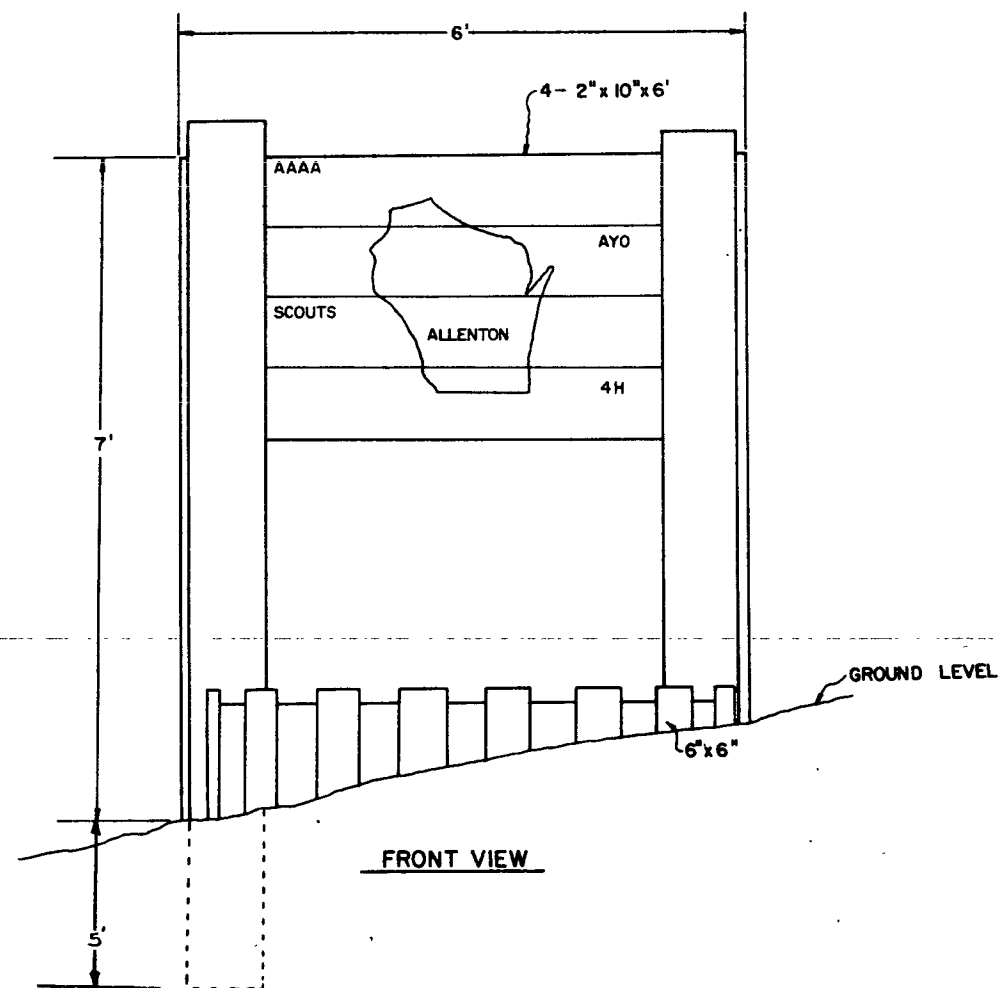

FRONT VIEW

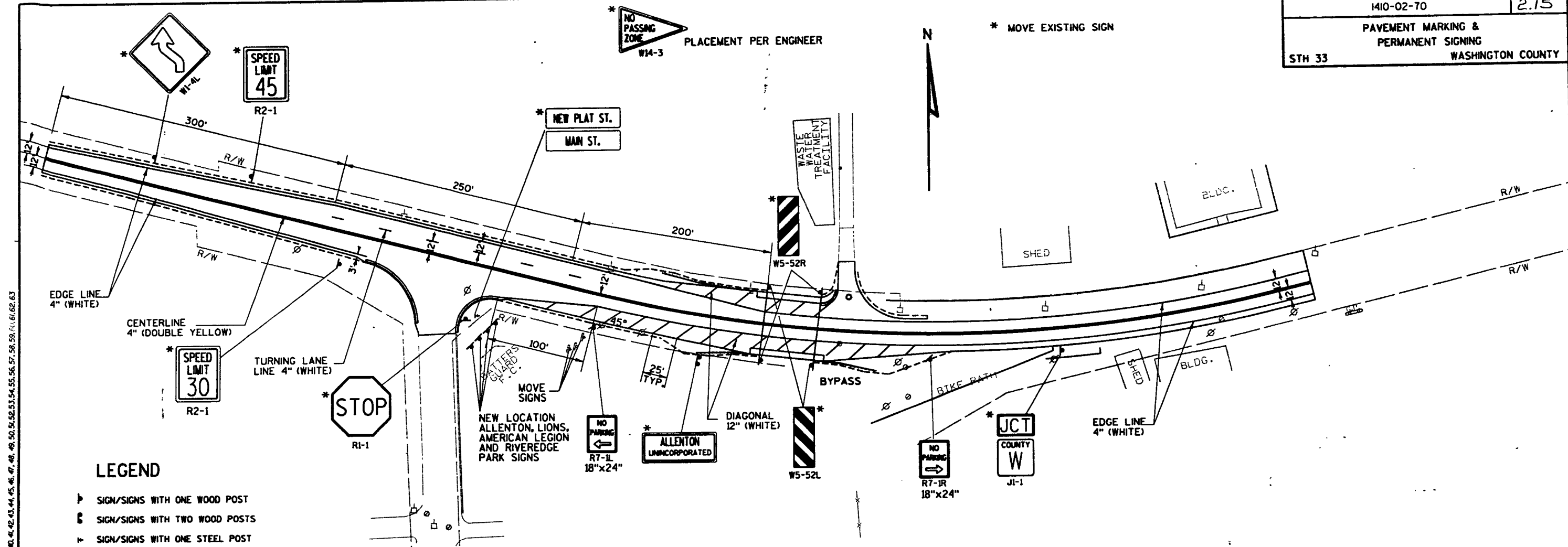

LEGEND

- ▶ SIGN/SIGNS WITH ONE WOOD POST
- ◀ SIGN/SIGNS WITH TWO WOOD POSTS
- ▼ SIGN/SIGNS WITH ONE STEEL POST

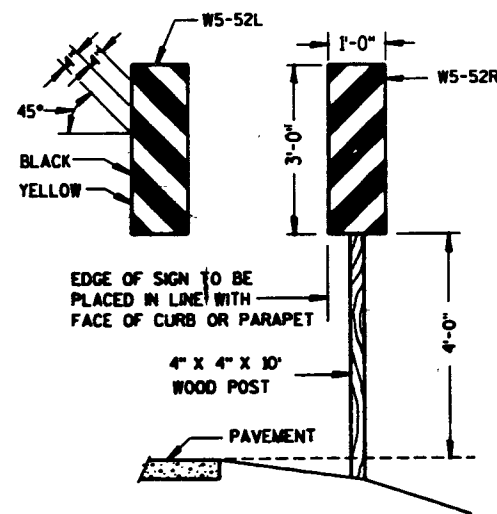

GENERAL NOTES FOR PERMANENT SIGNING

DETAILS OF TRAFFIC CONTROL DEVICES AND INSTALLATION NOT SHOWN ON THIS DRAWING SHALL CONFORM TO THE PERTINENT REQUIREMENTS OF THE STANDARD SPECIFICATIONS, THE SPECIAL PROVISIONS, AND THE MANUAL ON UNIFORM TRAFFIC CONTROL DEVICES.

LOCATE OBJECT MARKER POST(S) BEHIND GUARDRAIL WHEN PRESENT.

NO PASSING SIGNS (W14-3) SHALL BE PLACED ACCORDINGLY, FOLLOWING CONTRACTOR LOCATION OF NO PASSING ZONE.

ALL EXISTING SIGNS INTERFERING WITH CONSTRUCTION SHALL BE REMOVED SALVAGED AND RELOCATED AT A NEW LOCATION FROM THE EDGE OF PAVEMENT OR AS DIRECTED BY THE ENGINEER.

SALVAGED SIGNS SHALL BE ERECTED WITH NEW POSTS.

GENERAL NOTES FOR PAVEMENT MARKING

DETAILS OF CONSTRUCTION NOT SHOWN ON THIS DRAWING SHALL CONFORM TO STANDARD SPECIFICATIONS AND SPECIAL PROVISIONS.

EDGE LINES SHALL BE OMITTED THROUGH INTERSECTIONS. EDGE LINES SHALL BE CONTINUED THROUGH DRIVEWAYS.

HALF CYCLE LENGTHS (25') WITH 2' MINIMUM STRIPE LENGTHS SHALL BE PROVIDED ON ROADWAYS (INCLUDING TEMPORARY TRAVELED WAYS) WITH REVERSE CURVATURE, CURVATURE OF OVER 5 DEGREES OR WHEN DIRECTED BY THE ENGINEER TO MARK UNUSUAL ALIGNMENT OF THE TRAVELED WAY.

CONTRACTOR SHALL SPOT NO-PASSING ZONE MARKING WHERE SIGHT DISTANCE IS DEFICIENT.

LEVELS ON = 1, 2, 3, 4, 5, 6, 7, 8, 9, 10, 11, 12, 13, 14, 15, 16, 17, 18, 19, 20, 21, 22, 23, 24, 25, 26, 27, 28, 29, 30, 31, 32, 33, 34, 35, 36, 37, 38, 39, 40, 41, 42, 43, 44, 45, 46, 47, 48, 49, 50, 51, 52, 53, 54, 55, 56, 57, 58, 59, 60, 61, 62, 63

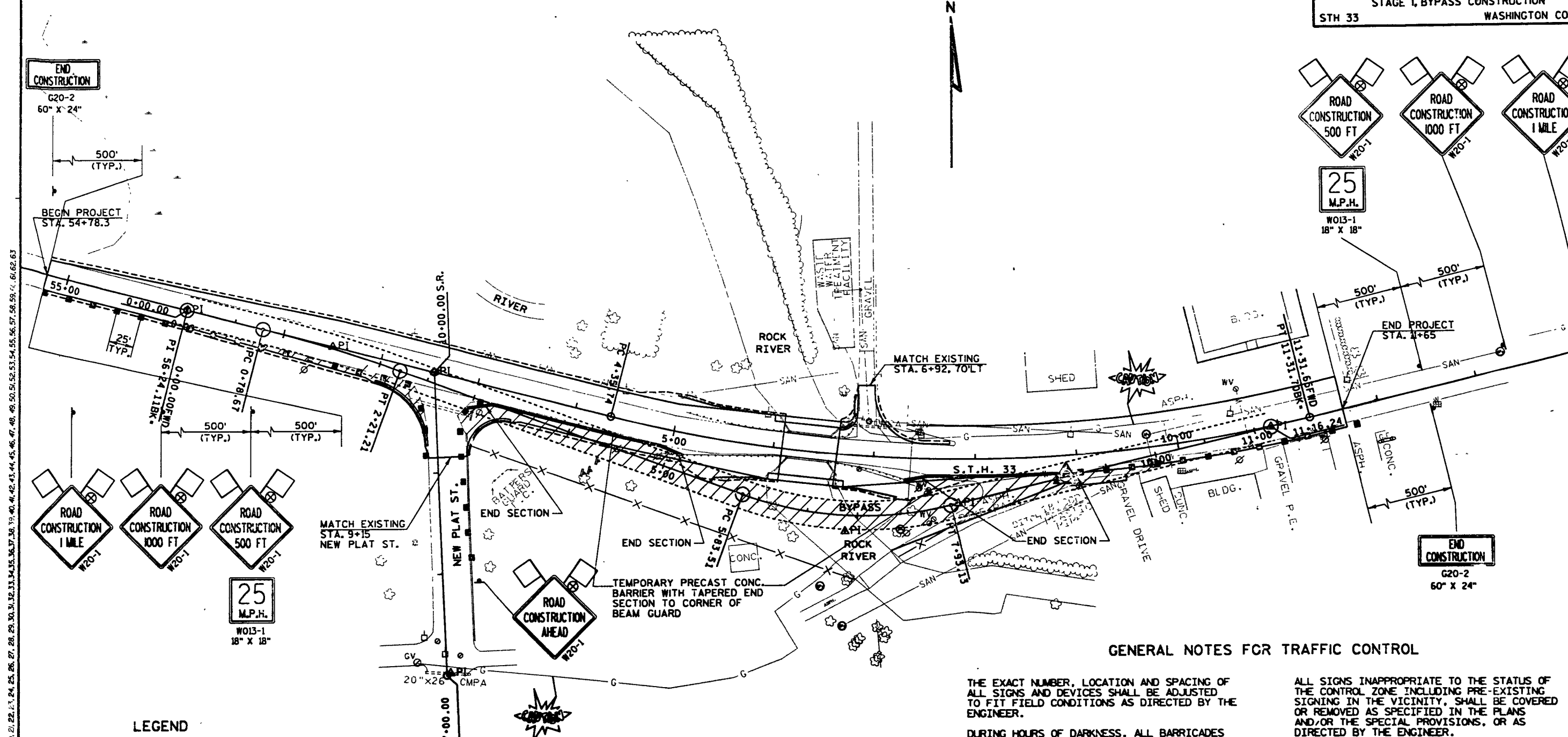

LEGEND

- WORK AREA
- SIGN ON PERMANENT SUPPORT
- DRUMS WITH TYPE "C" (STEADY BURN) LIGHTS. 25 FT. SPACING (TYP.)
- TYPE III BARRICADE 8' LONG WITH TWO TYPE "A" (LOW-INTENSITY FLASHING) LIGHTS.
- TEMPORARY PRECAST CONCRETE BARRIER WITH REFLECTIVE DELINEATORS
- SAFETY FENCE AT T.L.E. LIMIT

GENERAL NOTES FOR TRAFFIC CONTROL

- THE EXACT NUMBER, LOCATION AND SPACING OF ALL SIGNS AND DEVICES SHALL BE ADJUSTED TO FIT FIELD CONDITIONS AS DIRECTED BY THE ENGINEER.
- DURING HOURS OF DARKNESS, ALL BARRICADES USED TO SHIELD A HAZARD SHALL BE EQUIPPED WITH TYPE "A" (LOW-INTENSITY FLASHING) LIGHTS AND DEVICES USED TO DELINEATE A TRAVEL PATH SHALL BE EQUIPPED WITH TYPE "C" (STEADY BURN) LIGHTS.
- FOR NIGHT TIME OPERATION ALL ADVANCE WARNING SIGNS SHALL HAVE A TYPE "A" (LOW-INTENSITY FLASHING) LIGHT.
- PAVEMENT MARKINGS NOT APPROPRIATE TO THE TRAVEL PATH SHALL BE REMOVED.
- WHEN A SIDE ROAD OR RAMP INTERSECTS THE FACILITY ON WHICH THE WORK IS BEING PERFORMED, ADDITIONAL TRAFFIC CONTROLS SHALL BE PROVIDED AS SPECIFIED IN THE PLANS AND/OR THE SPECIAL PROVISIONS OR AS DIRECTED BY THE ENGINEER.
- ALL SIGNS INAPPROPRIATE TO THE STATUS OF THE CONTROL ZONE INCLUDING PRE-EXISTING SIGNING IN THE VICINITY, SHALL BE COVERED OR REMOVED AS SPECIFIED IN THE PLANS AND/OR THE SPECIAL PROVISIONS, OR AS DIRECTED BY THE ENGINEER.
- ALL SIGNS ARE 48"x48" UNLESS OTHERWISE NOTED.
- "W" SIGNS ARE THE SAME AS "W" SIGNS, EXCEPT THE BACKGROUND IS ORANGE.
- CONTRACTOR SHALL PROVIDE DRIVEWAY ACCESS AT ALL TIMES.
- CONTRACTOR SHALL PROVIDE MINIMUM 11' DRIVING LANES AT ALL TIMES.

LEVELS ON = 1, 2, 3, 4, 5, 6, 7, 8, 9, 10, 11, 12, 13, 14, 15, 16, 17, 18, 19, 20, 21, 22, 23, 24, 25, 26, 27, 28, 29, 30, 31, 32, 33, 34, 35, 36, 37, 38, 39, 40, 41, 42, 43, 44, 45, 46, 47, 48, 49, 50, 51, 52, 53, 54, 55, 56, 57, 58, 59, 60, 61, 62, 63

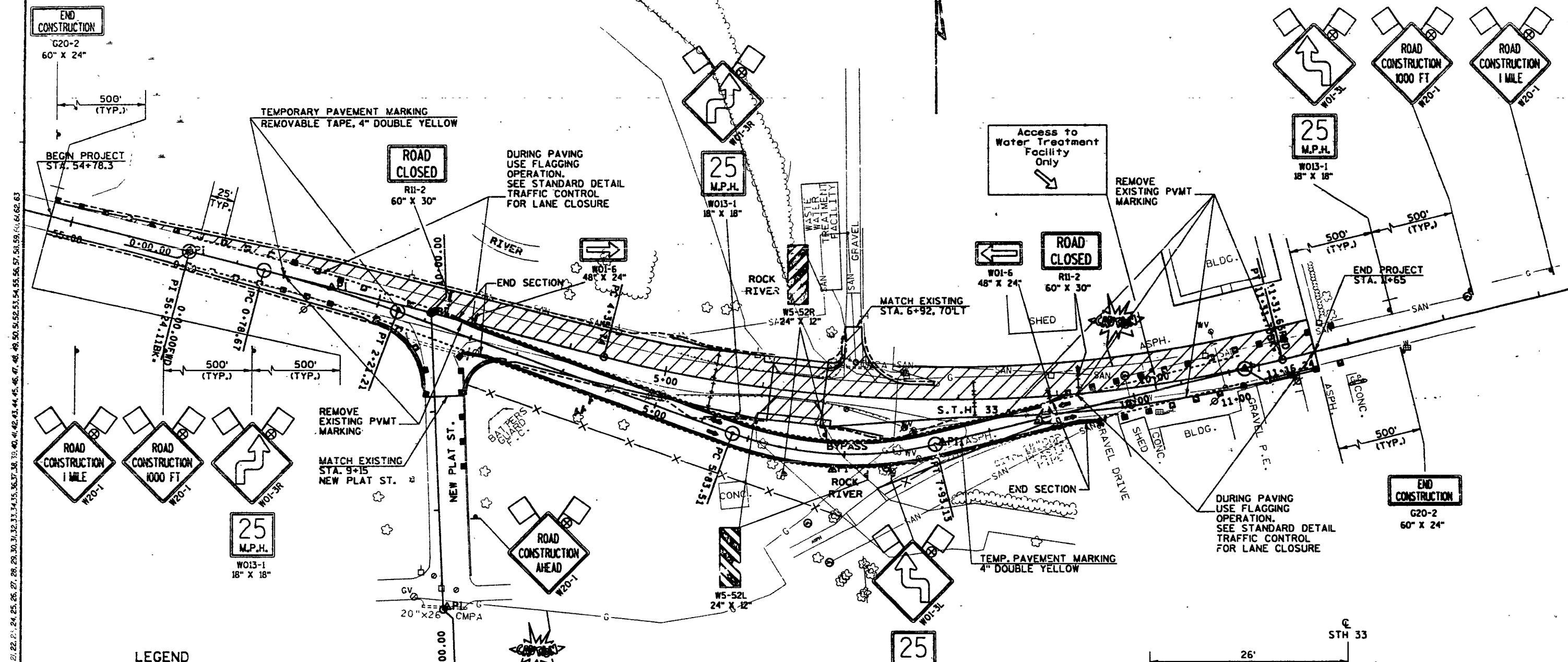

LEGEND

- WORK AREA
- SIGN ON PERMANENT SUPPORT
- DRUMS WITH TYPE "C" (STEADY BURN) LIGHTS. 25 FT. SPACING (TYP.)
- TYPE III BARRICADE 8' LONG WITH TWO TYPE "A" (LOW-INTENSITY FLASHING) LIGHTS.
- TEMPORARY PRECAST CONCRETE BARRIER WITH REFLECTIVE DELINEATORS
- SAFETY FENCE AT T.L.E. LIMITS

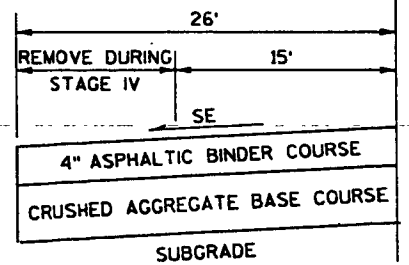

STA. TO STA.	SE
6+63 TO 7+75	0.041
7+75 TO 9+00	VARIES
9+00 TO 11+65	0.02

TEMPORARY ROADWAY FOR STAGE III CONSTRUCTION

LEVELS ON - 1, 2, 3, 4, 5, 6, 7, 8, 9, 10, 11, 12, 13, 14, 15, 16, 17, 18, 19, 20, 21, 22, 23, 24, 25, 26, 27, 28, 29, 30, 31, 32, 33, 34, 35, 36, 37, 38, 39, 40, 41, 42, 43, 44, 45, 46, 47, 48, 49, 50, 51, 52, 53, 54, 55, 56, 57, 58, 59, 60, 61, 62, 63

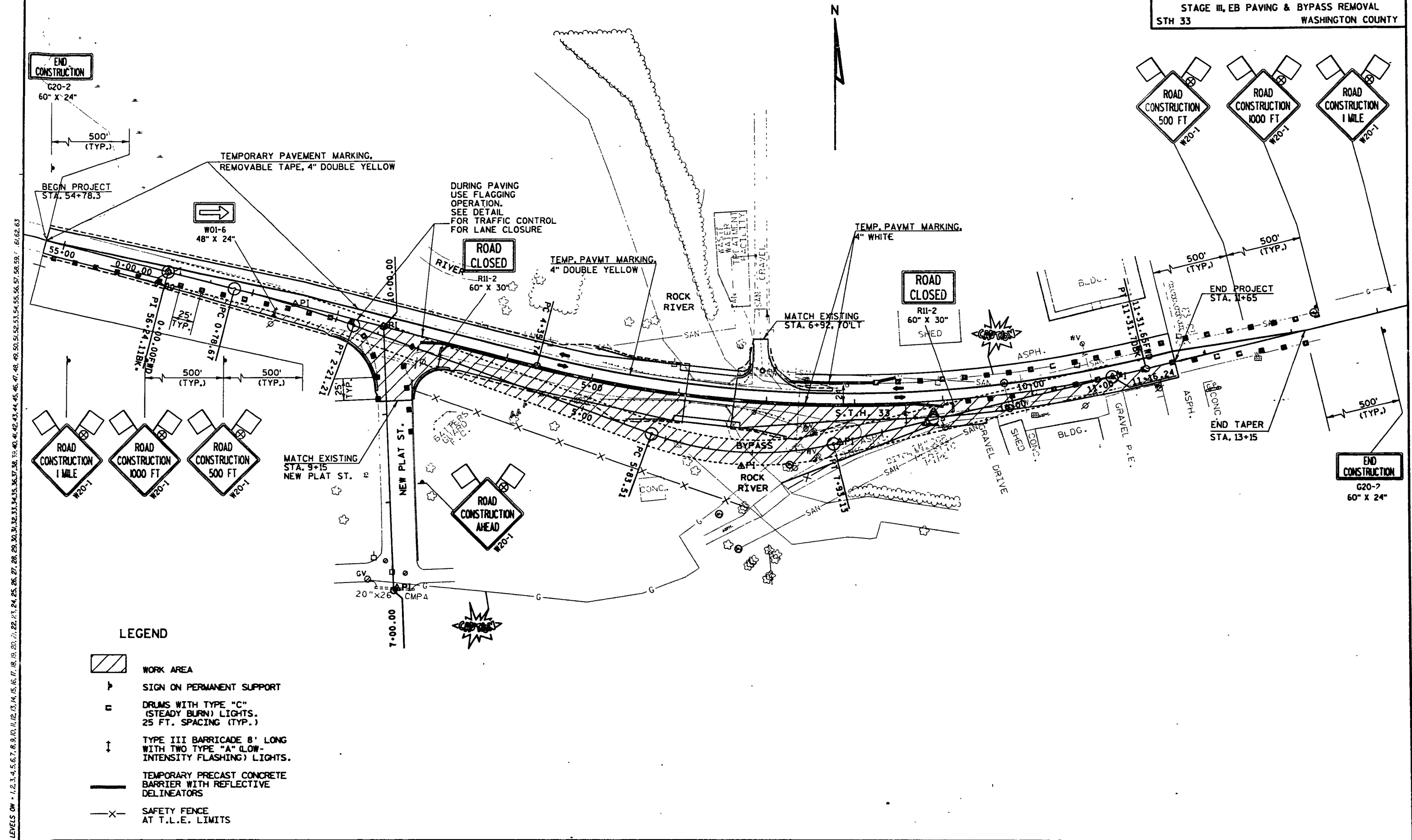

LEGEND

- WORK AREA
- SIGN ON PERMANENT SUPPORT
- DRUMS WITH TYPE "C" (STEADY BURN) LIGHTS. 25 FT. SPACING (TYP.)
- TYPE III BARRICADE 8' LONG WITH TWO TYPE "A" (LOW-INTENSITY FLASHING) LIGHTS.
- TEMPORARY PRECAST CONCRETE BARRIER WITH REFLECTIVE DELINEATORS
- SAFETY FENCE AT T.L.E. LIMITS

LEVELS ON - 1, 2, 3, 4, 5, 6, 7, 8, 9, 10, 11, 12, 13, 14, 15, 16, 17, 18, 19, 20, 21, 22, 23, 24, 25, 26, 27, 28, 29, 30, 31, 32, 33, 34, 35, 36, 37, 38, 39, 40, 41, 42, 43, 44, 45, 46, 47, 48, 49, 50, 51, 52, 53, 54, 55, 56, 57, 58, 59, 60, 61, 62, 63

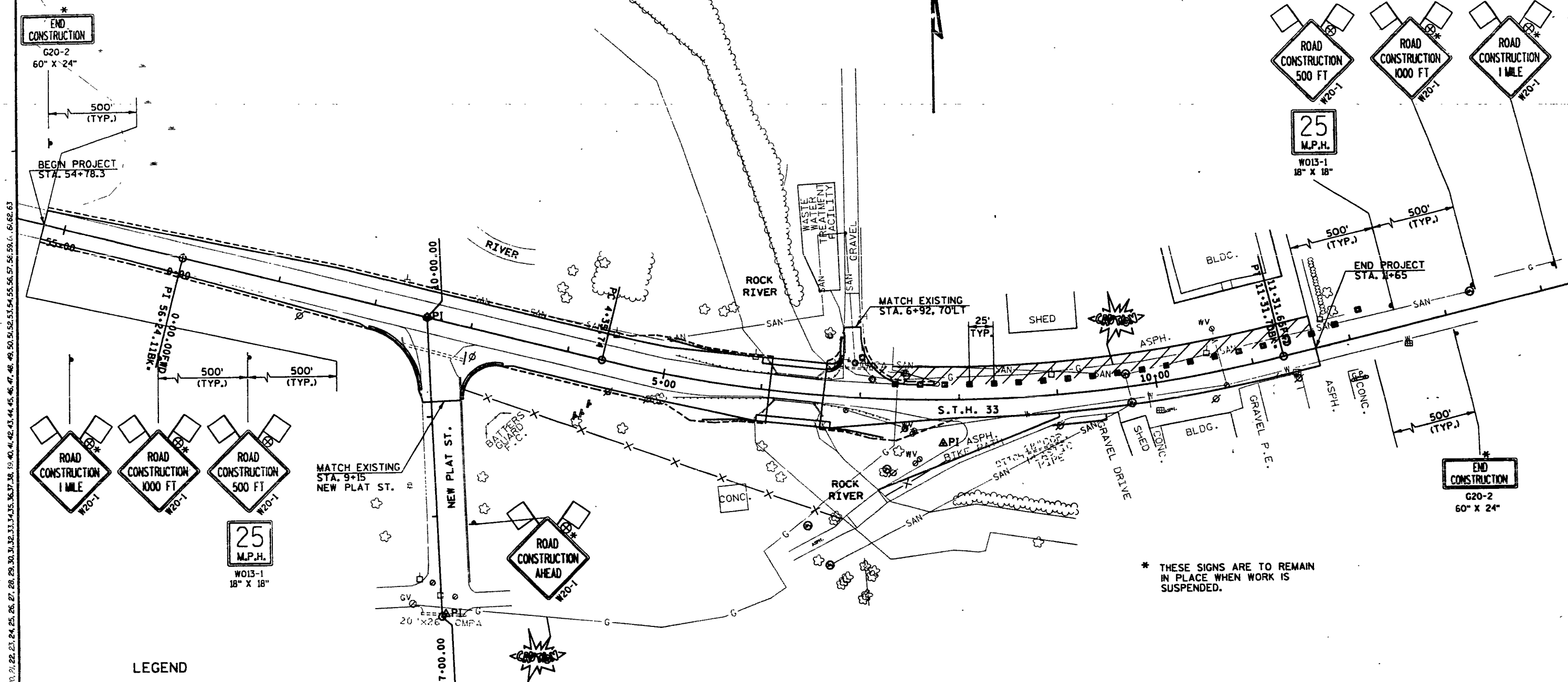

* THESE SIGNS ARE TO REMAIN IN PLACE WHEN WORK IS SUSPENDED.

LEGEND

- WORK AREA
- SIGN ON PERMANENT SUPPORT
- DRUMS WITH TYPE "C" (STEADY BURN) LIGHTS. 25 FT. SPACING (TYP.)
- TYPE III BARRICADE 8' LONG WITH TWO TYPE "A" (LOW-INTENSITY FLASHING) LIGHTS.
- TEMPORARY PRECAST CONCRETE BARRIER WITH REFLECTIVE DELINEATORS
- SAFETY FENCE AT T.L.E. LIMITS

LEVELS ON - 1.2, 1.3, 1.4, 1.5, 1.6, 1.7, 1.8, 1.9, 2.0, 2.1, 2.2, 2.3, 2.4, 2.5, 2.6, 2.7, 2.8, 2.9, 3.0, 3.1, 3.2, 3.3, 3.4, 3.5, 3.6, 3.7, 3.8, 3.9, 4.0, 4.1, 4.2, 4.3, 4.4, 4.5, 4.6, 4.7, 4.8, 4.9, 5.0, 5.1, 5.2, 5.3, 5.4, 5.5, 5.6, 5.7, 5.8, 5.9, 6.0, 6.1, 6.2, 6.3