

TRANSPORTATION PROJECT PLAT NO: 9261-07-20-4.01

BEING PART OF LOT 1 OF CSM RECORDED VOLUME 2, PAGE 68 AS DOCUMENT NUMBER 104939 LOCATED IN PART OF THE SW1/4 OF THE NW1/4 AND IN AND INCLUDING PART OF THE NW1/4 OF THE NW1/4 OF SECTION 33 AND PART OF THE NE1/4 OF THE NE1/4 OF SECTION 32, ALL IN TOWNSHIP 37 NORTH, RANGE 13 EAST, TOWN OF ARGONNE, FOREST COUNTY, WISCONSIN

RELOCATION ORDER - STH 32, CRANDON - THREE LAKES (CULVERT REPLACEMENTS), FOREST COUNTY

TO PROPERLY ESTABLISH, LAY OUT, WIDEN, ENLARGE, EXTEND, CONSTRUCT, RECONSTRUCT, IMPROVE, OR MAINTAIN A PORTION OF THE HIGHWAY DESIGNATED ABOVE, THE STATE OF WISCONSIN DEPARTMENT OF TRANSPORTATION DEEMS IT NECESSARY TO RELOCATE OR CHANGE SAID HIGHWAY AND ACQUIRE CERTAIN LANDS AND INTERESTS OR RIGHTS IN LANDS FOR THE ABOVE PROJECT.

TO EFFECT THIS CHANGE, PURSUANT TO AUTHORITY GRANTED UNDER SECTION 84.02 (3), 84.09, AND 84.30, WISCONSIN STATUTES, THE DEPARTMENT OF TRANSPORTATION HEREBY ORDERS THAT:

- THAT PORTION OF SAID HIGHWAY AS SHOWN ON THIS PLAT IS LAID OUT AND ESTABLISHED TO THE LINES AND WIDTHS AS SO SHOWN FOR THE ABOVE PROJECT.
- THE LANDS OR INTERESTS OR RIGHTS IN LANDS AS SHOWN ON THIS PLAT ARE REQUIRED BY THE DEPARTMENT FOR THE ABOVE PROJECT AND SHALL BE ACQUIRED IN THE NAME OF THE STATE OF WISCONSIN, PURSUANT TO THE PROVISIONS OF SECTION 84.09 (1) OR (2), WISCONSIN STATUTES.

NOTES:

POSITIONS SHOWN ON THIS PLAT ARE WISCONSIN COORDINATE REFERENCE SYSTEM COORDINATES (WISCRS), FOREST COUNTY, NAD83 (2011) IN US SURVEY FEET. VALUES SHOWN ARE GRID COORDINATES, GRID BEARINGS, AND GRID DISTANCES. GRID DISTANCES MAY BE USED AS GROUND DISTANCES.

ALL NEW RIGHT-OF-WAY MONUMENTS WILL BE TYPE 2 (TYPICALLY 3/4"x24" IRON REBARS) UNLESS OTHERWISE NOTED, AND WILL BE PLACED PRIOR TO THE COMPLETION OF THE PROJECT.

ALL RIGHT-OF-WAY LINES DEPICTED IN THE NON-ACQUISITION AREAS ARE INTENDED TO RE-ESTABLISH EXISTING RIGHT-OF-WAY LINES AS DETERMINED FROM PREVIOUS PROJECTS, OTHER RECORDED DOCUMENTS, OR FROM CENTERLINE OF EXISTING PAVEMENTS.

RIGHT-OF-WAY BOUNDARIES ARE DEFINED WITH COURSES OF THE PERIMETER OF THE HIGHWAY LANDS REFERENCED TO THE U.S. PUBLIC LAND SURVEY SYSTEM OR OTHER "SURVEYS" OF PUBLIC RECORD.

DIMENSIONING FOR THE NEW RIGHT-OF-WAY IS MEASURED ALONG AND PERPENDICULAR TO THE NEW REFERENCE LINES.

A TEMPORARY LIMITED EASEMENT (TLE) IS A RIGHT FOR CONSTRUCTION PURPOSES, AS DEFINED HEREIN, INCLUDING THE RIGHT TO OPERATE NECESSARY EQUIPMENT THEREON, THE RIGHT OF INGRESS AND EGRESS, AS LONG AS REQUIRED FOR SUCH PUBLIC PURPOSE, INCLUDING THE RIGHT TO PRESERVE, PROTECT, REMOVE, OR PLANT THEREON ANY VEGETATION THAT THE HIGHWAY AUTHORITIES MAY DEEM DESIRABLE. ALL (TLES) ON THIS PLAT EXPIRE AT THE COMPLETION OF THE CONSTRUCTION PROJECT FOR WHICH THIS INSTRUMENT IS GIVEN.

A PERMANENT LIMITED EASEMENT (PLE) IS A RIGHT FOR CONSTRUCTION AND MAINTENANCE PURPOSES, AS DEFINED HEREIN, INCLUDING THE RIGHT TO OPERATE NECESSARY EQUIPMENT THEREON AND THE RIGHT OF INGRESS AND EGRESS, AS LONG AS REQUIRED FOR SUCH PUBLIC PURPOSE, INCLUDING THE RIGHT TO PRESERVE, PROTECT, REMOVE OR PLANT THEREON ANY VEGETATION THAT THE HIGHWAY AUTHORITIES MAY DEEM DESIRABLE, BUT WITHOUT PREJUDICE TO THE OWNERS'S RIGHTS TO MAKE OR CONSTRUCT IMPROVEMENTS ON SAID LANDS OR TO FLATTEN THE SLOPES, SAID ACTIVITIES WILL NOT IMPAIR OR OTHERWISE ADVERSELY AFFECT THE HIGHWAY FACILITIES.

AN EASEMENT FOR HIGHWAY PURPOSES (HE), AS LONG AS SO USED, INCLUDING THE RIGHT TO PRESERVE, PROTECT, REMOVE, OR PLANT THEREON ANY VEGETATION THAT THE HIGHWAY AUTHORITIES MAY DEEM DESIRABLE.

PROPERTY LINES SHOWN ON THIS PLAT ARE DRAWN FROM DATA DERIVED FROM MAPS AND DOCUMENTS OF PUBLIC RECORD AND/OR EXISTING OCCUPATIONAL LINES. THIS PLAT MAY NOT BE A TRUE REPRESENTATION OF EXISTING PROPERTY LINES, EXCLUDING RIGHT-OF-WAY, AND SHOULD NOT BE USED AS A SUBSTITUTE FOR AN ACCURATE FIELD SURVEY.

FOR THE LATEST ACCESS/DRIVEWAY INFORMATION, CONTACT THE PLANNING UNIT OF THE WISCONSIN DEPARTMENT OF TRANSPORTATION OFFICE IN RHINELANDER, WI.

PARCEL AND UTILITY IDENTIFICATION NUMBERS MAY NOT POINT TO ALL AREAS OF ACQUISITION, AS NOTED ON THE TYPING DETAIL PAGES.

EXISTING HIGHWAY RIGHT-OF-WAY SHOWN HEREIN IS BASED ON THE FOLLOWING POINTS OF REFERENCE FOR STH 32: CSM DOC #104939 VOLUME 2 PAGE 68, AND EXISTING CENTERLINE.

COURSE TABLE		
COURSE	BEARING	DISTANCE
1000-1001	S89° 37' 56"W	2.42'
1001-1002	S89° 37' 56"W	33.00'
1002-PLE1003	N00° 22' 04"W	168.27'
PLE1003-1006	N00° 22' 04"W	3.43'
1006-PLE1007	SEE CURVE DATA	
PLE1003-PLE1004	S89° 37' 56"W	35.01'
PLE1004-PLE1005	N00° 18' 02"W	10.25'
PLE1005-PLE1007	N89° 39' 59"E	35.00'
PLE1007-1008	SEE CURVE DATA	
1008-HE1009	N00° 05' 03"W	19.49'
HE1009-HE1010	S89° 54' 57"W	15.00'
HE1010-HE1011	N00° 05' 03"W	37.83'
HE1011-HE1012	N00° 05' 03"W	3.31'
HE1012-HE1013	N89° 54' 57"E	15.00'
HE1013-1014	N00° 05' 03"W	217.46'
1014-1015	N89° 54' 57"E	33.00'
1015-1016	N89° 54' 57"E	2.22'
1016-1017	N89° 54' 57"E	30.78'
1017-HE1018	S00° 05' 03"E	228.53'
HE1018-HE1019	N90° 00' 00"E	15.00'
HE1019-HE1020	S00° 05' 03"E	8.66'
HE1020-HE1021	S00° 05' 03"E	30.35'
HE1021-HE1022	S89° 54' 57"W	15.00'
HE1022-1023	S00° 05' 03"E	10.53'
1023-1024	SEE CURVE DATA	
1024-1025	S00° 22' 04"E	171.70'
1025-1000	S89° 37' 56"W	30.58'

CURVE 1
PI STA = 49+43.51
Y = 599153.028
X = 841209.363
DELTA = 0°17'01" LT
D = 0°30'00"
T = 28.35'
L = 56.69'
R = 11459.16'
PC STA = 49+15.16
PT STA = 49+71.86

1006-1008
LCB=N00°13'33"W
LCH=56.86'
L=56.86'
R=11492.16'

1006-PLE1007
LCB=N00°21'02"W
LCH=6.81'
L=6.81'
R=11492.16'

CONVENTIONAL SYMBOLS

SECTION LINE	---+---	SECTION CORNER SYMBOL		R/W MONUMENT	●
QUARTER LINE	---+---	SECTION CORNER MONUMENT		NON-MONUMENTED R/W POINT	○
SIXTEENTH LINE	---+---	GEODETIC SURVEY MONUMENT		FOUND IRON PIN (1-INCH UNLESS NOTED)	IP
NEW REFERENCE LINE	---+---	SIXTEENTH CORNER MONUMENT		OFF-PREMISE SIGN	
NEW R/W LINE	---+---	SIGN		COMPENSABLE	
EXISTING R/W OR HE LINE	---+---	OFF-PREMISE SIGN		NON-COMPENSABLE	
PROPERTY LINE	---+---	OFF-PREMISE SIGN		WATER	W
LOT, TIE & OTHER MINOR LINES	---+---	OFF-PREMISE SIGN		GAS	G
SLOPE INTERCEPT	---+---	OFF-PREMISE SIGN		TELEPHONE OVERHEAD	OH
CORPORATE LIMITS	---+---	OFF-PREMISE SIGN		TRANSMISSION LINES	TL
UNDERGROUND FACILITY (COMMUNICATIONS, ELECTRIC, ETC)	---+---	OFF-PREMISE SIGN		ELECTRIC	E
NEW R/W (FEE OR HE) (HATCHING VARIES BY OWNER)	---+---	OFF-PREMISE SIGN		CABLE TELEVISION	CTV
TEMPORARY LIMITED EASEMENT AREA	---+---	OFF-PREMISE SIGN		FIBER OPTIC	FO
EASEMENT AREA (PERMANENT LIMITED OR RESTRICTED DEVELOPMENT)	---+---	OFF-PREMISE SIGN		SANITARY SEWER	SS
TRANSMISSION STRUCTURES	---+---	OFF-PREMISE SIGN		STORM SEWER	SS
BUILDING		OFF-PREMISE SIGN			
TO BE REMOVED		OFF-PREMISE SIGN			
BRIDGE		OFF-PREMISE SIGN			

EXISTING MONUMENTS			
POINT	Y (NORTHING)	X (EASTING)	DESCRIPTION
IP751	599365.691	841175.975	2-3/8" O.D. IRON PIPE
IP752	599365.734	841176.124	0.5" IRON ROD
IP754	599109.552	841243.284	1.00" O.D. IRON PIPE

UTILITY INTERESTS REQUIRED

UTILITY NUMBER	OWNER(S)	INTEREST REQUIRED
201	WISCONSIN PUBLIC SERVICE COMPANY (ELECTRIC)	RELEASE OF RIGHTS
202	WISCONSIN PUBLIC SERVICE COMPANY (GAS)	RELEASE OF RIGHTS
203	FRONTIER NORTH INC. (COMMUNICATION)	RELEASE OF RIGHTS

SCHEDULE OF LANDS & INTERESTS REQUIRED

OWNER'S NAMES ARE SHOWN FOR REFERENCE PURPOSES ONLY AND ARE SUBJECT TO CHANGE PRIOR TO THE TRANSFER OF LAND INTERESTS TO THE DEPARTMENT.				
PARCEL NUMBER	OWNERS	INTEREST REQUIRED	HE SQ. FT.	PLE SQ. FT.
1	ALLEN C. KEEPERS AND KIM L. KEEPERS, TRUSTEES OF THE AKK INCOME TRUST DATED DECEMBER 18, 2014	HE/PLE/TLE	617	359
2	KENNETH KEEPERS, JR.	TLE	---	---
3	CHRISTOPHER L. GESKE AND JAMES L. GESKE	HE/TLE	586	---
4	MELVIN J. PITTS AND DARLA E. PITTS, CARL J. PITTS, HIS WIFE, A LIFE ESTATE INTREST; AND EDWARD L. PTTS, CARL J. PITTS AND HELEN SUSAN VILLALPANDO, AS TENANTS IN COMMON, A REMAINDER INTEREST	TLE	---	---

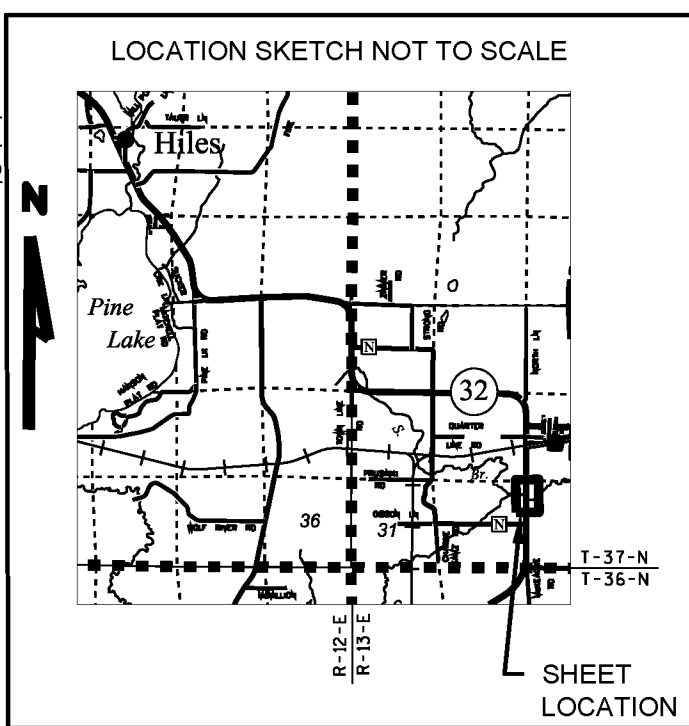
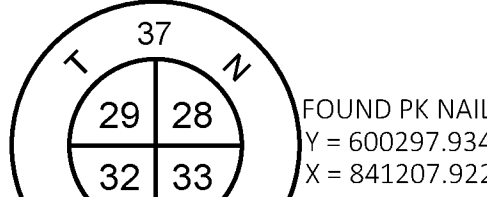

DOC #232954
CORTNEY BRITTEN
CLEEREMAN
REGISTER OF DEEDS
FOREST COUNTY, WI
RECEIVED FOR RECORD
Jan 13, 2021
4:00 PM
RECORDING FEE: \$25.00
TRANSFER FEE: \$0.00
FEE EXEMPT: #
NUMBER OF PAGES: 1
The above recording information verifies that this document has been electronically recorded and returned to WisDOT - NE Region - Green Bay - P
RESERVED FOR REGISTER OF DEEDS
PROJECT NUMBER 9261-07-20-4.01
AMENDMENT NO:

SCALE, FEET 0 20 40

NW/NW

- 201 WISCONSIN PUBLIC SERVICE COMPANY (ELECTRIC) DOC 1420494 - PAR 1, PAR 2
- 202 WISCONSIN PUBLIC SERVICE COMPANY (GAS) NO RECORD EASEMENT - PAR 3, PAR 4
- 203 FRONTIER NORTH INC. (COMMUNICATION) NO RECORD EASEMENT - PAR 3, PAR 4

CONVENTIONAL ABBREVIATIONS

ACCESS RIGHTS	AR	POINT OF INTERSECTION	PI
ACRES	AC	PROPERTY LINE	PL
AHEAD	AH	RECORDED AS	(100')
ALUMINUM	ALUM	REEL / IMAGE	R/I
AND OTHERS	ET AL	REFERENCE LINE	R/L
BACK	BK	REMAINING	REM
BLOCK	BLK	RESTRICTIVE DEVELOPMENT	RDE
CENTERLINE	C/L	EASEMENT	
CERTIFIED SURVEY MAP	CSM	RIGHT	RT
CONCRETE	CONC	RIGHT OF WAY	R/W
COUNTY	CO	SECTION	SEC
COUNTY TRUNK HIGHWAY	CTH	SEPTIC VENT	SEPV
DISTANCE	DIST	SQUARE FEET	SF
CORNER	COR	STATE TRUNK HIGHWAY	STH
DOCUMENT NUMBER	DOC	STATION	STA
EASEMENT	EASE	TELEPHONE PEDESTAL	TP
EXISTING	EX	TEMPORARY LIMITED	TLE
GAS VALVE	GV	EASEMENT	
GRID NORTH	GN	TRANSPORTATION PROJECT	TPP
HIGHWAY EASEMENT	HE	PLAT	
IDENTIFICATION	ID	UNITED STATES HIGHWAY	USH
LAND CONTRACT	LC	VOLUME	V
LEFT	LT		
MONUMENT	MON		
NATIONAL GEODETIC SURVEY	NGS		
NUMBER	NO		
OUTLOT	OL		
PAGE	P		
POINT OF TANGENCY	PT		
PERMANENT LIMITED	PLE		
EASEMENT			
POINT OF BEGINNING	POB		
POINT OF CURVATURE	PC		
POINT OF COMPOUND CURVE	PCC		

CURVE DATA

LONG CHORD	LCH
LONG CHORD BEARING	LCB
RADIUS	R
DEGREE OF CURVE	D
CENTRAL ANGLE	Δ/DELTA
LENGTH OF CURVE	L
TANGENT	T
DIRECTION AHEAD	DA
DIRECTION BACK	DB

TLE STATION & OFFSET TABLE		
POINT NO.	STATION	OFFSET
TLE1050	48+72.48	-33.00'
TLE1051	48+72.48	-46.01'
TLE1052	48+90.91	-46.01'
TLE1053	48+90.96	-73.07'
TLE1054	49+28.36	-73.00'
TLE1055	49+28.26	-53.00'
TLE1056	49+91.35	-52.92'
TLE1057	49+91.35	-62.94'
TLE1058	50+08.69	-62.95'
TLE1059	49+86.21	-33.00'
TLE1060	50+35.38	-53.00'
TLE1061	51+94.04	-53.00'
TLE1062	51+94.04	-38.00'
TLE1063	52+49.96	-38.00'
TLE1064	52+12.09	33.00'
TLE1065	52+12.07	43.00'
TLE1066	51+43.77	43.00'
TLE1067	51+43.77	53.00'
TLE1068	50+21.43	53.06'
TLE1069	50+21.43	63.06'
TLE1070	50+13.31	63.07'
TLE1071	49+77.08	53.15'
TLE1072	49+78.37	33.00'
TLE1073	49+20.30	53.00'
TLE1074	49+20.30	48.00'
TLE1075	47+43.54	48.00'

STATION & OFFSET TABLE		
POINT NO.	STATION	OFFSET
1000	47+43.47	2.42'
1001	47+43.47	0.00'
1002	47+43.47	-33.00'
PLE1003	49+11.74	-33.00'
PLE1004	49+11.74	-68.01'
PLE1005	49+21.95	-68.00'
1006	49+15.16	-33.00'
PLE1007	49+21.95	-33.00'
1008	49+71.86	-33.00'
HE1009	49+91.35	-33.00'
HE1010	49+91.35	-48.00'
HE1011	50+29.18	-48.00'
HE1012	50+32.49	-48.00'
HE1013	50+32.49	-33.00'
1014	52+49.96	-33.00'
1015	52+49.96	0.00'
1016	52+49.96	2.22'
1017	52+49.96	33.00'
HE1018	50+21.43	33.00'
HE1019	50+21.41	48.00'
HE1020	50+12.74	48.00'
HE1021	49+82.39	48.00'
HE1022	49+82.39	33.00'
1023	49+71.86	33.00'
1024	49+15.16	33.00'
1025	47+43.47	33.00'

ALL PLES ARE FOR DRAINAGE PURPOSES.

ALL TLES ARE FOR SLOPE GRADING PURPOSES.

LOT 1
CSM DOC #104939
V2 P 68

ARGONNE

SW/NW

TLE1075

emcs

I, KEVIN C. BOYER PROFESSIONAL LAND SURVEYOR, HEREBY CERTIFY THAT IN FULL COMPLIANCE WITH THE PROVISIONS OF SECTION 84.095 OF THE WISCONSIN STATUTES AND UNDER THE DIRECTION OF THE DEPARTMENT OF TRANSPORTATION, I HAVE SURVEYED AND MAPPED THIS TRANSPORTATION PROJECT PLAT AND SUCH PLAT CORRECTLY REPRESENTS ALL EXTERIOR BOUNDARIES OF THE SURVEYED LAND.

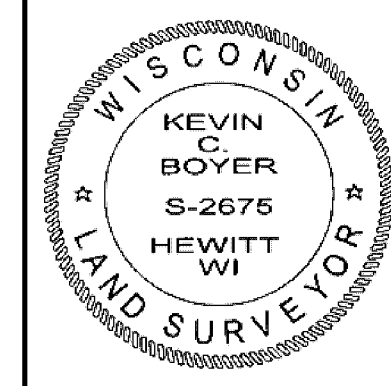

SIGNATURE: Kevin C. Boyer DATE: 1/13/2021

PRINT NAME: KEVIN C. BOYER

REGISTRATION NUMBER: S-2675

THIS PLAT AND RELOCATION ORDER ARE APPROVED FOR THE WISCONSIN DEPARTMENT OF TRANSPORTATION

SIGNATURE: Curt Van Erum DATE: 1/13/2021

PRINT NAME: CURT VAN EREM