

LEGEND

- PULL BOX 12" X 24"
- PULL BOX 24" X 36"
- PULL BOX 24" X 42"
- SIGNAL STANDARD, PEDESTAL BASE
- PEDESTRIAN SIGNAL W/PUSH BUTTON
- SIGNAL POLE, MONOTUBE ARM
- SIGNAL HEAD MAST-ARM MOUNT
- LUMINAIRE
- CONTROL CABINET BASE
- 3" CONDUIT (2" from PB to T1 concrete base)
- SIGNAL HEAD NUMBER MOUNTING CONFIGURATION
- LOOP DETECTOR

CONFIGURATION WITH HEAD NUMBERS					
3-V 	4-VLFY 	4-VL 	4-HL 	5-VR 	1-P
3, 4, 5 8, 9 14, 17	1, 2 6, 7	12, 15	13, 16	10, 11	18, 19 20, 21

MONOTUBE STRUCTURE NUMBERS	
SB5	S-70-0360
SB9	S-70-0361

NOTE: SIGNAL HEADS # 1 & # 6 REQUIRE TUNNEL VISORS

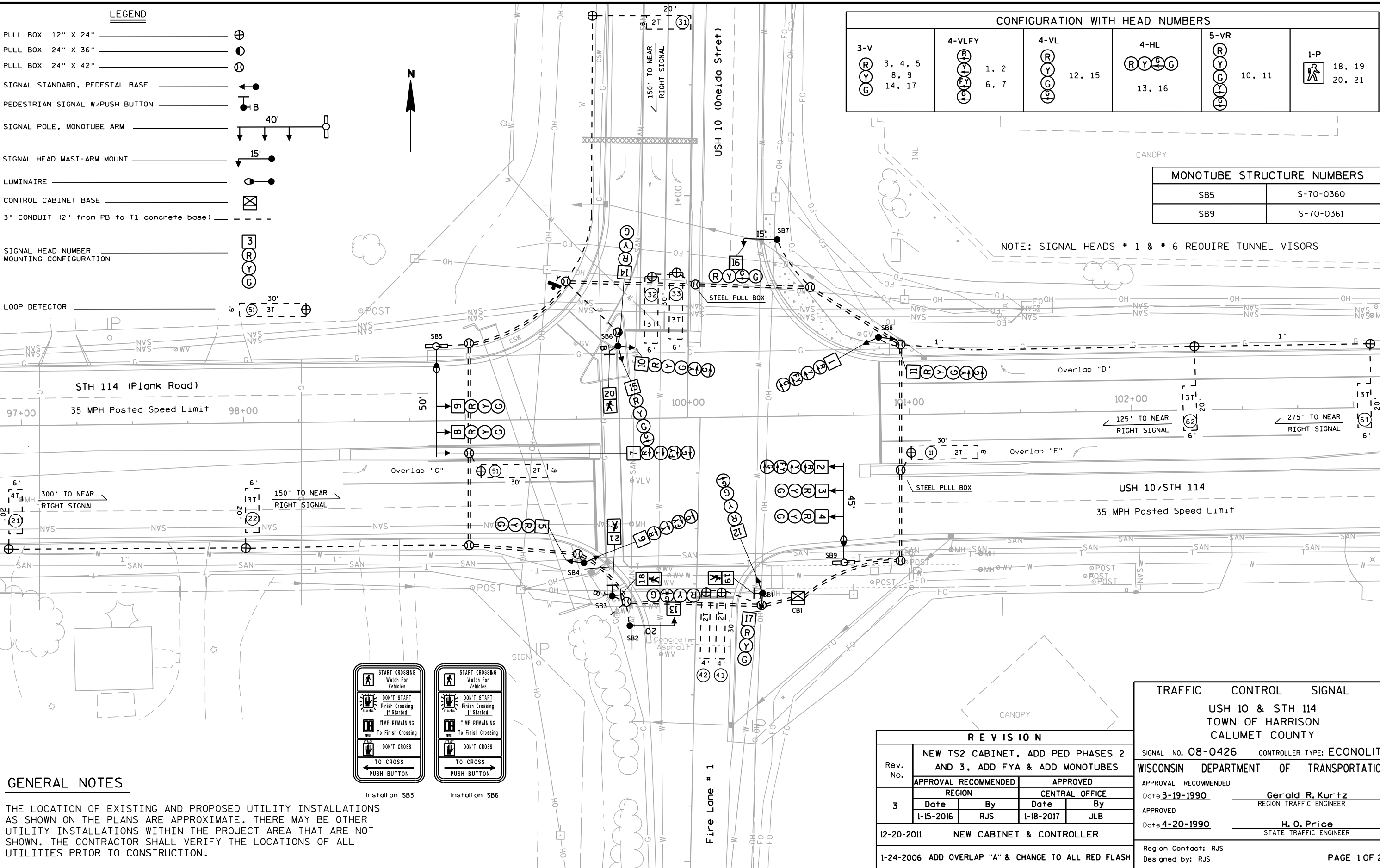

GENERAL NOTES

THE LOCATION OF EXISTING AND PROPOSED UTILITY INSTALLATIONS AS SHOWN ON THE PLANS ARE APPROXIMATE. THERE MAY BE OTHER UTILITY INSTALLATIONS WITHIN THE PROJECT AREA THAT ARE NOT SHOWN. THE CONTRACTOR SHALL VERIFY THE LOCATIONS OF ALL UTILITIES PRIOR TO CONSTRUCTION.

REVISION			
Rev. No.	NEW TS2 CABINET, ADD PED PHASES 2 AND 3, ADD FYA & ADD MONOTUBES		
3	APPROVAL RECOMMENDED		APPROVED
	REGION	CENTRAL OFFICE	
	Date	By	Date By
12-20-2011 NEW CABINET & CONTROLLER			
1-24-2006 ADD OVERLAP "A" & CHANGE TO ALL RED FLASH			

TRAFFIC CONTROL SIGNAL	
USH 10 & STH 114 TOWN OF HARRISON CALUMET COUNTY	
SIGNAL NO. 08-0426	CONTROLLER TYPE: ECONOLITE
WISCONSIN DEPARTMENT OF TRANSPORTATION	
APPROVAL RECOMMENDED	Date 3-19-1990
APPROVED	Date 4-20-1990
Region Contact: RJS Designed by: RJS	
Gerald R. Kurtz REGION TRAFFIC ENGINEER	
H. O. Price STATE TRAFFIC ENGINEER	
PAGE 1 OF 2	

	HEAD NUMBERS	FLASH
Ø1	6, 7	R
Ø2	3, 4, 5	R
Ø3	12, 13, 14	R
Ø4	15, 16, 17	R
Ø5	1, 2	R
Ø6	8, 9, 10, 11	R
Ø7		
Ø8		
Ø2P	18, 19	-
Ø3P	20, 21	-
OLD	10, 11	-
OLE	6, 7	-
OLG	1, 2	-

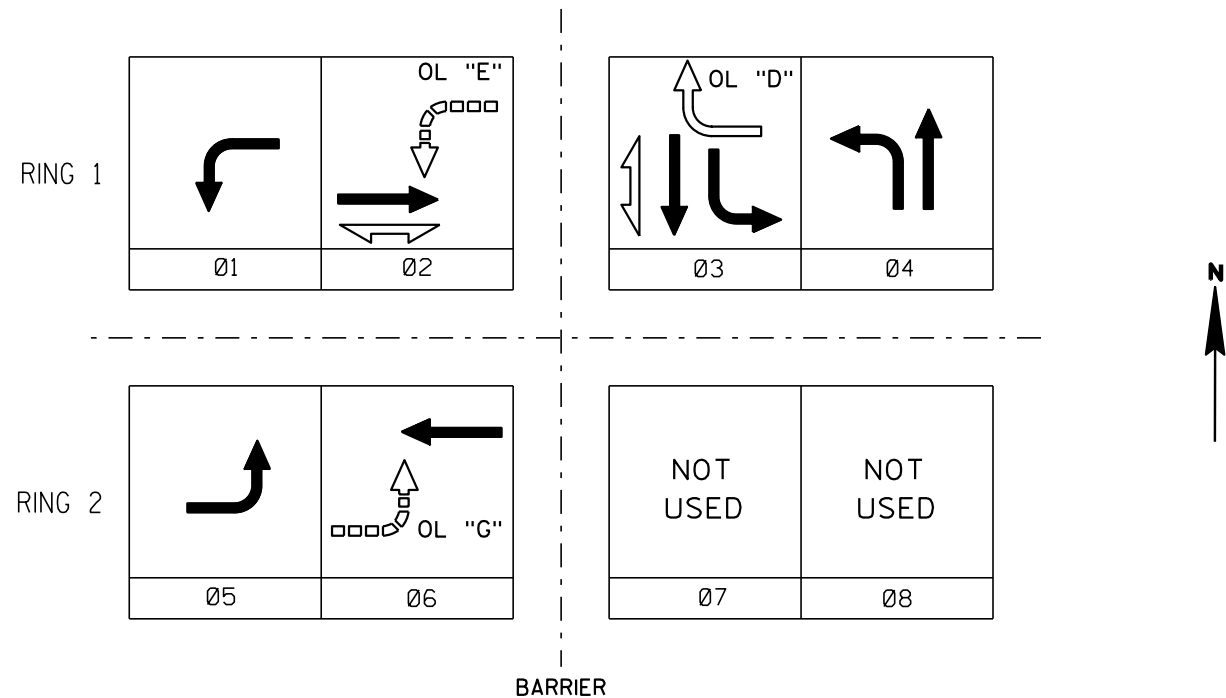

PHASE NUMBER	PHASE LOCKING	DUAL ENTRY W / Ø	PHASE RECALL	PHASE ACTIVE
1				x
2			MIN/PED	x
3				x
4				x
5				x
6			MIN	x
7				
8				

TYPE OF INTERCONNECT/COMMUNICATION	
CELL MODEM	
CLOSED LOOP	
TWISTED PAIR*	
FIBER OPTIC*	
FIBER OPTIC (ETHERNET)	
RADIO	

TYPE OF COORDINATION	
NONE	
TBC	x
TRAFFIC RESPONSIVE	
ADAPTIVE	
*LOCATION OF MASTER CONTROLLER NO:	S00-0000
SIGNAL SYSTEM #:	SS00-0000

TYPE OF LIGHTING	
BY OTHER AGENCY	x
IN TRAFFIC SIGNAL CABINET	x
IN SEPARATE DOT LIGHTING CABINET	

TYPE OF PRE-EMPT	
NONE	x
RAILROAD	
EMERGENCY VEHICLE	
GTT	
TOMAR	
HARDWIRE	
3M	
LIFT BRIDGE	
QUEUE DETECTOR	

OVERLAP STANDARD
OL "D" = 3

DETECTOR LOGIC

RACK # 1							
DETECTOR CHANNEL	3	1	7	5	11	9	15
PLAN LOOP DETECTOR *(S)	11	21	31	32	41	51	61
ASSIGNED PHASE	1	2	3	3	4	5	6
OPERATION MODE	Veh	Veh	Veh	Veh	Veh	Veh	Veh
SWITCH TO PHASE							
EXTEND							
DELAY			YES				
DETECTOR CHANNEL	4	2	8	6	12	10	16
PLAN LOOP DETECTOR *(S)		22		33			62
ASSIGNED PHASE		2		3			6
OPERATION MODE		Veh		Veh			Veh
SWITCH TO PHASE							
EXTEND							
DELAY							

RACK # 2							
DETECTOR CHANNEL	19	17	23	21	27	25	31
PLAN LOOP DETECTOR *(S)							
ASSIGNED PHASE							
OPERATION MODE							
SWITCH TO PHASE							
EXTEND							
DELAY							
DETECTOR CHANNEL	20	18	24	22	28	26	32
PLAN LOOP DETECTOR *(S)							
ASSIGNED PHASE							
OPERATION MODE							
SWITCH TO PHASE							
EXTEND							
DELAY							

- GENERAL NOTES:
1. PROVIDE FOR HAND CONTROL.

Revision 3	
USH 10 & STH 114 TOWN OF HARRISON CALUMET COUNTY	
SIGNAL NO. 08-0426	
CABINET: TS2	CONTROLLER: ECONOLITE
DATE: 1-18-2017	PAGE NO. 2 OF 2