

CONFIGURATION WITH HEAD NUMBERS			
3-H R Y G 2, 6	3-V R Y G 1, 3, 4, 7	3-VL R Y G 9, 10	5-VL R Y G G 5, 8

LEGEND

- PULL BOX 12" X 24"
- PULL BOX 24" X 36"
- PULL BOX 24" X 42"
- SIGNAL STANDARD, PEDESTAL MOUNT
- SIGNAL POLE, MAST-ARM, TRANSFORMER MOUNT
- CONTROL CABINET BASE
- 2" CONDUIT (unless otherwise noted)
- LOOP DETECTOR (In 1" Conduit)
- SIGNAL HEAD NUMBER MOUNTING CONFIGURATION
- LUMINAIRE
- OVERHEAD LINES
- UNDERGROUND ELECTRIC
- YIELD SIGN
- RAMP GATE
- RAMP GATE SOLAR PANEL

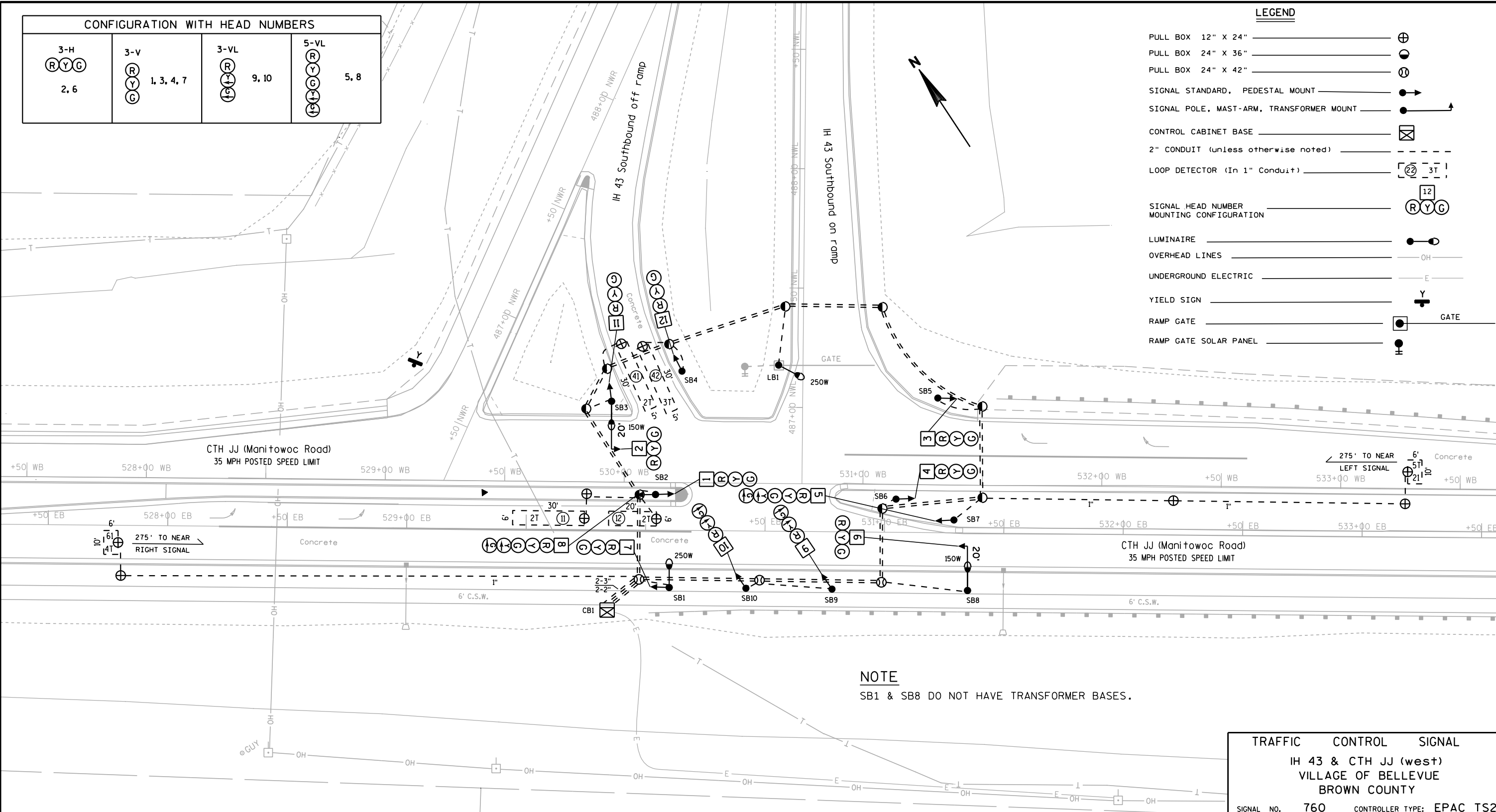

NOTE  
SB1 & SB8 DO NOT HAVE TRANSFORMER BASES.

GENERAL NOTE

THE LOCATION OF EXISTING AND PROPOSED UTILITY INSTALLATIONS AS SHOWN ON THE PLANS ARE APPROXIMATE. THERE MAY BE OTHER UTILITY INSTALLATIONS WITHIN THE PROJECT AREA THAT ARE NOT SHOWN. THE CONTRACTOR SHALL VERIFY THE LOCATIONS OF ALL UTILITIES PRIOR TO CONSTRUCTION.

R E V I S I O N			
Rev. No.	Relocate Southside Signals/Cabinet, New Loops and Change to All Red Flash		
1	APPROVAL RECOMMENDED		APPROVED
	REGION	CENTRAL OFFICE	
	Date	By	Date By
	12-21-09	RJS	12-29-09 JLB

TRAFFIC CONTROL SIGNAL	
IH 43 & CTH JJ (west) VILLAGE OF BELLEVUE BROWN COUNTY	
SIGNAL NO. 760	CONTROLLER TYPE: EPAC TS2
WISCONSIN DEPARTMENT OF TRANSPORTATION	
APPROVAL RECOMMENDED Date 3-22-99	G. F. WESOLOWSKI REGION TRAFFIC ENGINEER
APPROVED Date 4-12-99	WILLIAM C. GILDING STATE TRAFFIC ENGINEER
REGION CONTACT: RJS DESIGNED BY: RJS REVISED BY: RJS	

## DETECTOR LOGIC

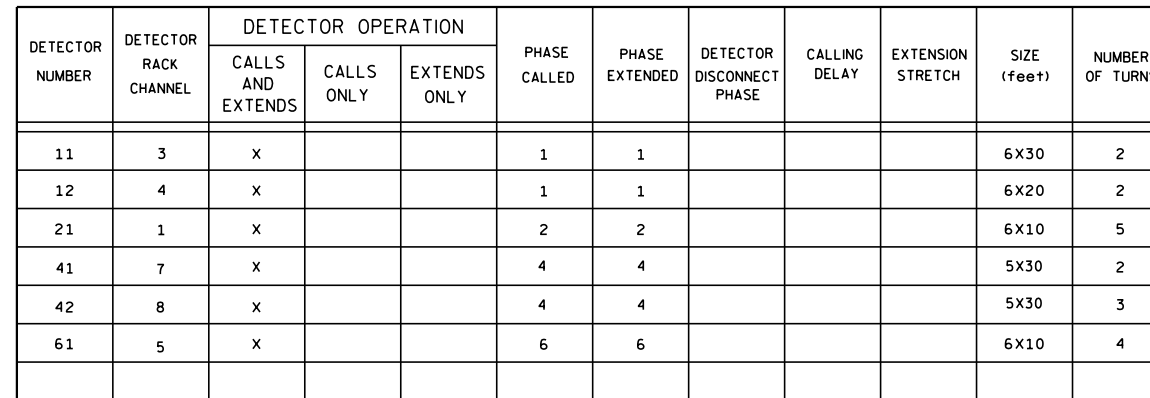

PHASE NUMBER	PHASE LOCKING	DUAL ENTRY W / Ø	PHASE RECALL	PHASE ACTIVE
1				YES
2			MIN.	YES
3				
4				YES
5				
6			MIN.	YES
7				
8				

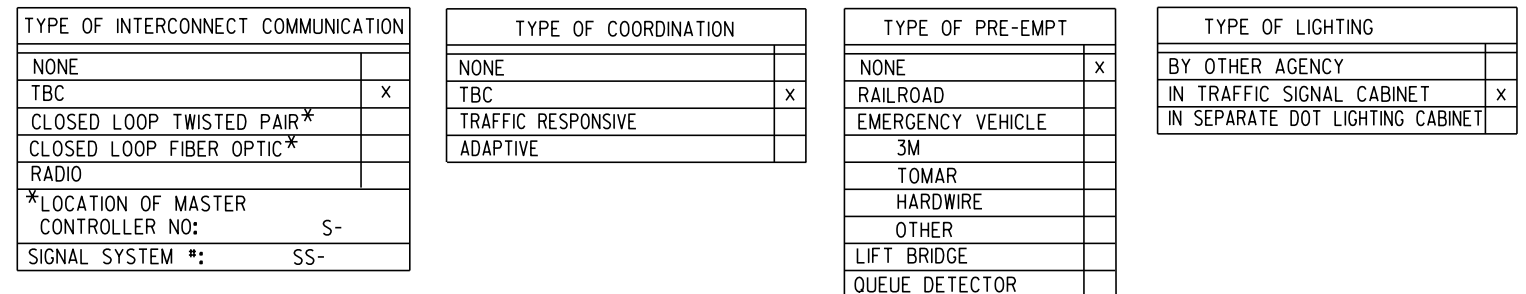

\*\* CLEARANCE TO A PHASE IN CONFLICT WITH THIS PHASE ON (SEE CHART 1 BELOW)

PHASE ON	NONCONFLICTING PHASE ALLOWED TO TIME CONCURRENTLY	PHASES IN CONFLICT WITH PHASE ON
01	6	2, 4
02	6	1, 4
03		
04	None	1, 2, 6
05		
06	1 or 2	4
07		
08		

GENERAL NOTES:

1. ANY ACTUATED PHASE FOR WHICH THERE IS NO CALL SHALL BE SKIPPED.
2. WHEN ONE PHASE IS ON ALONE, ANY NON-CONFLICTING PHASE MAY START TIMING CONCURRENTLY WITHOUT A CLEARANCE INTERVAL. (SEE CHART 1)
3. IF ANY OPPOSING THRU PHASES ARE TIMING CONCURRENTLY, THEY SHALL TERMINATE TOGETHER DUE TO PERMISSIVE LEFT TURN CONFLICT.
4. PROVIDE FOR HAND CONTROL.

Updated 10-8-2013

IH 43 & CTH JJ (west)  
VILLAGE OF BELLEVUE  
BROWN COUNTY

SIGNAL NO. 760

CONTROLLER TYPE: EPAC TS2

DATE: 12-29-2009

PAGE NO. 2 OF 2

PROJECT NO: 0083-03-01
------------------------

HWY: IH 43

COUNTY: BROWN

SEQUENCE OF OPERATIONS	S-760
------------------------	-------

SHEET NO:

E