

## GENERAL NOTE

THE LOCATION OF EXISTING AND PROPOSED UTILITY INSTALLATIONS AS SHOWN ON THE PLANS ARE APPROXIMATE. THERE MAY BE OTHER UTILITY INSTALLATIONS WITHIN THE PROJECT AREA THAT ARE NOT SHOWN. THE CONTRACTOR SHALL VERIFY THE LOCATIONS OF ALL UTILITIES PRIOR TO CONSTRUCTION.

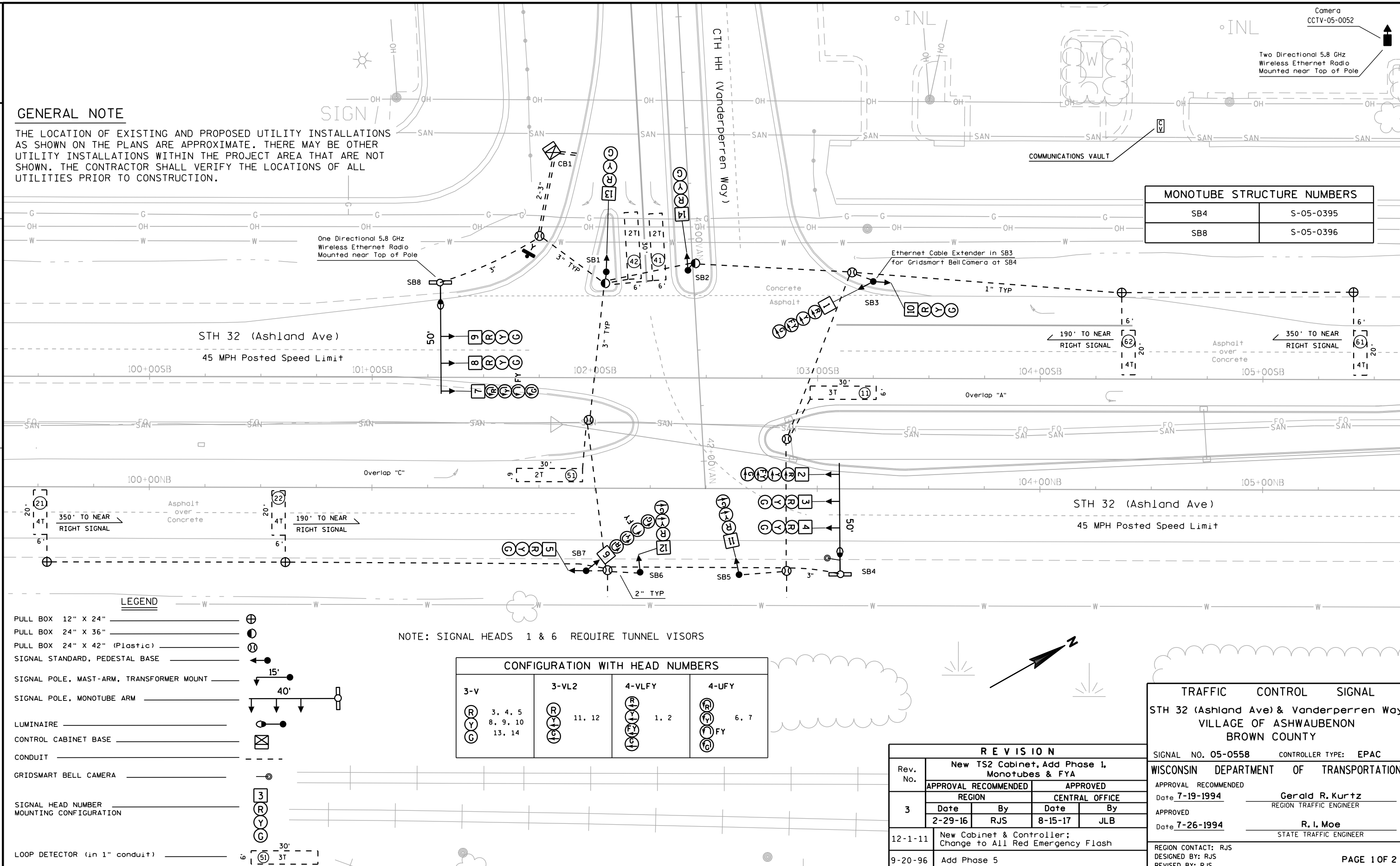

	HEAD NUMBERS	FLASH
Ø1	6, 7	-
Ø2	3, 4, 5	R
Ø3		
Ø4	11, 12, 13, 14	R
Ø5	1, 2	-
Ø6	8, 9, 10	R
Ø7		
Ø8		
Ø2P		
Ø4P		
Ø6P		
Ø8P		
OLA	6, 7	Ⓜ
OLB		
OLC	1, 2	Ⓜ
OLD		

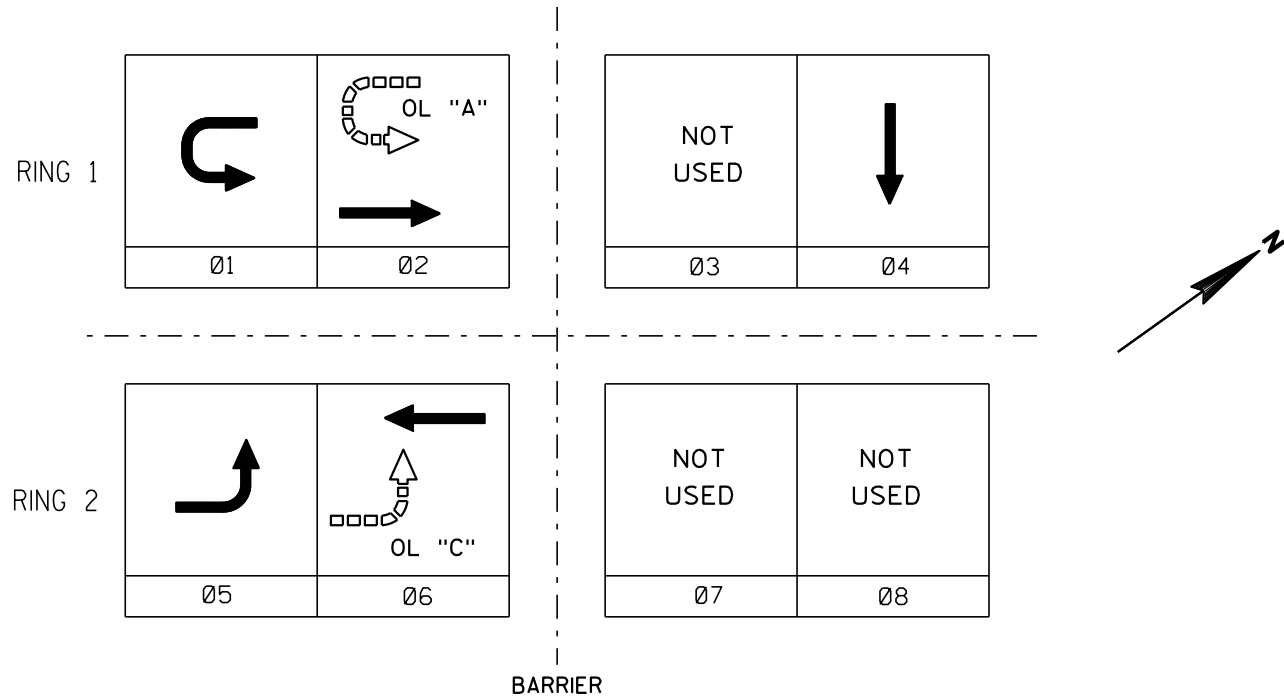

CONTROLLER LOGIC				
PHASE NUMBER	PHASE LOCKING	DUAL ENTRY W / Ø	PHASE RECALL	PHASE ACTIVE
1				YES
2			MIN	YES
3				
4				YES
5				YES
6			MIN	YES
7				
8				

TYPE OF INTERCONNECT/COMMUNICATION	
CELL MODEM	
CLOSED LOOP	
TWISTED PAIR*	
FIBER OPTIC*	
FIBER OPTIC (ETHERNET)	
RADIO	x

TYPE OF COORDINATION	
NONE	
TBC	x
TRAFFIC RESPONSIVE	
ADAPTIVE	
*LOCATION OF MASTER CONTROLLER NO:	S00-0000
SIGNAL SYSTEM #:	SS00-0000

TYPE OF LIGHTING	
BY OTHER AGENCY	
IN TRAFFIC SIGNAL CABINET	x
IN SEPARATE DOT LIGHTING CABINET	

TYPE OF PRE-EMPT	
NONE	x
RAILROAD	
EMERGENCY VEHICLE	
GTT	
TOMAR	
HARDWIRE	
3M	
LIFT BRIDGE	
QUEUE DETECTOR	

GENERAL NOTES:  
1. PROVIDE FOR HAND CONTROL.

DETECTOR LOGIC

RACK # 1							
DETECTOR CHANNEL	3	1	7	5	11	9	15
PLAN LOOP DETECTOR *(S)	11	21	41	51	61		
ASSIGNED PHASE	1	2	4	5	6		
OPERATION MODE	Veh	Veh	Veh	Veh	Veh		
SWITCH TO PHASE							
EXTEND		Yes			Yes		
DELAY			Yes				
DETECTOR CHANNEL	4	2	8	6	12	10	16
PLAN LOOP DETECTOR *(S)		22	42		62		
ASSIGNED PHASE		2	4		6		
OPERATION MODE		Veh	Veh		Veh		
SWITCH TO PHASE							
EXTEND							
DELAY			Yes				

RACK # 2							
DETECTOR CHANNEL	19	17	23	21	27	25	31
PLAN LOOP DETECTOR *(S)							
ASSIGNED PHASE							
OPERATION MODE							
SWITCH TO PHASE							
EXTEND							
DELAY							
DETECTOR CHANNEL	20	18	24	22	28	26	32
PLAN LOOP DETECTOR *(S)							
ASSIGNED PHASE							
OPERATION MODE							
SWITCH TO PHASE							
EXTEND							
DELAY							

OVERLAP SPECIAL

	Protected	Permissive
OL "A"	1	2
OL "B"		
OL "C"	5	6
OL "D"		

Revision 3

STH 32 (Ashland Ave) & Vanderperren Way VILLAGE OF ASHWAUBENON BROWN COUNTY	
SIGNAL NO. 05-0558	
CABINET: TS2	CONTROLLER: EPAC
DATE: 8-15-2017	PAGE NO. 2 OF 2