

CONFIGURATION WITH HEAD NUMBERS			
3-VL <div><div>R</div><div>Y</div><div>G</div></div> 9, 10	3-H <div><div>R</div><div>Y</div><div>G</div></div> 2, 6	3-V <div><div>R</div><div>Y</div><div>G</div></div> 3, 5, 7 8, 11	<div><div>R</div><div>Y</div><div>G</div></div> 5-VL <div><div>R</div><div>Y</div><div>G</div></div> 1, 4



R1-1F
30" X 30"

Mount under Signal Face
numbers 3, 4, 7, 8, & 11.

GENERAL NOTE

THE LOCATION OF EXISTING AND PROPOSED UTILITY INSTALLATIONS
AS SHOWN ON THE PLANS ARE APPROXIMATE. THERE MAY BE OTHER
UTILITY INSTALLATIONS WITHIN THE PROJECT AREA THAT ARE NOT
SHOWN. THE CONTRACTOR SHALL VERIFY THE LOCATIONS OF ALL
UTILITIES PRIOR TO CONSTRUCTION.

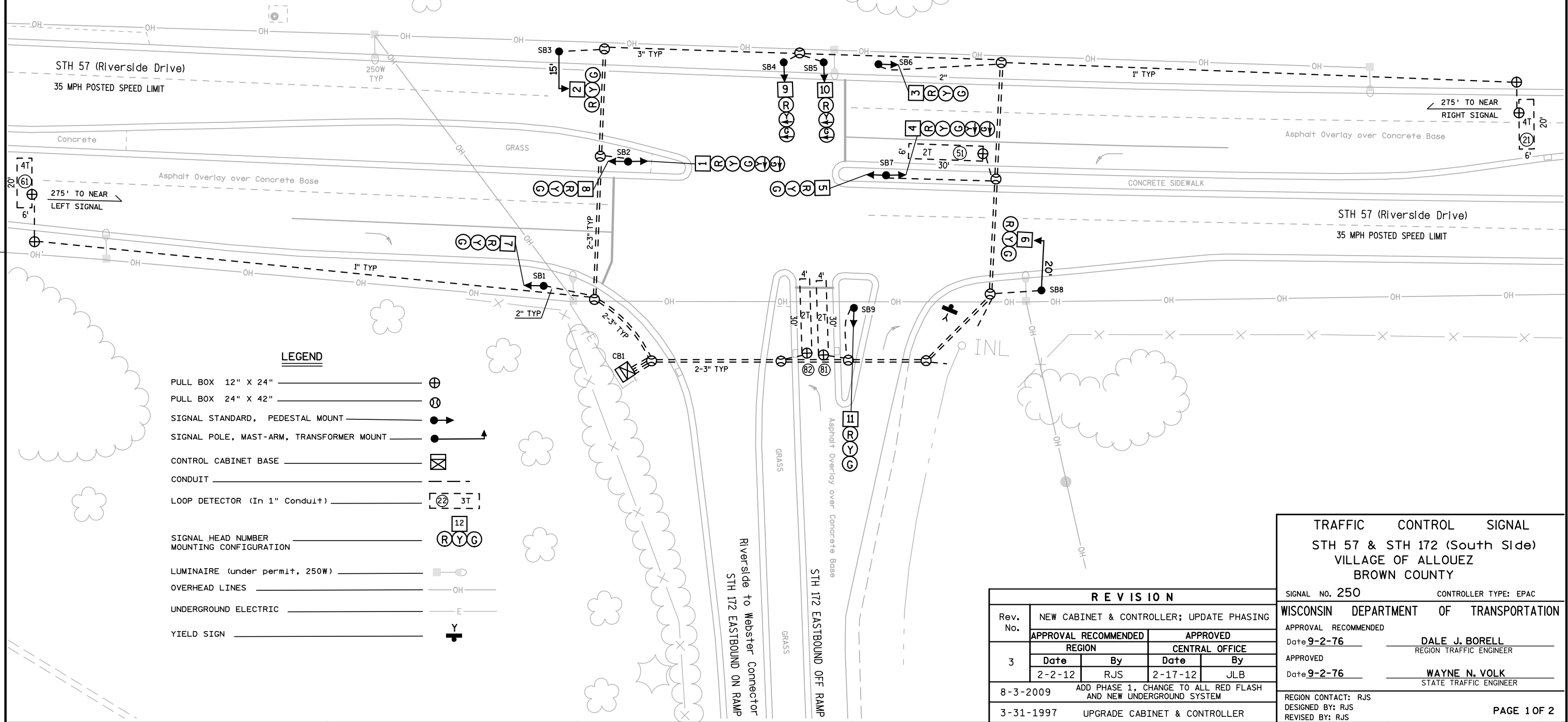

LEGEND	
PULL BOX 12" X 24"	⊕
PULL BOX 24" X 42"	⊖
SIGNAL STANDARD, PEDESTAL MOUNT	→
SIGNAL POLE, MAST-ARM, TRANSFORMER MOUNT	→
CONTROL CABINET BASE	⊠
CONDUIT	---
LOOP DETECTOR (In 1" Conduit)	[22] 3T
SIGNAL HEAD NUMBER MOUNTING CONFIGURATION	<div><div>12</div><div>R</div><div>Y</div><div>G</div></div>
LUMINAIRE (under permit, 250W)	⬤
OVERHEAD LINES	—OH—
UNDERGROUND ELECTRIC	—E—
YIELD SIGN	Y

REVISION			
Rev. No.	NEW CABINET & CONTROLLER; UPDATE PHASING		
3	APPROVAL RECOMMENDED		APPROVED
	REGION	CENTRAL OFFICE	
	Date	By	Date By
8-3-2009 ADD PHASE 1, CHANGE TO ALL RED FLASH AND NEW UNDERGROUND SYSTEM			
3-31-1997 UPGRADE CABINET & CONTROLLER			

TRAFFIC CONTROL SIGNAL	
STH 57 & STH 172 (South Side)	
VILLAGE OF ALLOUEZ	
BROWN COUNTY	
SIGNAL NO. 250	CONTROLLER TYPE: EPAC
WISCONSIN DEPARTMENT OF TRANSPORTATION	
APPROVAL RECOMMENDED	
Date 9-2-76	DALE J. BORELL REGION TRAFFIC ENGINEER
APPROVED	
Date 9-2-76	WAYNE N. VOLK STATE TRAFFIC ENGINEER
REGION CONTACT: RJS	
DESIGNED BY: RJS	REVISD BY: RJS

CONTROLLER LOGIC

PHASE NUMBER	PHASE LOCKING	DUAL ENTRY W / Ø	PHASE RECALL	PHASE ACTIVE
1				
2			MIN	YES
3				
4				
5				YES
6			MIN	YES
7				
8				YES

TYPE OF LIGHTING	
BY OTHER AGENCY	X
IN TRAFFIC SIGNAL CABINET	
IN SEPARATE DOT LIGHTING CABINET	

1. ANY ACTUATED PHASE FOR WHICH THERE IS NO CALL SHALL BE SKIPPED.
2. WHEN ONE PHASE IS ON ALONE, ANY NON-CONFLICTING PHASE MAY START TIMING CONCURRENTLY WITHOUT A CLEARANCE INTERVAL. (SEE CHART 1)
3. IF ANY OPPOSING THRU PHASES ARE TIMING CONCURRENTLY, THEY SHALL TERMINATE TOGETHER DUE TO PERMISSIVE LEFT TURN CONFLICT.
4. PROVIDE FOR HAND CONTROL.

STH 57 & STH 172 (South Side)
VILLAGE OF ALLOUEZ
BROWN COUNTY

PAGE NO. 2 OF 2

E