

CONDUCTOR COLOR SCHEME	
Circuit "A"	= Black
Circuit "B"	= Red
Circuit "C"	= Blue
Circuit "D"	= Brown
Circuit "E"	= Orange
Circuit "F"	= Yellow

LEGEND

- | | |
|--|--------|
| LIGHTING CONTROL CABINET WITH METER BREAKER PEDESTAL | ⊠ |
| 2" CONDUIT, NON-METALLIC (unless otherwise noted) | — |
| LIGHTING UNIT | ● |
| PULL BOX 24" X 42" | ⊙ |
| UTILITY POLE | ⊙ |
| ELECTRIC, UNDERGROUND | — E — |
| ELECTRIC, OVERHEAD | — OH — |

- EXAMPLE (see individual label on each lighting unit)
- III-LED A-12-5-A-4
- LIGHT UNIT NUMBER IN CIRCUIT
 - CIRCUIT ID
 - BASE TYPE
 - MAST ARM LENGTH (in feet)
 - LAMP WATTAGE
 - DISTRIBUTION TYPE

240 VOLT SYSTEM
120/240 VOLT ELECTRIC SERVICE

NOTES:

WISCONSIN DOT NORTHEAST REGION ELECTRICAL UNIT SHALL APPROVE FINAL LOCATIONS FOR ALL CONCRETE BASES IN THE FIELD PRIOR TO CONSTRUCTION. CONTACT THEM 3 DAYS IN ADVANCE AT (920) 492-5710.

THE LOCATION OF EXISTING AND PROPOSED UTILITIES AS SHOWN ON THE PLANS ARE APPROXIMATE. IN ADDITION, THERE MAY BE OTHER UTILITIES WITHIN THE PROJECT AREA WHICH ARE NOT SHOWN. THE CONTRACTOR SHALL VERIFY THE LOCATIONS OF ALL UTILITIES PRIOR TO CONSTRUCTION.

USH 151 NB & HWY 45/CTH V CITY OF FOND DU LAC FOND DU LAC COUNTY	
LIGHTING NO. 20-2000	
DESIGNER: WISDOT NE REGION TRAFFIC UNIT	
DATE: 5-13-2016	SHEET NO. 1 OF 2

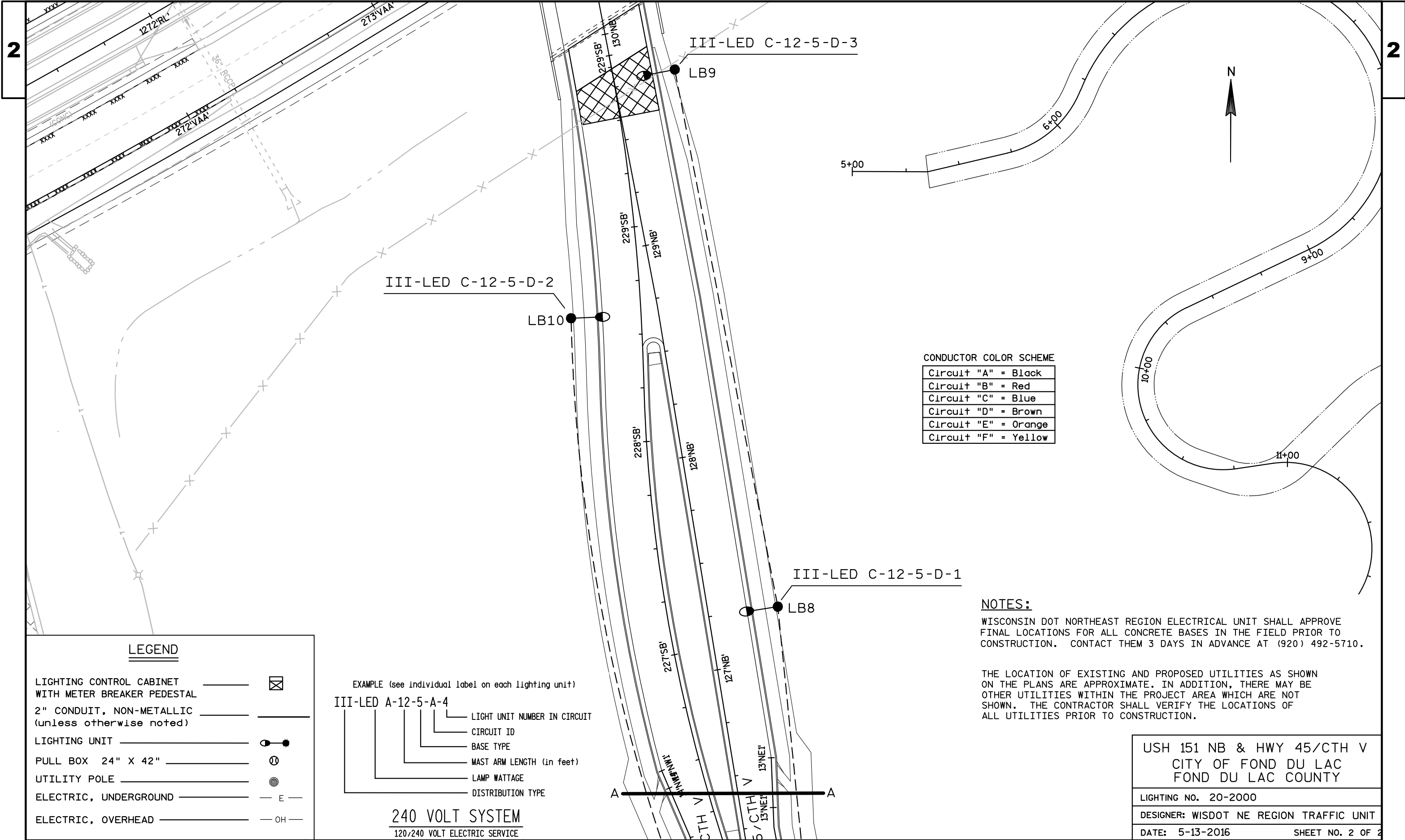

LEGEND

- LIGHTING CONTROL CABINET WITH METER BREAKER PEDESTAL
- 2" CONDUIT, NON-METALLIC (unless otherwise noted)
- LIGHTING UNIT
- PULL BOX 24" X 42"
- UTILITY POLE
- ELECTRIC, UNDERGROUND
- ELECTRIC, OVERHEAD

EXAMPLE (see individual label on each lighting unit)

III-LED A-12-5-A-4

- LIGHT UNIT NUMBER IN CIRCUIT
- CIRCUIT ID
- BASE TYPE
- MAST ARM LENGTH (in feet)
- LAMP WATTAGE
- DISTRIBUTION TYPE

240 VOLT SYSTEM
120/240 VOLT ELECTRIC SERVICE

CONDUCTOR COLOR SCHEME

Circuit "A"	= Black
Circuit "B"	= Red
Circuit "C"	= Blue
Circuit "D"	= Brown
Circuit "E"	= Orange
Circuit "F"	= Yellow

NOTES:

WISCONSIN DOT NORTHEAST REGION ELECTRICAL UNIT SHALL APPROVE FINAL LOCATIONS FOR ALL CONCRETE BASES IN THE FIELD PRIOR TO CONSTRUCTION. CONTACT THEM 3 DAYS IN ADVANCE AT (920) 492-5710.

THE LOCATION OF EXISTING AND PROPOSED UTILITIES AS SHOWN ON THE PLANS ARE APPROXIMATE. IN ADDITION, THERE MAY BE OTHER UTILITIES WITHIN THE PROJECT AREA WHICH ARE NOT SHOWN. THE CONTRACTOR SHALL VERIFY THE LOCATIONS OF ALL UTILITIES PRIOR TO CONSTRUCTION.

USH 151 NB & HWY 45/CTH V CITY OF FOND DU LAC FOND DU LAC COUNTY	
LIGHTING NO. 20-2000	
DESIGNER: WISDOT NE REGION TRAFFIC UNIT	
DATE: 5-13-2016	SHEET NO. 2 OF 2