

SEE SHEETS 30 & 46 FOR MAINLINE LIGHTING

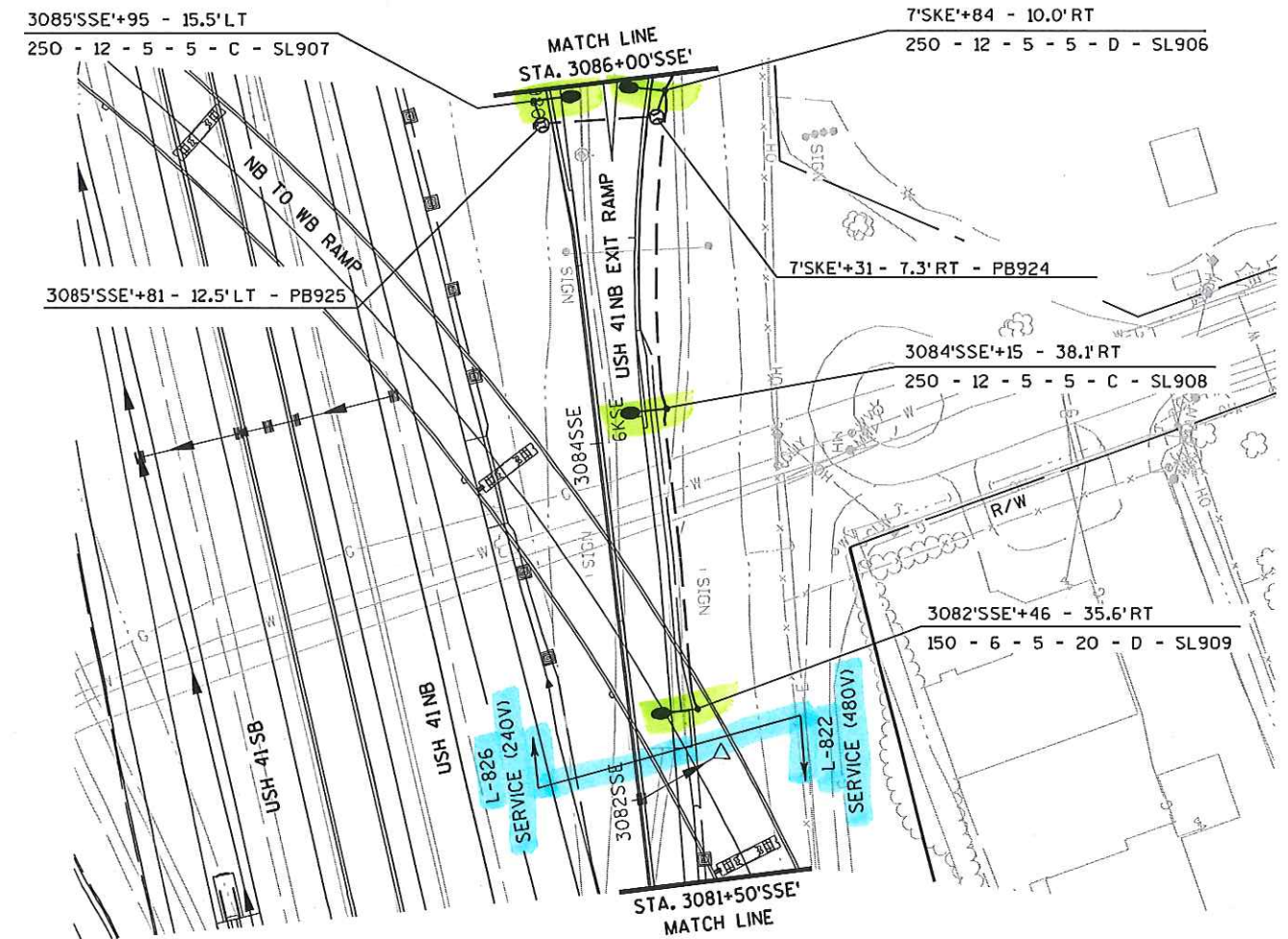

SEE SHEETS 30 & 46 FOR MAINLINE LIGHTING

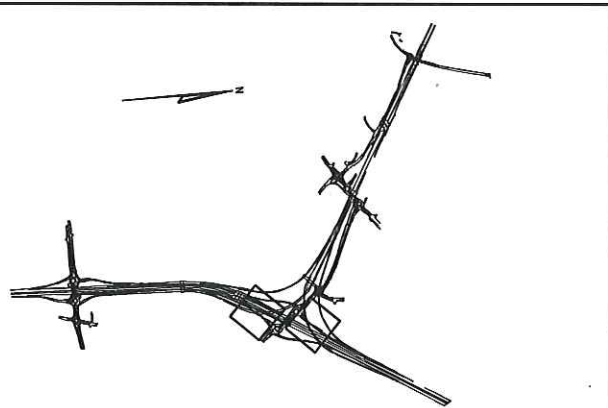

USH 41 & SHAWANO AVE. ROUNDABOUTS
VILLAGE OF HOWARD
BROWN COUNTY

LIGHTING NO. L-826 1 CABINET, 4 CIRCUITS

DESIGNER: KL ENGINEERING, INC. 120/240 VOLT

DATE: 3-01-12

SHEET 2 OF 2

PROJECT NO: 1133-03-71

HWY: USH 41

COUNTY: BROWN

LIGHTING PLANS

SHEET 52 OF 70

SHEET

E

FILE NAME : g:\wdotne\wne30-0739\brown county - 02\1133-03-73 (wis 29 interchange)\dgn\plan sheets\023527_LP.dgn

PLOT DATE : 4/5/2012

PLOT BY : KL Engineering

PLOT NAME :

PLOT SCALE :

WISDOT/CADDs SHEET 42