

LEVELS ON = 1,2,3,4,5,6,7,8,9,10,11,12,13,14,15,16,17,18,19,20,21,22,23,24,25,26,27,28,29,30,31,32,33,34,35,36,37,38,39,40,41,42,43,44,45,46,47,48,49,50,51,52,53,54,55,56,57,58,59,60,61,62,63

LEGEND

- PULL BOX 24" X 36"

TYPE 5 POLE & CONCRETE BASE,  
SIGNAL MEMBER, 4-1/2" CLAMP,  
8' LONG, 250 WATTS

LIGHTING CONTROLLER WITH  
METER BREAKER PEDESTAL

2" CONDUIT

POWER POLE

SERVICE POLE

OVERHEAD ELECTRIC

UNDERGROUND ELECTRIC
- 

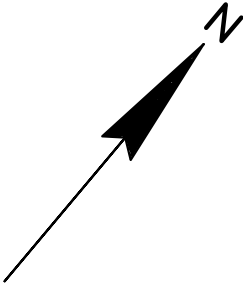
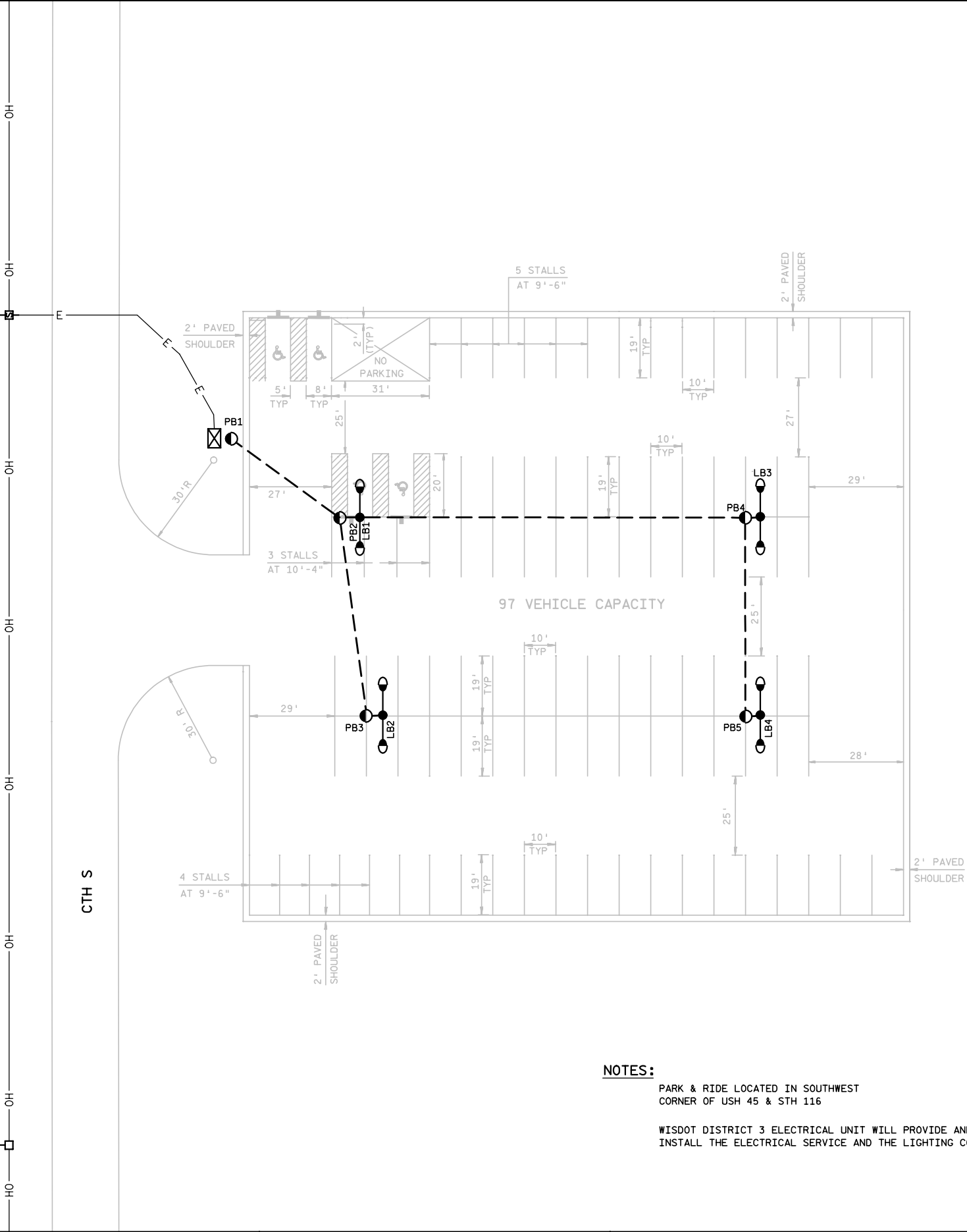

Changed to LED B

NOTES:  
PARK & RIDE LOCATED IN SOUTHWEST  
CORNER OF USH 45 & STH 116  
  
WISDOT DISTRICT 3 ELECTRICAL UNIT WILL PROVIDE AND  
INSTALL THE ELECTRICAL SERVICE AND THE LIGHTING CONTROLLER.

AS-BUILT 12-29-03

BUTTE DES MORTS PARK & RIDE  
USH 45 & STH 116/CTH GG  
WINNEBAGO COUNTY

LIGHTING NO. L562

DESIGNED BY RJS

DATE 6-20-01

SHEET NO. OF

STATE PROJECT NUMBER:6200-05-77

HWY: USH 45

COUNTY: WINNEBAGO

CONSTRUCTION DETAIL L-562

SCALE, FEET 0

SHEET NO:

E

FILE NAME : ++gre31fp1+FCSERVER+d3\_620005+205.dgn

PLOT DATE: 10-MAR-2004 10:06

ORG DATE : 10-24-00

PLOT NAME : 205ca

Originator : DISTRICT 3

PLOT SCALE : 40.000000:1.000000