

PROPOSED SINGLE LANE ROUNDABOUT DESIGN
WIS 76 AND COUNTY JJ INTERSECTION
WIS 76
OUTAGAMIE COUNTY
PROJECT 6517-10-00
Public Involvement Meeting **DISPLAY** (12-02-15)


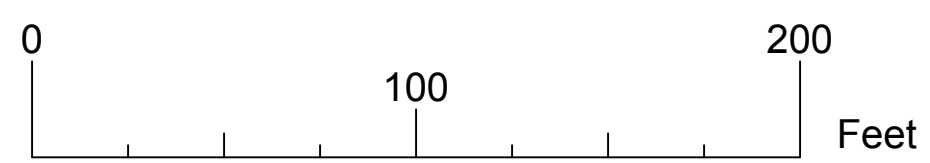

LEGEND

- ROADWAY/DRIVEWAY SURFACE
- SIDEWALK / MUTI-USE PATH
- PROPOSED MEDIAN ISLAND
- ESTIMATED GRADING LIMITS
- PROPOSED OBLITERATION
- STORM SEWER DISCHARGE LOCATION
- PROPOSED RIGHT-OF-WAY REQUIRED