

LEGEND

- PULL BOX 12" X 24"
- PULL BOX 24" X 36"
- SIGNAL STANDARD, PEDESTAL MOUNT
- SIGNAL POLE, MAST-ARM, TRANSFORMER MOUNT
- LUMINAIRE (250W, unless otherwise noted)
- CONTROL CABINET BASE
- CONDUIT
- LOOP DETECTOR (In 1" Conduit)
- SIGNAL HEAD NUMBER MOUNTING CONFIGURATION

CONFIGURATION WITH HEAD NUMBERS		
3-V 	5-VL 	3-H 
12, 14, 15 18, 20, 22	16, 19	13, 17, 21

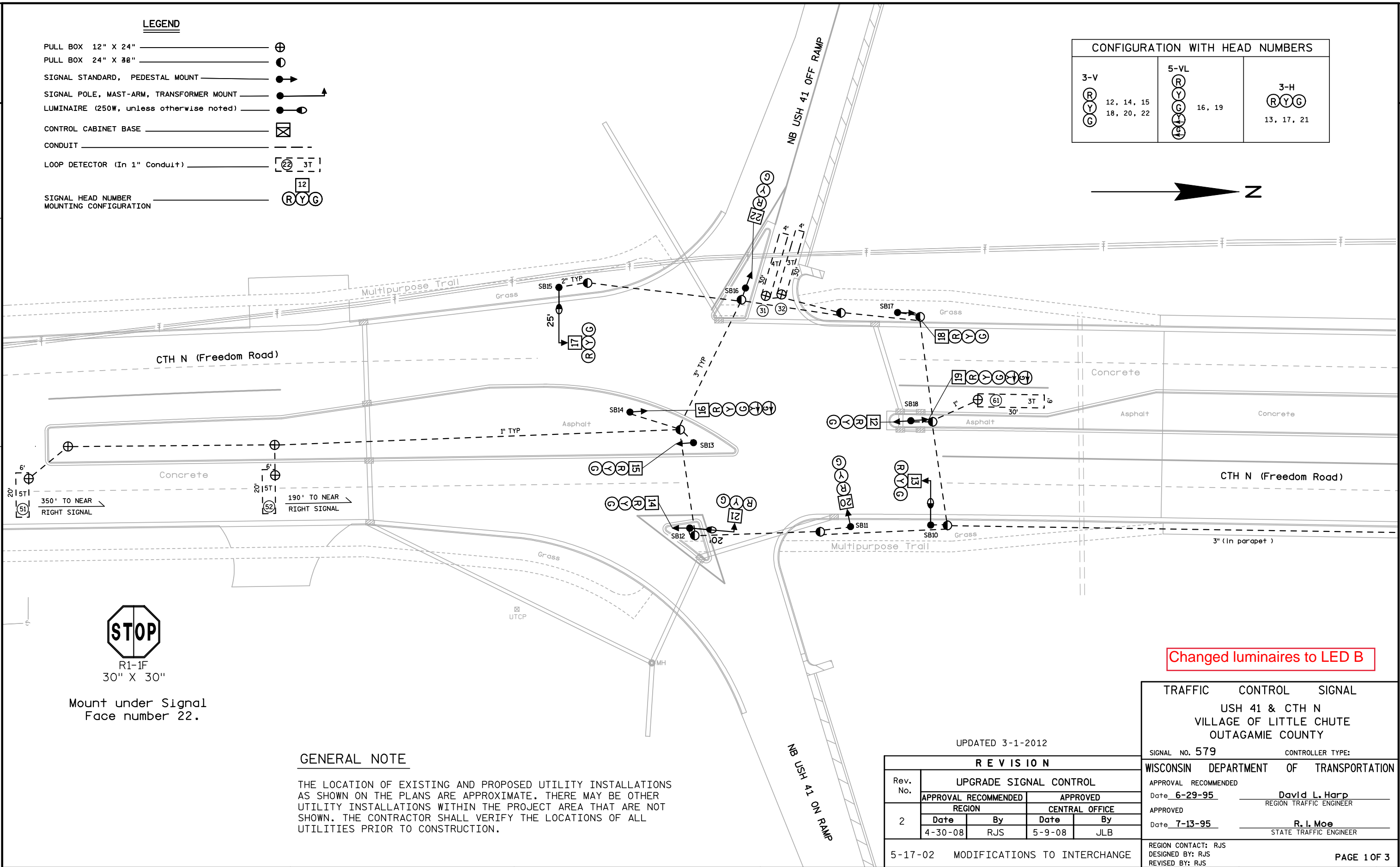

R1-1F  
30" X 30"

Mount under Signal  
Face number 22.

GENERAL NOTE

THE LOCATION OF EXISTING AND PROPOSED UTILITY INSTALLATIONS AS SHOWN ON THE PLANS ARE APPROXIMATE. THERE MAY BE OTHER UTILITY INSTALLATIONS WITHIN THE PROJECT AREA THAT ARE NOT SHOWN. THE CONTRACTOR SHALL VERIFY THE LOCATIONS OF ALL UTILITIES PRIOR TO CONSTRUCTION.

Changed luminaires to LED B

UPDATED 3-1-2012

REVISION			
Rev. No.	UPGRADE SIGNAL CONTROL		APPROVED
	APPROVAL RECOMMENDED	APPROVED	
2	REGION	CENTRAL OFFICE	By
	Date	Date	
	4-30-08	5-9-08	JLB
5-17-02 MODIFICATIONS TO INTERCHANGE			

TRAFFIC CONTROL SIGNAL  
USH 41 & CTH N  
VILLAGE OF LITTLE CHUTE  
OUTAGAMIE COUNTY

SIGNAL NO. 579 CONTROLLER TYPE:

WISCONSIN DEPARTMENT OF TRANSPORTATION

APPROVAL RECOMMENDED

Date 6-29-95 David L. Harp  
REGION TRAFFIC ENGINEER

APPROVED

Date 7-13-95 R. L. Moe  
STATE TRAFFIC ENGINEER

REGION CONTACT: RJS  
DESIGNED BY: RJS  
REVISED BY: RJS

PAGE 1 OF 3

CONFIGURATION WITH HEAD NUMBERS		
3-V	3-H	5-VL
<div><div>R</div><div>Y</div><div>G</div></div> 1, 3, 4 7, 9, 11	<div><div>R</div><div>Y</div><div>G</div></div> 2, 6, 10	<div><div>R</div><div>Y</div><div>G</div><div>Y</div><div>G</div><div>R</div></div> 5, 8

LEGEND	
CONCRETE CABINET BASE	
PULL BOX 12" X 24"	
PULL BOX 24" X 36"	
SIGNAL STANDARD, PEDESTAL MOUNT	
SIGNAL POLE, MAST-ARM, TRANSFORMER MOUNT	
LUMINAIRE (250W, unless otherwise noted)	
CONTROL CABINET BASE	
CONDUIT	
LOOP DETECTOR (In 1" Conduit)	
SIGNAL HEAD NUMBER MOUNTING CONFIGURATION	
SERVICE POLE	
UTILITY POLE	
OVERHEAD LINES	
UNDERGROUND ELECTRIC	

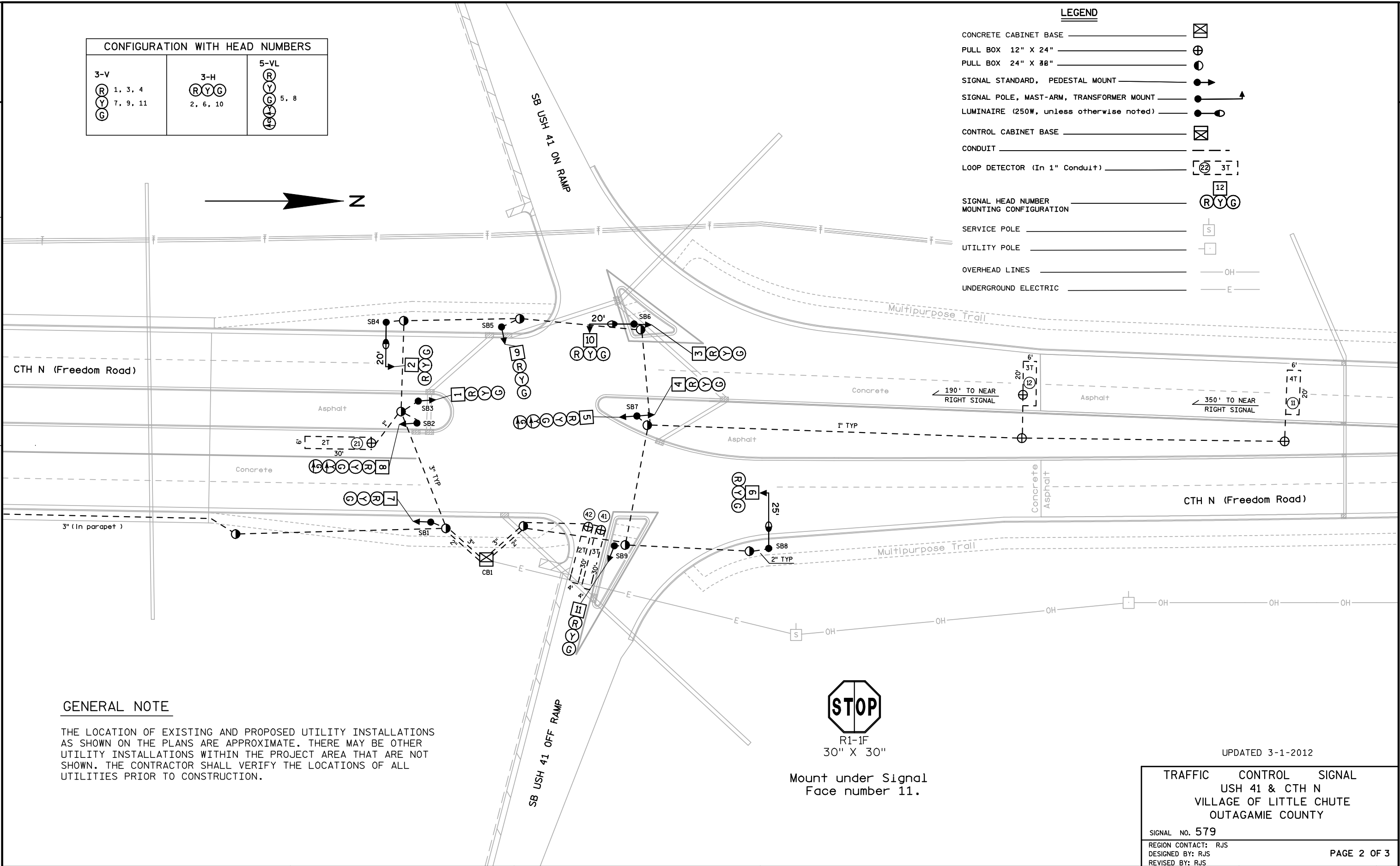

GENERAL NOTE

THE LOCATION OF EXISTING AND PROPOSED UTILITY INSTALLATIONS AS SHOWN ON THE PLANS ARE APPROXIMATE. THERE MAY BE OTHER UTILITY INSTALLATIONS WITHIN THE PROJECT AREA THAT ARE NOT SHOWN. THE CONTRACTOR SHALL VERIFY THE LOCATIONS OF ALL UTILITIES PRIOR TO CONSTRUCTION.

UPDATED 3-1-2012

TRAFFIC CONTROL SIGNAL	
USH 41 & CTH N	
VILLAGE OF LITTLE CHUTE	
OUTAGAMIE COUNTY	
SIGNAL NO. 579	
REGION CONTACT: RJS	PAGE 2 OF 3
DESIGNED BY: RJS	
REVISED BY: RJS	

