

**Notice:** Collection of this information is authorized under s. NR 5.09, Wis. Admin. Code. Failure to provide this information may result in removal of waterway markers. Personal information collected will be used to administer the Waterway Marker Permit program and may be provided to requesters as required by Wisconsin's Open Records law [ss. 19.31-19.39, Wis. Stats.].





**Instructions:** Refer to instructions and requirements on the back of this form. Complete this form and send to your local conservation county warden.

ID No. <b>4068</b>	Region <b>SER</b>	<input checked="" type="radio"/> Placement <input type="radio"/> Discontinue <input type="radio"/> Change
Jurisdiction: <input type="radio"/> City <input checked="" type="radio"/> Town <input type="radio"/> Village of <b>Kewaskum</b>		County of <b>Washington</b> , Wisconsin.

<b>Section 1: Applicant Information</b>				<b>Section 2: Property Owner</b>			
Applicant Name <b>Wisconsin Department of Transportation</b>				Property Owner Name <b>Washington County Highway Department</b>			
Street Address <b>141 NW Barstow Street</b>				Street Address <b>900 Lang Street</b>			
City <b>Waukesha</b>	State <b>WI</b>	ZIP Code <b>53187</b>		City <b>West Bend</b>	State <b>WI</b>	ZIP Code <b>53090</b>	
Telephone Number (include area code) <b>(262) 548-8772</b>				Telephone Number (include area code) <b>(262) 335-4435</b>			
Name of lake or body of water buoys will be placed <b>Milwaukee River</b>				I consent to the placement of water marker(s) adjacent to the waters of my private property.			
Location of Marker(s) <b>Town of Kewaskum</b>	$\frac{1}{4}$ $\frac{1}{4}$ $\frac{1}{4}$	Section <b>23</b>	Township <b>12 N</b>	Range <b>19</b>	<input checked="" type="radio"/> E <input type="radio"/> W	Signature of Applicant (authorizing representative) <i>[Signature]</i>	Date Signed <b>2/28/2021</b>

For Construction Projects - Enter Information Below

WDOT Project Number <b>4867-01-70</b>	Project Start Date <b>01/03/2022</b>	Project End Date <b>04/29/2022</b>
------------------------------------------	-----------------------------------------	---------------------------------------

Type of Marker(s)	Qty.	Type of Marker(s)	Qty.	Message on Marker	Remarks
Aid to Nav. Center		Boat Excluded 			Ordinance Required
Aid to Nav. Red	8	Swim Area 		SWIM AREA	Name of Beach:
Aid to Nav. Green	8	Controlled Area 			Ordinance Required
Mooring		Hazard Warning 	4	DANGER	Placed upstream/downstream of bridge
Non-standard or signs		Informational 			

Describe:

Attach diagrams and maps showing the proposed location of the marker(s). Identify the exact location of the water marker(s) in distance from one or more fixed objects, whose location is known or provide the GPS coordinates of the marker(s) placement. The above information provided in support of the application for placement of water marker(s) is true and correct.

Applicant Representative (print name) <b>Ted Dumke</b>	Signature of Applicant (authorizing representative) <i>[Signature]</i>	Date Signed <b>2/28/2021</b>
-----------------------------------------------------------	---------------------------------------------------------------------------	---------------------------------

**Section 3: Local Government Authorization**

- ☒ **Approved** -- The above named applicant may place and maintain, subject to DNR approval, the above described marker(s).  
☐ **Disapproved** -- The placement of the described marker(s) may not take place.

Name of Local Government or State Agency <b>Town of Kewaskum</b>		Restrictions	
Approved by (print name) <b>Scott J Wollner</b>	Title <b>Town Chairman</b>	Approved by (signature) <i>[Signature]</i>	Date Signed <b>2-25-21</b>

<b>Leave Blank - DNR Use Only</b>			
Warden's Recommendation <input checked="" type="radio"/> Approved <input type="radio"/> Disapproved	Recreation Safety Warden <input checked="" type="radio"/> Approved <input type="radio"/> Disapproved		
Ordinance on File <input type="radio"/> Yes <input type="radio"/> No <input checked="" type="radio"/> Not Required	Signature <b>Jason Roberts</b>	Date Signed <b>03/02/2021</b>	
Warden's (Printed) Name <b>Warden Steve Swiertz</b>	Bureau of Law Enforcement <input type="radio"/> Approved <input type="radio"/> Disapproved		
Warden's Signature <b>Approved via email/phone call</b>	Date Signed <b>03/02/2021</b>	Signature <i>Ryan Serwe</i>	Date Signed <b>3/5/2021</b>

## General Information

The WATERWAY MARKER APPLICATION AND PERMIT, Form 8700-58, **is an application to place waterway markers**. When fully completed, it becomes **a permit to place the markers**, or a notice of discontinuing placement of markers or a notice of a change in the placement of markers in a previous permit. Markers may not be placed in Wisconsin waters until the permit application has been completed **and this form has been approved by the DNR**.

**The municipality having jurisdiction over the water where the markers are placed must approve the permit issuance. The Department of Natural Resources (DNR) must approve the application prior to it becoming effective.**

MOORING BUOYS may or may not need Department approval or SECTION 3 completed depending on the criteria in s. 30.772, Wis. Stats., or the existence of an approved mooring ordinance.

Generally, only municipalities may be the applicant for **Aids to Navigation, Controlled Area and Boat Excluded markers**.

**EXCEPTION: Swimming area buoys** can be approved for placement in conjunction with bathing beaches operated by resorts, clubs, civic organizations where they are **open to the public or used by large numbers of people**.

Municipalities, individuals, resorts, clubs, civic organizations, etc. may be the applicant for **Hazard Warning and Informational markers**.

Municipalities may contract with individuals, clubs and other organizations to buy, maintain and place Aids to Navigation and regulatory markers. The municipality maintains responsibility.

**For unique circumstances, check with your local DNR Warden or your DNR Regional Recreation Safety Warden.**

---

## Instructions For Completing the Form

Indicate if application and permit is for a first time placement; a discontinuation, or a change of a current permit.

**Jurisdiction** - Identify the (City, Town or Village) of (Name of Municipality) having jurisdiction over the water and the County of (Name of County) where the markers will be or are currently located.

### Section 1 - Applicant and Section 2 - Property Owner

If the applicant or property owner is a municipality, business, club, etc., use this name in the "Applicant's Name" block. Name of Waterbody and Location of Marker(s) must be completed.

### Section 2 - Property Owner

Must be completed depending on the type of markers the permit is an application for.

### Type of Markers and Quantity

1. Locate the type of markers and fill in the quantity.
2. Provide the message to be placed on the marker if the markers are Controlled Area, Hazard Warning or Informational.
3. Remarks: Indicate if the marker is a sign or buoy or has unique characteristics.
4. Describe the exact message that will be written on the marker if non-standard or sign(s).

### Section 3 - Local Government Authorization

Must be completed by an officer or representative of the local government or State Agency with local jurisdiction. Approval signature must be an officer of the local jurisdiction even if applicant and local jurisdiction are the same governing body.

### Diagram(s) and Map(s) must:

1. Allow a person to locate where the markers are placed or will be placed.
2. Show the relation of the markers from some fixed reference point. Distances in feet must be shown from fixed reference point(s) and in relation to each marker.
3. Show the relationship of the markers to other riparian owners, significant objects and water areas.
4. Must be as accurate as possible. GPS or Land coordinates of each marker are preferred.

Upon completion of Section 1 and 2 (if necessary), forward the application to your local municipality for completion of Section 3. They must then forward it to the Department of Natural Resources.

If you have problems completing this form, consult with your local Warden or your Recreation Safety Warden.



DODGE CO.

FOND DU LAC CO.

SHEBOYGAN CO.

# LEGEND

- Freeway
- Multi-lane Divided
- U.S. or State Hwy
- County Trunk Hwy
- Town Road
- Pierland
- Railroad
- State Trail
- Interchange
- Highway Separation
- Interstate Highway No.
- U.S. Highway No.
- State Highway No.
- County Highway Letter
- State Boundary
- County Boundary
- Civil Town Boundary
- Section Line
- Dam
- Hospital
- Airport
- County Seat
- Unincorporated Village
- Fish Hatchery
- Game Farm
- Public Hunt or Fish Grds.
- Public Camp & Picnic Grds.
- Ranger Station
- State Park
- County Park
- Without Facilities
- Rest Area
- Wayside
- Univ. of Wisconsin
- Washington Co.

Project Location  
ID 4867-01-00  
CTH H Over Milwaukee River

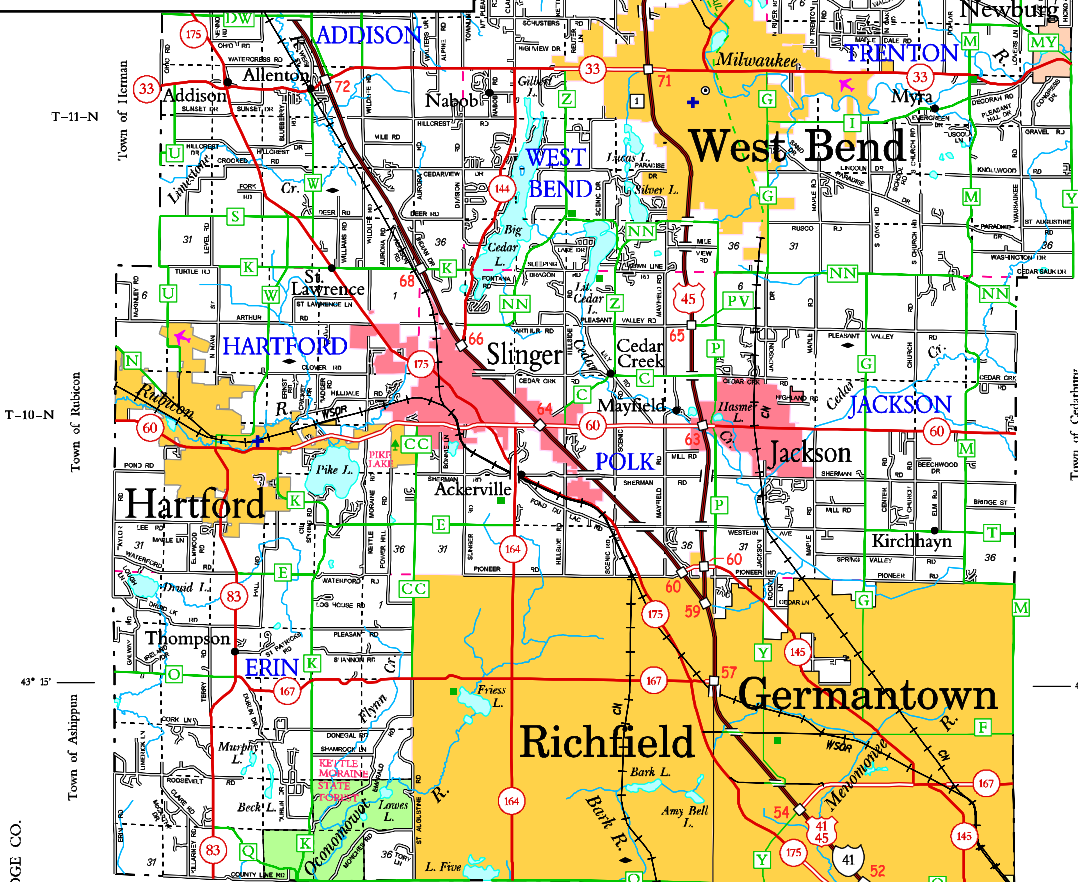

T-12-N

Town of Predoma

T-11-N

Town of Sauville

T-10-N

Town of Cedarburg

OZAUKEE CO.

43° 15'

Town of Merton

Town of Lisbon

R-19-E

R-20-E

WAUKESHA CO.

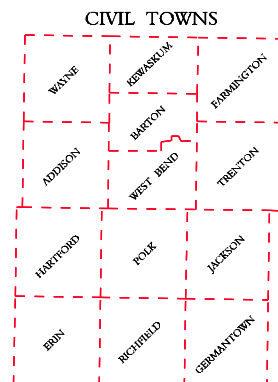

## WASHINGTON CO.

DEPARTMENT OF TRANSPORTATION  
Madison, Wisconsin

SCALE 0 1 2 MILES

Corrected for  
JAN. 2019

Base compiled from U.S.G.S. Quadrangles  
1:50,000 Series

### MILES OF HIGHWAY as of Dec. 31, 2017

STATE	187
COUNTY	182
LOCAL ROADS	1071
OTHER ROADS	0
TOTAL FOR COUNTY	1540

Land Area (2000 Census) 430 sq mi  
Population (2000 Census) 131,887  
County Seat West Bend

### SECTION NUMBERING OF A TOWNSHIP

6	5	4	3	2	1
7	8	9	10	11	12
18	17	16	15	14	13
19	20	21	22	23	24
30	29	28	27	26	25
31	32	33	34	35	36

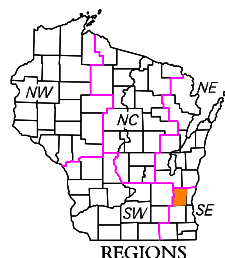

# ArcGIS WebMap



March 27, 2019

- Trails
- NNAGSTREAM
- DNR/Army Corps of Eng. Regulated Wetland
- Right-of-Way

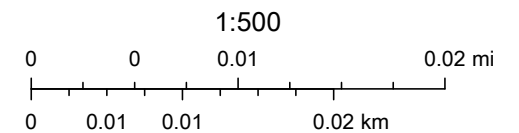

Washington County, Washington County, Wisconsin

PROJECT ID: 4867-01-70  
WITH: N/A

COUNTY: WASHINGTON

ORDER OF SHEETS

Section No. 1	Title
Section No. 2	Typical Sections and Details (Includes Erosion Control Plans)
Section No. 3	Estimate of Quantities
Section No. 3	Miscellaneous Quantities
Section No. 4	Right of Way Plat
Section No. 5	Plan and Profile
Section No. 6	Standard Detail Drawings
Section No. 7	Sign Plates
Section No. 8	Structure Plans
Section No. 9	Computer Earthwork Data
Section No. 9	Cross Sections

TOTAL SHEETS =



DESIGN DESIGNATION

A.A.D.T. (2022)	=	4,240
A.A.D.T. (2042)	=	5,840
D.H.V.	=	469
D.D.	=	51/49
T.	=	10.0%
DESIGN SPEED	=	35 MPH
ESALS	=	760,000

CONVENTIONAL SYMBOLS

PLAN

CORPORATE LIMITS	
PROPERTY LINE	
LOT LINE	
LIMITED HIGHWAY EASEMENT	
EXISTING RIGHT OF WAY	
PROPOSED OR NEW R/W LINE	
SLOPE INTERCEPT	
REFERENCE LINE	
EXISTING CULVERT	
PROPOSED CULVERT (Box or Pipe)	
COMBUSTIBLE FLUIDS	
MARSH AREA	
WOODED OR SHRUB AREA	

PROFILE

GRADE LINE	
ORIGINAL GROUND	
MARSH OR ROCK PROFILE (To be noted as such)	
SPECIAL DITCH	
GRADE ELEVATION	
CULVERT (Profile View)	
UTILITIES	
ELECTRIC	
FIBER OPTIC	
GAS	
SANITARY SEWER	
STORM SEWER	
TELEPHONE	
WATER	
UTILITY PEDESTAL	
POWER POLE	
TELEPHONE POLE	

STATE OF WISCONSIN  
DEPARTMENT OF TRANSPORTATION  
PLAN OF PROPOSED IMPROVEMENT  
CTH H  
BRIDGE OVER MILWAUKEE RIVER B660655  
CTH H  
WASHINGTON COUNTY

STATE PROJECT NUMBER  
4867-01-70

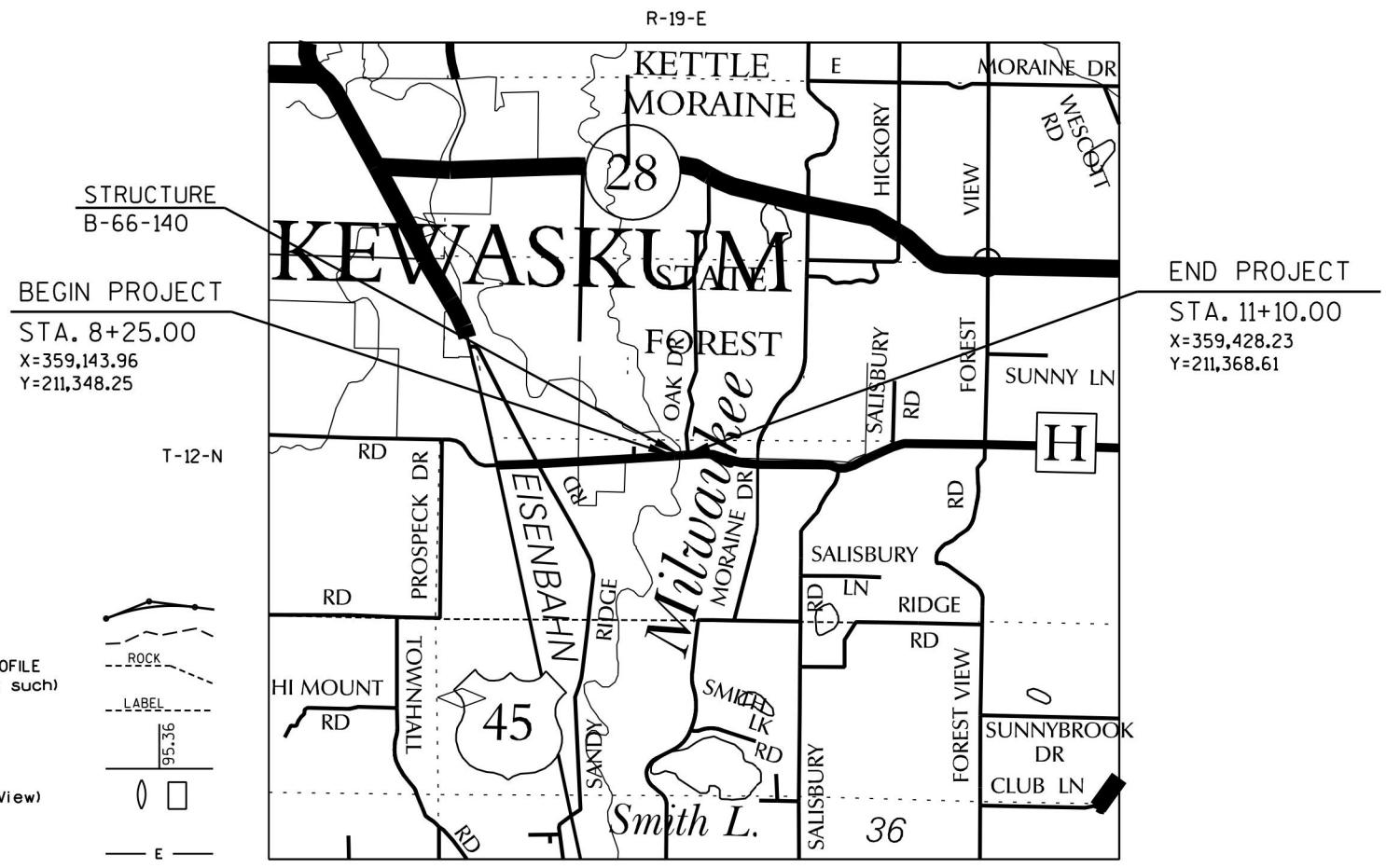

LAYOUT  
SCALE 0 0.5 MI.

TOTAL NET LENGTH OF CENTERLINE = 0.054 MI.

Coordinates on this plan are referenced to the Wisconsin County Coordinate System (WCCS), Washington, NAD 83 (2011).  
Elevations shown on this plan are referenced to the North American Vertical Datum of 1988 NAVD 88 (2011).

STATE PROJECT	FEDERAL PROJECT	
	PROJECT	CONTRACT
4867-01-70		

ACCEPTED FOR  
WASHINGTON COUNTY

(Date) (Signature & Title of Official)

ORIGINAL PLANS PREPARED BY



STATE OF WISCONSIN  
DEPARTMENT OF TRANSPORTATION

PREPARED BY

Surveyor	STRAND ASSOCIATES, INC.
Designer	STRAND ASSOCIATES, INC.
Project Manager	KATHLEEN KRAMER
Regional Examiner	
Regional Supervisor	
C.O. Examiner	

APPROVED FOR THE DEPARTMENT

DATE: (Signature)

E

## LAYOUT DURING BRIDGE REMOVAL

REMOVE BRIDGE HALF AT A TIME TO ACCOMMODATE BOAT TRAFFIC UNDER THE SPANS NOT BEING WORKED ON.

BOAT TRAFFIC WILL TRAVEL UNDER SPAN 2 WHEN SPAN 1 IS BEING REMOVED. THEN BUOYS WILL BE MOVED TO ALLOW BOAT TRAFFIC UNDER THE OLD SPAN 1 WHILE SPAN 2 IS BEING REMOVED.

THE EXACT LOCATION AND SPACING OF ALL DEVICES SHALL BE ADJUSTED TO FIT FIELD CONDITIONS.

## LEGEND

- ⓓ DANGER BUOY
- ⓐ GREEN DIRECTIONAL BUOY
- Ⓡ RED DIRECTIONAL BUOY

## LAYOUT DURING BRIDGE CONSTRUCTION

ACCESS UNDER EITHER SPAN 1, 2, OR 3 TO BE DETERMINED BY CONTRACTOR'S OPERATIONS AND AS DIRECTED BY THE ENGINEER.

THE EXACT LOCATION AND SPACING OF ALL DEVICES SHALL BE ADJUSTED TO FIT FIELD CONDITIONS.

## LEGEND

- ⓓ DANGER BUOY
- ⓐ GREEN DIRECTIONAL BUOY
- Ⓡ RED DIRECTIONAL BUOY

