

SUP

PROJECT ID: 8050-00-71

COUNTY: BURNETT

APRIL 2021

ORDER OF SHEETS

Section No.	1	Title
Section No.	2	Typical Sections and Details
Section No.	3	Estimate of Quantities
Section No.	3	Miscellaneous Quantities
<del>Section No.</del>	<del>4</del>	<del>Right of Way Plan</del>
Section No.	5	Plan and Profile
Section No.	6	Standard Detail Drawings
<del>Section No.</del>	<del>7</del>	<del>Sign Plates</del>
<del>Section No.</del>	<del>8</del>	<del>Structure Plans</del>
<del>Section No.</del>	<del>9</del>	<del>Computer Earthwork Data</del>
<del>Section No.</del>	<del>9</del>	<del>Gross Sections</del>

TOTAL SHEETS = 22

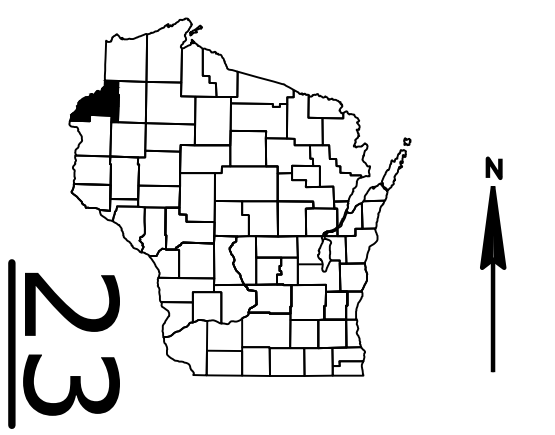

DESIGN DESIGNATION 8050-00-01

A.A.D.T.	2019	=	3436
A.A.D.T.		=	TRAFFIC FORECAST DATA UNAVAILABLE
D.H.V.		=	
D.D.		=	
T.		=	
DESIGN SPEED		=	55-60 MPH
ESALS		=	

CONVENTIONAL SYMBOLS

PLAN

CORPORATE LIMITS

PROPERTY LINE

LOT LINE

LIMITED HIGHWAY EASEMENT

EXISTING RIGHT OF WAY

PROPOSED OR NEW R/W LINE

SLOPE INTERCEPT

REFERENCE LINE

EXISTING CULVERT

PROPOSED CULVERT (Box or Pipe)

COMBUSTIBLE FLUIDS

MARSH AREA

WOODED OR SHRUB AREA

PROFILE

GRADE LINE

ORIGINAL GROUND

MARSH OR ROCK PROFILE (To be noted as such)

SPECIAL DITCH

GRADE ELEVATION

CULVERT (Profile View)

UTILITIES

ELECTRIC

FIBER OPTIC

GAS

SANITARY SEWER

STORM SEWER

TELEPHONE

WATER

UTILITY PEDESTAL

POWER POLE

TELEPHONE POLE

ROCK

LABEL

95.36

300'FB

CAUTION

E

FO

G

SAN

SS

T

W

Ø

STATE OF WISCONSIN  
DEPARTMENT OF TRANSPORTATION  
PLAN OF PROPOSED IMPROVEMENT  
SIREN - SPOONER  
FOSMO DRIVE TO WEST HERTEL DRIVE  
STH 70  
BURNETT

STATE PROJECT NUMBER  
8050-00-71

STATE PROJECT	FEDERAL PROJECT	
	PROJECT	CONTRACT
8050-00-71	WISC 2021270	1

PREPARED BY  
Surveyor \_\_\_\_\_ NW REGION  
Designer \_\_\_\_\_ ALANNA PEKURI  
Project Manager \_\_\_\_\_ BETH CUNNINGHAM, PE  
Regional Examiner \_\_\_\_\_ JENNIFER OLDENBURG  
Regional Supervisor \_\_\_\_\_ ANDREW STENSLAND, PE

APPROVED FOR THE DEPARTMENT  
DATE: 11/25/2021 Andrew Stensland (Signature)

E

FILE NAME : C:\USERS\DOTAYP\DESKTOP\80500001\SHEETS\PLAN\010101\_TI.DWG

PLOT DATE : 10/14/2020 11:52 AM

PLOT BY : PEKURI, ALANNA J

PLOT NAME :

GENERAL NOTES

THERE ARE UTILITY FACILITIES WITHIN THE PROJECT AREA THAT ARE NOT SHOWN ON THE PLANS. THE CONTRACTOR SHALL COORDINATE THEIR CONSTRUCTION ACTIVITIES WITH A CALL TO DIGGERS HOTLINE AND/OR A DIRECT CALL TO UTILITIES THAT HAVE FACILITIES IN THE AREA. NOT ALL UTILITIES ARE MEMBERS OF DIGGERS HOTLINE.

ACCESS TO ALL RESIDENCES AND BUSINESSES SHALL BE MAINTAINED DURING CONSTRUCTION.

AS-BUILTS USED FOR PLAN DEVELOPMENT  
PROJECT NO: 8050-10-60, CONSTRUCTION YEAR: 2009  
PROJECT NO: PRIVATE PROJECT PLAN NUMBER S0634 6-16-00115, CONSTRUCTION YEAR: 2017

TRAFFIC CONTROL GENERAL NOTES

PLACE TRAFFIC CONTROL SIGNS PER SDD "TRAFFIC CONTROL ADVANCE WARNING SIGNS 45 MPH OR GREATER, TWO WAY UNDIVIDED ROAD OPEN TO TRAFFIC" AT BEGIN AND END PROJECT LIMITS AND AT SIDEROADS AS APPLICABLE CONTAINED WITHIN THE SDD FOR SIDEROAD APPROACHES.

FOR TRAFFIC CONTROL SIGNS THAT WILL BE IN PLACE LONGER THAN 7 DAYS, USE SDD "TEMPORARY TRAFFIC CONTROL, SIGN MOUNTING."

PLACE TRAFFIC CONTROL FOR SHOULDER WORK PER SDD "TRAFFIC CONTROL, WORK ON SHOULDER OR PARKING LANE, UNDIVIDED ROADWAY" AS APPLICABLE CONTAINED WITHIN THE SDD.

FOR LANE CLOSURES, SUCH AS WHEN MILLING OR PAVING, PLACE TRAFFIC CONTROL PER SDD "TRAFFIC CONTROL FOR LANE CLOSURE WITH FLAGGING OPERATION" AS APPLICABLE CONTAINED WITHIN THE SDD.

WHEN PLACING PAVEMENT MARKING, USE SDD "MOVING PAVEMENT MARKING OPERATION TWO-LANE TWO-WAY ROADWAY".

UTILITIES

DAIRYLAND POWER COOPERATIVE-ELECTRICITY  
ROB MALY  
3200 EAST AVE SOUTH  
LA CROSSE, WI 54602  
PHONE: 608-787-1427  
CELL PHONE: 608-518-2633  
EMAIL: rob.maly@dairylandpower.com

POLK-BURNETT ELECTRIC COOPERATIVE-ELECTRICITY  
STEVE JENSSEN  
7298 ST. RD 70  
WEBSTER, WI 54872  
PHONE: 715-646-2191  
CELL PHONE: 715-553-1394  
EMAIL: sjenssen@polkburnett.com

SIREN COMMUNICATIONS INC-COMMUNICATION LINE  
KENT BASSETT  
7723 MAIN STREET  
SIREN, WI 54872  
PHONE: 715-349-2224  
EMAIL: Kentbass@sirentel.net

WE ENERGIES GAS  
STEVEN CHAVERS  
104 W. SOUTH STREET  
RICE LAKE, WI 54868  
PHONE: 715-234-9605  
CELL PHONE: 715-213-4327  
EMAIL: Steven.chavers@we-energies.com

DNR

DNR LIAISON  
AMY CRONK - ENVIRONMENTAL ANALYSIS AND REVIEW SPECIALIST  
WDNR - NORTHWEST DISTRICT HEADQUARTERS  
810 WEST MAPLE STREET  
SPOONER, WI 54801  
PHONE: 715-635-4229  
EMAIL: AMY.CRONK@WISCONSIN.GOV

DESIGN CONTACT

WISCONSIN DEPARTMENT OF TRANSPORTATION  
ALANNA J. PEKURI - PROJECT LEADER  
1701 N. 4TH STREET  
SUPERIOR, WI 54880  
TELEPHONE: 715-392-7972  
EMAIL: alanna.pekuri@dot.wi.gov



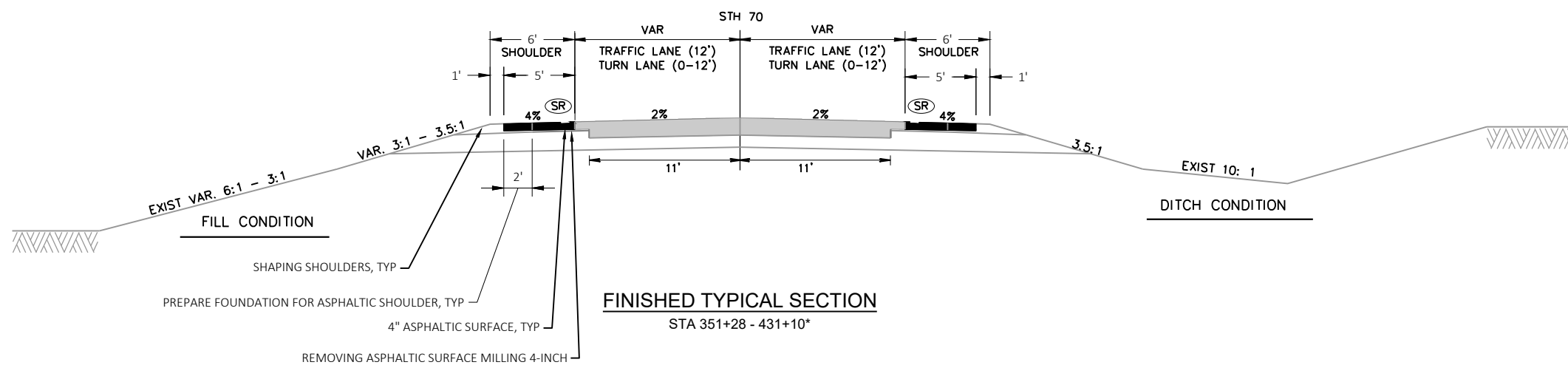
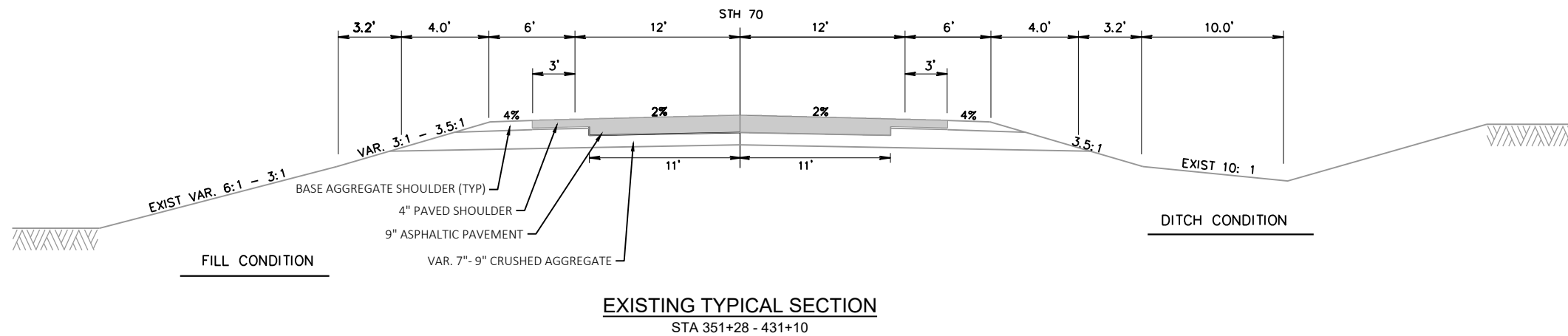

## NOTES

(SR) STA 351+60 - STA 430+60: ASPHALTIC SHOULDER RUMBLE STRIPS  
2-LANE RURAL. SEE SDD FOR "2-LANE RURAL SHOULDER RUMBLE  
STRIPS, MILLING" FOR ADDITIONAL INFORMATION.

\* STATION EXCEPTION FOR IMPROVEMENTS 384+82 LT TO  
401+40 LT

PROJECT NO: 8050-00-71

HWY: STH 70

COUNTY: BURNETT

TYPICAL SECTIONS

SHEET

E

Estimate Of Quantities

8050-00-71					
Line	Item	Item Description	Unit	Total	Qty
0002	204.0120	Removing Asphaltic Surface Milling	SY	4,640.000	4,640.000
0004	211.0400	Prepare Foundation for Asphaltic Shoulders	STA	144.000	144.000
0006	213.0100	Finishing Roadway (project) 01. 8050-00-71	EACH	1.000	1.000
0008	305.0500	Shaping Shoulders	STA	144.000	144.000
0010	455.0605	Tack Coat	GAL	464.000	464.000
0012	465.0105	Asphaltic Surface	TON	1,682.000	1,682.000
0014	465.0425	Asphaltic Shoulder Rumble Strips 2-Lane Rural	LF	13,459.000	13,459.000
0016	618.0100	Maintenance And Repair of Haul Roads (project) 01. 8050-00-71	EACH	1.000	1.000
0018	619.1000	Mobilization	EACH	1.000	1.000
0020	642.5001	Field Office Type B	EACH	1.000	1.000
0022	643.0300	Traffic Control Drums	DAY	3,531.000	3,531.000
0024	643.0715	Traffic Control Warning Lights Type C	DAY	141.000	141.000
0026	643.0900	Traffic Control Signs	DAY	705.000	705.000
0028	643.5000	Traffic Control	EACH	1.000	1.000
0030	646.1020	Marking Line Epoxy 4-Inch	LF	14,076.000	14,076.000
0032	650.5000	Construction Staking Base	LF	14,076.000	14,076.000
0034	650.8000	Construction Staking Resurfacing Reference	LF	14,076.000	14,076.000
0036	650.9910	Construction Staking Supplemental Control (project) 01. 8050-00-71	LS	1.000	1.000
0038	ASP.1T0A	On-the-Job Training Apprentice at \$5.00/HR	HRS	300.000	300.000
0040	ASP.1T0G	On-the-Job Training Graduate at \$5.00/HR	HRS	300.000	300.000

PAVEMENT

				204.0120	211.0400	213.0100.01	305.0500	455.0605	465.0105	465.0425	REMARKS
				REMOVING	FOUNDATION FOR	FINISHING	SHAPING	TACK COAT	ASPHALTIC	ASPHALTIC	
				ASPHALTIC	ASPHALTIC	ROADWAY	SHOULDERS		SURFACE	SHOULDER	
STATION	TO	STATION	LOCATION	SY	STA	EACH	STA	GAL	TON	LF	
351+28.72	-	431+10.22	R	2,612	80	-	80	261	947	7,607	REMOVING EXCESS SHOULDER MATERIAL INCIDENTAL TO PREPARE FOUNDATION FOR ASPHALTIC SHOULDERS
351+28.72	-	431+10.22	L	2,027	64	-	64	203	735	5,852	
351+28.72	-	431+10.22	BOTH	-	-	1	-	-	-	-	TYPE 1 RUMBLE STRIPS TO BE INSTALLED
TOTAL 0010				4,640	144	1	144	464	1,682	13,459	

TRAFFIC CONTROL

				643.0300	643.0715	643.0900	643.5000			
				TRAFFIC CONTROL	TRAFFIC CONTROL	TRAFFIC	TRAFFIC CONTROL			
				DRUMS	WARNING LIGHTS	SIGNS				
				EACH	C	EACH	EACH	DAY	EACH	
STATION	TO	STATION	LOCATION	EACH	DAY	EACH	EACH	DAY	EACH	
351+28.72	-	431+10.22	LT	66	1,547	3	-	-	-	
351+28.72	-	431+10.22	RT	85	1,983	3	-	-	-	
351+28.72	-	431+10.22	BOTH	-	-	-	15	705	1	
TOTAL 0010				3,531		141		705	1	

PAVEMENT MARKING

				646.1020	REMARKS
				MARKING LINE	
				EPOXY 4-INCH	
STATION	TO	STATION	LOCATION	LF	
351+28.72	-	431+10.22	R	7,994	WHITE EDGELINE
351+28.72	-	431+10.22	L	6,082	
TOTAL 0010				14,076	

CONSTRUCTION STAKING

				650.5000	650.8000
				CONSTRUCTION	CONSTRUCTION
				STAKING BASE	STAKING
				LF	REFERENCE
STATION	TO	STATION	LOCATION	LF	LF
351+28.72	-	431+10.22	R	7,994	7,994
351+28.72	-	431+10.22	L	6,082	6,082
TOTAL 0010				14,076	14,076

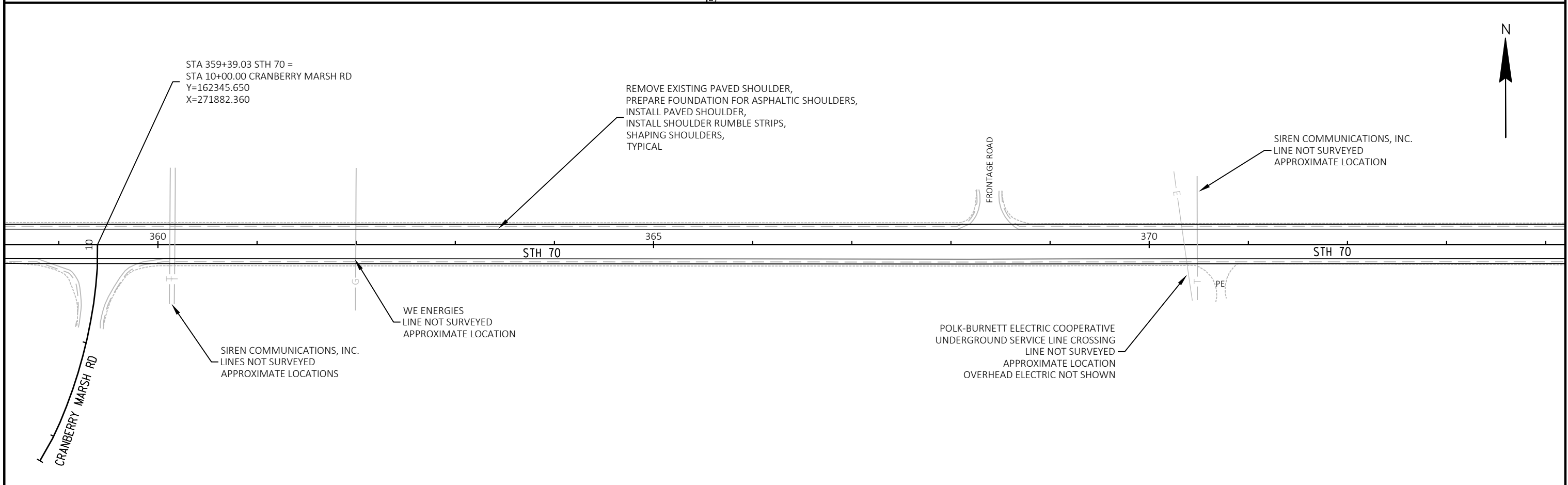
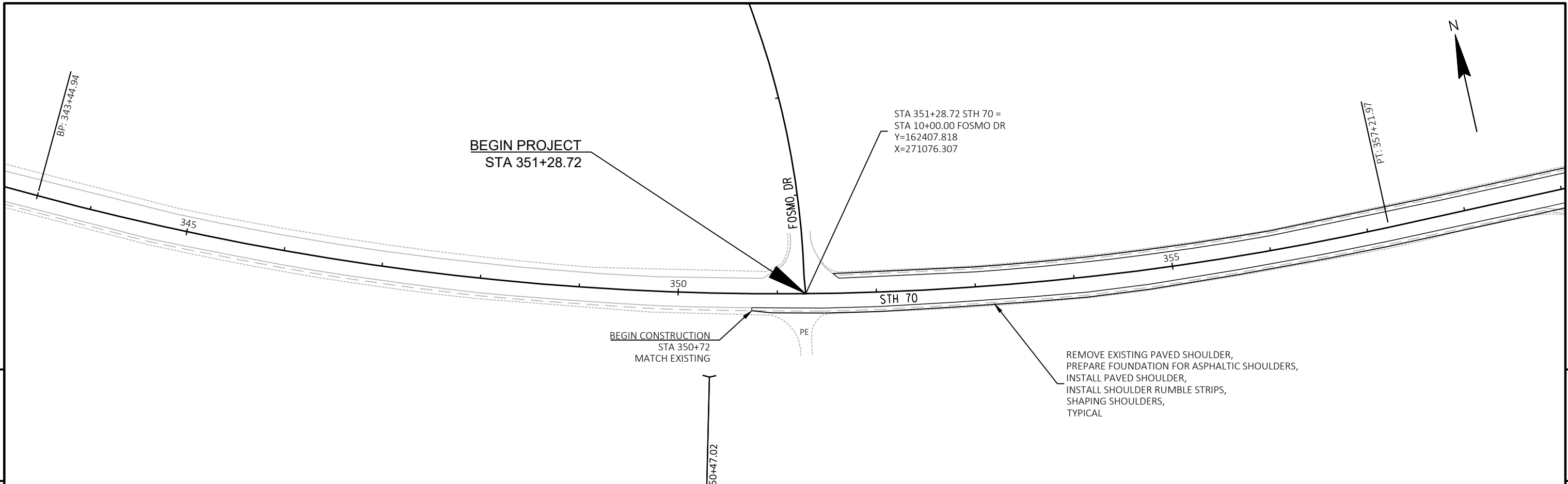

PROJECT NO: 8050-00-71	HWY: STH 70	COUNTY: BURNETT	PLAN	SHEET	E
------------------------	-------------	-----------------	------	-------	---

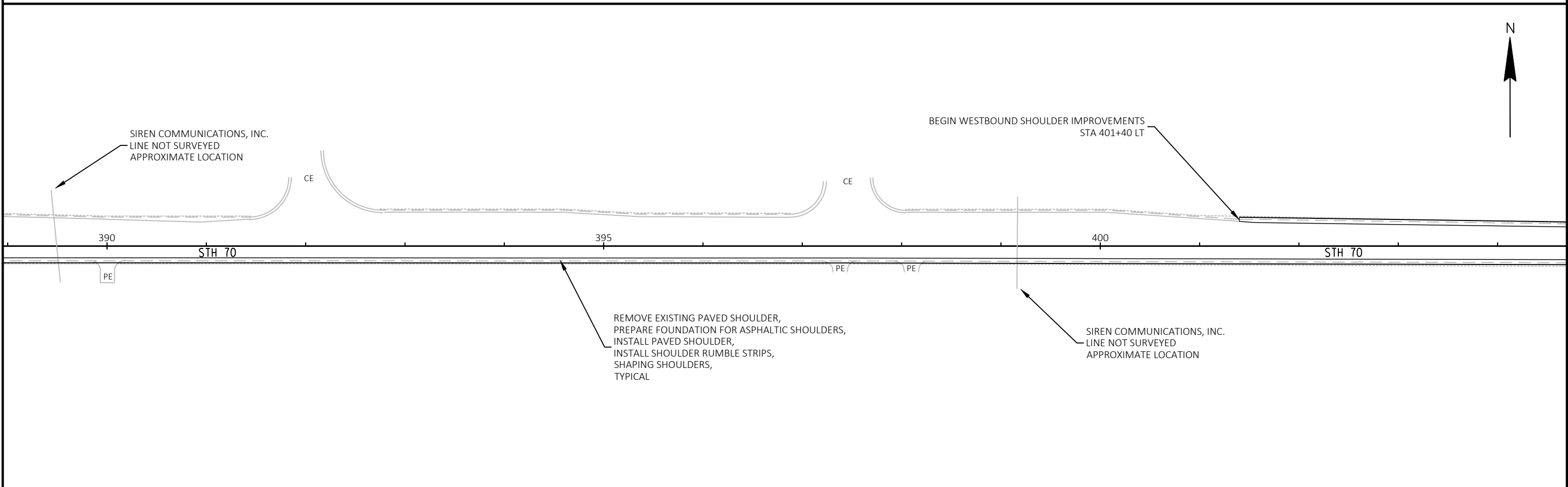
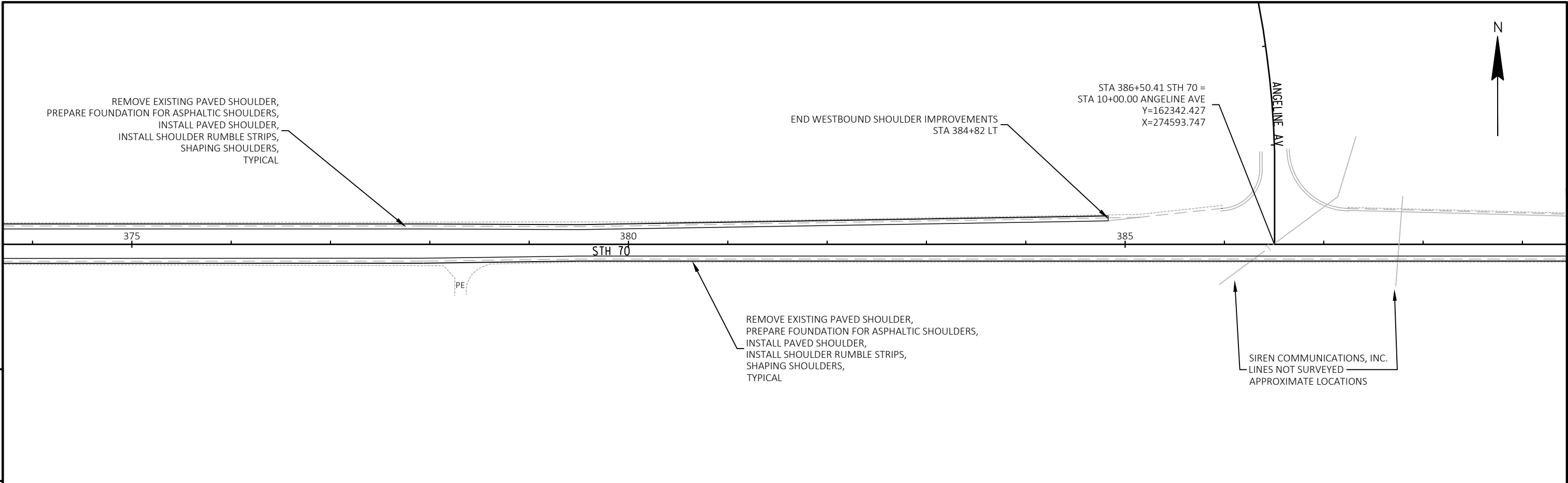

PROJECT NO: 8050-00-71	HWY: STH 70	COUNTY: BURNETT	PLAN	SHEET	E
------------------------	-------------	-----------------	------	-------	---

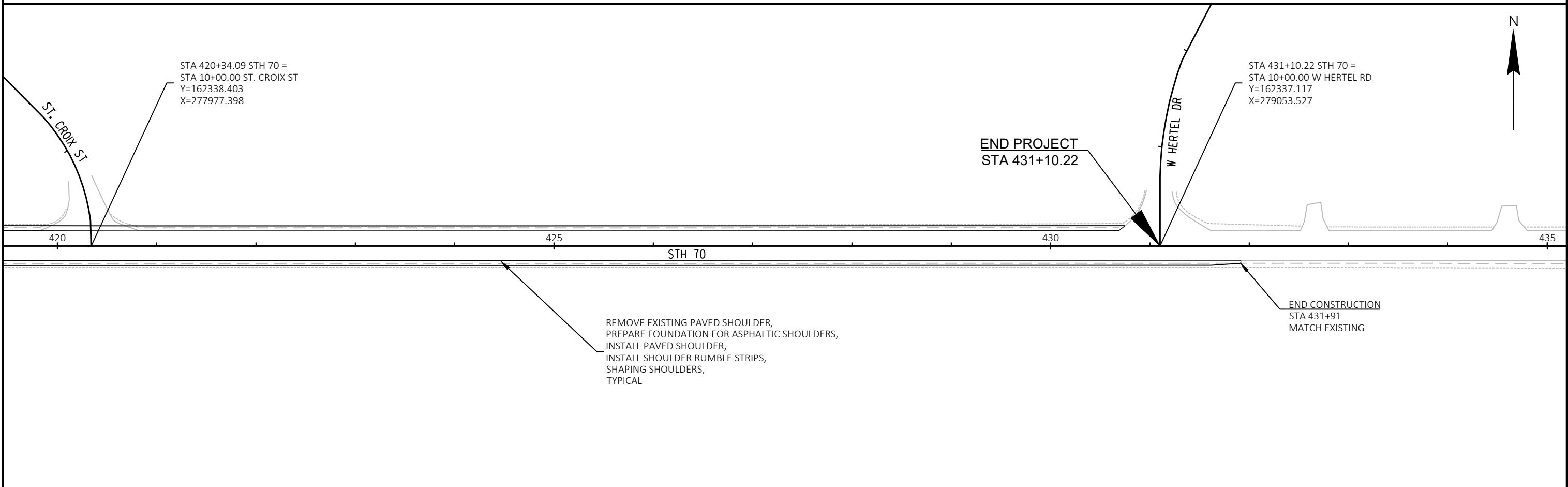
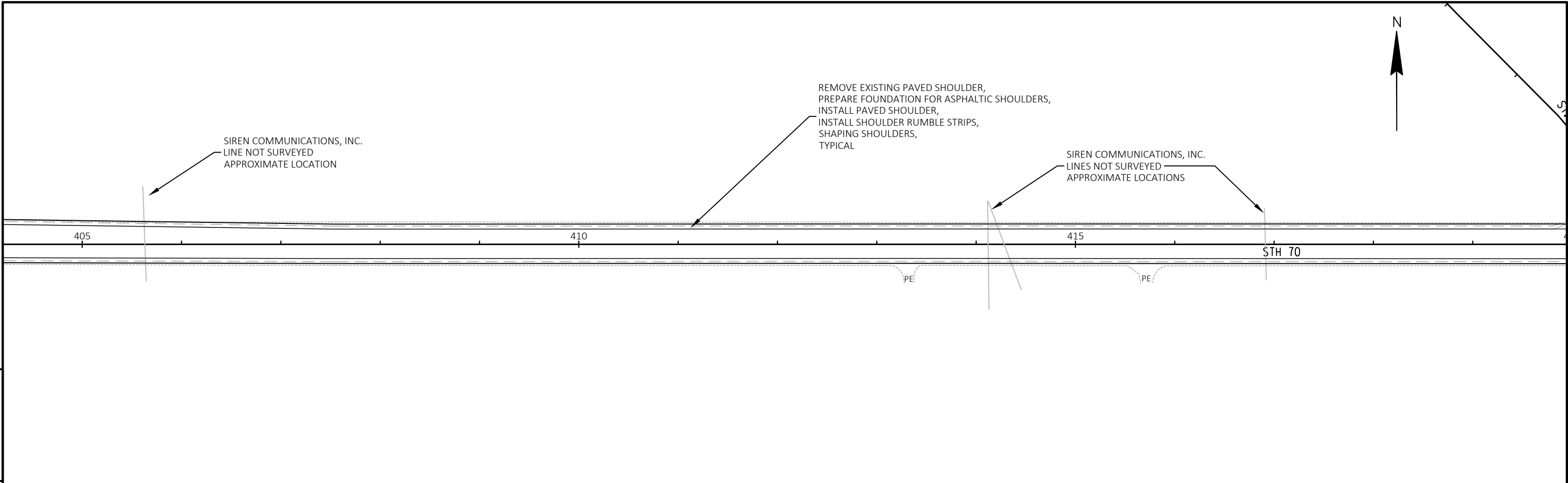

PROJECT NO: 8050-00-71	HWY: STH 70	COUNTY: BURNETT	PLAN	SHEET	E
------------------------	-------------	-----------------	------	-------	---



Standard Detail Drawing List

13A10-02A	2-LANE RURAL SHOULDER RUMBLE STRIP, MILLING
13A10-02C	2-LANE RURAL SHOULDER RUMBLE STRIP, MILLING
13A10-02D	2-LANE RURAL SHOULDER RUMBLE STRIP, MILLING
15C04-05	TRAFFIC CONTROL, ADVANCE WARNING SIGNS 45 M. P. H. OR GREATER TWO-WAY UNDIVIDED ROAD OPEN TO TRAFFIC
15C08-20A	LONGITUDINAL MARKING (MAINLINE)
15C11-07B	CHANNELIZING DEVICES DRUMS, CONES, BARRICADES AND VERTICAL PANELS
15C12-07	TRAFFIC CONTROL FOR LANE CLOSURE WITH FLAGGING OPERATION
15C19-06A	MOVING PAVEMENT MARKING OPERATION TWO-LANE TWO-WAY ROADWAY
15D28-04	TRAFFIC CONTROL, WORK ON SHOULDER OR PARKING LANE, UNDIVIDED ROADWAY
15D38-02A	TEMPORARY TRAFFIC CONTROL SIGN MOUNTING
15D38-02B	ATTACHMENT OF SIGNS TO POSTS

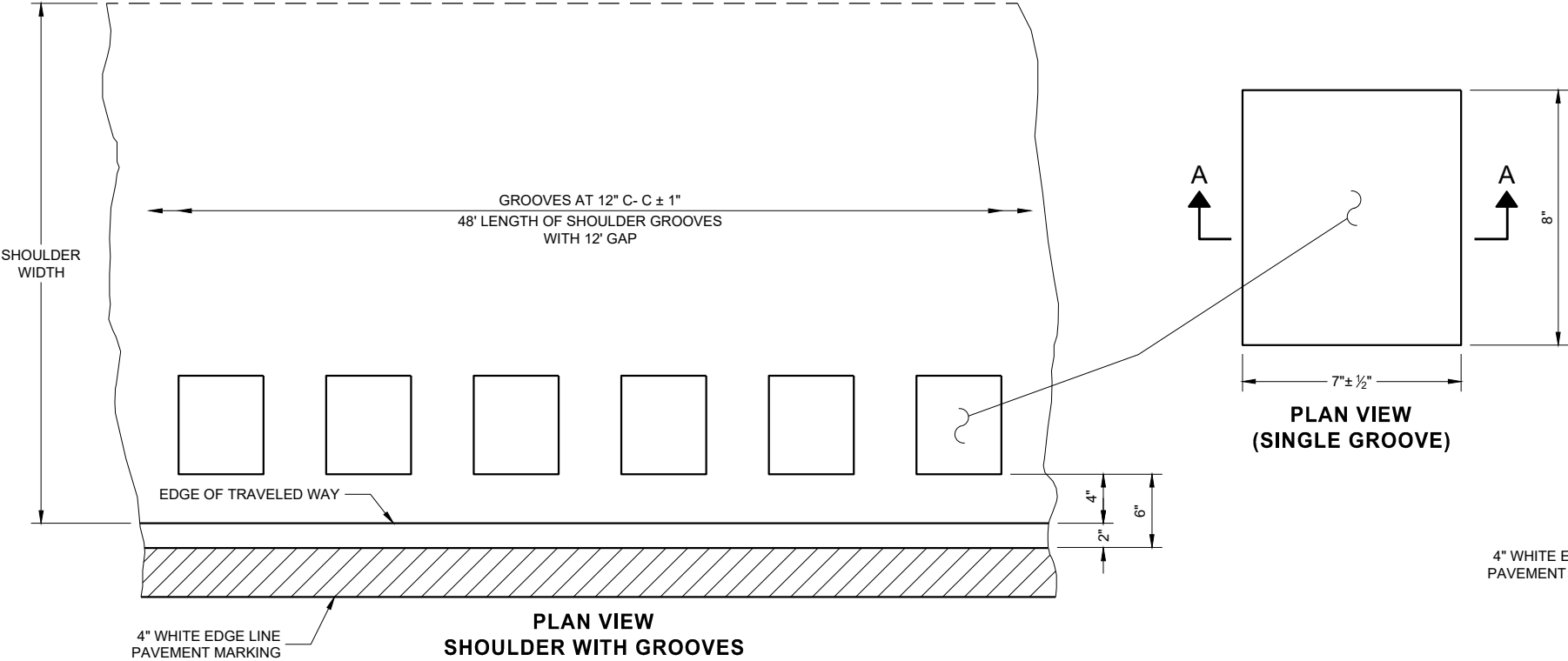

6

PLACEMENT DETAIL FOR TYPE 1 MILLED RUMBLE STRIP

GENERAL NOTES

DETAILS OF CONSTRUCTION NO SHOWN ON THIS DRAWING SHALL CONFORM TO THE PERTINENT REQUIREMENTS OF THE STANDARD SPECIFICATIONS AND APPLICABLE SPECIAL PROVISIONS.

DO NOT MILL SHOULDER GROOVES THROUGH ANY INTERSECTION, MARKED CROSSWALK, NON-MOTORIZED PATH CROSSING, OR SNOWMOBILE CROSSING.

- ① SHOULDER GROOVES MAY BE OMITTED IN AREAS WITH HIGH CONCENTRATIONS OF DRIVEWAYS. WHEN DIRECTED BY THE ENGINEER.

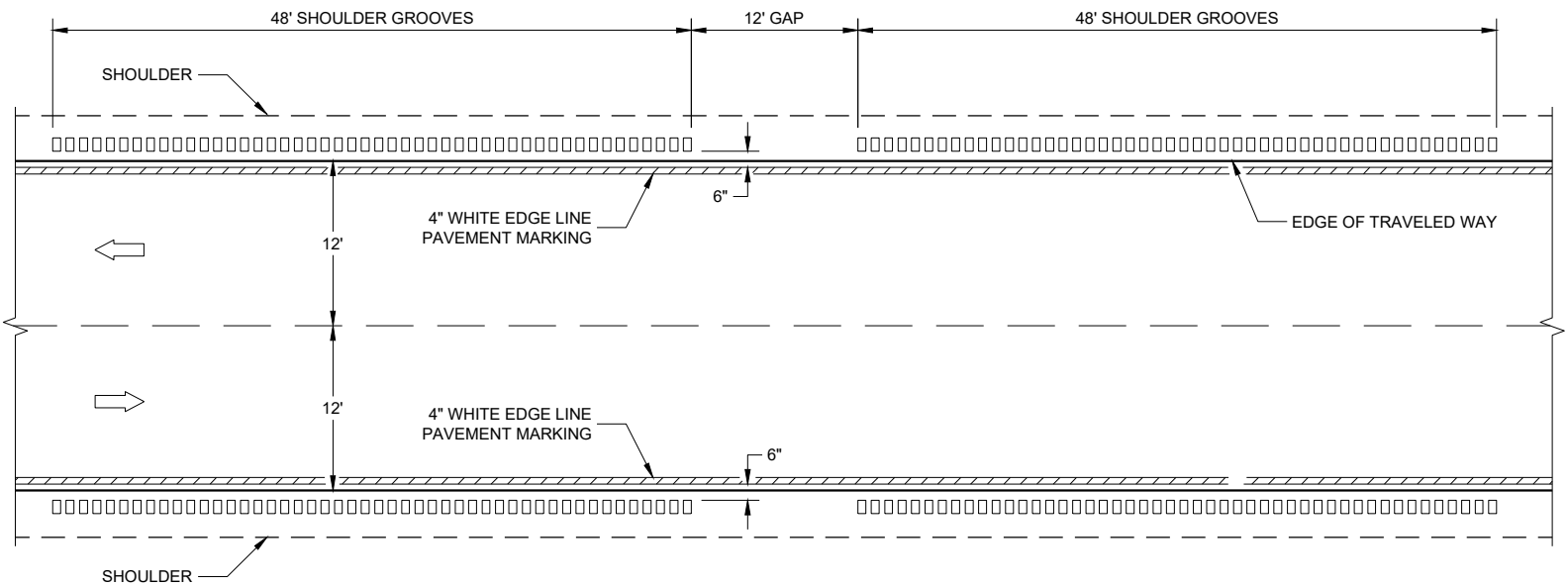
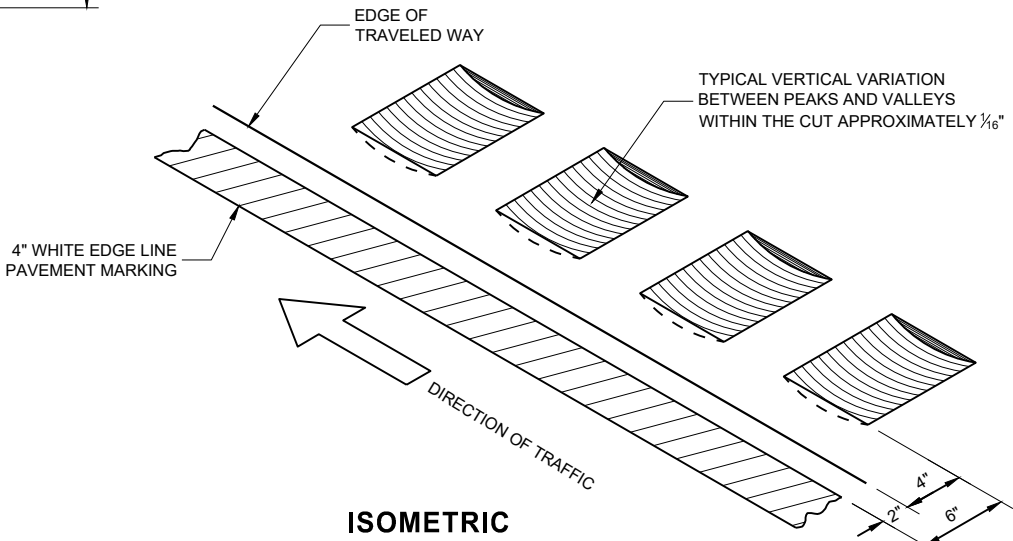

6

TYPE 1  
2 - LANE SHOULDER RUMBLE STRIP

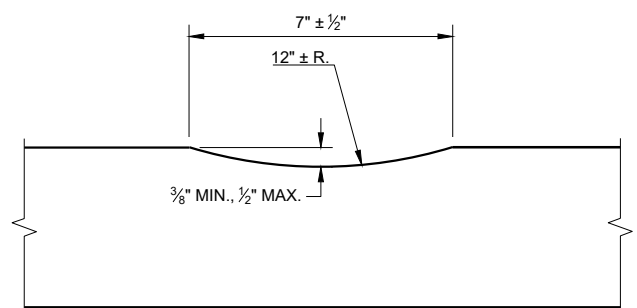

SECTION A - A

2-LANE RURAL SHOULDER  
RUMBLE STRIP, MILLING

STATE OF WISCONSIN  
DEPARTMENT OF TRANSPORTATION

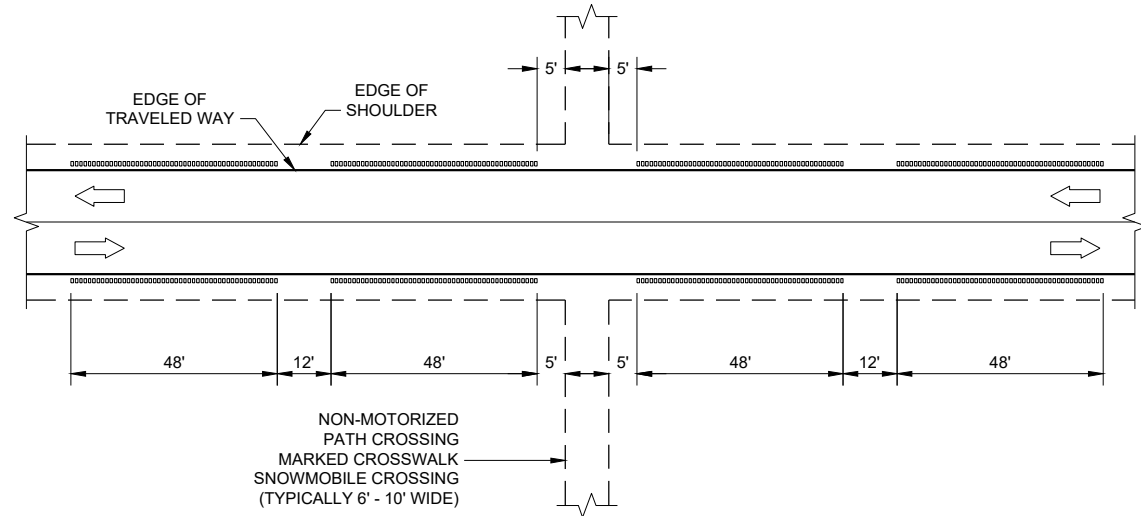

SHOULDER GROOVES AT MISCELLANEOUS CROSSINGS

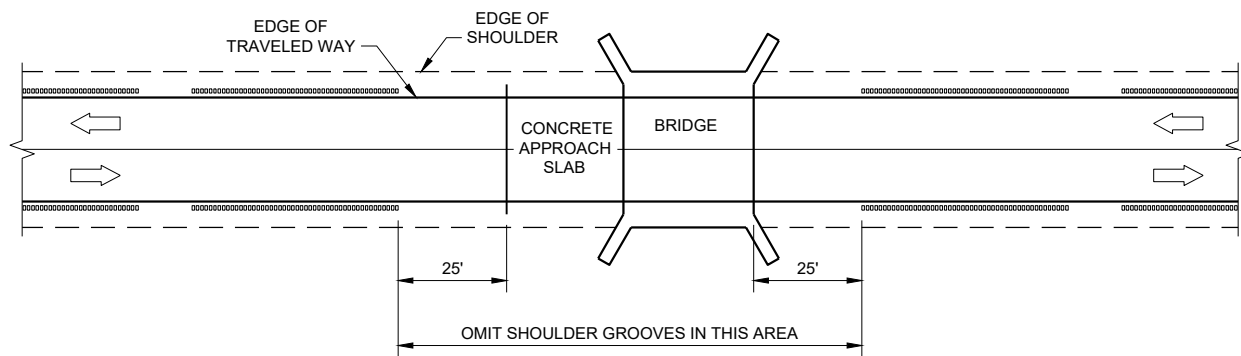

SHOULDER GROOVES AT BRIDGES

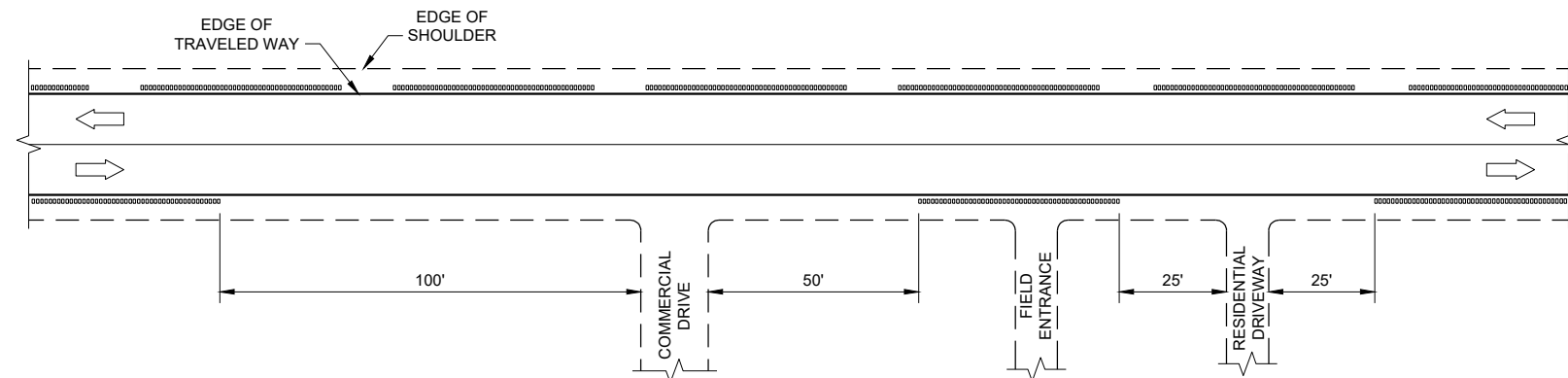

SHOULDER GROOVES AT DRIVEWAYS<sup>①</sup>

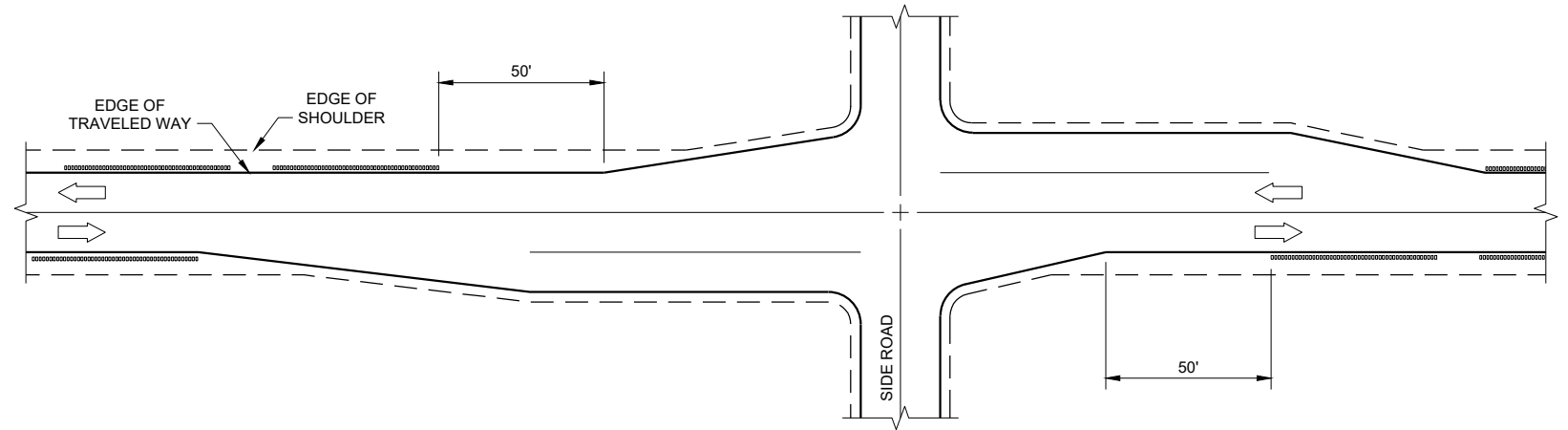

SHOULDER GROOVES AT RIGHT TURN LANE

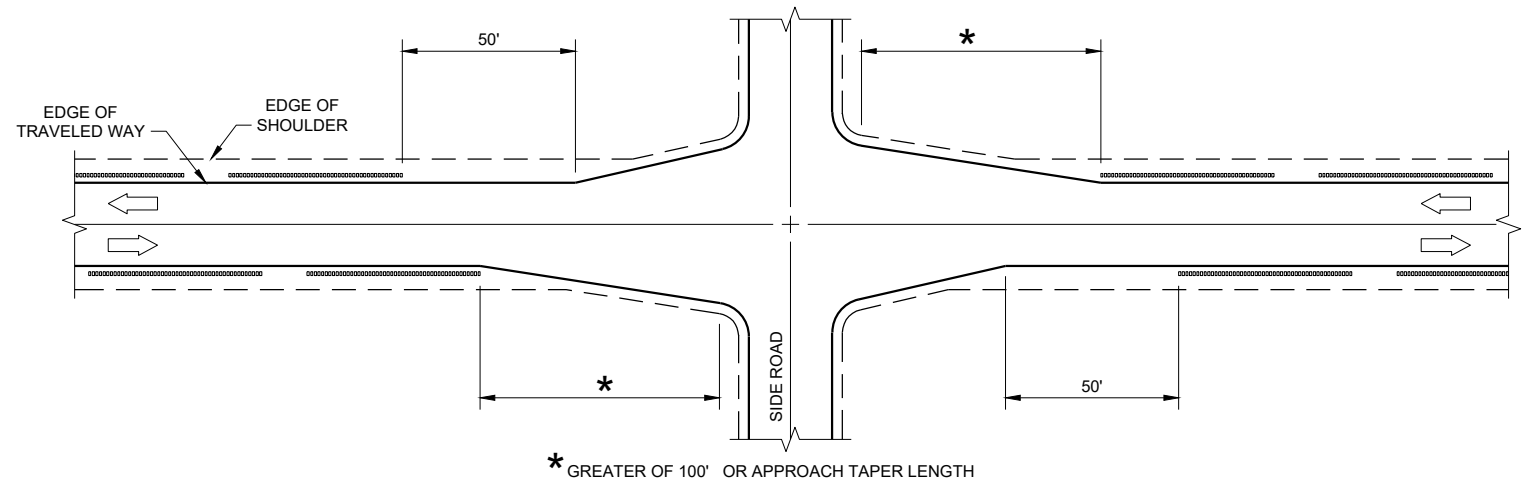

SHOULDER GROOVES AT INTERSECTIONS WITH APPROACH TAPER

### GENERAL NOTES

- ① SHOULDER GROOVES MAY BE OMITTED IN AREAS WITH HIGH CONCENTRATIONS OF DRIVEWAYS. WHEN DIRECTED BY THE ENGINEER.

**2-LANE RURAL SHOULDER  
RUMBLE STRIP, MILLING**

STATE OF WISCONSIN  
DEPARTMENT OF TRANSPORTATION

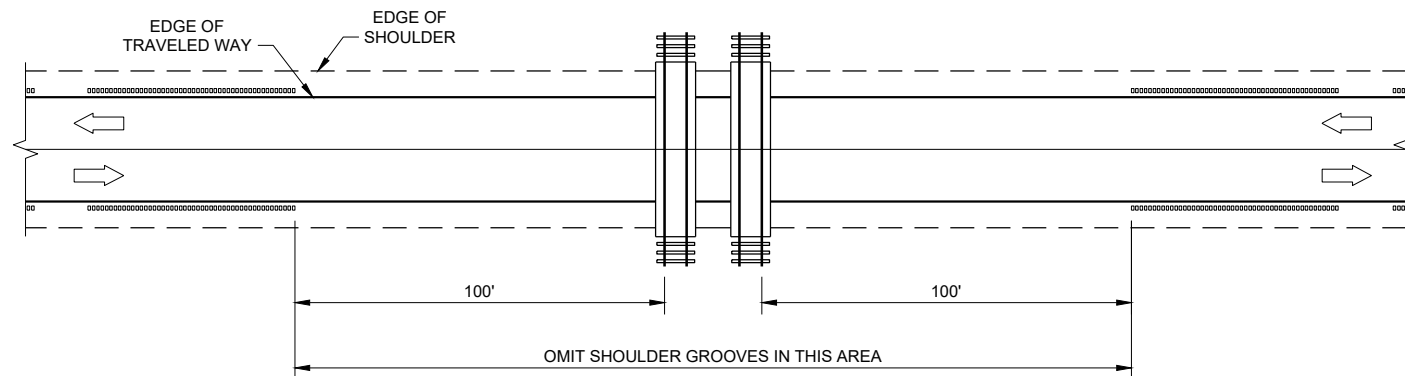

SHOULDER GROOVES AT RAILROADS

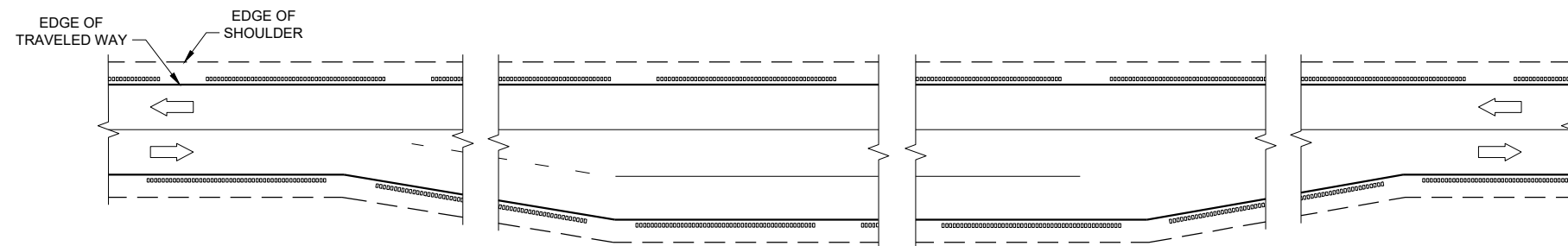

SHOULDER GROOVES AT PASSING AND CLIMBING LANES

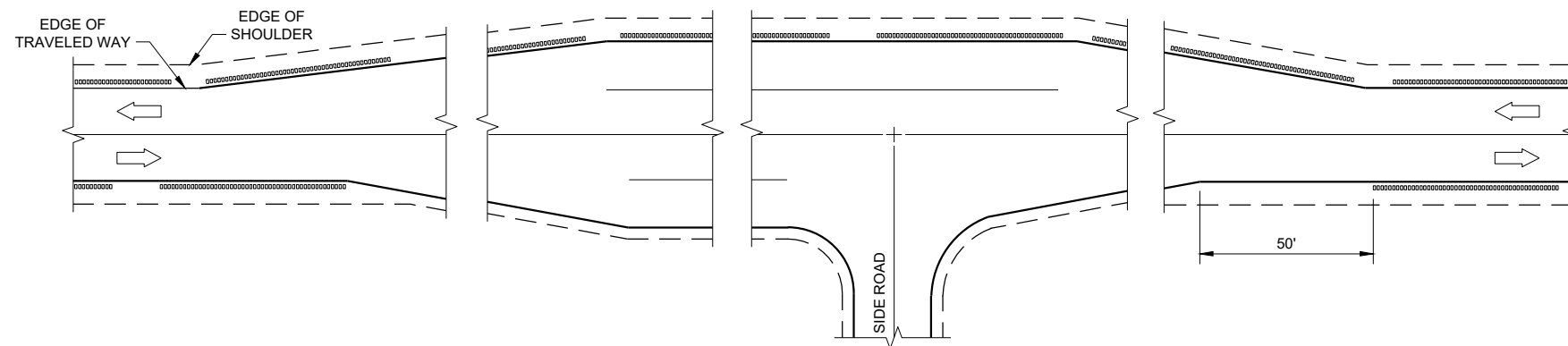

SHOULDER GROOVES AT BYPASS LANES

**2-LANE RURAL SHOULDER  
RUMBLE STRIP, MILLING**

STATE OF WISCONSIN  
DEPARTMENT OF TRANSPORTATION

APPROVED  
7/2018  
DATE  
/S/ Rodney Taylor  
ROADWAY STANDARDS DEVELOPMENT  
ENGINEER

FHWA

GENERAL NOTES

THE EXACT NUMBER, LOCATION, AND SPACING OF ALL SIGNS AND DEVICES SHALL BE ADJUSTED TO FIT FIELD CONDITIONS.

THE SPACING BETWEEN TRAFFIC CONTROL SIGNS SHOULD BE ADJUSTED TO NOT CONFLICT WITH AND SHOULD PROVIDE A MINIMUM OF 200 FEET (500 FEET DESIRABLE) CLEARANCE TO EXISTING SIGNS THAT WILL REMAIN IN PLACE.



ALL SIGNS ARE 48" X 48" UNLESS OTHERWISE NOTED.

SIGNS THAT WILL BE IN PLACE LESS THAN SEVEN CONTINUOUS DAYS AND NIGHTS MAY BE MOUNTED ON PORTABLE SUPPORTS.

IF A "STOP" SIGN MUST BE REMOVED FOR A WORK OPERATION, A TEMPORARY "STOP" SIGN SHALL BE PLACED PRIOR TO THE SIGN REMOVAL, OR A FLAGGER SHALL BE PROVIDED UNTIL THE SIGN IS REESTABLISHED.

- \* OMIT G20-1 SIGNS IF LENGTH OF WORK AREA IS 2 MILES OR LESS
- \*\* PLACE AN ADDITIONAL W20-1A "ROAD WORK AHEAD" SIGN IF WORK AREA WITHIN THE PROJECT IS SEPARATED BY MORE THAN 2 MILES FROM PREVIOUS WORK AREA.

LEGEND

-  SIGN ON PERMANENT SUPPORT
-  DIRECTION OF TRAFFIC
-  WORK AREA

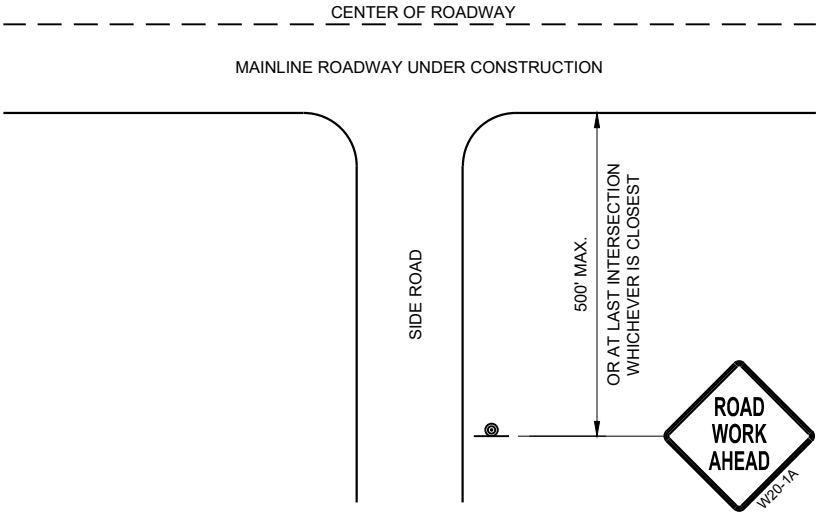

TYPICAL SIDE ROAD APPROACH  
WARNING SIGN DETAIL

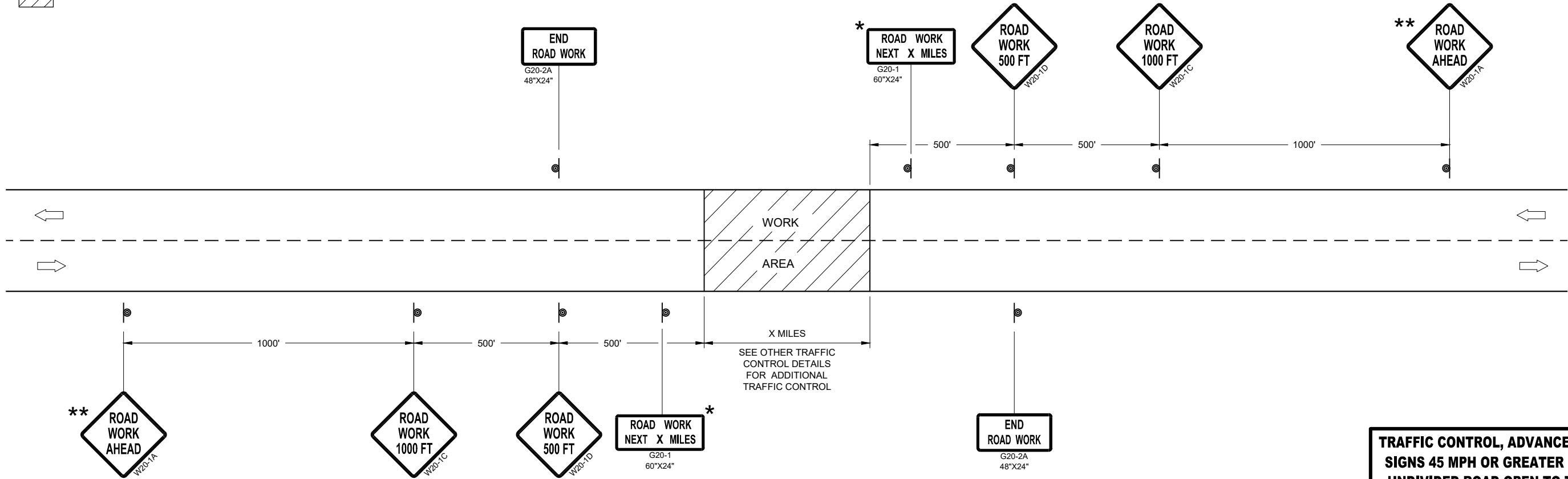

TRAFFIC CONTROL, ADVANCE WARNING SIGNS 45MPH OR GREATER

TRAFFIC CONTROL, ADVANCE WARNING  
SIGNS 45 MPH OR GREATER TWO-WAY  
UNDIVIDED ROAD OPEN TO TRAFFICE

STATE OF WISCONSIN  
DEPARTMENT OF TRANSPORTATION

APPROVED  
July 2018 /S/ Andrew Heidtke  
DATE WORK ZONE ENGINEER  
FHWA

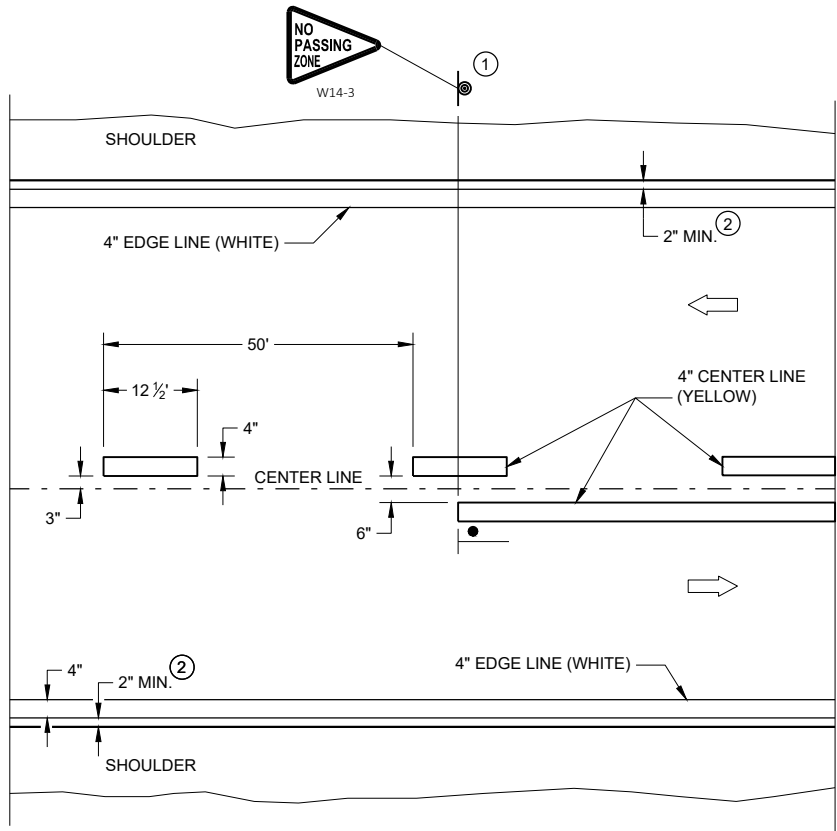

TWO WAY TRAFFIC

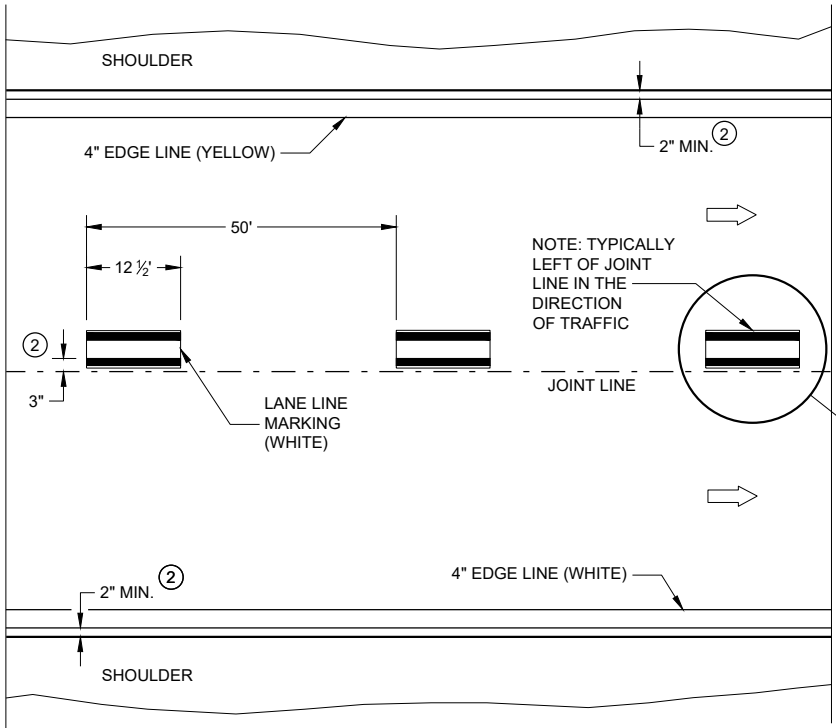

ONE WAY TRAFFIC

PERMANENT PAVEMENT MARKING

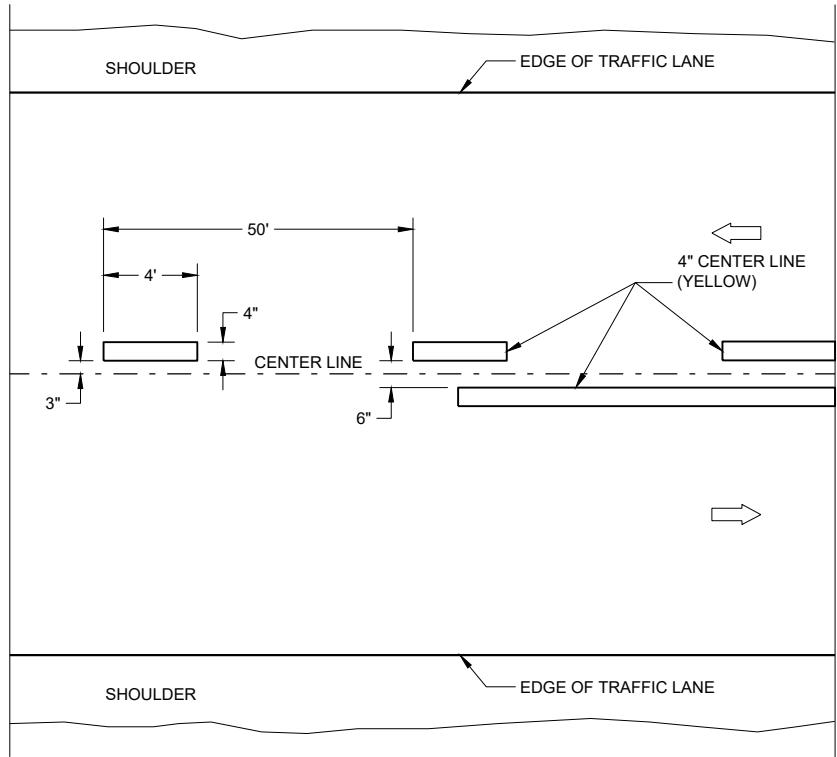

TWO WAY TRAFFIC

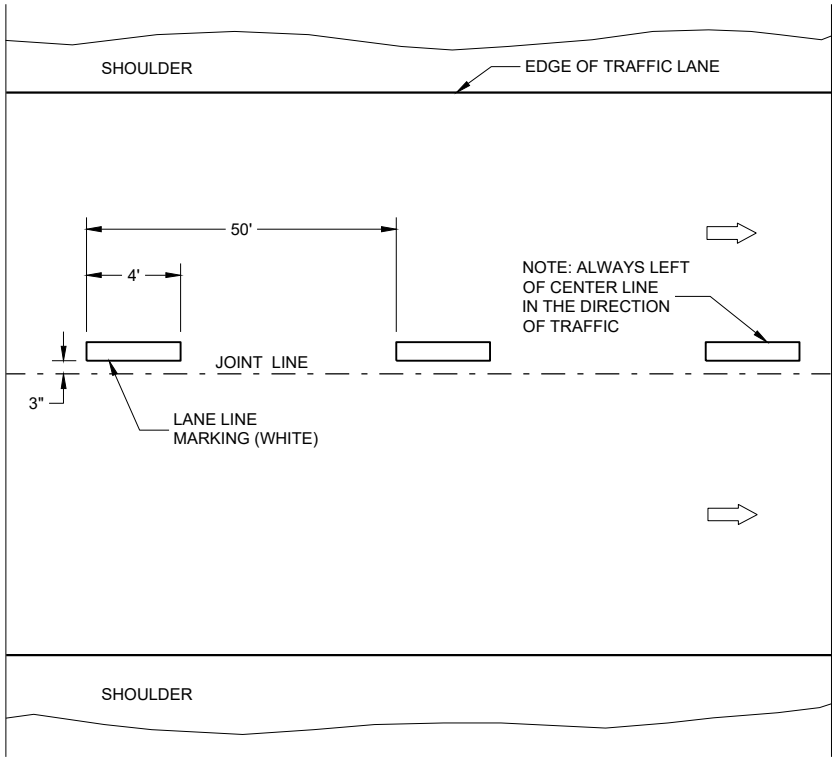

ONE WAY TRAFFIC

TEMPORARY PAVEMENT MARKING

GENERAL NOTES

DETAILS OF CONSTRUCTION NOT SHOWN ON THIS DRAWING SHALL CONFORM TO STANDARD SPECIFICATIONS AND SPECIAL PROVISIONS.

- ① LOCATE THE NO PASSING ZONE W14-3 SIGN WITH 50 FEET OF THE "T" MARKING
- ② MEASURE FROM EDGE OF MARKING TO JOINT LINE. THIS DOES NOT INCLUDE SPACE NEEDED FOR GROOVING OPERATIONS.

LEGEND

- "T" MARKING
- SIGN ON PERMANENT SUPPORT
- DIRECTION OF TRAFFIC

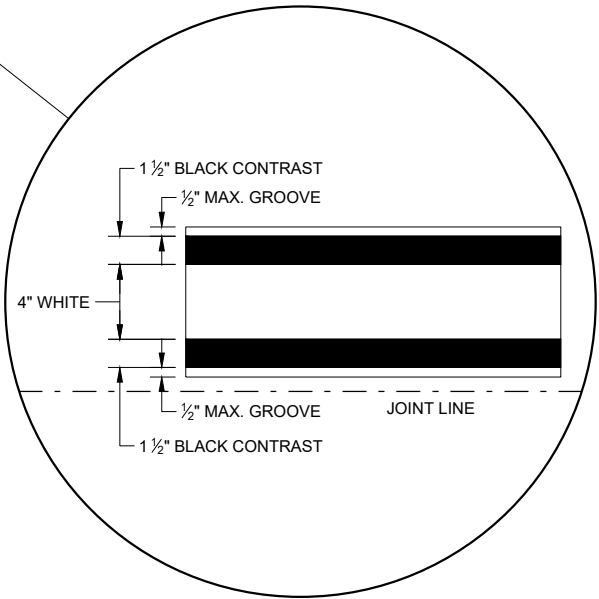

LONGITUDINAL MARKING  
(MAINLINE)

STATE OF WISCONSIN  
DEPARTMENT OF TRANSPORTATION

APPROVED  
February 2020  
DATE  
/S/ Matthew Rauch  
STATEWIDE SIGNING AND MARKING  
ENGINEER  
FHWA

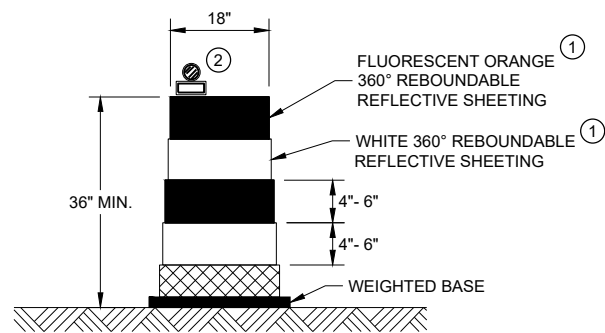

DRUM

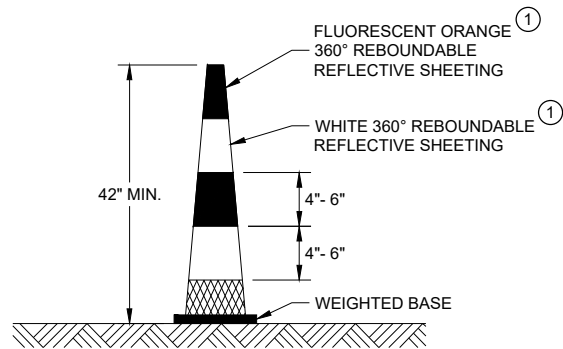

42" CONE

DO NOT USE IN TAPERS  
½ SPACING OF DRUMS

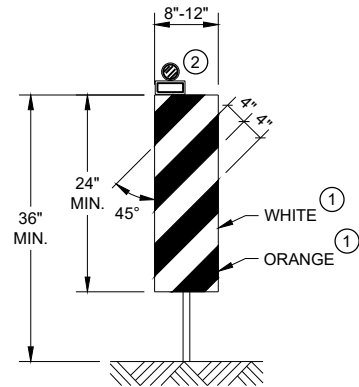

VERTICAL PANEL

THE STRIPES SHALL SLOPE DOWNWARD TO  
THE TRAFFIC SIDE FOR CHANNELIZATION.

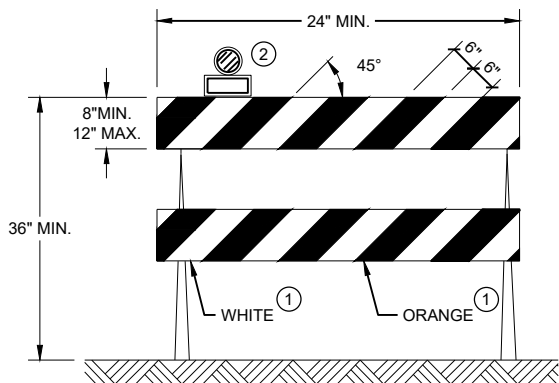

TYPE II BARRICADE

FOR RAILS LESS THAN 36" LONG, 4" WIDE STRIPES  
MAY BE USED. ALL STRIPES SHALL SLOPE DOWNWARD  
TO THE TRAFFIC SIDE FOR CHANNELIZATION.

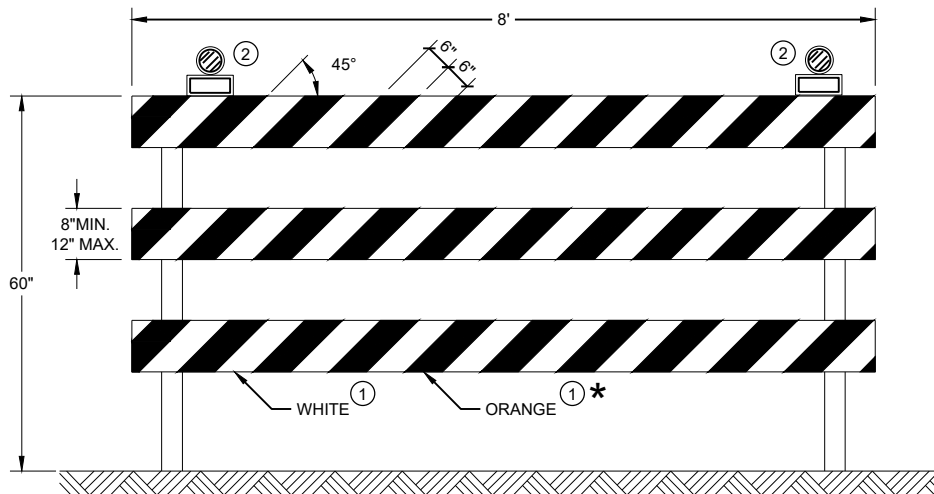

TYPE III BARRICADE

IF SIGN MOUNTED, DO NOT COVER MORE THAN 50% OF THE TOP  
TWO RAILS OR 33% OF THE TOTAL AREA OF THE THREE RAILS.

\* IF USED FOR A PERMANENT APPLICATION USE RED SHEETING.

GENERAL NOTES

- ① REFLECTIVE SHEETING SHALL FOLLOW THE REQUIREMENTS IN THE APPROVED PRODUCTS LISTING FOR SIGN SHEETING.
- ② LOCATION OF WARNING LIGHTS WHEN SHOWN ON THE PLAN.





CHANNELIZING DEVICES  
DRUMS, CONES, BARRICADES  
AND VERTICAL PANELS

STATE OF WISCONSIN  
DEPARTMENT OF TRANSPORTATION

APPROVED  
June 2017 /S/ Andrew Heidtke  
DATE WORK ZONE ENGINEER

FHWA

LEGEND

-  SIGN ON PORTABLE OR PERMANENT SUPPORT
-  TEMPORARY PORTABLE RUMBLE STRIP ARRAY
-  DIRECTION OF TRAFFIC
-  WORK AREA
-  FLAGGER, EQUIPPED WITH STOP/SLOW PADDLE FASTENED ON SUPPORT STAFF

GENERAL NOTES

DETAILS OF TRAFFIC CONTROL DEVICES AND INSTALLATION NOT SHOWN ON THIS DRAWING SHALL CONFORM TO THE PERTINENT REQUIREMENTS OF THE STANDARD SPECIFICATIONS, THE SPECIAL PROVISIONS, AND THE MANUAL ON UNIFORM TRAFFIC CONTROL DEVICES.

ALL SIGNS ARE 48" X 48" UNLESS OTHERWISE NOTED.

"WO" SIGNS ARE THE SAME AS "W" SIGNS EXCEPT THE BACKGROUND IS ORANGE.

THE EXACT NUMBER, LOCATION AND SPACING OF ALL SIGNS, DEVICES, AND LOCATION OF ALL FLAGGERS SHALL BE ADJUSTED TO FIT FIELD CONDITIONS AS APPROVED BY THE ENGINEER.

THE FIRST ADVANCE WARNING SIGN SHOULD TYPICALLY BE LOCATED IN ADVANCE OF THE ANTICIPATED TRAFFIC BACKUP OR QUEUE.

WHEN A SIDE ROAD OR RAMP INTERSECTS THE FACILITY ON WHICH THE WORK IS BEING PERFORMED, ADDITIONAL TRAFFIC CONTROLS SHALL BE PROVIDED AS SPECIFIED IN THE PLANS AND/OR THE SPECIAL PROVISIONS OR AS APPROVED BY THE ENGINEER.

FLAGGING

FLAGGERS SHALL BE IN SIGHT OF EACH OTHER OR IN DIRECT COMMUNICATION AT ALL TIMES. THEY SHALL BE EQUIPPED WITH STOP/SLOW PADDLES FASTENED ON SUPPORT STAFFS. WHEN THE FLAGGING OPERATION IS NOT IN EFFECT REMOVE TEMPORARY PORTABLE RUMBLE STRIPS PRIOR TO COVERING OR REMOVING ALL ADVANCE SIGNING.

① FOR MOVING WORK OPERATIONS, POST ADDITIONAL W20-7A FLAGGER SIGNS AT APPROXIMATELY 3,500' INTERVALS IN THE MOVING WORK OPERATION OR AS APPROVED BY THE ENGINEER.

② SIGN NOT REQUIRED IF FLAGGING OPERATION OCCURS WITHIN A SIGNED ROAD WORK ZONE AREA.

WHEN THE DISTANCE BETWEEN FLAGGERS EXCEEDS 2 MILES, A PILOT CAR IS REQUIRED. WHEN CURVES REDUCE SIGHT DISTANCE BELOW 400', A PILOT CAR IS REQUIRED.

TEMPORARY PORTABLE RUMBLE STRIPS

UTILIZE TEMPORARY PORTABLE RUMBLE STRIPS ON ALL FLAGGING OPERATIONS.

③ EACH TEMPORARY PORTABLE RUMBLE STRIP ARRAY CONSISTS OF THREE RUMBLE STRIPS SPACED ACCORDING TO MANUFACTURER'S RECOMMENDATION, PLACED TRANSVERSE ACROSS THE LANE AT LOCATIONS SHOWN.

ONLY USE TEMPORARY PORTABLE RUMBLE STRIPS FOR THE APPROVED PRODUCTS LIST.

INSTALL TEMPORARY RUMBLE STRIPS PER MANUFACTURER'S RECOMMENDATIONS.

PLACE ADVANCE SIGNING PRIOR TO INSTALLING TEMPORARY RUMBLE STRIPS.

DO NOT INSTALL TEMPORARY PORTABLE RUMBLE STRIPS ON GRAVEL, MILLED SURFACES, OR ASPHALT THAT HAS BEEN PAVED LESS THAN 12 HOURS.

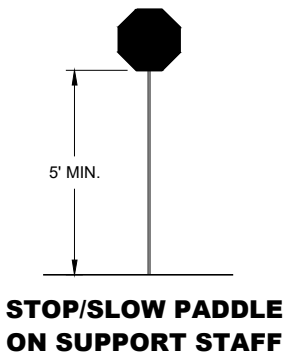

SIGN AND TEMPORARY RUMBLE STRIP ARRAY SPACING TABLE

SPEED LIMIT	SPACING "A"
25-30 MPH	200'
35-40 MPH	350'
45-55 MPH	500'



USE OF W03-4 SIGN IS OPTIONAL. WHEN USED, THIS SIGN SHALL BE LOCATED BETWEEN THE W20-7A AND W20-4A SIGNS, USING SPACING "A".

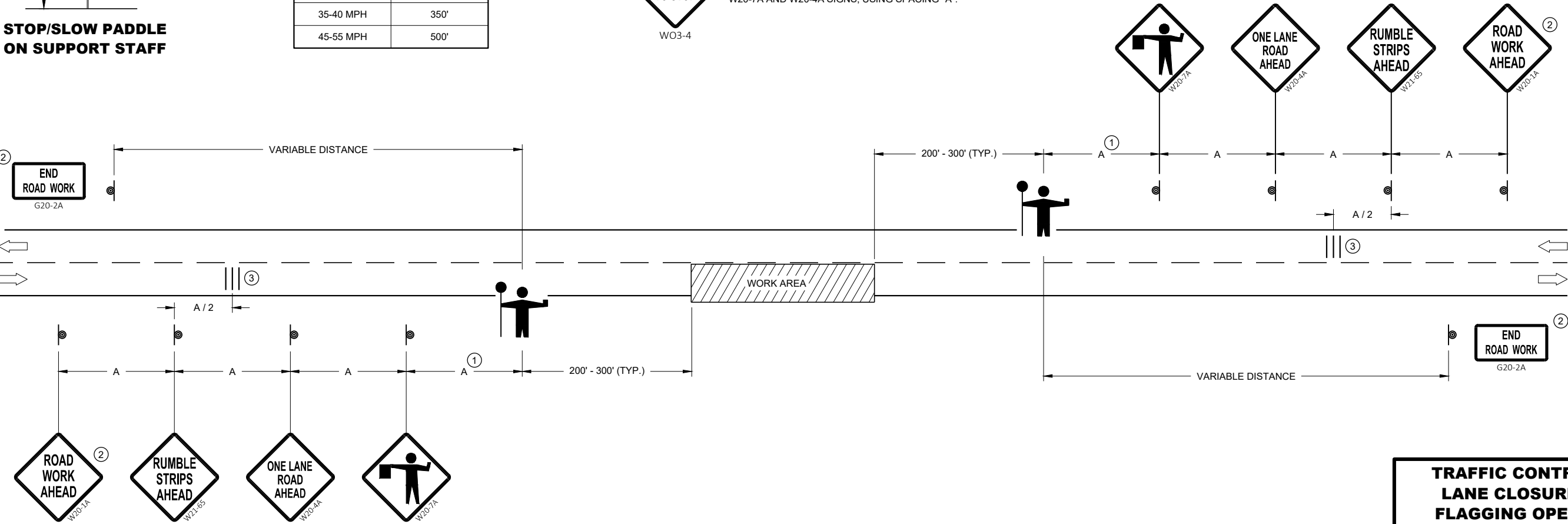

TRAFFIC CONTROL FOR LANE CLOSURE WITH FLAGGING OPERATION

**TRAFFIC CONTROL FOR LANE CLOSURE WITH FLAGGING OPERATION**





STATE OF WISCONSIN  
DEPARTMENT OF TRANSPORTATION

APPROVED  
May 2019 /S/ Andrew Heidtke  
DATE WORK ZONE ENGINEER

FHWA



LEGEND

- V1 LEAD VEHICLE
- V2 MARKING VEHICLE
- V3 SHADOW VEHICLE
-  TRUCK MOUNTED ATTENUATOR (TMA)
-  SIGN ON TEMPORARY SUPPORT
-  DIRECTION OF TRAFFIC
-  FLASHING ARROW PANEL (CAUTION)

GENERAL NOTES

- ALL VEHICLES SHALL BE EQUIPPED WITH TWO 360 DEGREE HIGH INTENSITY YELLOW FLASHING LIGHTS OR STROBE LIGHTS AND OPERATED WITH HEADLIGHTS TURNED ON.
- ALL VEHICLES SHALL BE EQUIPPED WITH REAR FACING TYPE B OR C FLASHING ARROW PANEL OPERATING IN CAUTION MODE. SIGNS PLACED ON VEHICLES MUST NOT OBSCURE THE ARROW PANEL.
- ALL SIGNS ARE 48" X 48" UNLESS OTHERWISE SPECIFIED.
- DISTANCE BETWEEN VEHICLES MAY VARY ACCORDING TO TERRAIN, SIGHT DISTANCE, PAINT DRYING TIME, AND OTHER FACTORS. WHENEVER ADEQUATE STOPPING SIGHT DISTANCE EXISTS TO THE REAR, SHADOW VEHICLES SHOULD MAINTAIN THE MINIMUM DISTANCE FROM THE WORK VEHICLE AND PROCEED AT THE SAME SPEED AS THE WORK VEHICLE. SHADOW VEHICLES SHOULD SLOW DOWN IN ADVANCE OF VERTICAL AND HORIZONTAL CURVES THAT RESTRICT SIGHT DISTANCE.
- THE WORK AND SHADOW VEHICLES SHOULD PULL OVER PERIODICALLY TO ALLOW TRAFFIC TO PASS.

- WHEN NO WORK ACTIVITY IS TAKING PLACE, REMOVE OR LAY STATIONARY SIGNS AND SUPPORTS FLAT ON THE GRADE WITH UPRIGHTS ORIENTED PARALLEL TO AND DOWNSTREAM FROM TRAFFIC.
- CONES SHOULD BE USED BETWEEN THE MARKING AND SHADOW VEHICLE AT 100 FOOT SPACING. CONES MAY BE OMITTED ON PAINTED LINE IF APPROVED BY THE ENGINEER. CONSIDER PAVEMENT MARKING DRY OR CURE TIMES AND TRAFFIC VOLUME.
- CONES SHALL BE A MINIMUM OF 18" FOR WET PAVEMENT MARKING .

- ① SIGNS SHALL BE REPEATED APPROXIMATELY EVERY THREE MILES.
- ② IF CONSTRUCTION WORK ZONE SIGNS ARE IN PLACE, W20-1A OR W21-63 ARE NOT REQUIRED.

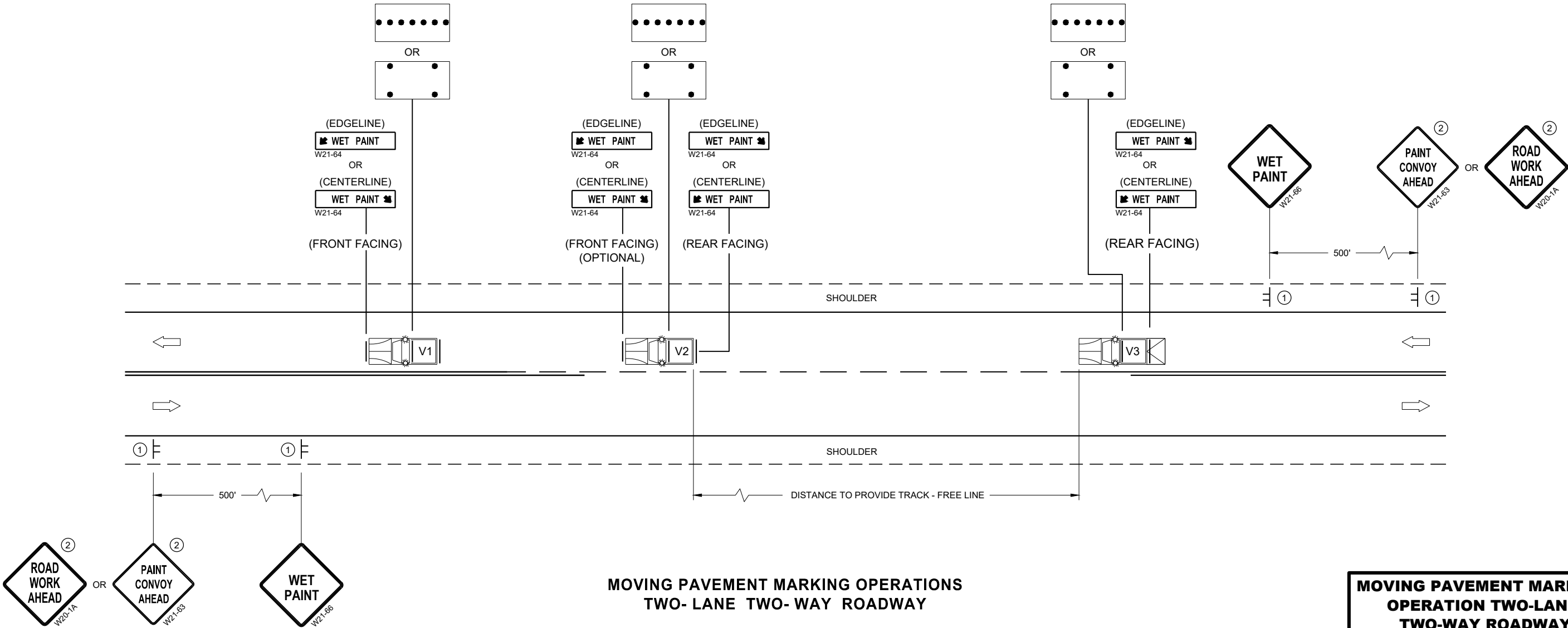





MOVING PAVEMENT MARKING  
OPERATION TWO-LANE  
TWO-WAY ROADWAY

STATE OF WISCONSIN  
DEPARTMENT OF TRANSPORTATION

APPROVED  
November 2019 /S/ Andrew Heidtke  
DATE WORK ZONE ENGINEER  
FHWA

LEGEND

-  SIGN ON PERMANENT SUPPORT
-  TRAFFIC CONTROL DRUM
-  DIRECTION OF TRAFFIC
-  WORK ZONE

GENERAL NOTES

ALL SIGNS ARE 48"X48" UNLESS OTHERWISE NOTED. IF NECESSARY DUE TO SPACE CONSTRAINTS IN URBAN AREAS, 36" X 36" SIGNS MAY BE USED IF APPROVED BY THE REGIONAL TRAFFIC UNIT.

"WO" SIGN IS THE SAME AS "W" SIGN EXCEPT THE BACKGROUND IS ORANGE.

ANY SIGNS TEMPORARY OR EXISTING, WHICH CONFLICT WITH THE TRAFFIC CONTROL "IN USE" SHALL BE REMOVED OR COVERED AS NEEDED AND AS APPROVED BY THE ENGINEER.

THE EXACT NUMBER, LOCATION, AND SPACING OF ALL SIGNS AND DEVICES SHALL BE ADJUSTED TO FIT FIELD CONDITIONS AS APPROVED BY THE ENGINEER.

CHANNELIZING DEVICES PLACED ADJACENT TO WORK AREA SHALL BE PULLED BACK FROM THE TRAVEL LANE WHEN WORK IS NOT IN PROGRESS.

SIGNS THAT WILL BE IN PLACE LESS THAN 7 CONTINUOUS DAYS AND NIGHTS MAY BE MOUNTED ON PORTABLE SUPPORTS.

W20-1A AND G20-2A SIGNS ARE NOT REQUIRED IF THE WORK AREA IS WITHIN A LARGER WORK ZONE WHERE THESE SIGNS ARE ALREADY PRESENT. G20-2A SIGNS MAY ALSO BE OMITTED IF DURATION OF WORK IS LESS THAN 7 CONTINUOUS DAYS AND NIGHTS.

6

6

SDD 15D28 - 04

SDD 15D28 - 04

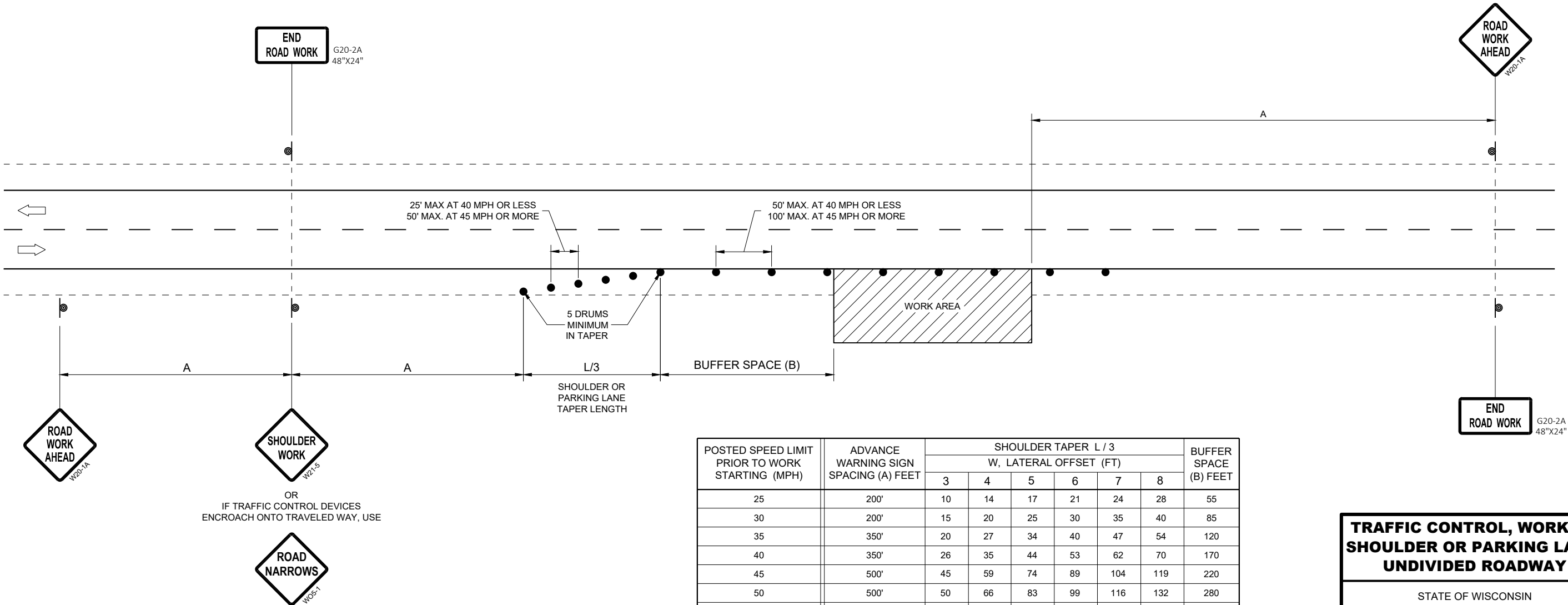

POSTED SPEED LIMIT PRIOR TO WORK STARTING (MPH)	ADVANCE WARNING SIGN SPACING (A) FEET	SHOULDER TAPER L / 3 W, LATERAL OFFSET (FT)						BUFFER SPACE (B) FEET
		3	4	5	6	7	8	
25	200'	10	14	17	21	24	28	55
30	200'	15	20	25	30	35	40	85
35	350'	20	27	34	40	47	54	120
40	350'	26	35	44	53	62	70	170
45	500'	45	59	74	89	104	119	220
50	500'	50	66	83	99	116	132	280
55	500'	54	73	91	109	127	145	335'

TRAFFIC CONTROL, WORK ON  
SHOULDER OR PARKING LANE,  
UNDIVIDED ROADWAY

STATE OF WISCONSIN  
DEPARTMENT OF TRANSPORTATION

APPROVED  
May 2020  
DATE

/S/ Andrew Heidtke  
STATEWIDE WORK ZONE TRAFFIC  
SAFETY ENGINEER

FHWA

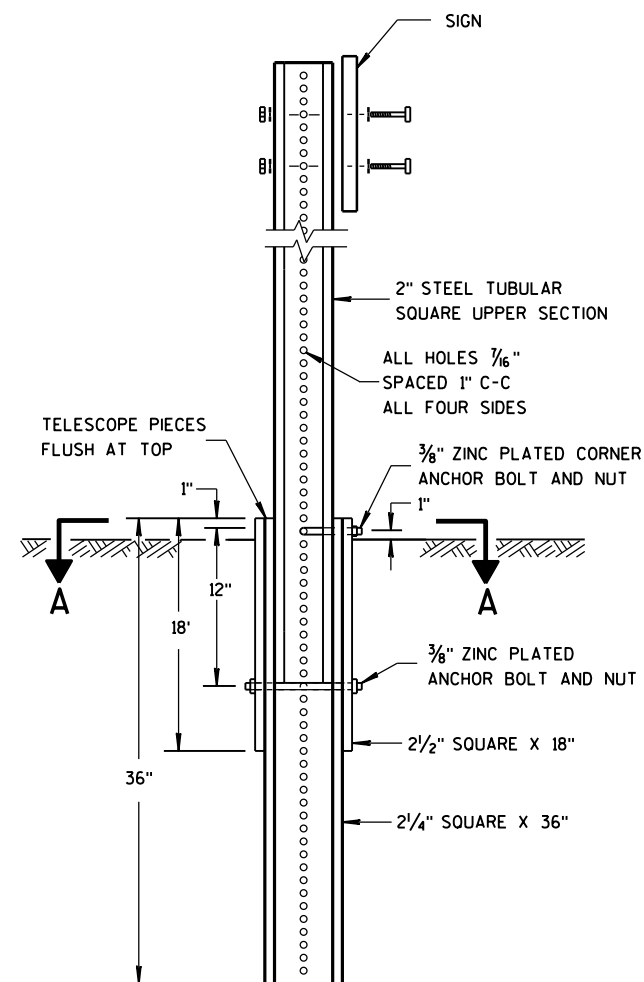

DETAIL OF TUBULAR STEEL SIGN POST

TUBULAR STEEL POSTS

AREA OF SIGN INSTALLATION (SQ. FT.)	NUMBER OF REQUIRED TUBULAR STEEL POSTS
9 OR LESS	1
GREATER THAN 9 LESS THAN OR EQUAL TO 18	2
GREATER THAN 18 LESS THAN OR EQUAL TO 27	3

SIGNS WIDER THAN 3 FEET OR LARGER THAN 9 SQ. FT. SHALL BE MOUNTED ON MULTIPLE POSTS (SEE ABOVE TABLE).  
SIGNS LARGER THAN 27 SQ. FT. SHALL NOT BE MOUNTED ON TUBULAR STEEL POSTS.

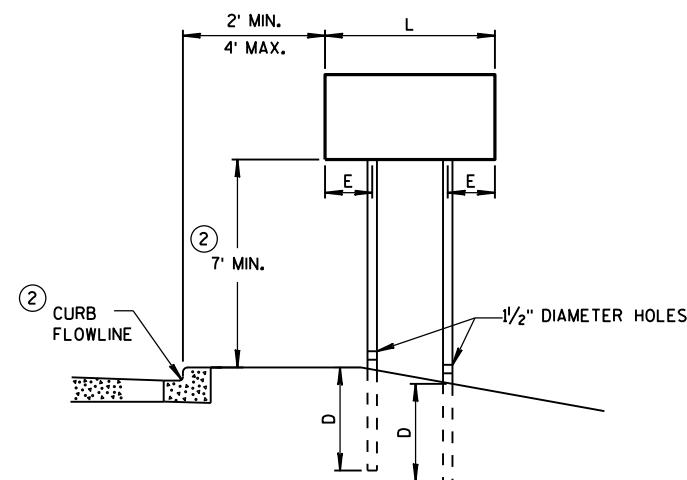
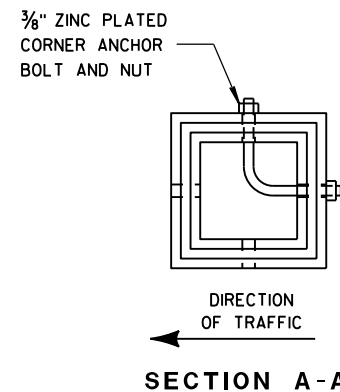

URBAN AREA

POST MOUNTING DETAIL FOR TEMPORARY TRAFFIC CONTROL FIXED MESSAGE SIGNS

WOOD POST EMBEDMENT DEPTH	
AREA OF SIGN INSTALLATION (SQ. FT.)	D (MIN)
20 OR LESS	4'
GREATER THAN 20	5'

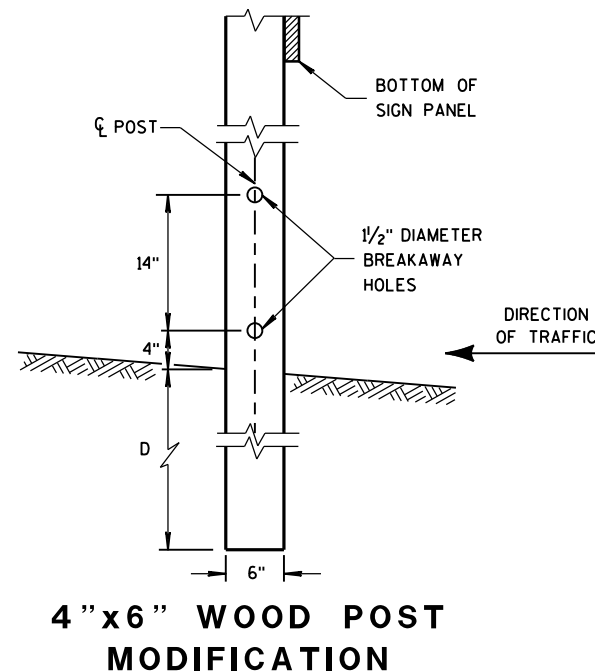

4" x 6" WOOD POST MODIFICATION

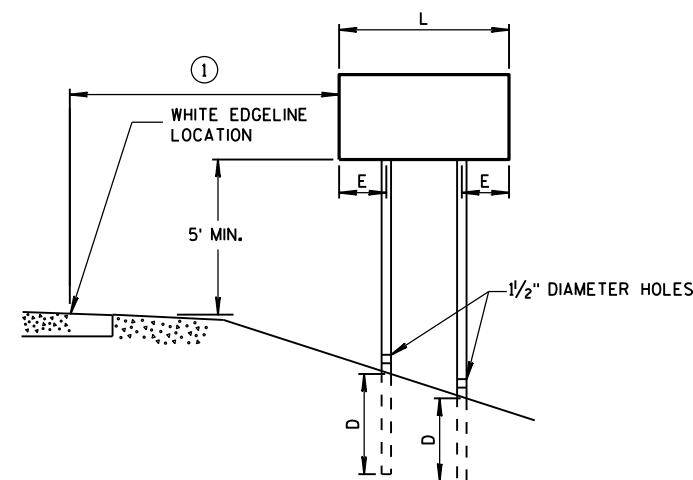

RURAL AREA

POST SPACING REQUIREMENTS		NUMBER OF WOOD POSTS REQUIRED
L	E	
48" OR LESS AND LESS THAN 20 SQ. FT.	-	1
LESS THAN 60"	12"	2
60" TO 120"	L/5	2
GREATER THAN 120" LESS THAN 168"	12"	3
168" AND GREATER	12"	4

SEE NOTE ③

GENERAL NOTES

- ① 6 FEET FROM THE EDGE OF PAVEMENT (EDGE LINE LOCATION) UNLESS OTHERWISE DIRECTED BY THE PROJECT ENGINEER. LATERAL OFFSET SHOULD BE ADJUSTED TO AVOID THE DITCH FLOWLINE.
- ② THE EXISTENCE OF CURB AND GUTTER DOES NOT IN ITSELF MANDATE THE VERTICAL CLEARANCE ILLUSTRATED. THAT HEIGHT IS TYPICALLY MEASURED WHERE THERE IS SIDEWALK ADJACENT TO THE ROADWAY OR PARKING IS PERMITTED. IN THE ABSENCE OF SIDEWALK, VERTICAL CLEARANCE IS MEASURED FROM THE TOP OF THE CURB. IF NO SIDEWALK AND NO PARKING, VERTICAL CLEARANCE MAY BE REDUCED TO 5 FOOT MINIMUM. OFFSET OF SIGNS IS MEASURED FROM THE CURB FLOWLINE.
- ③ FOR SIGNS REQUIRING 4 POSTS, SPACE INTERMEDIATE POSTS EVENLY.

TEMPORARY TRAFFIC CONTROL SIGN MOUNTING

STATE OF WISCONSIN  
DEPARTMENT OF TRANSPORTATION

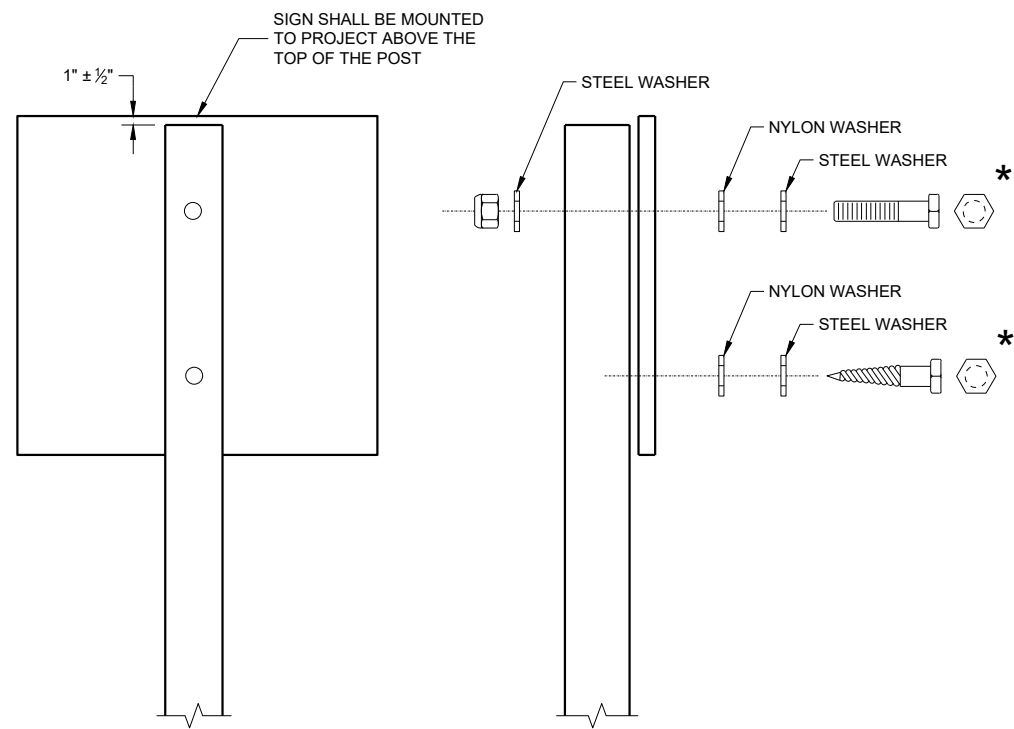

NUTS, BOLTS AND LAGS USED FOR MOUNTING SIGNS  
SHALL HAVE HEXAGONAL HEADS AND SHALL BE EITHER:

- A. HOT DIP GALVANIZED IN ACCORDANCE WITH ASTM  
DESIGNATION: A 153, CLASS D, OR SC 3
- B. ELECTRO-GALVANIZED IN ACCORDANCE WITH ASTM  
DESIGNATION: B 633, TYPE III, SC 3

THREADS ON BOLTS AND NUTS SHALL BE MANUFACTURED WITH  
SUFFICIENT ALLOWANCE FOR THE CADMIUM PLATE OR GALVANIZED  
COATING TO PERMIT THE NUTS TO RUN FREELY ON THE BOLTS.

WOOD POST (4" x 6")  
LAG SCREWS - 3/8" x 3"  
MACHINE BOLTS - 5/16" x 6 1/2" OR 7" LENGTH W/NUTS

SQUARE STEEL POST (2" x 2")  
MACHINE BOLTS - 3/8" x 3 1/4" LENGTH W/NUTS  
RIVETS - 3/32" (6605-9-6) BULB-TITE, TRI-FOLD, ALUMINUM  
BODY/MANDREL O.D. FLANGE 0.720 - 0.765 INCH,  
GRIP RANGE 0.042 - 0.375 INCH

WASHERS (ALL POSTS) -  
1 1/4" O.D. x 3/8" I.D. x 1/16" STEEL  
1 1/4" O.D. x 3/8" I.D. x 0.080 NYLON

\* TWO DIFFERENT FASTENING SYSTEMS ARE SHOWN FOR ILLUSTRATION  
PURPOSES. ON ANY INDIVIDUAL SIGN, EITHER ONE OR THE OTHER SYSTEM  
SHALL BE USED. ACTUAL NUMBER OF FASTENERS PER SIGN VARIES WITH  
THE SIGN AREA. FOR A SINGLE POST INSTALLATION, ALL SIGNS GREATER  
THAN 9 SQ. FT. REQUIRE THE USE OF 3 FASTENERS.

ATTACHMENT OF SIGNS TO POSTS	
STATE OF WISCONSIN DEPARTMENT OF TRANSPORTATION	
APPROVED June 2017 DATE	/S/ Andrew Heidtke WORK ZONE ENGINEER
FHWA	

## Notes



## ***Wisconsin Department of Transportation***

Dedicated people creating transportation solutions  
through innovation and exceptional service.

<http://www.dot.wisconsin.gov>