

LAX
 WITH: PROJECT ID: 1009-12-93
 COUNTY: VARIOUS COUNTIES

JANUARY 2020

ORDER OF SHEETS

Section No.	Title
Section No. 1	Title
Section No. 2	Typical Sections and Details
Section No. 3	Estimate of Quantities
Section No. 3	Miscellaneous Quantities
Section No. 4	Right of Way Plat
Section No. 5	Plan and Profile
Section No. 6	Standard Detail Drawings
Section No. 7	Sign Plates
Section No. 8	Structure Plans
Section No. 9	Computer Earthwork Data
Section No. 9	Cross Sections

TOTAL SHEETS = 26

STATE OF WISCONSIN DEPARTMENT OF TRANSPORTATION

PLAN OF PROPOSED IMPROVEMENT

SW REGION PVMT MARKING EASTERN CTYS

STN LOCATIONS PER ANNUAL PLAN

VAR HWY SW REGION WIDE

STATE PROJECT NUMBER
1009-12-93

STATE PROJECT	FEDERAL PROJECT	
	PROJECT	CONTRACT
1009-12-93	WISC 2020104	1

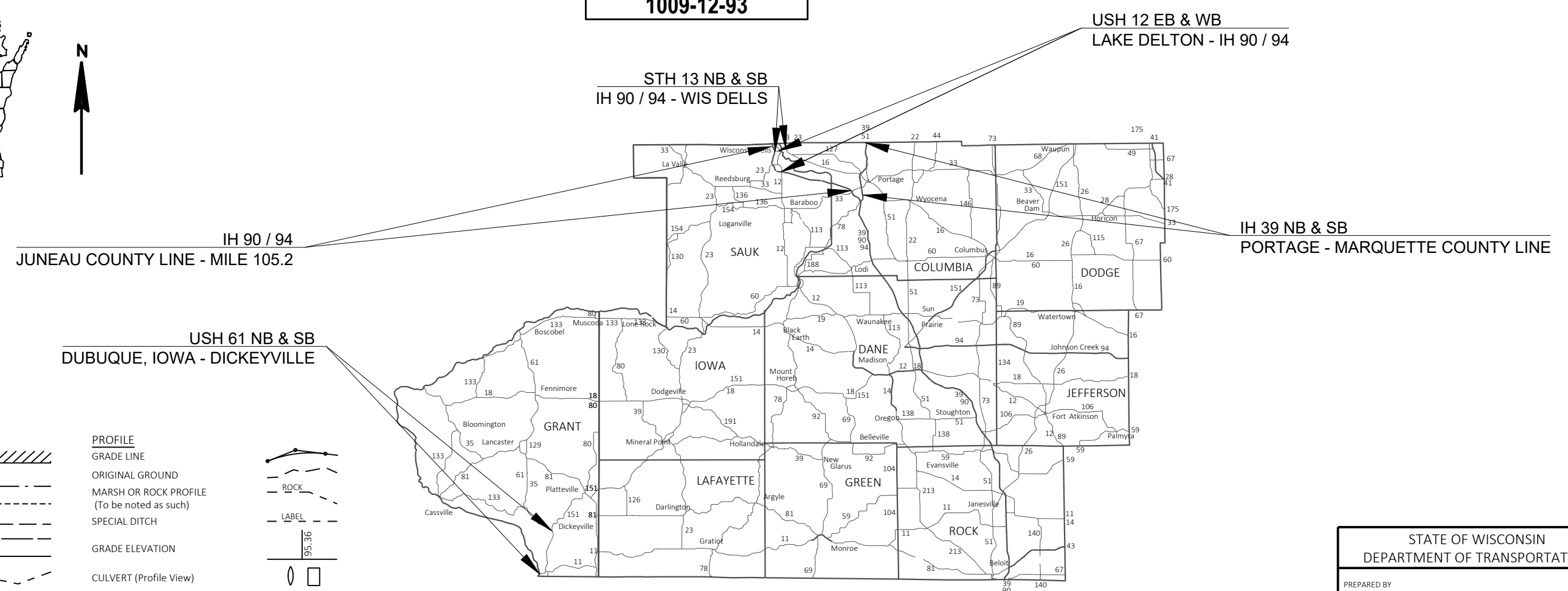
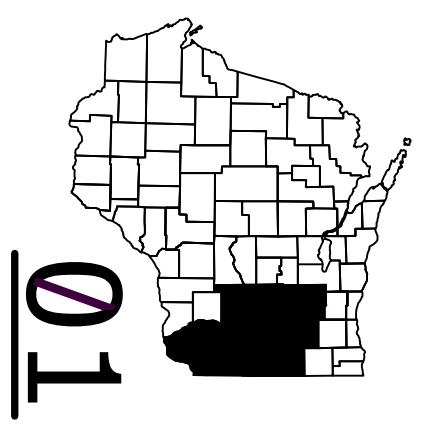

DESIGN DESIGNATION

A.A.D.T.	=
A.A.D.T.	=
D.H.V.	=
D.D.	=
T.	=
DESIGN SPEED	=
ESALS	=

CONVENTIONAL SYMBOLS

PLAN

CORPORATE LIMITS	
PROPERTY LINE	
LOT LINE	
LIMITED HIGHWAY EASEMENT	
EXISTING RIGHT OF WAY	
PROPOSED OR NEW R/W LINE	
SLOPE INTERCEPT	
REFERENCE LINE	
EXISTING CULVERT	
PROPOSED CULVERT (Box or Pipe)	
COMBUSTIBLE FLUIDS	
MARSH AREA	
WOODED OR SHRUB AREA	

PROFILE

GRADE LINE	
ORIGINAL GROUND	
MARSH OR ROCK PROFILE (To be noted as such)	
SPECIAL DITCH	
GRADE ELEVATION	
CULVERT (Profile View)	
UTILITIES	
ELECTRIC	
FIBER OPTIC	
GAS	
SANITARY SEWER	
STORM SEWER	
TELEPHONE	
WATER	
UTILITY PEDESTAL	
POWER POLE	
TELEPHONE POLE	

LAYOUT
 SCALE 0
 TOTAL NET LENGTH OF CENTERLINE =

STATE OF WISCONSIN
 DEPARTMENT OF TRANSPORTATION

PREPARED BY
 Surveyor _____
 Designer IVER PETERSON
 Project Manager _____
 Regional Examiner _____
 Regional Supervisor RICK VYDRZAL

APPROVED FOR THE DEPARTMENT
 DATE: 8/22/19
 (Signature)

GENERAL NOTES

THERE ARE UTILITY FACILITIES WITHIN THE PROJECT AREA THAT ARE NOT SHOWN ON THE PLANS. THE CONTRACTOR SHALL COORDINATE HIS CONSTRUCTION ACTIVITIES WITH A CALL TO DIGGERS HOTLINE AND/OR A DIRECT CALL TO THE UTILITIES THAT HAVE FACILITIES IN THE AREA. NOT ALL UTILITIES ARE MEMBERS OF DIGGERS HOTLINE.

DESIGN CONTACTS

PROJECT MANAGER
IVER R. PETERSON
WISDOT SW REGION
3550 MORMON COULEE ROAD
LA CROSSE, WI 54601
608-785-9060
iver.peterson@dot.wi.gov

PROJECT SUPERVISOR
RICHARD VYDRZAL
WISDOT SW REGION
3550 MORMON COULEE ROAD
LA CROSSE, WI 54601
608-785-9043



Estimate Of Quantities

1009-12-93

Line	Item	Item Description	Unit	Total	Qty
0002	619.1000	Mobilization	EACH	1.000	1.000
0004	643.5000	Traffic Control	EACH	1.000	1.000
0006	646.1020	Marking Line Epoxy 4-Inch	LF	1,105,934.000	1,105,934.000
0008	646.3020	Marking Line Epoxy 8-Inch	LF	43,804.000	43,804.000
0010	646.5020	Marking Arrow Epoxy	EACH	32.000	32.000
0012	646.5120	Marking Word Epoxy	EACH	21.000	21.000
0014	646.5320	Marking Railroad Crossings Epoxy	EACH	75.000	75.000
0016	646.5420	Marking Aerial Enforcement Bar Epoxy	EACH	100.000	100.000
0018	646.6120	Marking Stop Line Epoxy 18-Inch	LF	1,217.000	1,217.000
0020	646.7420	Marking Crosswalk Epoxy Transverse Line 6-Inch	LF	2,661.000	2,661.000
0022	SPV.0090	Special 01. Marking Line Epoxy 6-Inch	LF	12,659.000	12,659.000

3

3

PAVEMENT MARKING EPOXY (DIVIDED HIGHWAYS)

GRANT COUNTY (DUBUQUE, IOWA - DICKEYVILLE)

HIGHWAY	LOCATION (From)	LOCATION (To)	646.1020				646.3020			646.6120
			4-INCH EDGELINE YELLOW L.F.	4-INCH LANELINE WHITE L.F.	4-INCH MINI DASHES WHITE L.F.	4-INCH EDGELINE WHITE L.F.	8-INCH CHANNELIZING WHITE (MAINLINE) L.F.	8-INCH CHANNELIZING WHITE (RAMP) L.F.	8-INCH CHANNELIZING WHITE (ISLAND GORE) L.F.	18-INCH STOP LINE WHITE L.F.
USH 61 NB	East end of the Mississippi River Bridge (Dubuque, Iowa)	0.25 Miles South of USH 151 & CTH HH (Dickeyville)	38418	9982		34125				
	Exit 1 at STH 11 & 35	Off Ramp	725		154	2175	241	241		29
	Exit 1 at STH 11 & 35	On Ramp	1094			2672	643	643	602	
	Exit 2 at Badger Rd & Eagle Point Rd	Off Ramp to Badger Rd & Eagle Point Rd	752		121	1433	404	404	100	46
	Exit 3 at Eagle Point Rd	On Ramp from Eagle Point Rd					177	177		
	Frontage Lane	Left Turn Lane					114			
	Kaiser Lane	Right Turn Lane					133			
	Old Highway Rd (South Junction)	Left Turn Lane					124			
	Jimtown Rd	Right Turn Lane					120			
	Exit 5 at CTH HHH (Kieler)	Off Ramp to CTH HHH (Kieler)	840		147	1714	239	239		24
	Exit 5 at CTH H (Kieler)	On Ramp from CTH H (Kieler)	997			2431	681	681		
	West Ave	Left Turn Lane					143			
	Old Highway Rd (North Junction)	Right Turn Lane					134			
	USH 61 SB	0.25 Miles South of USH 151 & CTH HH (Dickeyville)	East end of the Mississippi River Bridge (Dubuque)	39109	9930		30360			
Old Highway Rd (North Junction)		Left Turn Lane					129			
West Ave		Right Turn Lane					133			
Exit 5 at CTH H (Kieler)		Off ramp to CTH H (Kieler)	857		160	1863	352	352		30
Exit 5 at CTH HHH (Kieler)		On Ramp from CTH HHH (Kieler)	884			2344	628	628		
Jimtown Rd		Left Turn Lane					141			
Old Highway Rd (South Junction)		Right Turn Lane					123			
Kaiser Lane		Left Turn Lane					106			
Frontage Lane		Left Turn Lane					50			
Frontage Lane		Right Turn Lane					126			
Exit 3 at Eagle Point Rd		Off Ramp to Eagle Point Rd	1722		150	2584	219	219		
Exit 3 On Ramp From Eagle Point Rd		On Ramp from Eagle Point Rd	1722			2584	355	355		
Exit 2 On Ramp From Badger Rd		On Ramp from Badger Rd	958			2380	760	760		
Exit 1 Off Ramp To STH 11 & 35 & Rest Area		Off Ramp to STH 11/35 & Rest Area	1148		160	2043	233	233		26
STH 11 & Rest Area								100		
Exit 1 at STH 11 & 35	On Ramp from STH 11/35	1243			2429	507	507			
Rest Area	Entrance	1806			1580					
Rest Area Cars and Trucks Split Gore								117		
Rest Area Cars and Trucks Merge Gore								50		
Rest Area to STH 11 EB and USH 61 SB On Ramp	Island Gore							77		
Rest Area (Leaving)	Stop Line to STH 11 EB								20	
Rest Area (Leaving)	Stop Line to USH 61 SB On Ramp								23	
Sub Totals			92275	19912	892	92717	7015	5439	1046	198

PAVEMENT MARKING EPOXY (INTERSTATE LOCATIONS)

COLUMBIA COUNTY (PORTAGE AREA)

HIGHWAY	LOCATION (From)	LOCATION (To)	646.1020				646.3020		
			4-INCH EDGE LINE YELLOW L.F.	4-INCH LANE LINE WHITE L.F.	4-INCH MINI DASHES WHITE L.F.	4-INCH EDGE LINE WHITE L.F.	8-INCH CHANNELIZING WHITE (MAINLINE) L.F.	8-INCH CHANNELIZING WHITE (RAMP) L.F.	8-INCH CHANNELIZING WHITE (ISLAND GORE) L.F.
IH 39 NB	1750' South of Cascade Mountain Rd	1103' North of mile marker 96 (Marquette Co Line)	58686	14672		48496			
	Exit 85 at Cascade Mountain Rd	OFF Ramp	583		148	1385	145	145	105
	Exit 85 at Cascade Mountain Rd	ON Ramp	646			2090	580	580	
	Exit 87 at STH 33	OFF Ramp	1165		134	2102	175	175	350
	Exit 87 at STH 33	ON Ramp	1034			2872	627	627	175
	Exit 89 at STH 16	OFF Ramp	887		138	1955	209	361	
	Exit 89 at STH 16	ON Ramp	1052			2597	605	605	184
	Exit 92 at USH 51	OFF Ramp	595	1367	135		205	205	
	Exit 92 at USH 51	ON Ramp	1050	250		2893	540	674	
IH 39 SB	1103' North of mile marker 96 (Marquette Co Line)	1750' South of Cascade Mountain Rd	58074	14519		50104			
	Exit 92 at USH 51	OFF Ramp	1709		45	2263	366	366	
	Exit 92 at USH 51	ON Ramp	861			2206	662	662	
	Exit 89 at STH 16	OFF Ramp	1129		229	2759	180	180	184
	Exit 89 at STH 16	ON Ramp	1069			2546	414	414	220
	Exit 87 at STH 33	OFF Ramp	1179		142	2345	184	184	100
	Exit 87 at STH 33	ON Ramp	1137			3007	520	520	200
	Exit 85 at Cascade Mountain Rd	OFF Ramp	410		84	1092	191	309	105
	Exit 85 at Cascade Mountain Rd	ON Ramp	617			1468	483	483	
Sub Totals			131883	30808	1055	132180	6086	6490	1623

PAVEMENT MARKING EPOXY (INTERSTATE LOCATIONS)

SAUK & COLUMBIA COUNTIES (WIS DELLS AREA)

HIGHWAY	LOCATION (From)	LOCATION (To)	646.1020				646.3020			
			4-INCH EDGE LINE YELLOW L.F.	4-INCH LANE LINE WHITE L.F.	4-INCH MINI DASHES WHITE L.F.	4-INCH EDGE LINE WHITE L.F.	8-INCH CHANNELIZING WHITE (MAINLINE) L.F.	8-INCH CHANNELIZING WHITE (RAMP) L.F.	8-INCH CHANNELIZING WHITE (ISLAND GORE) L.F.	8-INCH CHANNELIZING WHITE (MINI DASHES) L.F.
IH 90/94 EB	Mile Marker 86.5 (Juneau County Line)	Mile Marker 105.2 (North of Exit 106)	100648	25363		94253				
	Exit 87 at STH 13 (Wis Dells)	OFF Ramp	1962			3251	455	275	137	
	Exit 87 at STH 13 (Wis Dells)	ON Ramp	2405	1900		3644	393	393		
	Exit 89 at STH 23 (Wis Dells)	OFF Ramp	925		45	1320	229	229	350	
	Exit 89 at STH 23 (Wis Dells)	ON Ramp	1150			2025	452	452		
	Exit 92 at USH 12 (Wis Dells)	OFF Ramp	2254		124	3419	210	210	468	
IH 90/94 WB	Exit 92 at USH 12 (Wis Dells)	ON Ramp (USH 12 EB to IH 90/94 EB)	1273			1875	163	163	547	
	Exit 92 at USH 12 (Wis Dells)	ON Ramp (USH 12 WB to IH 90/94 EB)	911		88	3446	496	150		
	Mile Marker 105.2 (North of Exit 106)	Juneau Co Line	100589	25349		92545				
	Exit 92 at USH 12 (Wis Dells)	OFF Ramp	1955		126	3235	226	226	300	
	Exit 92 at USH 12 (Wis Dells)	ON Ramp (USH 12 EB to IH 90/94 WB)	1015		66	3576	435	435		
	Exit 92 at USH 12 (Wis Dells)	ON Ramp (USH 12 WB to IH 90/94 WB)	1282			2507			507	
	Exit 89 at STH 23 (Wis Dells)	OFF Ramp	1004			1712	279	279	534	
	Exit 89 at STH 23 (Wis Dells)	ON Ramp	1086			2471	671	671		
Exit 87 at STH 13 (Wis Dells)	OFF Ramp	1027		102	2432	286	286	53		
	ON Ramp	705			2874	630	300	85		
Sub Totals			220191	52612	551	224585	4925	4069	1652	1329

PROJECT NO: 1009-12-93

HWY: IH 39 & IH 90/94

COUNTY: COLUMBIA & SAUK

MISCELLANEOUS QUANTITIES

SHEET NO:

E

FILE NAME :

PLOT DATE :

PLOT BY :

PLOT NAME :

ORG DATE :

ORIGINATOR : DIST _

PLOT SCALE : 1:1

3

PAVEMENT MARKING EPOXY (DIVIDED HIGHWAYS)			646.1020				SPV.0090.01		646.3020		
SAUK & COLUMBIA COUNTIES (WIS DELLS)			4-INCH EDGE LINE YELLOW L.F.	4-INCH CENTERLINE NO PASSING YELLOW L.F.	4-INCH LANE LINE WHITE L.F.	4-INCH EDGE LINE WHITE L.F.	6-INCH MINI DASHES WHITE L.F.	6-INCH EDGE LINE WHITE L.F.	8-INCH CHANNELIZING WHITE (MAINLINE) L.F.	8-INCH CHANNELIZING WHITE (ISLAND GORE) L.F.	8-INCH CHANNELIZING WHITE (MINI DASHES) L.F.
HIGHWAY	LOCATION (From)	LOCATION (To)									
SAUK COUNTY (WIS DELLS)											
STH 13 NB	Interstate 90 - 94 EB Exit Gore	Sauk/Columbia County Line	4303		1426	4351	227	2132	205		
STH 13 NB	S Frontage Rd										
STH 13 NB	S Frontage Rd									85	
STH 13 NB	CTH H Left Turn Lane									130	
STH 13 NB	Trout Rd Right Turn Island									37	
COLUMBIA COUNTY (WIS DELLS)											
STH 13 SB	Sauk/Columbia County Line	Interstate 90 - 94 EB On Ramp Gore	5872		1891	5447	148	2150			
STH 13 SB	CTH H Right Turn Lane	Paul Bunyan's Cook Shanty Through Lanes Right Turn Lane							293		
STH 13 SB	Trout Rd Left Turn Island									188	
STH 13 SB	Commercial Entrance								101		104
STH 13 SB	USH 12, STH 16 and STH 23								478		
STH 13 SB	USH 12, STH 16 and STH 23								55	137	55
STH 13 NB & SB	Sauk/Columbia County Line	STH 16/23 East of Wis Dells	1530	9266	2564	2522		8002	364		
Sub Totals			11705	9266	5881	12320	375	12284	1496	577	159

3

PAVEMENT MARKING EPOXY (DIVIDED HIGHWAYS)			646.1020				646.3020		
SAUK COUNTY (WIS DELLS - LAKE DELTON)			4-INCH EDGE LINE YELLOW L.F.	4-INCH CENTERLINE YELLOW L.F.	4-INCH LANE LINE WHITE L.F.	4-INCH EDGE LINE WHITE L.F.	8-INCH CHANNELIZING WHITE (MAINLINE) L.F.	8-INCH CHANNELIZING WHITE (ISLAND GORE) L.F.	8-INCH CHANNELIZING WHITE (MINI DASHES) L.F.
HIGHWAY	LOCATION (From)	LOCATION (To)							
USH 12 EB	STH 13, Wisconsin Dells	Gasser Rd, Lake Delton	9192	24075	3577	7812			
USH 12 EB	STH 13 (Left Turn Lane)							367	
USH 12 EB	STH 13 (Right Turn Lane)							110	
USH 12 EB	STH 13 (Through Lanes)							124	24
USH 12 EB	Parking Lot (Left Turn Lane)		Timbavati Wildlife Park					91	
USH 12 EB	Commercial Entrance (Left Turn Lane)							46	
USH 12 EB	CTH A							51	
USH 12 WB	Gasser Rd, Lake Delton	STH 13, Wisconsin Dells	9228	1786	3577	7854			
USH 12 WB	CTH A	Mc Donalds						98	
USH 12 WB	Commercial Entrance (Left Turn Lane)						157		
USH 12 WB	STH 13 (Right Turn Lane)						335	108	
USH 12 WB	STH 13 (Through Lanes)						170		
USH 12 WB	STH 13 (Left Turn Lane)						217		
Sub Totals			18420	25861	7154	15666	1067	807	24

PROJECT NO: 1009-12-93

HWY: STH 13 & USH 12

COUNTY: SAUK & COLUMBIA

MISCELLANEOUS QUANTITIES

SHEET NO:

E

FILE NAME :

PLOT DATE :

PLOT BY :

PLOT NAME :

ORG DATE :

ORIGINATOR : DIST _

PLOT SCALE : 1:1

PAVEMENT MARKING EPOXY (SPECIAL MARKINGS)

COLUMBIA & IOWA COUNTIES

HIGHWAY	LOCATION (AT)	LOCATION (DIRECTION)	646.5020			646.5120	646.6120	646.7420
			ARROWS TYPE 1 WHITE EACH	ARROWS TYPE 2 WHITE EACH	ARROWS TYPE 3 WHITE EACH	WORDS "ONLY" WHITE EACH	18-INCH STOP LINE WHITE L.F.	6-INCH CROSSWALK WHITE L.F.
COLUMBIA COUNTY (WIS DELLS)								
STH 13 NB	Superior St/River Rd - Wis Dells	Northbound		1		1	38	142
STH 13 SB	Superior St/River Rd - Wis Dells	Southbound		1		1	38	146
Superior St	STH 13 - Wis Dells	Westbound					24	98
River Rd	STH 13 - Wis Dells	Eastbound					27	108
STH 13 NB	Oak St - Wis Dells	Northbound					28	111
STH 13 SB	Oak St - Wis Dells	Southbound					26	121
Oak St	STH 13 - Wis Dells	Westbound					26	92
STH 13 NB	Vine St - Wis Dells	Northbound					26	107
STH 13 SB	Vine St - Wis Dells	Southbound					28	107
Vine St	STH 13 - Wis Dells	Westbound					24	87
Vine St	STH 13 - Wis Dells	Eastbound					15	73
STH 13 NB	STH 16/23 Wis Dells	Northbound (Ahead/Left Turn)		2	1	1	24	
STH 13 NB	STH 16/23 Wis Dells	Right Turn Lane						48
STH 13 NB	STH 16/23 Wis Dells	Northbound from STH 13/16/23						70
STH 13 SB	STH 16/23 Wis Dells	Southbound (Ahead/Left Turn)		1		1	33	76
STH 13 SB	STH 16/23 Wis Dells	Right Turn Lane		1		1	24	48
STH 23 WB	STH 13/16 Wis Dells	Westbound					20	
STH 16 WB	STH 13/23 Wis Dells	Westbound (Ahead/Left Turn)		2		2	57	148
STH 16 EB	STH 13/23 Wis Dells	Eastbound from STH 13/23						71
IOWA COUNTY (DODGEVILLE)								
USH 18 EB	STH 23	Eastbound (Ahead & Turn Lanes)					50	102
USH 18 EB	STH 23 (Replace according to new standards)	Eastbound (Left Turn Lane)		2		1		
USH 18 EB	STH 23 (Replace according to new standards)	Eastbound (Right Turn Lane)		2		1		
USH 18 EB	STH 23	Eastbound (Far Side of Intersection)						64
USH 18 WB	STH 23	Westbound (Ahead & Turn Lanes)					53	116
USH 18 WB	STH 23 (Replace according to new standards)	Westbound (Left Turn Lane)		2				
USH 18 WB	STH 23 (Replace according to new standards)	Westbound (Right Turn Lane)		2		1		
USH 18 WB	STH 23	Westbound (Far Side of Intersection)						98
STH 23 NB	USH 18	Northbound (Ahead/Left Turn)					36	76
STH 23 NB	USH 18	Northbound (Left Turn Lane)		2				
STH 23 NB	USH 18	Northbound (Right Turn Lane)		1		1	22	
STH 23 NB	USH 18	Northbound (Far Side of Intersection)						100
STH 23 SB	USH 18	Southbound (Ahead & Turn Lanes)					45	112
STH 23 SB	USH 18	Southbound (Left Turn Lane)		2		1		
STH 23 SB	USH 18	Southbound (Far Side of Intersection)						100
STH 23 NB	CTH YZ	Northbound					24	
STH 23 SB	CTH YZ	Southbound					24	
CTH YZ EB	STH 23	Eastbound					50	
CTH YZ WB	STH 23	Westbound					60	
USH 18 WB	N Johns St - Dodgeville	Westbound		3		3	50	240
USH 18 EB	N Johns St - Dodgeville	Eastbound		2		2	60	
N Johns St	USH 18 - Dodgeville	Northbound	1	2		2	45	
N Johns St	USH 18 - Dodgeville	Southbound		1		1	42	
USH 18 WB	Lisa St - Dodgeville	Westbound		1		1		
Sub Totals			1	30	1	21	1019	2661

PROJECT NO: 1009-12-93

HWY: VARIOUS

COUNTY: COLUMBIA & IOWA

MISCELLANEOUS QUANTITIES

SHEET NO:

E

FILE NAME :

PLOT DATE :

PLOT BY :

PLOT NAME :

ORG DATE :

ORIGINATOR : DIST _

PLOT SCALE : 1:1

3

PAVEMENT MARKING EPOXY (SPECIAL MARKINGS)		646.5320
HIGHWAY	LOCATION	RAILROAD CROSSINGS WHITE EACH
COLUMBIA COUNTY		
USH 51 NB	North of STH 16 (South of Portage)	2
USH 51 SB	North of STH 16 (South of Portage)	1
USH 51 NB	CTH P Portage	2
USH 51 SB	CTH P Portage	2
STH 60 EB	West of Commercial St (Arlington)	1
STH 60WB	East of Commercial St (Arlington)	1
STH 113 SB	County Line Rd (South of Lodi) (See Dane Co for NB)	1
STH 146 NB	North of Cabbage Rd (Cambria)	1
STH 146 SB	South of Commerce St (Cambria)	1
DANE COUNTY		
USH 12 WB	Exit 252 Geenway Blvd Off Ramp (Madison) (Type 4 Arrow)	
STH 19 EB	CTH CV (Windsor)	2
STH 19 WB	CTH CV (Windsor)	2
USH 51 NB	Lexington Ave (Madison)	3
USH 51 SB	Lexington Ave (Madison)	3
STH 73 NB	North of Freidel Dr (Marshall)	1
STH 73 SB	North of Freidel Dr (Marshall)	1
STH 78 NB	South of Webb St (Black Earth)	1
STH 78 SB	North of Webb St (Black Earth)	1
STH 113 NB	South of Verleen St (Waunakee)	1
STH 113 SB	North of Verleen St (Waunakee)	1
STH 113 NB	Dane St. (Dane)	1
STH 113 SB	Railroad St (Dane)	1
STH 113 NB	County Line Rd (South of Lodi) (See Columbia Co for SB)	1
DODGE COUNTY		
STH 26 NB	South of Maple Dr (Minnesota Jct)	1
STH 26 SB	North of Maple Dr (Minnesota Jct)	1
STH 26 NB	CTH BI (Burnette)	1
STH 26 SB	CTH BI (Burnette)	1
STH 49 NB	Old 41 Rd. (East of Lomira)	1
STH 49 SB	Old 41 Rd. (East of Lomira)	1
STH 67 NB	CTH O (Ashippun)	1
STH 67 SB	CTH O (Ashippun)	1
Sub Total		39

PAVEMENT MARKING EPOXY (SPECIAL MARKINGS)		646.5320
HIGHWAY	LOCATION	RAILROAD CROSSINGS WHITE EACH
DODGE COUNTY (cont)		
STH 67 NB	Downer Rd (Iron Ridge)	1
STH 67 SB	Downer Rd (Iron Ridge)	1
STH 67 NB	North of STH 33	1
STH 67 SB	North of STH 33	1
STH 73 NB	North of Center St (Randolph)	1
STH 73 SB	North of Stark St (Randolph)	1
USH 151 NB	South of CTH E (Beaver Dam)	2
USH 151 SB	North of CTH E (Beaver Dam)	2
USH 151 NB	3000' South of STH 26 (Waupun)	2
USH 151 SB	4000' South of STH 26 (Waupun)	2
GREEN COUNTY		
STH 11 EB	West of CTH KS (East of Juda)	1
STH 11 WB	East of CTH KS (East of Juda)	1
Jefferson County		
STH 89 NB	South of Hunters Ln (South of Waterloo)	1
STH 89 SB	North of Hunters Ln (South of Waterloo)	1
ROCK COUNTY		
STH 11 EB	CTH D (Janesville)	2
STH 11 WB	CTH D (Janesville)	2
STH 11 EB	West of Hanover Rd (Janesville)	1
STH 11 WB	West of Hanover Rd (Janesville)	1
USH 14 EB	Newville Rd (Janesville)	2
USH 14 WB	Newville Rd (Janesville)	2
STH 140 NB	South of Avalon Rd (Avalon)	1
STH 140 SB	North of Avalon Rd (Avalon)	1
STH 140 NB	Front St (Clinton)	1
STH 140 SB	Front St (Clinton)	1
STH 140 NB	Southside of Clinton	1
STH 140 SB	Southsde of Clinton	1
STH 213 NB	Spring St (Orfordville)	1
STH 213 SB	Spring St (Orfordville)	1
Sub Total		36

3

SUMMARY OF RAILROAD CROSSING (SPECIAL MARKING)		646.5320
HIGHWAY	COUNTY	RAILROAD CROSSINGS WHITE EACH
VARIOUS	COLUMBIA, DANE & DODGE COUNTIES	39
VARIOUS	DODGE (CONT), GREEN, JEFFERSON & ROCK COUNTIES	36
TOTAL		75

PROJECT NO: 1009-12-93

HWY: VARIOUS

COUNTY: VARIOUS

MISCELLANEOUS QUANTITIES

SHEET NO:

E

FILE NAME :

PLOT DATE :

PLOT BY :

PLOT NAME :

ORG DATE :

ORIGINATOR : DIST _

PLOT SCALE : 1:1

3

3

PAVEMENT MARKING EPOXY (SPECIAL MARKINGS)			646.5420
COLUMBIA, DANE, DODGE, GREEN, JEFFERSON & SAUK COUNTIES			AERIAL ENFORCEMENT BARS 24-INCH WHITE EACH
HIGHWAY	LOCATION (AT)	LOCATION	
	COLUMBIA COUNTY		
IH 39/90/94 NB	Mile Post 122 CTH K		10
IH 39/90/94 SB	Mile Post 122 CTH K		10
	DANE COUNTY		
USH 151 NB	South of CTH V	New install	10
	DODGE COUNTY		
USH 151 NB	Between East Salem Rd and Forest Rd		10
USH 151 SB	Between East Salem Rd and Forest Rd		10
	GREEN COUNTY		
STH 11 WB	CTH KK (West of the intersection) East of Monroe	New install	10
STH 11 EB	STH 59 (East of the STH 59 overpass) East of Monroe	New install	10
	JEFFERSON COUNTY		
IH 94 WB	Between mile post 277-278 west of Willow Glen Rd		10
	SAUK COUNTY		
IH 90 EB	Mile Marker 88.5 - 89.0	West of STH 23	10
IH 90 WB	Mile Marker 88.5 - 89.0	West of STH 23	10
TOTAL			100

PAVEMENT MARKING SUMMARY (LONG LINE)

HIGHWAY	COUNTY (LOCATION)	646.1020					SPV.0090.01		646.3020				
		4-INCH EDGELINE YELLOW L.F.	4-INCH CENTERLINE NO PASSING YELLOW L.F.	4-INCH LANELINE WHITE L.F.	4-INCH MINI DASHES WHITE L.F.	4-INCH EDGELINE WHITE L.F.	6-INCH MINI DASHES WHITE L.F.	6-INCH EDGELINE WHITE L.F.	8-INCH CHANNELIZING WHITE (MAINLINE) L.F.	8-INCH CHANNELIZING WHITE (RAMP) L.F.	8-INCH CHANNELIZING WHITE (ISLAND GORE) L.F.	8-INCH CHANNELIZING WHITE (MINI DASHES) L.F.	
USH 61 NB & SB	GRANT COUNTY (DUBUQUE, IOWA - DICKEYVILLE)	92275		19912	892	92717			7015	5439	1046		
IH 39 NB & SB	COLUMBIA COUNTY (PORTAGE AREA)	131883		30808	1055	132180			6086	6490	1623		
IH 90/94 EB & WB	SAUK & COLUMBIA COUNTIES (WIS DELLS AREA)	220191		52612	551	224585			4925	4069	1652	1329	
STH 13 NB & SB	SAUK & COLUMBIA COUNTIES (WIS DELLS)	11705	9266	5881		12320	375	12284	1496		577	159	
USH 12 EB & WB	SAUK COUNTY (WIS DELLS)	18420	25861	7154		15666			1067		807	24	
TOTALS		474474	35127	116367	2498	477468	375	12284	20589	15998	5705	1512	
				TOTAL 4-INCH	1105934	TOTAL 6-INCH		12659	TOTAL 8-INCH		43804		

PAVEMENT MARKING EPOXY SUMMARY (SPECIAL MARKINGS)

HIGHWAY	COUNTY	646.5020			646.5120	646.6120	646.7420
		ARROWS TYPE 1 WHITE EACH	ARROWS TYPE 2 WHITE EACH	ARROWS TYPE 3 WHITE EACH	WORDS "ONLY" WHITE EACH	18-INCH STOP LINE WHITE L.F.	6-INCH CROSSWALK WHITE L.F.
USH 61 NB & SB	GRANT COUNTY (DUBUQUE, IOWA - DICKEYVILLE)					198	
STH 13 & USH 18	COLUMBIA & IOWA COUNTIES	1	30	1	21	1019	2661
TOTALS		1	30	1	21	1217	2661
				TOTAL ARROWS	32		

PROJECT NO: 1009-12-93

HWY: VARIOUS

COUNTY: VARIOUS

MISCELLANEOUS QUANTITIES

SHEET NO:

E

FILE NAME : _____

PLOT DATE : _____

PLOT BY : _____

PLOT NAME : _____

ORG DATE : _____

ORIGINATOR : DIST _

PLOT SCALE : 1:1

Standard Detail Drawing List

15C07-14B	PAVEMENT MARKING WORDS
15C07-14C	PAVEMENT MARKING ARROWS
15C08-19A	LONGITUDINAL MARKING (MAINLINE)
15C08-19C	PAVEMENT MARKING (TURN LANES)
15C09-11A	SIGNING AND PAVEMENT MARKING DETAILS FOR RAILROAD-HIGHWAY GRADE CROSSINGS
15C14-03	AERIAL ENFORCEMENT BARS PAVEMENT MARKING DETAILS
15C19-05A	MOVING PAVEMENT MARKING OPERATION TWO-LANE TWO-WAY ROADWAY
15C19-05B	MOVING PAVEMENT MARKING OPERATION MULTI-LANE UNDIVIDED ROADWAY
15C19-05C	MOVING PAVEMENT MARKING OPERATION MULTI-LANE DIVIDED ROADWAY
15C27-03A	DOUBLE ARROW WARNING SIGN PLACEMENT
15C31-03A	PAVEMENT MARKING (RAMPS AND GORES)
15C31-03C	PAVEMENT MARKING FOR PARALLEL ON-RAMP AND PARALLEL OFF-RAMP
15C33-03	STOP LINE AND CROSSWALK PAVEMENT MARKING

GENERAL NOTES

DETAILS OF INSTALLATION, MATERIALS AND WORKMANSHIP NOT SHOWN ON THIS DRAWING SHALL CONFORM TO THE PERTINENT REQUIREMENTS OF THE STANDARD SPECIFICATIONS AND APPLICABLE SPECIAL PROVISIONS.

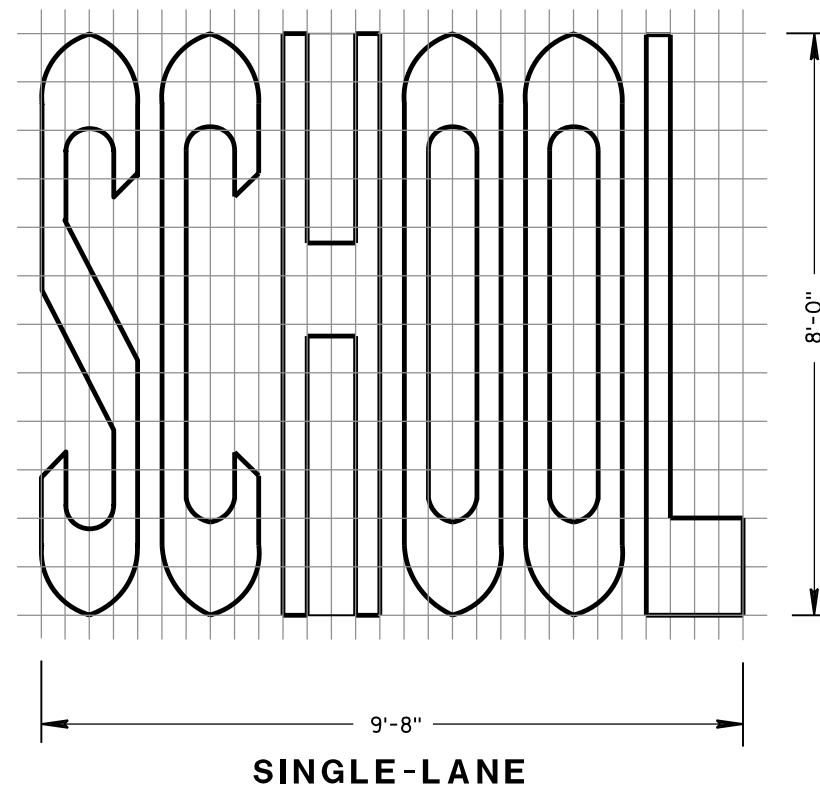
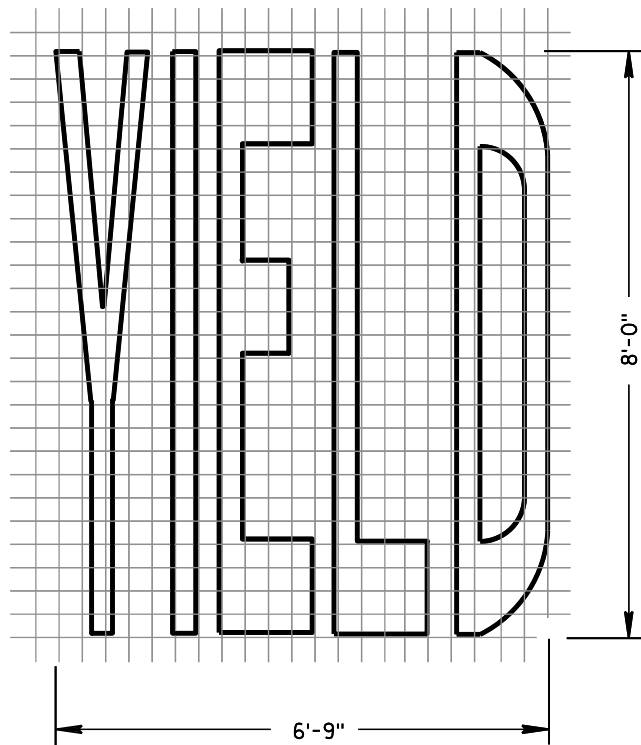
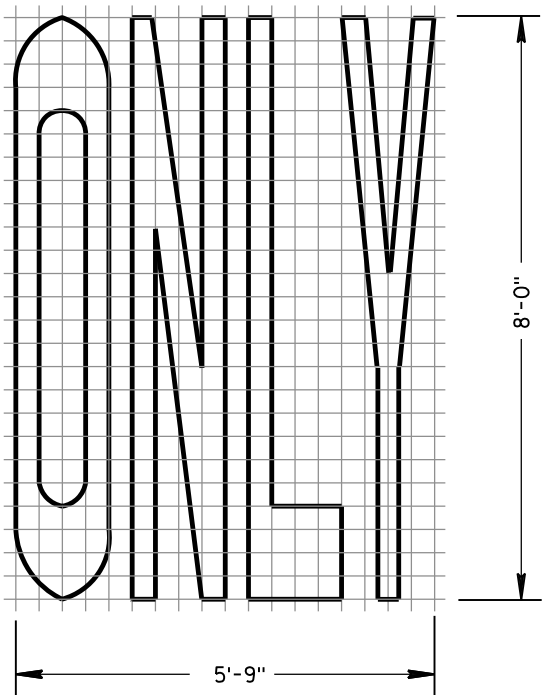
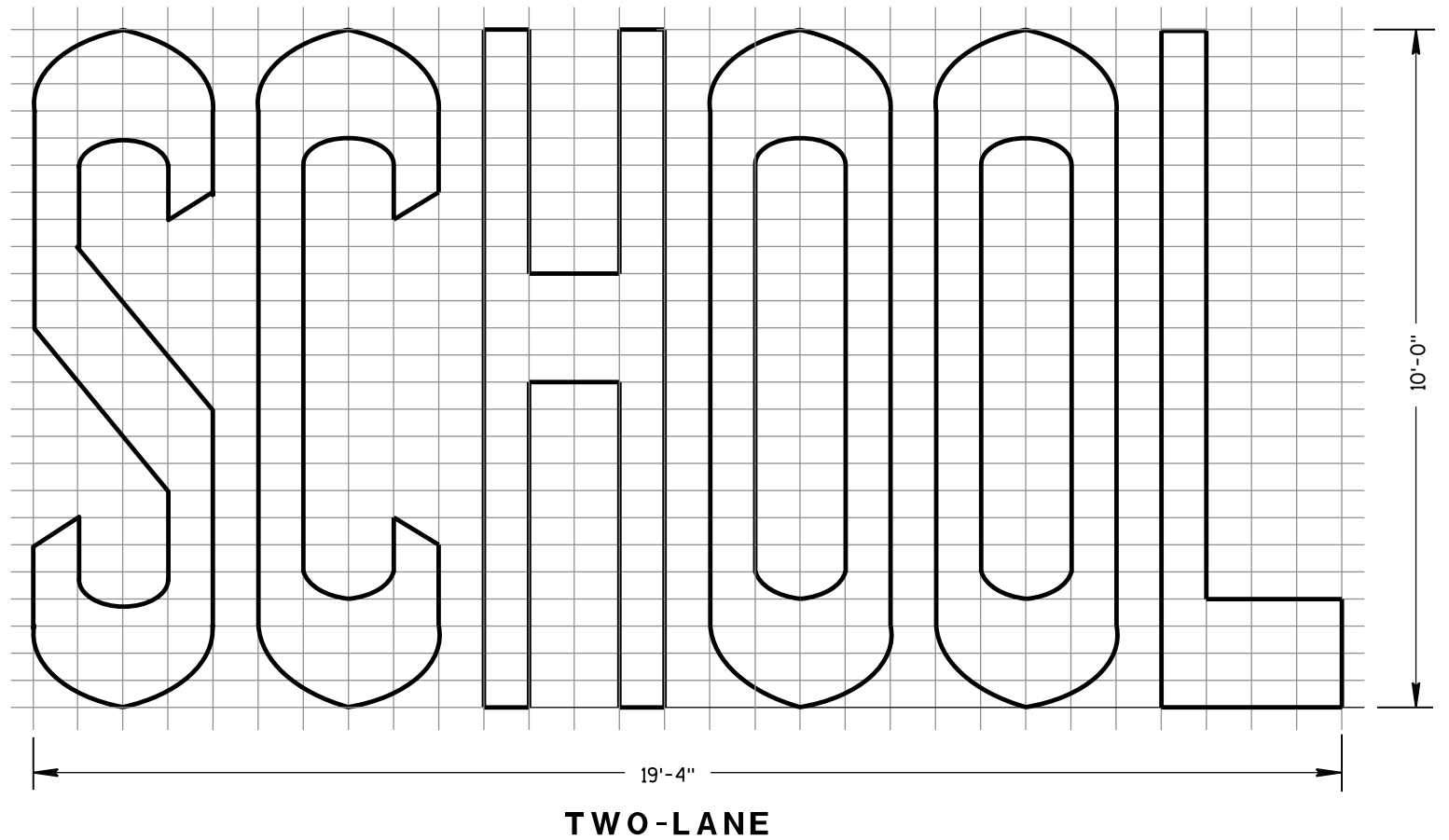
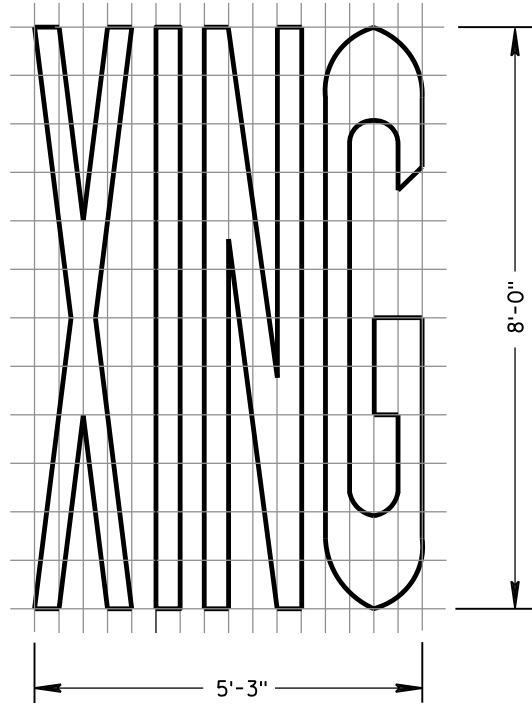
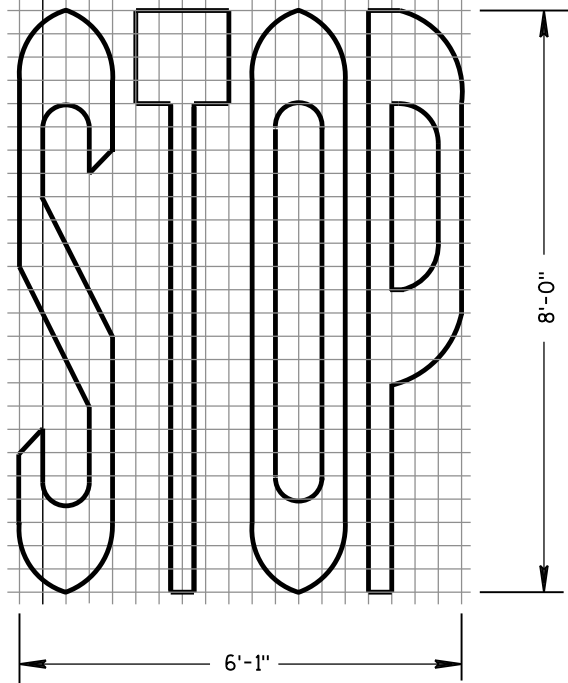

PAVEMENT MARKING WORDS

STATE OF WISCONSIN
DEPARTMENT OF TRANSPORTATION

APPROVED
June 2017 /S/ Matthew R. Rauch
DATE STATE SIGNING AND MARKING ENGINEER
FHWA

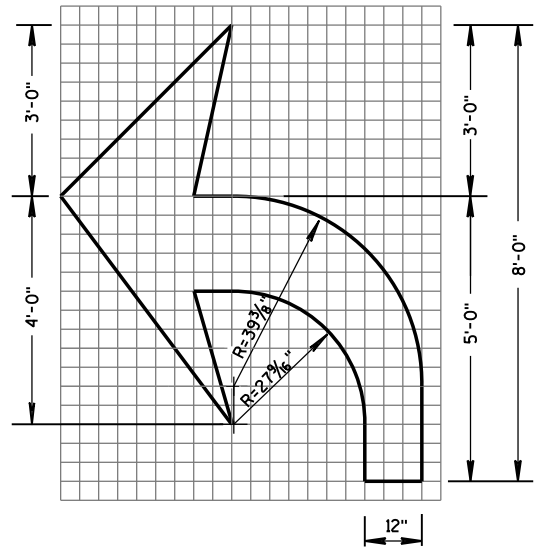

TYPE 2

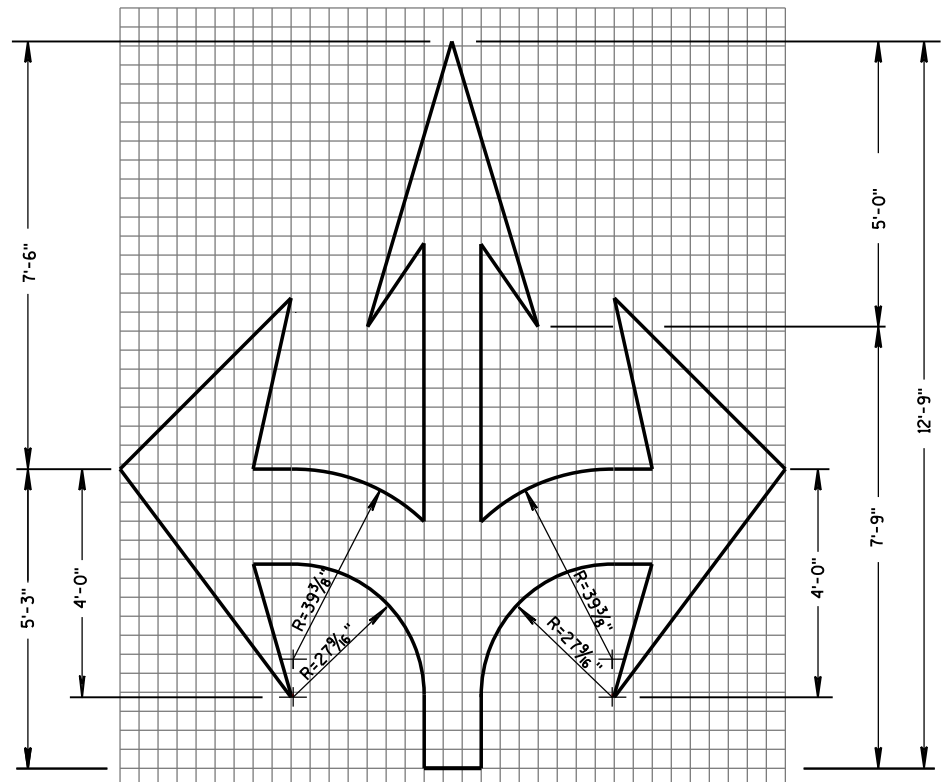

TYPE 6

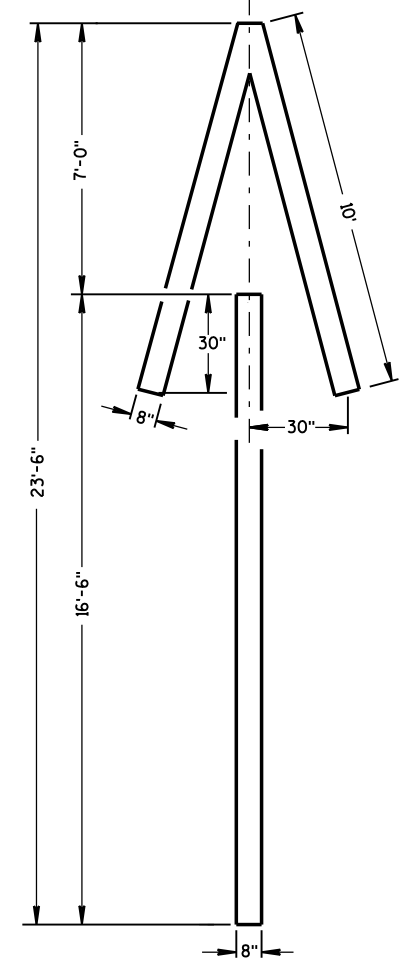

TYPE 4

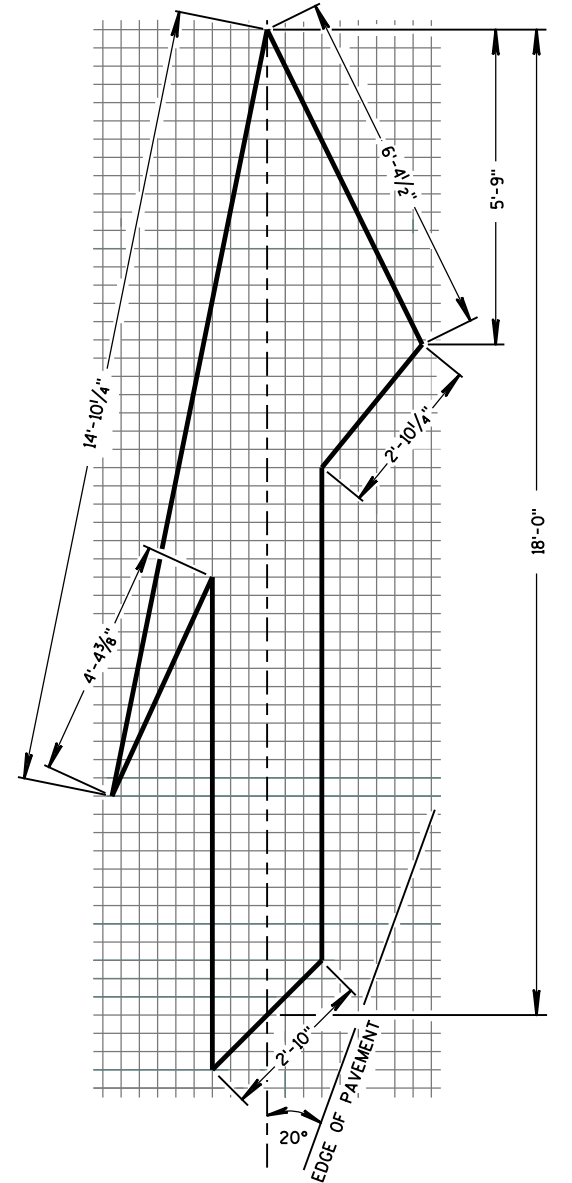

TYPE 5 LANE DROP ARROW

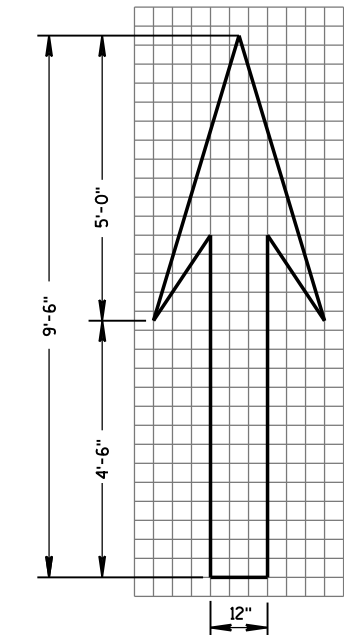

TYPE 1

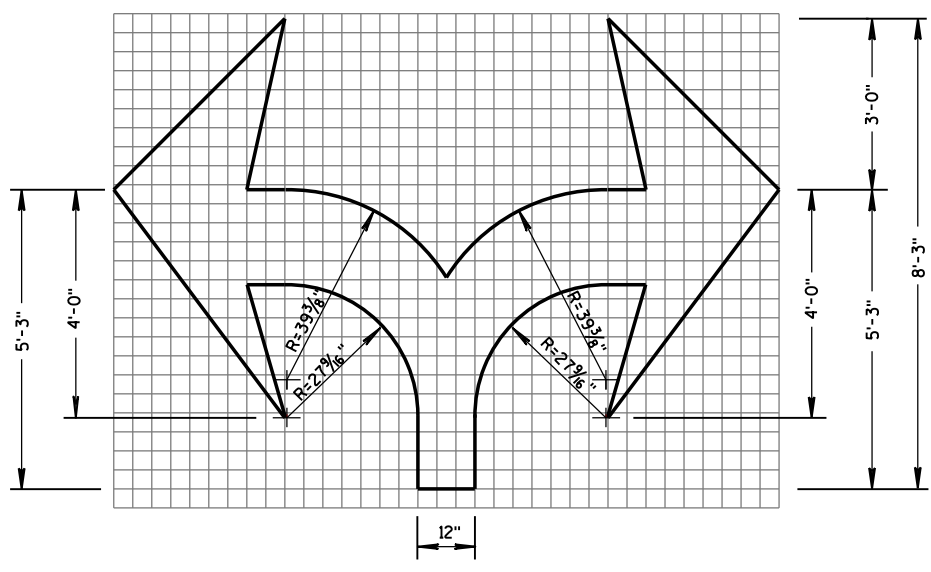

TYPE 7

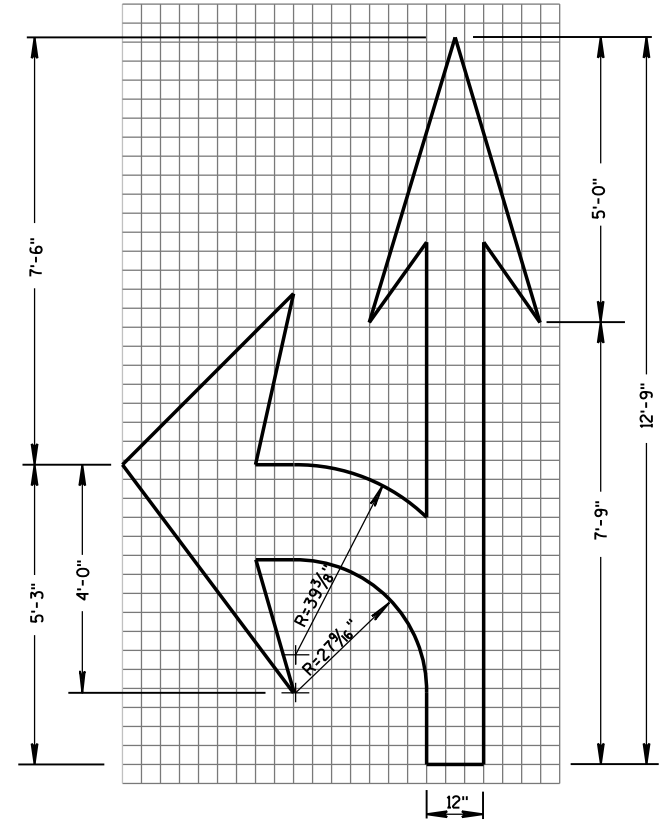

TYPE 3

GENERAL NOTES

DETAILS OF INSTALLATION, MATERIALS AND WORKMANSHIP NOT SHOWN ON THIS DRAWING SHALL CONFORM TO THE PERTINENT REQUIREMENTS OF THE STANDARD SPECIFICATIONS AND APPLICABLE SPECIAL PROVISIONS.

PAVEMENT MARKING ARROWS	
STATE OF WISCONSIN DEPARTMENT OF TRANSPORTATION	
APPROVED June 2017 DATE	/s/ Matthew R. Rauch STATE SIGNING AND MARKING ENGINEER
FHWA	

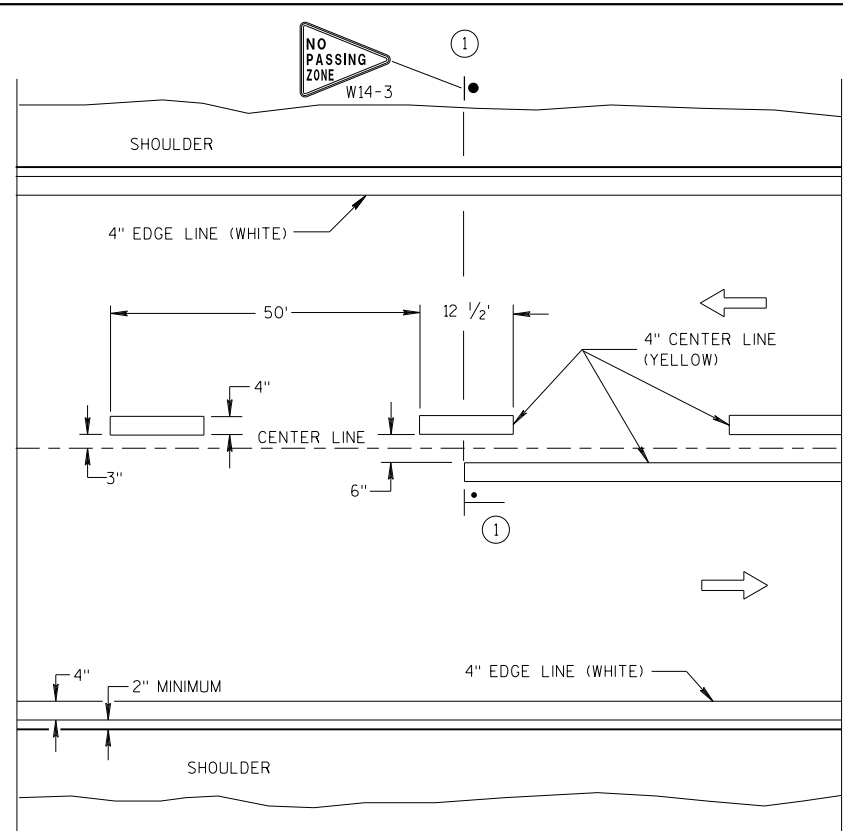

TWO WAY TRAFFIC

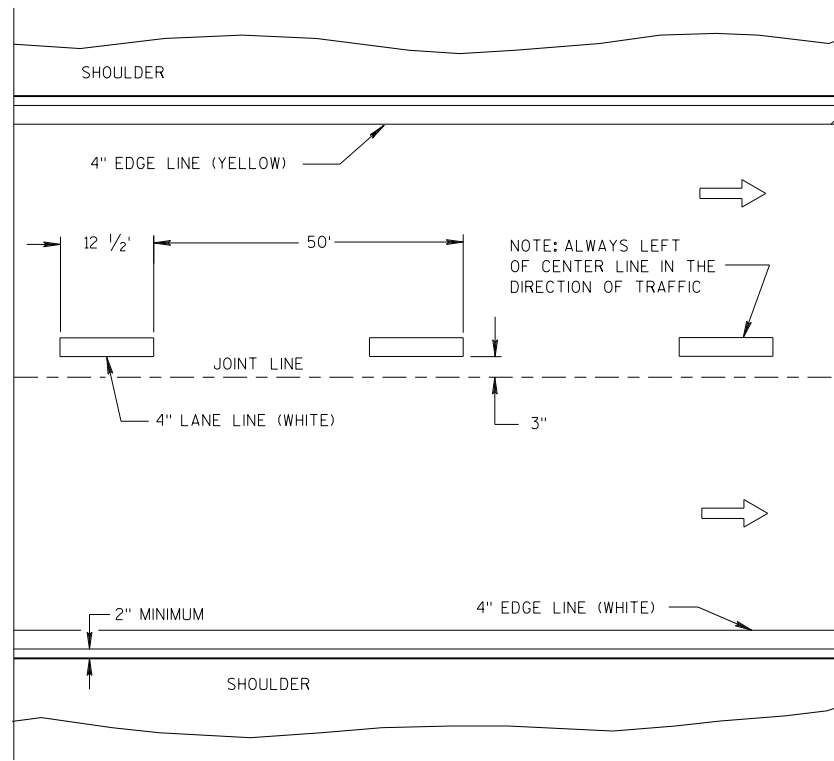

ONE WAY TRAFFIC

PERMANENT PAVEMENT MARKING

GENERAL NOTES

DETAILS OF CONSTRUCTION NOT SHOWN ON THIS DRAWING SHALL CONFORM TO STANDARD SPECIFICATIONS AND SPECIAL PROVISIONS.

① LOCATE THE NO PASSING ZONE W14-3 SIGN WITHIN 50 FEET OF THE "T" MARKING.

NOTE

ARROW SYMBOL (→) SHOWS DIRECTION OF TRAVEL

LEGEND

- "T" MARKING
- POST MOUNTED SIGN

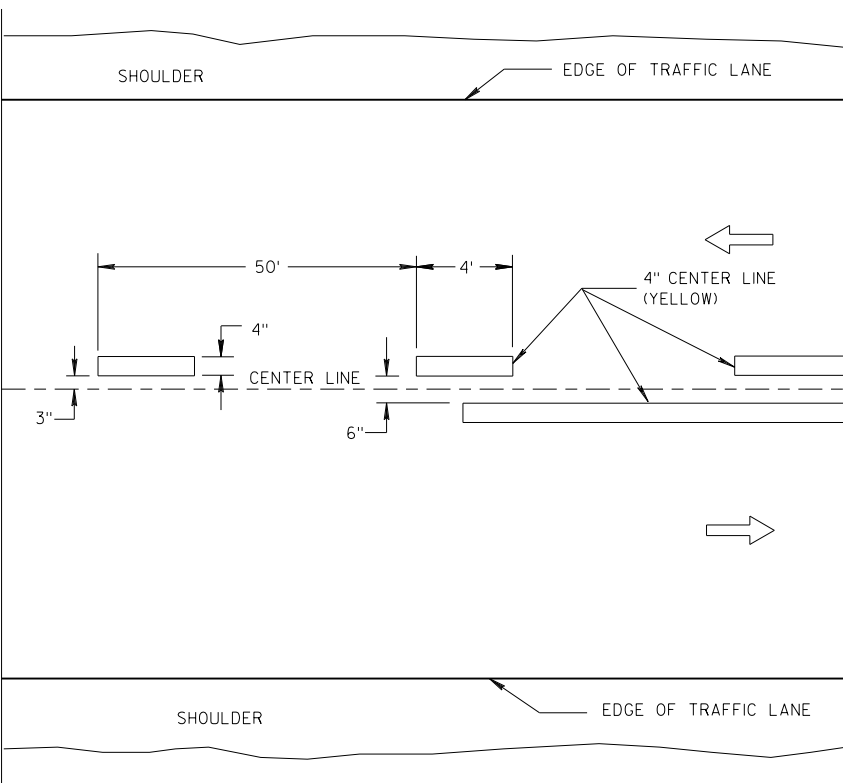

TWO WAY TRAFFIC

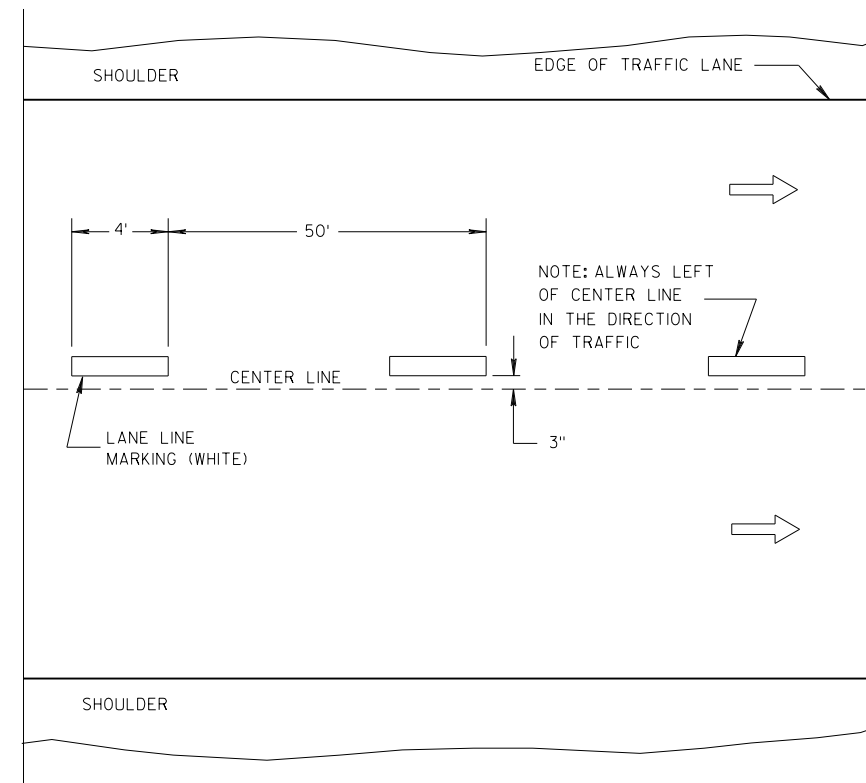

ONE WAY TRAFFIC

TEMPORARY PAVEMENT MARKING

LONGITUDINAL MARKING (MAINLINE)

STATE OF WISCONSIN
DEPARTMENT OF TRANSPORTATION

APPROVED
DATE 7/2018 /S/ Matthew R. Rauch
STATE SIGNING AND MARKING ENGINEER
FHWA

TURN LANE OPTIONS

LENGTH OF TURN BAY (L) OF 0-47' DOES NOT REQUIRE PAVEMENT MARKING ARROWS OR WORDS

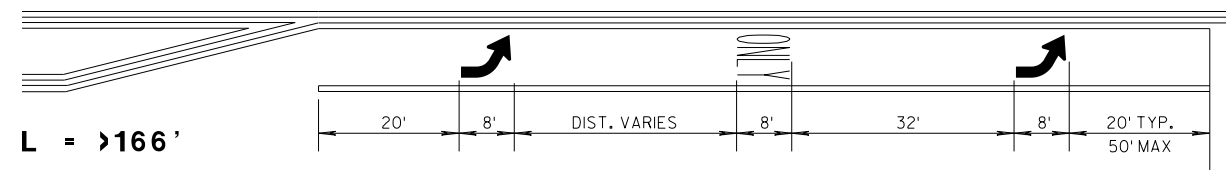
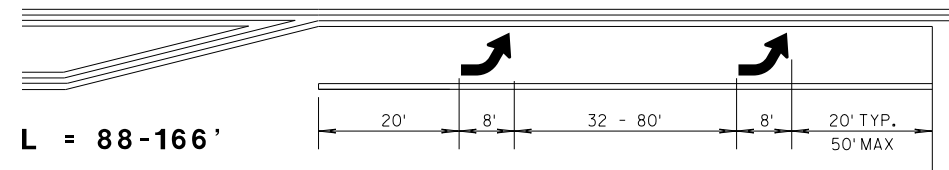
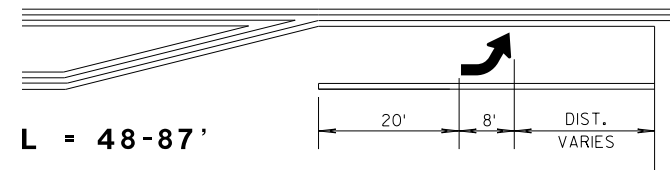

* (SEE TURN LANE OPTIONS FOR PLACEMENT OF PAVEMENT MARKING ARROWS AND WORDS)

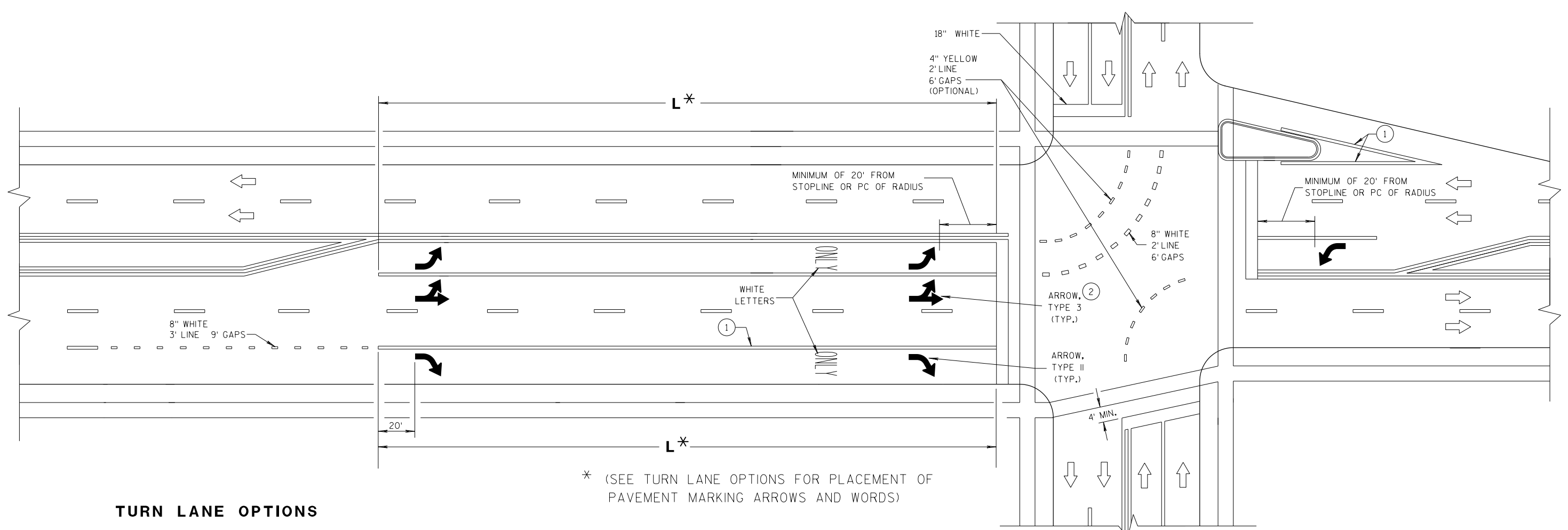

GENERAL NOTES

- ① 8" WHITE
- ② QUANTITY AND LOCATION OF TYPE 3 ARROW ARE THE SAME AS THE TYPE II ARROWS IN THE ADJACENT TURN LANE. FOR TURN LANES WITH A PHYSICAL SEPARATION, THE ARROWS AND ONLY MARKING ARE ELIMINATED.

➔ DIRECTION OF TRAFFIC

L = LENGTH OF TURN BAY

PAVEMENT MARKING (TURN LANES)
STATE OF WISCONSIN DEPARTMENT OF TRANSPORTATION



W14-3

500' MIN.

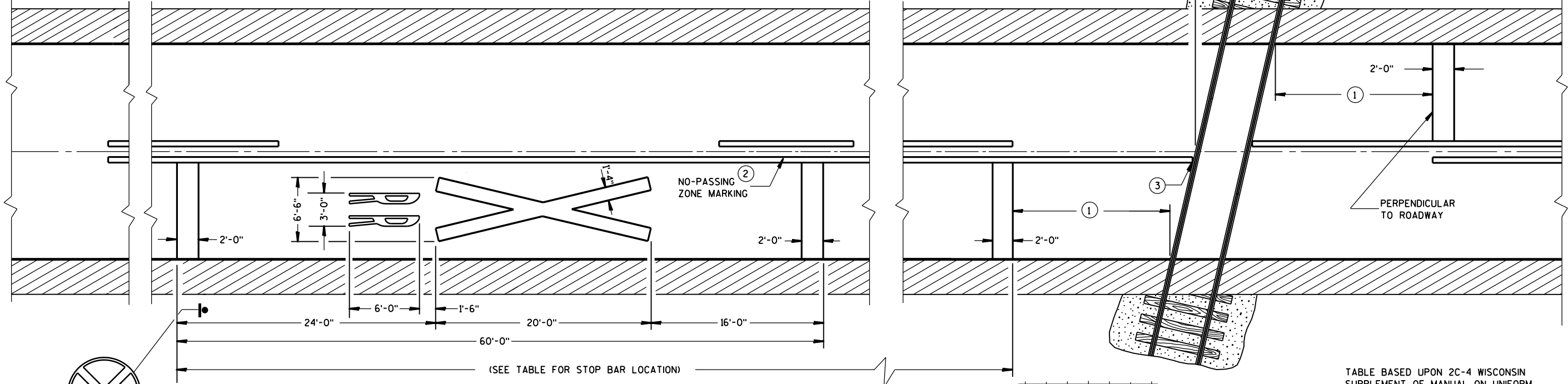

W10-1

PAVEMENT MARKING

GENERAL NOTES

DETAILS OF CONSTRUCTION, MATERIALS, AND WORKMANSHIP NOT SHOWN ON THIS DRAWING SHALL CONFORM TO THE PERTINENT REQUIREMENTS OF THE STANDARD SPECIFICATIONS AND THE APPLICABLE SPECIAL PROVISIONS.

ON MULTI-LANE ROADS THE TRANSVERSE BANDS SHOULD EXTEND ACROSS ALL APPROACH LANES, AND INDIVIDUAL R X R SYMBOLS SHOULD BE USED IN EACH APPROACH LANE.

CENTER OR LANE LINES AND NO-PASSING ZONE MARKINGS SHOWN ON THIS DRAWING ARE REQUIRED AND PAID FOR UNDER OTHER ITEMS IN THE CONTRACT.

RETRACE EXISTING SYMBOL WHERE EXISTING SYMBOLS ARE PLACED.

- ① MINIMUM 8' FROM ANY RAILROAD WARNING DEVICES (SIGNALS, GATES, ETC.) OR 25' FROM THE NEAREST RAIL, WHICHEVER DISTANCE IS GREATER.
- ② 500' MINIMUM. MARKING LIMITS MAY BE EXTENDED AS DIRECTED BY THE ENGINEER TO MEET ADJACENT NO-PASSING ZONE MARKINGS.
- ③ FOR MULTIPLE TRACK CROSSINGS, THE BARRIER LINE SHALL EXTEND TO THE NEAR RAIL OF THE FURTHEST TRACK IN THE DIRECTION OF HIGHWAY TRAVEL.

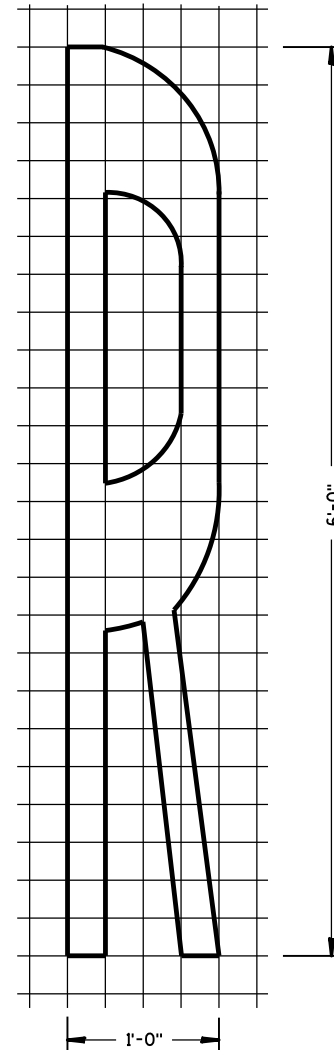

TABLE BASED UPON 2C-4 WISCONSIN SUPPLEMENT OF MANUAL ON UNIFORM TRAFFIC CONTROL DEVICES.

Posted Speed (M.P.H.)	Dimension Range (Feet)
25	150* - 250
30	200* - 300
35	250* - 450
40	300* - 500
45	400* - 650
50	550* - 800
55	750* - 1000
60	1000* - 1250
65	1000* - 1250

* THE MINIMUM DISTANCES IN THE TABLE ARE DESIRABLE AND SHOULD BE USED. THE DISTANCES MAY BE INCREASED UP TO THE MAXIMUM TO ALLOW FOR FIELD CONDITIONS SUCH AS THE CLOSE PROXIMITY OF DRIVEWAYS, BRIDGES, SIDEROADS OR OTHER FEATURES THAT WOULD PROHIBIT THE MINIMUM DISTANCES FROM BEING USED.

SIGNING AND PAVEMENT MARKING DETAILS FOR RAILROAD-HIGHWAY GRADE CROSSINGS

STATE OF WISCONSIN
DEPARTMENT OF TRANSPORTATION

APPROVED

Sept., 2017 /S/ Matthew R. Rauch
DATE STATE SIGNING AND MARKING ENGINEER

FHWA

GENERAL NOTES

① PLACE TWO TO FIVE AERIAL OR VASCAR BARS AT 660 FOOT SPACING.

A CAR CAN BE PROVIDED BY THE WISCONSIN STATE PATROL FOR TRAFFIC CONTROL.

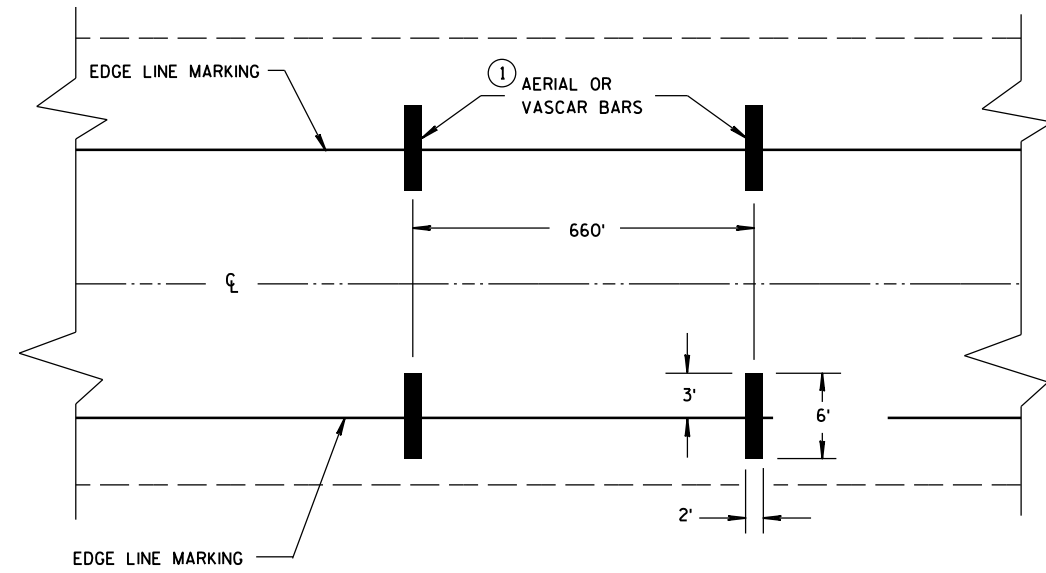

TYPICAL FOR TWO WAY OR ONE WAY TRAFFIC

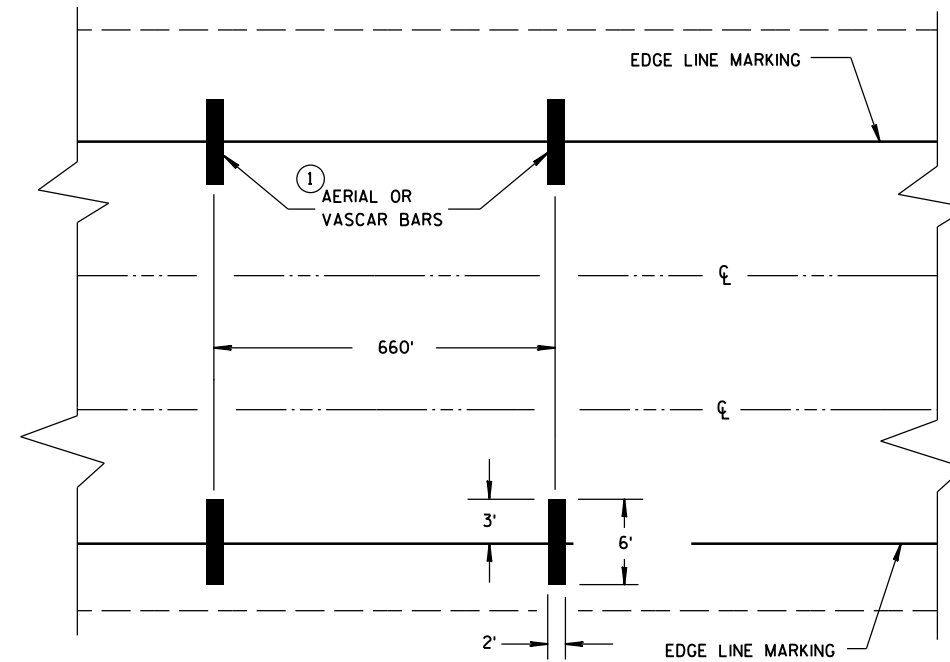

TYPICAL FOR MULTILANE TRAFFIC

SPEED ENFORCEMENT ZONE WITH AERIAL OR VASCAR BARS

6

6

S.D.D. 15 C 14-3

S.D.D. 15 C 14-3

**AERIAL ENFORCEMENT BARS
PAVEMENT MARKING DETAILS**

STATE OF WISCONSIN
DEPARTMENT OF TRANSPORTATION

APPROVED
June 2017 /S/ Matthew R. Rauch
DATE STATE SIGNING AND MARKING ENGINEER
FHWA

GENERAL NOTES

ALL VEHICLES SHALL BE EQUIPPED WITH TWO 360 DEGREE HIGH INTENSITY YELLOW FLASHING LIGHTS OR STROBE LIGHTS AND OPERATED WITH HEADLIGHTS TURNED ON.

VEHICLES SHALL BE EQUIPPED WITH REAR FACING TYPE B OR C FLASHING ARROW PANEL OPERATING IN CAUTION MODE. SIGNS PLACED ON VEHICLES MUST NOT OBSCURE THE ARROW PANEL.

ALL SIGNS ARE 48" X 48" UNLESS OTHERWISE SPECIFIED.

IF SPEED LIMIT IS 40 MPH OR LESS STATIONARY SIGNS MAY BE OMITTED IF CONES ARE USED.

ALTERNATE SIGN MESSAGES, SUCH AS "PAINT CREW AHEAD" OR "ROAD PAINTING AHEAD" MAY BE USED.

DISTANCE BETWEEN VEHICLES MAY VARY ACCORDING TO TERRAIN, SIGHT DISTANCE, PAINT DRYING TIME, AND OTHER FACTORS. WHENEVER ADEQUATE STOPPING SIGHT DISTANCE EXISTS TO THE REAR, SHADOW VEHICLES SHOULD MAINTAIN THE MINIMUM DISTANCE FROM THE WORK VEHICLE AND PROCEED AT THE SAME SPEED AS THE WORK VEHICLE. SHADOW VEHICLES SHOULD SLOW DOWN IN ADVANCE OF VERTICAL OR HORIZONTAL CURVES THAT RESTRICT SIGHT DISTANCE.

THE WORK AND SHADOW VEHICLES SHOULD PULL OVER PERIODICALLY TO ALLOW TRAFFIC TO PASS.

THIS DRAWING SHALL BE USED FOR CENTERLINE OR EDGELINE MARKING.

WHEN NO WORK ACTIVITY IS TAKING PLACE, REMOVE OR TURN THE STATIONARY WARNING SIGNS AWAY FROM TRAFFIC.

① CONES MAY BE OMITTED ON PAINTED LINE IF APPROVED BY THE ENGINEER. CONSIDER PAVEMENT MARKING DRY OR CURE TIMES AND TRAFFIC VOLUME.

② USE STANDARD SIGN W21-64 WITH APPROPRIATE ARROW.

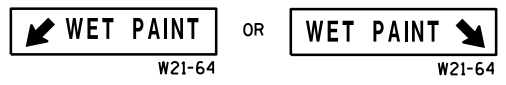

③ OPTIONAL TRUCK-MOUNTED ATTENUATOR.

④ SIGNS SHALL BE REPEATED APPROXIMATELY EVERY THREE MILES.

⑤ IF CONSTRUCTION WORK ZONE SIGNS ARE IN PLACE, W20-1 OR W21-63 ARE NOT REQUIRED.

LEGEND

V1 LEAD VEHICLE

V2 SHADOW VEHICLE

V3 TRAIL VEHICLE WITH TMA

TMA TRUCK-MOUNTED ATTENUATOR

SIGN ON TEMPORARY SUPPORT

DIRECTION OF TRAFFIC

CONES

FLASHING ARROW PANEL (CAUTION)

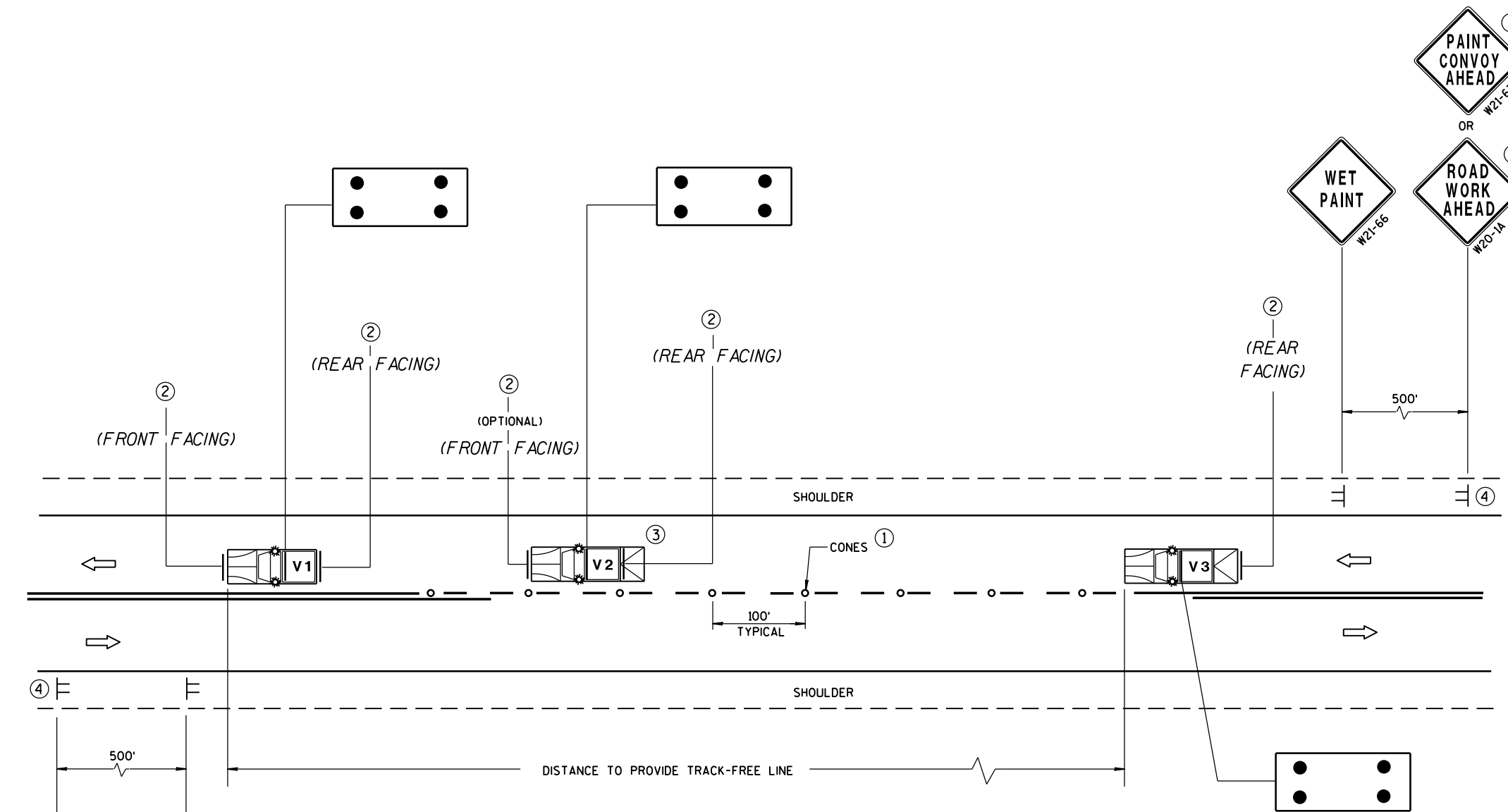

MOVING PAVEMENT MARKING OPERATIONS TWO-LANE TWO-WAY ROADWAY

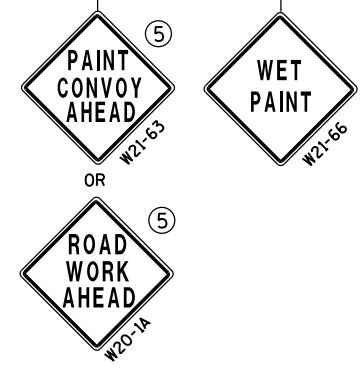

MOVING PAVEMENT MARKING
OPERATION
TWO-LANE TWO-WAY ROADWAY

STATE OF WISCONSIN
DEPARTMENT OF TRANSPORTATION

APPROVED
DATE: Sept., 2017 /S/ Andrew Heidtke
WORK ZONE ENGINEER
FHWA

GENERAL NOTES

ALL VEHICLES SHALL BE EQUIPPED WITH TWO 360 DEGREE HIGH INTENSITY YELLOW FLASHING LIGHTS OR STROBE LIGHTS AND OPERATED WITH HEADLIGHTS TURNED ON.

ALL VEHICLES SHALL BE EQUIPPED WITH REAR FACING TYPE B OR C FLASHING ARROW PANEL. SIGNS PLACED ON VEHICLES MUST NOT OBSCURE THE ARROW PANEL.

ALL SIGNS ARE 48" X 48" UNLESS OTHERWISE SPECIFIED.

IF SPEED LIMIT IS 40 MPH OR LESS STATIONARY SIGNS MAY BE OMITTED IF CONES ARE USED.

ALTERNATE SIGN MESSAGES, SUCH AS "PAINT CREW AHEAD" OR "ROAD PAINTING AHEAD" MAY BE USED.

DISTANCE BETWEEN VEHICLES MAY VARY ACCORDING TO TERRAIN, SIGHT DISTANCE, PAINT DRYING TIME, AND OTHER FACTORS. WHENEVER ADEQUATE STOPPING SIGHT DISTANCE EXISTS TO THE REAR, SHADOW VEHICLES SHOULD MAINTAIN THE MINIMUM DISTANCE FROM THE WORK VEHICLE AND PROCEED AT THE SAME SPEED AS THE WORK VEHICLE. SHADOW VEHICLES SHOULD SLOW DOWN IN ADVANCE OF VERTICAL OR HORIZONTAL CURVES THAT RESTRICT SIGHT DISTANCE.

WHEN WORK ACTIVITY BLOCKS THE LEFT LANE, REVERSE TRAFFIC CONTROL.

WHEN A RAMP INTERSECTS THE FACILITY ON WHICH THE WORK IS BEING PERFORMED, PROVIDE ADDITIONAL TRAFFIC CONTROLS AS SPECIFIED IN THE CONTRACT OR AS APPROVED BY THE ENGINEER.

USE AN ATTENUATOR ON THE REAR MOST VEHICLE THAT BLOCKS ALL OR PART OF THE TRAFFIC LANE.

FOR EDGELINE MARKING OR IF CONES ARE NOT USED, POSITION THE REAR MOST SHADOW VEHICLE ON THE SHOULDER AS SHOWN IN THE MUTCD IF THE SHOULDER HAS ADEQUATE WIDTH.

WHEN NO WORK ACTIVITY IS TAKING PLACE, REMOVE OR TURN THE STATIONARY WARNING SIGNS AWAY FROM TRAFFIC.

THIS DRAWING SHALL BE USED FOR CENTERLINE OR EDGELINE OR LANELINE MARKING FOR MULTILANE UNDIVIDED ROADWAYS.

① CONES MAY BE OMITTED ON PAINTED LINE IF APPROVED BY THE ENGINEER. CONSIDER PAVEMENT MARKING DRY OR CURE TIMES AND TRAFFIC VOLUME.

② USE STANDARD SIGN W21-64 WITH APPROPRIATE ARROW.

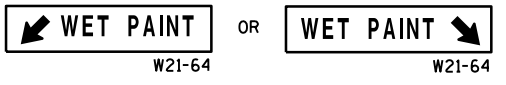

③ OPTIONAL TRUCK-MOUNTED ATTENUATOR.

④ SIGNS SHALL BE REPEATED APPROXIMATELY EVERY THREE MILES.

⑤ IF CONSTRUCTION WORK ZONE SIGNS ARE IN PLACE, W20-1 OR W21-63 ARE NOT REQUIRED.

LEGEND

V1 LEAD VEHICLE

V2 SHADOW VEHICLE

V3 TRAIL VEHICLE WITH TMA

TMA TRUCK-MOUNTED ATTENUATOR

SIGN ON TEMPORARY SUPPORT

DIRECTION OF TRAFFIC

CONES

FLASHING ARROW PANEL (MERGE)

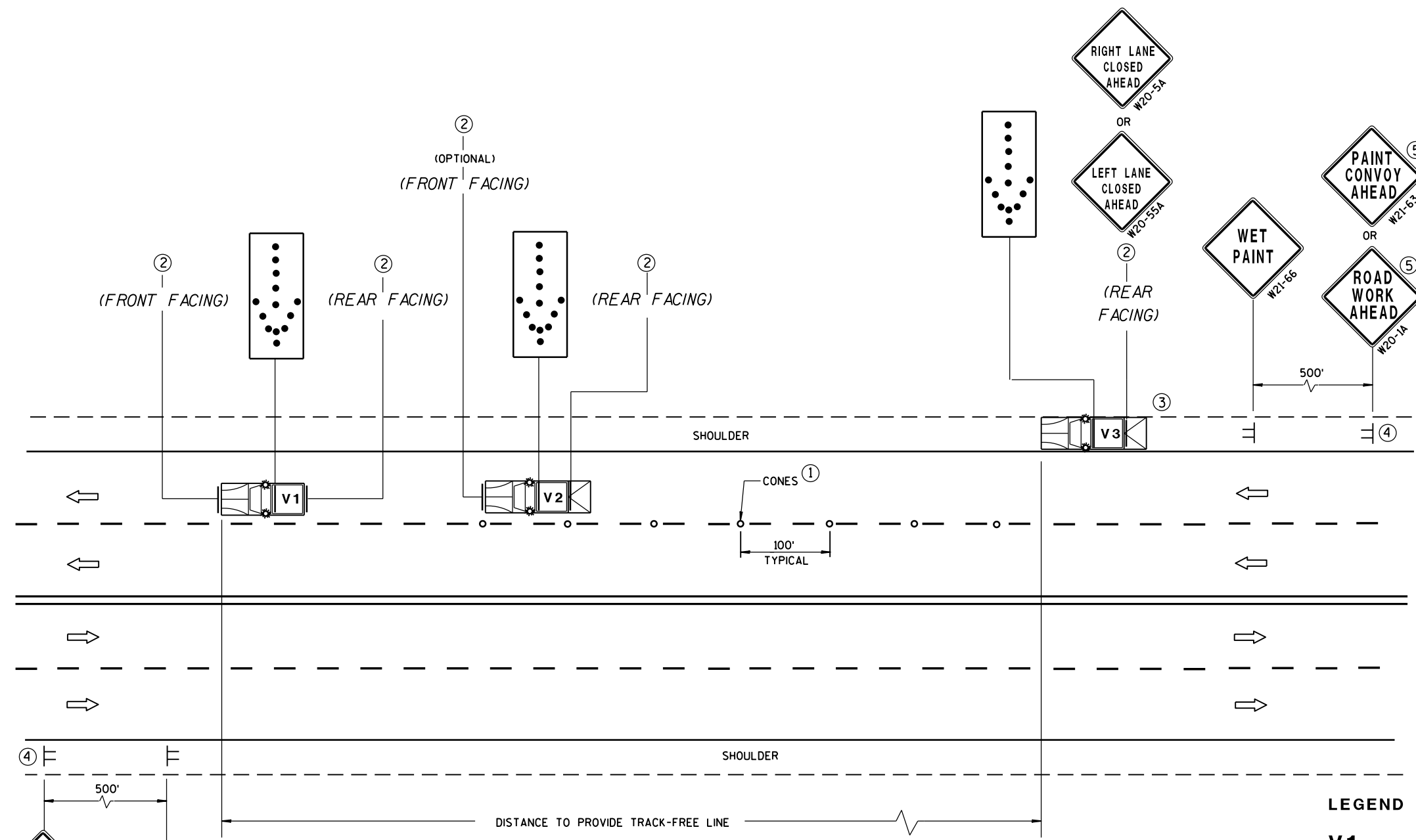

MOVING PAVEMENT MARKING OPERATIONS MULTI-LANE UNDIVIDED ROADWAY

**MOVING PAVEMENT MARKING
OPERATION
MULTI-LANE UNDIVIDED ROADWAY**

STATE OF WISCONSIN
DEPARTMENT OF TRANSPORTATION

APPROVED
Sept., 2017 /s/ Andrew Heidtke
DATE WORK ZONE ENGINEER
FHWA

GENERAL NOTES

ALL VEHICLES SHALL BE EQUIPPED WITH TWO 360 DEGREE HIGH INTENSITY YELLOW FLASHING LIGHTS OR STROBE LIGHTS AND OPERATED WITH HEADLIGHTS TURNED ON.
 ALL VEHICLES SHALL BE EQUIPPED WITH REAR FACING TYPE B OR C FLASHING ARROW PANEL. SIGNS PLACED ON VEHICLES MUST NOT OBSCURE THE ARROW PANEL.
 ALL SIGNS ARE 48" X 48" UNLESS OTHERWISE SPECIFIED.
 IF SPEED LIMIT IS 40 MPH OR LESS STATIONARY SIGNS MAY BE OMITTED IF CONES ARE USED.
 ALTERNATE SIGN MESSAGES, SUCH AS "PAINT CREW AHEAD" OR "ROAD PAINTING AHEAD" MAY BE USED.

DISTANCE BETWEEN VEHICLES MAY VARY ACCORDING TO TERRAIN, SIGHT DISTANCE, PAINT DRYING TIME, AND OTHER FACTORS. WHENEVER ADEQUATE STOPPING SIGHT DISTANCE EXISTS TO THE REAR, SHADOW VEHICLES SHOULD MAINTAIN THE MINIMUM DISTANCE FROM THE WORK VEHICLE AND PROCEED AT THE SAME SPEED AS THE WORK VEHICLE. SHADOW VEHICLES SHOULD SLOW DOWN IN ADVANCE OF VERTICAL OR HORIZONTAL CURVES THAT RESTRICT SIGHT DISTANCE.

WHEN WORK ACTIVITY BLOCKS THE LEFT LANE, REVERSE TRAFFIC CONTROL.
 WHEN A RAMP INTERSECTS THE FACILITY ON WHICH THE WORK IS BEING PERFORMED, PROVIDE ADDITIONAL TRAFFIC CONTROLS AS SPECIFIED IN THE CONTRACT OR AS APPROVED BY THE ENGINEER.

USE AN ATTENUATOR ON THE REARMOST VEHICLE THAT BLOCKS ALL OR PART OF THE TRAFFIC LANE.

FOR EDGELINE MARKING OR IF CONES ARE NOT USED, POSITION THE REARMOST SHADOW VEHICLE ON THE SHOULDER AS SHOWN IN THE MUTCD IF THE SHOULDER HAS ADEQUATE WIDTH. USE DOUBLE ARROWS WHEN CONVOY IS IN CENTER LANE ONLY.

WHEN NO WORK ACTIVITY IS TAKING PLACE, REMOVE OR TURN THE STATIONARY WARNING SIGNS AWAY FROM TRAFFIC.

THIS DRAWING SHALL BE USED FOR EDGELINE OR LANELINE MARKING FOR MULTILANE DIVIDED ROADWAYS.

- ① CONES MAY BE OMITTED ON PAINTED LINE IF APPROVED BY THE ENGINEER. CONSIDER PAVEMENT MARKING DRY OR CURE TIMES AND TRAFFIC VOLUME.
 - ② USE STANDARD SIGN W21-64 WITH APPROPRIATE ARROW.
- OR

W21-64 W21-64
- ③ SIGNS SHALL BE REPEATED AFTER EVERY ON RAMP OR EVERY THREE MILES.
 - ④ IF CONSTRUCTION WORK ZONE SIGNS ARE IN PLACE, W20-1 OR W21-63 ARE NOT REQUIRED.

LEGEND

- V1** LEAD VEHICLE
- V2** SHADOW VEHICLE
- V3** TRAIL VEHICLE WITH TMA
- TMA** TRUCK-MOUNTED ATTENUATOR
- SIGN ON TEMPORARY SUPPORT
- DIRECTION OF TRAFFIC
- CONES
- FLASHING ARROW PANEL (MERGE)

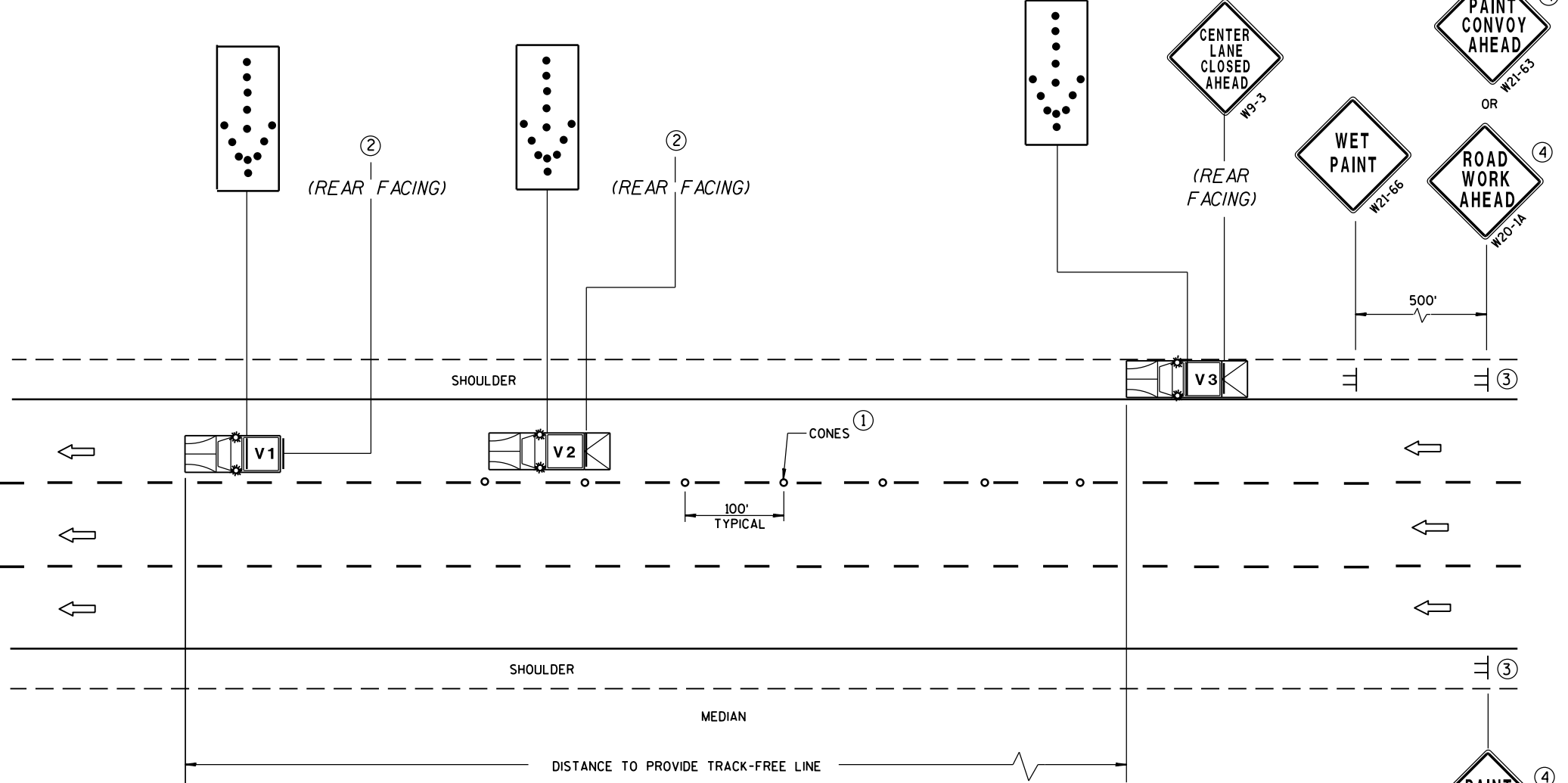
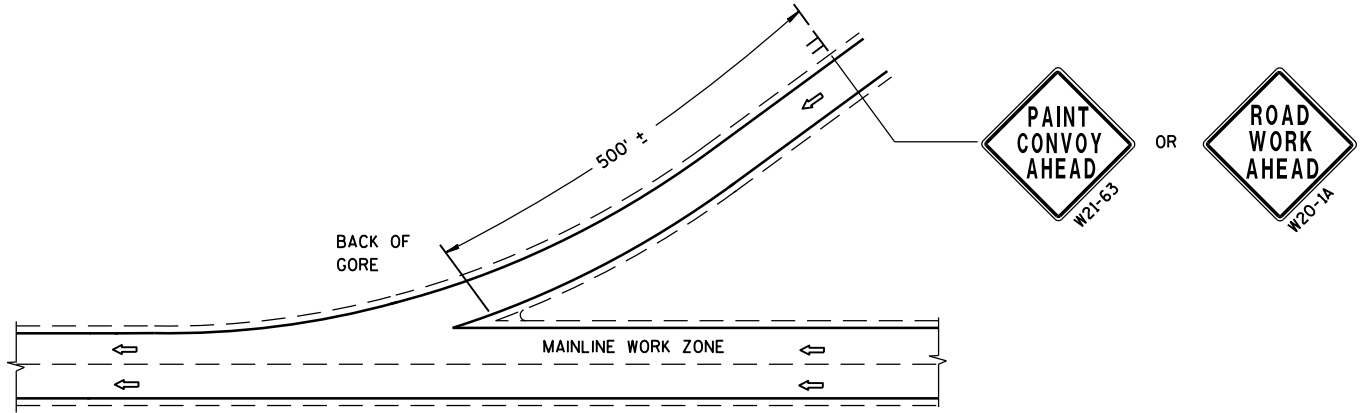

**MOVING PAVEMENT MARKING OPERATIONS
 MULTI-LANE DIVIDED ROADWAY**

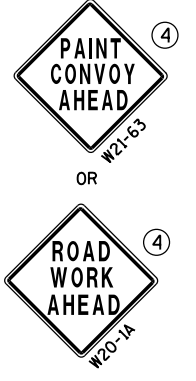

MOVING PAVEMENT MARKING OPERATION MULTI-LANE DIVIDED ROADWAY	
STATE OF WISCONSIN DEPARTMENT OF TRANSPORTATION	
APPROVED DATE	/S/ Andrew Heldtke WORK ZONE ENGINEER
FHWA	

REQUIREMENTS FOR EDGE LINES		
POSTED SPEED	IS THERE CONTINUOUS LIGHTING?	
	YES	NO
≤ 30 MPH	NO	OPTIONAL
35 OR 40 MPH	OPTIONAL	RECOMMENDED
≥ 45 MPH	RECOMMENDED	REQUIRED

GENERAL NOTES

APPLIES TO ISLANDS AT LEFT TURNS AT ONE WAY ROADWAYS AS WELL.
SEE MISCELLANEOUS QUANTITIES FOR SIGN SIZE.

- ① MARK CURB NOSES YELLOW.
- ② MARK ACCORDING TO TABLE.

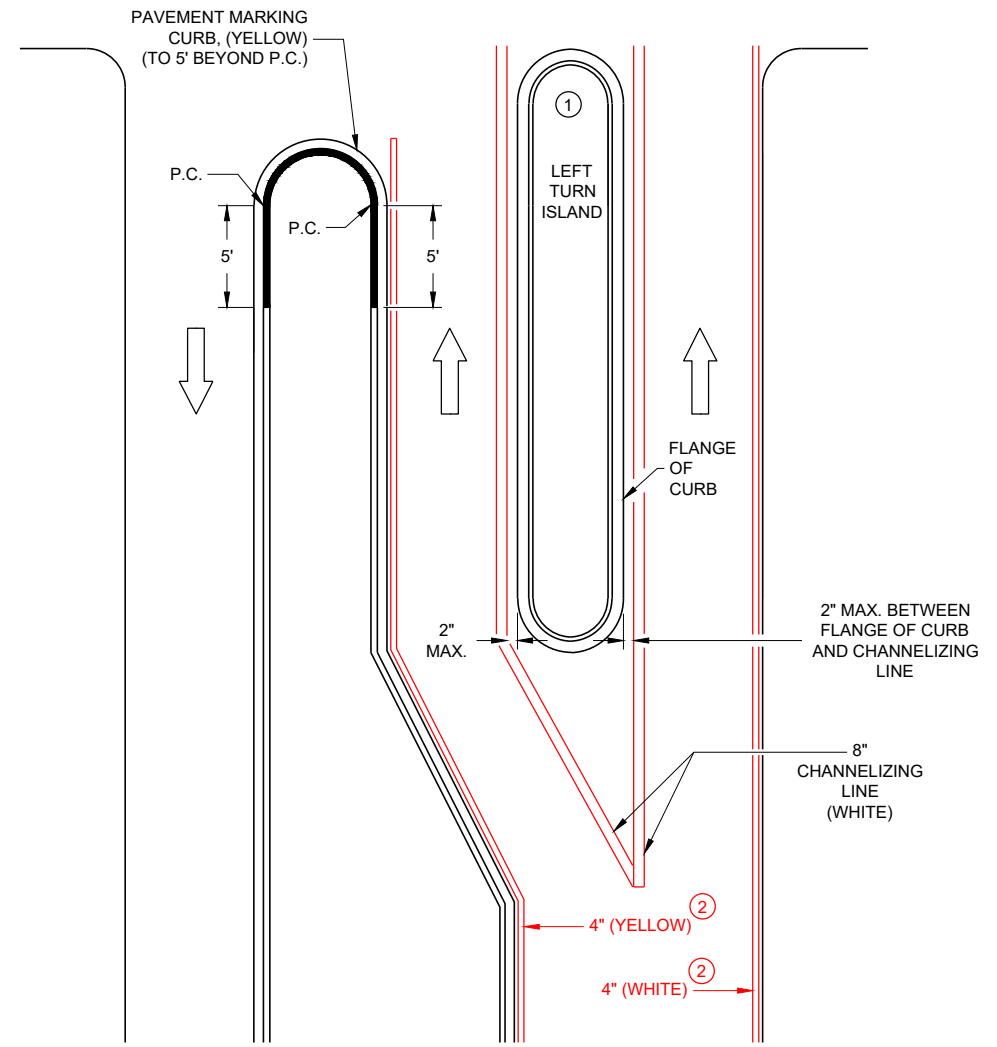

LEFT TURN & MEDIAN ISLAND

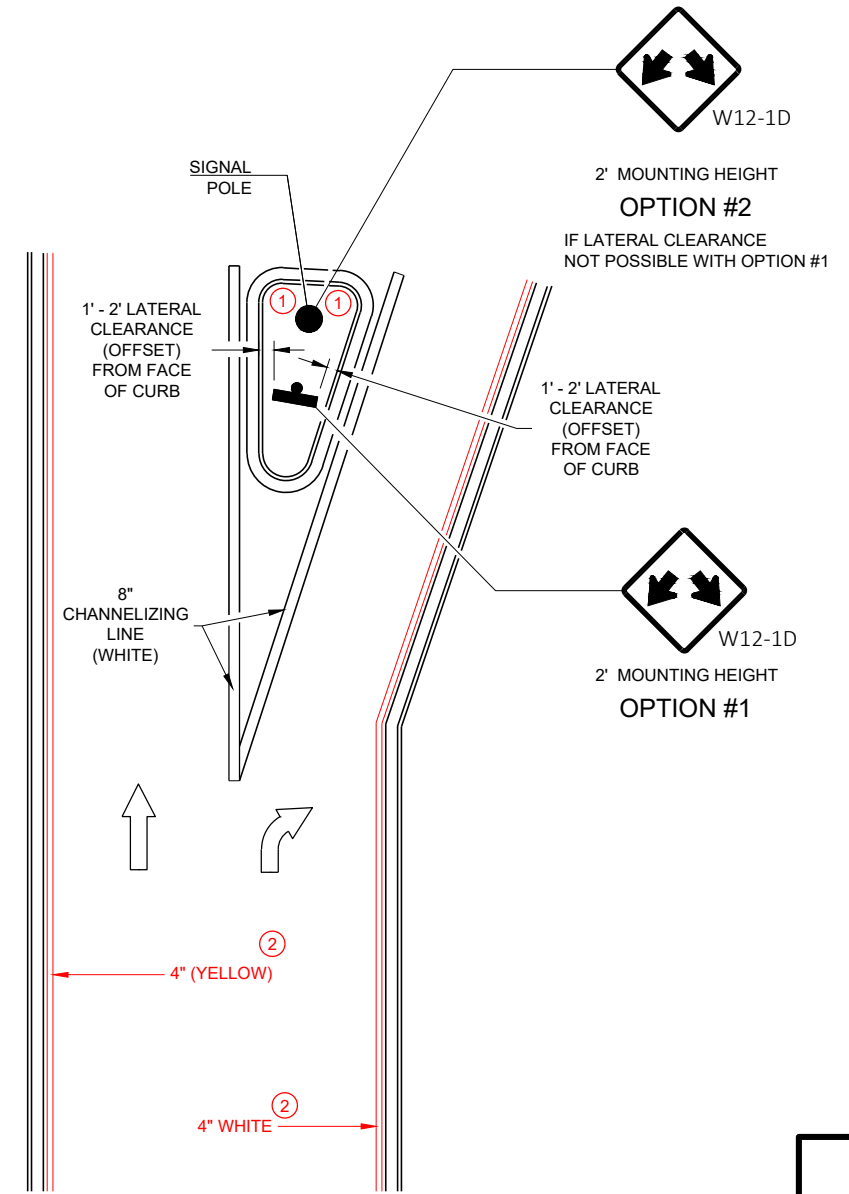

RIGHT TURN ISLAND

6

6

SDD 15C27 - 03a

SDD 15C27 - 03a

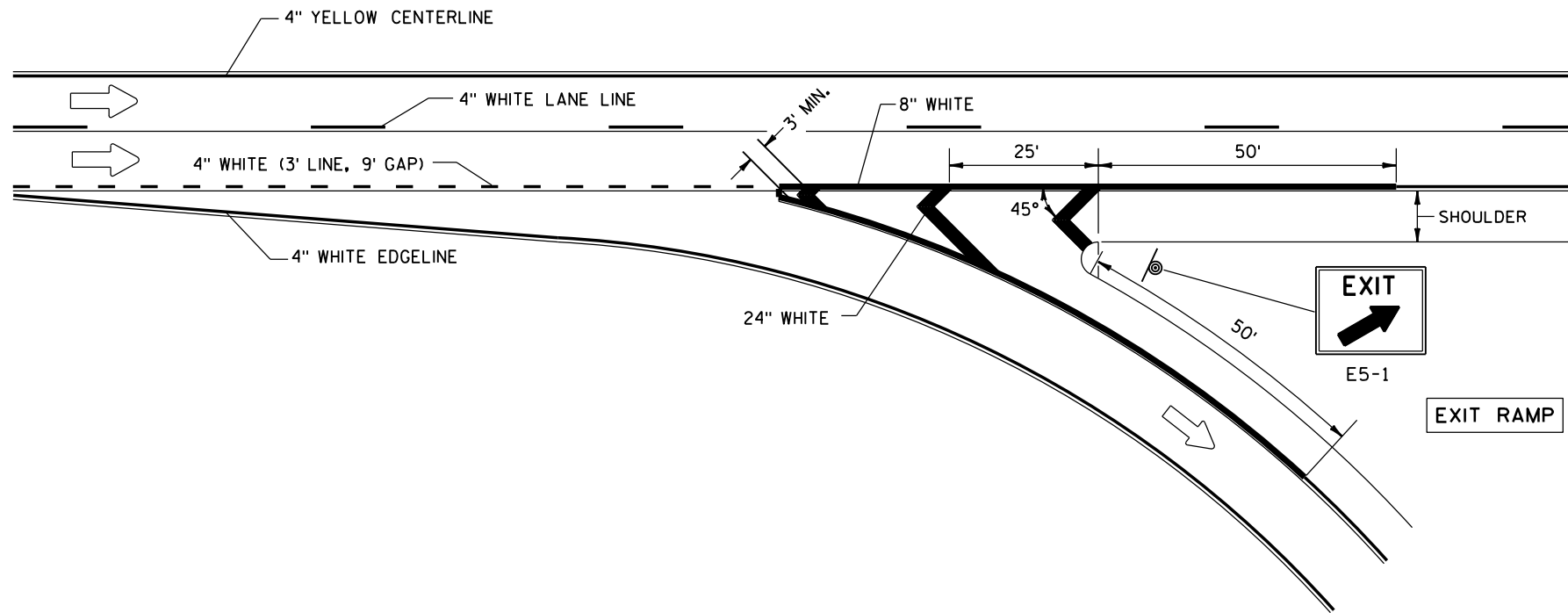

DOUBLE ARROW WARNING SIGN PLACEMENT	
STATE OF WISCONSIN DEPARTMENT OF TRANSPORTATION	
APPROVED 7/2018 DATE	/S/ Matthew R. Rauch STATE SIGNING AND MARKING ENGINEER



GENERAL NOTES

PLACE GROOVE 3 INCHES LEFT OF JOINT.

LEGEND

-  DIRECTION OF TRAVEL
-  SIGN ON PERMANENT SUPPORT

PAVEMENT MARKING FOR EXIT RAMP

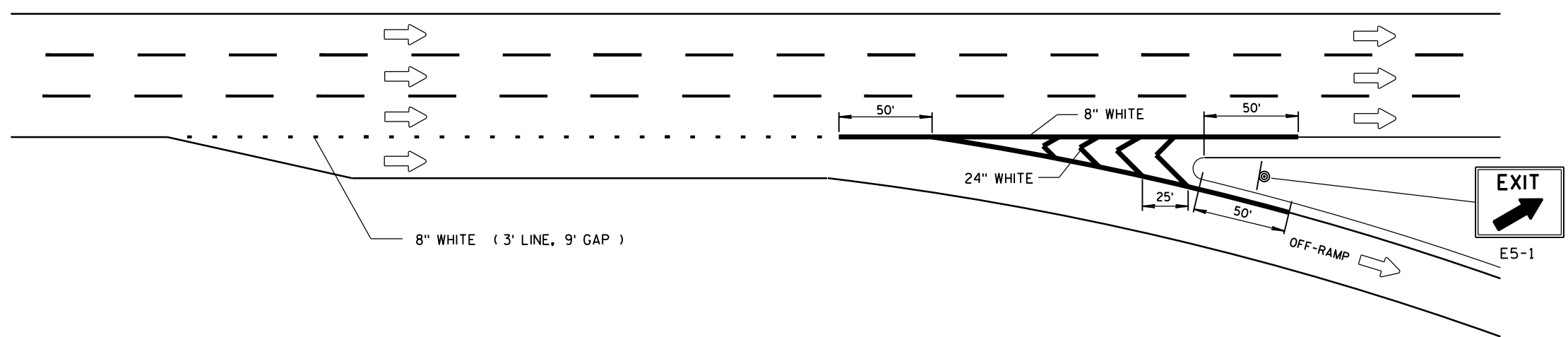

SERVICE INTERCHANGE PAVEMENT MARKING FOR PARALLEL EXIT-RAMP

6

6

S.D.D. 15 C 31-3a

S.D.D. 15 C 31-3a

<p>PAVEMENT MARKING (RAMPS AND GORES)</p>
<p>STATE OF WISCONSIN DEPARTMENT OF TRANSPORTATION</p>

GENERAL NOTES

PLACE GROOVE 3 INCHES LEFT OF JOINT.

① 1/2 LENGTH OF FULL WIDTH ACCELERATION LANE.

PAVEMENT MARKING FOR ENTRANCE RAMP

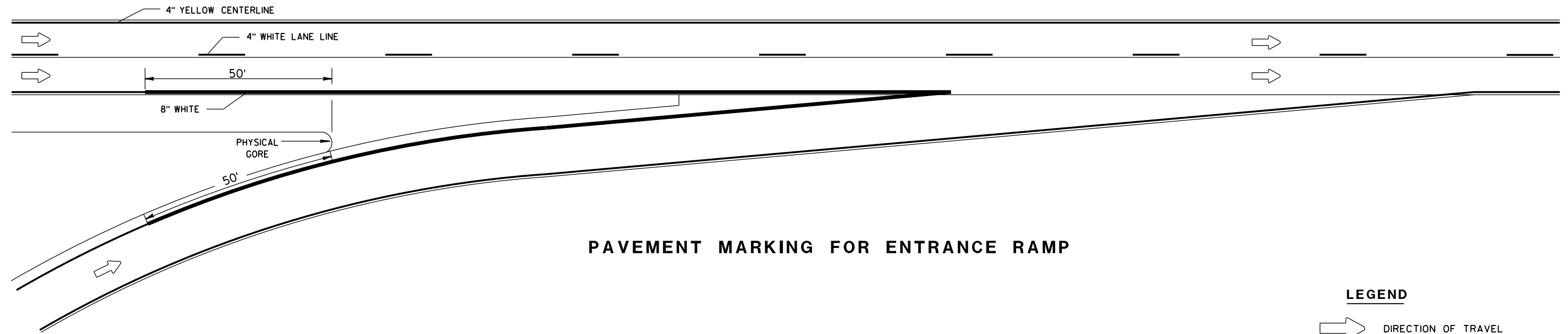

LEGEND

➔ DIRECTION OF TRAVEL

6

6

SERVICE INTERCHANGE PAVEMENT MARKING FOR PARALLEL ENTRANCE-RAMP

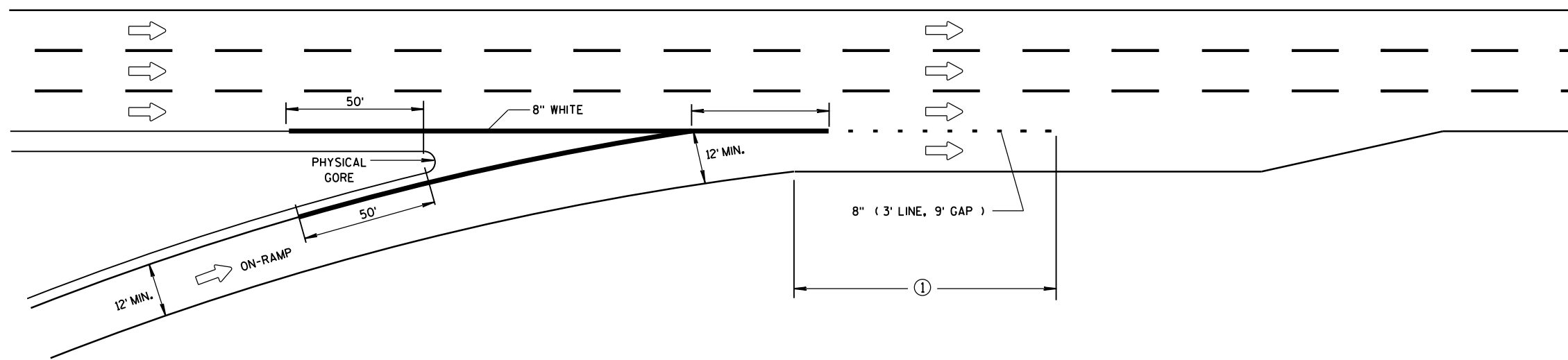

**PAVEMENT MARKING FOR
PARALLEL ON-RAMP AND
PARALLEL OFF-RAMP**

STATE OF WISCONSIN
DEPARTMENT OF TRANSPORTATION

APPROVED
DATE: Sept., 2017 /S/ Matthew R. Rauch
STATE SIGNING AND MARKING ENGINEER
FHWA

S.D.D. 15 C 31-3c

S.D.D. 15 C 31-3c

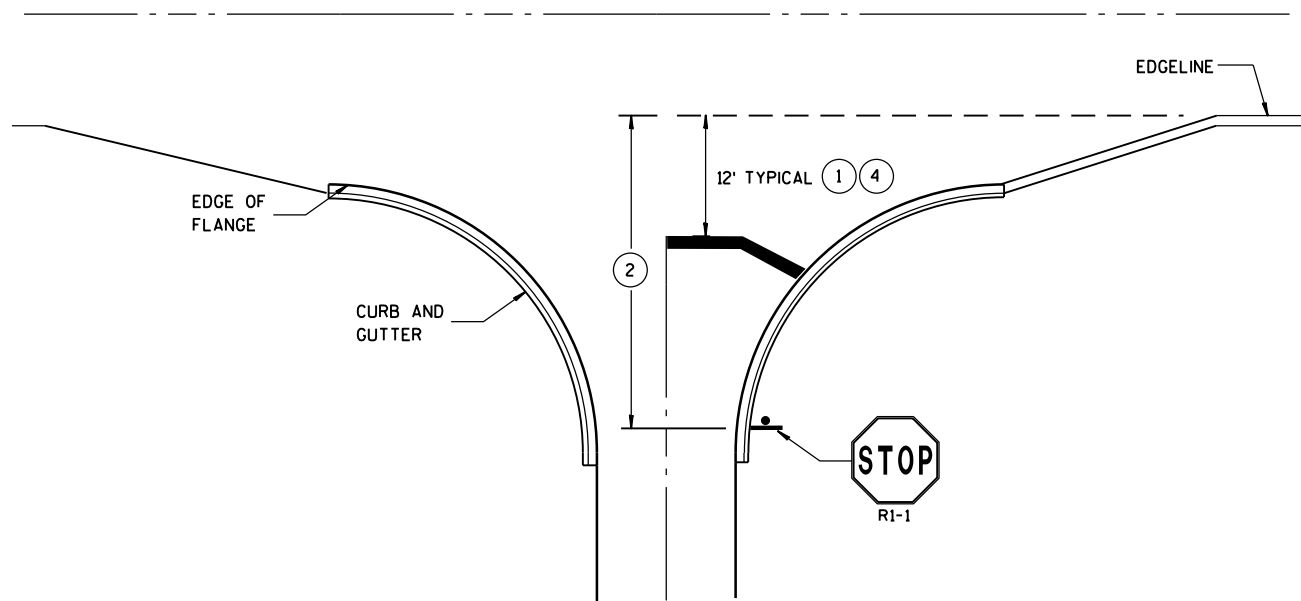

TYPICAL STOP LINE PAVEMENT MARKING WITH CURB AND GUTTER

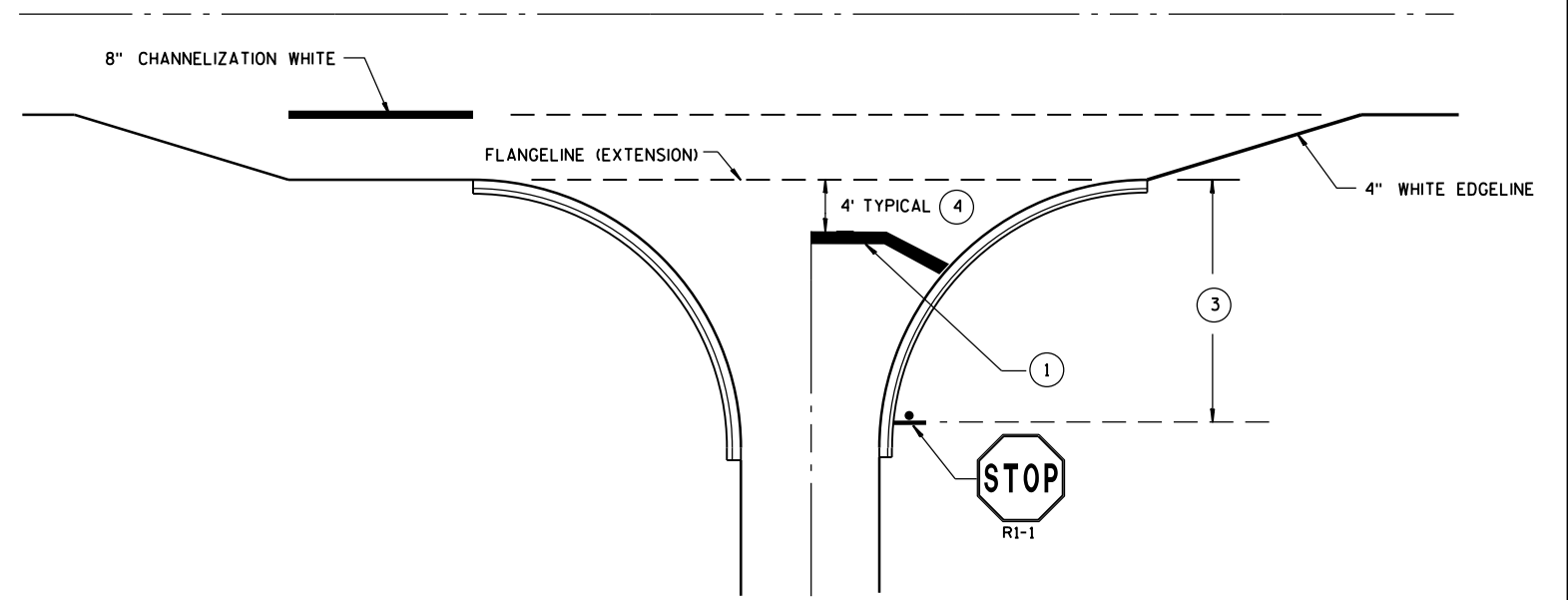

TYPICAL STOP LINE PAVEMENT MARKING FOR SIDEROADS WITH RIGHT TURN LANE

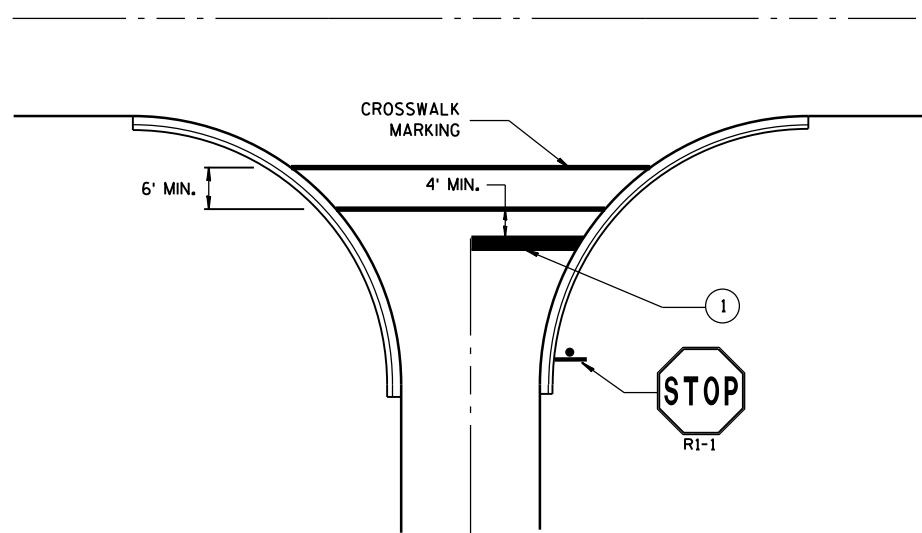

TYPICAL STOP LINE PAVEMENT MARKING FOR SIDEROADS WITH CROSSWALK MARKING

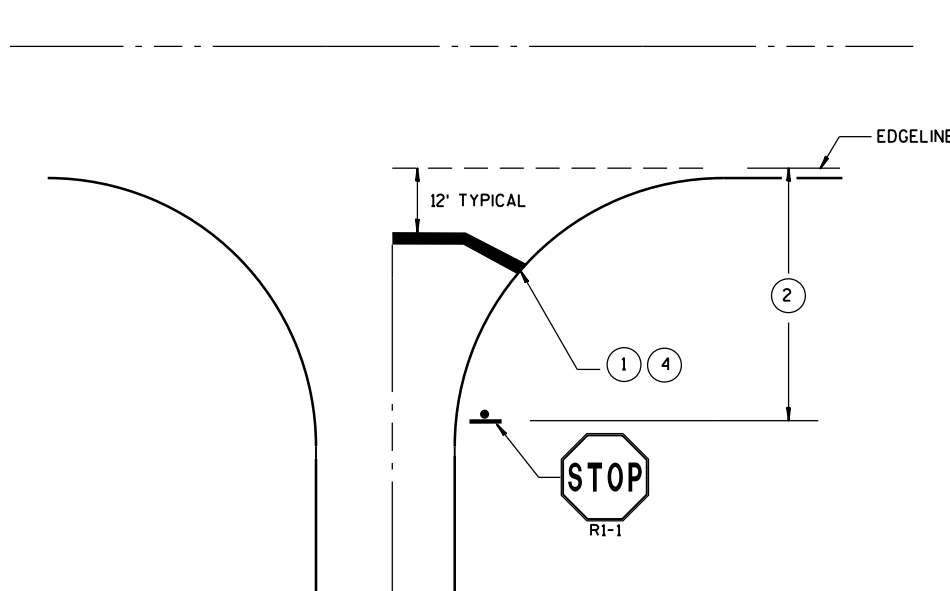

TYPICAL STOP LINE PAVEMENT MARKING WITHOUT CURB AND GUTTER

GENERAL NOTES

STOP SIGN SHALL BE PLACED A MINIMUM OF 6 FEET TO A MAXIMUM OF 50 FEET FROM THE EDGELINE LOCATION.

- ① 18-INCH STOP LINES MAY BE DELETED OR ADDED BY THE PROJECT ENGINEER BASED ON VISIBILITY AND SIGHT LINES.
- ② IF STOP SIGN IS LESS THAN OR EQUAL TO 40 FEET FROM THE EDGELINE THAN NO STOP LINE IS REQUIRED.
- ③ IF STOP SIGN IS LESS THAN OR EQUAL TO 30 FEET FROM THE FLANGELINE EXTENSION THAN NO STOP LINE IS REQUIRED.
- ④ MOVE CLOSER TO EDGE OF TRAVEL LANE AS NEEDED FOR VISIBILITY AND SIGHT LINES. (NO CLOSER THAN 4 FEET).

STOP LINE AND CROSSWALK PAVEMENT MARKING

STATE OF WISCONSIN
DEPARTMENT OF TRANSPORTATION

APPROVED
DATE: Sept., 2017 /S/ Matthew R. Rauch
STATE SIGNING AND MARKING ENGINEER
FHWA

Notes



Wisconsin Department of Transportation

Dedicated people creating transportation solutions through innovation and exceptional service.

<http://www.dot.wisconsin.gov>