

LAX

PROJECT ID: 1009-11-99

WITH:

COUNTY: VARIOUS COUNTIES

SOUTHWEST REGION

APRIL 2018

ORDER OF SHEETS

Section No. 1	Title
<del>Section No. 2</del>	<del>Typical Conditions and Details</del>
Section No. 3	Estimate of Quantities
Section No. 3	Miscellaneous Quantities
<del>Section No. 4</del>	<del>Right of Way Plan</del>
<del>Section No. 5</del>	<del>Plan and Profile</del>
Section No. 6	Standard Detail Drawings
<del>Section No. 7</del>	<del>Sign Plans</del>
<del>Section No. 8</del>	<del>Structure Plans</del>
<del>Section No. 9</del>	<del>Computer Earthwork Data</del>
<del>Section No. 9</del>	<del>Cross Sections</del>

TOTAL SHEETS = 18

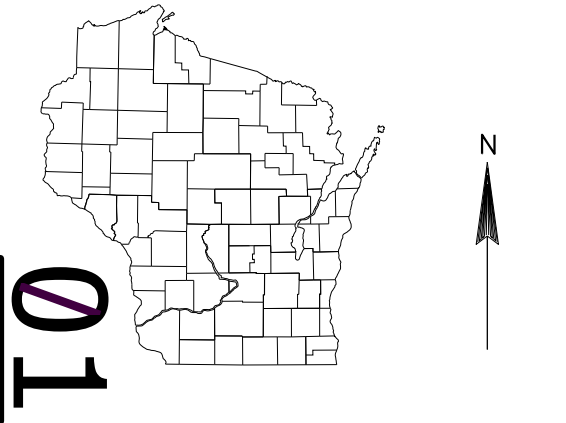

DESIGN DESIGNATION

A.A.D.T.	=
A.A.D.T.	=
D.H.V.	=
D.D.	=
T.	=
DESIGN SPEED	=
ESALS	=

CONVENTIONAL SYMBOLS

PLAN		PROFILE
CORPORATE LIMITS		GRADE LINE
PROPERTY LINE		ORIGINAL GROUND
LOT LINE		MARSH OR ROCK PROFILE
LIMITED HIGHWAY EASEMENT		(To be noted as such)
EXISTING RIGHT OF WAY		SPECIAL DITCH
PROPOSED OR NEW R/W LINE		
SLOPE INTERCEPT		GRADE ELEVATION
REFERENCE LINE		CULVERT (Profile View)
EXISTING CULVERT		UTILITIES
PROPOSED CULVERT		ELECTRIC
(Box or Pipe)		FIBER OPTIC
COMBUSTIBLE FLUIDS		GAS
		SANITARY SEWER
		STORM SEWER
		TELEPHONE
MARSH AREA		WATER
		UTILITY PEDESTAL
WOODED OR SHRUB AREA		POWER POLE
		TELEPHONE POLE

STATE OF WISCONSIN

DEPARTMENT OF TRANSPORTATION

PLAN OF PROPOSED IMPROVEMENT

SW REGION PVMT MARKING EASTERN CTYS

STN LOCATIONS PER ANNUAL PLAN

VAR HWY

SW REGION WIDE

STATE PROJECT NUMBER

1009-11-99

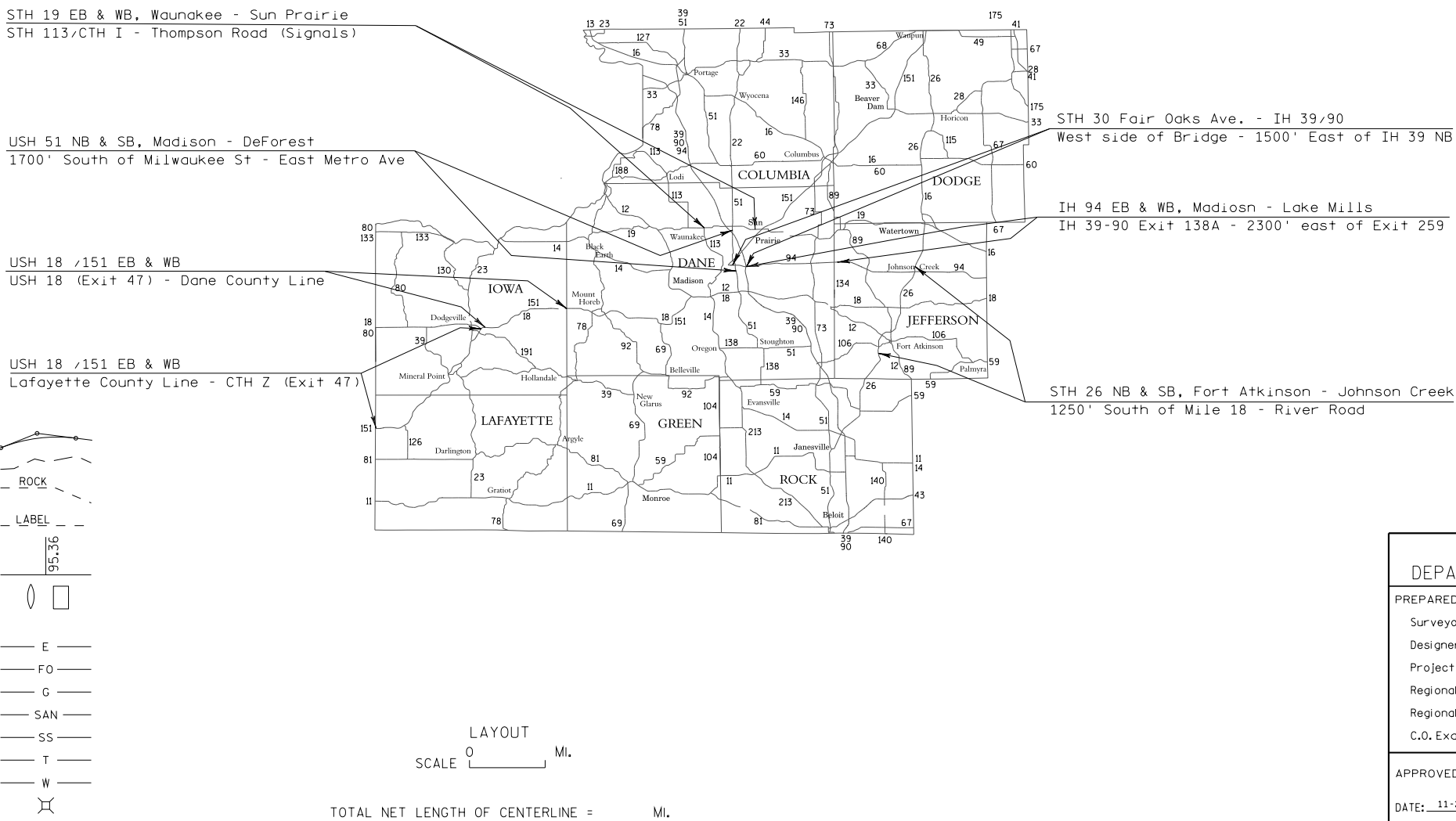

STATE PROJECT	FEDERAL PROJECT	
	PROJECT	CONTRACT
1009-11-99		

STATE OF WISCONSIN  
DEPARTMENT OF TRANSPORTATION

PREPARED BY

Surveyor	
Designer	IVER PETERSON
Project Manager	
Regional Examiner	
Regional Supervisor	KAREN OLSON
C.O. Examiner	

APPROVED FOR THE DEPARTMENT

DATE: 11-27-2017

Karen L Olson

(Signature)

E

GENERAL NOTES

THERE ARE UTILITY FACILITIES WITHIN THE PROJECT AREA THAT ARE NOT SHOWN ON THE PLANS. THE CONTRACTOR SHALL COORDINATE HIS CONSTRUCTION ACTIVITIES WITH A CALL TO DIGGERS HOTLINE AND/OR A DIRECT CALL TO THE UTILITIES THAT HAVE FACILITIES IN THE AREA. NOT ALL UTILITIES ARE MEMBERS OF DIGGERS HOTLINE.

DESIGN CONTACTS

PROJECT MANAGER  
IVER R. PETERSON  
WISDOT SW REGION  
3550 MORMON COULEE ROAD  
LA CROSSE, WI 54601  
608-785-9060  
[iver.peterson@dot.wi.gov](mailto:iver.peterson@dot.wi.gov)

PROJECT SUPERVISOR  
KAREN OLSON  
WISDOT SW REGION  
3550 MORMON COULEE ROAD  
LA CROSSE, WI 54601  
608-792-7479  
[karen.olson@dot.wi.gov](mailto:karen.olson@dot.wi.gov)



Estimate Of Quantities

1009-11-99					
Line	Item	Item Description	Unit	Total	Qty
0002	619.1000	Mobilization	EACH	1.000	1.000
0004	643.5000	Traffic Control	EACH	1.000	1.000
0006	646.1020	Marking Line Epoxy 4-Inch	LF	2,178,320.000	2,178,320.000
0008	646.3020	Marking Line Epoxy 8-Inch	LF	111,129.000	111,129.000

PAVEMENT MARKING EPOXY (DIVIDED / UNDIVIDED HIGHWAYS)			646.1020				646.3020		
DANE COUNTY			4-INCH EDGE LINE YELLOW L.F.	4-INCH CENTERLINE NO PASSING YELLOW L.F.	4-INCH LANE LINE WHITE L.F.	4-INCH EDGE LINE WHITE L.F.	8-INCH CHANNELIZING WHITE (MAINLINE) L.F.	8-INCH CHANNELIZING WHITE (RAMP) L.F.	8-INCH CHANNELIZING WHITE (ISLAND GORE) L.F.
HIGHWAY	LOCATION (From)	LOCATION (To)							
STH 30 EB	DANE COUNTY								
	Fair Oaks Ave Bridge (West side of bridge deck)	1500' East of IH39-90 NB Bridge	13056		3386	10874			
	Exit for Fair Oaks	OFF Ramp		430		472			
	Exit for Fair Oaks	ON Ramp	180	500		583	195	195	
	Exit for USH 51 (Stoughton Rd)	OFF Ramp	769			1274	503	503	400
	Exit for USH 51 (Stoughton Rd)	ON Ramp	1070		320	1907	460	369	
	Exit for CTH T ( Thompson Dr)	OFF Ramp	100			9123	887	887	
	Exit for IH 39-90 SB to Janesville/Chicago	OFF Ramp				540	264	264	
	Exit for IH 39-90 NB to Wisconsin Dells	OFF Ramp	663				343	343	
	ON Ramp from IH 39-90 NB	ON Ramp from IH 39-90 NB to STH 30 EB				1324	357	357	
	ON Ramp from IH 39-90 SB	ON Ramp from IH 39-90 SB to STH 30 EB	1914				356	358	
STH 30 WB	IH 94 Mile Marker 248.0 WB	Fair Oaks Ave Bridge (West side of bridge deck)	14487		4089	11853			
	Exit 240 for STH 30 WB	OFF Ramp to STH 30 WB					410	408	
	Exit 4-A for IH39-90 SB to Janesville	OFF Ramp to IH 39-90 SB					211	211	
	ON Ramp from IH 39-90 SB	ON Ramp from IH 39-90 SB to STH 30 WB				1346	782	775	
	ON Ramp from IH 39-90 NB	ON Ramp from IH 39-90 NB to STH 30 EB	2386				630	630	
	ON Ramp from Commercial Ave	ON Ramp from Commercial Ave/CTH T to STH 30 WB	445			444	508	510	
	Exit for USH 51 (Stoughton Rd)	OFF Ramp to USH 51 (Stoughton Rd)	1063		179	1488	417	412	686
	Exit for USH 51 (Stoughton Rd)	ON Ramp from USH 51 (Stoughton Rd)	778		314	1105	731	731	
	Exit for Fair Oaks Ave	OFF Ramp to Fair Oaks Ave				325	325	325	153
	Exit for Fair Oaks Ave	ON Ramp form Fair Oaks Ave to STH 30 WB		800		810			
STH 19 (EB & WB)	STH 113/CTH I (Waunakee)	Thompson Rd Signals (Sun Prairie)	25450	44087	1095	86200	6735		
Sub Totals			62361	45817	9383	129668	14114	7278	1239

PAVEMENT MARKING EPOXY (DIVIDED HIGHWAYS)			646.1020			646.3020		
DANE COUNTY			4-INCH EDGE LINE YELLOW L.F.	4-INCH LANE LINE WHITE L.F.	4-INCH EDGE LINE WHITE L.F.	8-INCH CHANNELIZING WHITE (MAINLINE) L.F.	8-INCH CHANNELIZING WHITE (RAMP) L.F.	8-INCH CHANNELIZING WHITE (ISLAND GORE) L.F.
HIGHWAY	LOCATION (From)	LOCATION (To)						
USH 51 NB	DANE COUNTY							
	1700' South of Milwaukee St Bridge (Madison)	East Metro Dr (Deforest)	32091	10607	31435	8546		
	Exit to Milwaukee St (Madison)	OFF Ramp	496	51	932	245	245	250
USH 51 SB	Exit to Milwaukee St (Madison)	ON Ramp	1196	250	2699	265	265	250
	East Metro Dr (Deforest)	1700' South of Milwaukee St Bridge (Madison)	33157	11221	29740	7739		
	Exit to Milwaukee St (Madison)	OFF Ramp	1783	350	2639			
	Exit to Milwaukee St (Madison)	ON Ramp	524		1779	659	659	
Sub Totals			69247	22479	69224	17454	1169	500

PAVEMENT MARKING EPOXY (DIVIDED HIGHWAYS)			646.1020			646.3020		
IOWA & LAFAYETTE COUNTIES			4-INCH EDGE LINE YELLOW L.F.	4-INCH LANE LINE WHITE L.F.	4-INCH EDGE LINE WHITE L.F.	8-INCH CHANNELIZING (MAINLINE) WHITE L.F.	8-INCH CHANNELIZING (RAMP) WHITE L.F.	8-INCH CHANNELIZING (ISLAND GORE) WHITE L.F.
HIGHWAY	LOCATION (From)	LOCATION (To)						
USH 18/151 EB	IOWA COUNTY							
	Exit 47 at USH 18 (Dodgeville)	Dane Co Line	71500	16789	68986	1784		
	Exit 58 at CTH ID (Barneveld)	OFF Ramp				367	765	
USH 18/151 WB	Exit 58 at CTH ID (Barneveld)	ON Ramp				765	763	
	Dane Co Line	Exit 47 USH 151	71202	17640	70849	2165		
	Exit 58 at CTH ID (Barneveld)	OFF Ramp				330	327	113
USH 151 NB	Exit 58 at CTH ID (Barneveld)	ON Ramp				668	668	
	IOWA & LAFAYETTE COUNTIES							
	340' south of Lafayette Co sign (Platteville)	CTH Z east of Exit 47 at USH 18 (Dodgeville)	133134	29157	130364	8110		
USH 151 NB	Exit 26 at STH 126 (Belmont)	OFF Ramp	1161		1719	389	388	
	Exit 26 at STH 126 (Belmont)	ON Ramp	811		2107	725	722	
	Exit 37 at CTH O (Mineral Point)	OFF Ramp				354	357	
	Exit 37 at CTH O (Mineral Point)	ON Ramp				850	842	46
	Exit 40 at STH 39 (Mineral Point)	OFF Ramp				389	390	
	Exit 40 at STH 39 (Mineral Point)	ON Ramp				765	759	
	Exit 44 at STH 23 (Dodgeville)	OFF Ramp				200	200	
	Exit 44 at STH 23 (Dodgeville)	ON Ramp				750	750	
	Exit 47 at USH 18 (Dodgeville)	OFF Ramp				285	285	
	Exit 47 at USH 18 (Dodgeville)	ON Ramp				815	815	
	CTH Z east of Exit 47 at USH 18 (Dodgeville)	550' north of Exit 21 OFF Ramp at CTH XX (Platteville)	137755	35015	128377	8110		
	Exit 47 at USH 18 (Dodgeville)	OFF Ramp				750	750	
	Exit 47 at USH 18 (Dodgeville)	ON Ramp				685	685	
	Exit 44 at STH 23 (Dodgeville)	OFF Ramp				285	285	
	Exit 44 at STH 23 (Dodgeville)	ON Ramp				685	685	
USH 151 SB	Exit 40 at STH 39 (Mineral Point)	OFF Ramp				399	338	
	Exit 40 at STH 39 (Mineral Point)	ON Ramp				874	874	
	Exit 37 at CTH O (Mineral Point)	OFF Ramp				379	378	
	Exit 37 at CTH O (Mineral Point)	ON Ramp				833	795	
	Exit 26 at STH 126 (Belmont)	OFF Ramp	1123		1676	382	383	
	Exit 26 at STH 126 (Belmont)	ON Ramp	779		2208	740	742	
Sub Totals			417465	98601	406286	33833	13946	159

PAVEMENT MARKING EPOXY (DIVIDED HIGHWAYS)						646.3020		
JEFFERSON COUNTY						646.1020		
HIGHWAY	LOCATION (From)	LOCATION (To)	4-INCH EDGE LINE YELLOW L.F.	4-INCH LANE LINE WHITE L.F.	4-INCH EDGE LINE WHITE L.F.	8-INCH CHANNELIZING (MAINLINE) WHITE L.F.	8-INCH CHANNELIZING (RAMP) WHITE L.F.	8-INCH CHANNELIZING (ISLAND GORE) WHITE L.F.
STH 26 NB	JEFFERSON COUNTY							
	1250' south of MM 18 (Fort Atkinson)	River Rd (Johnson Creek)	90399	22600	78881			
	Exit 19 at STH 106 (Fort Atkinson)	OFF Ramp				505	315	
	Exit 19 at STH 106 (Fort Atkinson)	ON Ramp				888	868	
	Exit 21 at USH 12 (Fort Atkinson)	OFF Ramp				214	214	
	Exit 21 at USH 12 (Fort Atkinson)	ON Ramp				749	729	
	Exit 23 at Business 26 (Fort Atkinson)	OFF Ramp				253	253	
	Exit 23 at Business 26 (Fort Atkinson)	ON Ramp				619	553	
	Exit 25 at Business 26/ TO STH 89 (Jefferson)	OFF Ramp				377	277	80
	Exit 25 at Business 26/ TO STH 89 (Jefferson)	ON Ramp				432	382	
	Exit 27 at USH 18 (Jefferson)	OFF Ramp				408	373	102
	Exit 27 at USH 18 (Jefferson)	ON Ramp				348	198	
	Exit 30 at Business 26 (Jefferson)	OFF Ramp				350	251	
	Exit 30 at Business 26 (Jefferson)	ON Ramp				340	288	
STH 26 SB	River Rd (Johnson Creek)	1250' south of MM 18 (Fort Atkinson)	90451	22630	78801			
	Exit 30 at Business 26 (Jefferson)	OFF Ramp				402	311	150
	Exit 30 at Business 26 (Jefferson)	ON Ramp				531	469	
	Exit 27 at USH 18 (Jefferson)	OFF Ramp				425	275	225
	Exit 27 at USH 18 (Jefferson)	ON Ramp				494	424	
	Exit 25 at Business 26/ TO STH 89 (Jefferson)	OFF Ramp				374	259	90
	Exit 25 at Business 26/ TO STH 89 (Jefferson)	ON Ramp				520	455	
	Exit 23 at Business 26 (Fort Atkinson)	OFF Ramp				386	386	81
	Exit 23 at Business 26 (Fort Atkinson)	ON Ramp				401	341	70
	Exit 21 at USH 12 (Fort Atkinson)	OFF Ramp				244	244	
	Exit 21 at USH 12 (Fort Atkinson)	ON Ramp				629	609	
	Exit 19 at STH 106 (Fort Atkinson)	OFF Ramp				323	323	
	Exit 19 at STH 106 (Fort Atkinson)	ON Ramp				725	705	
Sub Totals			180850	45230	157682	10937	9502	798

PAVEMENT MARKING EPOXY (INTERSTATE LOCATIONS)				646.1020			646.3020
DANE & JEFFERSON COUNTIES				4-INCH EDGE LINE YELLOW L.F.	4-INCH LANE LINE WHITE L.F.	4-INCH EDGE LINE WHITE L.F.	8-INCH CHANNELIZING WHITE (ISLAND GORE) L.F.
HIGHWAY	LOCATION (From)	LOCATION (To)					
IH 94 EB	DANE & JEFFERSON COUNTIES						
	Mile Marker 240.8 (Exit 138A) at the IH 39/90/94 split - Madison	2300' East of Exit 259 - STH 89 Lake Mills		101112	17576	93192	
	Exit 244 at CTH N	OFF Ramp		1480		1990	
	Exit 244 at CTH N	ON Ramp		1066		3334	
	Exit 250 at STH 73	OFF Ramp		581		1560	50
	Exit 250 at STH 73	ON Ramp		671		2112	
	Exit 259 at STH 89	OFF Ramp		916		1830	50
	Exit 259 at STH 89	ON Ramp		660		1992	
IH 94 WB	2300' East of Exit 259 - STH 89 Lake Mills	500' north of MM 240.6 (IH 39/90 top of On Ramp)		102590	17980	94566	
	Exit 259 at STH 89	OFF Ramp		1101		1997	50
	Exit 259 at STH 89	ON Ramp		951		2683	
	Exit 250 at STH 73	OFF Ramp		897		1612	50
	Exit 250 at STH 73	ON Ramp		525		2017	
	Exit 244 at CTH N	OFF Ramp		788		1343	
	Exit 244 at CTH N	ON Ramp		1330	185	3390	
Sub Totals				214668	35741	213618	200

NOTE: Existing Reflective Tape (Channelizing Lines) Are to Remain

PAVEMENT MARKING EPOXY SUMMARY								
		646.1020				646.3020		
HIGHWAY	COUNTY	4-INCH EDGE LINE YELLOW L.F.	4-INCH CENTERLINE NO PASSING YELLOW L.F.	4-INCH LANE LINE WHITE L.F.	4-INCH EDGE LINE WHITE L.F.	8-INCH CHANNELIZING WHITE (MAINLINE) L.F.	8-INCH CHANNELIZING WHITE (RAMP) L.F.	8-INCH CHANNELIZING WHITE (ISLAND GORE) L.F.
STH 19 / STH 30	Dane County	62361	45817	9383	129668	14114	7278	1239
USH 51	Dane County	69247		22479	69224	17454	1169	500
USH 18/151	Iowa & Lafayette Counties	417465		98601	406286	33833	13946	159
STH 26	Jefferson County	180850		45230	157682	10937	9502	798
IH 94	Dane & Jefferson Counties	214668		35741	213618			200
		944591	45817	211434	976478	76338	31895	2896
		TOTAL 4-INCH 2178320				TOTAL 8-INCH 111129		

Standard Detail Drawing List

15C08-18A	LONGI TUD I N A L   M A R K I N G   ( M A I N L I N E )
15C08-18B	PA V E M E N T   M A R K I N G   ( T U R N   L A N E S )
15C19-04A	M O V I N G   P A V E M E N T   M A R K I N G   O P E R A T I O N   T W O - L A N E   T W O - W A Y   R O A D W A Y
15C19-04B	M O V I N G   P A V E M E N T   M A R K I N G   O P E R A T I O N   M U L T I - L A N E   U N D I V I D E D   R O A D W A Y
15C19-04C	M O V I N G   P A V E M E N T   M A R K I N G   O P E R A T I O N   M U L T I - L A N E   D I V I D E D   R O A D W A Y
15C31-02A	PA V E M E N T   M A R K I N G   ( R A M P S   A N D   G O R E S )
15C31-02B	PA V E M E N T   M A R K I N G   M A J O R   S P L I T   F R E E W A Y   T O   F R E E W A Y
15C31-02C	PA V E M E N T   M A R K I N G   F O R   P A R A L L E L   O N - R A M P   A N D   P A R A L L E L   O F F - R A M P
15C35-01A	PA V E M E N T   M A R K I N G   ( I N T E R S E C T I O N S )



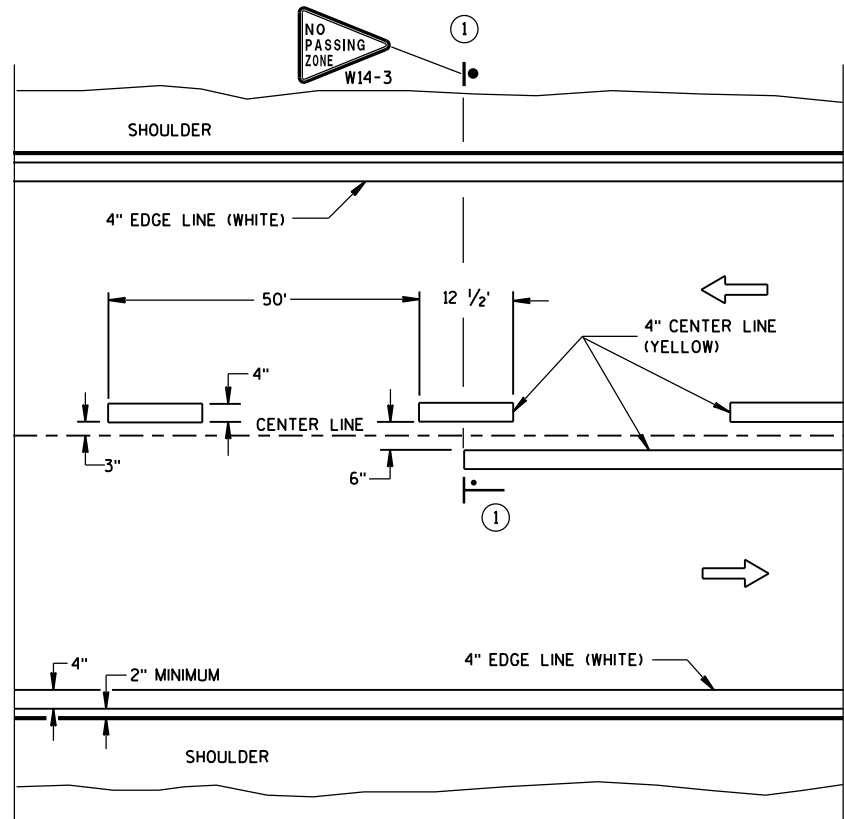

TWO WAY TRAFFIC

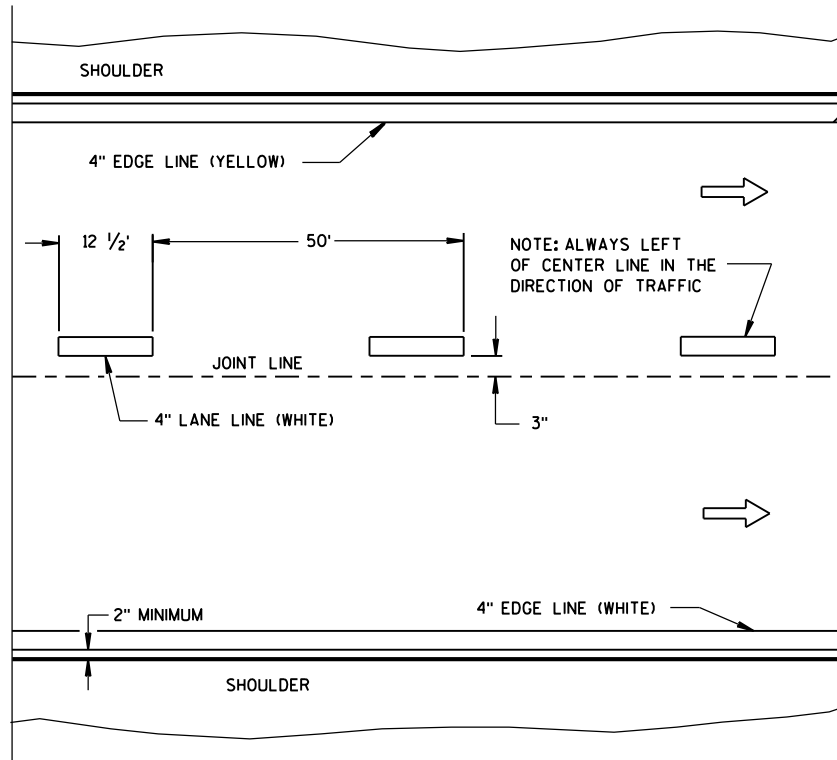

ONE WAY TRAFFIC

PERMANENT PAVEMENT MARKING

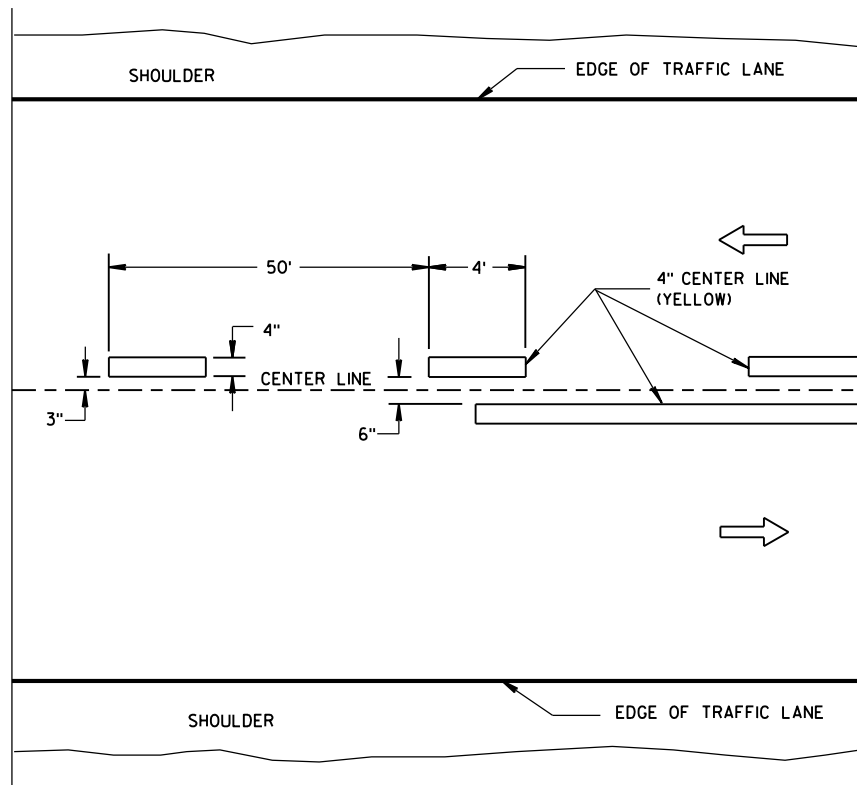

TWO WAY TRAFFIC

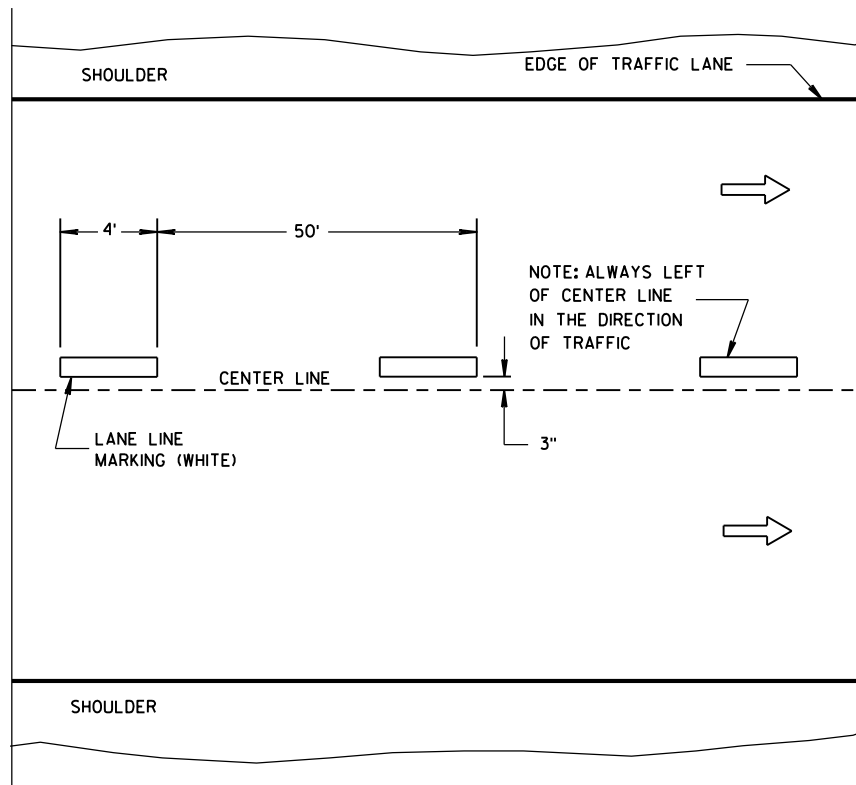

ONE WAY TRAFFIC

TEMPORARY PAVEMENT MARKING

GENERAL NOTES

DETAILS OF CONSTRUCTION NOT SHOWN ON THIS DRAWING SHALL CONFORM TO STANDARD SPECIFICATIONS AND SPECIAL PROVISIONS.

① LOCATE THE NO PASSING ZONE W14-3 SIGN WITHIN 50 FEET OF THE "T" MARKING.

NOTE

ARROW SYMBOL (→) SHOWS DIRECTION OF TRAVEL

LEGEND

├── "T" MARKING

● POST MOUNTED SIGN

LONGITUDINAL MARKING  
(MAINLINE)

STATE OF WISCONSIN  
DEPARTMENT OF TRANSPORTATION

APPROVED  
June 2017 /S/ Matthew R. Rauch  
DATE STATE SIGNING AND MARKING ENGINEER  
FHWA

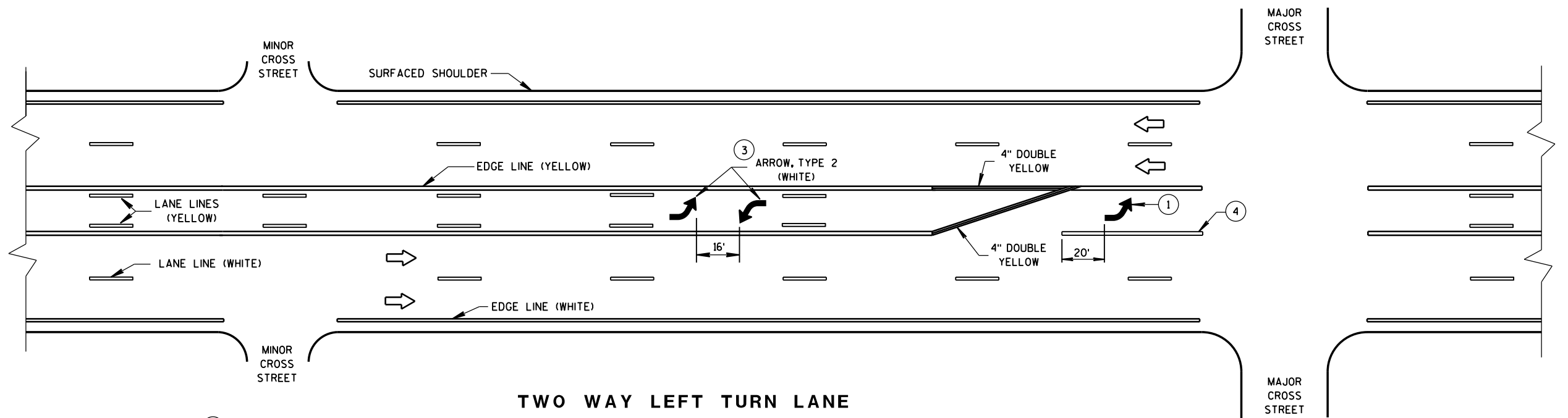
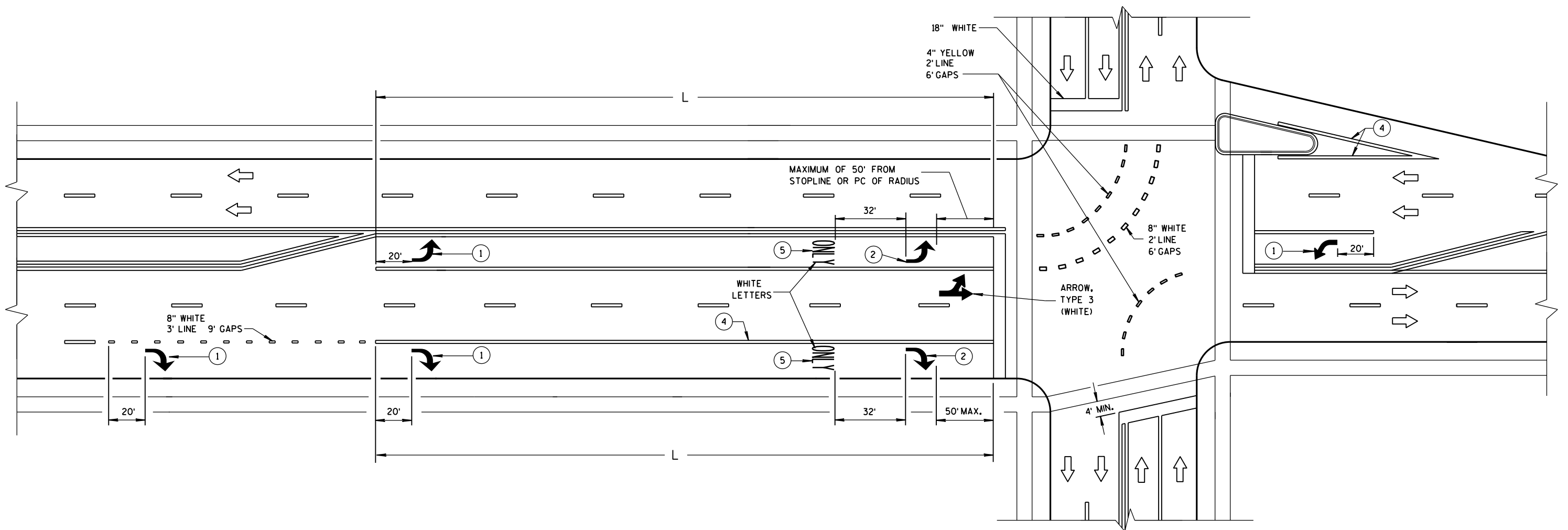

### GENERAL NOTES

- ① REQUIRED ARROW, TYPE 2 (WHITE).
- ② REQUIRED ARROW, TYPE 2 (WHITE) WHEN  $L$  IS GREATER THAN 78 FEET AND LESS THAN OR EQUAL TO 166 FEET.
- ③ A SET OF ARROWS IS REQUIRED EVERY 400 FEET OR NEAR INTERSECTIONS OR DRIVEWAYS WITH TURNING TRAFFIC.
- ④ 8" WHITE
- ⑤ REQUIRED WORD ONLY WHEN  $L$  IS GREATER THAN 166 FEET.

### TWO WAY LEFT TURN LANE

NOTE:  
ARROW SYMBOL (  )  
SHOWS DIRECTION OF TRAVEL

$L$  = LENGTH OF TURN BAY

PAVEMENT MARKING  
(TURN LANES)

STATE OF WISCONSIN  
DEPARTMENT OF TRANSPORTATION

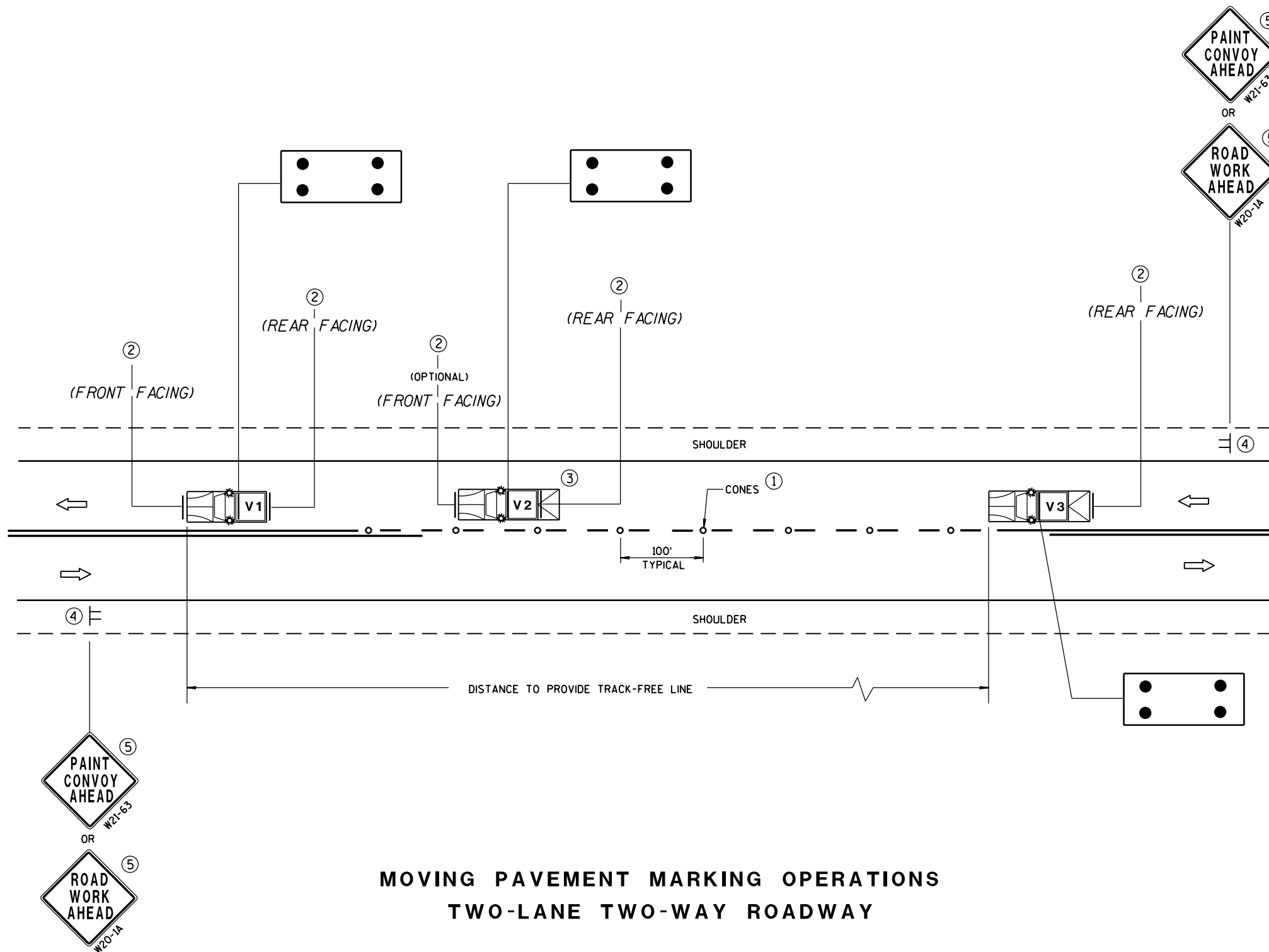

MOVING PAVEMENT MARKING OPERATIONS  
TWO-LANE TWO-WAY ROADWAY

## GENERAL NOTES

ALL VEHICLES SHALL BE EQUIPPED WITH TWO 360 DEGREE HIGH INTENSITY YELLOW FLASHING LIGHTS OR STROBE LIGHTS AND OPERATED WITH HEADLIGHTS TURNED ON.

VEHICLES SHALL BE EQUIPPED WITH REAR FACING TYPE B OR C FLASHING ARROW PANEL OPERATING IN CAUTION MODE. SIGNS PLACED ON VEHICLES MUST NOT OBSCURE THE ARROW PANEL.

ALL SIGNS ARE 48" X 48" UNLESS OTHERWISE SPECIFIED.

IF SPEED LIMIT IS 40 MPH OR LESS STATIONARY SIGNS MAY BE OMITTED IF CONES ARE USED.

ALTERNATE SIGN MESSAGES, SUCH AS "PAINT CREW AHEAD" OR "ROAD PAINTING AHEAD" MAY BE USED.

DISTANCE BETWEEN VEHICLES MAY VARY ACCORDING TO TERRAIN, SIGHT DISTANCE, PAINT DRYING TIME, AND OTHER FACTORS. WHENEVER ADEQUATE STOPPING SIGHT DISTANCE EXISTS TO THE REAR, SHADOW VEHICLES SHOULD MAINTAIN THE MINIMUM DISTANCE FROM THE WORK VEHICLE AND PROCEED AT THE SAME SPEED AS THE WORK VEHICLE. SHADOW VEHICLES SHOULD SLOW DOWN IN ADVANCE OF VERTICAL OR HORIZONTAL CURVES THAT RESTRICT SIGHT DISTANCE.

THE WORK AND SHADOW VEHICLES SHOULD PULL OVER PERIODICALLY TO ALLOW TRAFFIC TO PASS.

THIS DRAWING SHALL BE USED FOR CENTERLINE OR EDGELINE MARKING.

WHEN NO WORK ACTIVITY IS TAKING PLACE, REMOVE OR TURN THE STATIONARY WARNING SIGNS AWAY FROM TRAFFIC.

① CONES MAY BE OMITTED ON PAINTED LINE IF APPROVED BY THE ENGINEER. CONSIDER PAVEMENT MARKING DRY OR CURE TIMES AND TRAFFIC VOLUME.

② USE STANDARD SIGN W21-64 WITH APPROPRIATE ARROW.

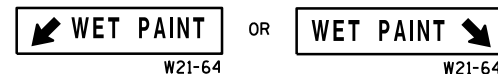

③ OPTIONAL TRUCK-MOUNTED ATTENUATOR.

④ SIGNS SHALL BE REPEATED APPROXIMATELY EVERY THREE MILES.

⑤ IF CONSTRUCTION WORK ZONE SIGNS ARE IN PLACE, W20-1 OR W21-63 ARE NOT REQUIRED.

## LEGEND

V1 LEAD VEHICLE

V2 SHADOW VEHICLE

V3 TRAIL VEHICLE WITH TMA

TMA TRUCK-MOUNTED ATTENUATOR

SIGN ON TEMPORARY SUPPORT

DIRECTION OF TRAFFIC

CONES

FLASHING ARROW PANEL (CAUTION)

MOVING PAVEMENT MARKING  
OPERATION  
TWO-LANE TWO-WAY ROADWAY

STATE OF WISCONSIN  
DEPARTMENT OF TRANSPORTATION

APPROVED  
June 2016  
DATE  
FHWA

/S/ Peter Amakobe Atepe  
STATEWIDE WORK ZONE TRAFFIC  
SAFETY ENGINEER

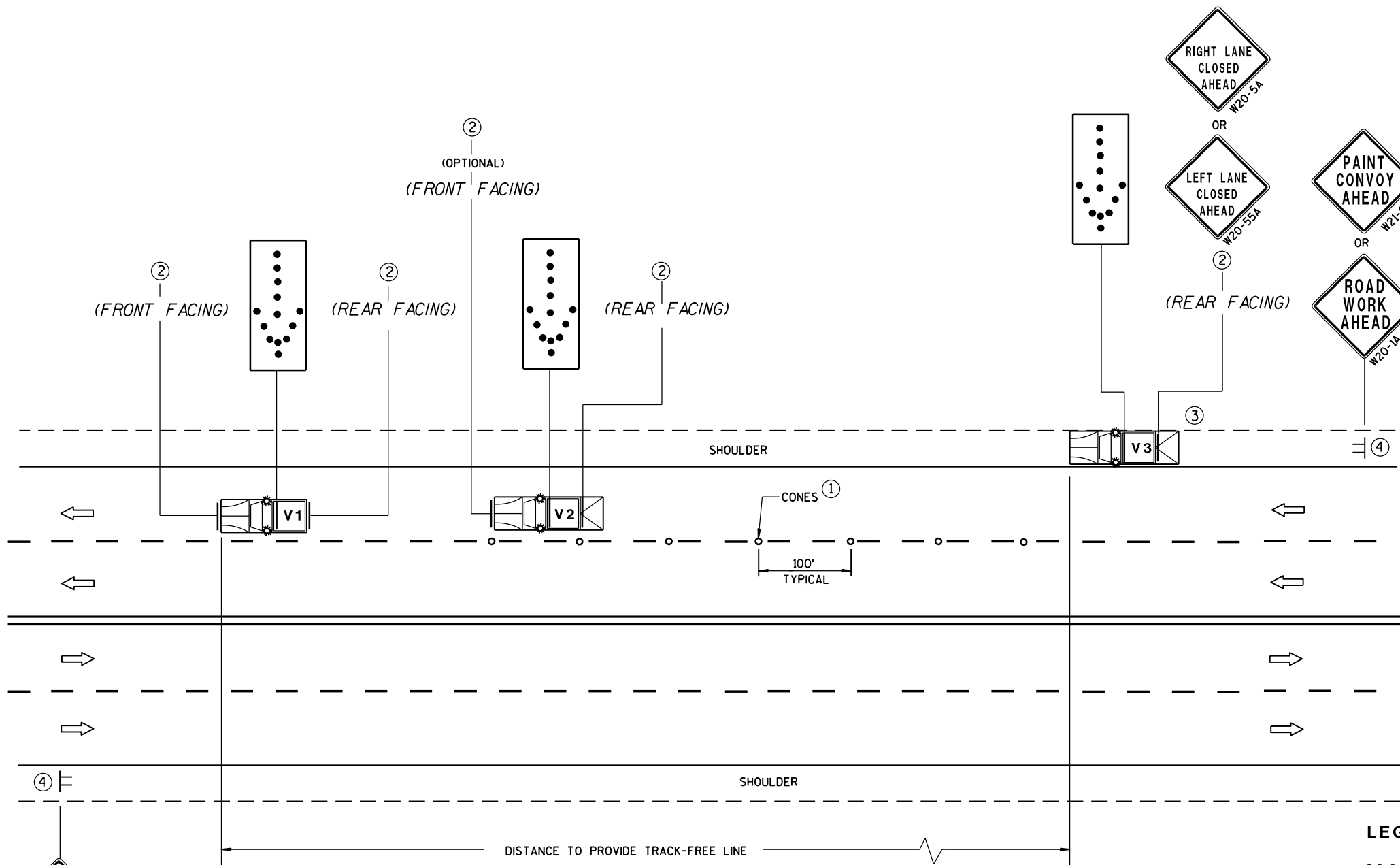

MOVING PAVEMENT MARKING OPERATIONS  
MULTI-LANE UNDIVIDED ROADWAY

GENERAL NOTES

ALL VEHICLES SHALL BE EQUIPPED WITH TWO 360 DEGREE HIGH INTENSITY YELLOW FLASHING LIGHTS OR STROBE LIGHTS AND OPERATED WITH HEADLIGHTS TURNED ON.

ALL VEHICLES SHALL BE EQUIPPED WITH REAR FACING TYPE B OR C FLASHING ARROW PANEL. SIGNS PLACED ON VEHICLES MUST NOT OBSCURE THE ARROW PANEL.

ALL SIGNS ARE 48" X 48" UNLESS OTHERWISE SPECIFIED.

IF SPEED LIMIT IS 40 MPH OR LESS STATIONARY SIGNS MAY BE OMITTED IF CONES ARE USED.

ALTERNATE SIGN MESSAGES, SUCH AS "PAINT CREW AHEAD" OR "ROAD PAINTING AHEAD" MAY BE USED.

DISTANCE BETWEEN VEHICLES MAY VARY ACCORDING TO TERRAIN, SIGHT DISTANCE, PAINT DRYING TIME, AND OTHER FACTORS. WHENEVER ADEQUATE STOPPING SIGHT DISTANCE EXISTS TO THE REAR, SHADOW VEHICLES SHOULD MAINTAIN THE MINIMUM DISTANCE FROM THE WORK VEHICLE AND PROCEED AT THE SAME SPEED AS THE WORK VEHICLE. SHADOW VEHICLES SHOULD SLOW DOWN IN ADVANCE OF VERTICAL OR HORIZONTAL CURVES THAT RESTRICT SIGHT DISTANCE.

WHEN WORK ACTIVITY BLOCKS THE LEFT LANE, REVERSE TRAFFIC CONTROL.



WHEN A RAMP INTERSECTS THE FACILITY ON WHICH THE WORK IS BEING PERFORMED, PROVIDE ADDITIONAL TRAFFIC CONTROLS AS SPECIFIED IN THE CONTRACT OR AS APPROVED BY THE ENGINEER.

USE AN ATTENUATOR ON THE REARMOST VEHICLE THAT BLOCKS ALL OR PART OF THE TRAFFIC LANE.



FOR EDGE LINE MARKING OR IF CONES ARE NOT USED, POSITION THE REARMOST SHADOW VEHICLE ON THE SHOULDER AS SHOWN IN THE MUTCD IF THE SHOULDER HAS ADEQUATE WIDTH.

WHEN NO WORK ACTIVITY IS TAKING PLACE, REMOVE OR TURN THE STATIONARY WARNING SIGNS AWAY FROM TRAFFIC.

THIS DRAWING SHALL BE USED FOR CENTERLINE OR EDGE LINE OR LANELINE MARKING FOR MULTILANE UNDIVIDED ROADWAYS.

- ① CONES MAY BE OMITTED ON PAINTED LINE IF APPROVED BY THE ENGINEER. CONSIDER PAVEMENT MARKING DRY OR CURE TIMES AND TRAFFIC VOLUME.
- ② USE STANDARD SIGN W21-64 WITH APPROPRIATE ARROW.  
 OR   
W21-64 W21-64
- ③ OPTIONAL TRUCK-MOUNTED ATTENUATOR.
- ④ SIGNS SHALL BE REPEATED APPROXIMATELY EVERY THREE MILES.
- ⑤ IF CONSTRUCTION WORK ZONE SIGNS ARE IN PLACE, W20-1 OR W21-63 ARE NOT REQUIRED.

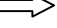
LEGEND

- V1 LEAD VEHICLE
- V2 SHADOW VEHICLE
- V3 TRAIL VEHICLE WITH TMA
- TMA TRUCK-MOUNTED ATTENUATOR
-  SIGN ON TEMPORARY SUPPORT
-  DIRECTION OF TRAFFIC
-  CONES
-  FLASHING ARROW PANEL (MERGE)

MOVING PAVEMENT MARKING  
OPERATION  
MULTI-LANE UNDIVIDED ROADWAY

STATE OF WISCONSIN  
DEPARTMENT OF TRANSPORTATION

APPROVED  
June 2016 /S/ Peter Amakobe Atepe  
DATE STATEWIDE WORK ZONE TRAFFIC  
FHWA SAFETY ENGINEER

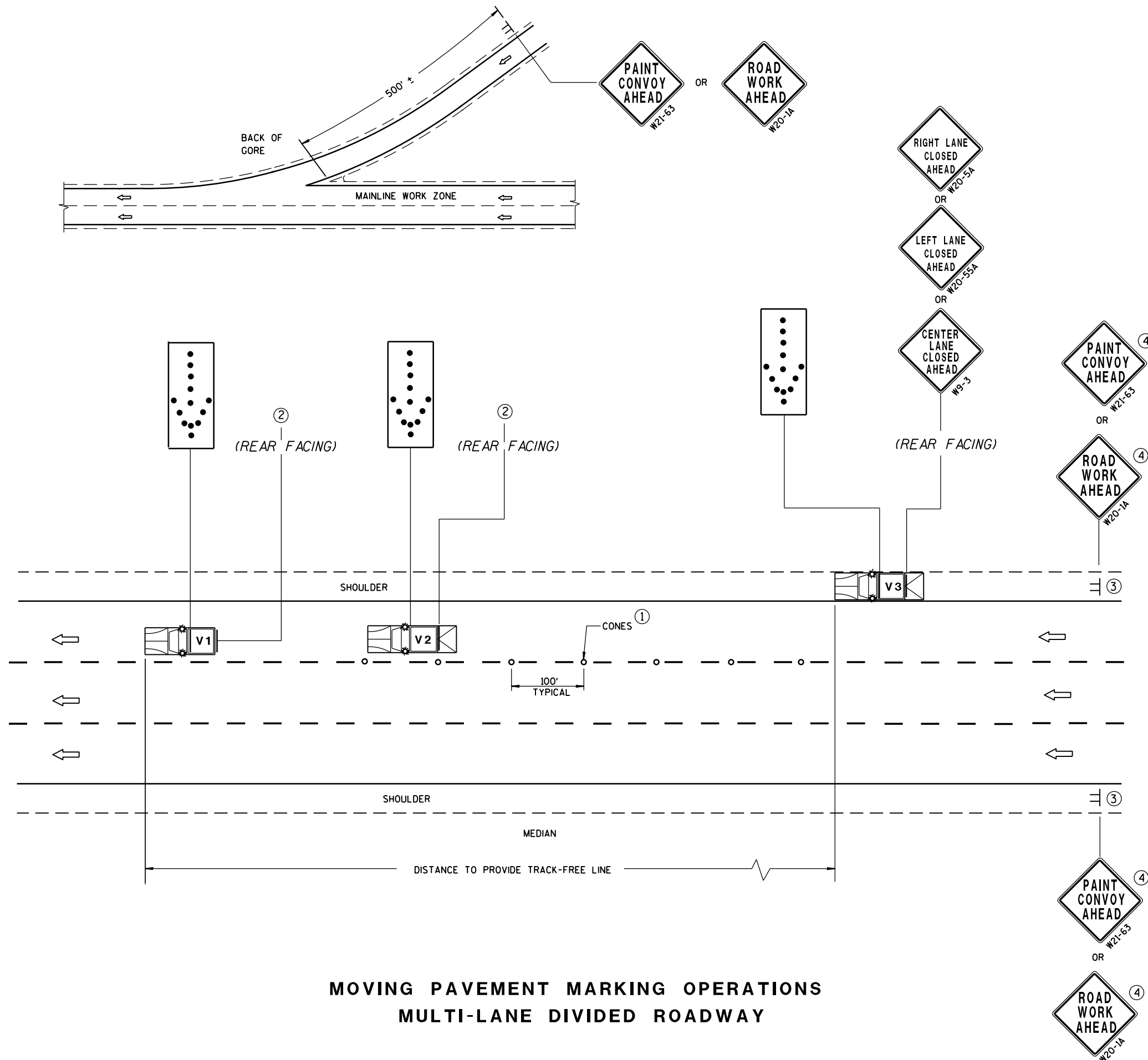

## GENERAL NOTES

ALL VEHICLES SHALL BE EQUIPPED WITH TWO 360 DEGREE HIGH INTENSITY YELLOW FLASHING LIGHTS OR STROBE LIGHTS AND OPERATED WITH HEADLIGHTS TURNED ON.

ALL VEHICLES SHALL BE EQUIPPED WITH REAR FACING TYPE B OR C FLASHING ARROW PANEL. SIGNS PLACED ON VEHICLES MUST NOT OBSCURE THE ARROW PANEL.

ALL SIGNS ARE 48" X 48" UNLESS OTHERWISE SPECIFIED.

IF SPEED LIMIT IS 40 MPH OR LESS STATIONARY SIGNS MAY BE OMITTED IF CONES ARE USED.

ALTERNATE SIGN MESSAGES, SUCH AS "PAINT CREW AHEAD" OR "ROAD PAINTING AHEAD" MAY BE USED.

DISTANCE BETWEEN VEHICLES MAY VARY ACCORDING TO TERRAIN, SIGHT DISTANCE, PAINT DRYING TIME, AND OTHER FACTORS. WHENEVER ADEQUATE STOPPING SIGHT DISTANCE EXISTS TO THE REAR, SHADOW VEHICLES SHOULD MAINTAIN THE MINIMUM DISTANCE FROM THE WORK VEHICLE AND PROCEED AT THE SAME SPEED AS THE WORK VEHICLE. SHADOW VEHICLES SHOULD SLOW DOWN IN ADVANCE OF VERTICAL OR HORIZONTAL CURVES THAT RESTRICT SIGHT DISTANCE.

WHEN WORK ACTIVITY BLOCKS THE LEFT LANE, REVERSE TRAFFIC CONTROL.

WHEN A RAMP INTERSECTS THE FACILITY ON WHICH THE WORK IS BEING PERFORMED, PROVIDE ADDITIONAL TRAFFIC CONTROLS AS SPECIFIED IN THE CONTRACT OR AS APPROVED BY THE ENGINEER.

USE AN ATTENUATOR ON THE REARMOST VEHICLE THAT BLOCKS ALL OR PART OF THE TRAFFIC LANE.

FOR EDGELINE MARKING OR IF CONES ARE NOT USED, POSITION THE REARMOST SHADOW VEHICLE ON THE SHOULDER AS SHOWN IN THE MUTCD IF THE SHOULDER HAS ADEQUATE WIDTH. USE DOUBLE ARROWS WHEN CONVOY IS IN CENTER LANE ONLY.

WHEN NO WORK ACTIVITY IS TAKING PLACE, REMOVE OR TURN THE STATIONARY WARNING SIGNS AWAY FROM TRAFFIC.

THIS DRAWING SHALL BE USED FOR EDGELINE OR LANELINE MARKING FOR MULTILANE DIVIDED ROADWAYS.

- ① CONES MAY BE OMITTED ON PAINTED LINE IF APPROVED BY THE ENGINEER. CONSIDER PAVEMENT MARKING DRY OR CURE TIMES AND TRAFFIC VOLUME.

- ② USE STANDARD SIGN W21-64 WITH APPROPRIATE ARROW.

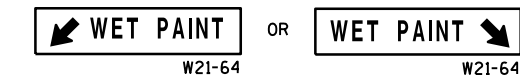

- ③ SIGNS SHALL BE REPEATED AFTER EVERY ON RAMP OR EVERY THREE MILES.

- ④ IF CONSTRUCTION WORK ZONE SIGNS ARE IN PLACE, W20-1 OR W21-63 ARE NOT REQUIRED.

## LEGEND

**V1** LEAD VEHICLE

**V2** SHADOW VEHICLE

**V3** TRAIL VEHICLE WITH TMA

 **TMA** TRUCK-MOUNTED ATTENUATOR

☐ SIGN ON TEMPORARY SUPPORT



DIRECTION OF TRAFFIC

○ CONES

FLASHING  
ARROW  
PANEL ( MERGE )

## MOVING PAVEMENT MARKING OPERATION MULTI-LANE DIVIDED ROADWAY

STATE OF WISCONSIN  
DEPARTMENT OF TRANSPORTATION

APPROVED  
June 2016 /S/ Peter Amakobe Atepe  
DATE STATEWIDE WORK ZONE TRAFFIC  
FHWA SAFETY ENGINEER

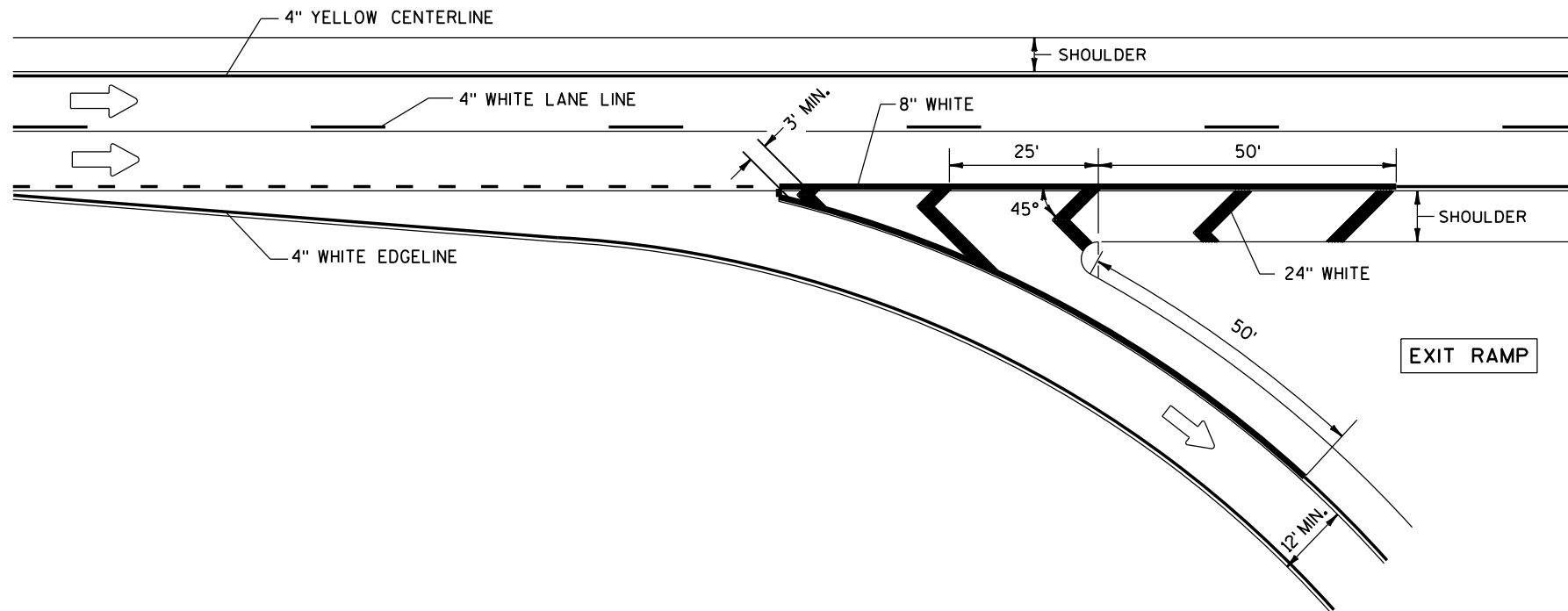

PAVEMENT MARKING FOR EXIT RAMP

## GENERAL NOTES

PLACE GROOVE 3 INCHES LEFT OF JOINT.

## LEGEND

→ DIRECTION OF TRAVEL

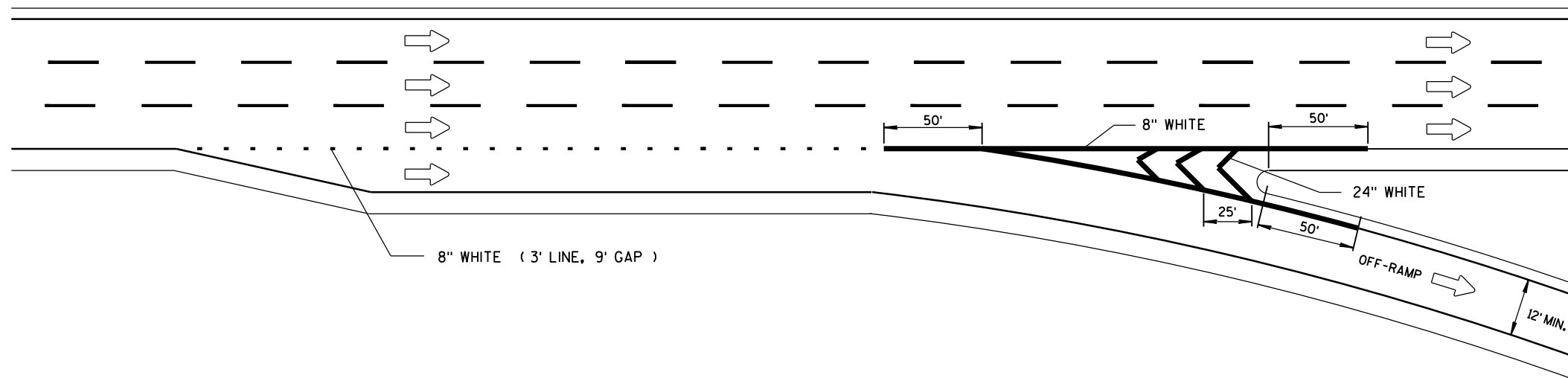

SERVICE INTERCHANGE PAVEMENT MARKING FOR PARALLEL EXIT-RAMP

PAVEMENT MARKING  
(RAMPS AND GOES)

STATE OF WISCONSIN  
DEPARTMENT OF TRANSPORTATION

**GENERAL NOTES**

PLACE GROOVE 3 INCHES LEFT OF JOINT.

**LEGEND**

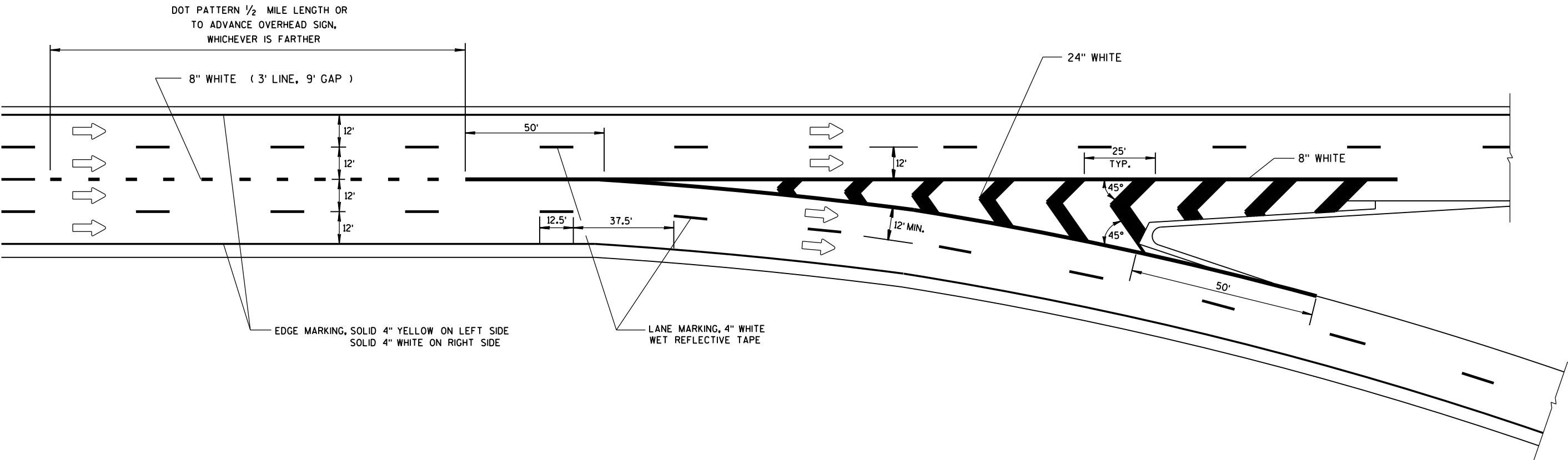

PAVEMENT MARKING  
MAJOR SPLIT  
FREEWAY TO FREEWAY

STATE OF WISCONSIN  
DEPARTMENT OF TRANSPORTATION

**GENERAL NOTES**

PLACE GROOVE 3 INCHES LEFT OF JOINT.

① 1/2 LENGTH OF FULL WIDTH ACCELERATION LANE.

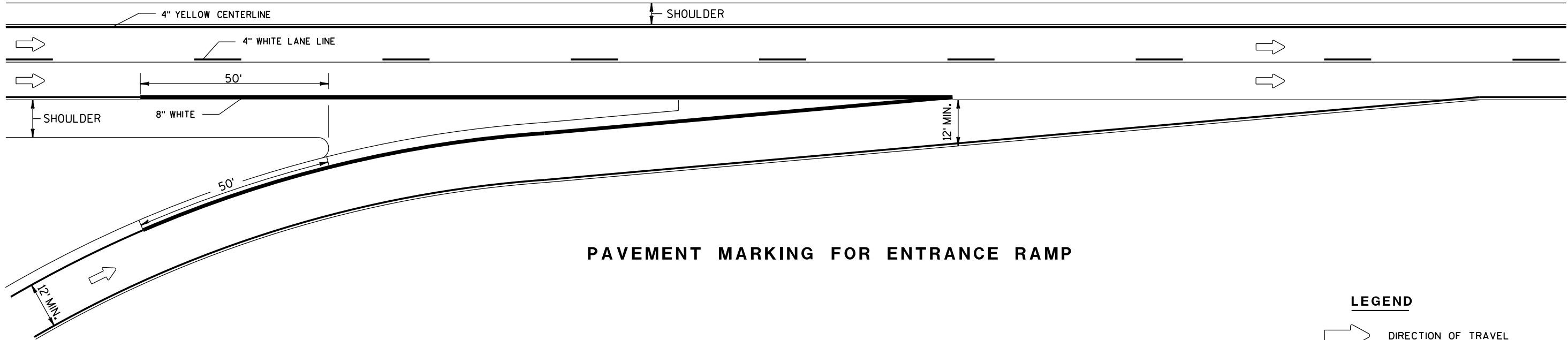

**PAVEMENT MARKING FOR ENTRANCE RAMP**

**LEGEND**

➡ DIRECTION OF TRAVEL

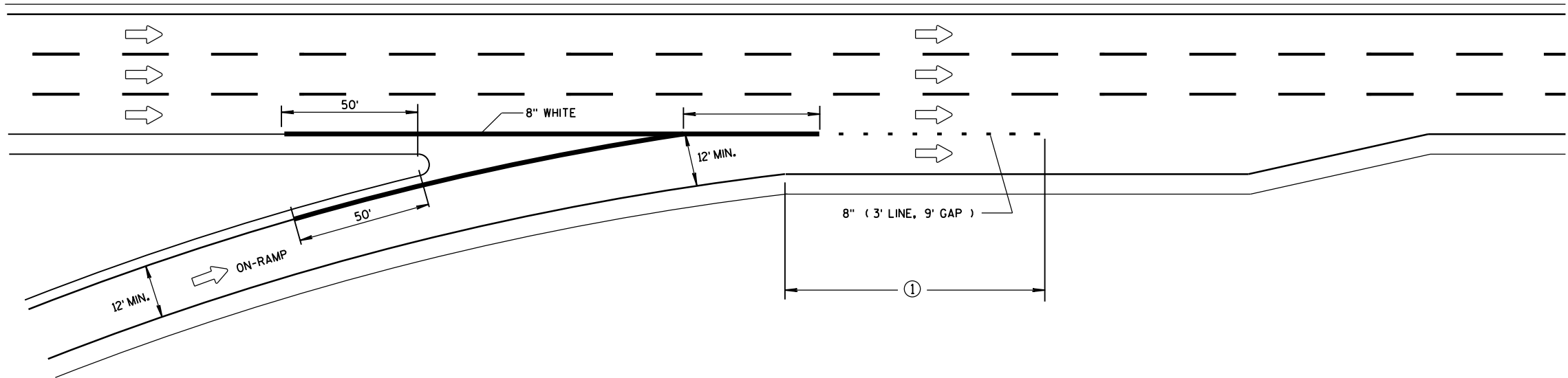

**SERVICE INTERCHANGE PAVEMENT MARKING FOR PARALLEL ENTRANCE-RAMP**

**PAVEMENT MARKING FOR  
PARALLEL ON-RAMP AND  
PARALLEL OFF-RAMP**

STATE OF WISCONSIN  
DEPARTMENT OF TRANSPORTATION

APPROVED  
Sept., 2016 /S/ Matthew R. Rauch  
DATE STATE SIGNING AND MARKING ENGINEER  
FHWA



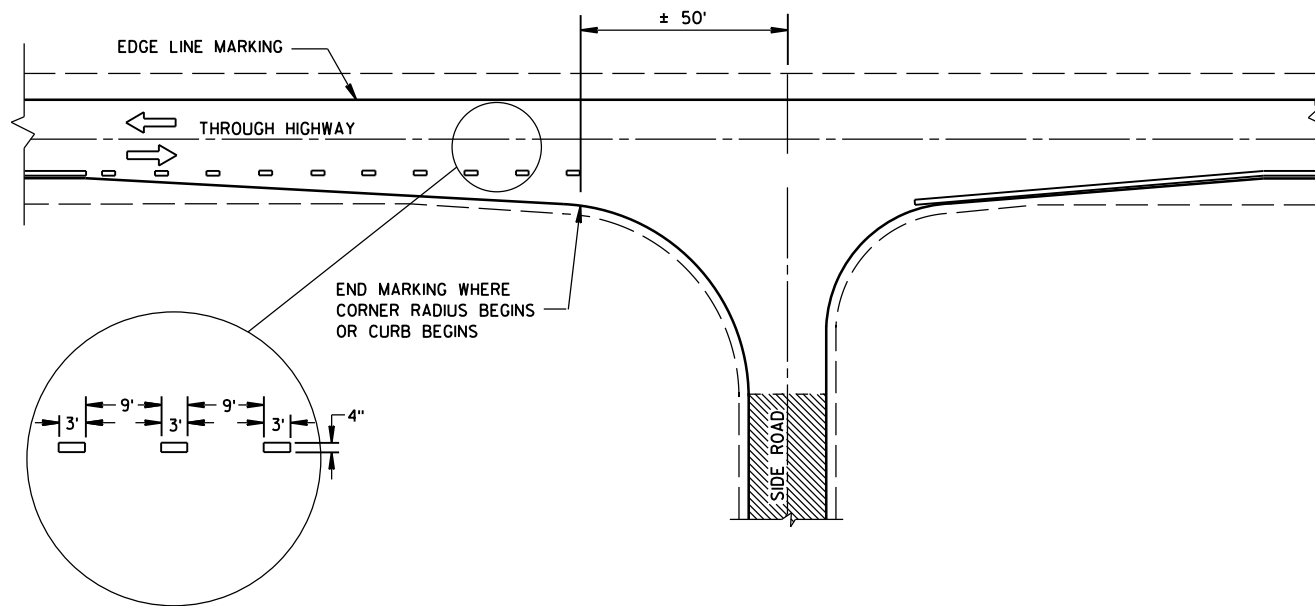

**MINOR INTERSECTION WITHOUT CURBS**

## GENERAL NOTES

EDGE LINES SHALL BE OMITTED THROUGH INTERSECTIONS. EDGE LINES SHALL BE CONTINUED THROUGH DRIVEWAYS.

- ① WHEN DISTANCE "A" IS LESS THAN 250 FEET, OMIT LANE LINE.
- ② WHEN DISTANCE "B" IS LESS THAN 100 FEET, OMIT CHANNELIZING LANE LINE.
- ③ BARRIER LINE ENDS AT SIDE ROAD PAVEMENT/SURFACE EDGE EXTENSION.
- ④ BARRIER LINE STARTS 500 FEET PRIOR TO THE BYPASS TAPER.

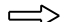
ARROW SYMBOL (  ) SHOWS DIRECTION OF TRAVEL

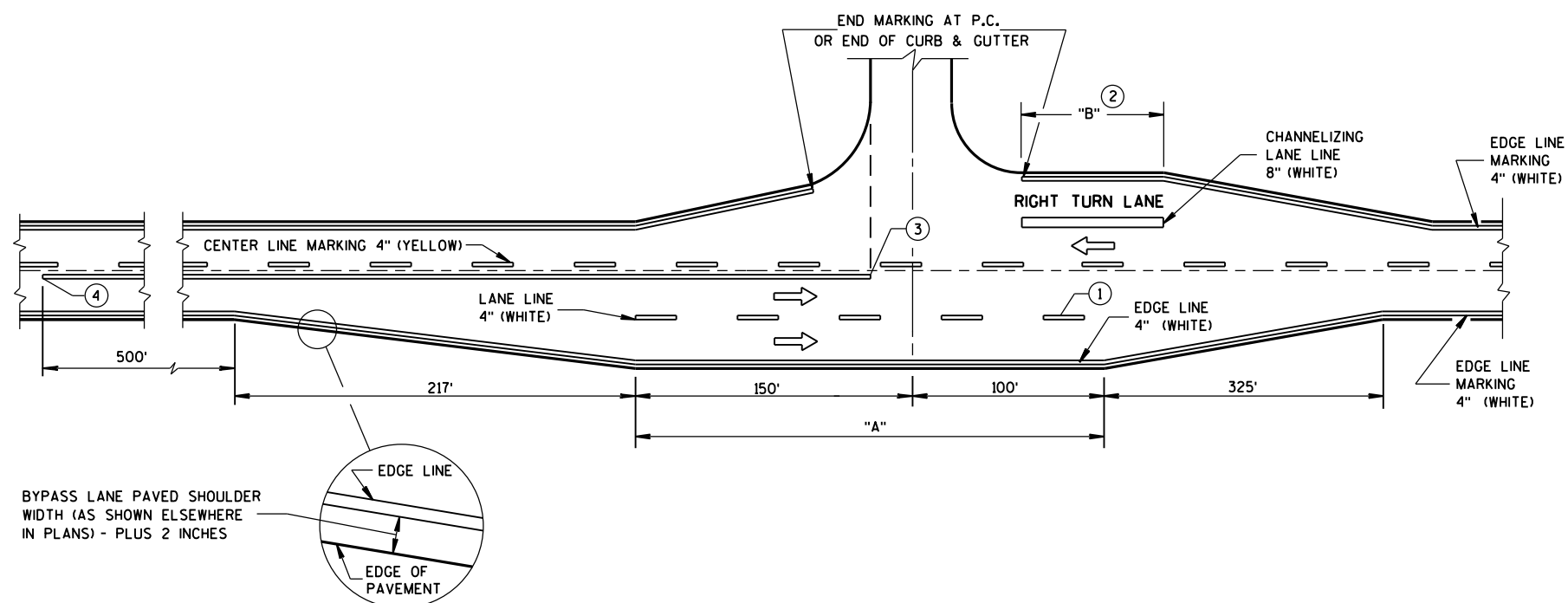

**MAJOR INTERSECTIONS**  
(INTERSECTION WITH FULL RIGHT TURN LANE OR BYPASS LANES)

**PAVEMENT MARKING  
(INTERSECTIONS)**

STATE OF WISCONSIN  
DEPARTMENT OF TRANSPORTATION



## ***Wisconsin Department of Transportation***

Dedicated people creating transportation solutions  
through innovation and exceptional service.

<http://www.dot.wisconsin.gov>