

OUTDOOR ADVERTISING VEGETATION MANAGEMENT CHECKLIST

For use in management of *DT1812 Application/Permit to Work on Highway Right of Way*
to Alter Highway Vegetation that Obstructs a Sign Face, under 84.305, Stats.

OASIS No. 17109 Completion Date _____ Owner Clear Channel Highway 43 County Milw Owner's No. 31509 Face EF

BEFORE PERMIT IS ISSUED

A. BHM (OA staff to complete)

Name of person completing these tasks: Jenny Harmon, Date 6/19/14

1. Yes ☒ No ☐ BHM-OA staff notified when application is received
2. Yes ☒ No ☐ Permit application contains information required in the *Applicant Checklist*. Return if incomplete
3. Yes ☒ No ☐ *OAVM Checklist* (top line filled-out) region notified to complete lines 10-19 below within two weeks
4. Yes ☒ No ☐ Application added to spreadsheet.
5. Yes ☒ No ☐ Database comment added to OASIS
6. Yes ☐ No ☐ BHM-OA file created containing the following documents:
 - ☒ a. A COPY of the permit as submitted
 - ☒ b. Single view report from the OASIS database
 - ☒ c. Photolog shots taken at 1000', 750', 500', and 250'
 - ☐ d. Any other relevant information
7. Yes ☒ No ☐ Scan documents into one folder in SharePoint and notify Landscape Architect Consultant F+P Site
8. Yes ☒ No ☐ Verify annual fee payments are current and fees have been paid for 5 or more years (except on-premise)
9. Yes ☒ No ☐ Verify vegetation removal is not part of documented living snow fence
10. Yes ☐ No ☐ Review the region's *Checklist* responses to confirm the sign is legal. Check BHM records
11. Yes ☒ No ☐ Add date due dates; under sections B, C, and in step 40 on this checklist and notify region and landscape architect consultant that section A. is completed

B. REGION (regional sign coordinator to complete by DATE: 7/3/14)

Name of person completing these tasks: _____, Date _____

12. Yes ☐ No ☐ The sign and the sign site have been visited and closely examined for evidence of changes
13. Yes ☐ No ☐ The sign fully located on private property and does not encroach into highway right-of-way
14. Yes ☐ No ☐ Database photos, taken on-site, are complete and current
15. Yes ☐ No ☐ Category: _____ Status _____ The sign meets all the requirements of its category
(OFF, ONP, DIR, NC, GRF etc.) (Legal or ILL)
16. The current zoning of this land is _____ (Note source used to determine this.)
17. NA ☐ Yes ☐ No ☐ Search regional records, permits, photologs, and aerial photos to confirm sign's legality
This sign has changed from when it became nonconforming or grandfathered [Lighting added, face is larger, new support structure, more or fewer posts than originally, etc.]
18. Yes ☐ No ☐ On-premise signs: The sign is on the building AND the building is within 100' of the right-of-way
19. Yes ☐ No ☐ A scenic easement or a deed restriction is in effect on this land
20. Yes ☐ No ☐ This highway is a designated scenic byway
21. Yes ☐ No ☐ This highway is scheduled for improvements. Project _____ Build Date _____
22. Yes ☐ No ☐ Notify BHM-OA Section B. is completed

C. LANDSCAPE ARCHITECT CONSULTANT (landscape architect consultant to complete by DATE: 7/19/14)

Name of person completing these tasks: _____, Date _____

22. Yes ☐ No ☐ The vegetation is part of a visual screen for a junkyard on or near the sign site
23. Yes ☐ No ☐ Submit cultural resources review to UW-Milwaukee for archeological and American Indian assessment
(See the following website for details. <http://archaeolab.anthro.uwm.edu/OASIS/>)
- Submitted Date _____ Cleared Date _____
24. Yes ☐ No ☐ NA ☐ Coordinate a endangered or threatened species review with WDNR if the sign is in Brown or Door Co.
- Submitted Date _____ Cleared Date _____
- WDNR Contact:
Lisie Kitchel 101 S. Webster St.
(608) 266-5248 phone Madison, Wisconsin 53707
25. Yes ☐ No ☐ Set up and attend removal site review with sign coordinator, certified arborist and sign owner
Date _____
26. Yes ☐ No ☐ Vegetation history evaluated
____ Blocks glare from adjacent traveled way (headlight screen). Safety ☐ Satisfies general aesthetics. Welfare ☐
____ Creates wind or snow barrier (living snow fence). Safety ☐ Screens a residence. Aesthetics ☐
27. Yes ☐ No ☐ Evaluate 500' view window
28. Yes ☐ No ☐ Review removal site vegetation to determine species is listed as prohibited on the DNR's NR 40 invasive species list
29. Yes ☐ No ☐ Review ANSI standards for pruning, not removal
30. Yes ☐ No ☐ Review marked vegetation to be removed, use identification method from application [item 8. Applicant Checklist]
31. Yes ☐ No ☐ Photograph sign site from 1000', 750', 500', and 250' distances and other photos as needed
32. Yes ☐ No ☐ Confirm $\geq 2''$ diameter vegetation that blocks the sign face, in the selected 500' view window
- Number of trees $\geq 2''$ in diameter to be removed: _____
Fee for $\geq 2''$ in diameter trees to be removed: \$ _____
(Number of trees to be removed x \$200.00)
33. Yes ☐ No ☐ Prepare report, proposed vegetation removal
34. Yes ☐ No ☐ Submit vegetation report to BHM Landscape Architects for approval

D. BHM (BHM landscape architect and BHM-OA Staff to complete)

Name of person(s) completing these tasks: BHM LA _____ BHM-OA _____

AFTER LANDSCAPE ARCHITECT CONSULTANT COMPLETES CHECKLIST

35. Yes ☐ No ☐ BHM landscape architect reviews and approves vegetation report
36. Yes ☐ No ☐ Outdoor advertising program provides final approval of vegetation report and permit decision to LA Consultant. Approval Date ____/____/____

E. LANDSCAPE ARCHITECT CONSULTANT (landscape architect consultant to complete)

Name of person completing these tasks: _____, Date _____

AFTER BHM VEGETATION REPORT APPROVAL AND PERMIT DECISION

37. Yes ☐ No ☐ Coordinate decision letter, permit conditions, restrictions, contingencies, attachments.
38. Yes ☐ No ☐ Email decision letter to permit applicant. Include BHM LA, BHM OA, Region sign coordinator, and Region maintenance supervisor.
39. Yes ☐ No ☐ Email permit conditions, restrictions, contingencies and attachments to region sign coordinator to issue 1812 Work on Highway Right-of-Way permit

PERMIT IS ISSUED BY REGION

F. REGION (regional sign coordinator or permit coordinator to complete)

Name of person completing these tasks: _____, Date _____

40. Yes ___ No ___ Receive notice from landscape architect consultant regarding permit determination

41. Yes ___ No ___ Issue permit for vegetation removal identified in vegetation report

42. Yes ___ No ___ Place on SharePoint approved permit and notify BHM-OA

Permit No. _____ Date Due 8 / 18 / 14 Date Issued ____ / ____ / ____

VEGETATION REMOVAL

G. REGION (regional sign coordinator to complete)

Name of person completing these tasks: _____, Date _____

43. Yes ___ No ___ Schedule work with sign owner Date ____ / ____ / ____

44. Yes ___ No ___ Oversee vegetation removal and site restorations

45. NA ___ Yes ___ No ___ Document vegetation removals outside scope of permit

46. NA ___ Yes ___

47. Yes ___ No ___ Fill out close-out report below within 5 days of removal and notify landscape architect consultant
Once close-out report is reviewed the sign company will be invoiced for removals

A. Date of work ____ / ____ / ____

B. Sign owner _____ and contractor _____

C. Yes ___ No ___ Does follow-up work remain. If yes what is the follow-up work _____

D. Date site was fully restored ____ / ____ / ____

E. Notable site conditions (rain, steep slope, access) _____

F. Equipment used _____

G. Yes ___ No ___ Were there permit violations. was work authorized beyond what was permitted; if so, describe and explain.

H. Total ≥ 2 " trees removed _____

I. How many ≥ 2 " trees were subject to the \$200 fee _____ (for invoice purposes)

AFTER VEGETATION REMOVAL

H. LANDSCAPE ARCHITECT CONSULTANT (landscape architect consultant to complete)

Name or initial of person completing these tasks: _____, Date _____

48. Yes ☐ No ☐ Review closeout report from Region. Date closeout report received: _____
49. Yes ☐ No ☐ Invoice sign owner for vegetation removed identified on closeout report, place on SharePoint, and notify BHM-OA

I. BHM (BHM-OA staff to complete)

Name of person completing these tasks: _____, Date _____

50. Yes ☐ No ☐ Invoiced for vegetation removed reviewed
51. Yes ☐ No ☐ Date payment received ____/____/____

Rev. Date: 05-15-2014

| | | | | | |
|----------------------|------------|------------------------|-------------------------------------|-----------------------|-------------------------------------|
| Oasis #: | 17109 | Size (sq. ft.): | 1344 | Zoning: | Commercial |
| Old Oasis #: | 212990 | Type 1: | BB | Category: | OFF |
| Old Permit #: | 40-0123-88 | Type 2: | | Chngbl Msg: | |
| Owner's #: | 31509 | Facing: | NS | NC Reason: | |
| RP: | 066K+0.13 | Side of Hwy: | R | Permit Date: | 1/25/1988 |
| Inv Dir: | N | HAGL: | | Install Date: | |
| Sort Hwy: | 43 | R/W to Sign: | 0 | Rem/Exp Date: | |
| Quadrant: | SWSW | Lighted: | <input checked="" type="checkbox"/> | Municipality: | City of Greenfield |
| Section: | 23 | | | County: | 40 MILWAUKEE |
| Town: | 6 | | | Active: | <input checked="" type="checkbox"/> |
| Range: | 21E | | | Followup Date: | |

Location from centerline of nearest intersection (below):
670' from 60th St. - permit: 600' E. of 60th Street CL

Note:

Approved Activity (Directional sign use only):

Sign Owner: Clear Channel Outdoor
Address: 908 Silvernail Road
Cty/St/Zip: Pewaukee WI 53072

Land Owner: First Health Care Corp dba Mt. Carm
Address: 5700 West Layton Avenue
Cty/St/Zip: Greenfield WI 53220-4099

Installer: OIS Default - 1
Address: Unknown
Cty/St/Zip: Unknown WI XXX



RECEIVED

JUN 19 2014

APPLICANT CHECKLIST

For use in submitting a DT1812 Application/Permit to Work on Highway Right of Way
to Alter Highway Vegetation that Obstructs a Sign Face, under s. 84.305 Stats. Bureau of Hwy Operations

RECEIVED

JUN 19 2014

Submit permit applications to: Wisconsin Department of Transportation – Outdoor Advertising Program
4802 Sheboygan Avenue – Room 501
Madison WI 53702

Bureau of Hwy Operations

IMPORTANT NOTES - READ BEFORE SUBMITTING PERMIT APPLICATION

The applicant must be the sign owner.

The 60-day review period begins when a complete application is date-stamped in the Bureau of Highway Maintenance.

Each sign face requires a separate application.

Clear cutting is prohibited.

1. ✓ Provide a completed **APPLICANT CHECKLIST** with each permit application.
2. ✓ Provide a completed *DT1812 Application/Permit to Work on Highway Right of Way* [4-pages].
3. ✓ Provide payment of the nonrefundable permit application fee of \$250 [no cash]. (Note: Invoice for repayment of trees equal to and larger than two inches at breast height will be issued following vegetation removal.)
4. Yes X No ___ Has a permit to work on highway right of way been obtained to mark the affected vegetation?
5. Yes ___ No X Is any affected vegetation located within a municipality and within 10 feet of the nearest pavement edge?
If yes, provide municipality approval.
6. ✓ Provide a color photograph of the full view window that shows the affected vegetation, the sign face, and a north arrow.
7. Provide the following:
 - a. OASIS number of the sign. 17109 Sign face direction. Faces east
 - b. Owner's panel or other ID number. Panel # 9151 Lease # 31509
 - c. Have five years of annual fees been paid on this sign, to the extent required by law? Yes X No ___
(Does not apply to on-premise signs.)
 - d. Missing or changed landowner contact information. Refer to the annual billing, if needed.
8. Clearly describe the proposed work including the affected trees, shrubs and hedges. Identify the number of trees removed with a diameter equal to or greater than two inches at breast height (4.5 feet) above ground level.
ON Billing
9. ✓ Provide a detailed removal site sketch signed by a certified arborist. The site sketch must be included and signed by a certified arborist to be considered a complete application. The following link can aid you in finding a certified arborist:
<http://www.waa-isa.org/arborists/search.asp>

A site sketch must show:

- ✓ a. A north arrow
- ✓ b. Highway in relation to sign
- ✓ c. The complete view zone and view window
- ✓ d. Survey of all vegetation to be pruned or removed within the requested 500 feet that obstructs the sign face
- ✓ e. Access to the work site

Signature of Sign Owner or Authorized Representative

Printed Name of Sign Owner or Authorized Representative

Date

Signature of Certified Arborist

Printed Name of Certified Arborist

Date

Certification Number, Expiration Date



APPLICATION/PERMIT TO WORK ON HIGHWAY RIGHT-OF-WAY

JUN 19 2014

Wisconsin Department of Transportation (WisDOT)

DT1812 3/2014 s. 86.07(2), 86.16 and other applicable Wis. Stats.

Bureau of Hwy Operations

| | | | | |
|---|---|---|----------------------|---|
| 1. Applicant's Name, Address, City, State and ZIP Code Clear Channel Outdoor 908 Silvernail Road Pewaukee, WI 53072 OASIS #17109 Panel #9151 | | 2. Work Start Date | 3. Work Finish Date* | 4. Highway (Check all that apply) <input type="checkbox"/> WIS <input type="checkbox"/> US <input checked="" type="checkbox"/> Interstate <u>894</u> <input type="checkbox"/> |
| 5. Work Location (Check/list all that apply) <input type="checkbox"/> Town <input type="checkbox"/> Village <input checked="" type="checkbox"/> City of: <u>Greenfield</u> County: <u>MILWAUKEE</u> | | | | |
| 6. Is the work area near a survey monument? If yes, email geodetic@dot.wi.gov or call 866-568-2852. <input type="checkbox"/> Yes <input checked="" type="checkbox"/> No | 7. Trans 401 project designation? See provision #13. For all Major projects, provide a formal erosion control plan with this application. <input type="checkbox"/> Minor <input type="checkbox"/> Major | 8. Location Details (Town, range, section, 1/4 sect; provide plat map or location sketch) <u>I-894 SS 600 ft E/O 60th St.</u> <u>T6N R21E Sec 23 SWSW</u> | | |
| 9. Are any environmental permits, certifications or approvals required from other regulatory agencies, including tribal governments? If yes, provide a copy of each item. If no, proof of agency coordination may still be required with this application. Click on environmental coordination for more information. <input type="checkbox"/> Yes <input checked="" type="checkbox"/> No | | | | |
| 10. Work Type (Check all that apply) <input type="checkbox"/> Access management <input type="checkbox"/> Crash investigation/cleanup <input type="checkbox"/> Drainage: Culverts/tiles <input type="checkbox"/> Drainage: Grading/riprap <input type="checkbox"/> Drainage: Storm Sewer <input type="checkbox"/> Environmental assessment <input type="checkbox"/> Harvesting nature products <input type="checkbox"/> Hazmat: Cleanup/remediation <input type="checkbox"/> Hazmat: Monitoring wells <input type="checkbox"/> Invasive species assessment <input type="checkbox"/> Landscaping <input type="checkbox"/> Soil borings <input type="checkbox"/> Surveying <input checked="" type="checkbox"/> other below _____ | 12. Work Zone Description (Check all that apply) <input checked="" type="checkbox"/> Not applicable <input type="checkbox"/> Full road closure: detour** <input type="checkbox"/> Full road closure: temporary <input type="checkbox"/> Lane closure: without flagging <input type="checkbox"/> Lane closure: with flagging <input type="checkbox"/> Lane encroachment (2 feet or less) <input type="checkbox"/> Intersection/roundabout <input type="checkbox"/> Shoulder/parking lane closure Freeway/expressway location <input type="checkbox"/> Off shoulder: < 30' off white line <input type="checkbox"/> Off shoulder: ≥ 30' off white line <input checked="" type="checkbox"/> Near R/W line or fence Non-Freeway/expressway location <input type="checkbox"/> Off shoulder: < 15' off white line <input type="checkbox"/> Off shoulder: ≥ 15' off white line <input type="checkbox"/> Back of curb: < 2' behind <input type="checkbox"/> Back of curb: ≥ 2' behind | 13. Provide Detailed Description of How Work Will Be Accomplished. Use page 2 or additional pages if needed. For chemical treatment, answer questions on page 2. Provide work plans, drawings and specifications as needed. Trim or Remove vegetation in DOT Right-of-Way to provide a 500 ft viewing window for billboard. Clear Channel Outdoor will access R/W from adjacent land owner. See Site Plan | | |
| 11. Vegetation Management (Check all that apply) <input type="checkbox"/> Mow <input checked="" type="checkbox"/> Remove <input type="checkbox"/> Prune <input checked="" type="checkbox"/> Cut and/or trim <input type="checkbox"/> Plant <input checked="" type="checkbox"/> Chemically treat ¹³ | | | | |

It is understood and agreed that approval is subject to the applicant's full compliance with the pertinent Statutes, as well as any codes, rules, regulations, and other jurisdictional agencies' permit requirements. Applicant shall comply with all permit provisions, superimposed notes, and detail drawings that WisDOT may add. Any alteration of this form by the applicant is prohibited and may be cause to revoke this permit. When approved, the permit does not transfer any land; nor give, grant or convey any land right, right in land, nor easement in WisDOT right-of-way. It is not assignable or transferrable. All costs associated with this permit are the permittee's responsibility unless otherwise noted.

Good Tree Care, LLC

(Main Contractor Company Name, If applicable)

X [Signature]
(Applicant or Authorized Representative Signature)
(If Computer-filled, Brush Script Font)

6/16/14

(Date)

Greg Good (Owner)

(Contractor Representative/Title)

(Area Code/Phone No. - Office)

(262) 719-0100

(Area Code/Phone No. - Cell)

(Email Address)

Jerry Falvey

(Printed Name)

Real Estate Representative

(Title)

(262) 506-9024

(Area Code/Phone No.)

jerryfalvey@clearchannel.com

(Email Address)

*NOTE: If the work described is not completed by the "Work Finish Date" specified, this permit is null and void and the work shall not be completed unless authorized through a subsequent permit or an approved time extension. ANY PERMIT ISSUED IS REVOCABLE.

For Official Wisconsin DOT Use Only – Do Not Write Below

| | | |
|--|--|---------------------------|
| <input type="checkbox"/> PERMITTEE SHALL NOTIFY THE WISDOT REPRESENTATIVE LISTED BELOW 3 DAYS BEFORE STARTING ANY WORK: Region contact, title, office address, area code/phone no., and email address Wisconsin DOT _____ _____ _____ | <input type="checkbox"/> See Supplemental Permit Provisions (Page 4) <input type="checkbox"/> Special Permit Provisions Also Included <input type="checkbox"/> Lane Closure System notification required <input type="checkbox"/> Insurance or performance bond required <input type="checkbox"/> Other regulatory agency permits not required <input type="checkbox"/> **State highway traffic detour permit required <input type="checkbox"/> Permit issued in conjunction with: _____ <input type="checkbox"/> Permit voids and supersedes permit(s): # _____, Issued _____ <input type="checkbox"/> | Date Application Received |
| | | Date Application Complete |
| | | Permit Issuance Date |
| | | Permit Expiration Date |
| | | Permit Extension Date |
| | | Permit Number |

(WisDOT Authorized Representative Signature – If Computer-filled, Brush Script Font)

| | |
|--|---|
| <p>Use this section to provide information on chemical treatment (question #11):</p> <p>(a) Chemical(s) to be used and EPA Registration Number(s) (Example: Garlon 4 Ultra, EPA REG. NO. 62719-527) GARLON 4 EPA Reg. No. 62719-527</p> <p>(b) Type of application(s)? (Example: Stump treatment, broadcast, etc.) Stump treatment</p> <p>(c) Applicator name(s) and Wisconsin certification number(s)? (Example: Bill Smith, 146886-CA. Personnel must be licensed as commercial applicators in category 6.0, Right-of-Way, to legally apply herbicides on roadsides.) Greg Good WI Cert. Applicator Number 94900</p> <p>(d) How will property owners bordering the affected highway RW be notified prior to spraying? (Examples: In-person, doorknob cards, letters, phone calls, etc.) na</p> <p>(e) Will spraying occur near wetlands? (If yes, see question #9) na</p> <p>(f) Provide name(s) and cell number(s) for the supervisor or lead worker of each crew: Greg Good (262) 719-0100</p> | <p>Use this section to provide information that does not fit on front page or #11(a)-(f) on left:</p> |
|--|---|

INDEMNIFICATION

The Applicant shall save and hold the State, its officers, employees, agents, and all private and governmental contractors and subcontractors with the State under Chapter 84 Wisconsin Statutes, harmless from actions of any nature whatsoever (including any by Applicant itself) which arise out of, or are connected with, or are claimed to arise out of or be connected with any of the work done by the Applicant, or the construction or maintenance of facilities by the Applicant, pursuant to this permit or any other permit issued by the State for location of property, lines or facilities on highway right-of-way, (1) while the Applicant is performing its work, or (2) while any of the Applicant's property, equipment, or personnel, are in or about such place or the vicinity thereof, or (3) while any property constructed, placed or operated by or on behalf of Applicant remains on the State's property or right-of-way pursuant to this permit or any other permit issued by the State for location of property, lines or facilities on highway right-of-way; including without limiting the generality of the foregoing, all liability, damages, loss, expense, claims, demands and actions on account of personal injury, death or property loss to the State, its officers, employees, agents, contractors, subcontractors or frequenters; to the Applicant, its employees, agents, contractors, subcontractors, or frequenters; or to any other persons, whether based upon, or claimed to be based upon, statutory (including, without limiting the generality of the foregoing, worker's compensation), contractual, tort, or whether or not caused or claimed to have been caused by active or inactive negligence or other breach of duty by the State, its officers, employees, agents, contractors, subcontractors or frequenters; Applicant, its employees, agents, contractors, subcontractors or frequenters; or any other person. Without limiting the generality of the foregoing, the liability, damage, loss, expense, claims, demands and actions indemnified against shall include all liability, damage, loss, expense, claims, demands and actions for damage to any property, lines or facilities placed by or on behalf of the Applicant pursuant to this permit or any other permit issued by the State for location of property, lines or facilities on highway right-of-way in the past or present, or that are located on any highway or State property or right-of-way with or without a permit issued by the State, for any loss of data, information, or material; for trademark, copyright or patent infringement; for unfair competition or infringement of personal or property rights of any kind whatever. The Applicant shall at its own expense investigate all such claims and demands, attend to their settlement or other disposition, defend all actions based thereon and pay all charges of attorneys and all other costs and expenses of any kind arising from any such liability, damage, loss, claims, demands and actions.

Any transfer, whether voluntary or involuntary, of ownership or control of any property constructed, placed or operated by or on behalf of the Applicant that remains on the State's property or right-of-way pursuant to this permit shall not release Applicant from any of the indemnification requirements of this permit, unless the State is notified of such transfer in writing. Any acceptance by any other person or entity, whether voluntary or involuntary, of ownership or control of any property constructed, placed or operated by or on behalf of the Applicant that remains on the State's property or right-of-way pursuant to this permit, shall include acceptance of all of the indemnification requirements of this permit by the other person or entity receiving ownership or control.

Notwithstanding the foregoing, a private contractor or subcontractor with the State under Chapter 84 Wisconsin Statutes, that fails to comply with sections 66.0831 and 182.0175 Wisconsin Statutes (2011-2012), remains subject to the payment to the Applicant of the actual cost of repair of intentional or negligent damage by the contractor or subcontractor to any property, lines or facilities placed by or on behalf of the Applicant pursuant to this permit or any other permit issued by the State for location of property, lines or facilities on highway right-of-way, and remains subject to payment to the Applicant for losses due to personal injury or death resulting from negligence by the contractor or subcontractor.

Notwithstanding the foregoing, if the State, or its officers, employees and agents, fail to comply with sections 66.0831 and 182.0175 Wisconsin Statutes (2011-2012), the State or its officers, employees and agents, remain subject to the payment to the Applicant of the actual cost of repair of willful and intentional damage by the State, or its officers, employees and agents, to any property, lines or facilities placed by or on behalf of the Applicant pursuant to this permit or any other permit issued by the State for location of property, lines or facilities on highway right-of-way, and remain subject to payment to the Applicant for losses due to personal injury or death resulting from negligence by the State, its officers, employees and agents.

No indemnification of private contractors or subcontractors with the State under Chapter 84 Wisconsin Statutes, shall apply in the event of willful and intentional damage by such private contractors or subcontractors to the property, lines and facilities of the Applicant located on the highway right-of-way pursuant to this permit or any other permit issued by the State for the location of property, lines or facilities on highway right-of-way.

GENERAL PERMIT PROVISIONS AND CONDITIONS OF APPROVAL (#1-28)

Pursuant to Wisconsin Statutes and once approved by WisDOT, this permit allows performance of the specific work described over which WisDOT has permit authority. *The permittee shall abide by these general provisions, and any supplemental and/or special provisions.* (R/W = right-of-way)

- Warning signs, devices and methods shall be in place and fully functional prior to the start of any permitted work within highway R/W, and shall protect the public until all permit-associated work is complete. Warning signs and devices shall conform to the appropriate sizes, designs and configurations specified within the Manual of Uniform Traffic Control Devices and the Wisconsin MUTCD Supplement, current edition. Provide and maintain the quantity of signs and devices therein described, and supplement those with additional signs, devices and flaggers as necessary to functionally protect people and property from injury or damage at all times and under all conditions, including changed or changing conditions. All personnel shall wear retro-reflective safety vests while working within the highway R/W.
- Secure the work site and associated traffic control zone against any hazard to the public, both when the site is attended and is unattended during off-hours, holidays, and nighttime hours. This includes vehicles, equipment and materials. Any violation of this permit, particularly any failure to maintain safe work site and traffic control zone, will require immediately cure by the permittee, and may result in WisDOT stopping further work, removal of permittee from the highway R/W, and/or permit revocation.
- Coordinate the permitted work and in no case interfere with any ongoing highway improvement project.
- Keep a complete copy of the permit (which may be electronic) at the job site at all times the permitted work is ongoing along with a project manager or supervisor familiar with the permit and all of its details and requirements. Failure to comply with any part of this permit is the permittee's responsibility.
- Determine the location of, and protect or cause to protect from any damage, any existing facilities in the area affected by the permitted work. All notifications to other facility owners are the permittee's responsibility.
- Perform all permitted work without obstructing or closing any part of any traffic lane or fully closing any road unless specifically authorized by WisDOT.
- Alter the permitted facilities as may be ordered by WisDOT to facilitate highway improvement, alteration, safety control, or maintenance. Accept all costs of constructing, maintaining, altering, temporarily moving or relocating the permitted facilities.
- The permit authorizes only the described work of and for the permittee indicated on this permit. It does not grant authority for the work of any other, either by present or future installation.
- Any disturbance to, operation within, or use of a highway median is expressly prohibited, unless specifically authorized by WisDOT. **The use of interstate or freeway median crossovers for any reason is prohibited and subject to law enforcement citation.**
- Construction methods and restorations shall be in accordance with applicable parts of WisDOT's Standard Specifications for Highway and Structure Construction, current edition.
- Comply with all requirements of applicable regulations and codes, including, but not limited to, the Wisconsin Dept of Workforce Development, Workplace Safety Institute for safety precautions and operations relevant to trenching, tunneling, and excavation.
- Do not open at any time any greater length of trench than is necessary to maintain essential progress of the work.
- Implement erosion control best management practices (BMPs) prior to and at all times during work operations. Provide and maintain erosion control BMPs to protect all restored areas upon completion of the permitted work until the replacement vegetation achieves sustained growth. Trans 401 designations for major and minor projects in this permit use the same meanings as utility projects. If a project is not "minor", then it is "major".
- Derive no direct access to install, maintain or repair the permitted facility from the travel lane or shoulder of any freeway, or from any interchange ramp, unless specifically authorized by WisDOT or if needed due to an emergency. In the latter case, immediately contact the Wisconsin State Patrol and WisDOT Region Office as indicated on this permit.
- Install the facility in the specified permit location. Move any part of the facility found to be otherwise located to the correct location upon WisDOT order. Any facility part located other than as specified in this permit is at permittee's sole risk. Accordingly, if the same is undetected or is suffered to remain in variance to the permit, the permittee shall hold the State, its employees, agents and officers harmless and free of any cost, claim or liability associated with any accidental damage to such facility that may result from a highway construction, maintenance, traffic control, or R/W management project or function.
- Promptly restore all highway facilities disturbed by the permitted work or associated operation. WisDOT may issue a notice setting a specific time by which the restoration must be complete if restoration is not done voluntarily without delay. If the permittee fails to satisfactorily complete the restoration within the time established, WisDOT shall arrange for the restoration to be completed and bill the permittee accordingly. The permittee shall pay for all costs of said restoration.
- Collect any brush, trash or waste materials resulting from the permitted work, and dispose of said materials off the R/W in accordance with applicable solid waste disposal regulations.
- Send notice **within 10 calendar days** via regular mail or email to the authorized WisDOT representative who approved the permit upon completion of the work and restoration.
- Smooth and finished slopes shall be constructed at any location where any reggraded portion of the highway R/W meets the lands of adjacent property owners.
- Backfill any excavation permitted within the highway pavement limits or shoulder areas with suitable granular material, placed in lifts or layers 12 inches or less each in depth, and mechanically compact to meet the appropriate density as specified in WisDOT's Standard Specifications for Highway and Structure Construction, current edition. Do not use water jetting to facilitate mechanical compaction. Repair to WisDOT's satisfaction any subsequent heavings, settlements, or other faultings attributable to the permitted work. Use temporary sheeting, shoring and/or trench boxes as needed to prevent trench/tunnel cave-ins.
- Restore in-kind any curb, gutter, sidewalk, driveway, gravel base, ballast, shoulder material, or other highway R/W element/facility disturbed under this permit to the qualities, grades, compactions and conditions specified in WisDOT's Standard Specifications for Highway and Structure Construction, current edition.
- Restore any turfed R/W area disturbed under this permit with fine-graded topsoil having a depth of not less than 4 inches, and reseeded to perennial grass or sodded to WisDOT's satisfaction.
- Adjust manhole covers, shut-off and regulator valves, and like facilities to the level of the immediately adjacent grades.
- Cure faults related to work or facilities under this permit that, in WisDOT's opinion, obstruct highway drainage or in any other manner adversely affect highway maintenance or operation, and restore the R/W as directed by and to WisDOT's satisfaction.
- Keep all vehicles/equipment/materials outside the R/W fence including all bore pits of any bored or augered installations under a freeway. Do not keep vehicles/equipment/materials between any freeway travel lane and a bore pit if WisDOT authorizes the pit location within the freeway R/W. Locate all bore pits outside the clear zone and as close to the R/W fence as possible.

26. Do not keep vehicles/equipment/materials related to this permit within the non-freeway R/W limits except as are actively engaged in the work operation.
27. Be aware that future highway improvements may require the adjustment of part or all of the permitted facility, at permittee's cost, to conform to WisDOT's Utility Accommodation Policy.
28. Comply with appropriate laws, rules, policies, etc. when within tribal or federal lands. Provide documentation as needed when on WisDOT R/W to prove compliance or coordination with the following agencies:
- Wisconsin Historical Society to avoid/mitigate any potential cultural resource (archeological, historical, burial site, etc.) impacts per §44.40.
 - Department of Natural Resources to avoid/mitigate any potential storm water runoff, site erosion, wetland, waterway and endangered/threatened species impacts.

SUPPLEMENTAL PERMIT PROVISIONS (#29-50)

The permittee shall abide by the following checked provisions:

TREE & VEGETATION MANAGEMENT

- ☐ 29. Plant trees/vegetation only in such locations and in such species as indicated on the plans included and approved with this permit, or as WisDOT specifies in the field.
- ☐ 30. Maintain all plantings according to the attached special permit provisions.
- ☐ 31. Do not place any sign or marker identifying the plantings within the highway R/W limits.
- ☐ 32. WisDOT accepts no responsibility for loss that may occur to the plantings. Be fully aware that the plantings are subject to:
- Thinning and/or mortality
 - Normal hazards due to maintenance operations, snow control, and public utility installation or alteration
 - Trimming or removal, if or when the plantings cause restrictions to sight distance or hazardous snow/ice conditions on the highway
 - Destruction, if highway reconstruction is done
 - Partial or complete abandonment or obliteration, or return to private ownership, if future changes in highway location are made
- ☐ 33. Do not cut, trim or damage trees/vegetation to facilitate the installation or maintenance of the permitted facility except as authorized by the owner of such tree/vegetation. See Wisconsin Statutes 86.03(2), (4), 86.16(3), and 182.017(5).
- ☐ 34. Do not cut or prune oak trees between April 15 and October 15 to prevent Oak Wilt Disease from spreading unless a thick coat of asphalt base tree paint is applied immediately after any cut, pruning wound, or abrasion made between those dates. Cleanly cut the exposed ends of any roots encountered during grading or trenching with suitable pruning tools immediately after exposure. Adhere to any applicable laws, including local ordinances if they are stricter than WisDOT specifications.
- ☐ 35. Remove all stumps, branches, logs, and other debris resulting from the cutting and trimming operations and dispose of such materials off the R/W. Tree disposal may also occur by giving them to the adjacent property owner(s) at a storage location approved by the owner(s). Comply with any applicable laws that regulate the sale, transport, or pruning/cutting of trees.
- ☐ 36. Cut trees flush with the ground. Any remaining stumps shall not interfere with mowing operations.
- ☐ 37. Cut trees may be chipped and used for mulch on the R/W in a layer not exceeding three inches.

- ☐ 38. Trim only the trees/vegetation necessary to provide safe clearances or by special provisions. Do not damage non-target trees/vegetation. Do not clear cut trees/vegetation.
- ☐ 39. Survey the trees/vegetation to be removed and inspect jointly with a WisDOT representative prior to starting any work on the highway R/W.
- ☐ 40. Treat all deciduous tree stumps with a herbicide approved for this use. Do not treat evergreen tree stumps.

RAILROAD CROSSING WORK

- ☐ 41. Complete a permit/application form to detour state highway traffic (DT1479). This DT1812 permit shall only be in effect if WisDOT approves the matching DT1479 permit.
- ☐ 42. Comply with the attached "Special Provisions for Railroad Crossing Work."

WORK RESTRICTIONS

- ☐ 43. Daily, holiday and/or seasonal work restrictions apply to the permitted work as detailed on page __. Review the restrictions with the WisDOT Region Office(s) identified on this permit.

MISCELLANEOUS

- ☐ 44. Contact the WisDOT Region Office(s) identified on this permit to arrange for a Region representative to inspect the work site. Perform no work under this permit prior to his/her arrival.
- ☐ 45. Contact the WisDOT Region Office(s) identified on this permit prior to completing the permitted work to arrange for a Region representative to inspect the work before the permittee's employees or contractor leaves the site.
- ☐ 46. Call the State Traffic Operations Center (STOC) / - on a weekly basis or as otherwise determined by the STOC before working on any interstate or other major freeway. The STOC may place restrictions on work times and lane/shoulder closures based upon various special events, oversize freight movements, or daily peak travel times.
- ☐ 47. Construction by open-trench methods is authorized only if the permitted installation can be accomplished in advance of the highway paving. Bore or dry auger the permitted facility if this cannot be accomplished.
- ☐ 48. At any location where open-trench installation across highway pavement is authorized, saw-cut the surface full depth to enable it to be restored with smooth joints. Restore concrete pavement to the nearest joint.
- ☐ 49. Backfill all excavations according to the attached detail.
- ☐ 50. Blasting within the highway R/W is authorized with this permit.
- ☐ 51.

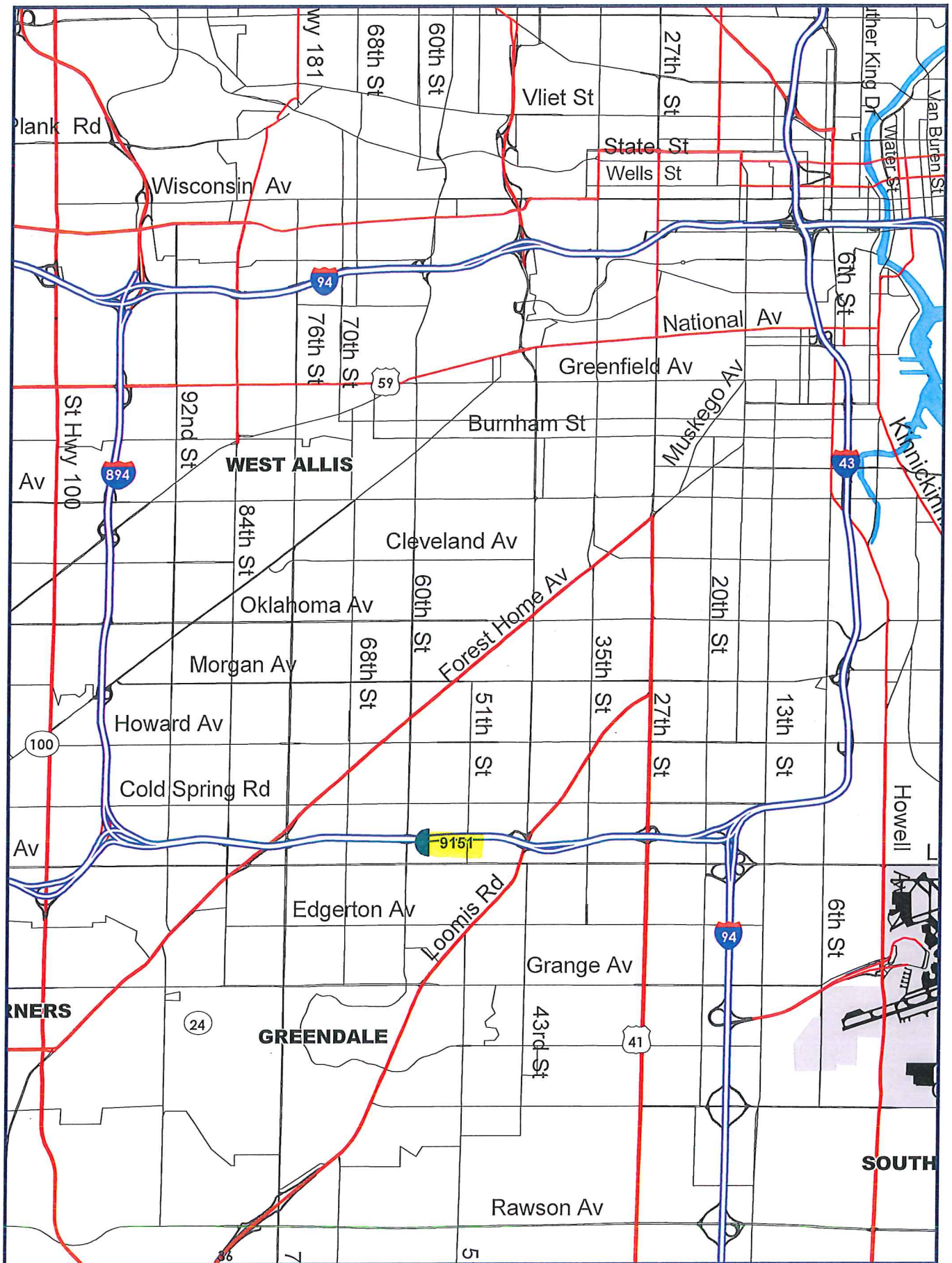

I-894 600 Ft E/O 60th St.
OASIS # 17109 Panel 9151
(1000 Feet)

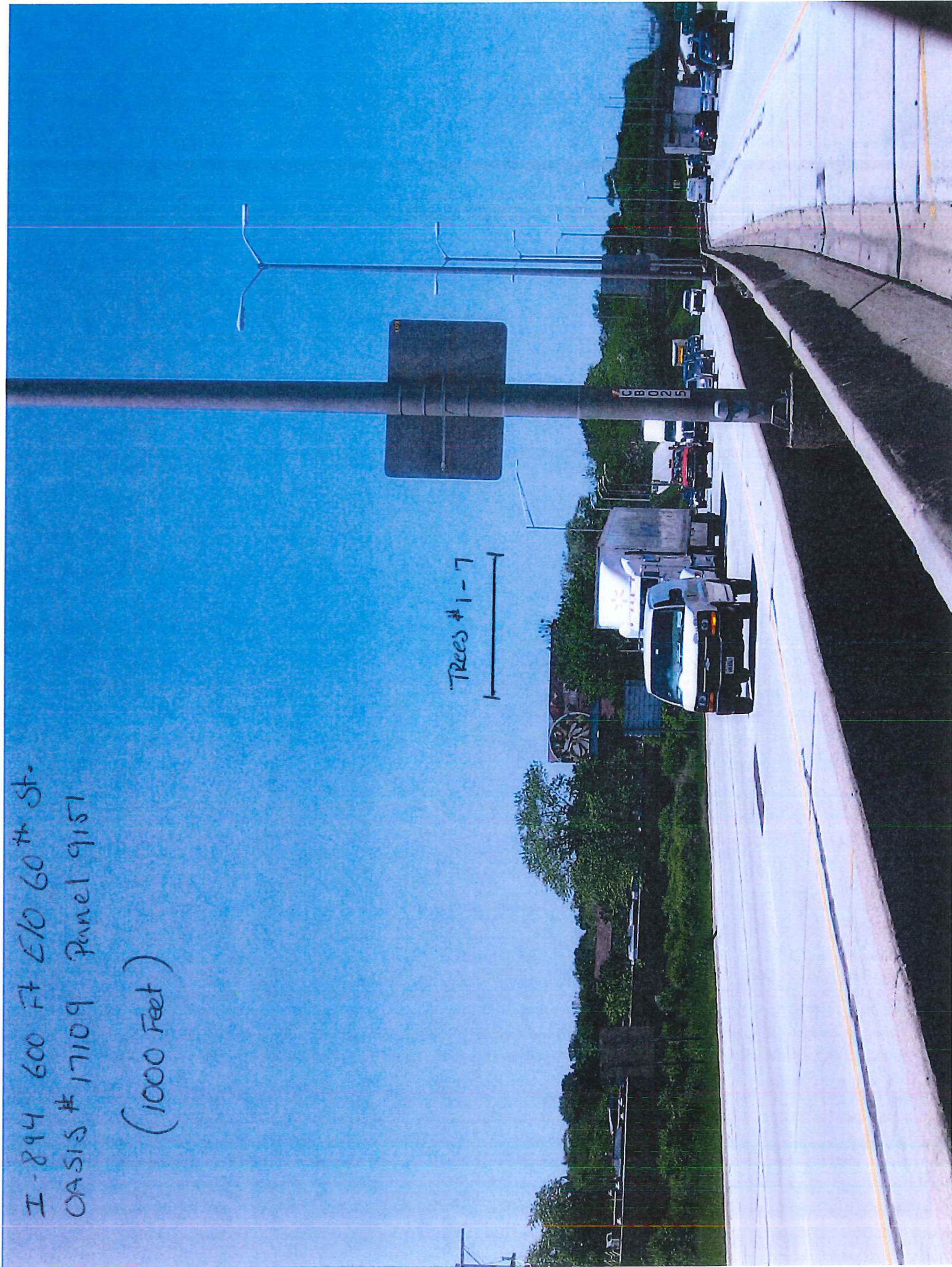

I-894 600 Ft. E/O 60th St.
OASIS # 17109 Panel # 9151

(750 Feet)

Trees # 1-7

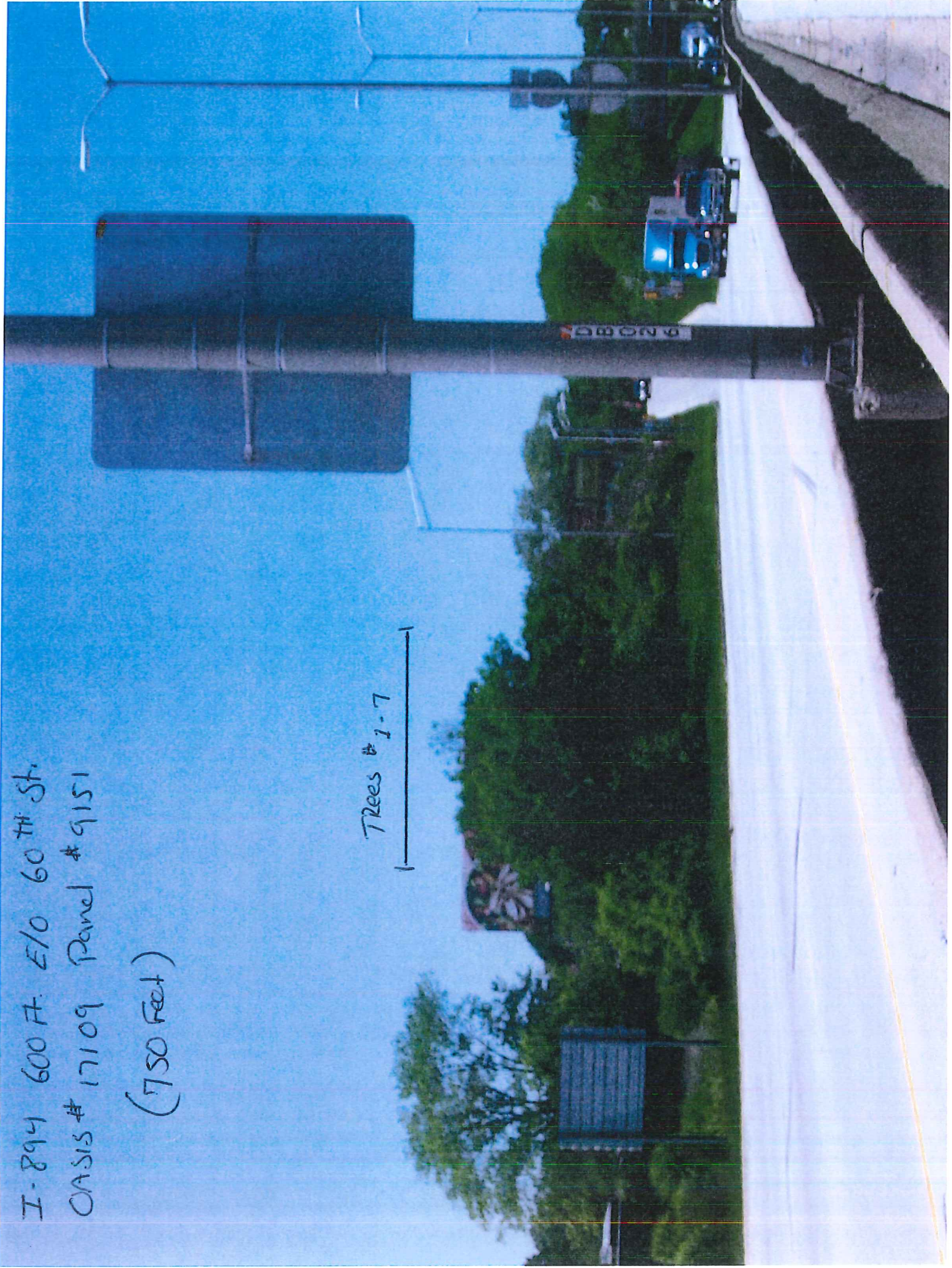

I-894 600 Ft. E/O 60th St.
OASIS # 17109 Panel # 9151

(500 Feet)

Trees # 1-7



I-894 600 Ft. E/O 60th St.
OASIS # 17109 Panel # 9151
(250 Feet)



⑥

⑦



W. Austin Ave

Airport Fwy

© 2014 Google

Google

2000

OASIS #17109 Panel #9151
 I-894 SS 600 ft E/O 60th Street
 T6N R21E Sec 23 SWSW

SITE PLAN

Certified Arborist

Sharon Jensen

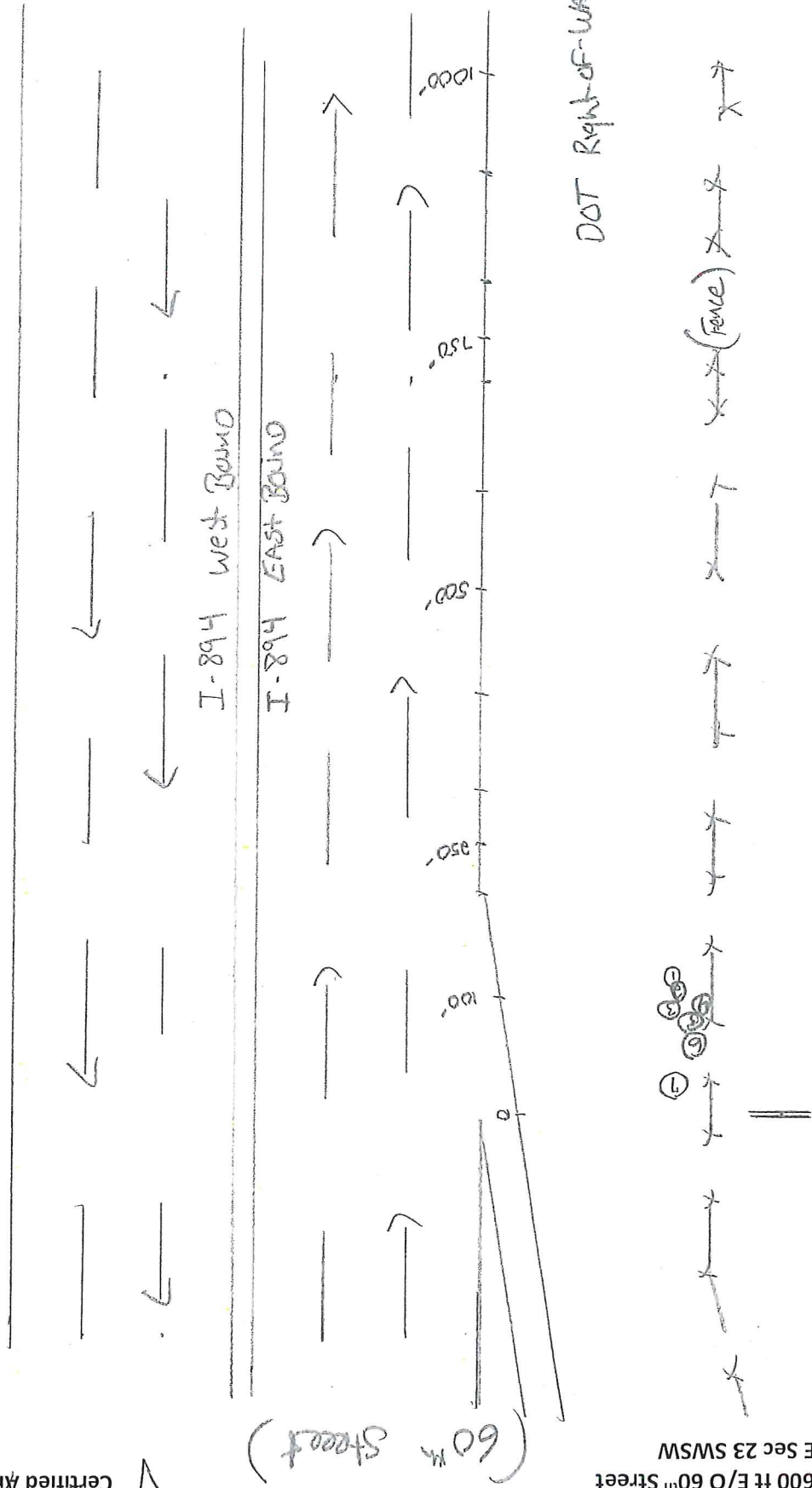

VEGETATION-IDENTIFICATION
From SITE-PLAN

I-894 SS 600 ft E/O 60th St
Oasis #17109 Panel #9151
Lease #31509

- | | |
|--------------|--------|
| 1. Green Ash | Remove |
| 2. Green Ash | Remove |
| 3. Linden | Remove |
| 4. Box Elder | Remove |
| 5. Green Ash | Remove |
| 6. Mulberry | Remove |
| 7. Red Cedar | Remove |

Total trees with a diameter of 2 inches or more to be removed= 7 trees

Harmon, Jenny - DOT

From: Wisniewski, Peter S - DOT
Sent: Monday, June 23, 2014 9:37 AM
To: Harmon, Jenny - DOT
Cc: Matheson, Todd - DOT
Subject: RE: Vegetation Removal

Hey Jenny,

These are all okay to trim vegetation.

I'm compiling a list as these come in. So next year you can do a quick search on this list. Until we get a map together, this is the best method I can think of to give you a way of checking. Even with a map, this would be a very quick way to know or not.

Thanks,

Peter

From: Harmon, Jenny - DOT
Sent: Monday, June 23, 2014 9:00 AM
To: Wisniewski, Peter S - DOT
Subject: Vegetation Removal

Peter,

Please check verify there is no known living snow fence in these areas. ASAP please. Thanks.

<< File: 17084.pdf >> << File: 17107.pdf >> << File: 17109.pdf >> << File: 17158.pdf >>

Jenny Harmon
WisDOT - DTSD, Highway Operations
Outdoor Advertising Program
PO Box 7986, Room 501
Madison, WI 53707-7986
608-266-6703

REMIT TO: Wisconsin Dept of Transportation
VENDOR: 0000123254

DATE: 05/14/14
VEND. LOCATION: 011

CHECK: 0071939001
ORIGIN: 817

| VENDOR INV | DATE | VOUCHER | ACCOUNT #/MESSAGES | AMOUNT |
|------------|----------|----------|---------------------------------|----------|
| DIS042914B | 04/29/14 | 06246362 | CLEAR CHANNEL OUTDOOR MILWAUKEE | \$250.00 |
| TOTAL | | | | \$250.00 |

Detach at Perforation Before Depositing Check

THIS DOCUMENT HAS A COLORED BACKGROUND, MICROPRINTING, VOID PANTOGRAPH AND WATERMARK ON THE BACK.

 **CLEAR CHANNEL**
WORLDWIDE

Clear Channel Outdoor, Inc
P.O. BOX 659512
SAN ANTONIO, TEXAS 78265-9512
(210) 253-4000
APHelpdesk@Clearchannel.com

USbank
Miamisburg, Ohio
56-503/422

(817)

Check No.
0071939001
Date
5/14/2014

PAY EXACTLY *Two Hundred Fifty AND 00/100*

PAY TO THE ORDER OF **WISCONSIN DEPT OF TRANSPORTATION**
POB 7986 Room 501
Highway Maintenance Attn Jenny Kluever
Madison, WI 53707-7986
USA

REF: CLEAR CHANNEL OUTDOOR MILWAUKEE

Amount
\$ 250.00
Void After 12 Months

Bin Al

⑈07193900⑈ ⑆042205038⑆ 130109175039⑈

See Reverse Side For Easy Opening Instructions