

PROJECT ID: 3575-01-76, 3575-01-77, 3575-01-79 COUNTY: JEFFERSON  
WITH 3575-01-78

STATE OF WISCONSIN  
DEPARTMENT OF TRANSPORTATION  
PLAN OF PROPOSED IMPROVEMENT

STATE PROJECT	FEDERAL PROJECT	
	PROJECT	CONTRACT
3575-01-76	NH 2003052	1
3575-01-77	NH 2003053	1
3575-01-79	STP 2003054	1

## INDEX OF SHEETS

Sheet No	Title
Sheet No	Typical Sections and Details
Sheet No	Estimate of Quantities
Sheet No	Miscellaneous Quantities
Sheet No	Right of Way Plot
Sheet No	Plan and Profile
Sheet No	Standard Detail Drawing
Sheet No	Sign Plates
Sheet No	✓ Structure Plans
Sheet No	Computer Earthwork Data
Sheet No	Gross Sections

TOTAL SHEETS 281 + sheet 140A

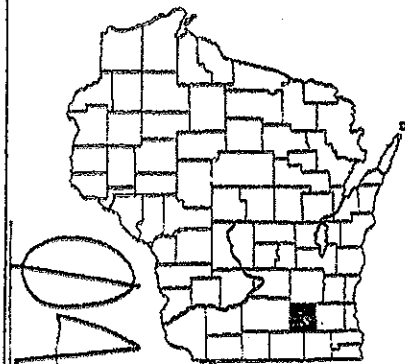

DESIGN DESIGNATION	
ADT(1998)	= 9,200
ADT(2023)	= 20,400
DHV(2023)	= 2,140
D	= 55-45
T % (ADT)	= 5.1
DESIGN SPEED	
STH 26 BYPASS TO BANKER ROAD	= 40 MPH
BANKER ROAD TO MAIN STREET	= 30 MPH
ESALS	= 2,038,700

## CONVENTIONAL SIGNS

COUNTY LINE	—————	POWER POLE	⊕
CORPORATE LIMITS	////////////////	TELEPHONE POLE	⊗
PROPERTY LINE	—————	GAS VALVE	⊙
LOT LINE	-----	WATER VALVE	⊗
LIMITED HIGHWAY EASEMENT	----	HYDRANT	⊕
EXISTING RIGHT OF WAY	—————	UNDERGROUND UTILITIES	
NEW RIGHT OF WAY	—————	CABLE TELEVISION	——— TV ———
REFERENCE LINE	—————	ELECTRIC	——— E ———
SLOPE INTERCEPT	~~~~~	TELEPHONE FIBER OPTIC	——— T-FO ———
ORIGINAL GROUND	~~~~~	TELEVISION FIBER OPTIC	——— TV-FO ———
MARSH OR ROCK PROFILE	-----	GAS	——— G ———
FENCE	X ——— X ——— X	SANITARY SEWER	——— S ———
RAILROADS	—————	STORM SEWER	——— SS ———
MARSH		TELEPHONE	——— T ———
WOODED AREA		WATER	——— W ———
CULVERT IN PLACE		CABLE TV PEDESTAL	⊠
CULVERT REQUIRED		ELECTRIC PEDESTAL	⊡
CULVERT REQUIRED (Profile)		TELEPHONE PEDESTAL	⊞
TRAFFIC SIGNAL		PULL BOX	⊞
TRAFFIC SIGNAL CONTROLLER		TELEPHONE MANHOLE	⊕
LIGHT POLE		WATER CURB STOP	⊗
SIGN		COMBUSTIBLE FLUIDS (UNDER PRESSURE)	

MADISON AVENUE  
(STH 26 TO BANKER ROAD)  
USH 12  
JEFFERSON COUNTY

MADISON AVENUE  
(BANKER ROAD TO MAIN STREET)  
USH 12  
JEFFERSON COUNTY

MADISON AVENUE  
(STH 26 TO MAIN STREET)  
(AESTHETIC ENHANCEMENTS)  
USH 12  
JEFFERSON COUNTY

Dr. Kurt Christmann, Bad  
Nau: Bremen, Carl-Neub. 1  
Friedrichs-Str. 100, 1000

STATE PROJECT NUMBER  
3575-01-76

STATE PROJECT NUMBER  
3575-01-77

STATE PROJECT NUMBER
3575-01-79

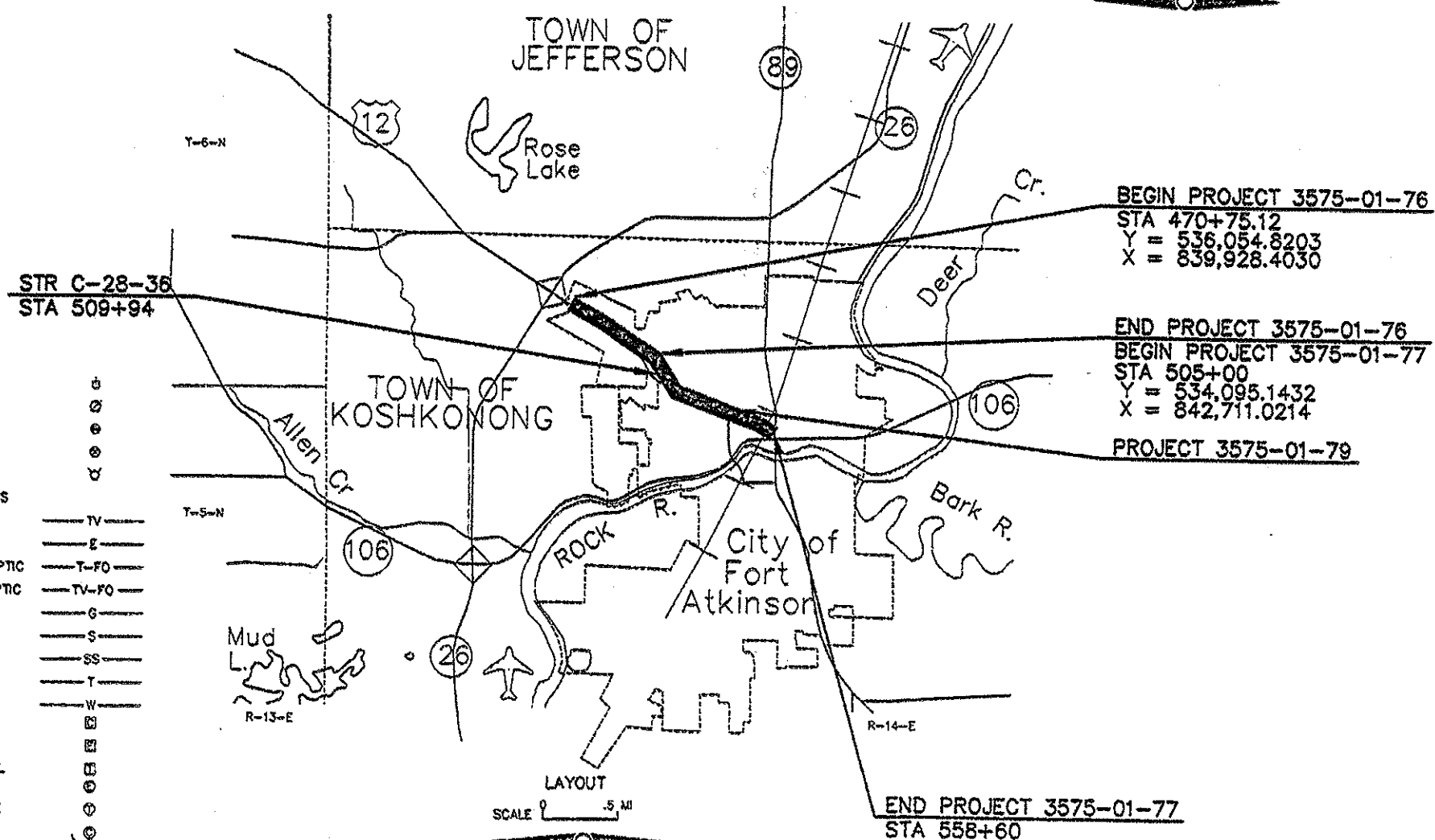

TOTAL NET LENGTH OF CENTERLINE = 0.649 MI 3575-01-76 URBAN  
= 1.015 MI 3575-01-77 URBAN  
= 0.000 MI 3575-01-79  
= 1.664 MI TOTAL

ALL CO-ORDINATES SHOWN ARE REFERENCED TO THE  
WISCONSIN COUNTY CO-ORDINATE SYSTEM FOR JEFFERSON COUNTY. (WCCS)  
ADJUSTMENT BASED ON THE NAD 83 1981 HORIZONTAL DATUM

ACCEPTED FOR

CITY OF FORT ATKINSON

6-14-02 DATE

*[Signature]*  
CITY ENGINEER & D.P.M.  
(SIGNATURE & TITLE OF OFFICIAL)

DATE

(SIGNATURE & TITLE OF OFFICIAL)

ORIGINAL PLANS PREPARED BY

**R. A. SMITH**  
& ASSOCIATES, INC.

Engineering  
Drawn by  
Vides

262-785-1777 fax: 786-0826  
16743 W. Hammond Rd. Suite 301  
Brookfield, WI 53005-2938





6/20/02 DATE

*Steven R. Berg*  
ENGINEER

STATE OF WISCONSIN  
DEPARTMENT OF TRANSPORTATION

PREPARED BY

Surveyor GAK (RA SMITH)

Designer SRB/BSP (RA SMITH)

Project Manager APR

District Examiner *[Signature]*

District Supervisor *[Signature]*

C O Plan Examiner *[Signature]*

APPROVED FOR DISTRICT OFFICE

DATE 6/27/2002 *[Signature]*  
(Signature)

WSDOT/CADDS SHEET 12

# HIGHWAY WORK PROPOSAL

Wisconsin Department of Transportation  
DT1502 5/2002 s.66.29(7) Wis. Stats.

Proposal Number:

04

COUNTY	STATE PROJECT ID	FEDERAL PROJECT ID	PROJECT DESCRIPTION	HIGHWAY
Jefferson	3575-01-76	NH 2003 052	Madison Avenue (STH 26 to Banker Road)	USH 12
Jefferson	3575-01-77	NH 2003 053	Madison Avenue (Banker Road to Main Street)	USH 12
Jefferson	3575-01-78		Madison Avenue (STH 26 to Main Street) (Sanitary Sewer and Water Main Plan)	USH 12
Jefferson	3575-01-79	STP 2003 054	Madison Avenue (STH 26 to Main Street) (Aesthetic Enhancements)	USH 12

This proposal, submitted by the undersigned bidder to the Wisconsin Department of Transportation, is in accordance with the advertised request for proposals. The bidder is to furnish and deliver all materials, and to perform all work for the improvement of the designated project in the time specified, in accordance with the appended Proposal Requirements and Conditions.

Proposal Guaranty Required, \$ 100,000.00  
Payable to: Wisconsin Department of Transportation

Bid Submittal Due

Date: December 10, 2002  
Time (Local Time): 9:00 AM

Contract Completion Time  
Completion Date: October 30, 2003

Assigned Disadvantaged Business Enterprise Goal

9 %

Attach Proposal Guaranty on back of this PAGE.

Firm Name, Address, City, State, Zip Code

**SAMPLE**

**NOT FOR BIDDING PURPOSES**

This contract is: subject to federal oversight.

This certifies that the undersigned bidder, duly sworn, is an authorized representative of the firm named above; that the bidder has examined and carefully prepared the bid from the plans and specifications and has checked the same in detail before submitting this proposal or bid; and that the bidder or agents, officer, or employees have not, either directly or indirectly, entered into any agreement, participated in any collusion, or otherwise taken any action in restraint of free competitive bidding in connection with this proposal bid.

Do not sign, notarize, or submit this Highway Work Proposal when submitting an electronic bid on the Internet.

Subscribed and sworn to before me this date \_\_\_\_\_

(Signature, Notary Public, State of Wisconsin)

(Bidder Signature)

(Print or Type Name, Notary Public, State Wisconsin)

(Bidder Signature)

(Date Commission Expires)  
Notary Seal

(Bidder Signature) (Bidder Title)

## For Department Use Only

Type of Work

Grading, base course, breaker run stone, concrete pavement, box culvert, curb and gutter, sidewalk, storm sewer, lighting, traffic signals, sanitary sewer, water main

Notice of Award Dated

Date Guaranty Returned

	01-76, Item 65085; Construction Staking, Electrical, Project 3575-01-77, Item 65086; Construction Staking, Electrical, Project 3575-01-79, Item 65087.....	43
33.	Approved Electrical Materials Listing and Updates to the Standard Electrical Specifications.....	47
34.	Temporary Channel Diversion, Structure C-28-36, Item 90004A.....	58
35.	Removing Cantilever Sign Structure, Item 90004B.....	58
36.	Temporary Traffic Signal, USH 12 & Main, Item 90004C.....	59
37.	Modify Existing Traffic Signal Cabinet, USH 12 & Lexington, Item 90004D.....	59
38.	Modify Existing Traffic Signal Cabinet, USH 12 & Robert, Item 90004E.....	60
39.	Modify Existing Traffic Signal Cabinet, USH 12 & Main, Item 90004F.....	61
40.	Salvage Traffic Signal Equipment, USH 12 & Lexington, Item 90004G.....	61
41.	Salvage Traffic Signal Equipment, USH 12 & Robert, Item 90004H.....	62
42.	Install Salvaged Traffic Signal Equipment, USH 12 & Lexington, Item 90004J.....	62
43.	Sign Posts, 14-Foot, Item 90005A; Sign Posts, 16-Foot, Item 90005B.....	62
44.	V-LOC Model 23, Item 90005C.....	63
45.	Mobilizations, Residential and Business Access, Item 90005D.....	63
46.	Sanitary Sewer Manholes, Item 90005E.....	64
47.	Removing Sanitary Sewer Manhole, Item 90005F.....	69
48.	Adjusting Sanitary Sewer Manhole Covers, Item 90005G.....	70
49.	Reconstructing Sanitary Manhole, Item 90005H.....	71
50.	Connect to Existing Sanitary Manhole, Item 90005J.....	72
51.	Connect to Existing Sanitary Sewer, Item 90005K.....	72
52.	Gate Valve, 8-Inch, Item 90005L; Butterfly Valve, 12-Inch, Item 90005M; Butterfly Valve, 16-Inch, Item 90005N.....	73
53.	Hydrants, Item 90005P.....	74
54.	Removing Existing Hydrants, Item 90005Q.....	77
55.	Connection to Existing Water Main, Cut-In, Item 90005R.....	77
56.	Connection to Existing Water Main, Item 90005S.....	78
57.	Concrete Bases, Type 2, Special, Item 90005T; Concrete Bases, Type 5, Special, Item 90005U.....	79
58.	Poles, Type 4, Special, Item 90005V; Poles, Type 5, Special, Item 90005W.....	80
59.	Luminaire, 250 WATT MH, Special, Item 90005X.....	80
60.	Luminaire Arm, Single Member, 4-Foot with Tenon Adapter, Item 90005Y; Luminaire Twin Arm, Single Member, 4-Foot with Tenon Adapter, Item 90005Z.....	81
61.	Street Lighting Electrical Service, Item 90005AA.....	81
62.	Street Lighting Control Center, Item 90005BB.....	82
63.	Guard Post, Item 90005CC.....	83
64.	Concrete Curb and Gutter, 30-Inch, Type A, Integral, Item 90030A; Concrete Curb and Gutter, 66-Inch, Type A, Item 90030B.....	83
65.	Removing Storm Sewer, 6-Inch, Item 90030C; Removing Storm Sewer, 8-Inch, Item 90030D; Removing Storm Sewer, 10-Inch, Item 90030E; Removing Storm Sewer, 12-Inch, Item 90030F; Removing Storm Sewer, 15-Inch, Item 90030G; Removing Storm Sewer, 18-Inch, Item 90030H; Removing Storm Sewer, 21-Inch, Item 90030J; Removing Storm Sewer, 24-Inch, Item 90030K.....	84
66.	Tree Root Sawing, Item 90030L.....	84
67.	Pipe Railing for Steps, Item 90030M.....	85

**58. Poles, Type 4, Special, Item 90005V; Poles, Type 5, Special, Item 90005W.**

**A. Description.** This item of work shall be in accordance with the Standard Specifications except the poles shall be octagonal painted steel with an integral "H" style base of nominal luminaire mounting height at 27-feet 6-inches. The pole top shall be fitted with a 3-inch OD X 9-inch tall tenon to accept the luminaire single or twin arm tenon adapter. Type 4 poles shall be minimum 7-gauge and Type 5 poles shall be minimum 11-gauge steel. The bolt circle shall be 15-inch for both poles with 1-inch diameter anchor bolts.

Poles shall be prime painted and finish coated at the factory. The manufacturer shall furnish a paint sample to match the City green color required for luminaries and arms. The contractor shall receive confirmation from the engineer that the City has accepted the color sample prior to manufacturer of the poles.

**B. Method of Measurement.** Poles, Type 4, Special and Poles, Type 5, Special shall be measured by the unit in place, completed and accepted.

**C. Basis of Payment.** Poles, Type 4, Special and Poles, Type 5, Special, measured as provided above, will be paid for at the contract unit price each; which price shall be full compensation for furnishing and installing all materials for all labor, tools, equipment and incidentals necessary to complete the work in accordance with the plans and contract.

**59. Luminaire, 250 WATT MH, Special, Item 90005X.**

**A. Description.** This item of work shall be in accordance with the Standard Specifications except the luminaire shall be specification grade ornamental teardrop 250-Watt Metal Halide as shown in plans and defined herein.

Ballast shall be copper wound Pulse Start 250 Watt Metal Halide with encapsulated starter. Ballast components shall be mounted to a unitized electrical module complete with disconnection plugs and shall be mounted and removable from above the lamp chamber. Three lug terminal block and street lighting grade mogul socket with lamp grip shell, center contact backed by coiled spring and glazed porcelain body to minimize undue vibration & back-out of lamp shall be provided. Complete ballast assembly shall be UL Listed for Wet Locations at 40 degree C.

Optical assembly shall be prismatic borosilicate glass refractor in teardrop shape. Combination of vertical burn base up lamp, anodized reflector & refractor shall produce IES Cutoff Type IV distribution.

Cast housings and hinged doorframe shall be copper free aluminum & finished with 7-stage electrostatically applied polyester powder paint. Contractor shall provide paint color chart for City selection of shade of green. All exposed hardware shall be stainless steel.

Complete luminaire assembly shall be vibration tested by manufacturer. The test shall verify that the luminaire is capable of withstanding, for stresses caused by peak accelerations from vibration of at least 1g for the equivalent of 20 years field operation. The test results shall show no structural damage to the luminaire enclosure, no reduction in electrical spacing and no loosening of fasteners sufficient to allow the release of any fixed integral component.

Luminaire shall be supplied with cast aluminum leveling adaptor to allow installation on specified arm and 250 Watt metal halide coated bulb finish lamp for base up operation on a pulse start ballast with a minimum rated life of 15,000 hours.

**B. Method of Measurement.** Luminaire 250 Watt MH, Special, shall be measured by the unit in place, completed and accepted.

**C. Basis of Payment.** Luminaire, 250 Watt MH, Special, measured as provided above, will be paid for at the contract unit price each; which price shall be full compensation for furnishing and installing all materials including luminaires, ballasts, lamps, hardware and attachments, and for all labor, tools, equipment and incidentals necessary to complete the work in accordance with the plans and contract.

**60. Luminaire Arm, Single Member, 4-Foot with Tenon Adapter, Item 90005Y; Luminaire Twin Arm, Single Member, 4-Foot with Tenon Adapter, Item 90005Z.**

**A. Description.** Luminaire arms shall be round aluminum, single member, as a single piece construction as shown in the plans. Arm shall consist of ornamental post-top mounting piece with a bent tube arm and a removable finial for wiring access. The bent tube shall be 4-feet horizontally and have a nominal 18-inch vertical offset from the pole top slip fitter housing to the luminaire slip fitter entrance. Twin luminaries shall have two 4-foot bent arms as shown in the plans. Arm and mounting piece shall slip fit assemble to a 3"OD x 9" tall pole top tenon and be secured by a minimum of 6 stainless steel socket setscrews. Finish shall be the same as for luminaire.

**B. Method of Measurement.** Luminaire Arm, Single Member, 4-foot with tenon adapter and Luminaire Twin Arm, Single Member, 4-foot with tenon adapter, shall be measured by the unit in place, completed and accepted.

**C. Basis of Payment.** Luminaire Arm, Single Member, 4-foot with tenon adapter and Luminaire Twin Arm, Single Member, 4-foot with tenon adapter, measured as provided above, will be paid for at the contract unit price each; which price shall be full compensation for furnishing and installing all materials including arm, slip fitter housing, hardware and attachments, and for all labor, tools, equipment and incidentals necessary to complete the work in accordance with the plans and contract.

**61. Street Lighting Electrical Service, Item 90005AA.**

**A. Description.** This item shall be in accordance with the standard specifications except a time of day meter shall be furnished.