

STATE OF WISCONSIN  
WISCONSIN DEPARTMENT OF TRANSPORTATION

28-146  
67-146

COUNTY: JEFFERSON

	DATE	MILEAGE FOR LOCAL ROADS/STREETS	<b>LOCAL ROADS/STREETS</b> Certified in accordance with sec. 86.30 Wis. stat.	
(1)	4-1-21	0.11	Name:	Title:
(2)	1-1-22	.		
(3)	4-1-22	.		
			Signature:	Date:

COUNTY: WAUKESHA

	DATE	MILEAGE FOR LOCAL ROADS/STREETS	<b>LOCAL ROADS/STREETS</b> Certified in accordance with sec. 86.30 Wis. stat.	
(1)	4-1-21	3.19	Name:	Title:
(2)	1-1-22	.		
(3)	4-1-22	.		
			Signature:	Date:

- (1) THIS DATA REPRESENTS THE LAST CERTIFIED MILEAGE AS CORRECTED BY WISDOT WHICH MAY HAVE BEEN USED FOR PAST TRANSPORTATION AIDS.
- (2) THE TOWN CHAIRMAN OR CITY/VILLAGE CLERK IS TO FILL IN THE MILEAGE TO BE CERTIFIED AS OPEN TO THE PUBLIC AS OF THE FOLLOWING JANUARY, INCLUDING THE NEW CHANGES THAT ARE MADE ON THE PLAT.
- (3) THIS DATA REPRESENTS MILEAGE ADJUSTMENTS MADE BY WISDOT DUE TO FIELD VERIFICATION, INVENTORY, ANNEXATION, ETC. TRANSPORTATION AID PAYMENTS MAY BE MADE BASED ON THIS FIGURE.

COUNTY: JEFFERSON

MILEAGE FOR COUNTY TRUNKS	MILEAGE FOR COUNTY OTHER ROADS
00.00	00.00

VILLAGE OF  
**LAC LA BELLE**  
COUNTY: JEFFERSON, WAUKESHA

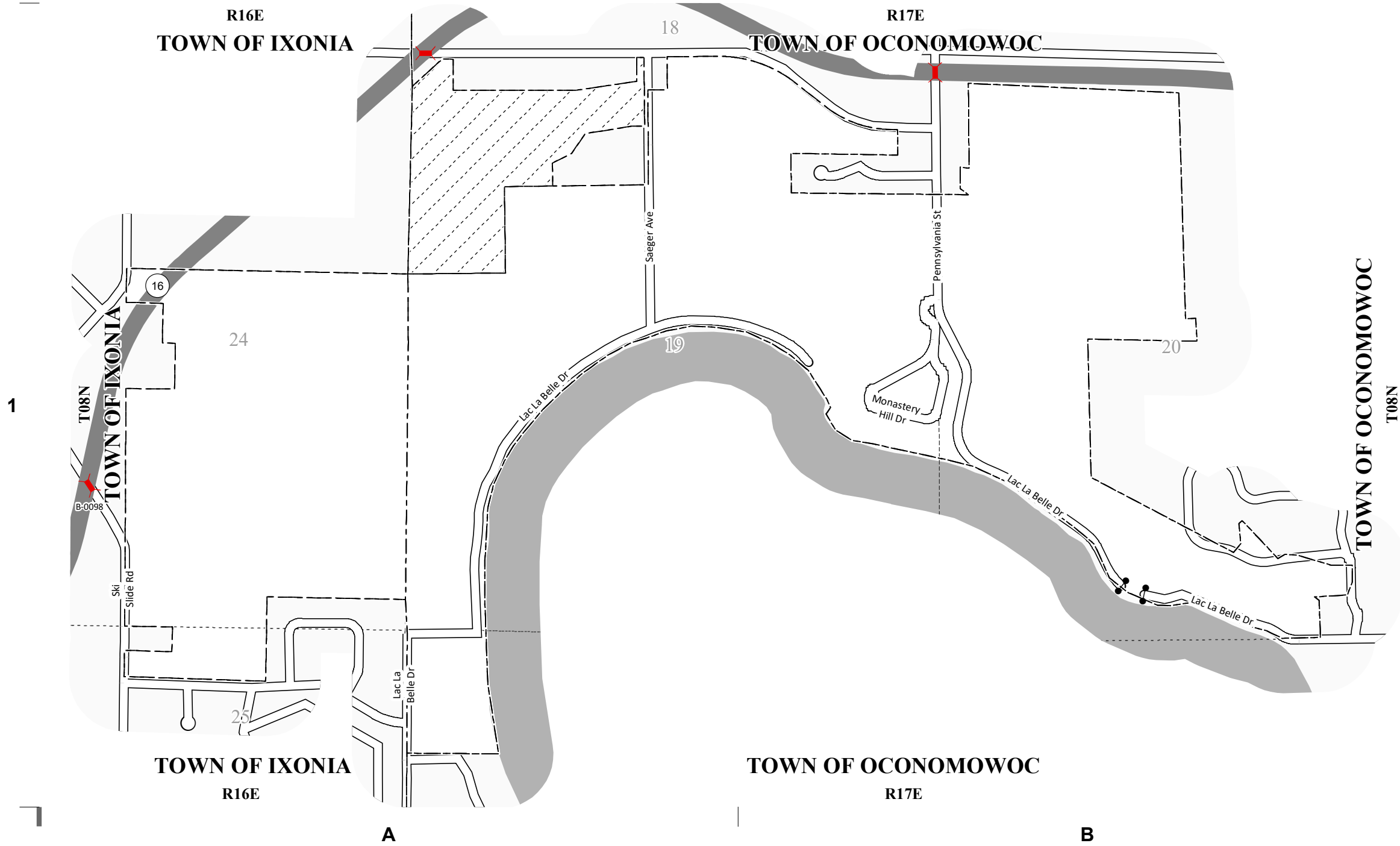

LEGEND:

	Local Road		Annexation
	State Trunk		Annexation Creating Town Island
	State On/Off Ramp		Litigation
	CVT Border		Bridge
	PLSS Border		Gate

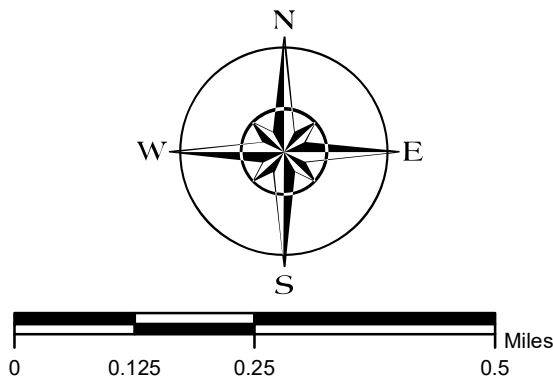

The information contained on this map was created for the official use of the Wisconsin Department of Transportation (WisDOT). Any other use while not prohibited, is the sole responsibility of the user. WisDOT expressly disclaims all liability regarding fitness of use of the information for other than official WisDOT business.